

PRIME DESIGN™

A Safe Fleet Brand

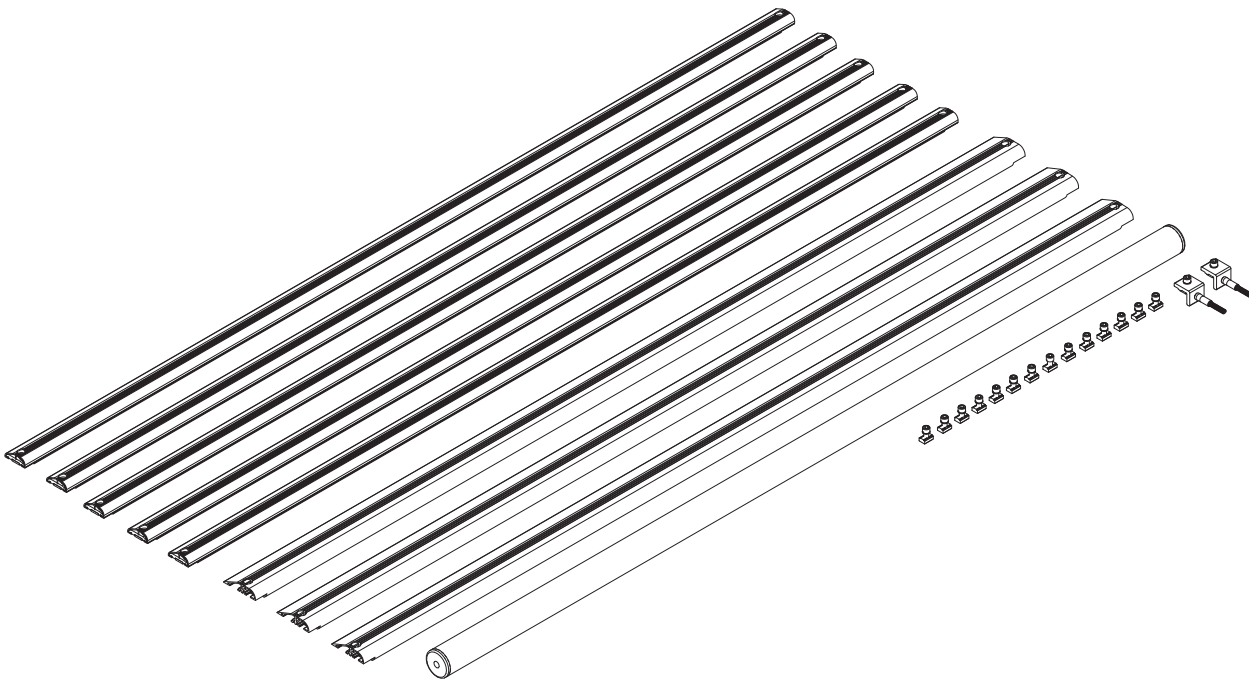

MODELS AVAILABLE:

AR-2002 (CLEAR ANODIZED)

AR-2002-BLK (BLACK ANODIZED)

AR-2002 AluRack Crossbar Module, 59" Kit

Page 2	Packaging Contents
Page 3	Strip Nuts and Roller Bracket
Page 4	Crossbar Configurations
Page 5	Crossbar Installation
Page 6	Roller Installation
Page 7	Final Instructions

PRIME DESIGN, A SAFE FLEET BRAND

Address: 580 Opperman Drive, Eagan, MN 55123 • Toll Free: 1.8.PRIME.RACK
Fax: 651-552-1799 • Email: info@primedesign.net • Website: www.primedesign.net

AR-2002

CONTENTS OVERVIEW

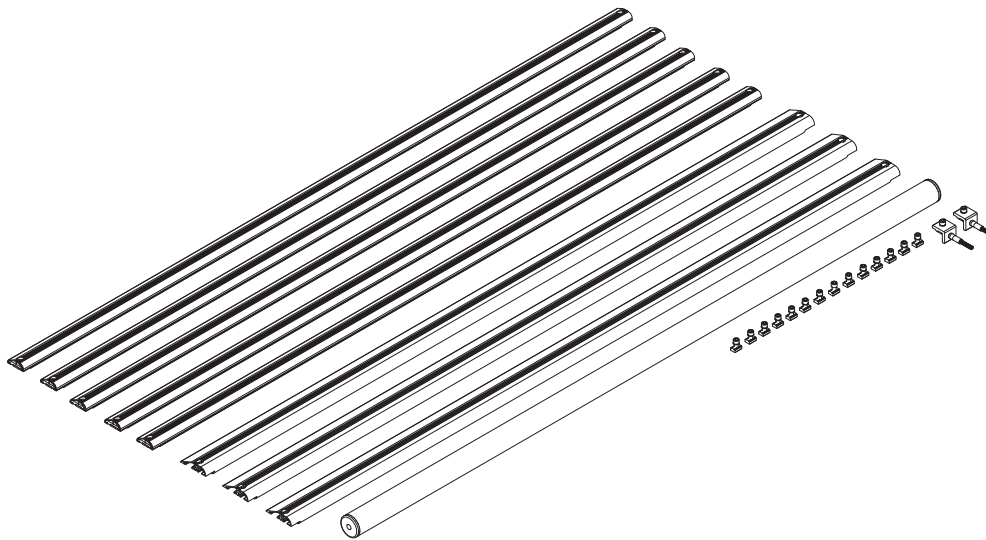

AluRack Heavy Duty Crossbar (Qty 3)
 With hardware, 59.00”
 Clear or Black (BLK), Anodized



AluRack Standard Crossbar (Qty 5)
 With hardware, 59.00”
 Clear or Black (BLK), Anodized



AluRack Roller Assembly (Qty 1)
 55.75”, with Caps
 Clear or Black (BLK), Anodized



Crossbar and Roller Hardware (Qty 1)

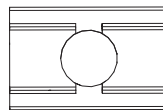

M8 Strip Nut (18X)

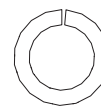

M8 Lock Washer (18X)

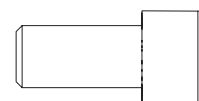

M8 Cap Head Bolt (18X)



Roller Bracket (2X)



Roller Tube Pin (2X)

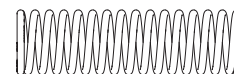

Roller Spring (2X)



Anti-Seize (1X)

STRIP NUT INSTALLATION

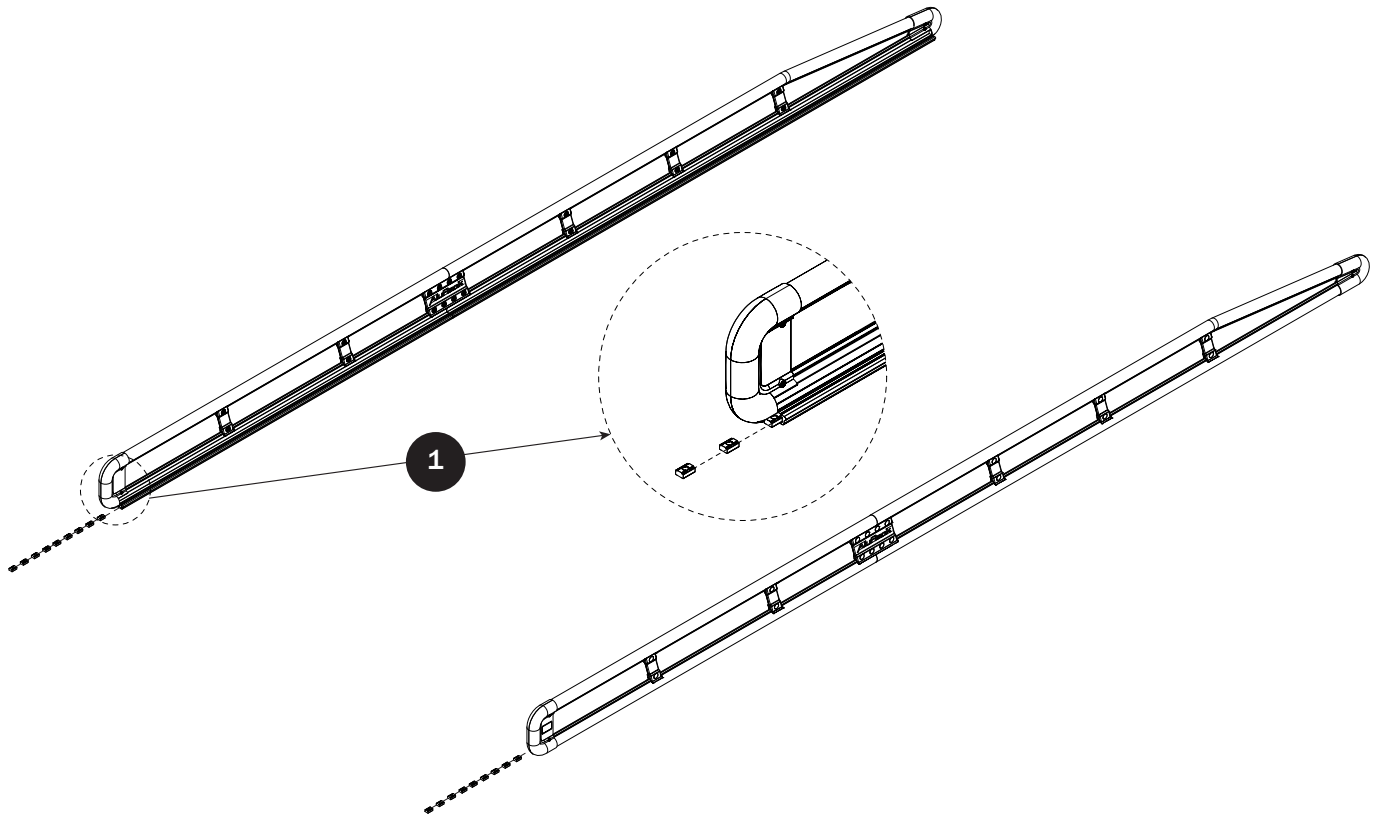

ROLLER BRACKETS

- 2 Install Roller Brackets into the rear most Strip Nuts, and align flush against the rear end of the Side Rail as shown. Torque Roller Bracket Bolts to 90 in-lbs.

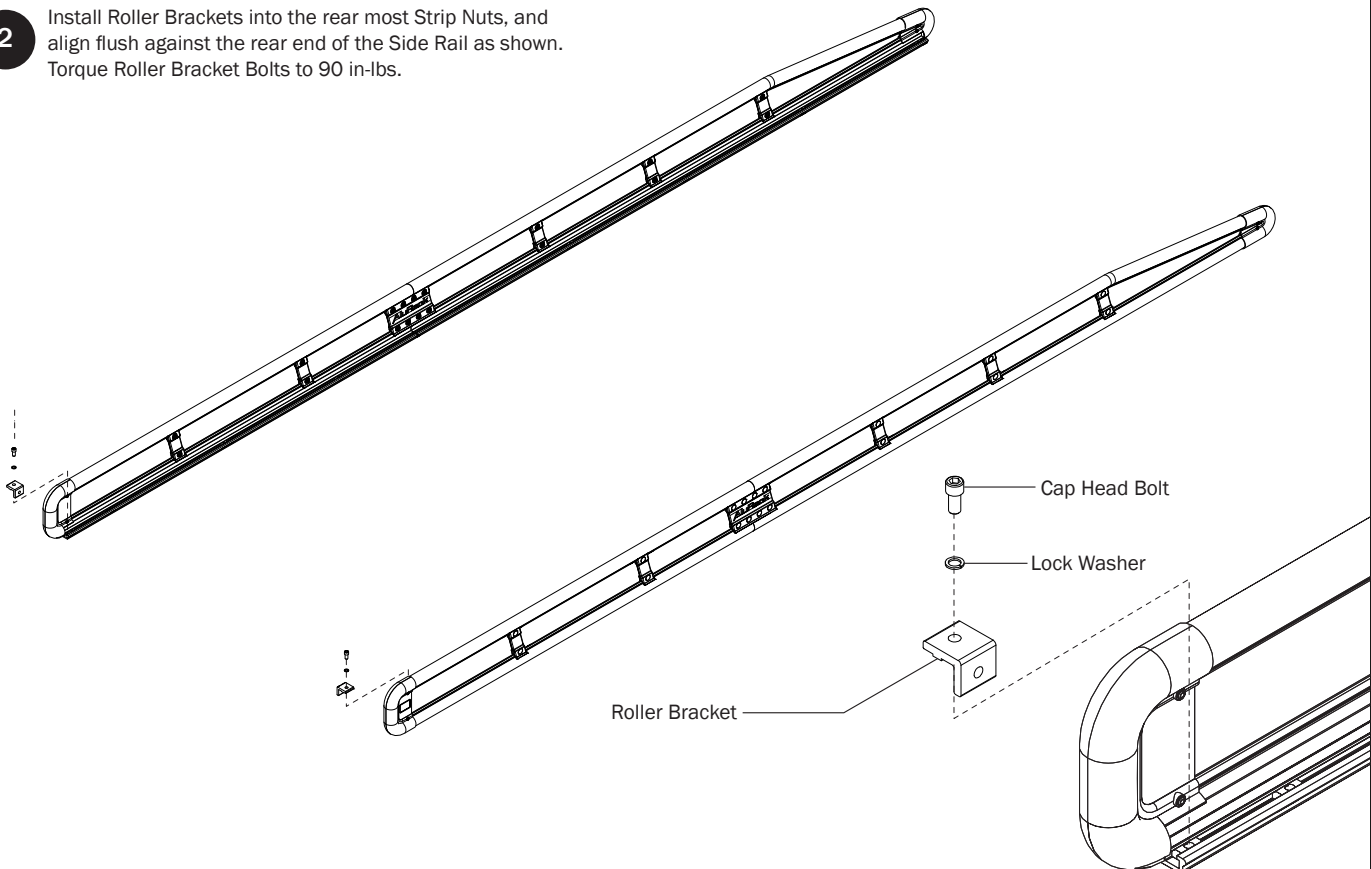

CROSSBAR CONFIGURATIONS

3 Measurements are specified according to distances from the Side Rail rear ends. It is recommended to determine your Crossbar pattern before installing them into your Strip Nuts to ensure proper order of use.

*The AluRack shown in Fig.1 is for Illustrative Purposes only, and your Configuration will vary. Refer to the table in Fig. 2-3 for your product-specific Configuration.

Fig. 1

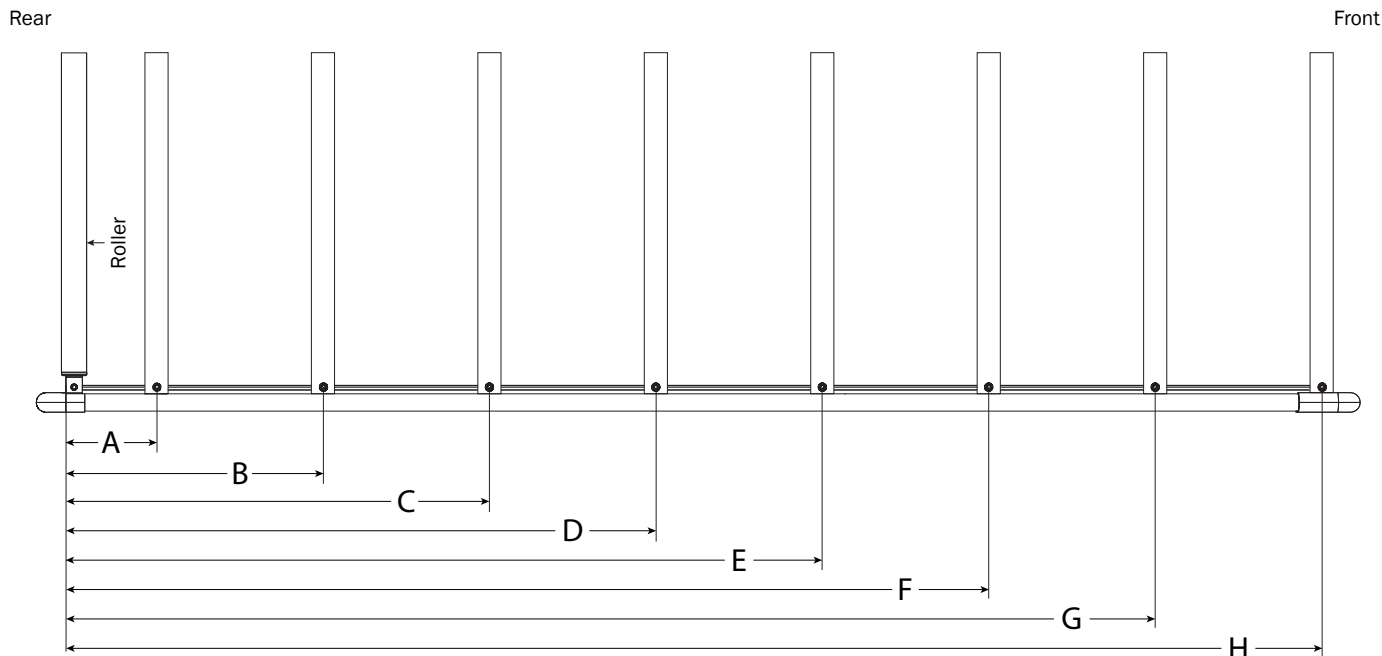

Fig. 2 | STD=STANDARD CROSSBAR | HD=HEAVY DUTY CROSSBAR

PRODUCT	Crossbar A	Crossbar B	Crossbar C	Crossbar D	Crossbar E	Crossbar F	Crossbar G	Crossbar H	FRONT SIDE RAIL END
AR1916: Metris 2016 L2H1 126" Wheelbase, 76" Roof Height	5.00" STD	20.00" HD	35.00" STD	50.00" STD	65.00" HD	80.00" STD	95.00" HD	Flush to Front Side Rail End	*112.00"
AR1929: Sprinter 2007+ L2H2 144" Wheelbase, 111" Roof Height	10.00" HD	25.50" STD	41.00" STD	56.50" HD	72.00" STD	87.50" STD	103.00" HD	Flush to Front Side Rail End	*120.00"
AR1930 Sprinter 2007+ L3H2/L4H2 170" Wheelbase, 111" Roof Height	9.75" HD	29.75" STD	49.75" STD	69.75" HD	89.75" STD	109.75" STD	129.75" HD	Flush to Front Side Rail End	*152.00"
Metris 2018 L3H1 135" Wheelbase, 76" Roof Height	3.75" STD	20.00" HD	36.25" STD	52.50" STD	68.75" HD	85.00" STD	101.25" HD	Flush to Front Side Rail End	*120.00"

* Side Rail Sizes vary according to customer sizing needs - See respective AR Side Rail Kit Manual to build your Side Rails.
 ** When mounting your AluRack, mounts must attach to the Heavy Duty Crossbars. Customer may adjust distances as needed.
 *** Custom Rack Layouts: Maximum Bolt Spacing on Crossbars and Roller is 24.00". Extra Heavy Duty Crossbars and Hardware are available as needed-contact Sales and Service.

LEFT SIDE RAILS AND CROSSBARS

4

Install the Crossbars according to your configuration in the Strip Nuts as shown and torque to 90 in-lbs.



NOTE: Rack shown is for Illustrative Purposes only. The order and placement of Standard Crossbars, Heavy Duty Crossbars, and Roller will vary as shown in Step 1, Fig. 2.

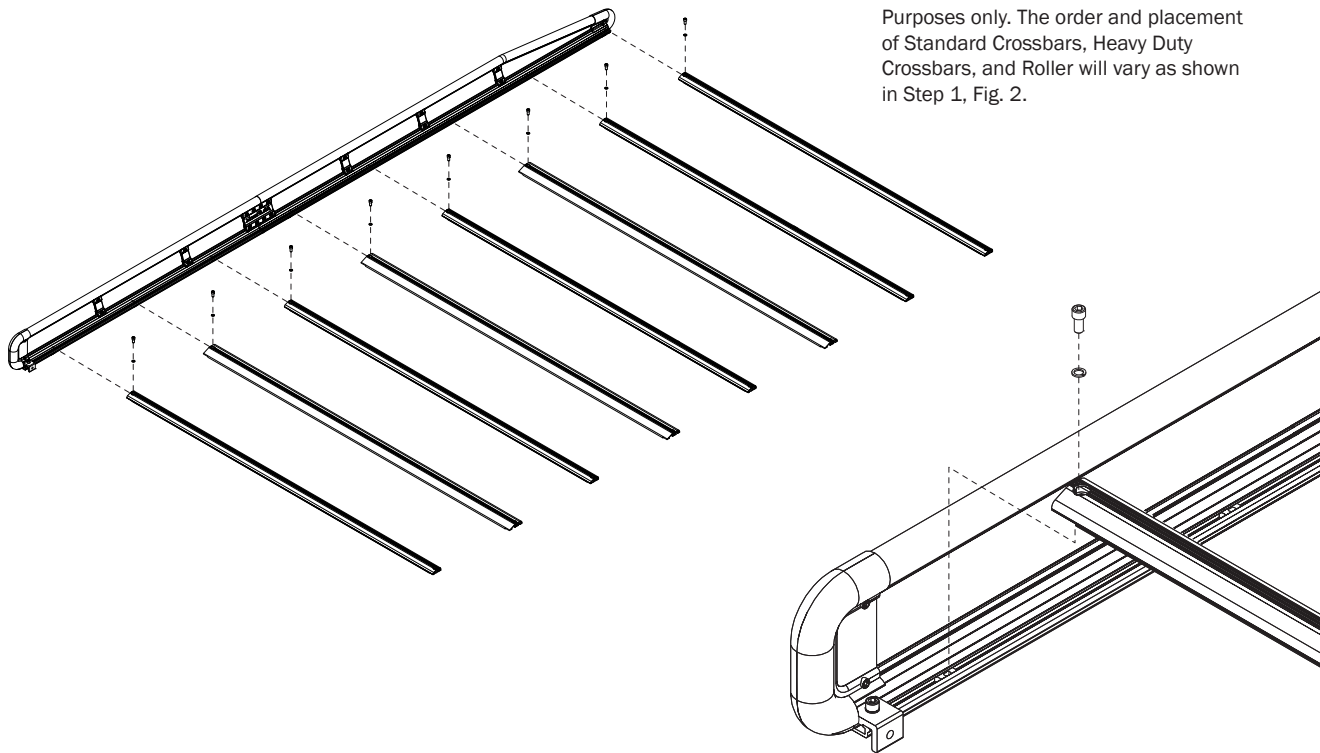

RIGHT SIDE RAILS AND CROSSBARS

5

Install the Crossbars according to your configuration in the Strip Nuts as shown and torque to 90 in-lbs.

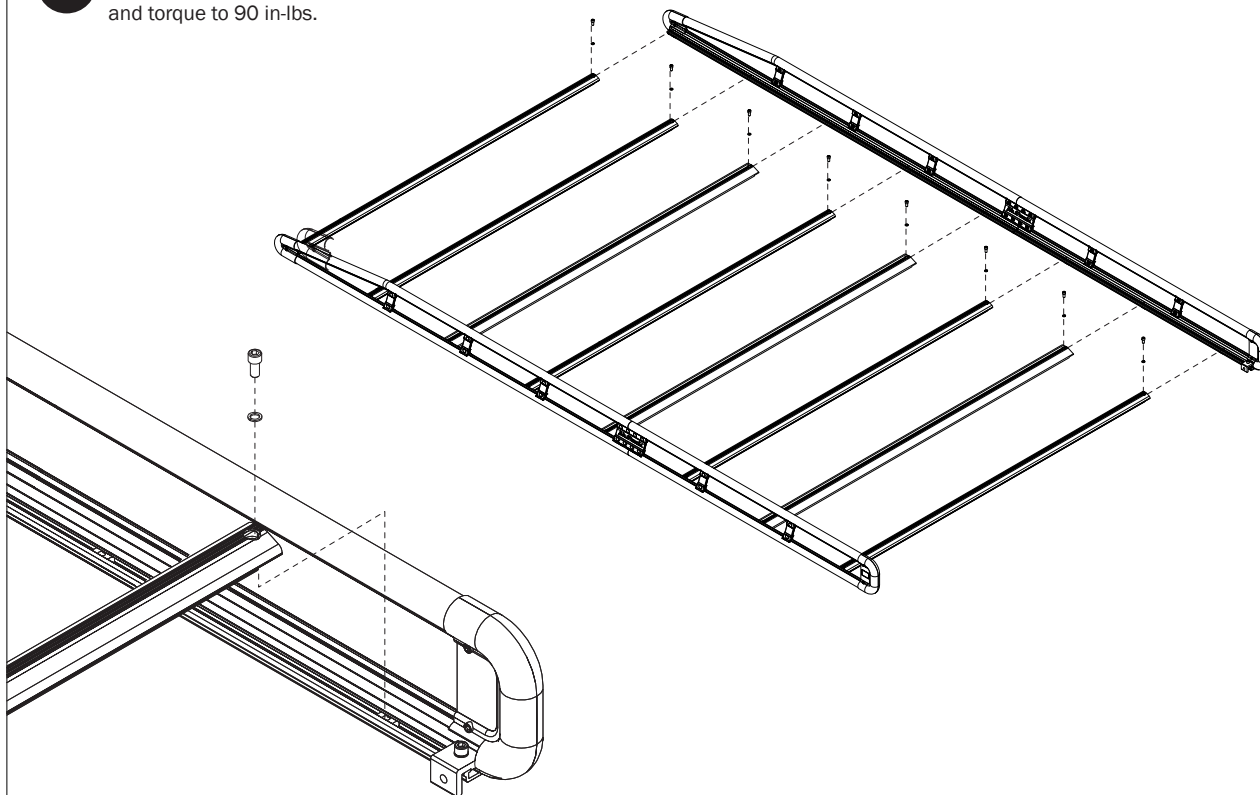

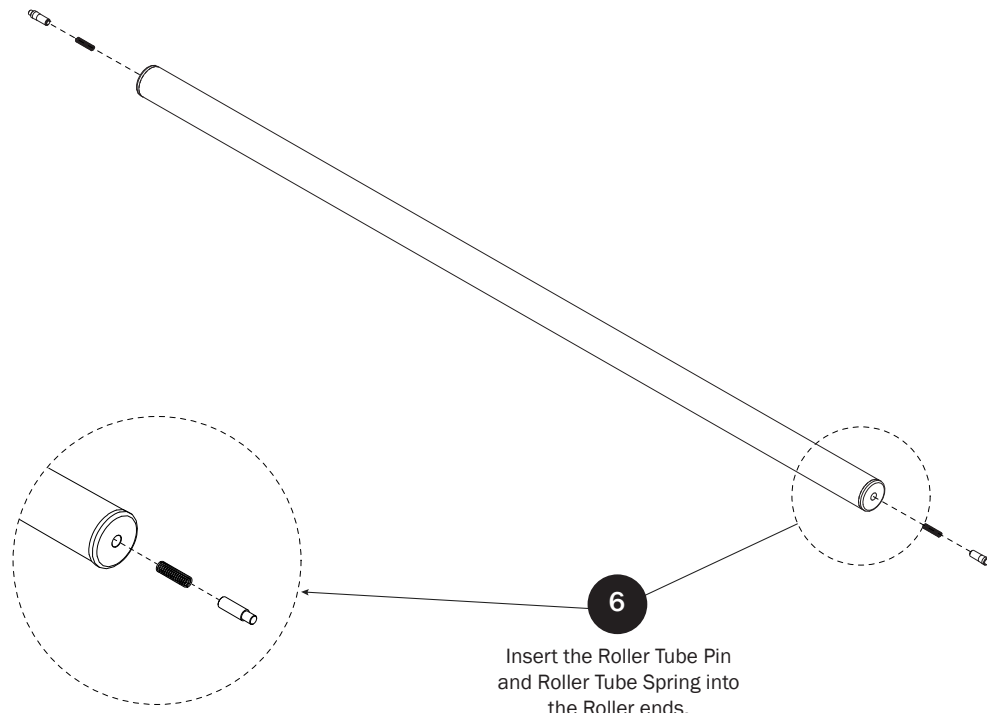
ROLLER INSTALLATION**ROLLER ASSEMBLY**

- 7 Insert the Roller Tube Pin on each side of the Roller Tube into the Brackets as shown.

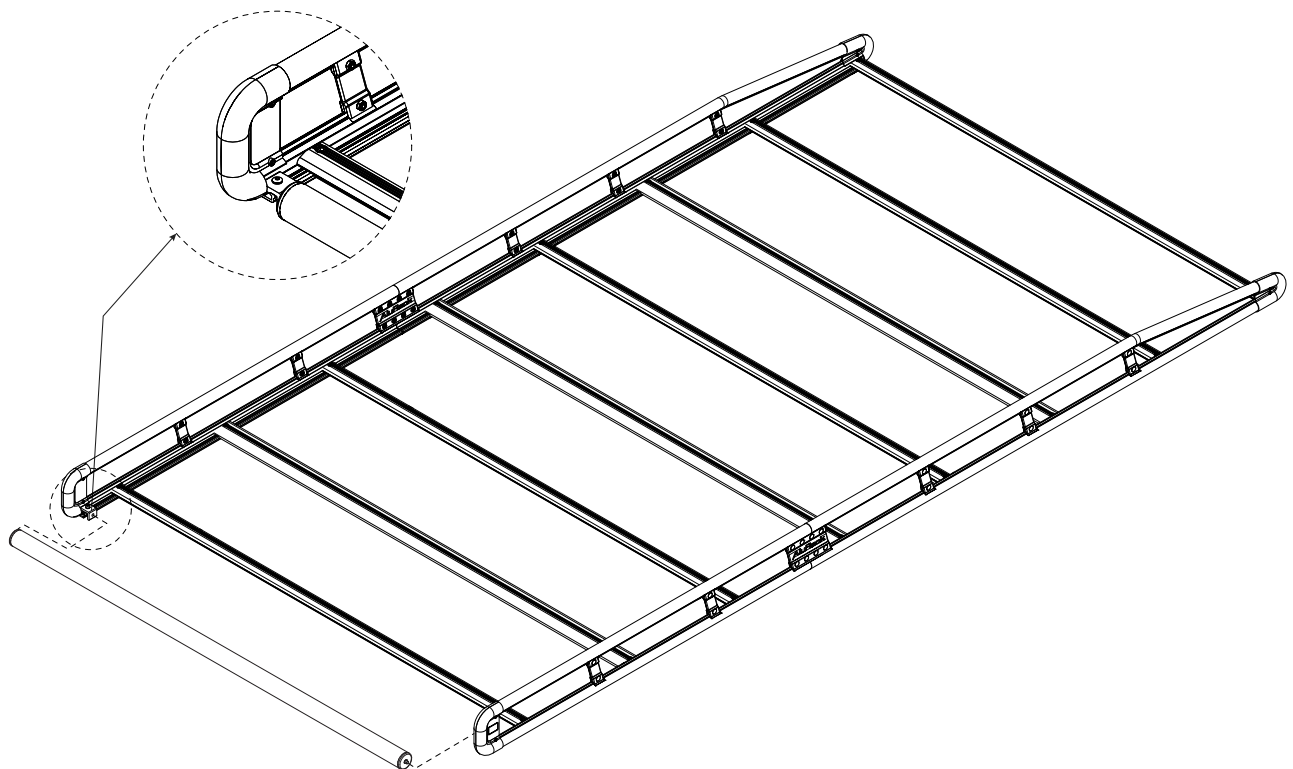

FINAL INSTRUCTIONS FOR WORK VANS

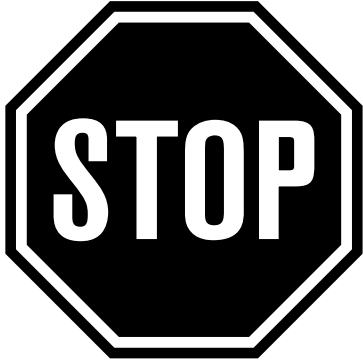

Do not mount the AluRack to an FBM system at this time.

Refer to the respective FBM Assembly Manual(s) included with your chosen rack configuration features.

WARNING: Failure to position the AluRack as shown in your FBM Assembly Manual may result in damage to the ladder rack.

INSTALLER NOTE: To purchase applicable features and accessories, please contact your authorized distributor, or a Prime Design Sales & Service Representative.

