

PRIME DESIGN™

A Safe Fleet Brand

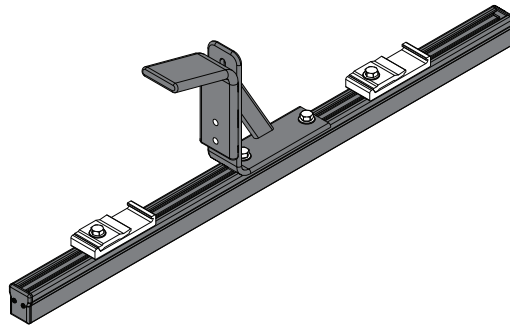

CONTENTS OVERVIEW

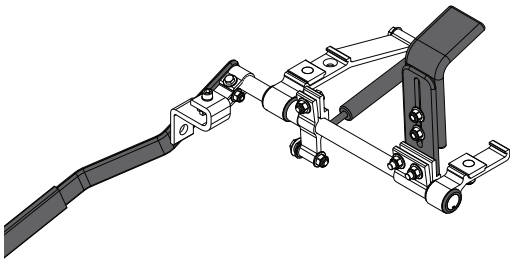
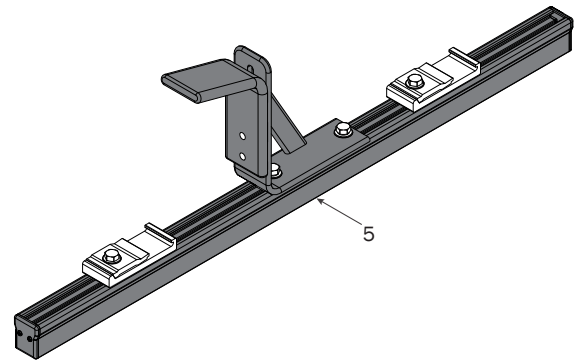
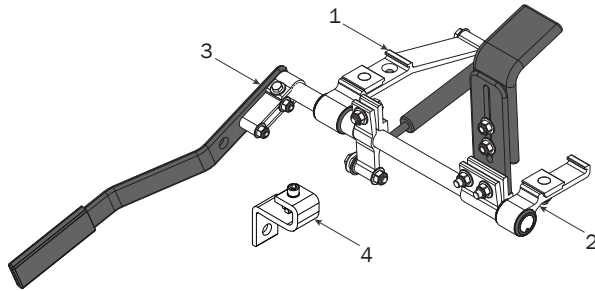

1—Quick Clamp AssemblyQty 1)
Left Hand, Rear, w/Handle

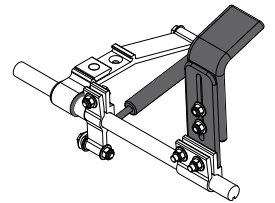

2—Rear Clamp Support Assembly..... (Qty 1)
AluRack



3—Clamp Down Handle Assembly (Qty 1)
Left Hand, 14.00", Bent w/Hardware



4—Lock Bracket Assembly..... (Qty 1)
AluRack, w/Hardware



5—Quick Clamp Front Hook Assembly (Qty 1)
AluRack, Adjustable

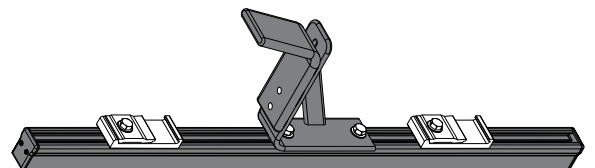

RIGHT ACX ASSEMBLY SEQUENCE



This ACX Left Hand Quick Clamp Assembly is shown installed onto a Prime Design AluRack for illustrative purposes only.

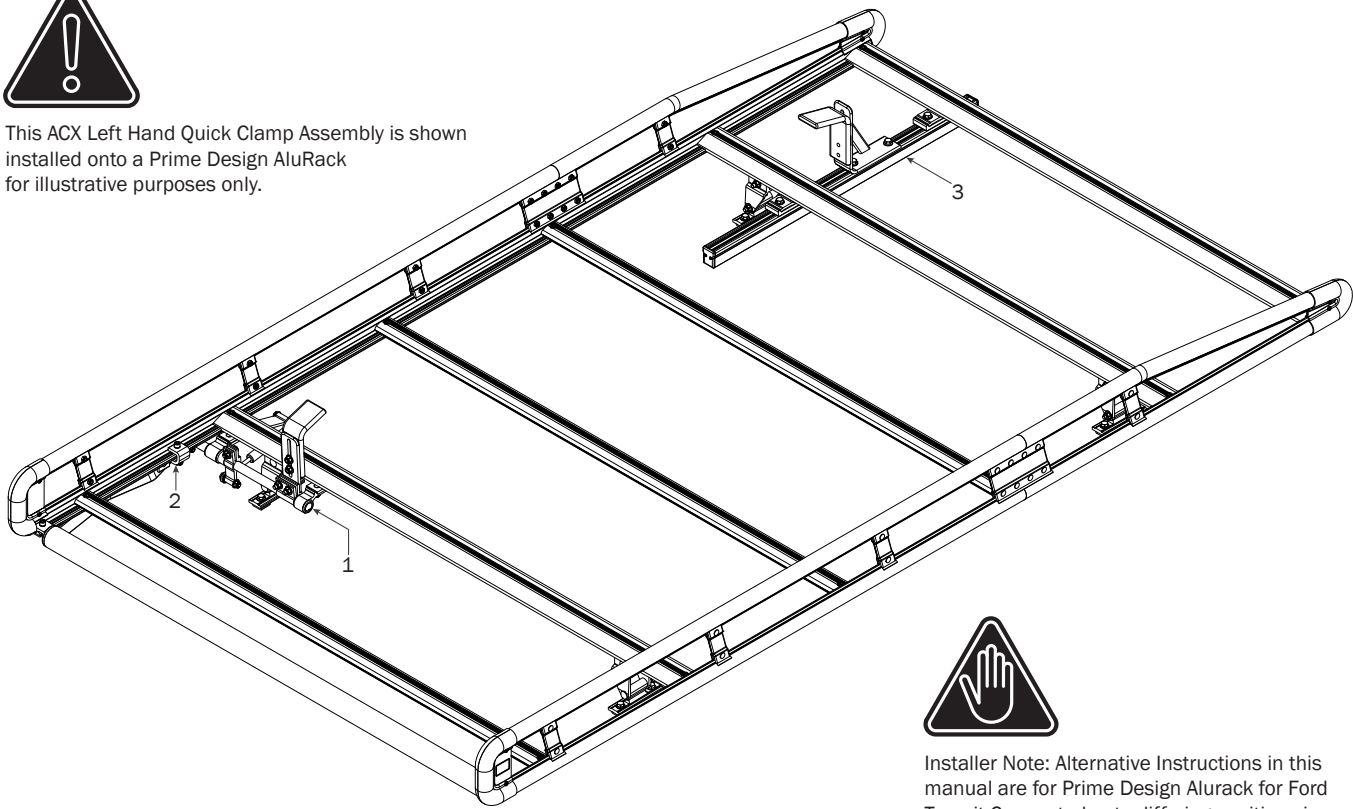

Installer Note: Alternative Instructions in this manual are for Prime Design Alurack for Ford Transit Connect, due to differing positions in Channel Mounts.

REAR QUICK CLAMP

SEE QUICK START GUIDE FOR ADJUSTMENTS

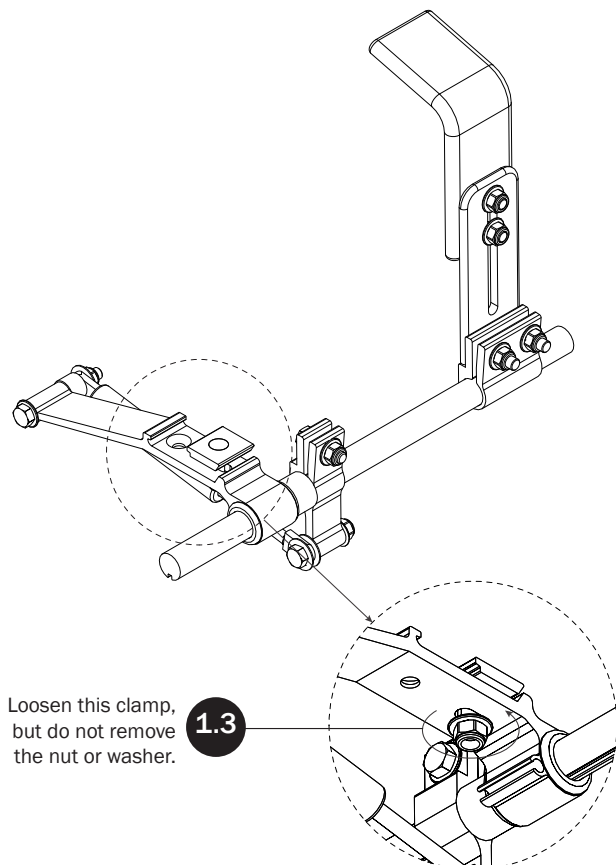
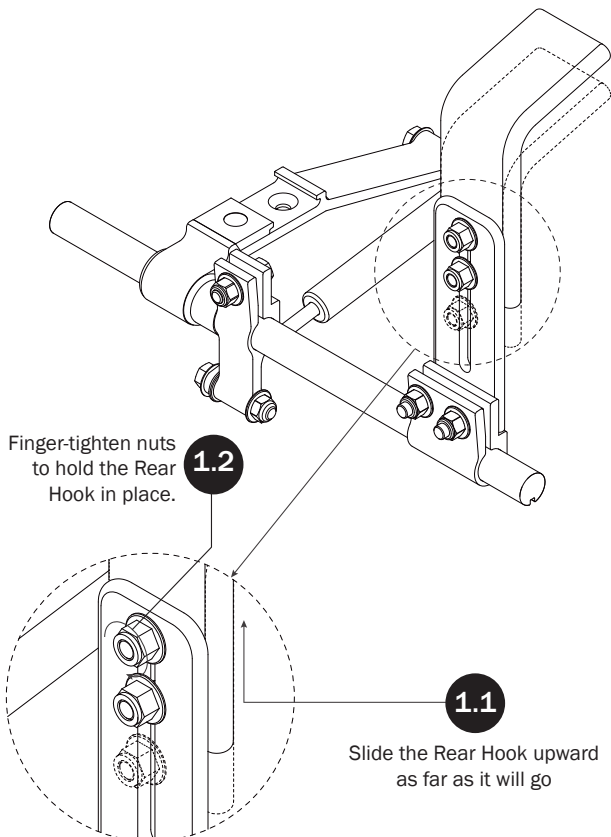

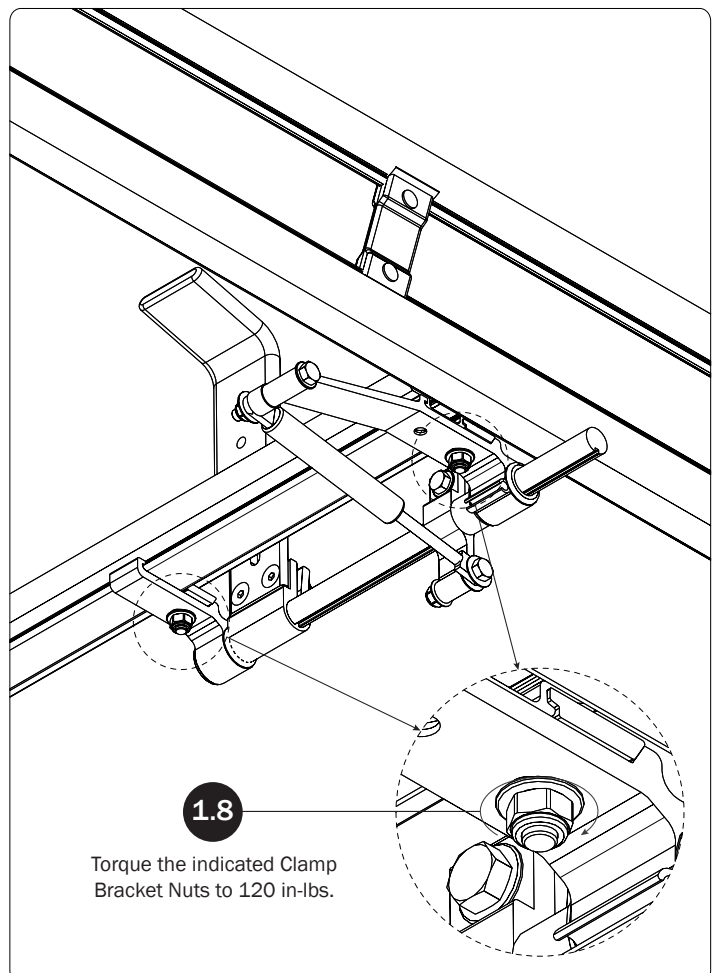
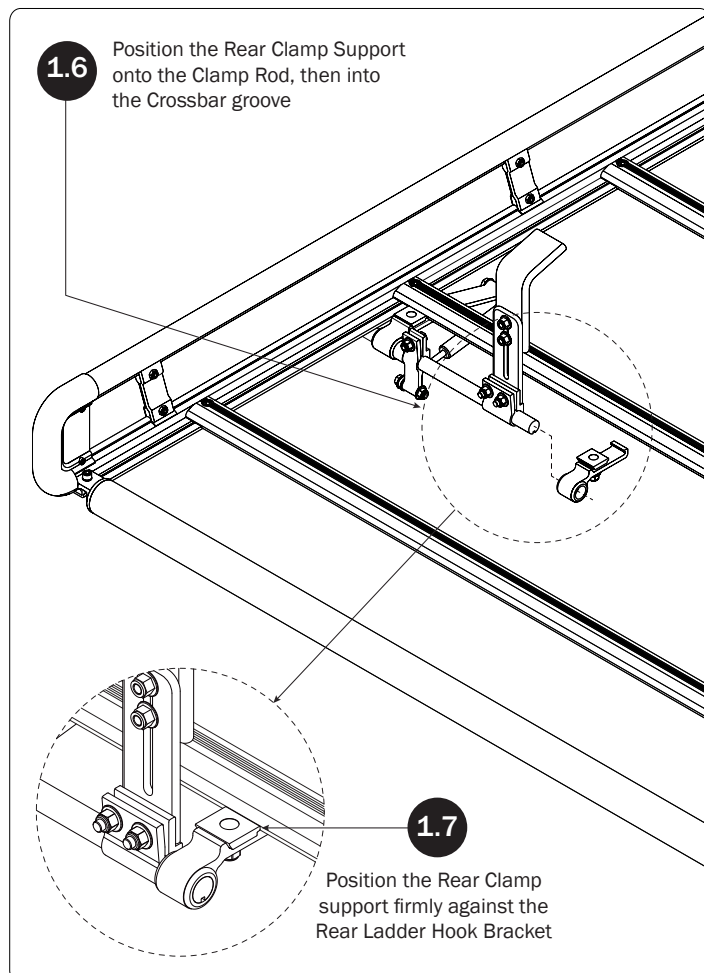
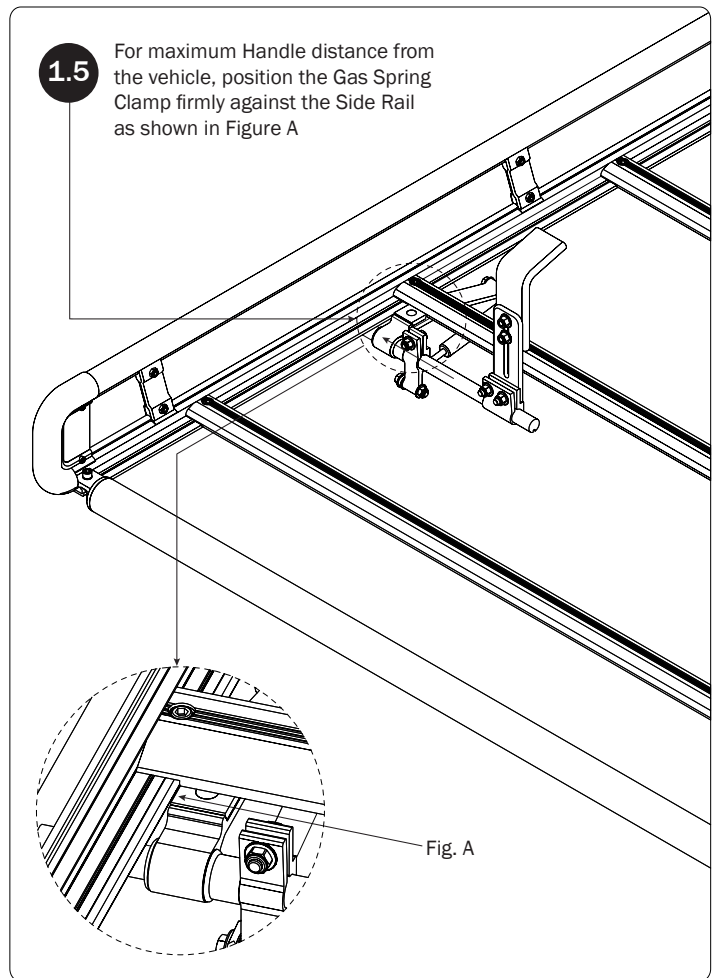
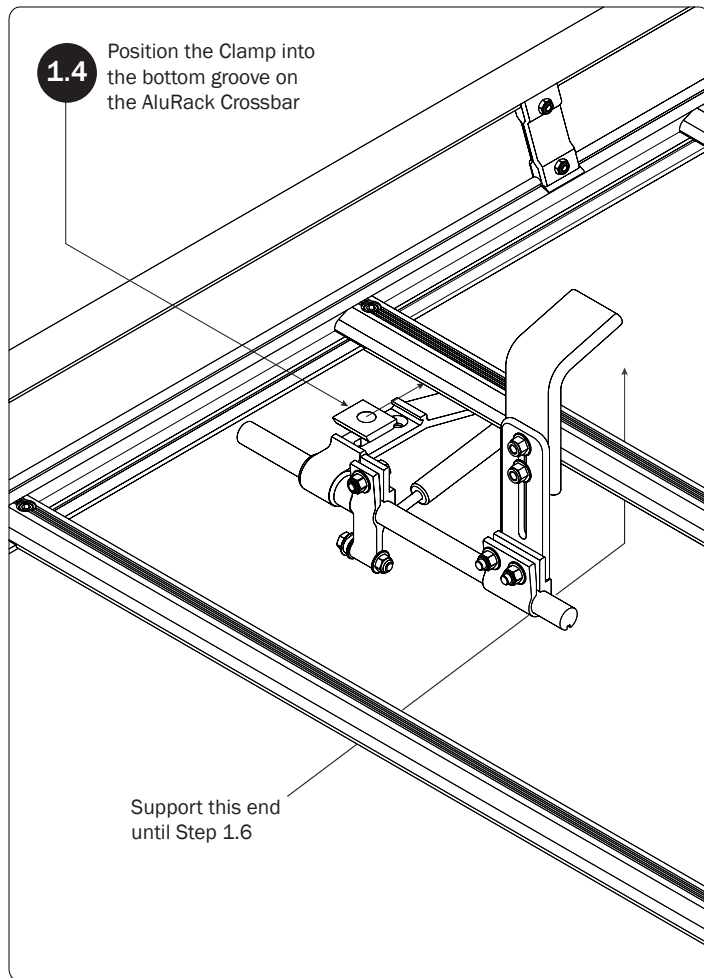

ALTERNATIVE POSITIONING FOR FORD TRANSIT CONNECT RACK MODELS

Position the Clamp into the bottom groove on the AluRack Crossbar

1.9

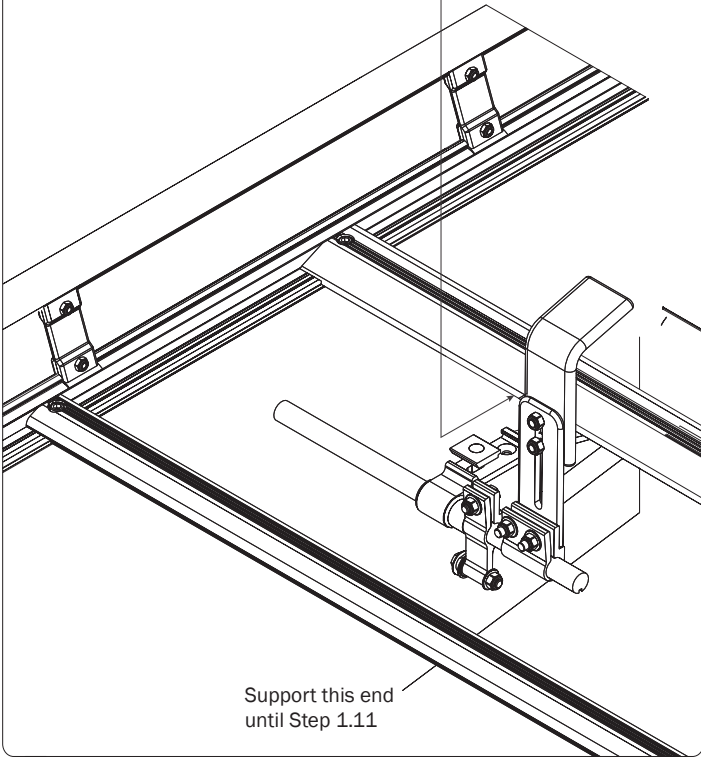

For maximum Handle distance from the vehicle, position the Gas Spring Clamp firmly against the Channel Mount as shown in Figure B

1.10

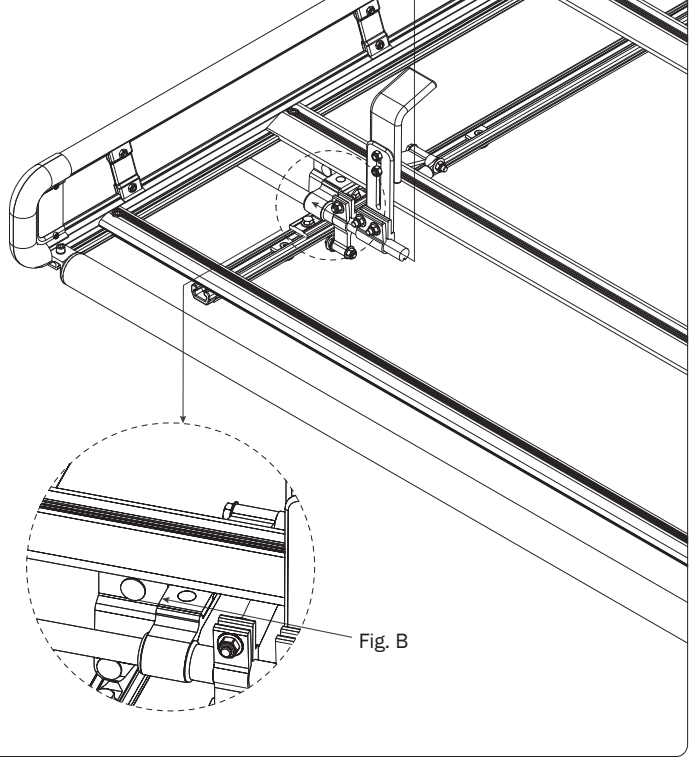

Position the Rear Clamp Support onto the Clamp Rod, then into the Crossbar groove

1.11

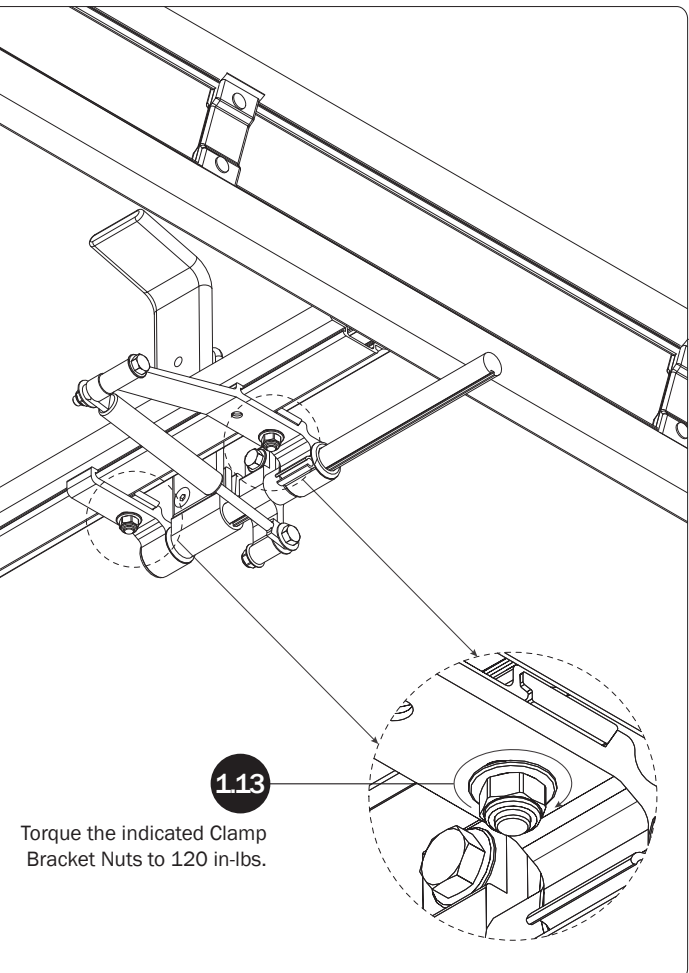
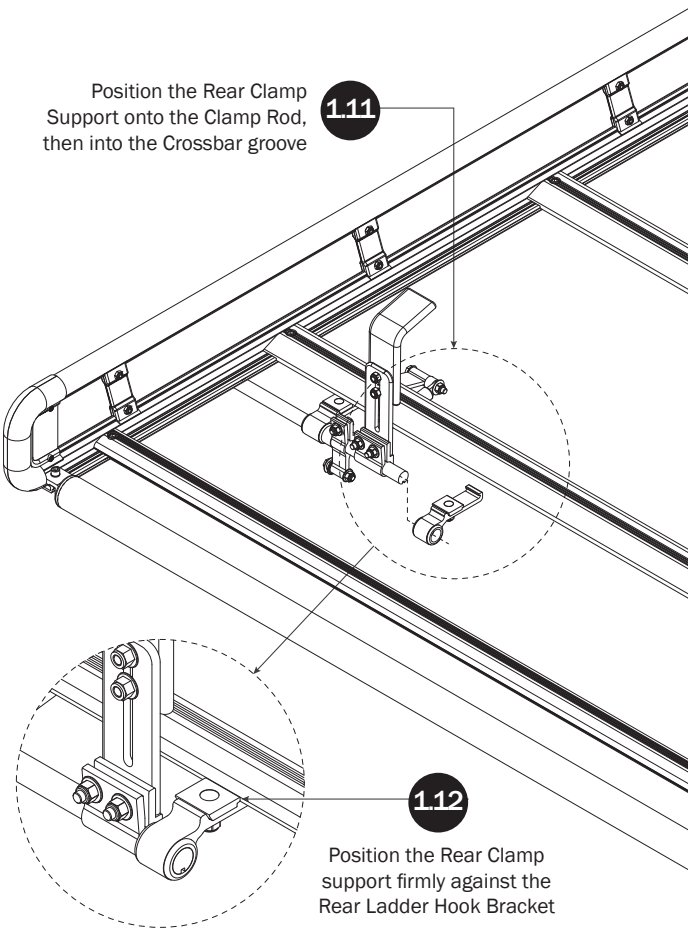

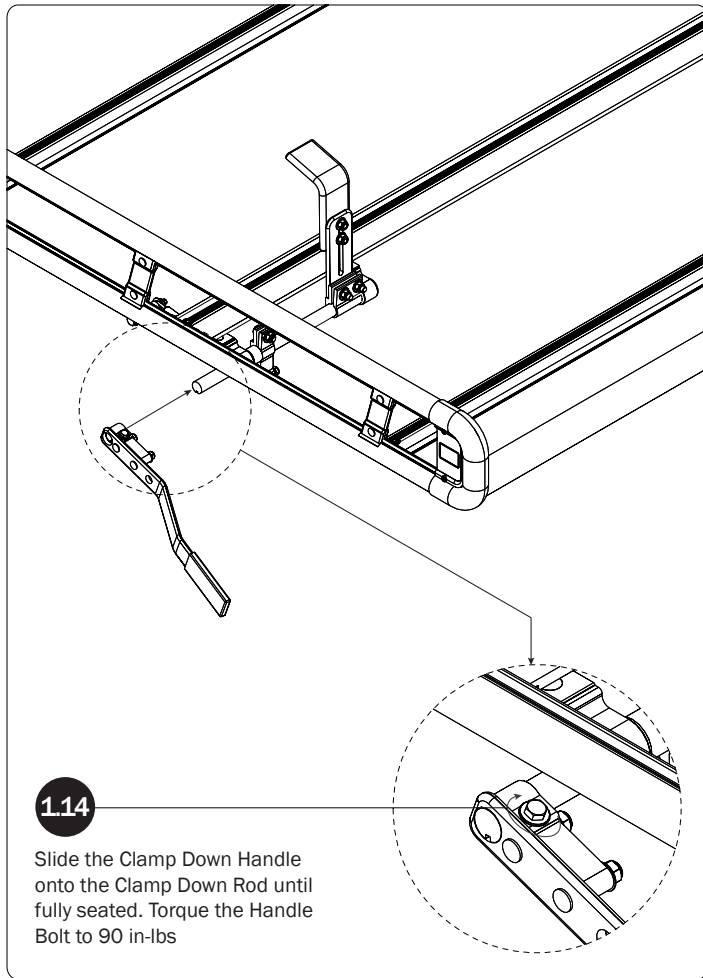

1.14

Slide the Clamp Down Handle onto the Clamp Down Rod until fully seated. Torque the Handle Bolt to 90 in-lbs

CLAMP DOWN LOCK BRACKET
SEE QUICK START GUIDE FOR ADJUSTMENTS

2.1 Remove the Lock Bracket hardware and retain for Step 2.4

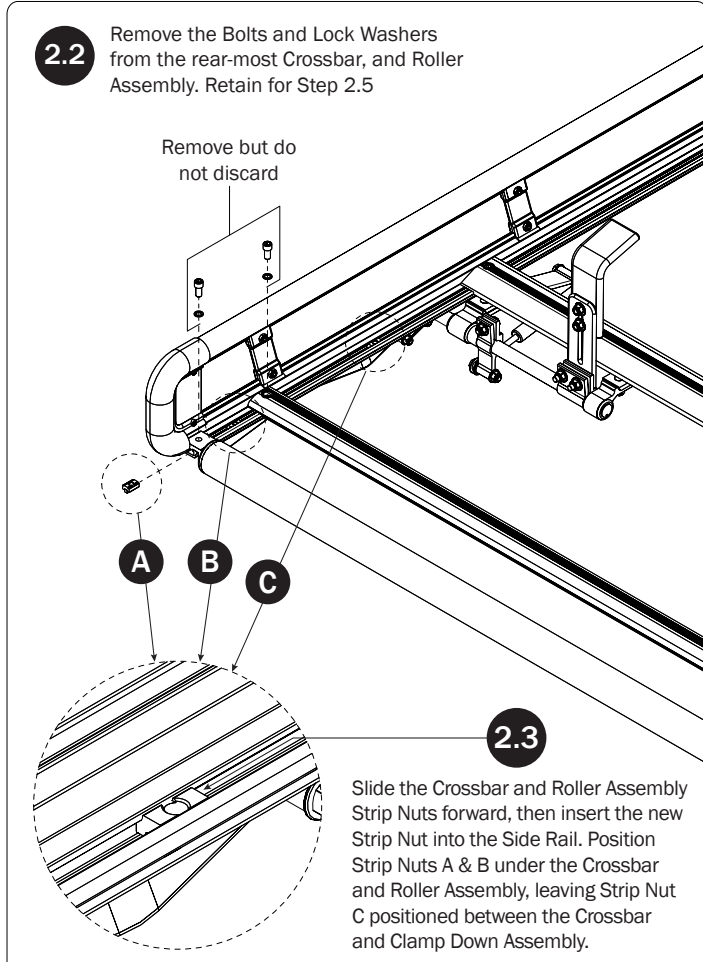
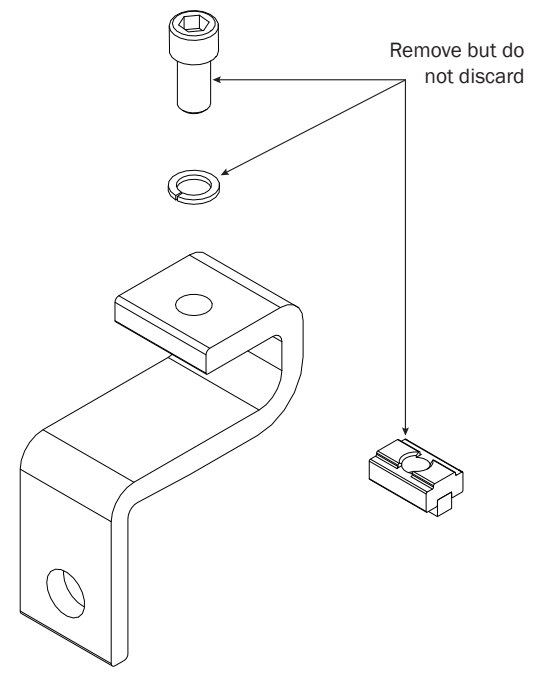

2.2

Remove the Bolts and Lock Washers from the rear-most Crossbar, and Roller Assembly. Retain for Step 2.5

Remove but do not discard

A B C

2.3

Slide the Crossbar and Roller Assembly Strip Nuts forward, then insert the new Strip Nut into the Side Rail. Position Strip Nuts A & B under the Crossbar and Roller Assembly, leaving Strip Nut C positioned between the Crossbar and Clamp Down Assembly.

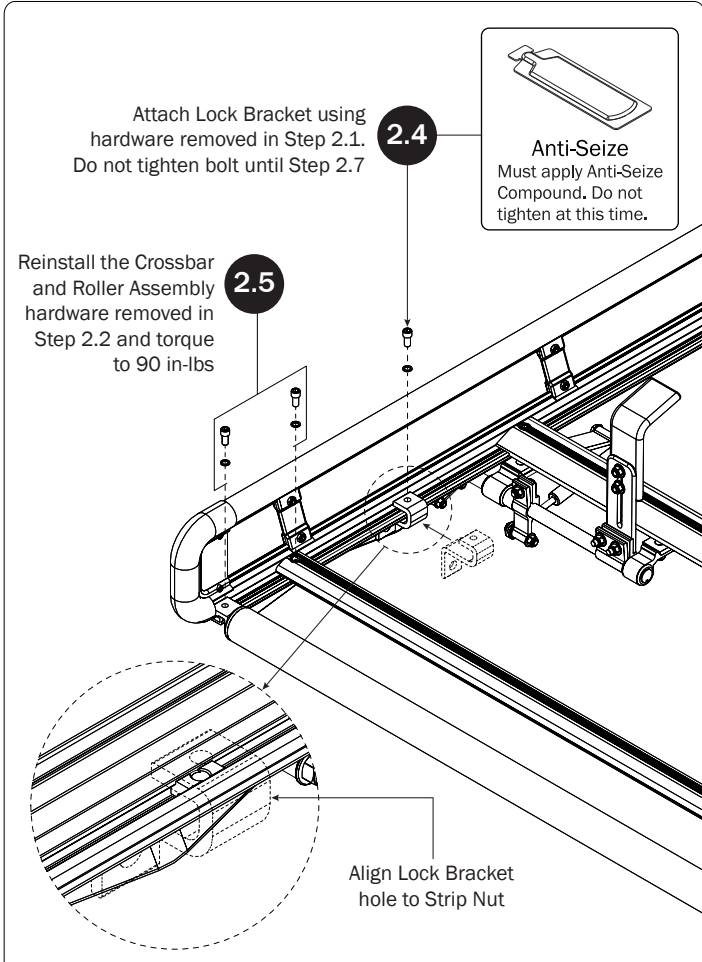

2.4

Attach Lock Bracket using hardware removed in Step 2.1. Do not tighten bolt until Step 2.7

Anti-Seize
Must apply Anti-Seize Compound. Do not tighten at this time.

2.5

Reinstall the Crossbar and Roller Assembly hardware removed in Step 2.2 and torque to 90 in-lbs

Align Lock Bracket hole to Strip Nut

2.6

Align the hole on the Lock Bracket to the lock hole on the Handle as shown below

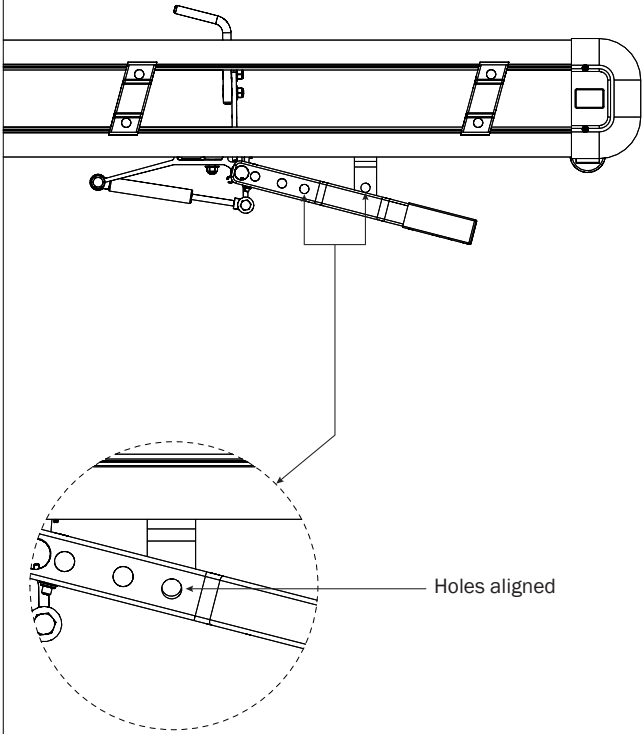

Holes aligned

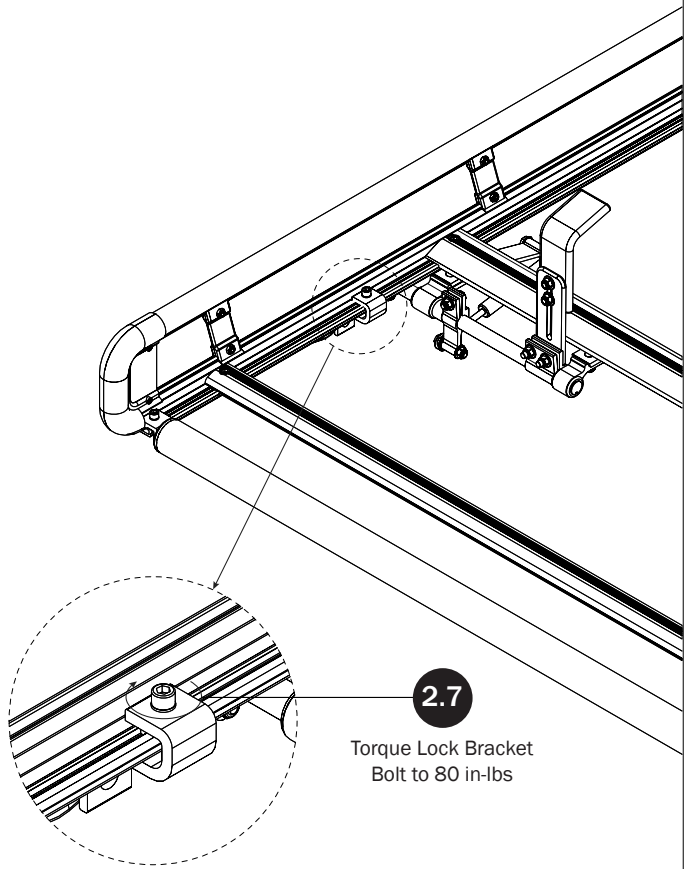

2.7

Torque Lock Bracket Bolt to 80 in-lbs

FRONT HOOK ASSEMBLY
SEE QUICK START GUIDE FOR ADJUSTMENTS

3.1

Loosen, but do not remove, the indicated bolts on the Front Ladder Assembly

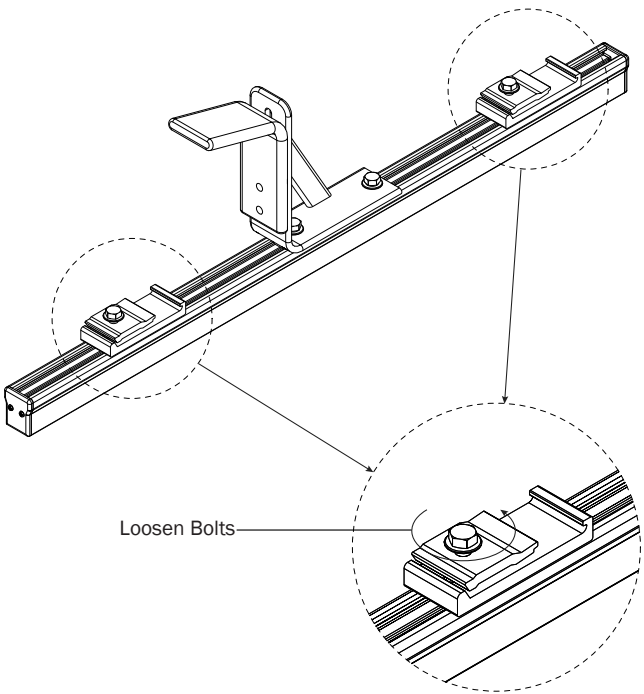

Loosen Bolts

3.2

After determining Front to Rear Ladder Hook spacing based upon ladder size, slide the Front Hook Assembly under the Crossbars to that determined distance.

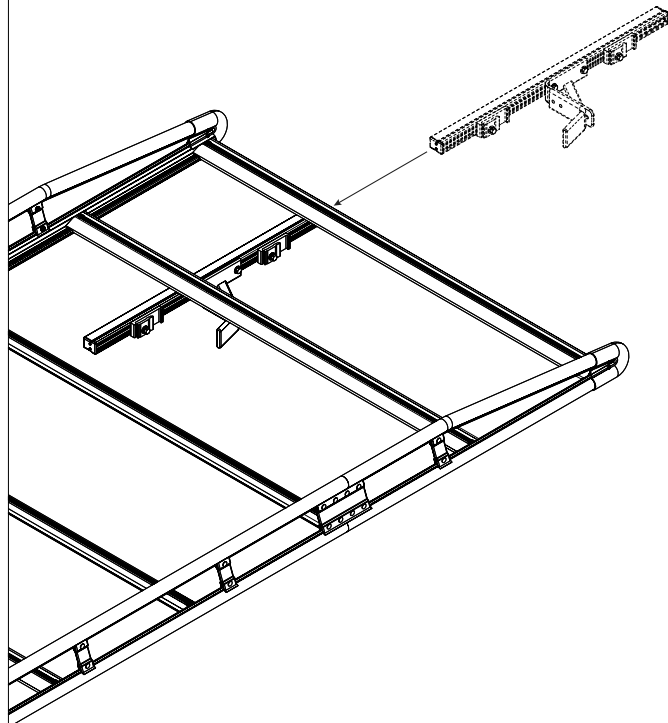

3.3 Attach the Front Hook Assembly onto your designated Crossbars. The Channel Connectors must seat into the bottom groove of the Crossbar as shown below. Do not tighten until Step 3.7

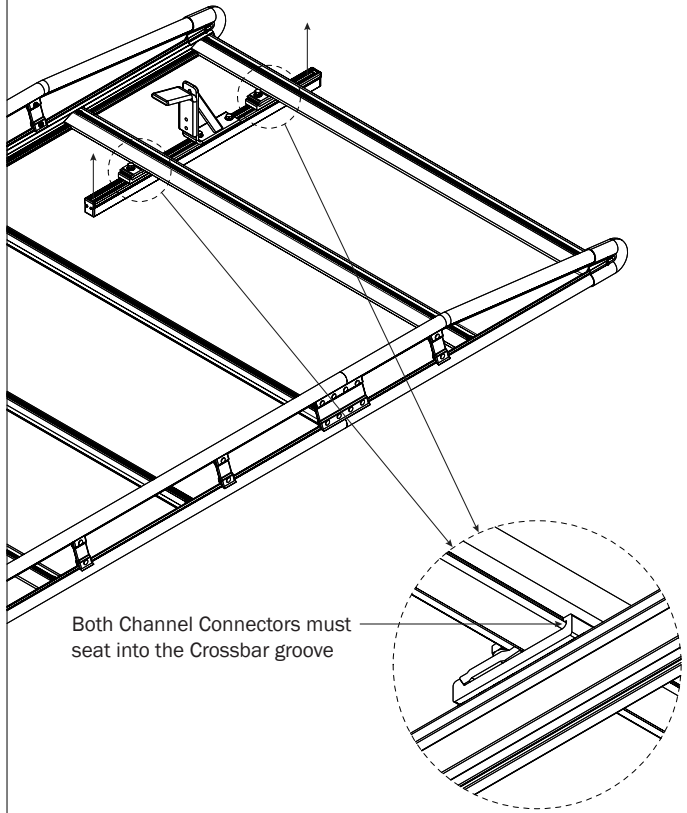

3.5 Position the Front Hook Assembly until it centers with the Rear Clamp Down Hook.

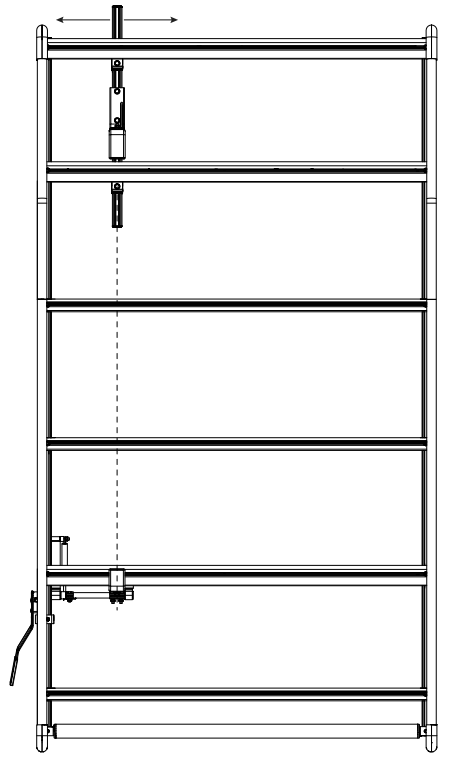

3.6 Position the Front Hook Assembly until the front of the Hook Channel is even to, or less than, the end of the Side Rails as shown in Figure C

