

PRIME DESIGN™

A Safe Fleet Brand

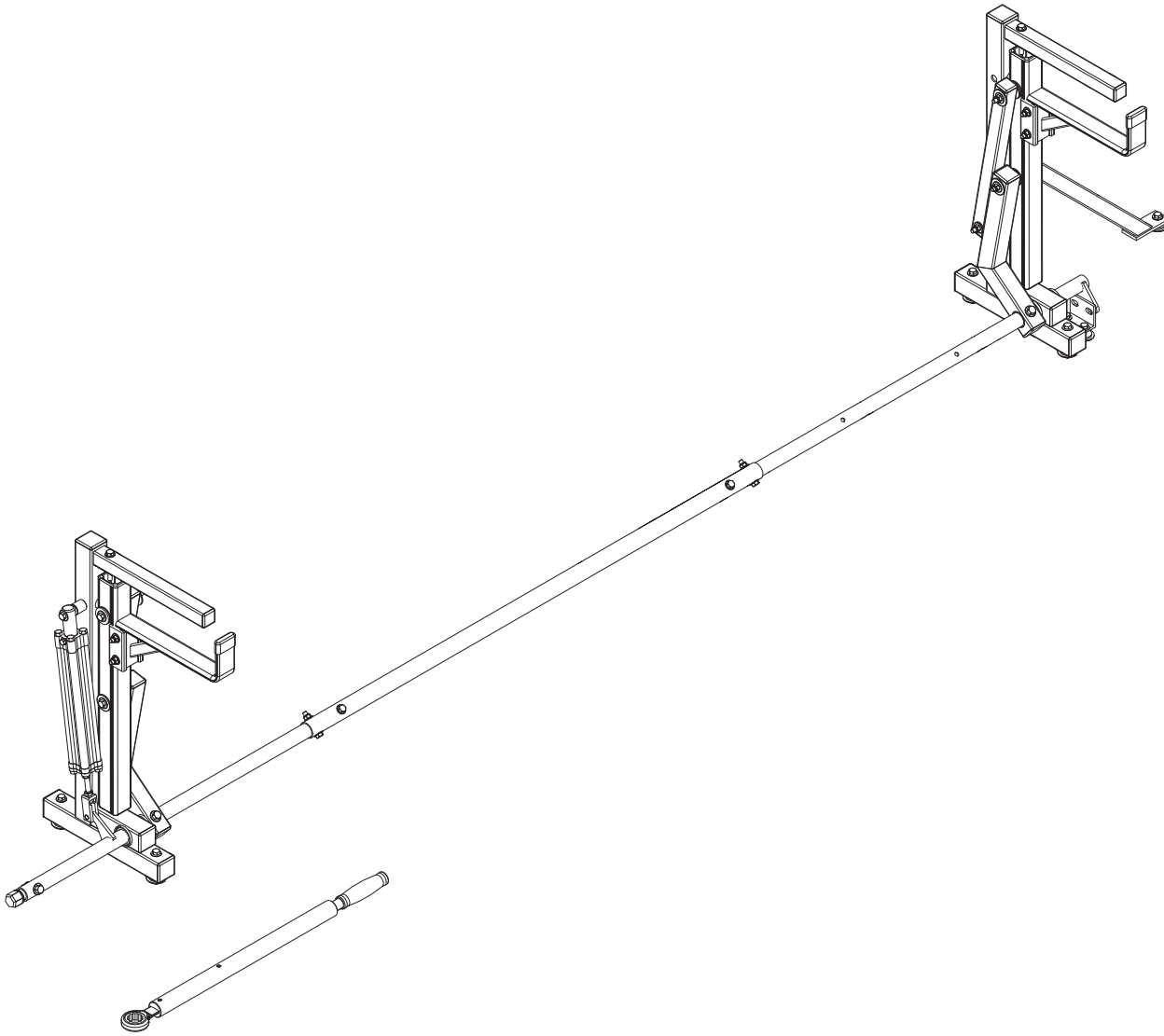

PRIME DESIGN, A SAFE FLEET BRAND

Address: 580 Opperman Drive, Eagan, MN 55123 • Toll Free: 1.8.PRIME.RACK
Fax: 651-552-1799 • Email: info@primedesign.net • Website: www.primedesign.net

CONTENTS OVERVIEW

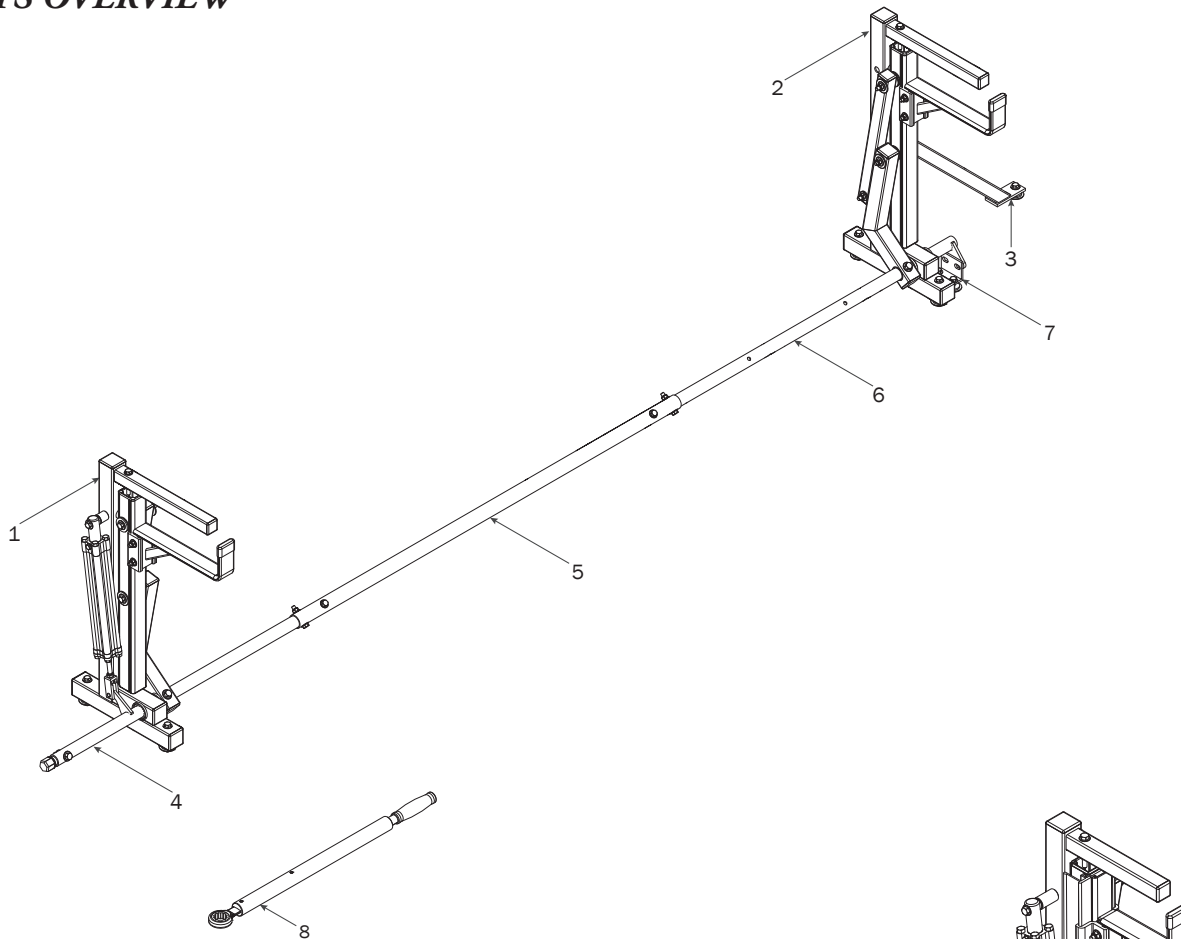

1—Rear Rotation Assembly..... (Qty 1)

2—Front Rotation Assembly..... (Qty 1)

3—Mount Brace..... (Qty 1)
20.00"

4—Rear Drive Shaft..... (Qty 1)
Hex Head, Right Hand, 34.00"

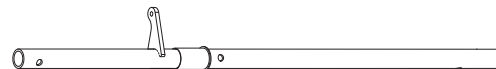
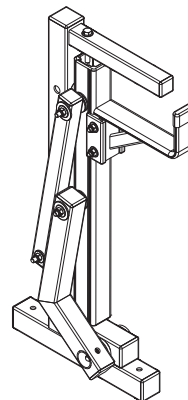
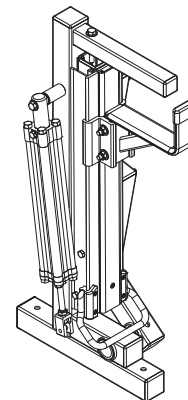

5—Connecting Bar..... (Qty 1)
48.00"

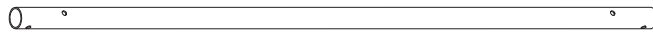

6—Front Drive Shaft..... (Qty 1)
B Version, with Locking Tab

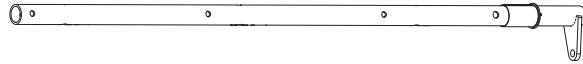

7—Drive Shaft Lock Bracket..... (Qty 1)



HKT-8163-Rotation Hardware Kit

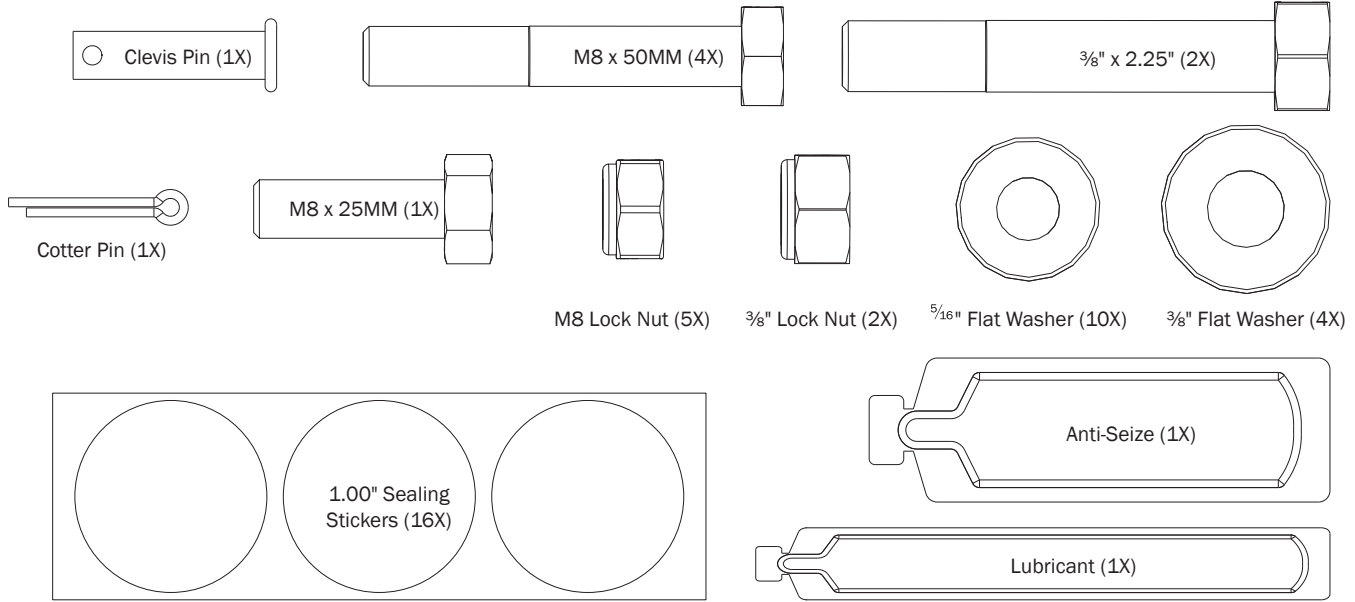

HKT-0255-Hardware Kit

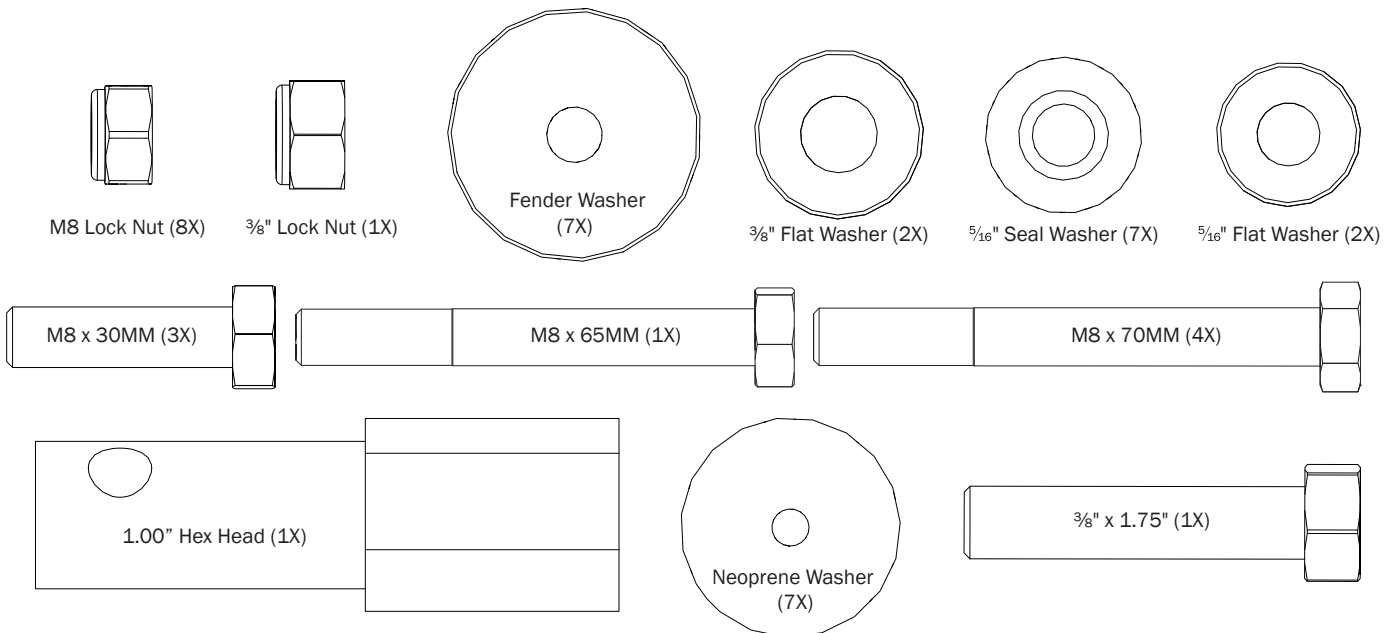

MOUNTING DIMENSIONS



Mounting to Service Body: dimensions are dependent upon Crossbar distances of 6'-8' plus allowance for Drive Shaft Support and Offset (Rear), and Mount Brace (Front)—the rear drive shaft must not extend past the vehicle bumper (see dimensions below).

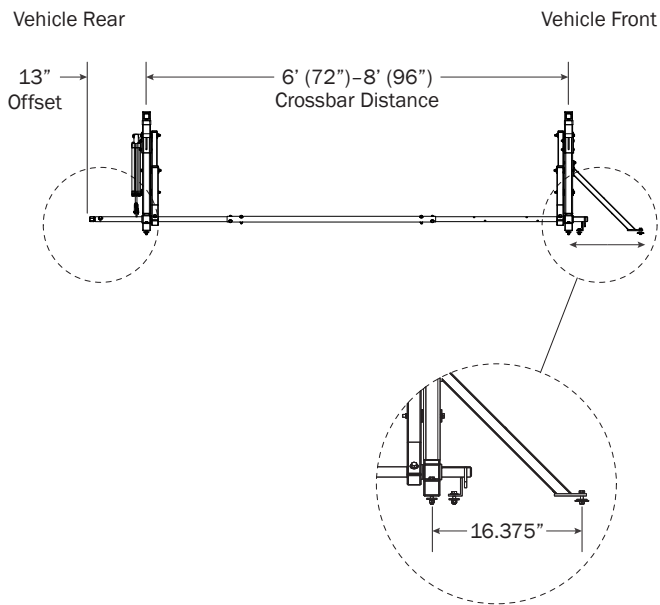

0.1 6.00 Ft: Drill holes into the Service Body mounting location according to dimensions shown.

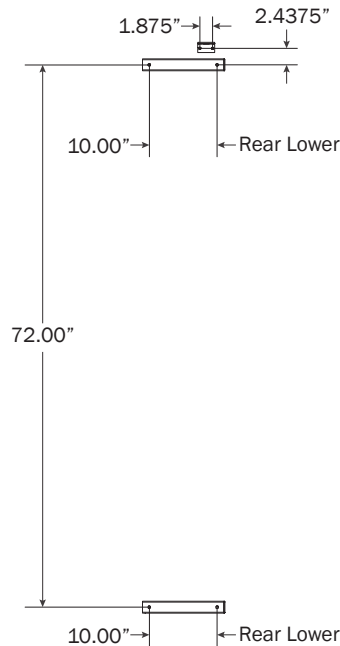

0.2 7.00 Ft: Drill holes into the Service Body mounting location according to dimensions shown.

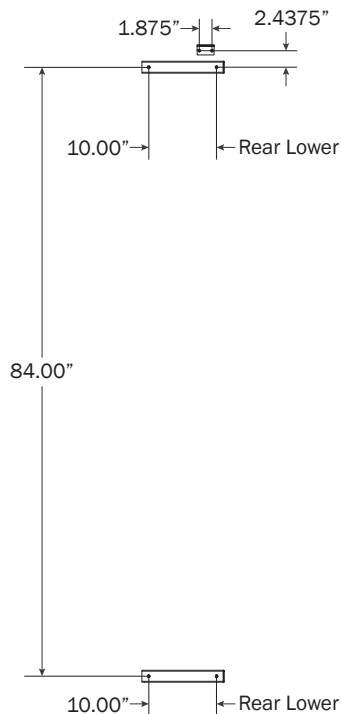

0.3 8.00 Ft: Drill holes into the Service Body mounting location according to dimensions shown.

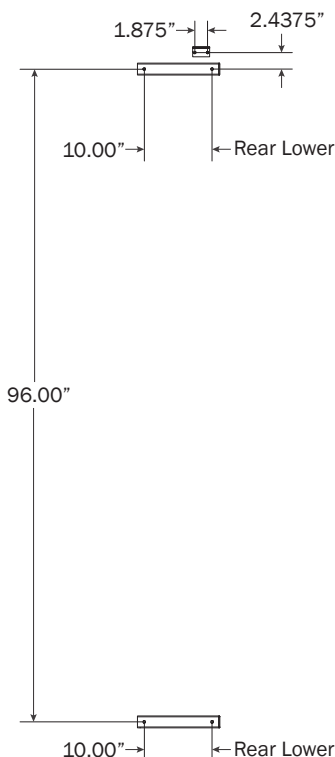

RIGHT ROTATION ASSEMBLY SEQUENCE

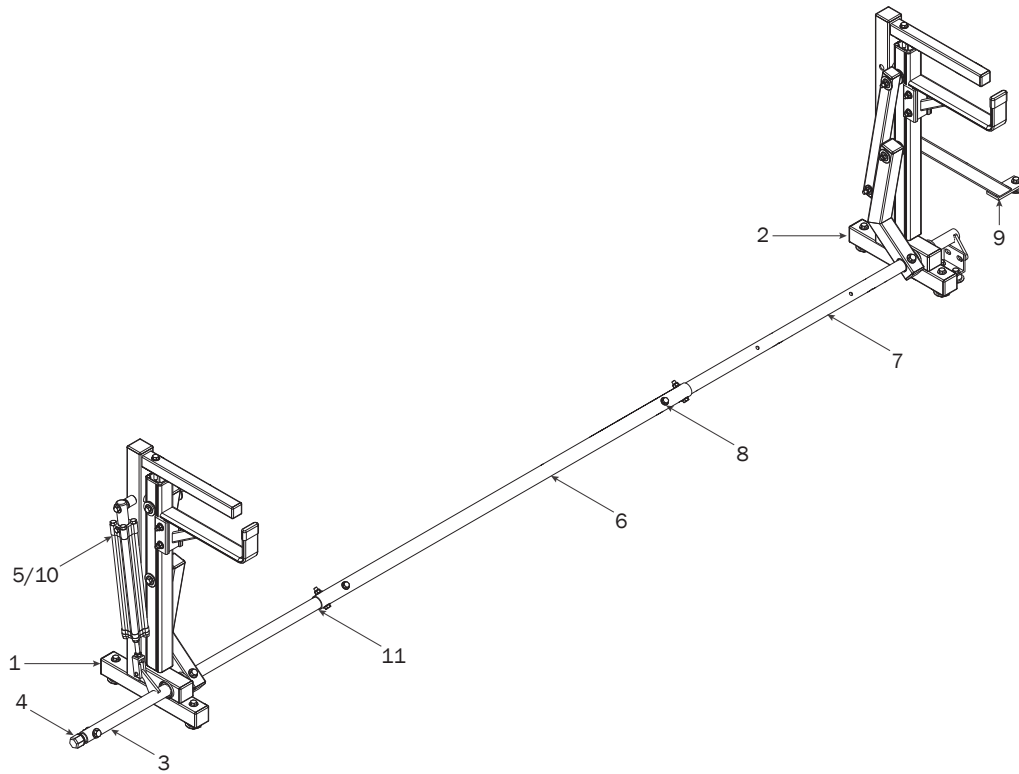

REAR ROTATION ASSEMBLY

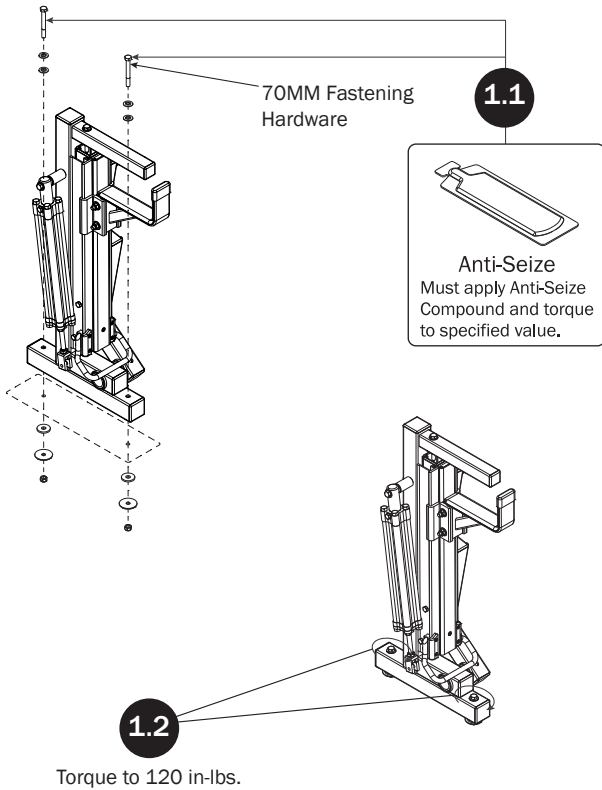

FRONT ROTATION ASSEMBLY AND DRIVE SHAFT LOCK BRACKET

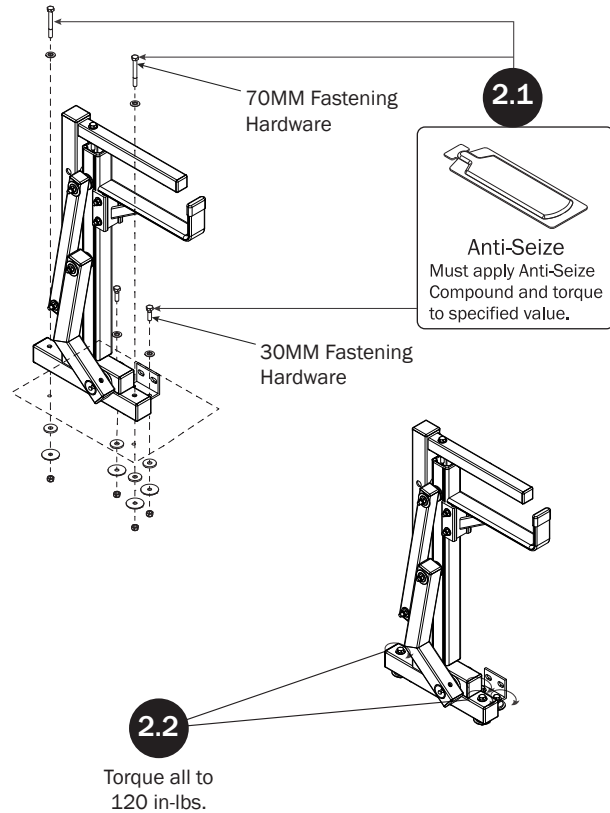

REAR DRIVE SHAFT

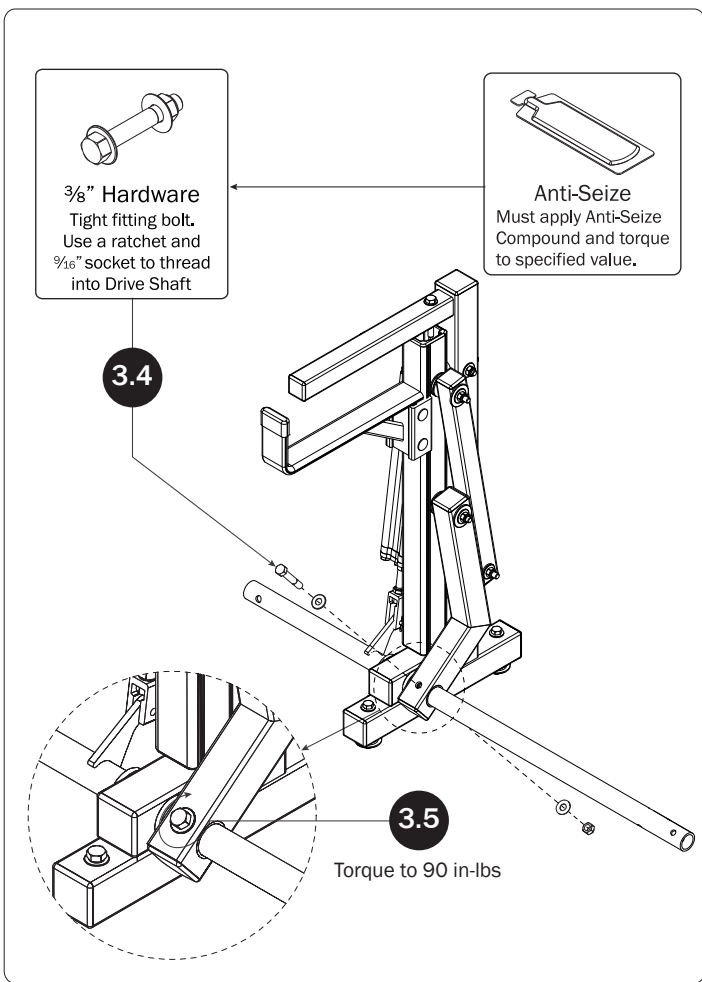
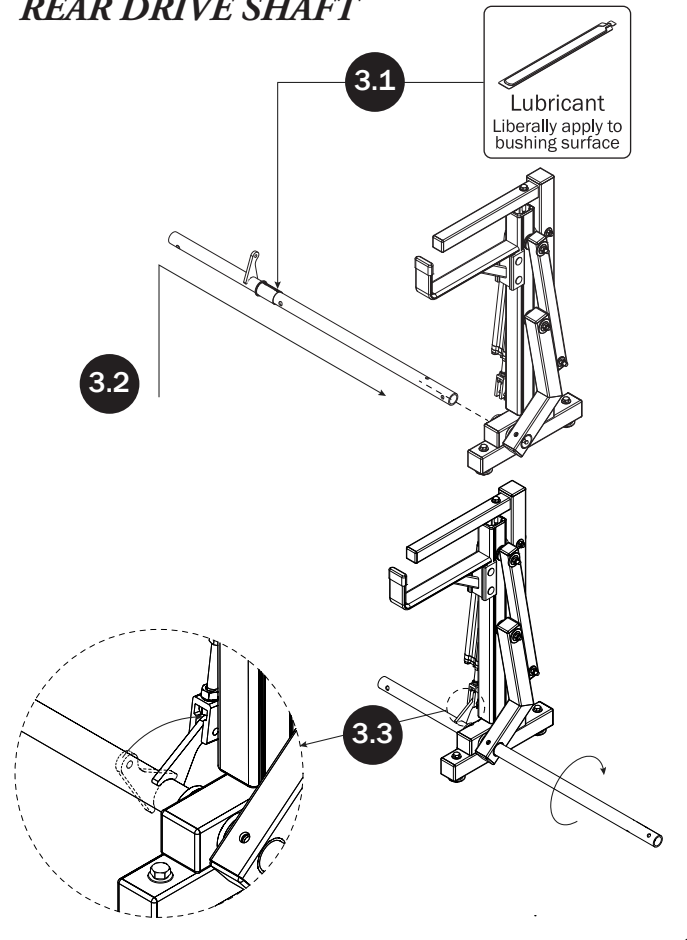

HEX STUD

4.1 Insert the Drive Shaft Hex Stud into the open end of the Drive Shaft Extension. Align the bolt holes, then install the 3/8" x 1.75" Hex Stud Bolt (1X), 3/8" Washer (2X), and 3/8" Lock Nut (1X) in the order shown.

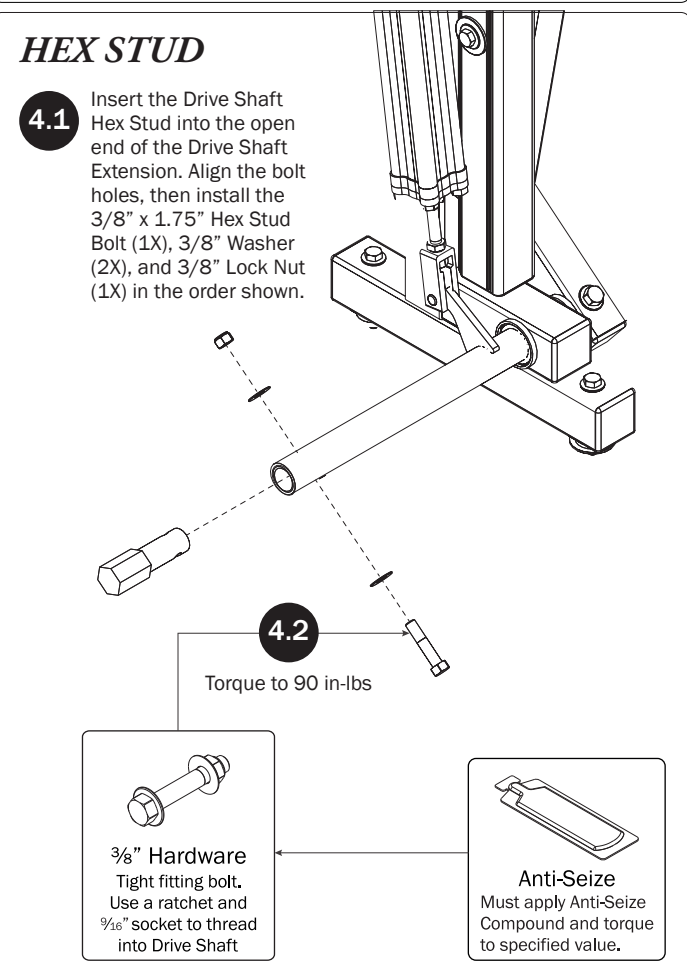

CYLINDER HARDWARE

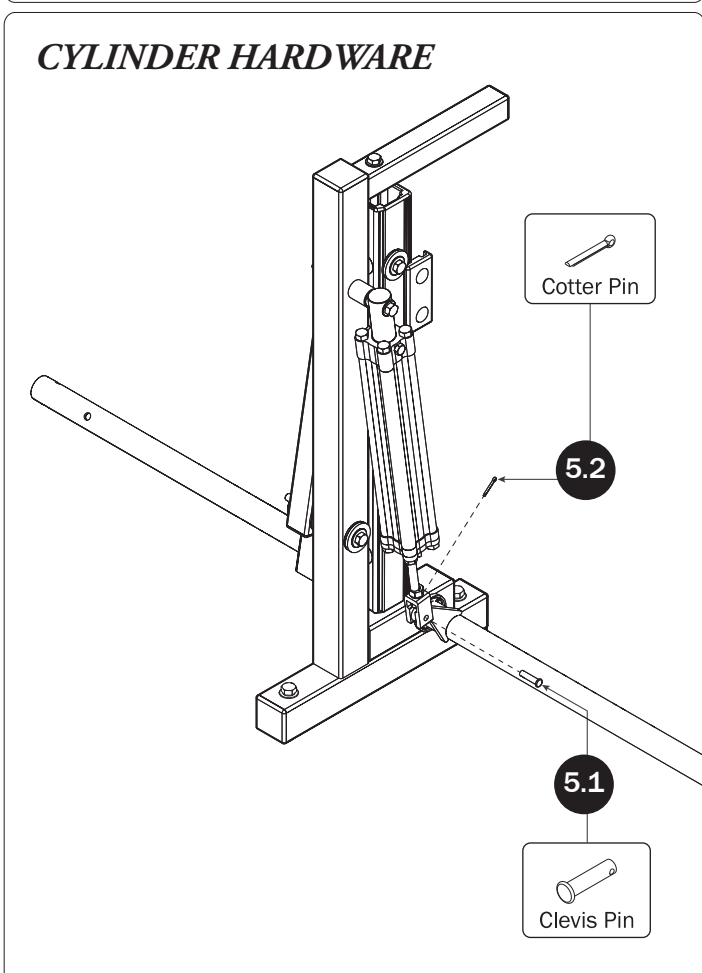

FRONT DRIVE SHAFT

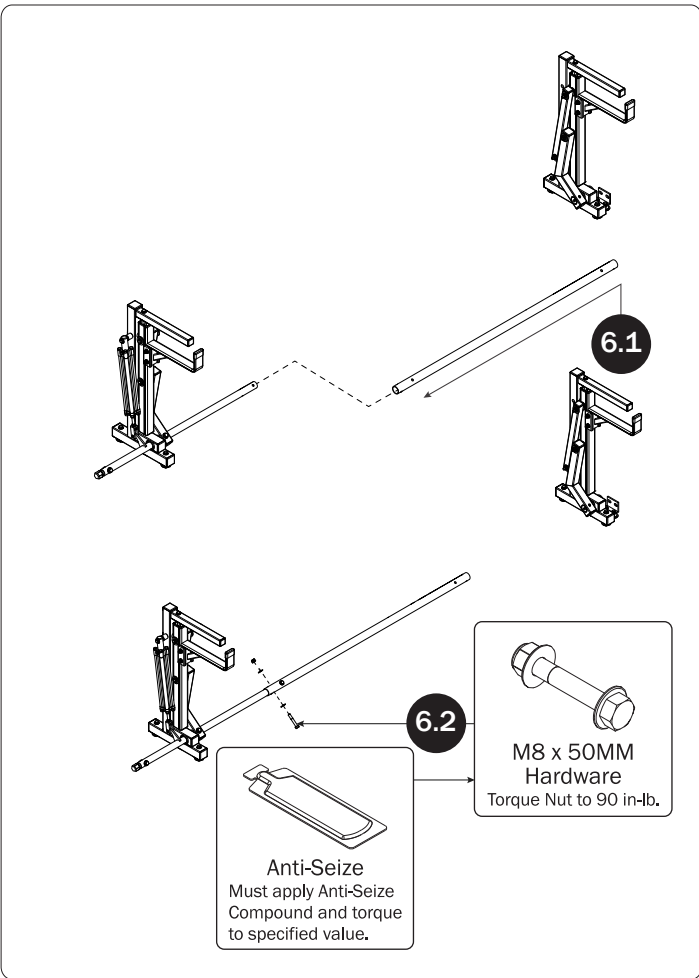
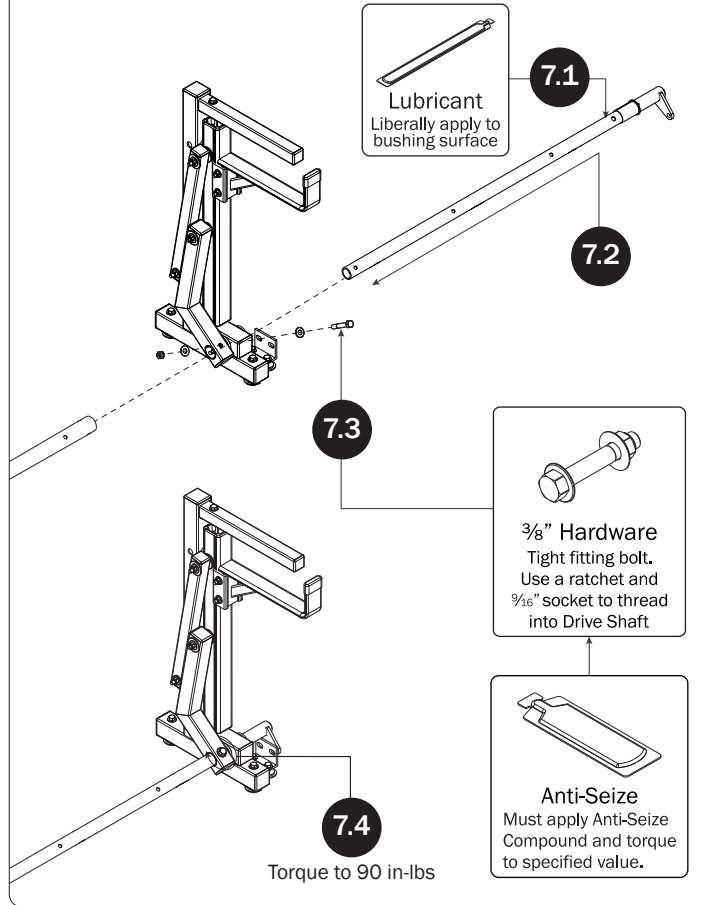

MOUNT BRACE INSTALLATION

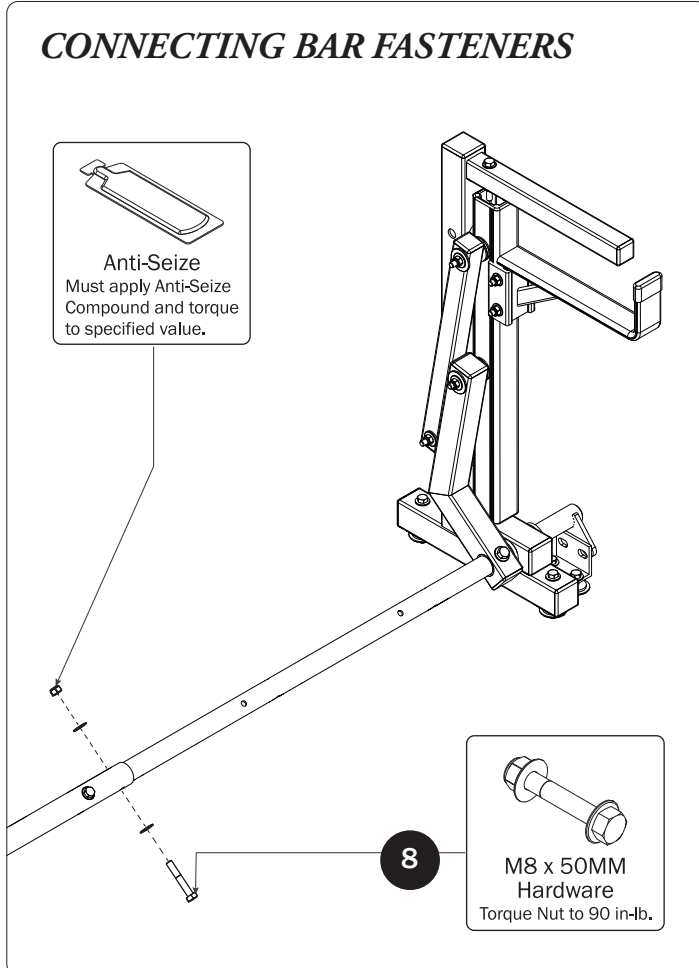
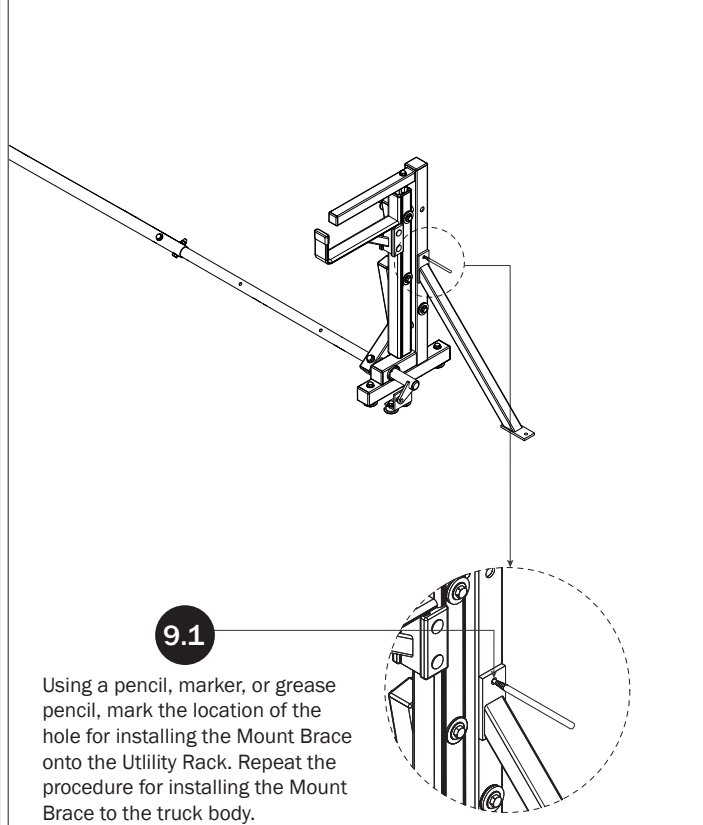

9.2 Remove the Mount Brace to expose the bolt hole markings. Using a 9MM, 23/64", or T size bit, drill a hole into the Utility Rack at the marked bolt hole location created during Step 10.1.

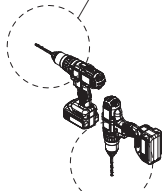
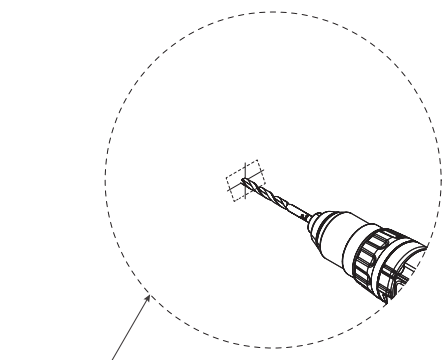

9.3

Repeat Step 10.2 procedure using the indicated bit to drill a hole into the truck body.

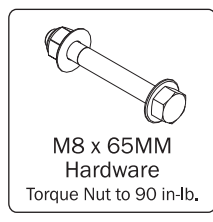
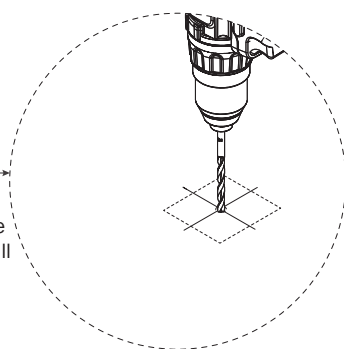

M8 x 65MM Hardware
Torque Nut to 90 in-lb.

9.4



Anti-Seize
Must apply Anti-Seize Compound and torque to specified value.

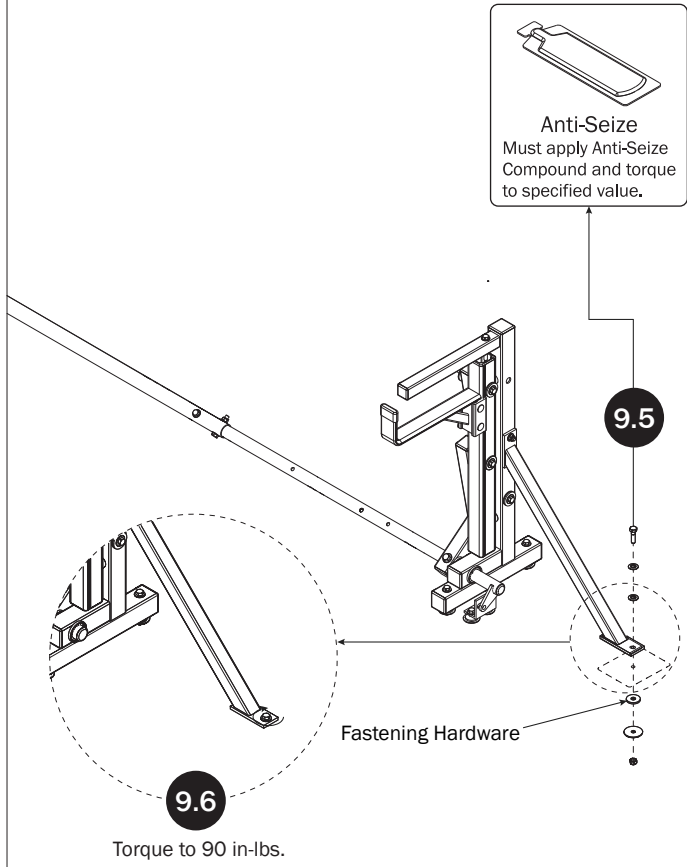
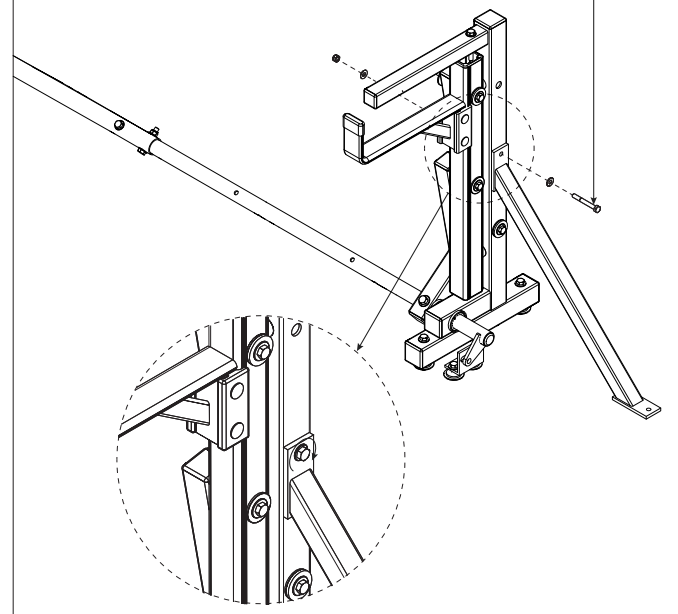

Anti-Seize
Must apply Anti-Seize Compound and torque to specified value.

9.5

9.6

Torque to 90 in-lbs.

CYLINDER ADJUSTMENT

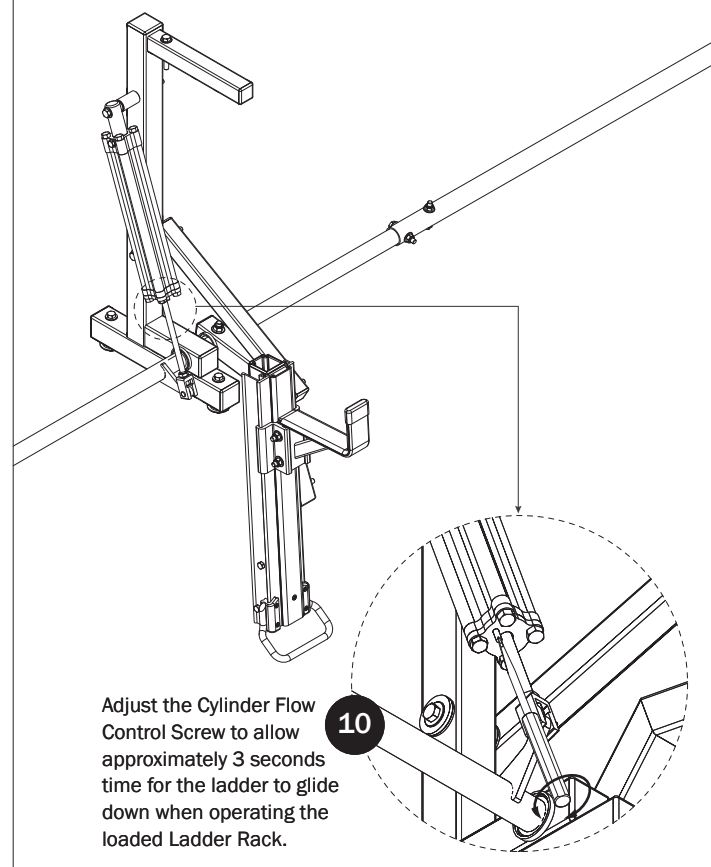

Adjust the Cylinder Flow Control Screw to allow approximately 3 seconds time for the ladder to glide down when operating the loaded Ladder Rack.

10

DRIVE SHAFT SEALING

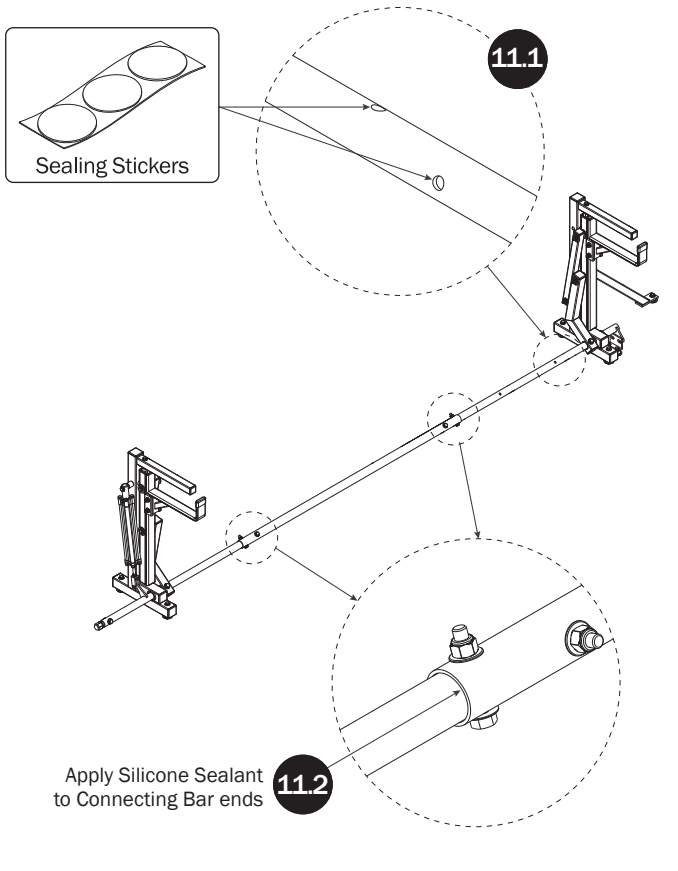

Page Intentionally Left Blank

Page Intentionally Left Blank

