

PRIME DESIGN™

A Safe Fleet Brand

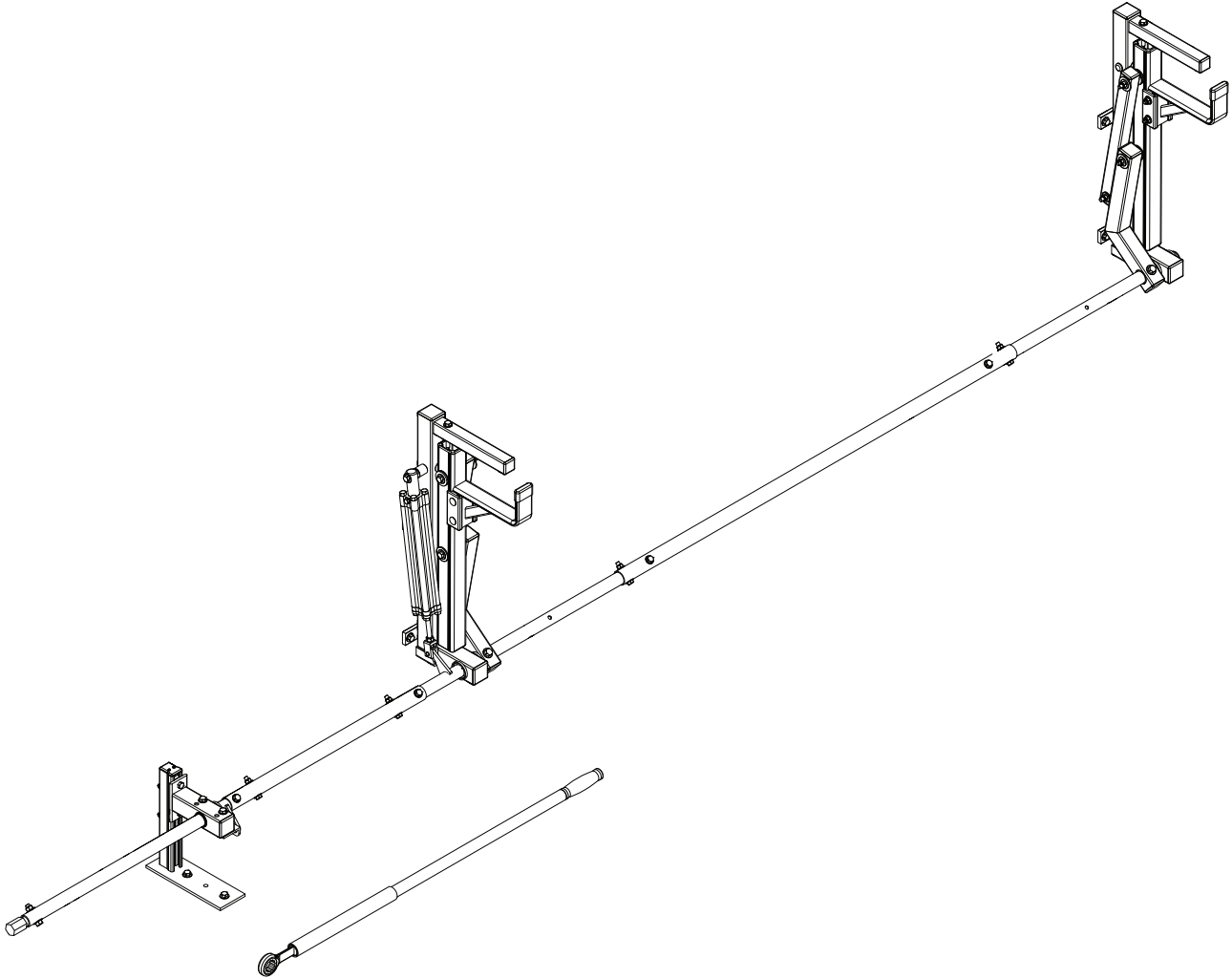

CONTENTS OVERVIEW

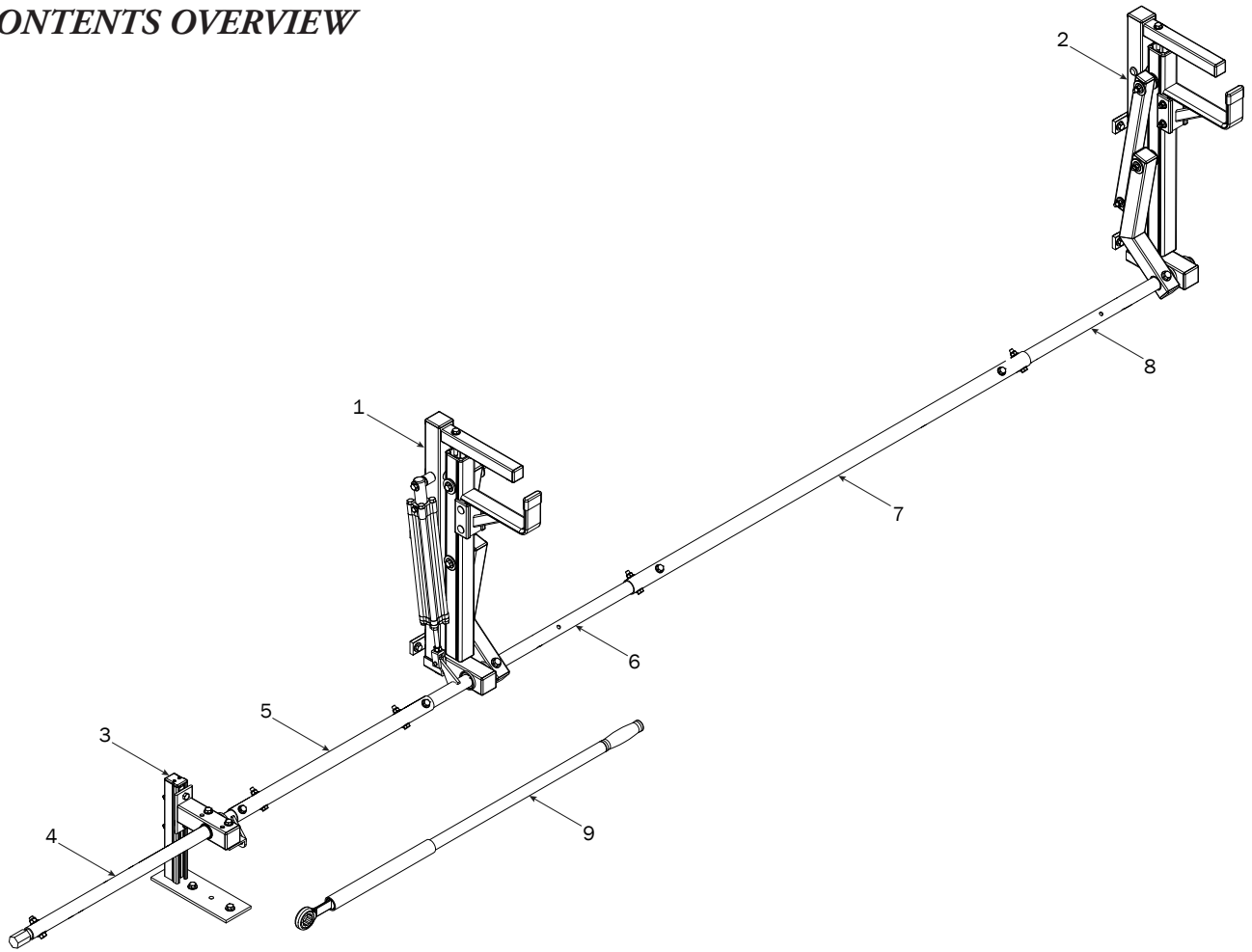

1—Rear Rotation Assembly..... (Qty 1)

2—Front Rotation Assembly..... (Qty 1)

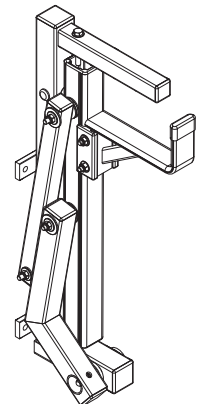
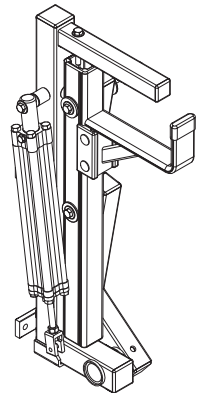

3—Vertical Drive Shaft Support..... (Qty 1)
Utility, Right Hand, Reversible

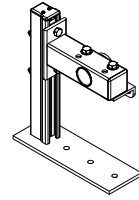

4—Drive Shaft Rear Extension..... (Qty 1)
Hex Drive, 28.50"

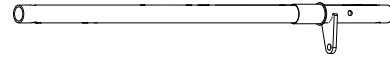

5—Connecting Bar..... (Qty 1)
24.00"

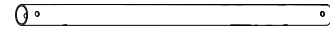

6—Drive Shaft..... (Qty 1)
Extended Rear, UV, Right Hand, 32.00"

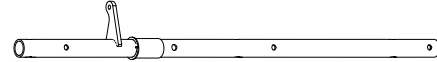

7—Connecting Bar..... (Qty 1)
48.00"

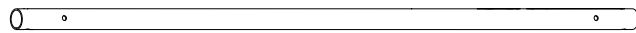

8—Front Drive Shaft..... (Qty 1)
B Version, 35.75"

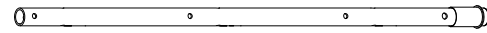

9—Ratcheting Handle Assembly..... (Qty 1)
41.00"L

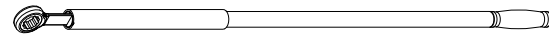

HKT-8119-Hardware Kit

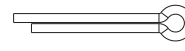

Cotter Pin (1X)



Clevis Pin (1X)

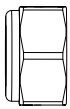

M8 Lock Nut (18X)

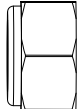

3/8" Lock Nut (3X)

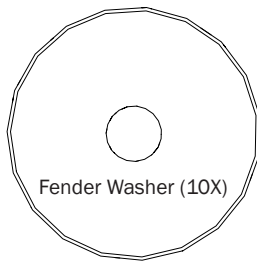

Fender Washer (10X)

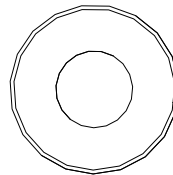

3/8" Flat Washer (6X)

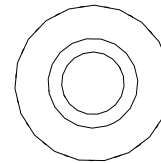

5/16" Seal Washer (10X)

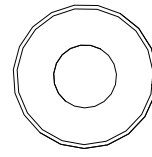

5/16" Flat Washer (16X)



M8 x 30MM (10X)

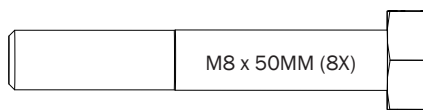

M8 x 50MM (8X)

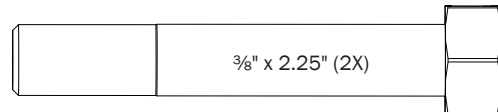

3/8" x 2.25" (2X)

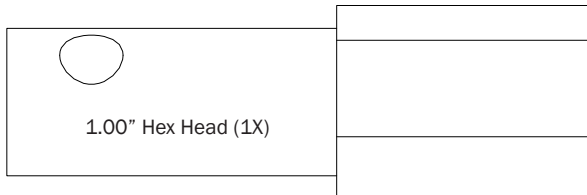

1.00" Hex Head (1X)

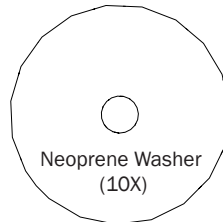

Neoprene Washer (10X)

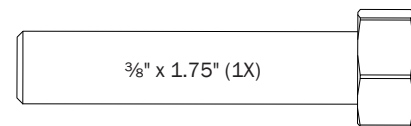

3/8" x 1.75" (1X)

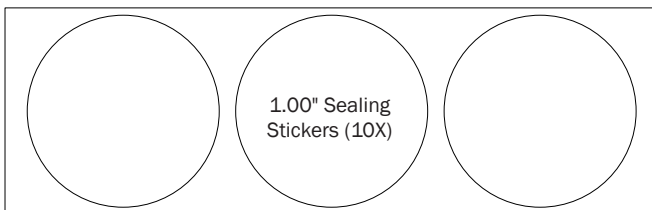

1.00" Sealing Stickers (10X)



Anti-Seize (1X)

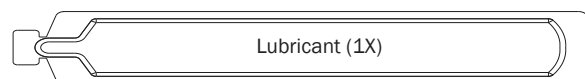

Lubricant (1X)

RIGHT ROTATION ASSEMBLY SEQUENCE



This vertical Utility Body ladder rack has been engineered to accommodate a variety of ladder lengths.

To configure this rack according to your carried ladder length, refer to the chart shown below for Steps 2 and 3.

Distance	Connect A to:	Connect C to:	Ladder Length:
1.52m (60")	B2	D1	20 Ft
1.83m (72")	B2	D2	24 Ft
2.13m (84")	B1	D2	28 Ft
2.43m (96")	B1	D3	32 Ft

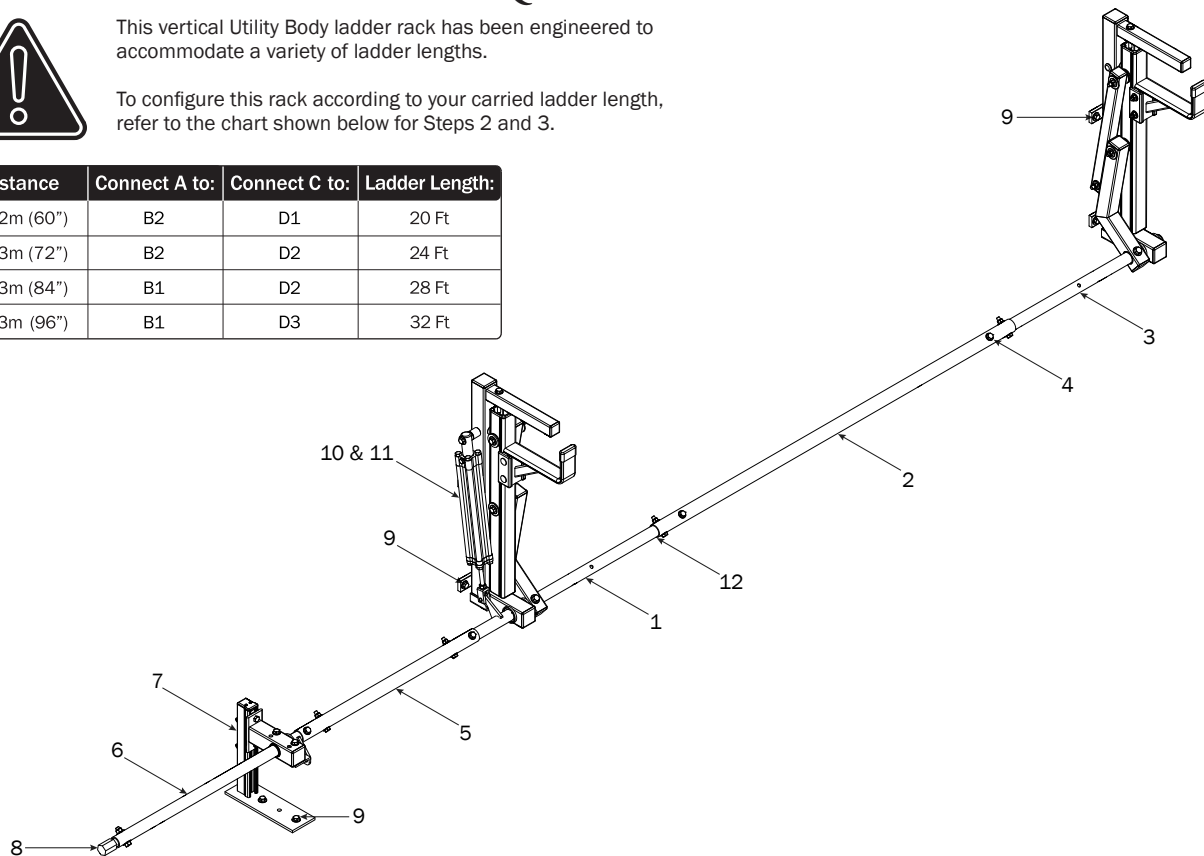

REAR DRIVE SHAFT

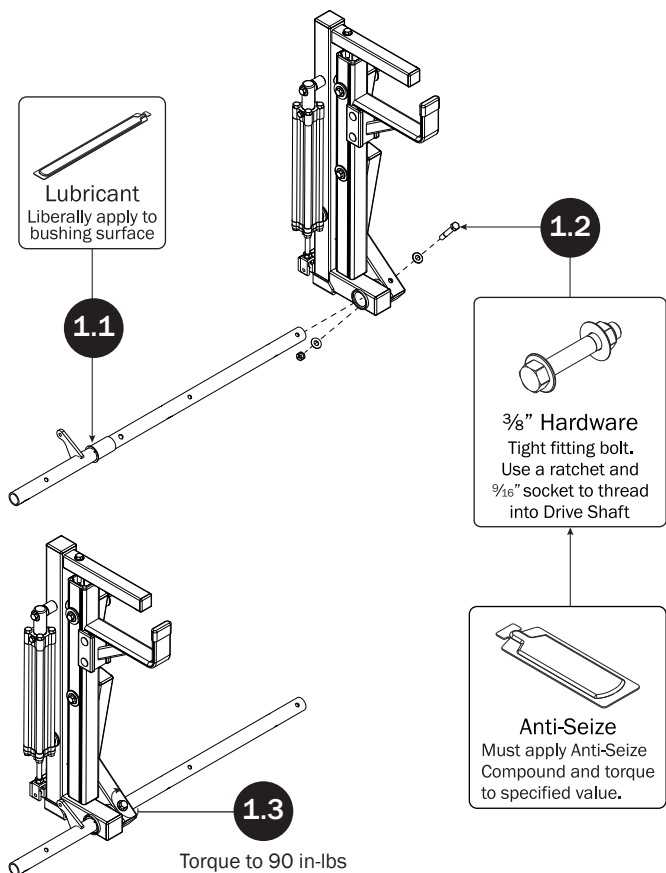

CONNECTING BAR—48"

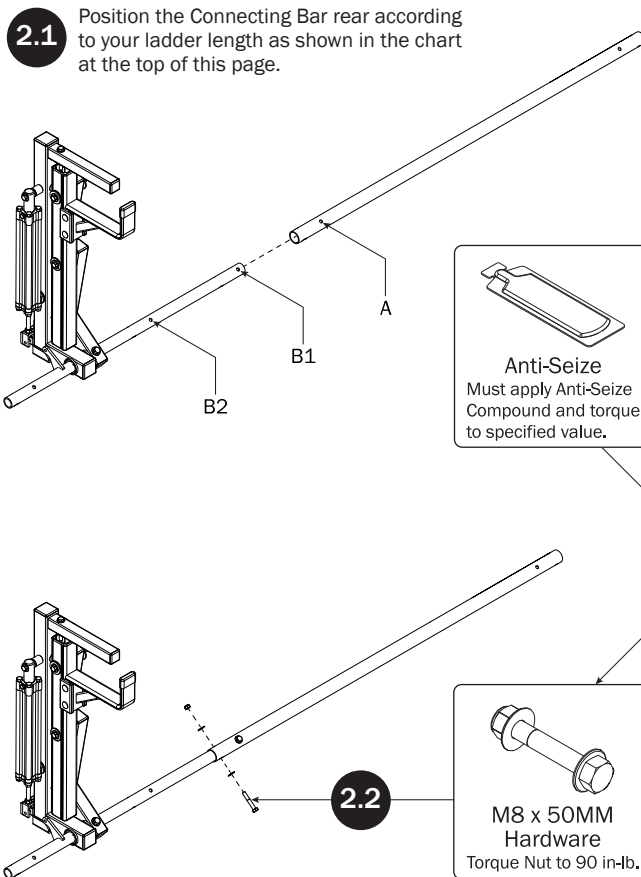

FRONT DRIVE SHAFT

3.1 Position the Connecting Bar front according to your ladder length as shown in the chart at the top of page 4.

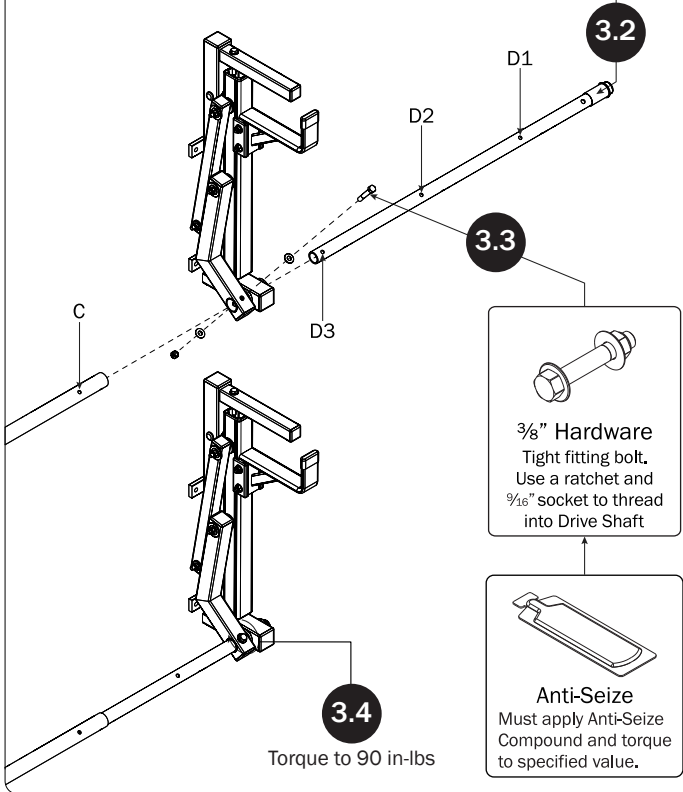

Lubricant
Liberal apply to bushing surface

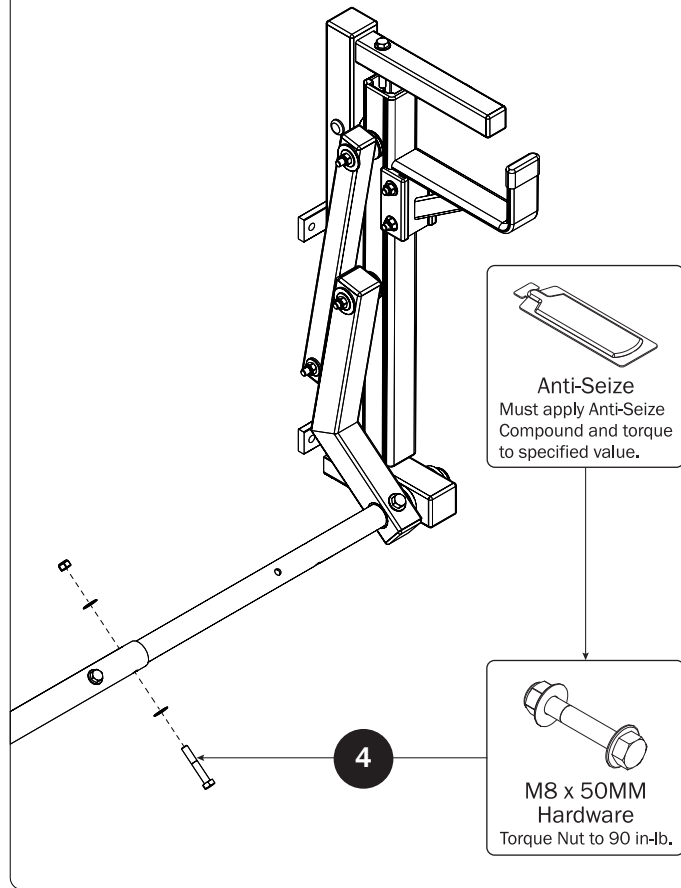

CONNECTING BAR FASTENERS

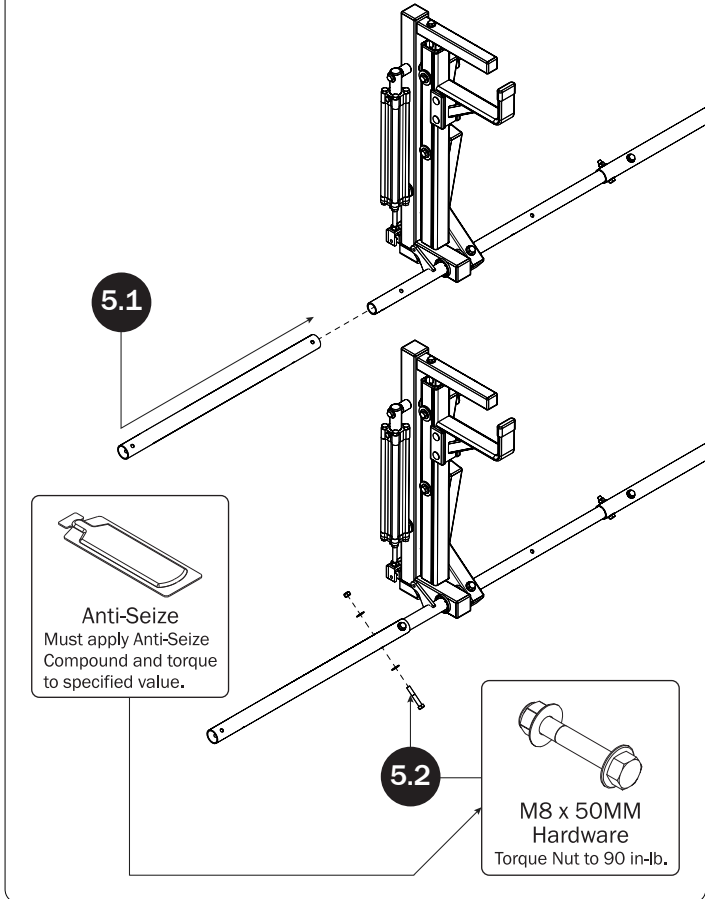

CONNECTING BAR-24"



HEX DRIVE SHAFT REAR EXTENSION

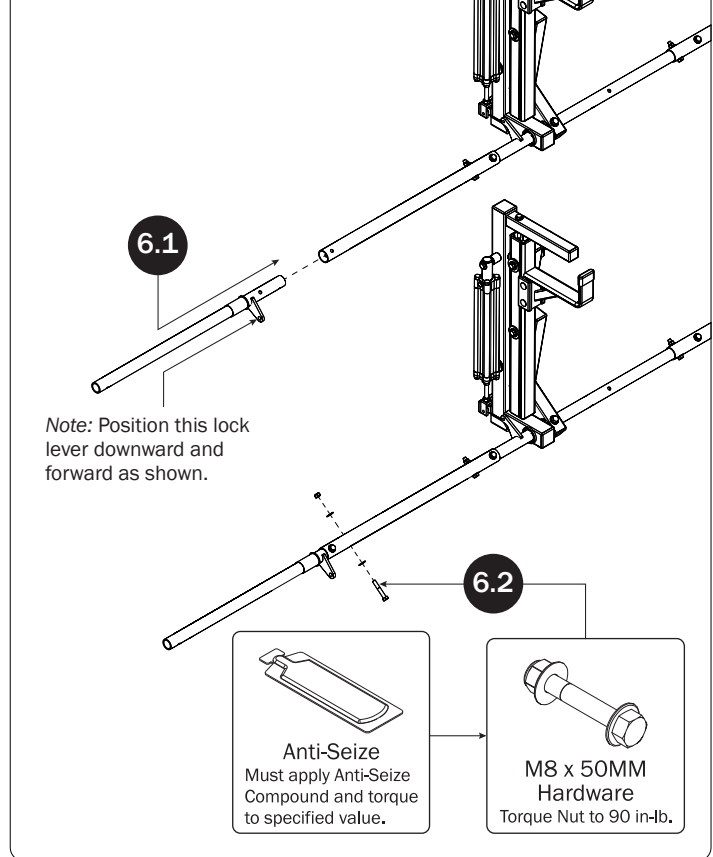

HEX DRIVE SHAFT REAR EXTENSION SUPPORT

7.1 This support is reversible to accommodate different Utility Body mounting positions. To reverse, follow Steps 7.1–7.6. To use as factory-assembled, start at Step 7.7

7.2 Remove and retain this hardware for Step 7.5

7.3 Remove and discard bolts and lock washers.

7.4 Remove and retain Drive Shaft Support for Step 7.5

7.5 Rotate the Rear Extension Support Foot 180° and reassemble using the Drive Shaft Support removed during Step 7.4, and the Nuts and Washers removed during Step 7.2. Do not tighten the Nuts until Step 7.6

7.6 Set to dimension show, and torque nuts to 80 in-lbs.

 Note: This Support will be shown in its typical factory-assembled orientation for the remainder of this manual. Functionality and installation is the same for either orientation, and all included parts and hardware will be used, other than those discarded during Step 7.3.

7.7 Lubricant
Liberal apply to bushing surface

7.8 Firmly seat the Support against the Drive Shaft Bushing.

DRIVE SHAFT HEX STUD-1"

8.1 Insert the Drive Shaft Hex Stud into the open end of the Drive Shaft Extension. Align the bolt holes, then install the 3/8" x 1.75" Hex Stud Bolt (1X), 3/8" Washer (2X), and 3/8" Lock Nut (1X) in the order shown.

8.2 Torque to 90 in-lbs

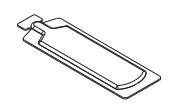

Anti-Seize
Must apply Anti-Seize Compound and torque to specified value.

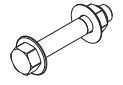

3/8" Hardware
Tight fitting bolt. Use a ratchet and 3/16" socket to thread into Drive Shaft

MOUNTING PREPARATION



The assembled rack is approximately 130" in length making it difficult to properly lift and place on the utility body. To prevent bodily injury and/or vehicle damage, it is recommended to use two people to safely lift and place the rack onto the vehicle.

- 9.1** Rotate the Hydraulic Cylinder upward to allow access to the mountings on the rear vertical Upright. Ensure the Hex Drive Shaft Extension Support is still firmly seated prior to marking its hole locations.

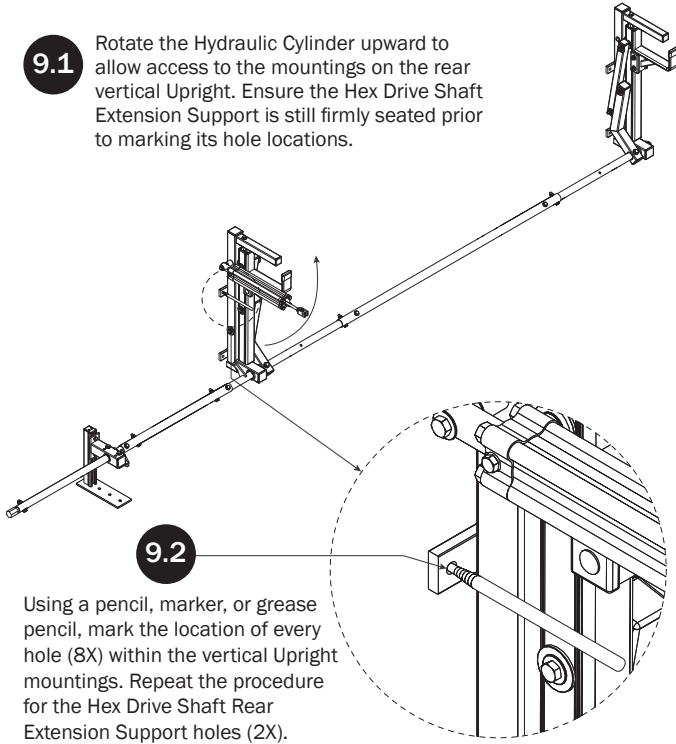

9.2

Using a pencil, marker, or grease pencil, mark the location of every hole (8X) within the vertical Upright mountings. Repeat the procedure for the Hex Drive Shaft Rear Extension Support holes (2X).

9.3

Remove the rack to expose the bolt hole markings. Using a 9MM, 23/64", or T size bit, drill holes into the Utility Body at the marked mounting bolt hole locations created during Step 9.2.

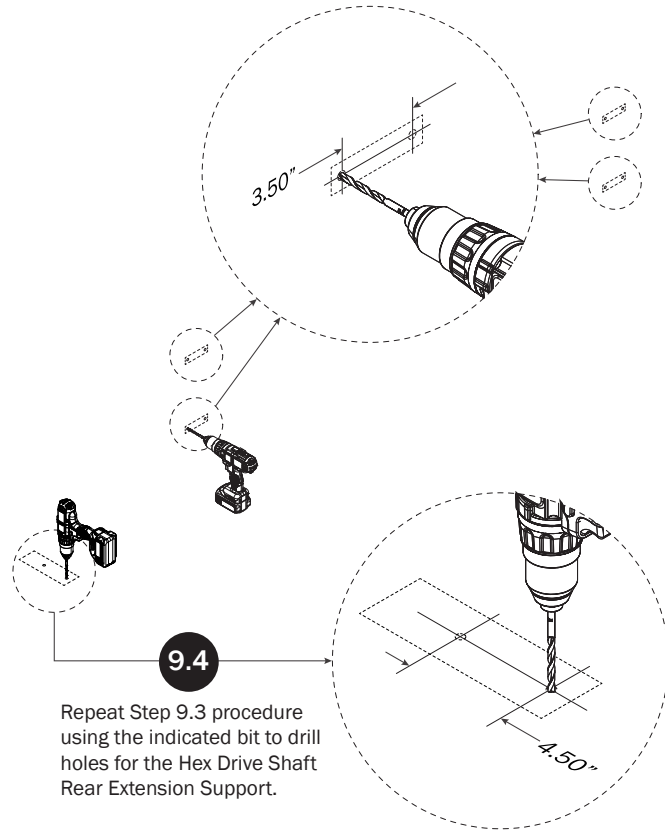

9.4

Repeat Step 9.3 procedure using the indicated bit to drill holes for the Hex Drive Shaft Rear Extension Support.

UTILITY BODY MOUNTING

- 9.5** Lift and position the rack back onto the Utility Body. Align the vertical Uprights until the mounting holes realign to the body holes drilled during Steps 9.3 and 9.4.

9.6

Using the fastening hardware shown below, attach the vertical Uprights to the Utility Body. The Neoprene Washer, Fender Washer, and Locknut install from the inside of the Utility Body in the order shown, while the Bolt and Seal Washer install from the outside. Do not tighten until Step 9.8

- 9.8** Torque to 90 in-lbs



Anti-Seize
Must apply Anti-Seize Compound and torque to specified value.

9.7

Using the fastening hardware shown to the right, attach the Hex Drive Shaft Rear Extension to the Utility Body. The Neoprene Washer, Fender Washer, and Locknut install from the inside of the Utility Body in the order shown, while the Bolt and Seal Washer install from the outside. Proceed to Step 9.8

Mounting Hardware (10X)

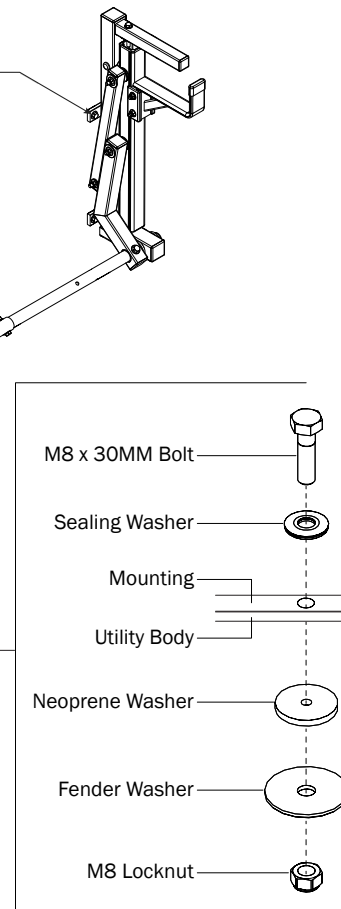

- M8 x 30MM Bolt
- Sealing Washer
- Mounting
- Utility Body
- Neoprene Washer
- Fender Washer
- M8 Locknut

CYLINDER HARDWARE

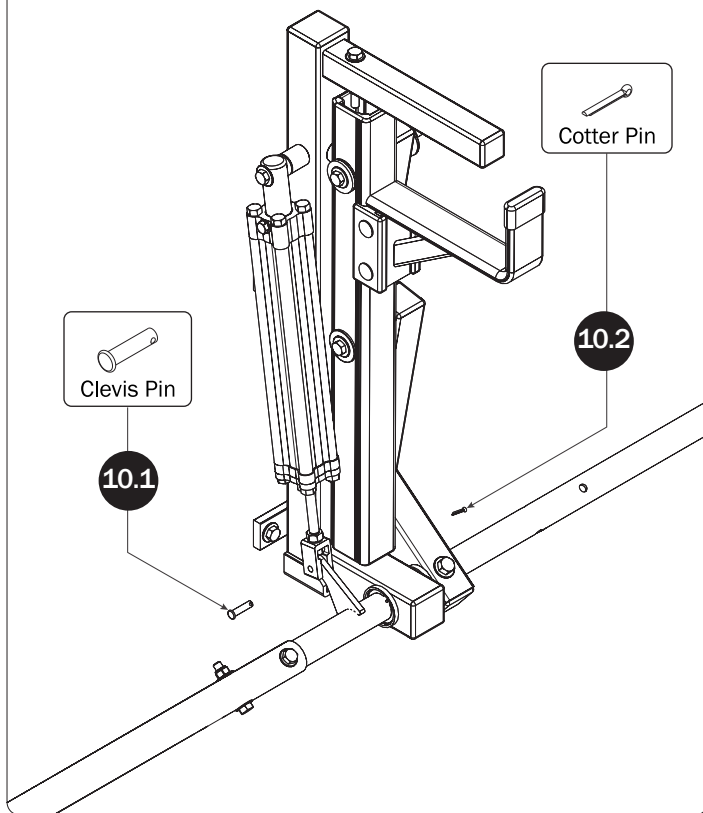

CYLINDER ADJUSTMENT

11.1 To properly adjust the Hydraulic Cylinder for load descent speed, position the intended-use ladder onto the Vertical Z Post. Proceed to Step 11.2 and adjust accordingly.

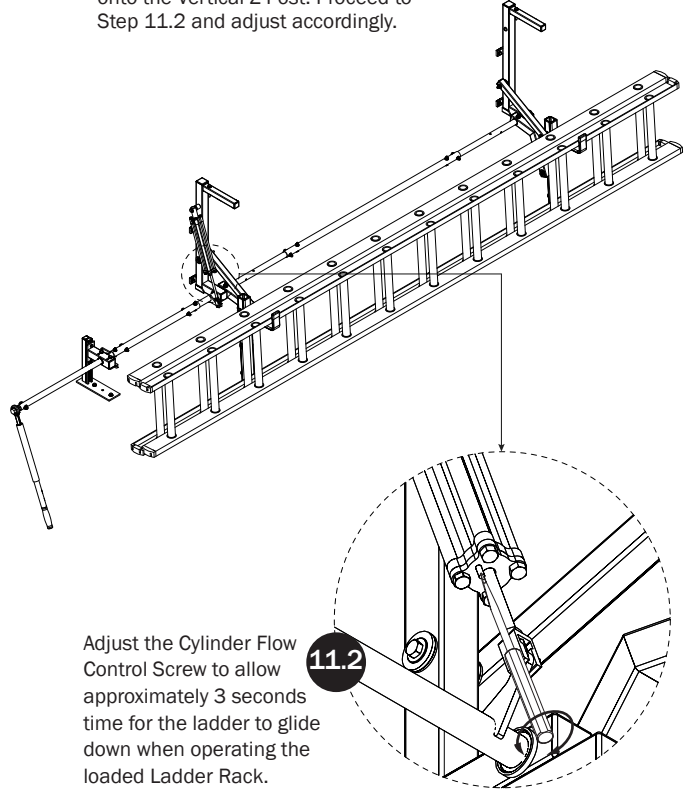

DRIVE SHAFT SEALING

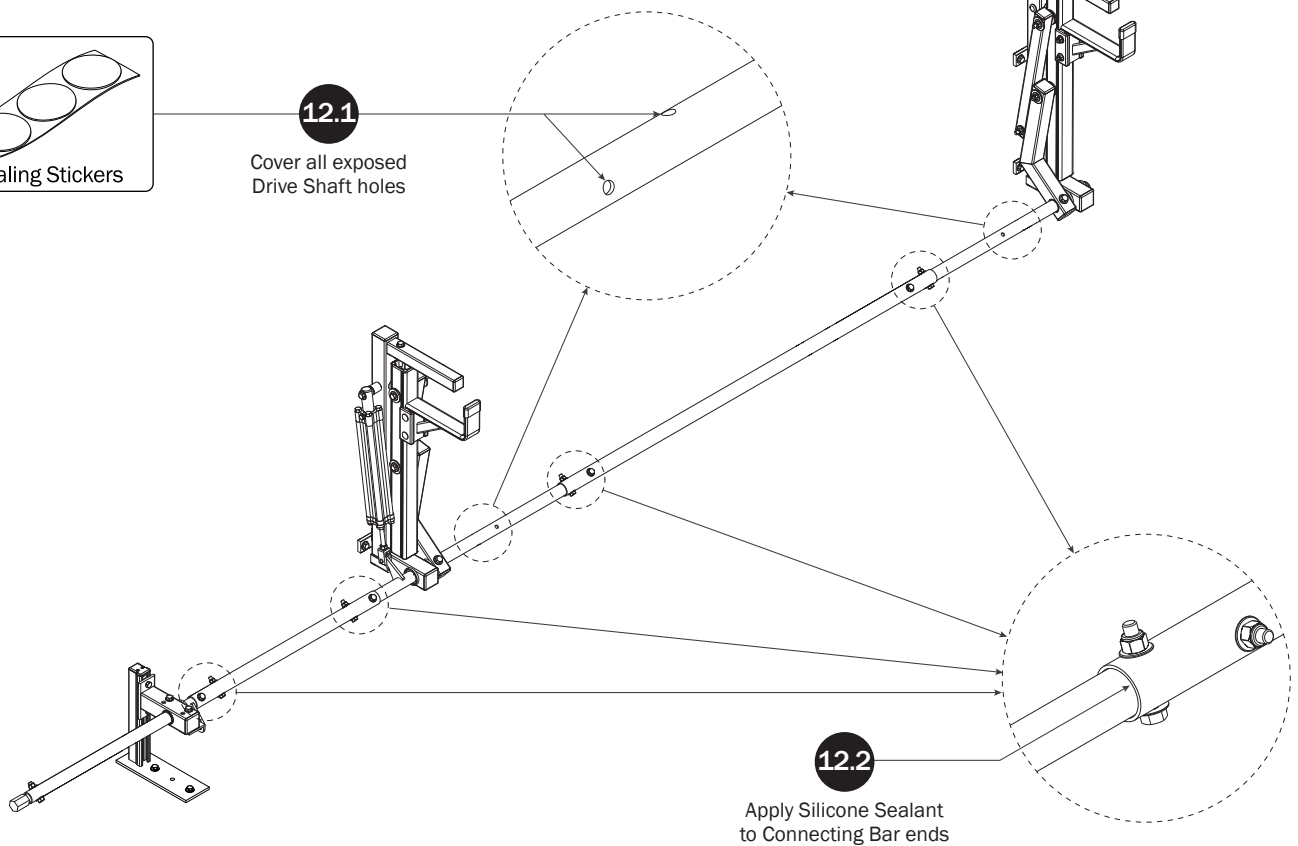
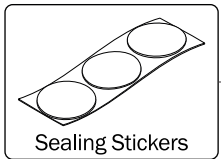

USAM-UXV214-US01 Rev-A 0618