

# PRIME DESIGN™

A Safe Fleet Brand

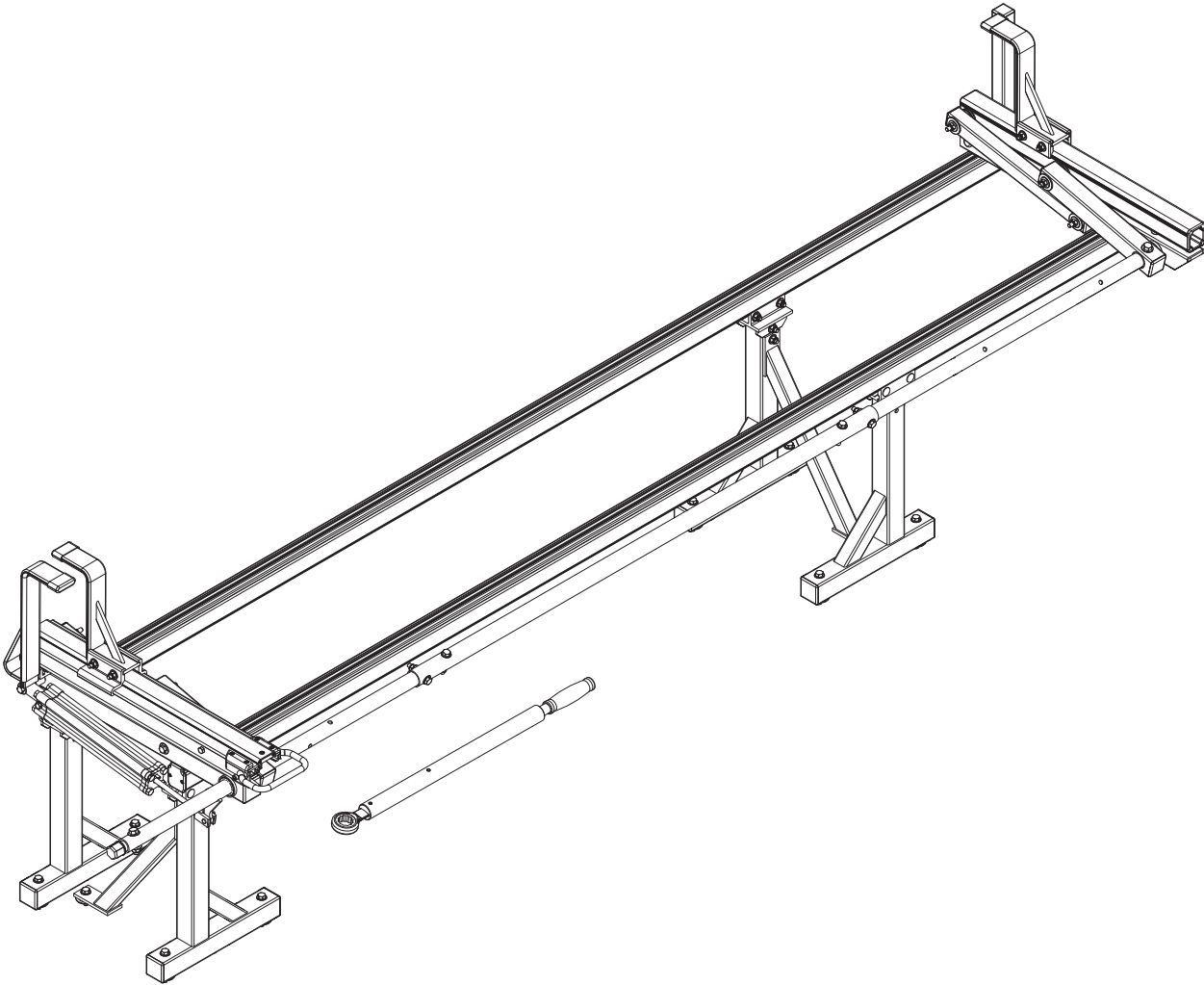

UXR  
1007

PRIME DESIGN, A SAFE FLEET BRAND

Address: 580 Opperman Drive, Eagan, MN 55123 • Toll Free: 1.8.PRIME.RACK  
Fax: 651-552-1799 • Email: [info@primedesign.net](mailto:info@primedesign.net) • Website: [www.primedesign.net](http://www.primedesign.net)

CONTENTS OVERVIEW

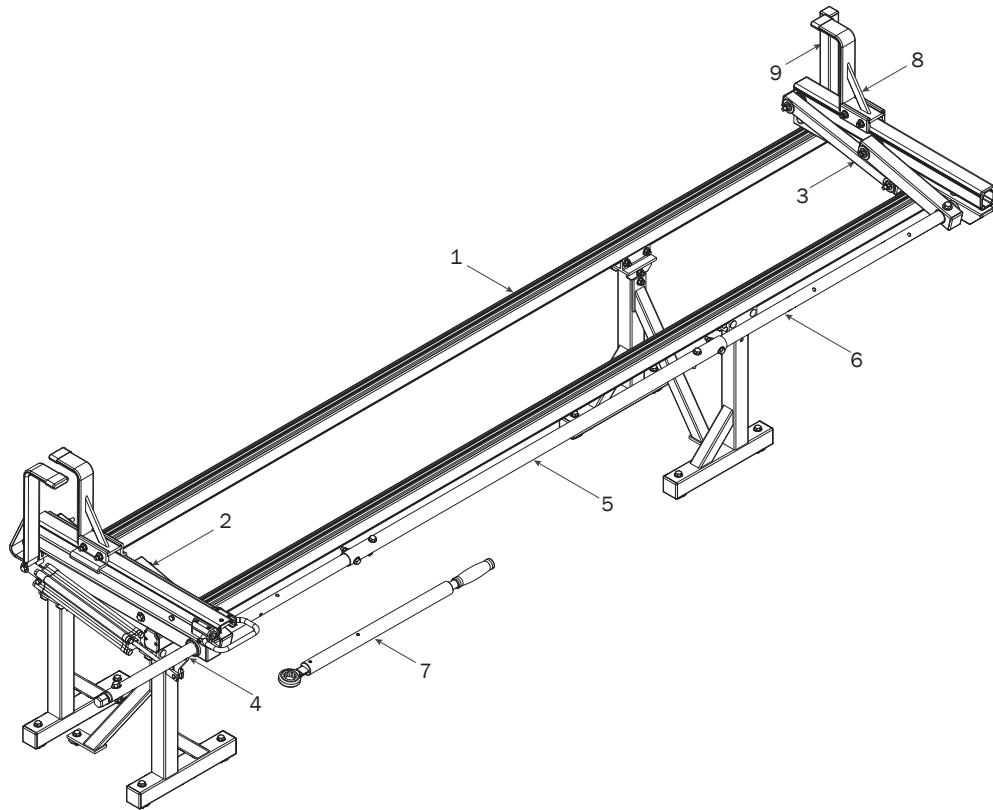

1—FBM-0117 ..... (Qty 1)  
98.00", Suspension Bar Frame, with Hardware



98".00 Suspension Bar (2X)

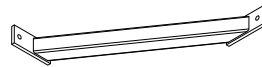

15.00" Mounting Brace (2X)

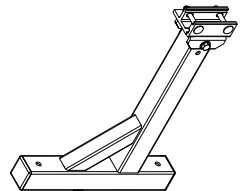

Utility Rack Base (4X)



M8 x 55MM (3X)



M8 x 65MM (11X)

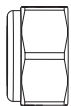

Lock Nut (12X)

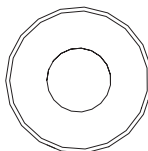

Flat Washer (14X)



Neoprene Washer (2X)

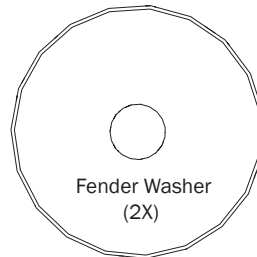

Fender Washer (2X)

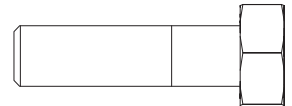

M8 x 30MM (2X)

2—Rear Rotation Assembly..... (Qty 1)

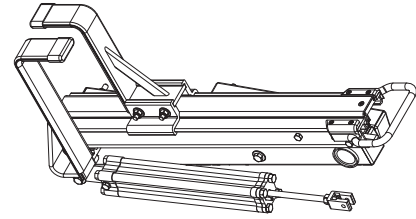

3—Front Rotation Assembly..... (Qty 1)

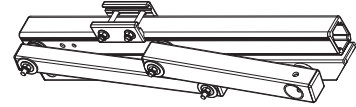

4—Rear Drive Shaft..... (Qty 1)  
Right Hand, B4 Version, 50.00”



5—Connecting Bar..... (Qty 1)  
48.00”



6—Front Drive Shaft ..... (Qty 1)  
B Version, 35.75”

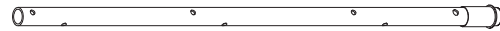

7—Ratcheting Handle Assembly ..... (Qty 1)  
With Hardware

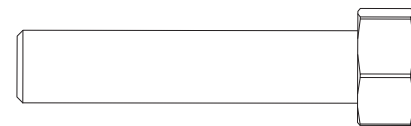
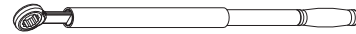
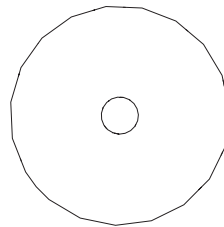
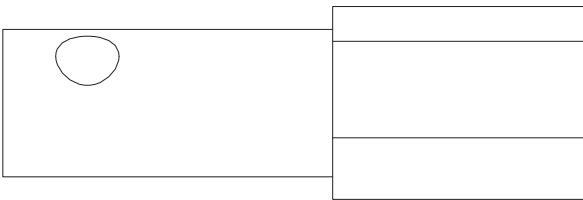

8—Z Post ..... (Qty 1)  
Adjustable, 7.25”

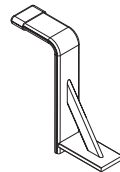

9—L Post ..... (Qty 1)  
9.25”

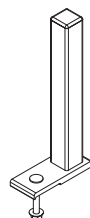

HKT-8163-Rotation Hardware Kit

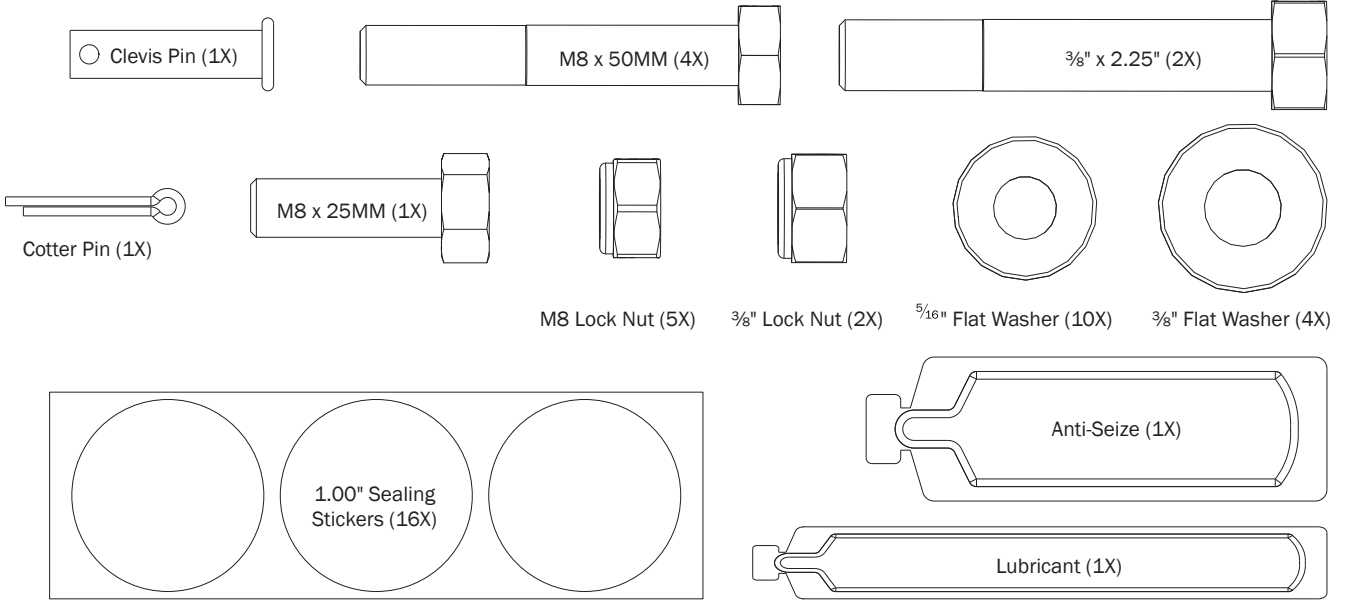

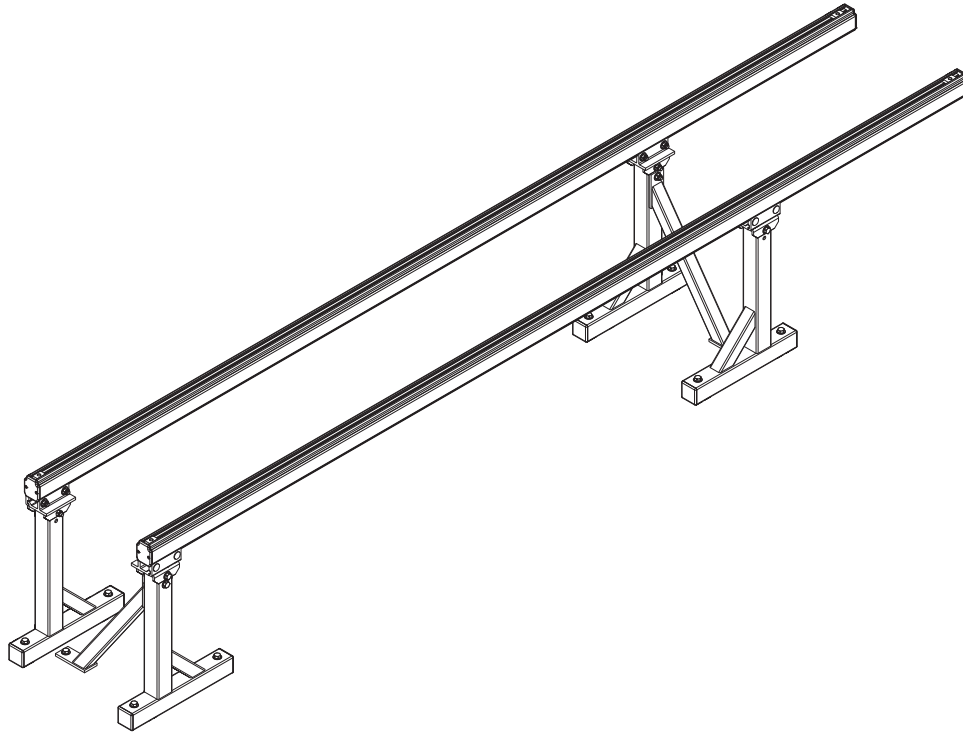

**MOUNTING BRACE**

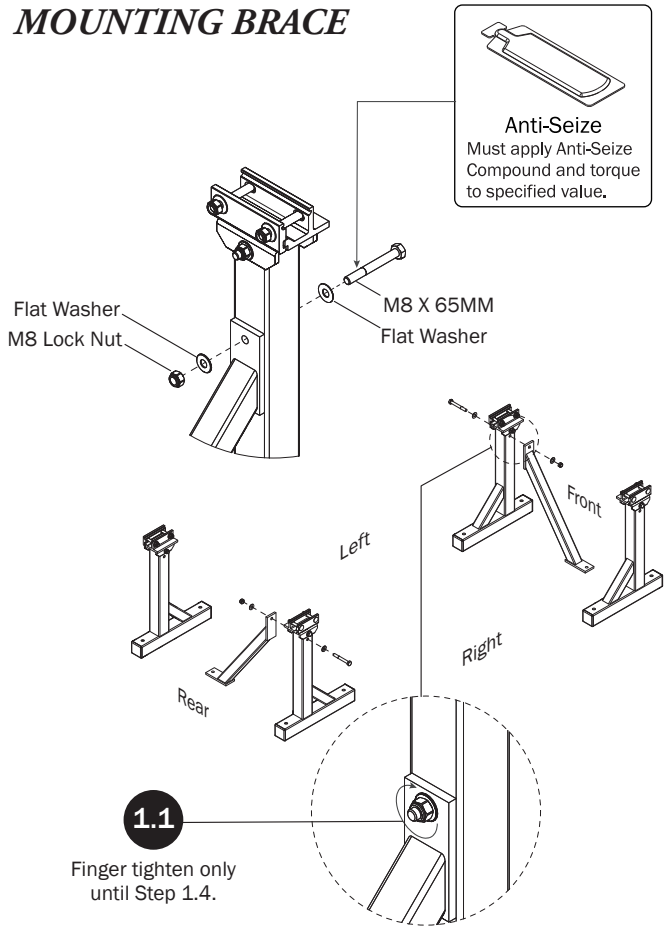

**UTILITY BASE  
DRILLING LOCATIONS**

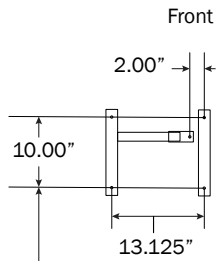

NOTE: The Rear Drive Shaft must not extend past the bumper of your vehicle. See Rear Drive Shaft Offset below for reference while placing your rack.

Marking and drilling distances are as shown.

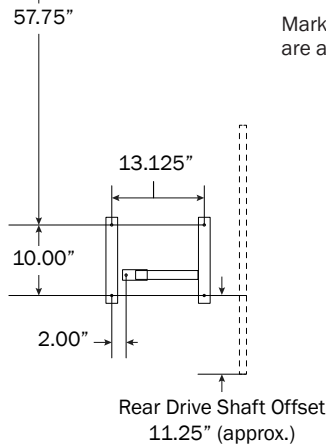

**UTILITY BASE**

**1.2** Apply Anti-Seize to Rack Base Mounting Bolts and install as show. Torque to 90 in-lbs.

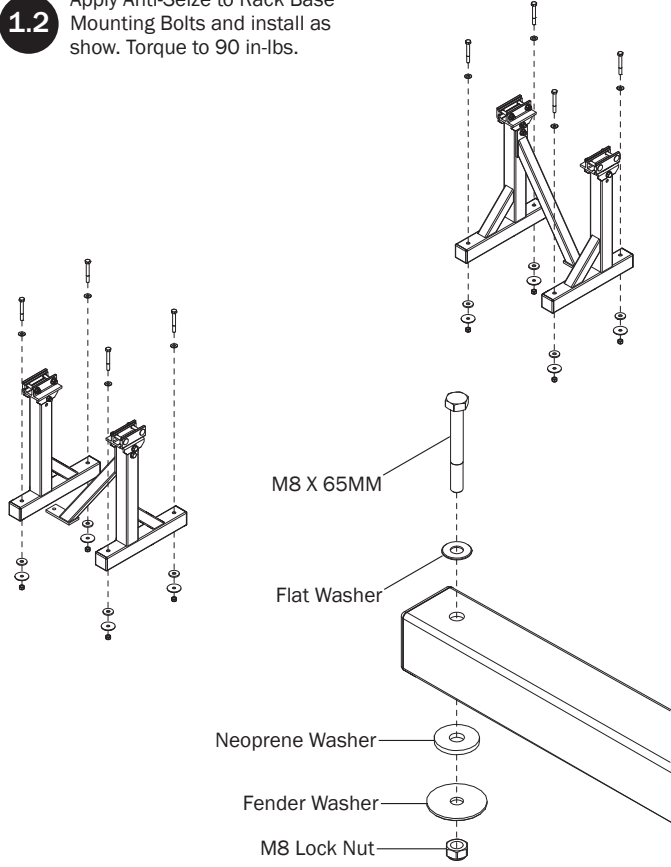

**1.3** Apply Anti-Seize to Brace Mounting Bolts and complete installation of mounting system.

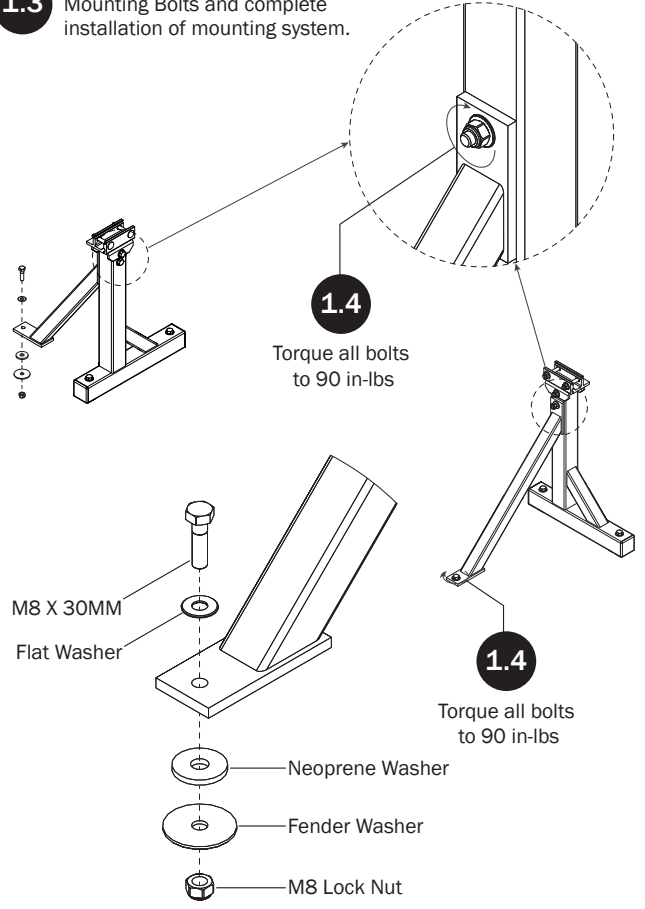

**SUSPENSION BARS**

**1.5** Place Suspension Bars onto the Utility Base and position as shown.

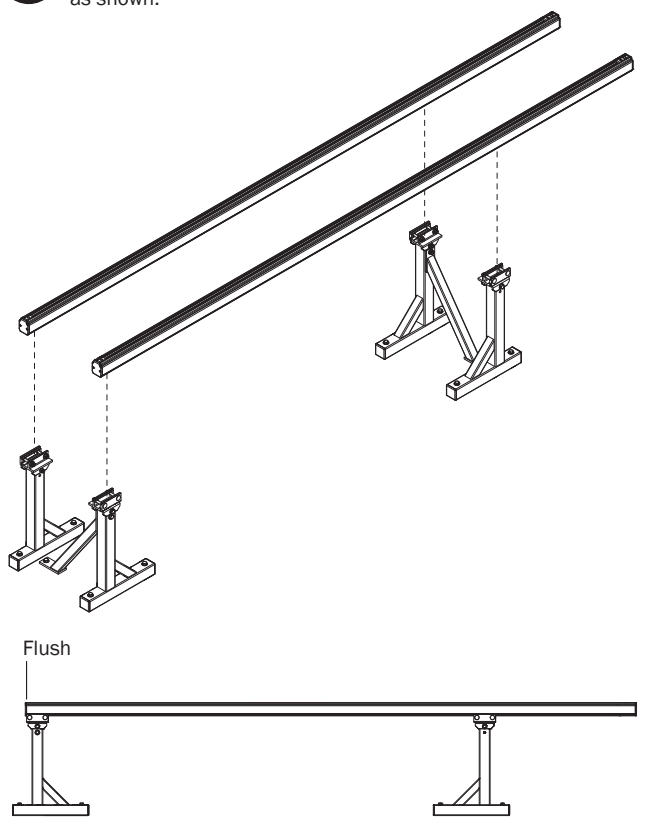

**1.6** Torque Utility Base Clamp Bolts to 90 in-lbs.

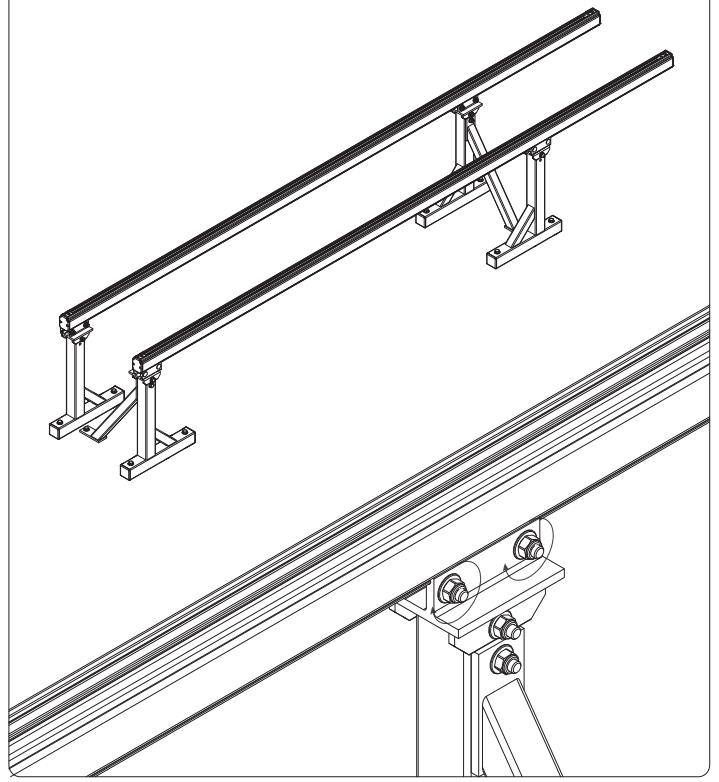

## RIGHT ROTATION ASSEMBLY SEQUENCE

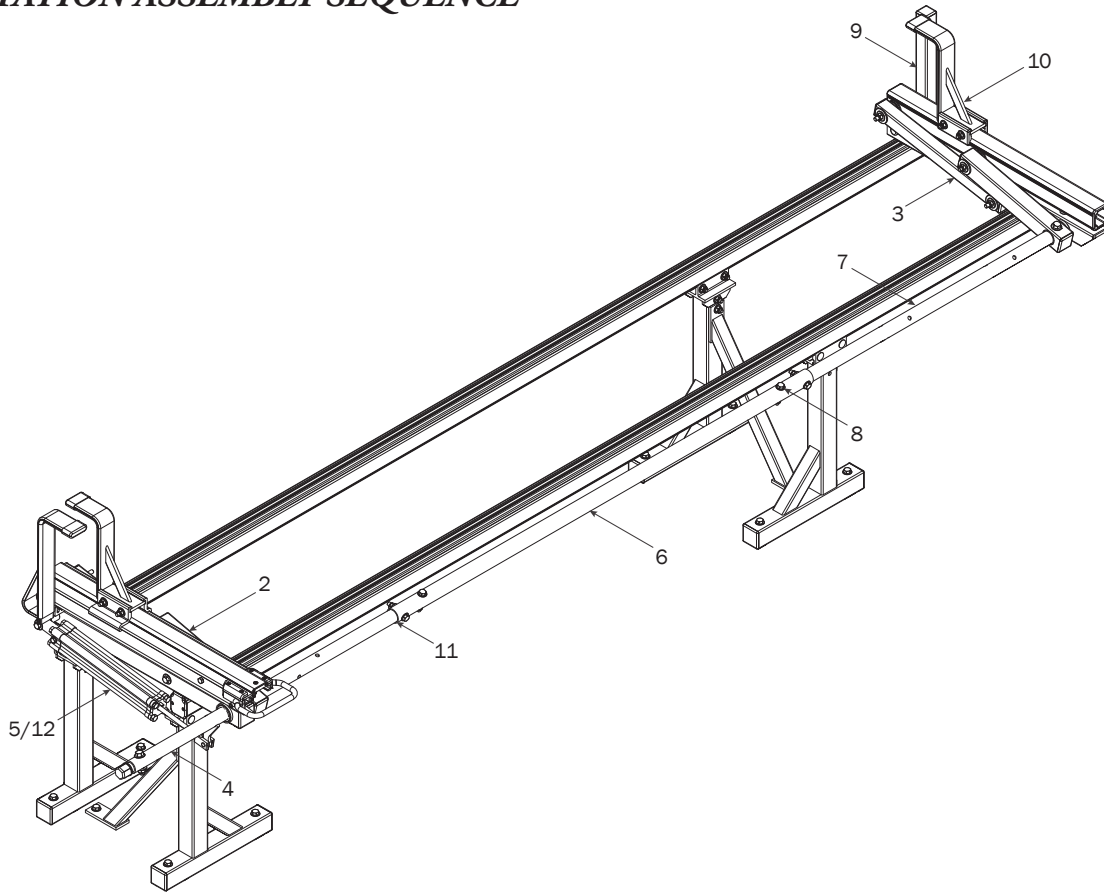

### REAR ROTATION ASSEMBLY

- 2** Place Rear Crossbar onto FBM as shown and torque to 90 in-lbs.

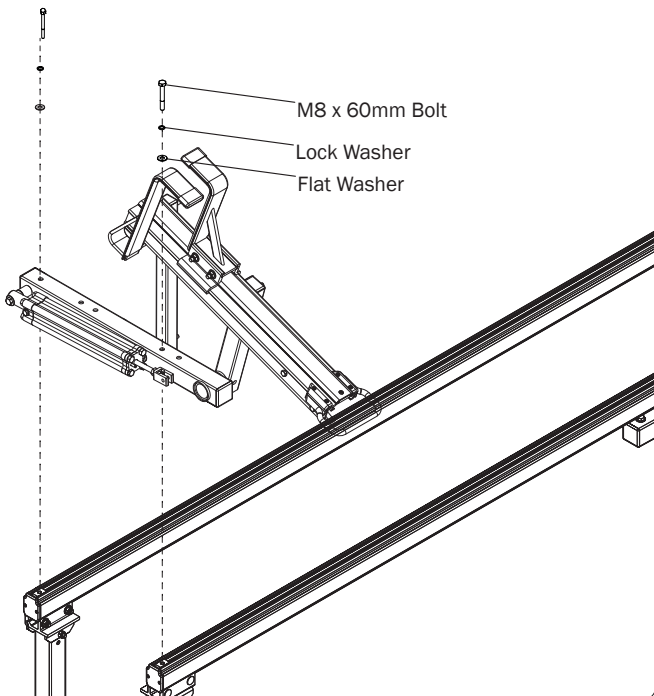

### FRONT ROTATION ASSEMBLY

- 3** Place Front Crossbar onto FBM as shown and torque to 90 in-lbs.

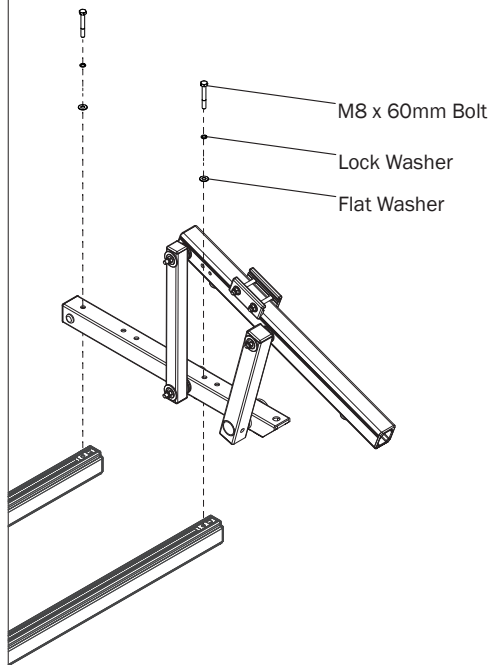

### REAR DRIVE SHAFT

NOTE: For instructional clarity, the FBM Mounting System will not be shown for the remainder of this Assembly Manual.

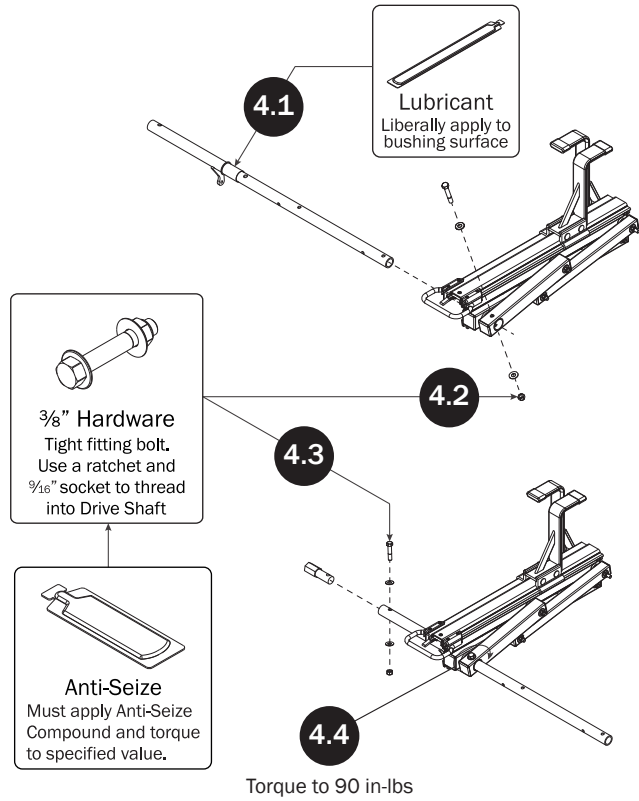

### CYLINDER HARDWARE

NOTE: Adjusting the Cylinder's Flow Control screw by 1-1/2 turns left to default setting will release the Cylinder Rod making it easier to pull the rod toward the Drive Shaft's Cylinder Lever during installation.

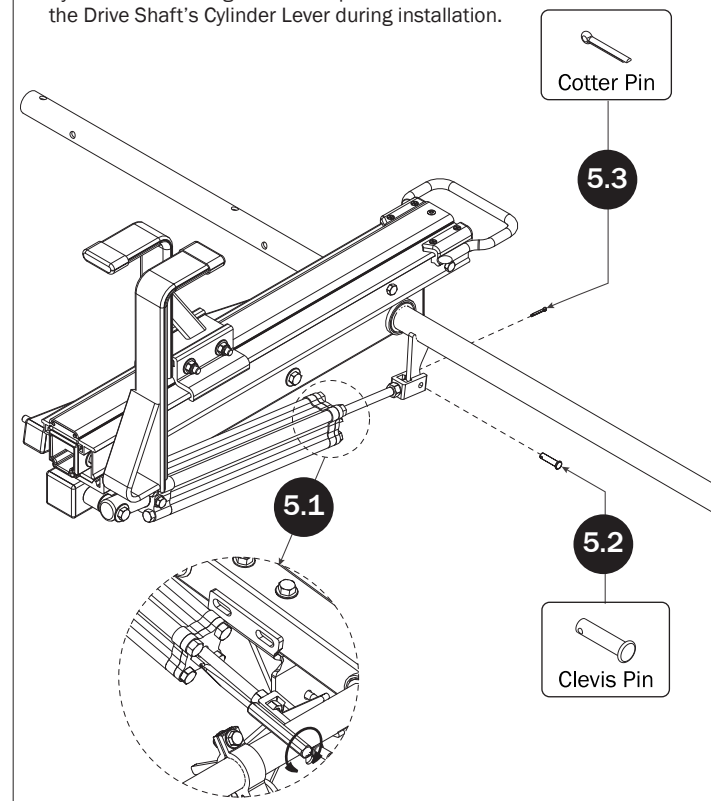

### CONNECTING BAR

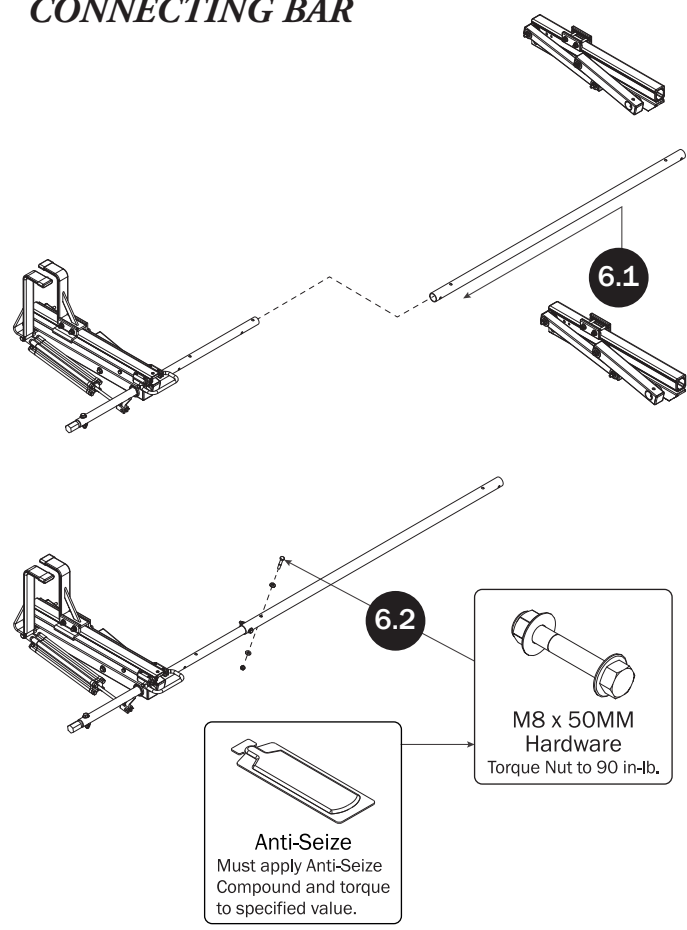

### FRONT DRIVE SHAFT

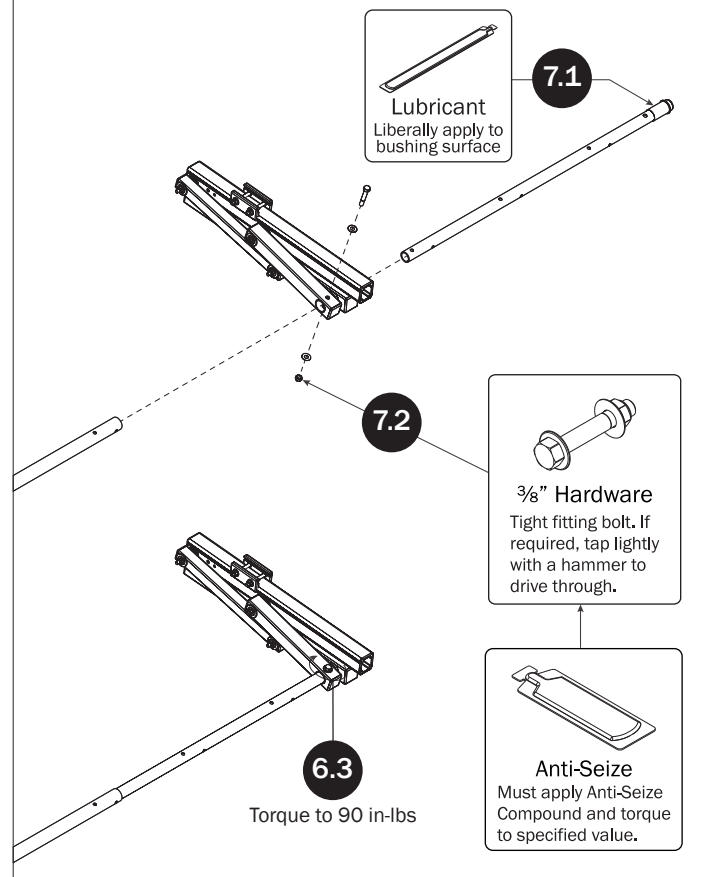



## CONNECTING BAR FASTENERS

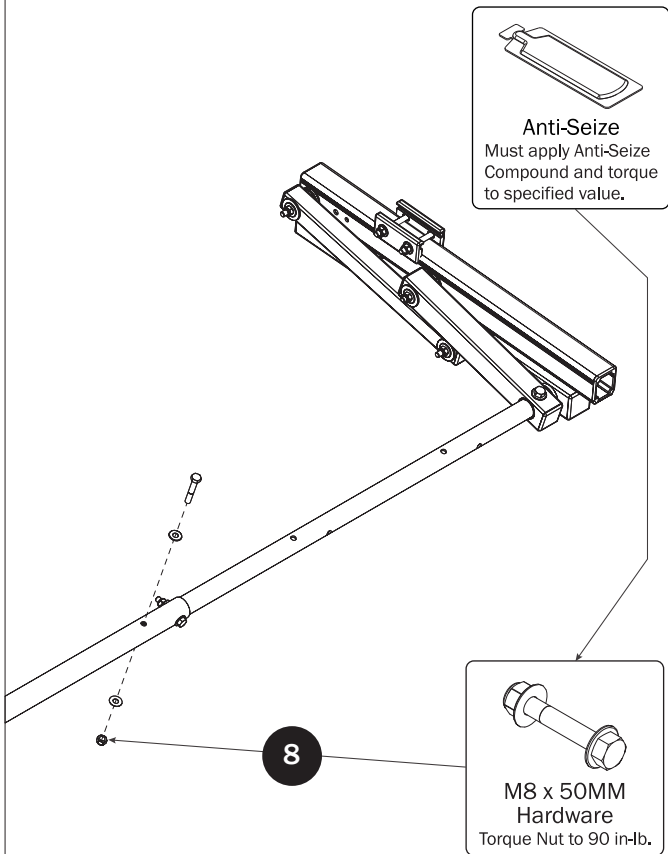

## L POSTS

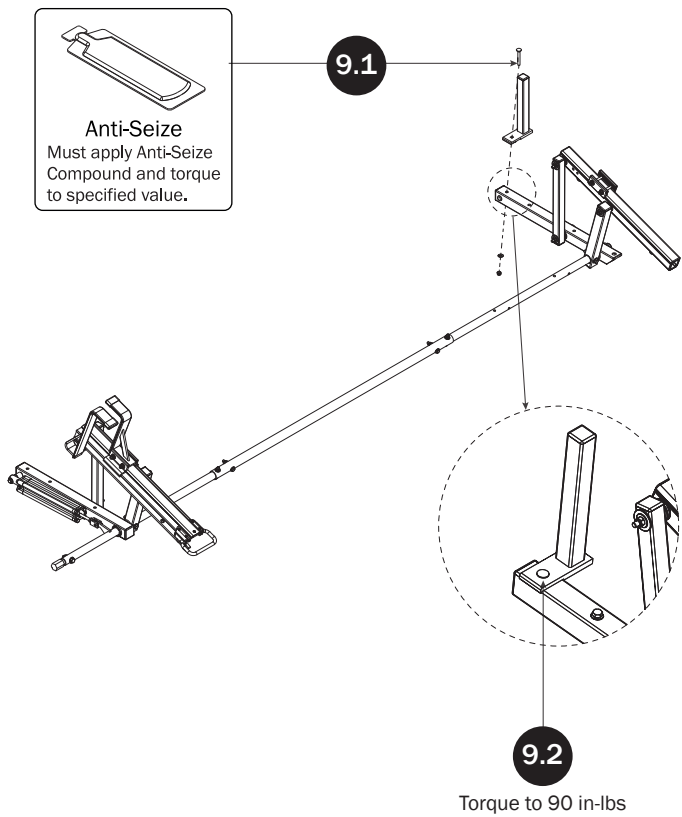

## Z POSTS

SEE QUICK START GUIDE FOR ADJUSTMENTS

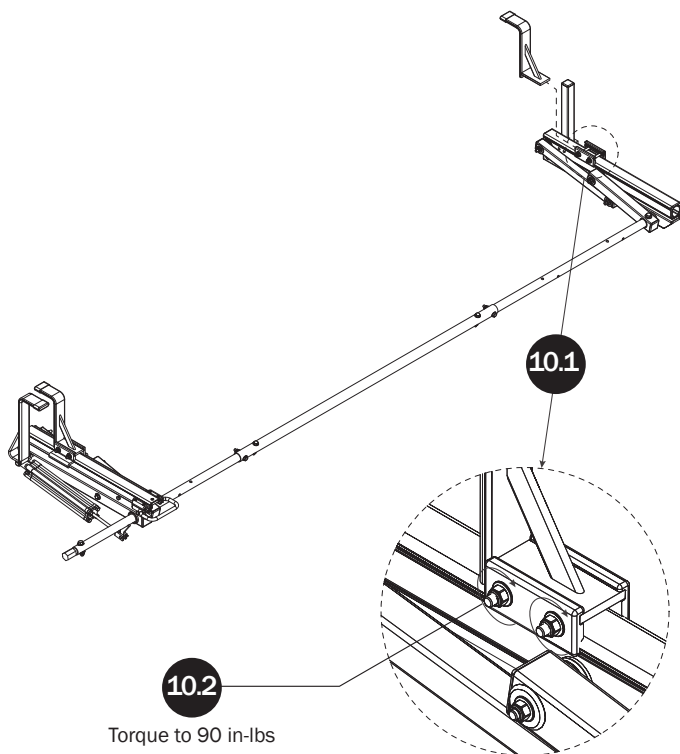

## DRIVE SHAFT SEALING

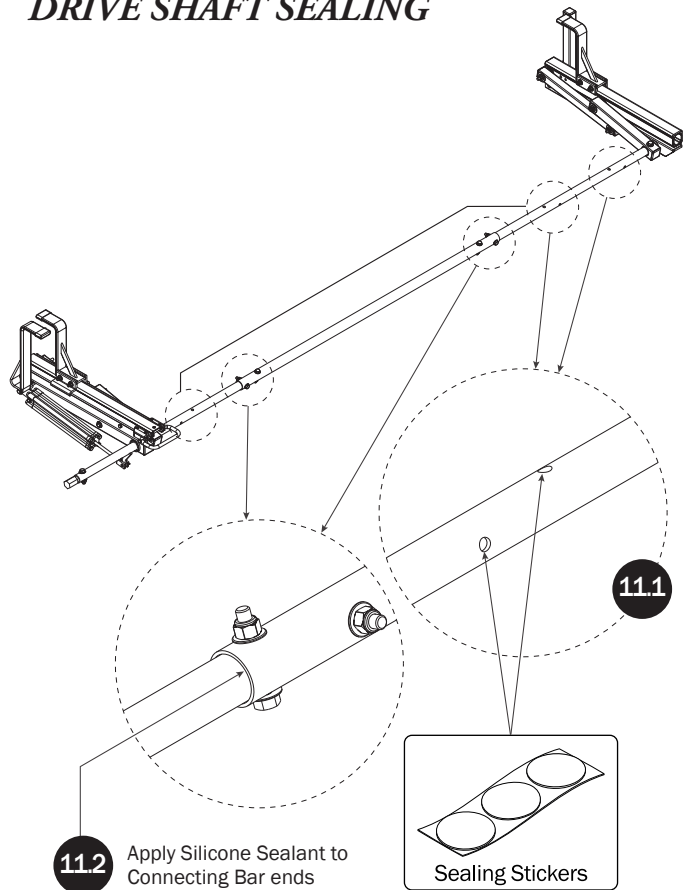

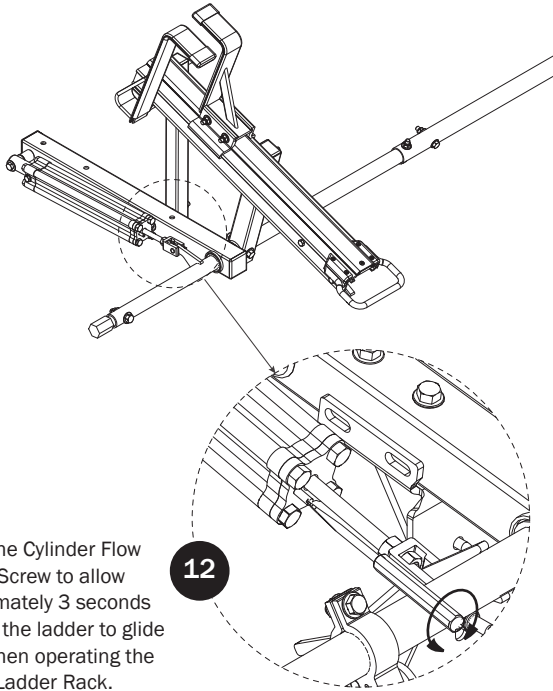
**CYLINDER ADJUSTMENT**

Adjust the Cylinder Flow Control Screw to allow approximately 3 seconds time for the ladder to glide down when operating the loaded Ladder Rack.

Page Intentionally Left Blank

