

PRIME DESIGN™

A Safe Fleet Brand

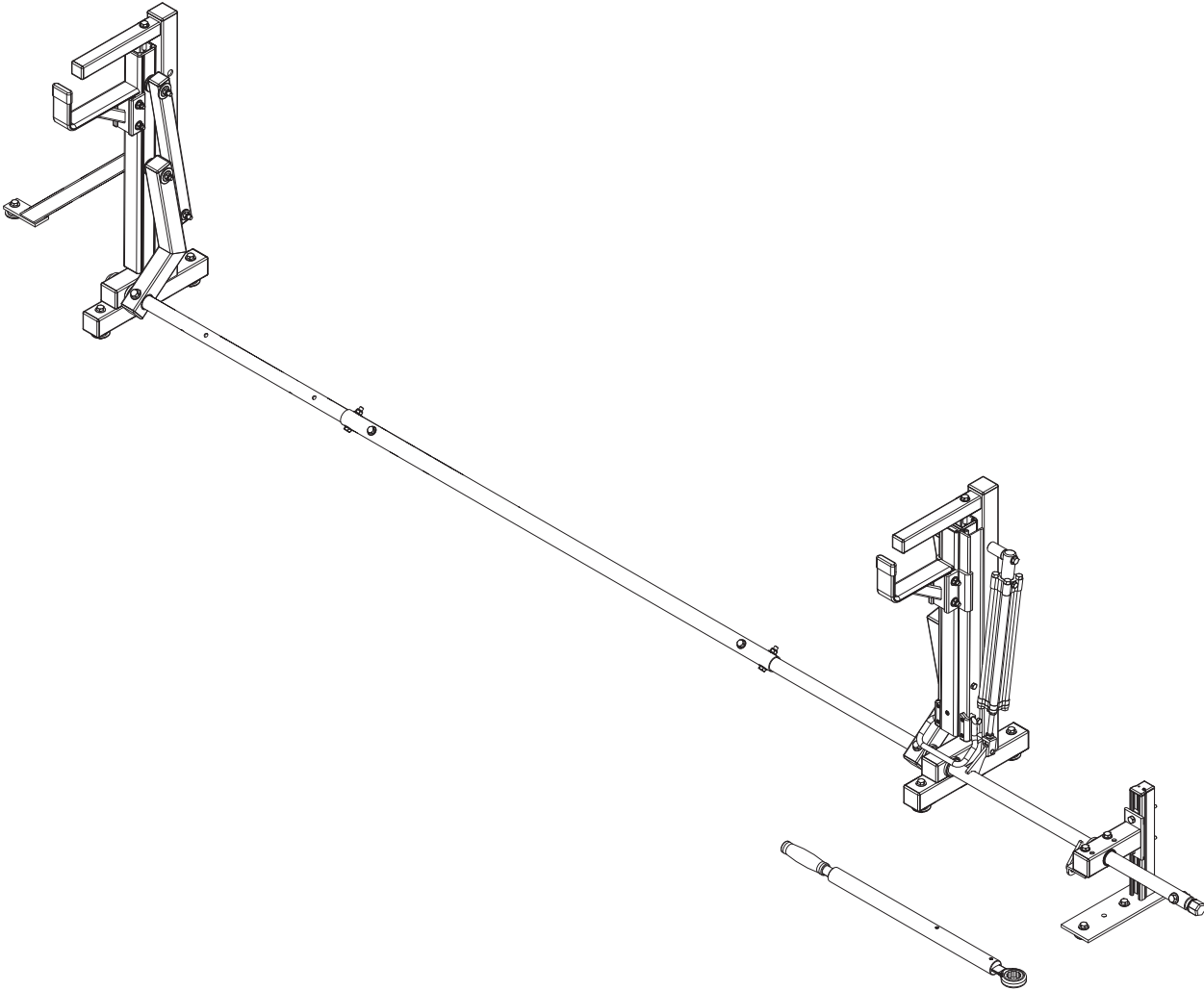

702XN

PRIME DESIGN, A SAFE FLEET BRAND

Address: 580 Opperman Drive, Eagan, MN 55123 • Toll Free: 1.8.PRIME.RACK
Fax: 651-552-1799 • Email: info@primedesign.net • Website: www.primedesign.net

CONTENTS OVERVIEW

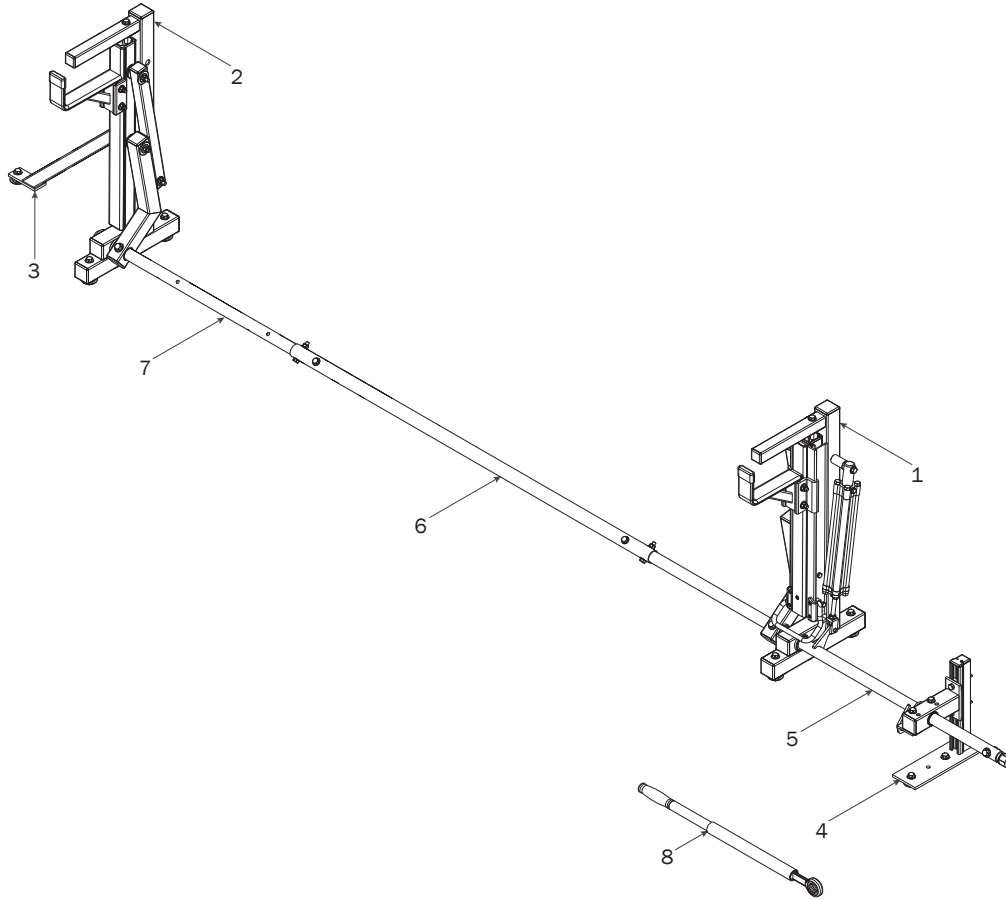

1—Rear Rotation Assembly..... (Qty 1)

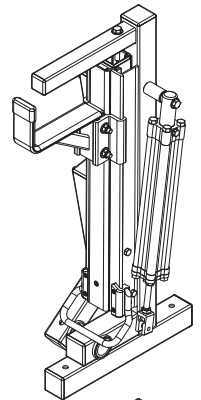

2—Front Rotation Assembly..... (Qty 1)

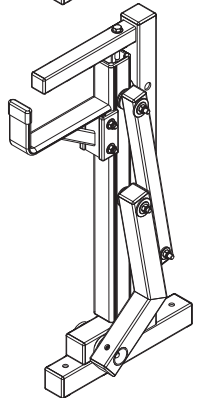

3—Mount Brace..... (Qty 1)
20.00"



4—Vertical Drive Shaft Support..... (Qty 1)
Utility, Left Hand

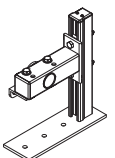

5—Rear Drive Shaft..... (Qty 1)
Hex Head, Left Hand, 50.00"

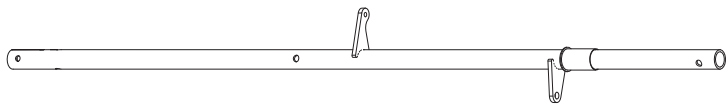

6—Connecting Bar..... (Qty 1)
48.00"

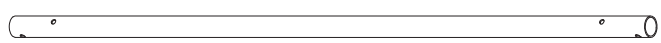

7—Front Drive Shaft..... (Qty 1)
B Version, 35.75"

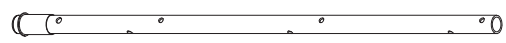

HKT-8163-Rotation Hardware Kit

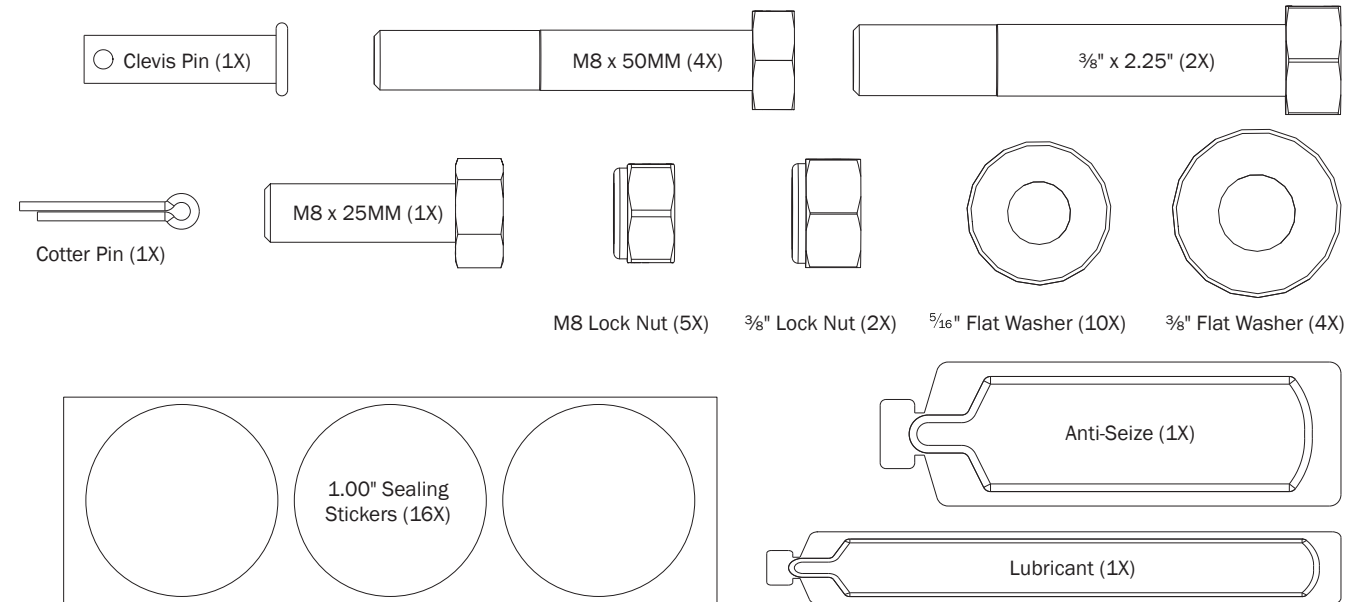

HKT-0255-Hardware Kit

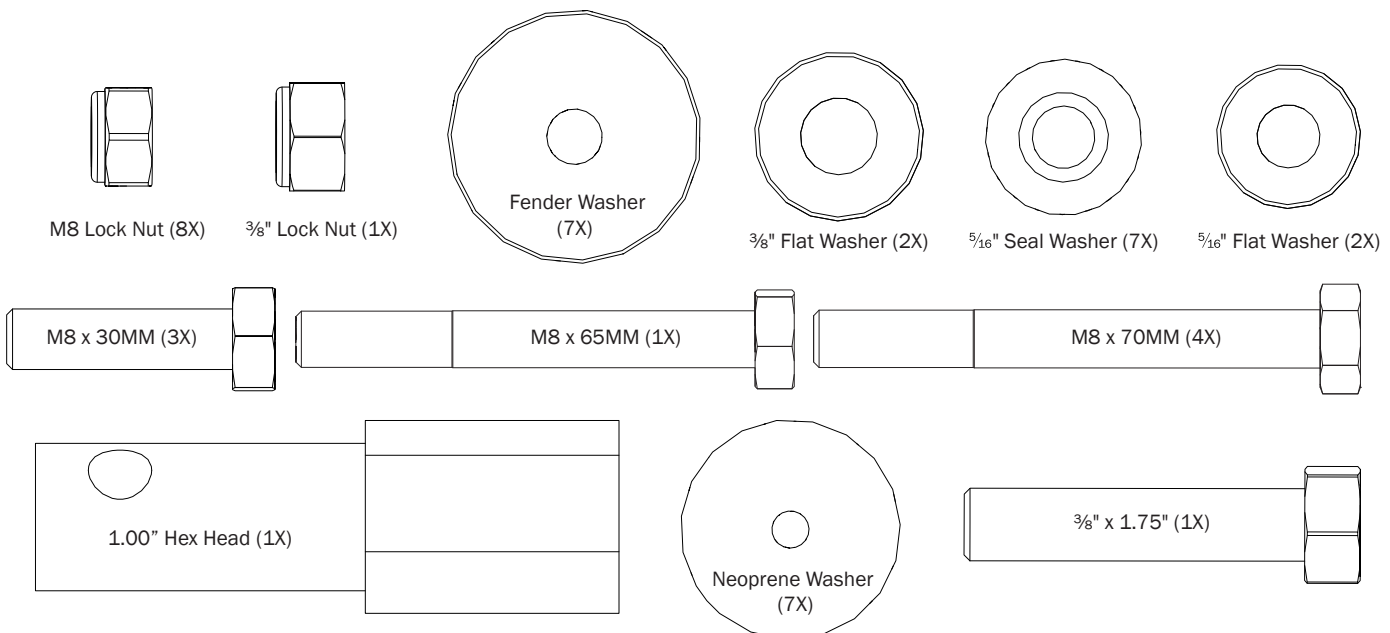

MOUNTING DIMENSIONS



Mounting to Service Body: dimensions are dependent upon Crossbar distances of 6'-8' plus allowance for Drive Shaft Support and Offset (Rear), and Mount Brace (Front)—the rear drive shaft must not extend past the vehicle bumper (see dimensions below).

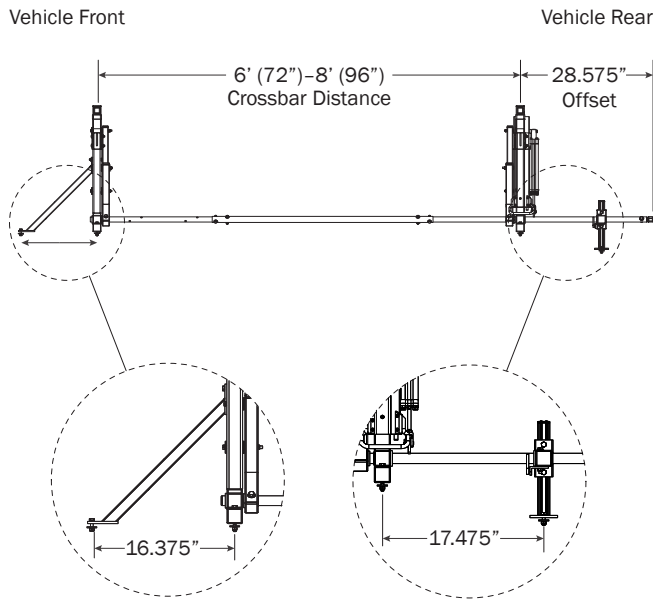

0.1 6.00 Ft: Drill holes into the Service Body mounting location according to dimensions shown.

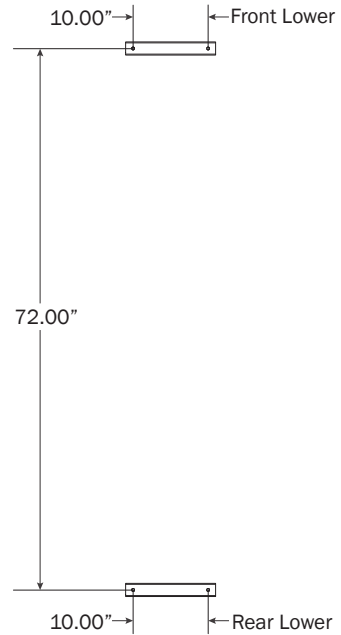

0.2 7.00 Ft: Drill holes into the Service Body mounting location according to dimensions shown.

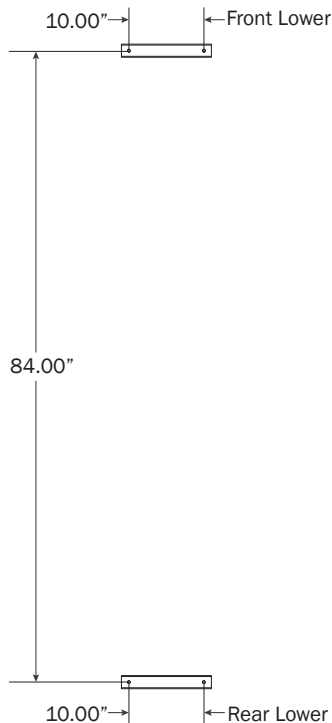

0.3 8.00 Ft: Drill holes into the Service Body mounting location according to dimensions shown.

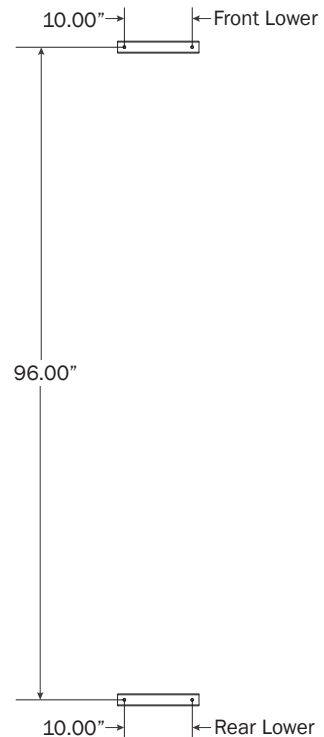

RIGHT ROTATION ASSEMBLY SEQUENCE

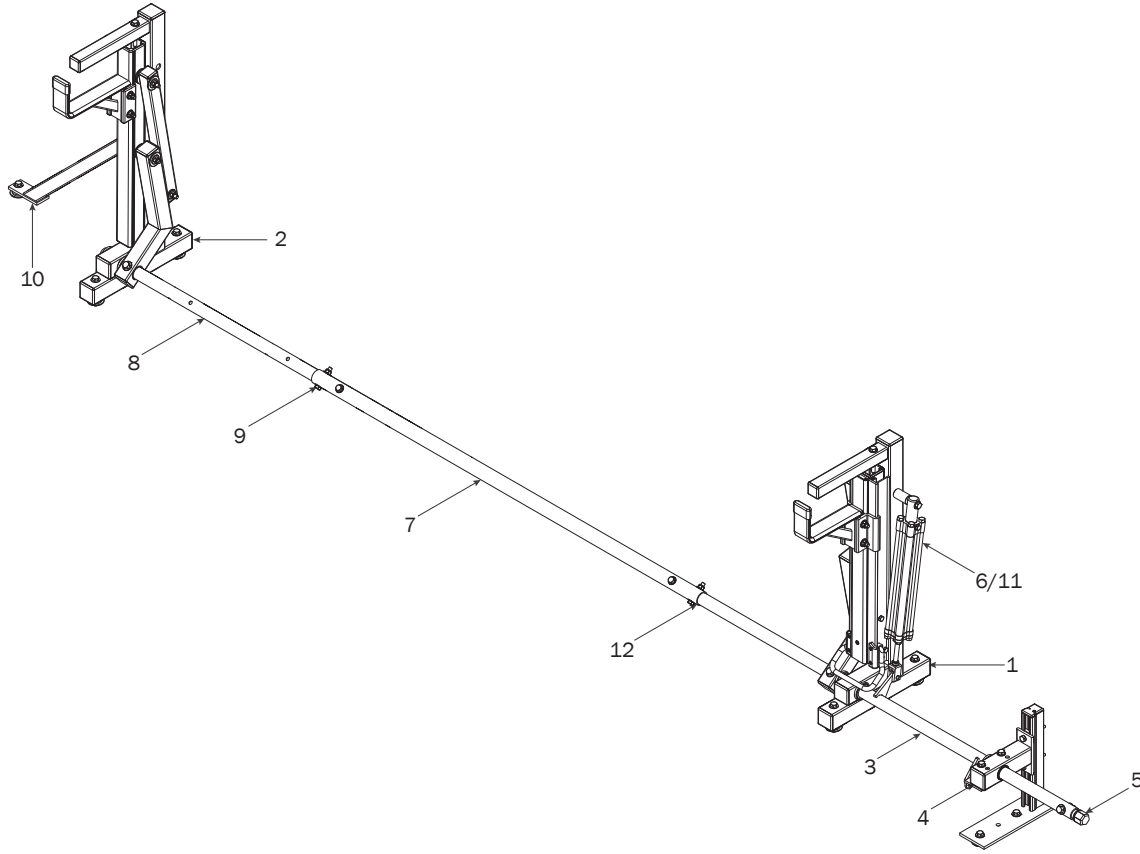

REAR ROTATION ASSEMBLY

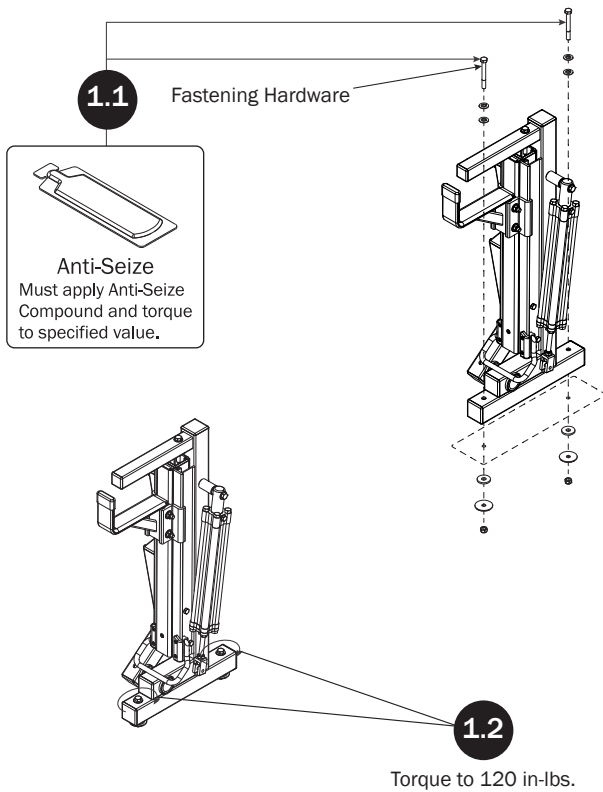

FRONT ROTATION ASSEMBLY

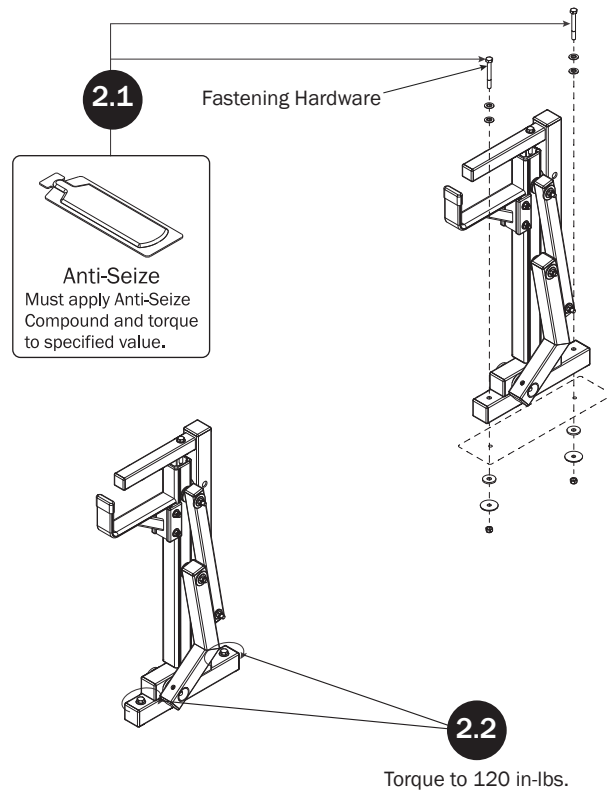

REAR DRIVE SHAFT

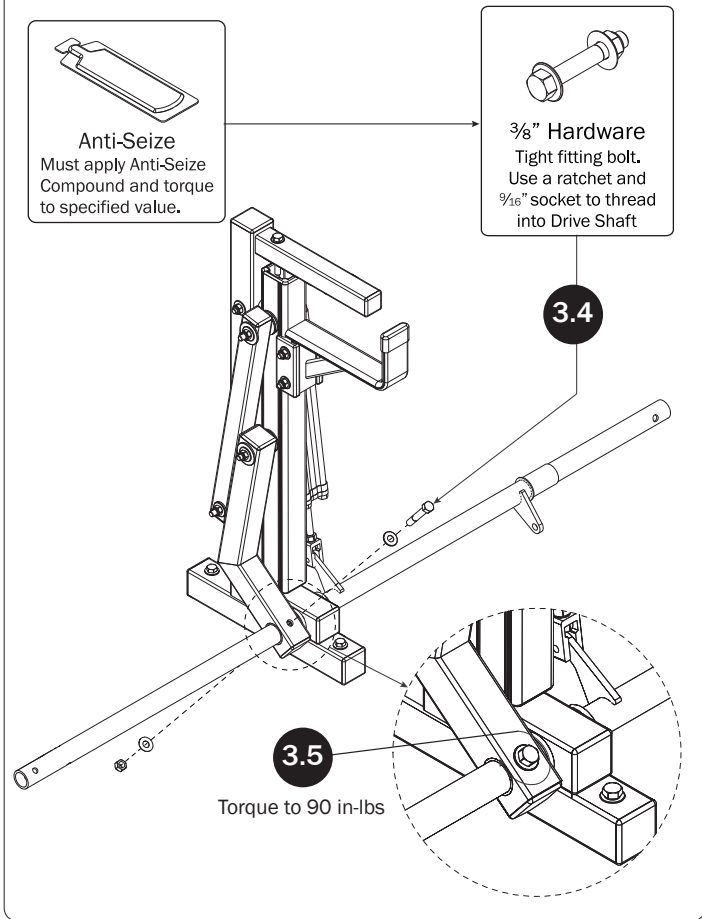
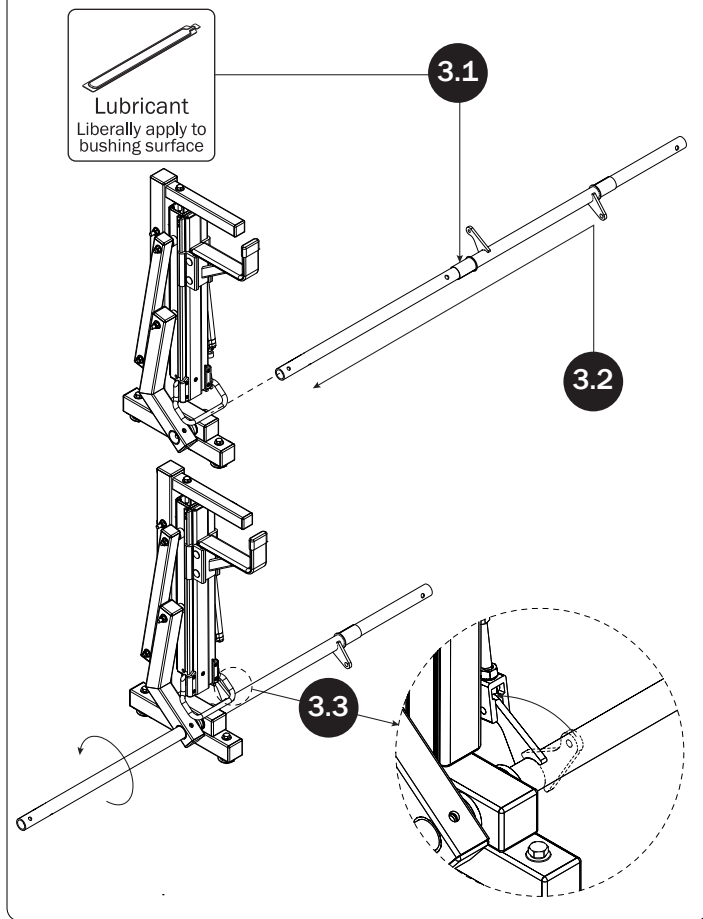

DRIVE SHAFT SUPPORT

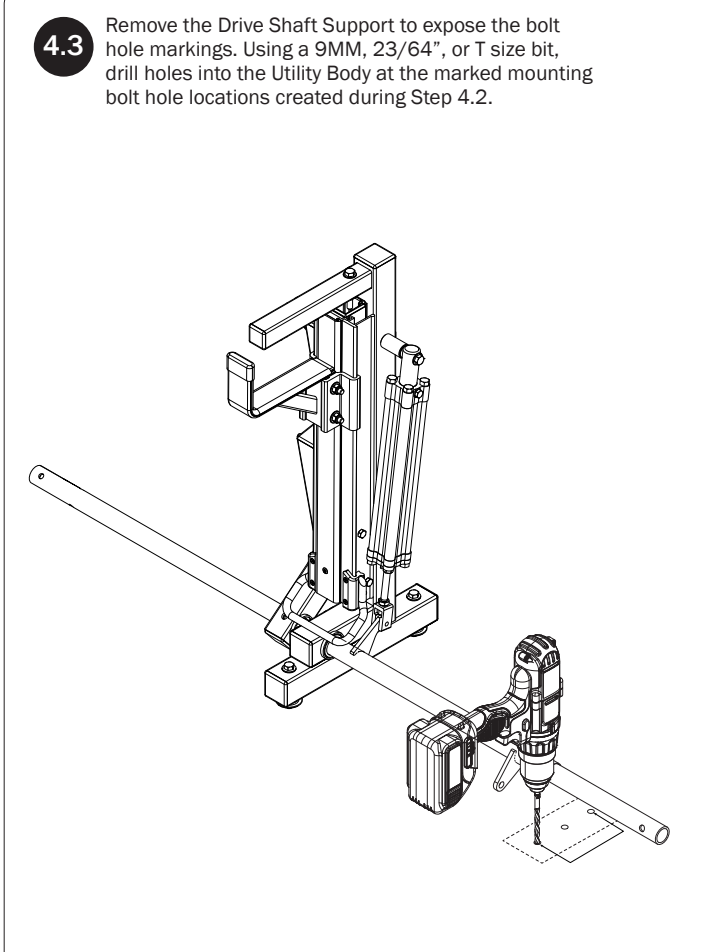
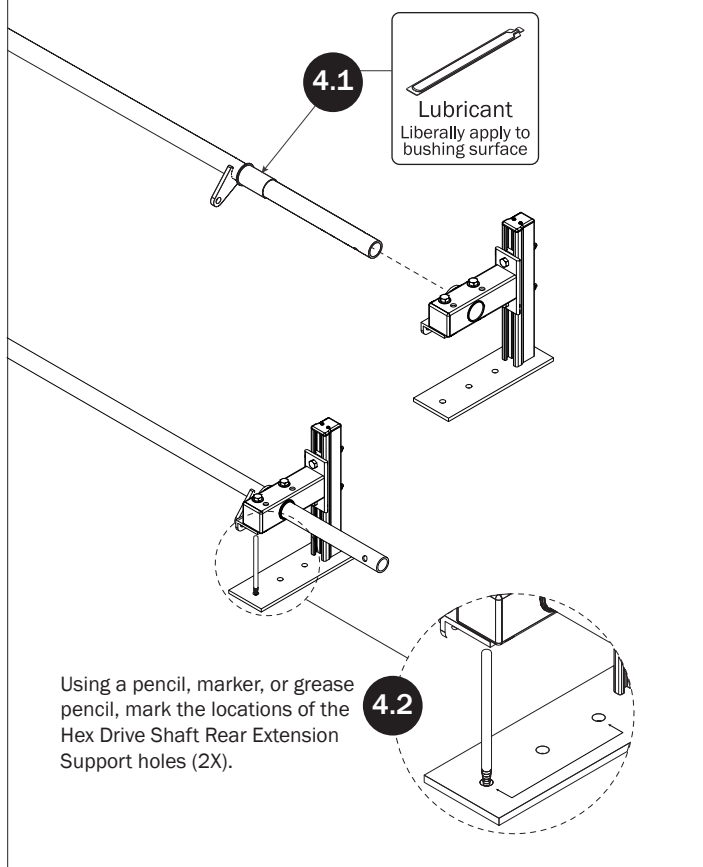

DRIVE SHAFT HEX STUD

5.1 Insert the Drive Shaft Hex Stud into the open end of the Drive Shaft Extension. Align the bolt holes, then install the 3/8" x 1.75" Hex Stud Bolt (1X), 3/8" Washer (2X), and 3/8" Lock Nut (1X) in the order shown.

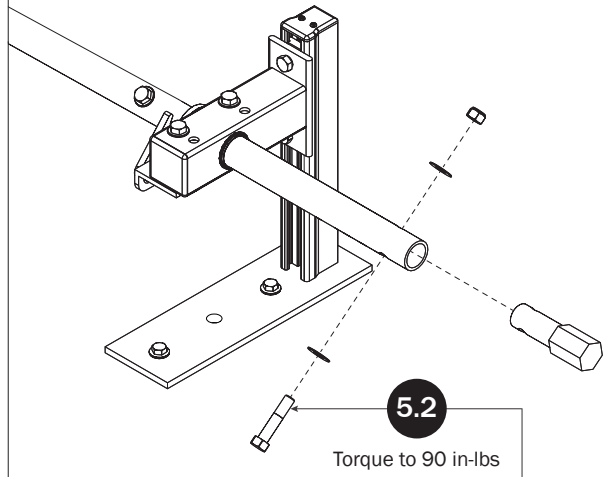

Anti-Seize
Must apply Anti-Seize Compound and torque to specified value.

3/8" Hardware
Tight fitting bolt. Use a ratchet and 3/16" socket to thread into Drive Shaft

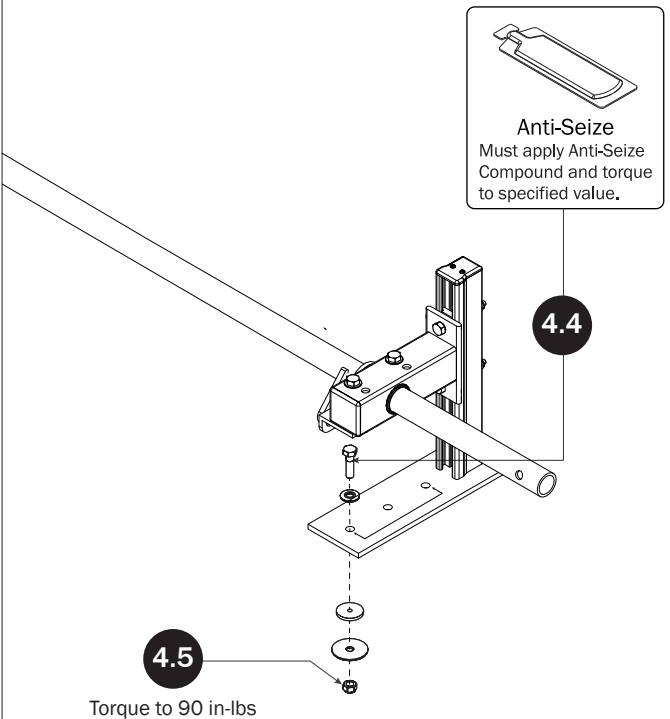

Anti-Seize
Must apply Anti-Seize Compound and torque to specified value.

4.5
Torque to 90 in-lbs

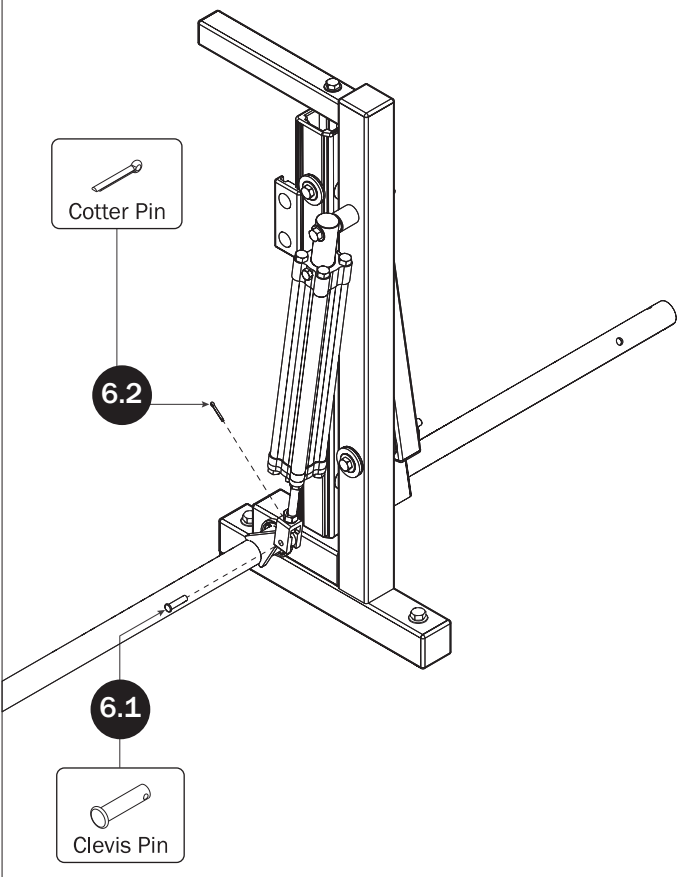

Cotter Pin

Clevis Pin

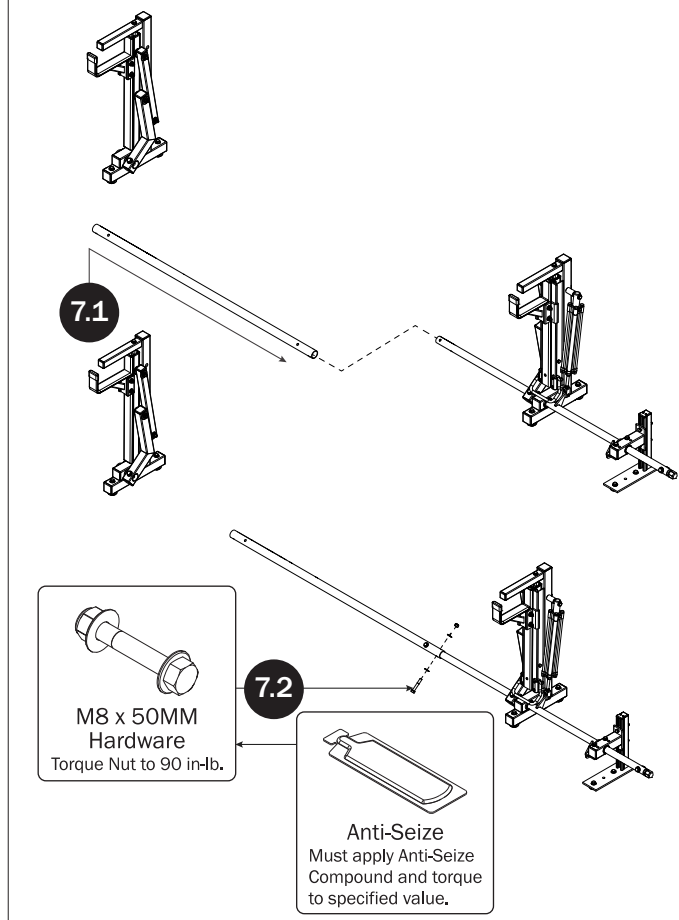

M8 x 50MM Hardware
Torque Nut to 90 in-lb.

Anti-Seize
Must apply Anti-Seize Compound and torque to specified value.

FRONT DRIVE SHAFT

8.1 Lubricant
Liberally apply to bushing surface

8.2

8.3

8.4 Torque to 90 in-lbs

3/8" Hardware
Tight fitting bolt. Use a ratchet and 3/16" socket to thread into Drive Shaft

Anti-Seize
Must apply Anti-Seize Compound and torque to specified value.

CONNECTING BAR FASTENERS

9

M8 x 50MM Hardware
Torque Nut to 90 in-lb.

Anti-Seize
Must apply Anti-Seize Compound and torque to specified value.

MOUNT BRACE INSTALLATION

10.1

Using a pencil, marker, or grease pencil, mark the location of the hole for installing the Mount Brace onto the Utility Rack. Repeat the procedure for installing the Mount Brace to the truck body.

10.2 Remove the Mount Brace to expose the bolt hole markings. Using a 9MM, 23/64", or T size bit, drill a hole into the Utility Rack at the marked bolt hole location created during Step 10.1.

10.3 Repeat Step 10.2 procedure using the indicated bit to drill a hole into the truck body.

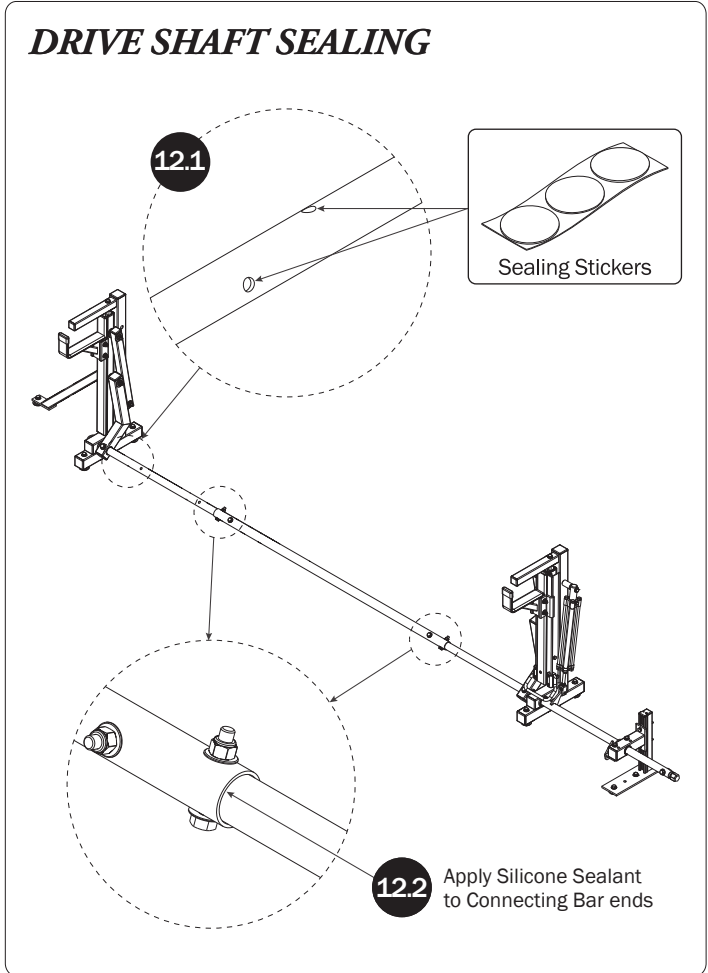
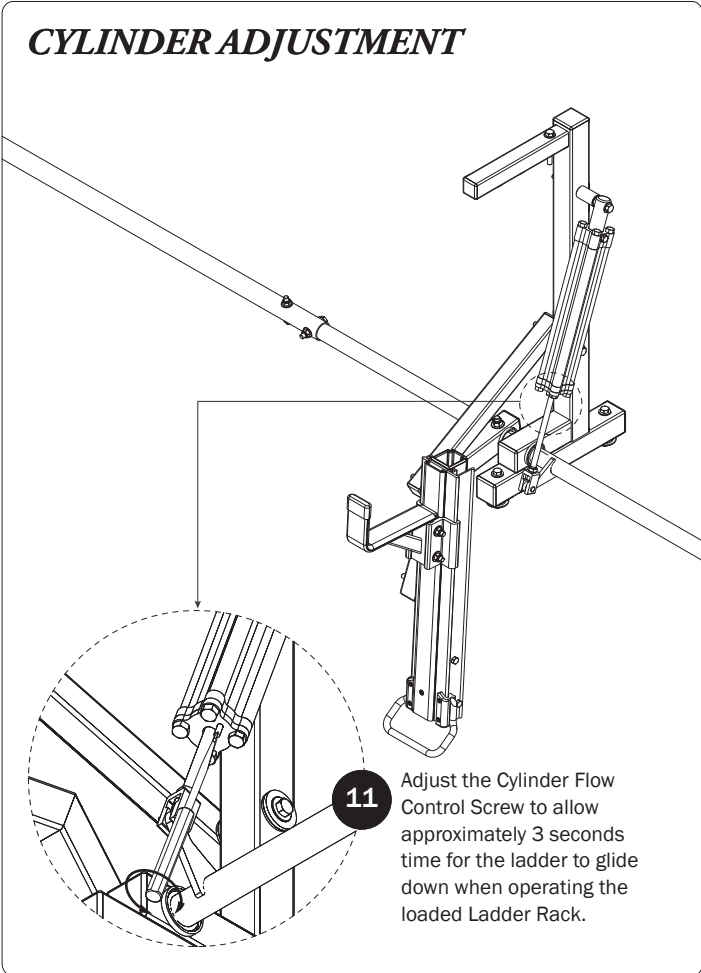
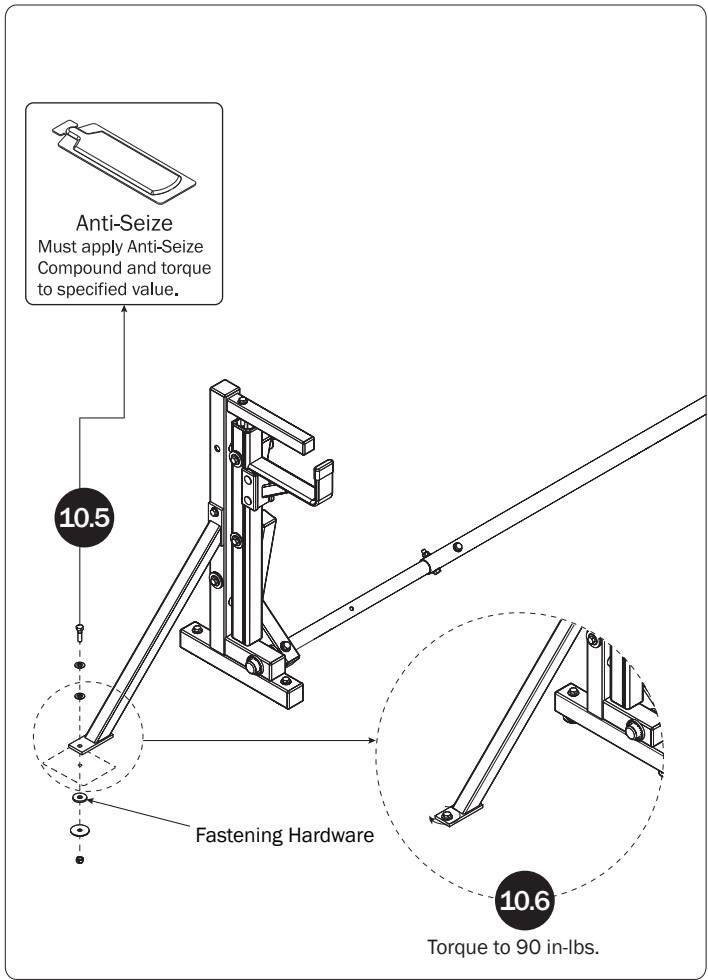
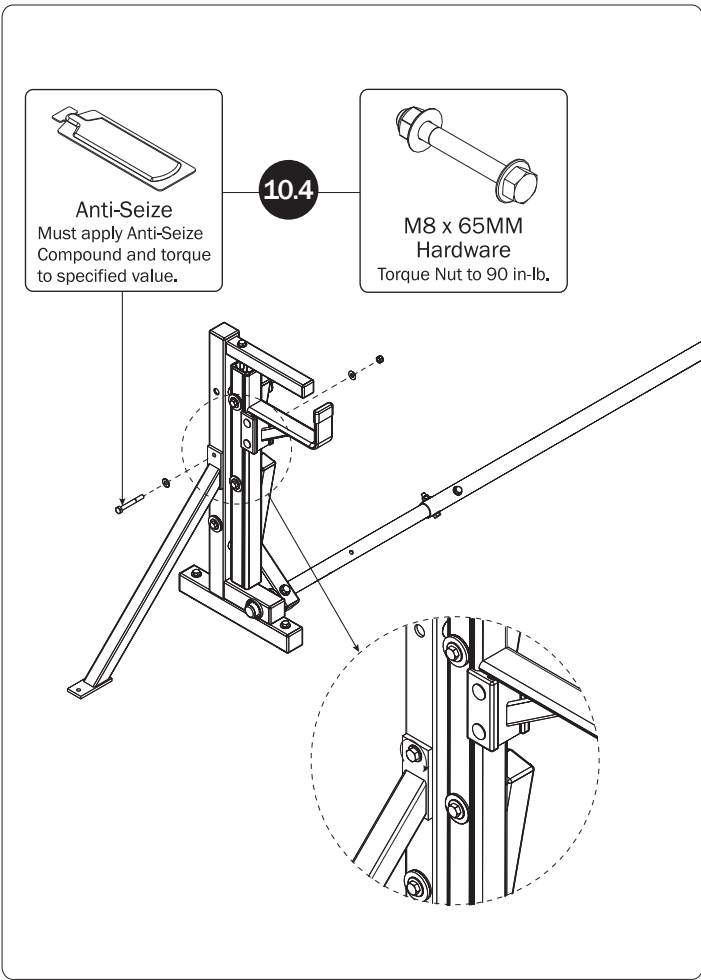

Page Intentionally Left Blank

Page Intentionally Left Blank

