

PRIME DESIGN™

A Safe Fleet Brand

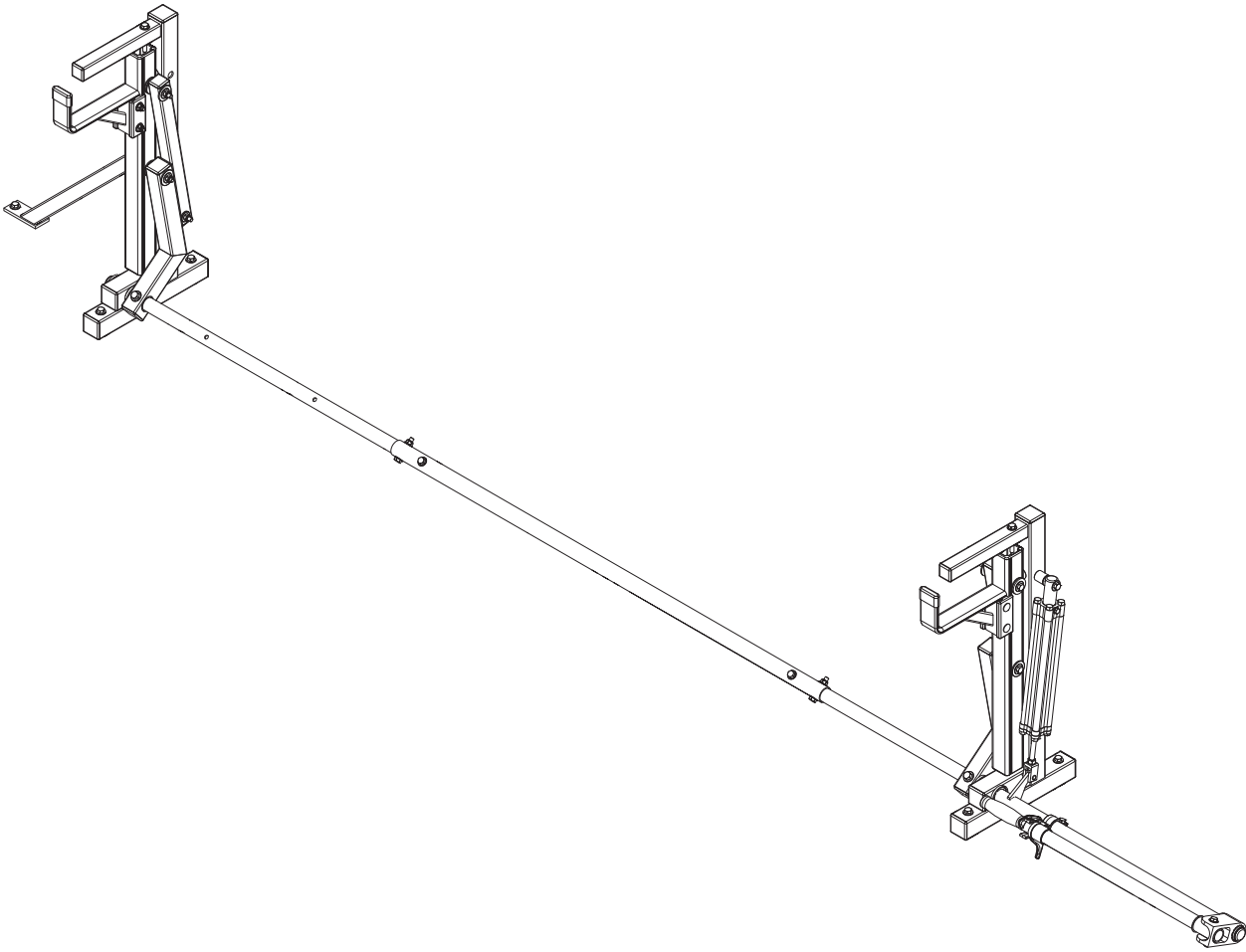

1020
UVX

PRIME DESIGN, A SAFE FLEET BRAND

Address: 580 Opperman Drive, Eagan, MN 55123 • Toll Free: 1.8.PRIME.RACK
Fax: 651-552-1799 • Email: info@primedesign.net • Website: www.primedesign.net

CONTENTS OVERVIEW

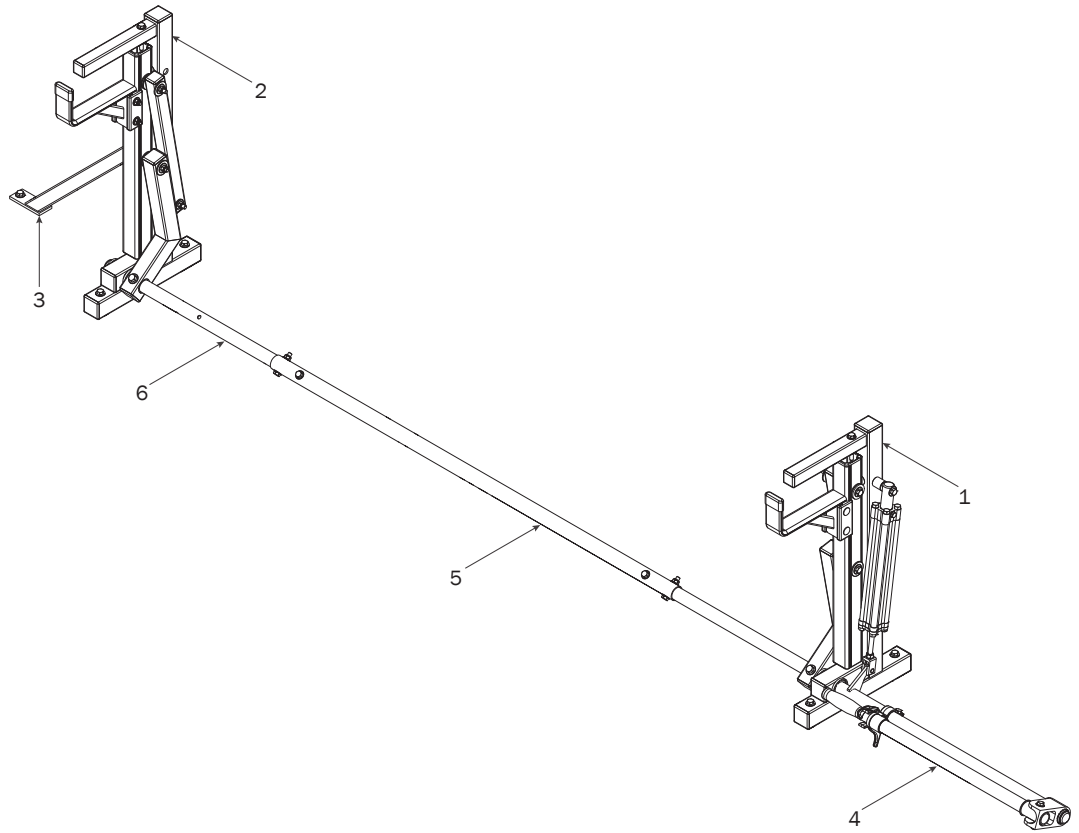

1—Rear Rotation Assembly..... (Qty 1)

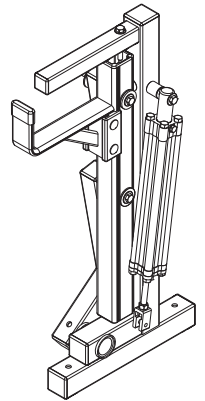

2—Front Rotation Assembly..... (Qty 1)

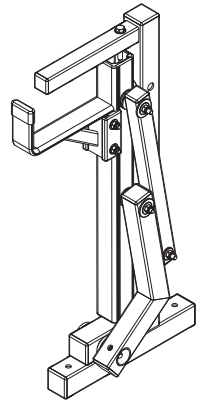

3—Mount Brace..... (Qty 1)
20.00”



4—Rear Drive Shaft..... (Qty 1)
Left Hand, 50.00”

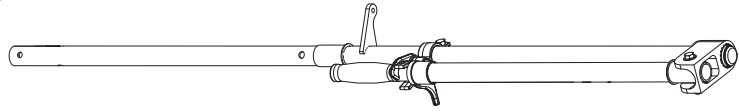

5—Connecting Bar..... (Qty 1)
48.00”



6—Front Drive Shaft..... (Qty 1)
B Version, 35.75”

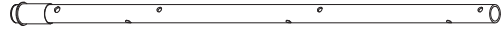

HKT-8163-Rotation Hardware Kit

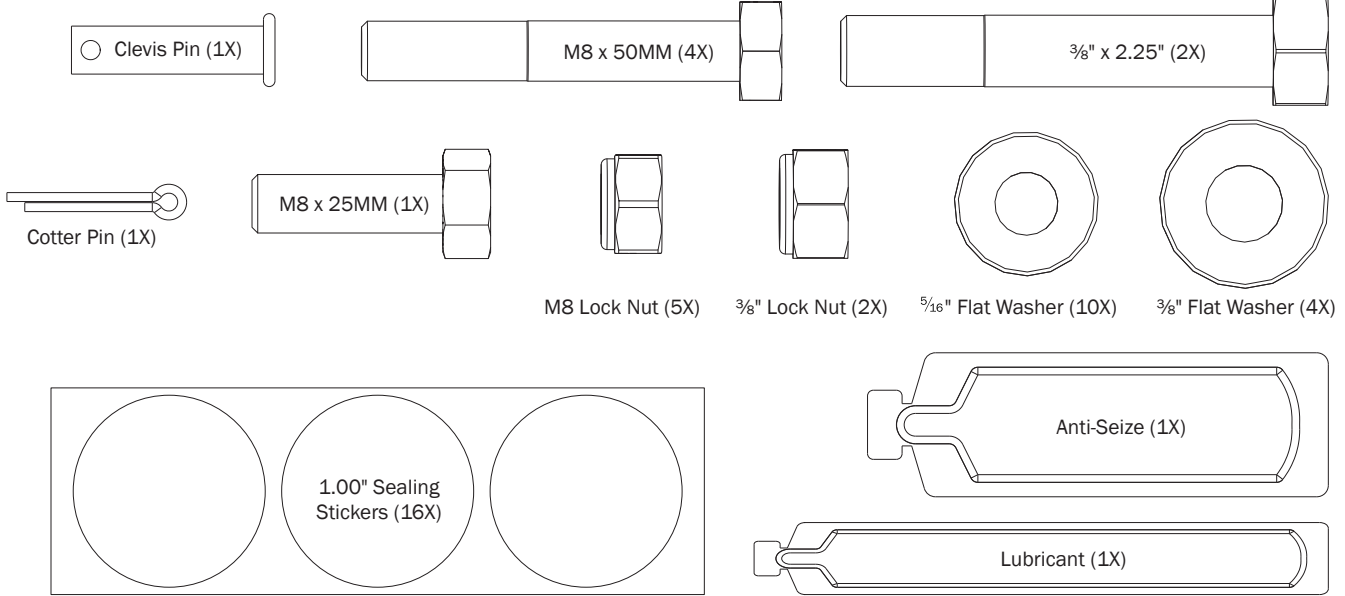

HKT-0055-Rotation Hardware Kit

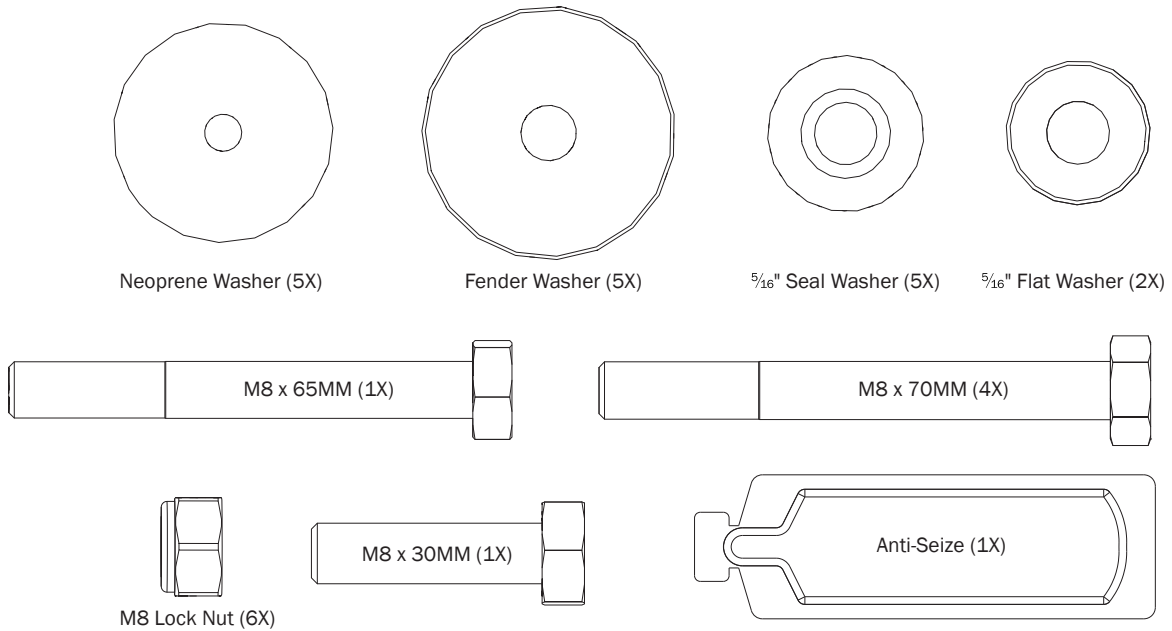

MOUNTING DIMENSIONS



Mounting to Service Body: dimensions are dependent upon Crossbar distances of 6'-8' plus allowance for the Mount Brace from the front of the Utility Rack.

Allow spacing for the Mount Brace, but do not drill or install until Step 9.

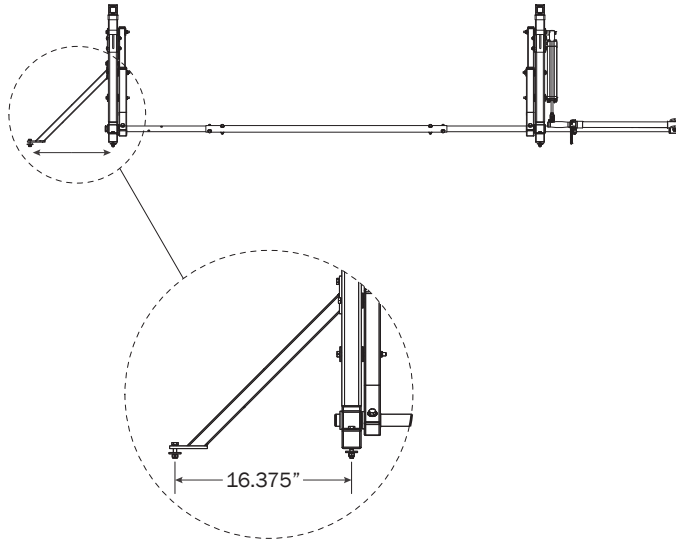

0.1 6.00 Ft: Drill holes into the Service Body mounting location according to dimensions shown.

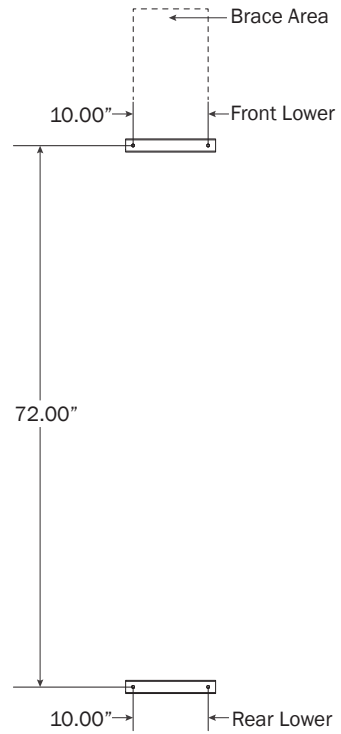

0.2 7.00 Ft: Drill holes into the Service Body mounting location according to dimensions shown.

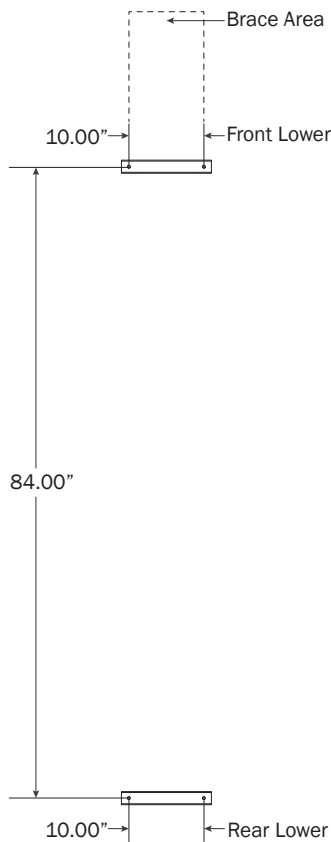

0.3 8.00 Ft: Drill holes into the Service Body mounting location according to dimensions shown.

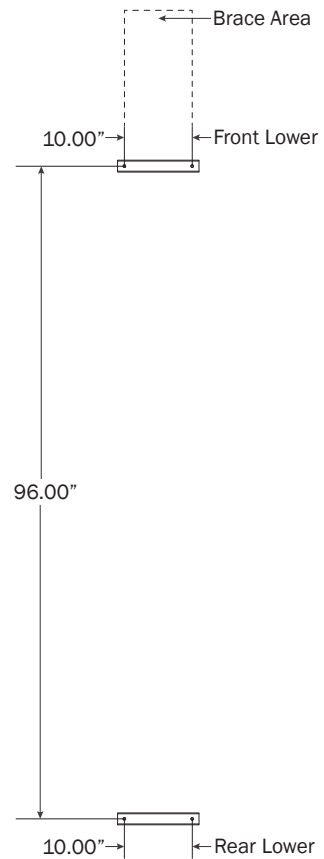

LEFT ROTATION ASSEMBLY SEQUENCE

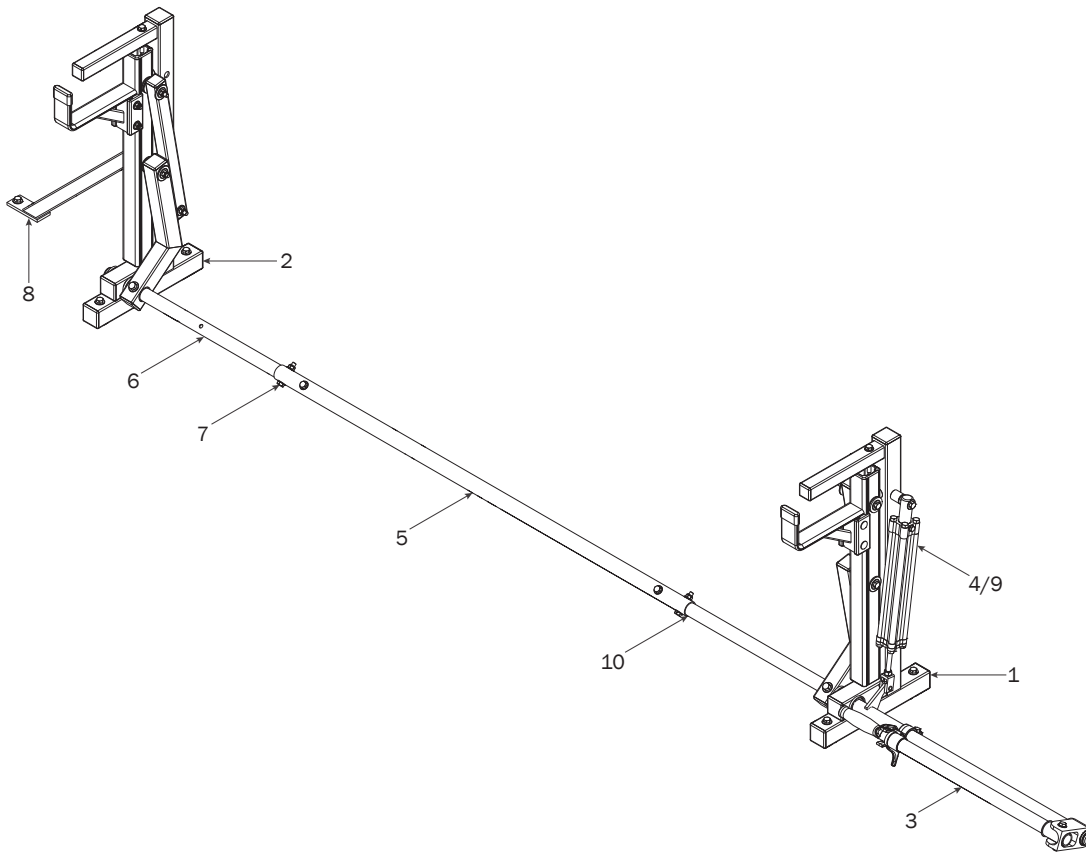

REAR ROTATION ASSEMBLY

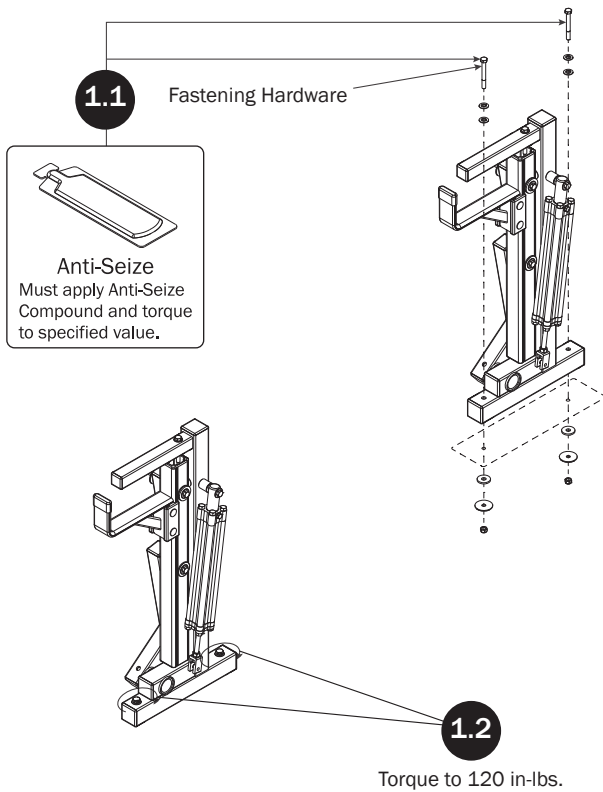

FRONT ROTATION ASSEMBLY

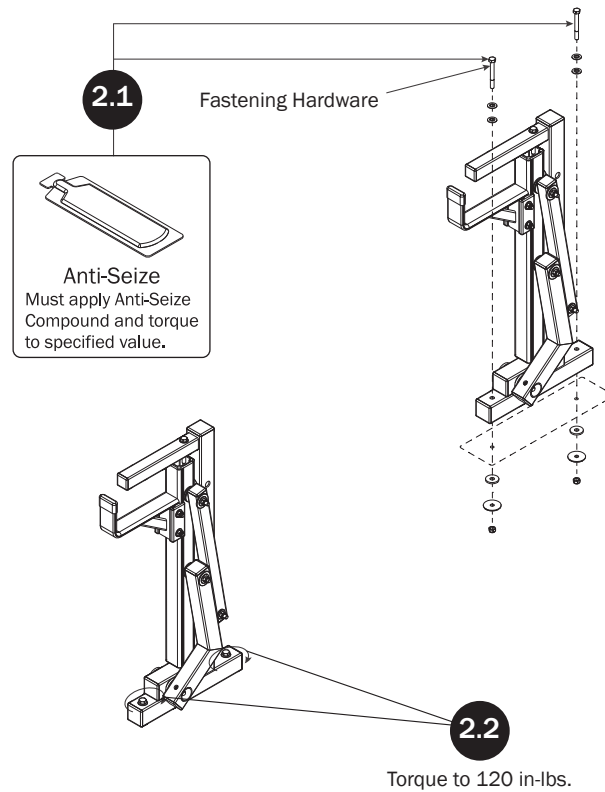

REAR DRIVE SHAFT

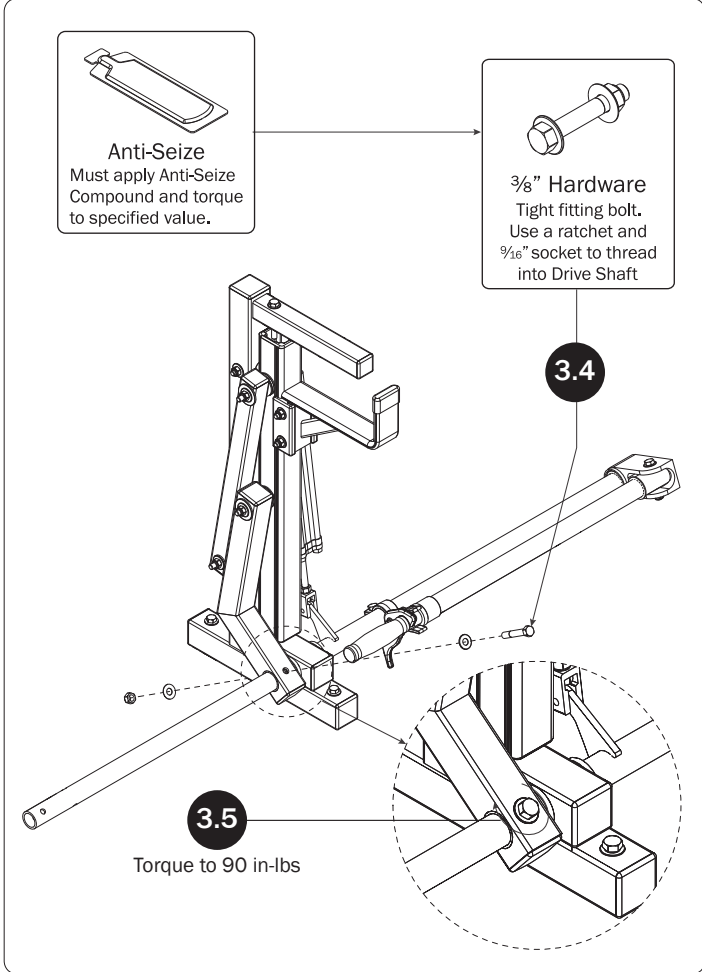
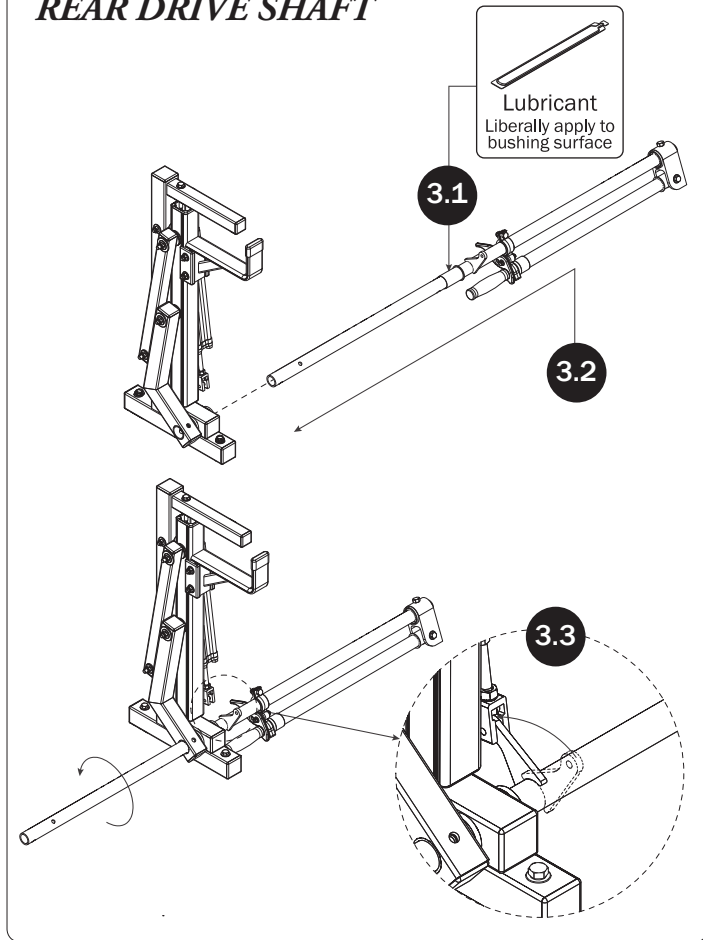

CYLINDER HARDWARE

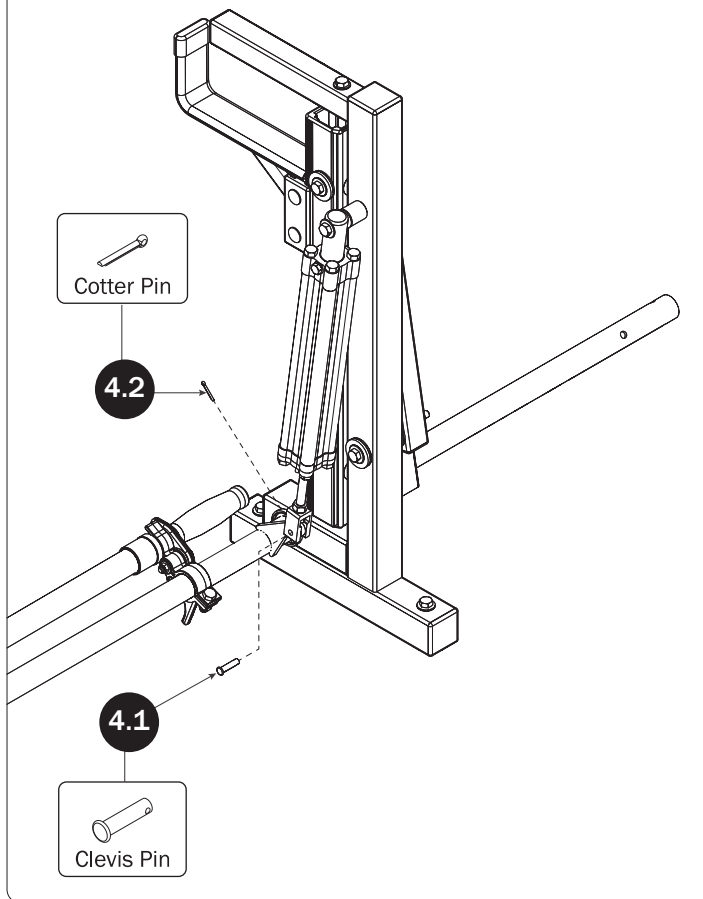

CONNECTING BAR

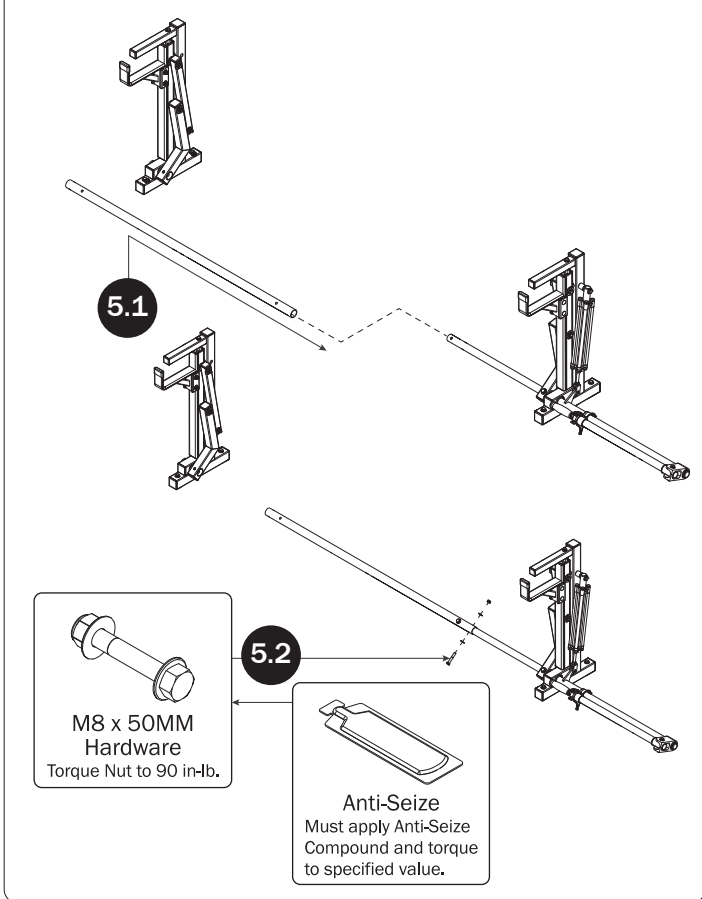

FRONT DRIVE SHAFT

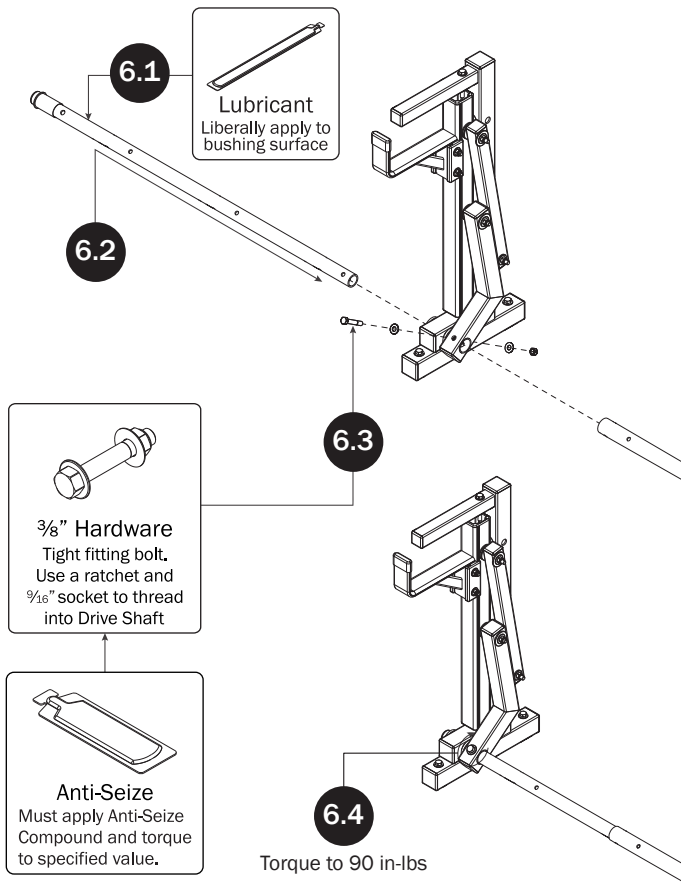

CONNECTING BAR FASTENERS

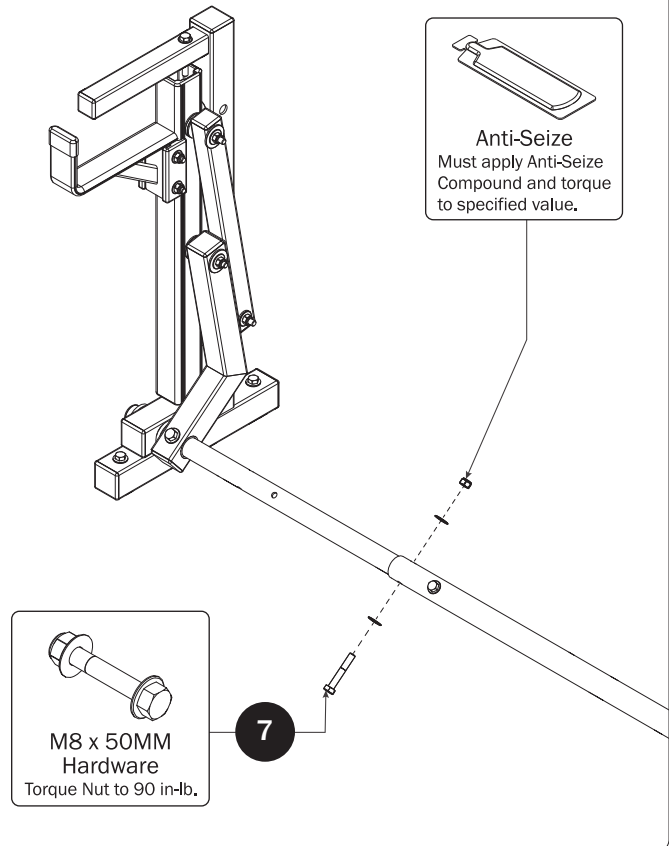

MOUNT BRACE INSTALLATION

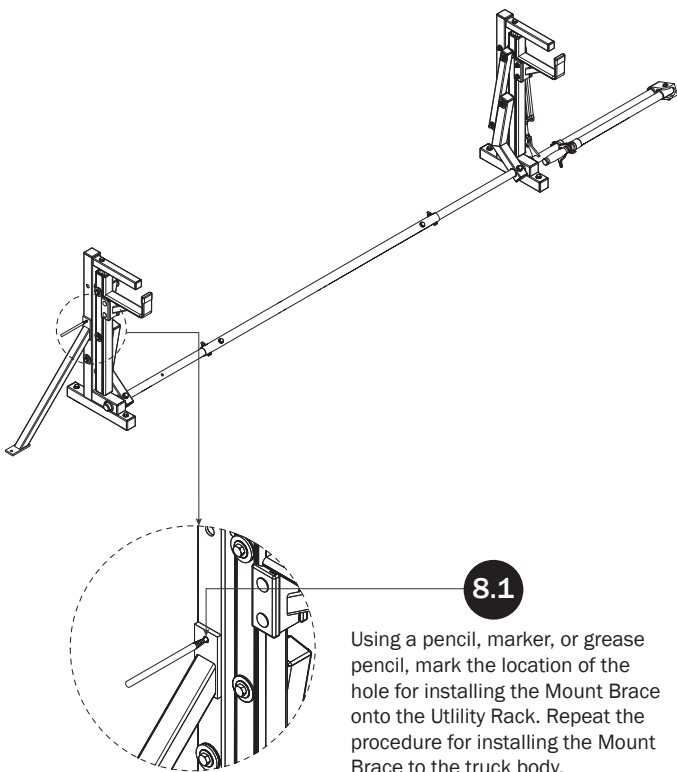

8.2 Remove the Mount Brace to expose the bolt hole markings. Using a 9MM, 23/64", or T size bit, drill a hole into the Utility Rack at the marked bolt hole location created during Step 8.1.

