

# PRIME DESIGN™

A Safe Fleet Brand

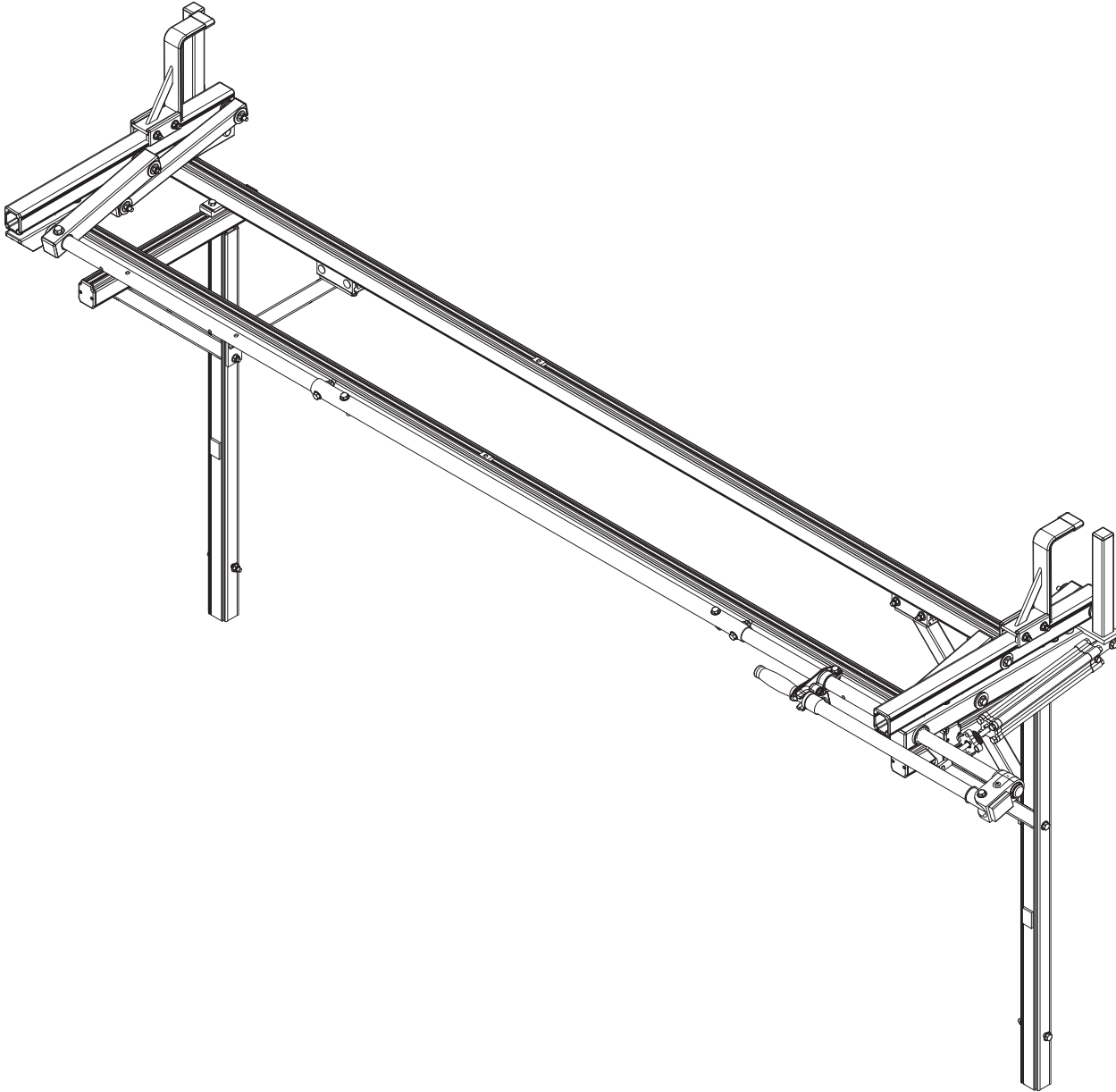

URX0017

PRIME DESIGN, A SAFE FLEET BRAND

Address: 580 Opperman Drive, Eagan, MN 55123 • Toll Free: 1.8.PRIME.RACK

Fax: 651-552-1799 • Email: [info@primedesign.net](mailto:info@primedesign.net) • Website: [www.primedesign.net](http://www.primedesign.net)

CONTENTS OVERVIEW

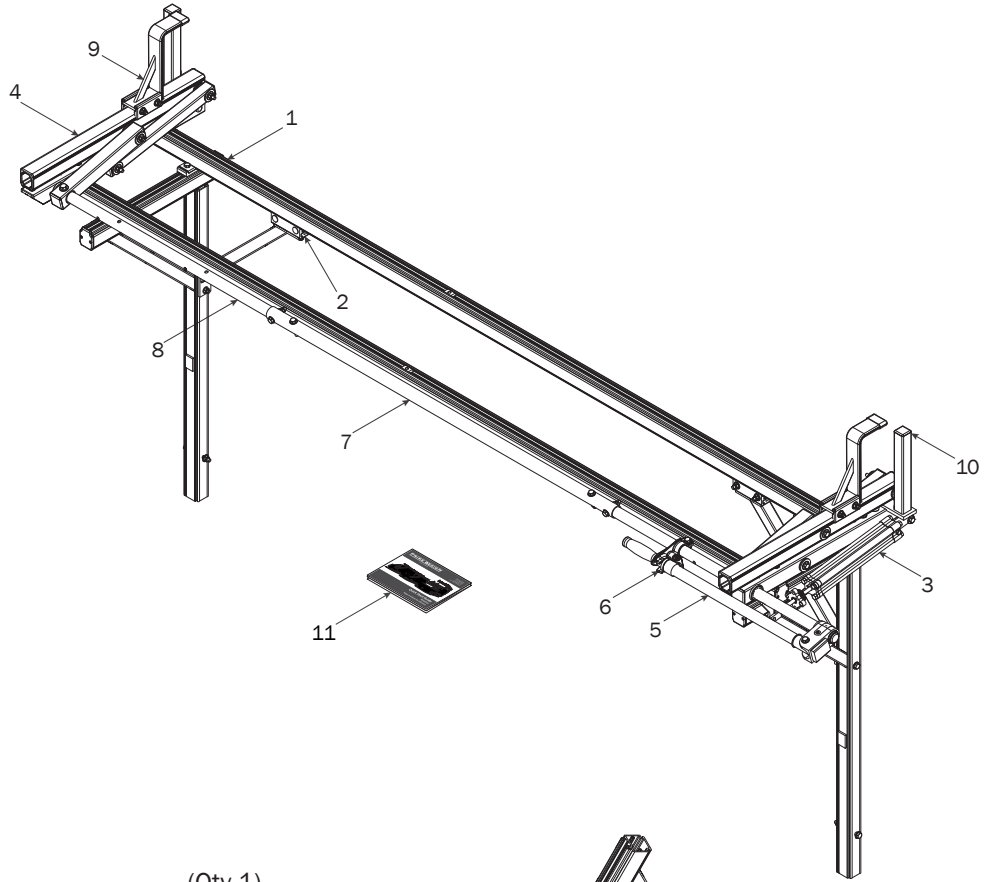

1—Side Wall Mounting System..... (Qty 1)  
98.00", Suspension Bar Frame, with Hardware

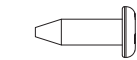
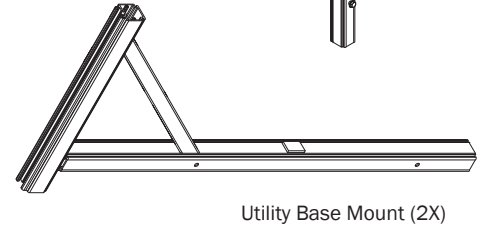
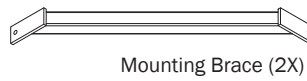

End Cap Screw (16X)



End Cap (8X)



Channel Connector (4X)

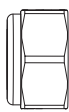

Lock Nut (4X)

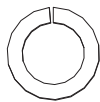

Lock Washer (4X)

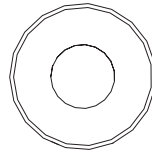

Flat Washer (16X)

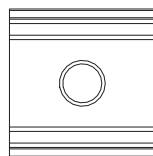
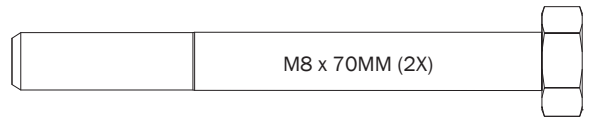

M8 Nut Bracket (4X)



2—WorkPro Light Mount ..... (Qty 2)  
Below Crossbar with Hardware



Bottom Connector (1X)



Clamp Connector Pair (1X)

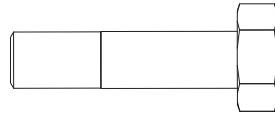

M8 x 25 MM (1X)

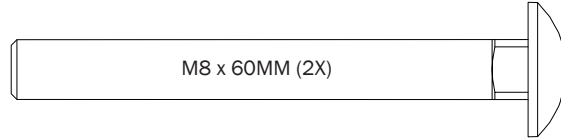

M8 x 60MM (2X)

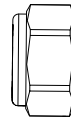

M8 Lock Nut (3X)

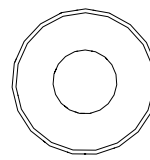

5/16" Flat Washer (3X)

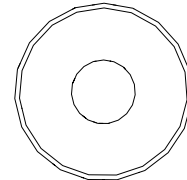

Nylon Washer (1X)

3—Rear Rotation Assembly..... (Qty 1)

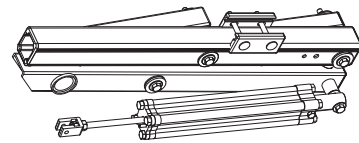

4—Front Rotation Assembly..... (Qty 1)

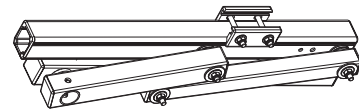

5—Rear Drive Shaft..... (Qty 1)  
Left Hand, B4 Version, 34.00"

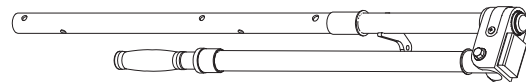

6—Handle Latch ..... (Qty 1)  
Right Hand



7—Connecting Bar..... (Qty 1)  
48.00"



8—Front Drive Shaft..... (Qty 1)  
B Version, 35.75"



9—Z Post ..... (Qty 1)  
Adjustable, 7.25"

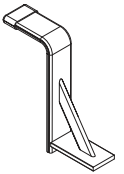

10—L Post ..... (Qty 1)  
9.25"

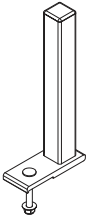

11—USQSG-Ergorack ..... (Qty 1)  
Quick Start Guide, Rotation

\* Once rack installation is complete, place the Quick Start Guide into the vehicle's glove box for future ladder setup and adjustment.

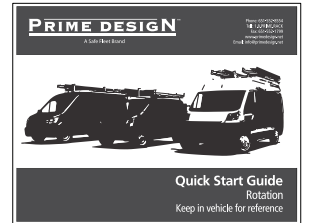

12—HKT-8163 (Not called out in Overview)..... (Qty 1)



M8 x 25MM (1X)

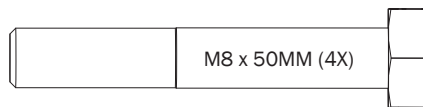

M8 x 50MM (4X)

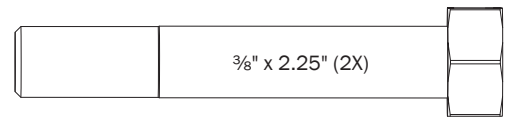

3/8" x 2.25" (2X)



Cotter Pin (1X)

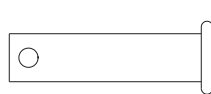

Clevis Pin (1X)

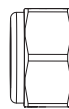

M8 Lock Nut (5X)



3/8" Lock Nut (2X)

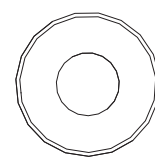

5/16" Flat Washer (10X)

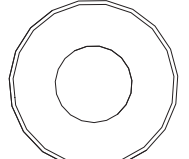

3/8" Flat Washer (4X)

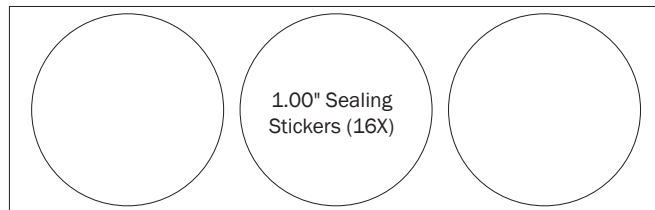

1.00" Sealing Stickers (16X)



Anti-Seize (1X)

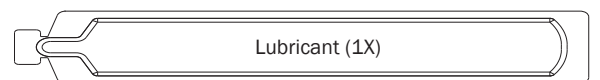

Lubricant (1X)

## FBM MOUNTING—OVERVIEW

The FBM is mounted into factory-installed mounting sleeves on the inside of the Utility Truck bed.

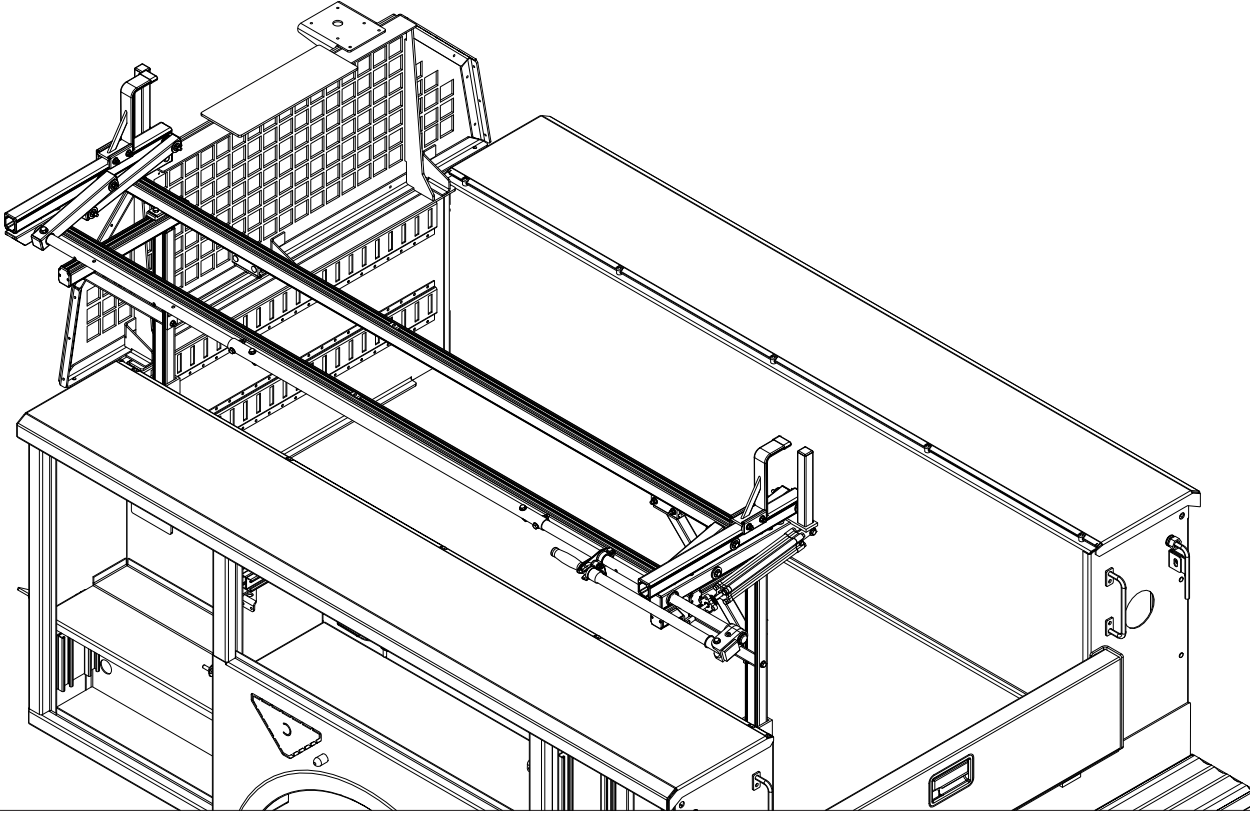

**0.1** Install Mounts onto Utility Body and as shown.

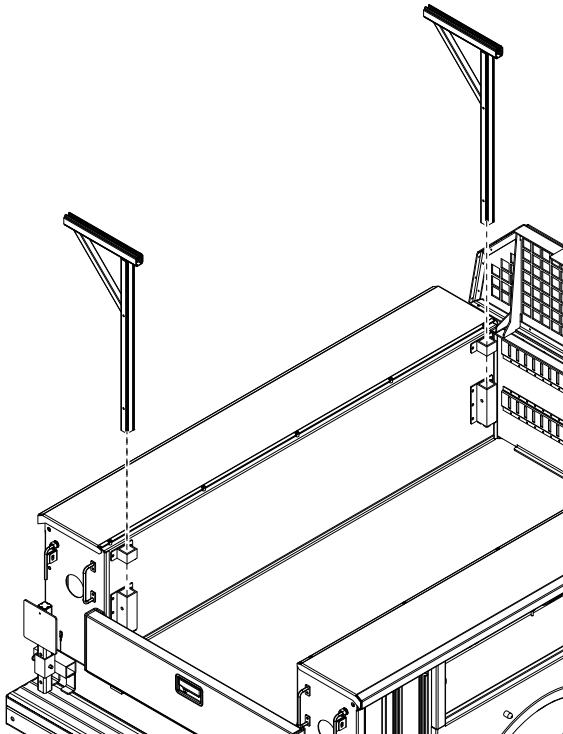

**0.2** Install mounting Hardware as shown and torque to 90 in-lbs.

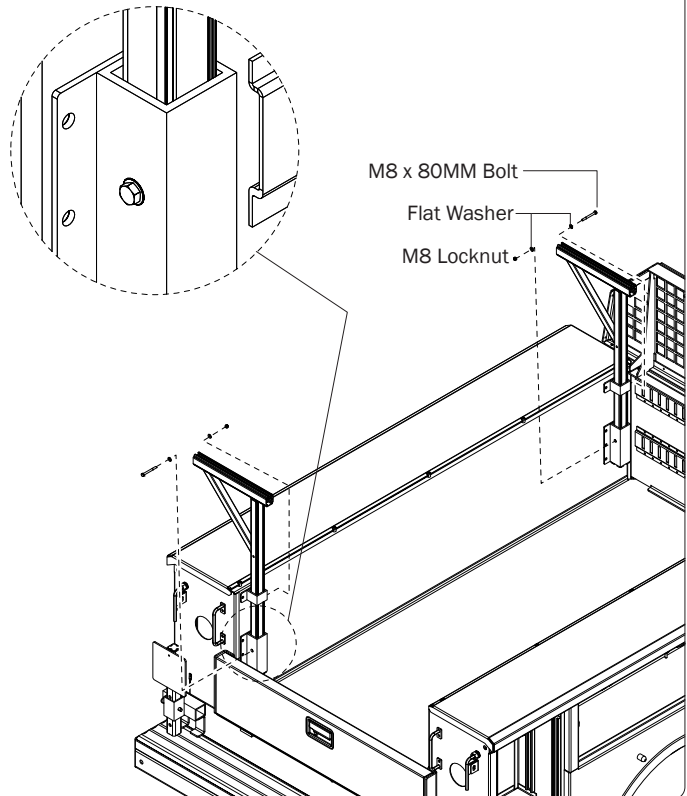

**NOTE:** For instructional clarity, the Utility Truck Body will not be shown for the remainder of this Assembly Manual.

- 0.3** If not already installed: install Channel Connectors and End Caps as shown.

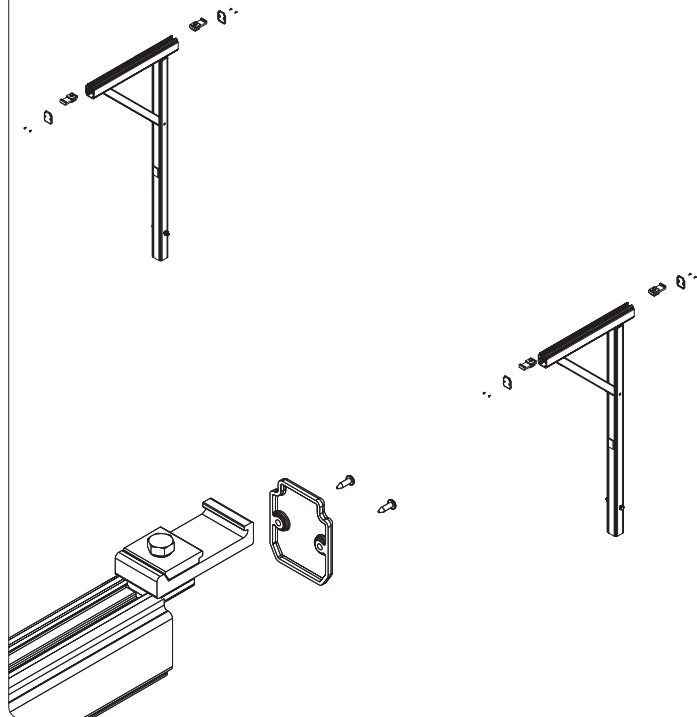

- 0.4** Mount the 98.00" Suspension Bars, and finger tighten into position as shown. Do not torque until Step 2.

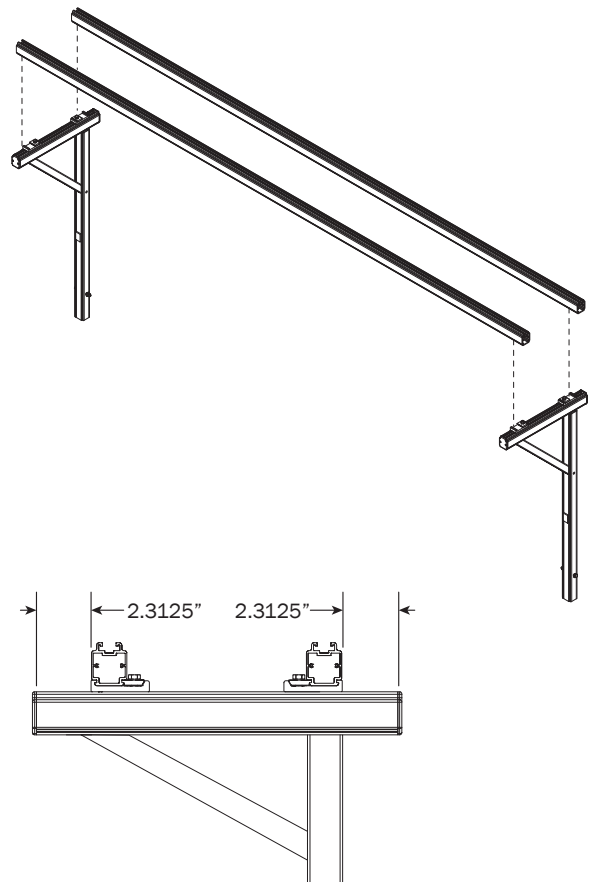

- 0.5** Assemble the WorkPro Clamp onto the Mounting Brace as shown and finger-tighten only.

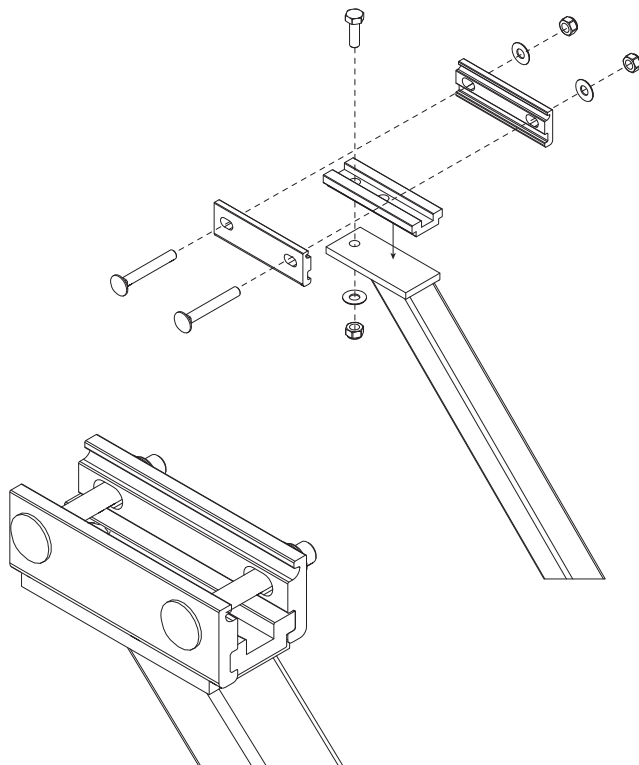

- 0.6** Mount the Brace as shown below and tighten clamp nuts to 90 in-lbs. Repeat Steps 0.5–0.6 for the front end.

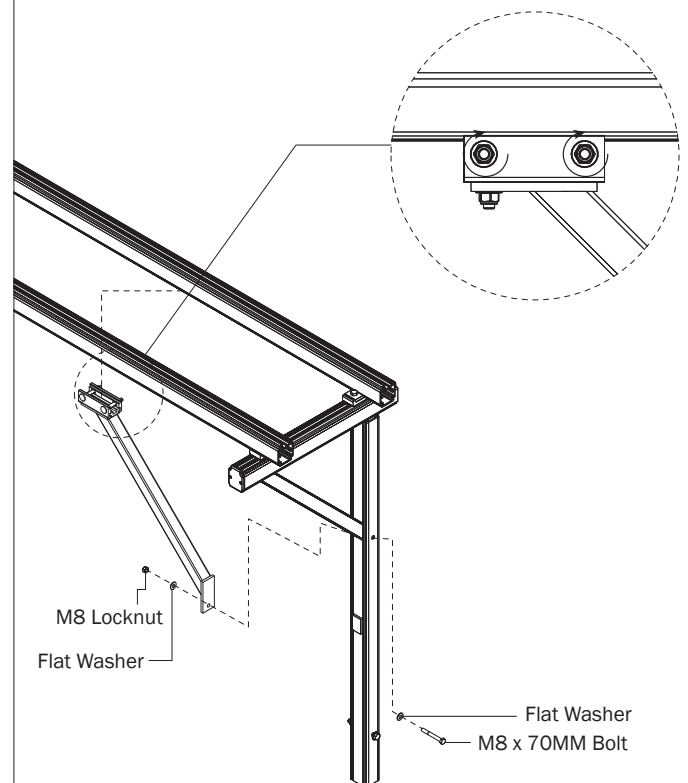

0.7

If not already installed: install Nut Brackets and End Caps as shown.

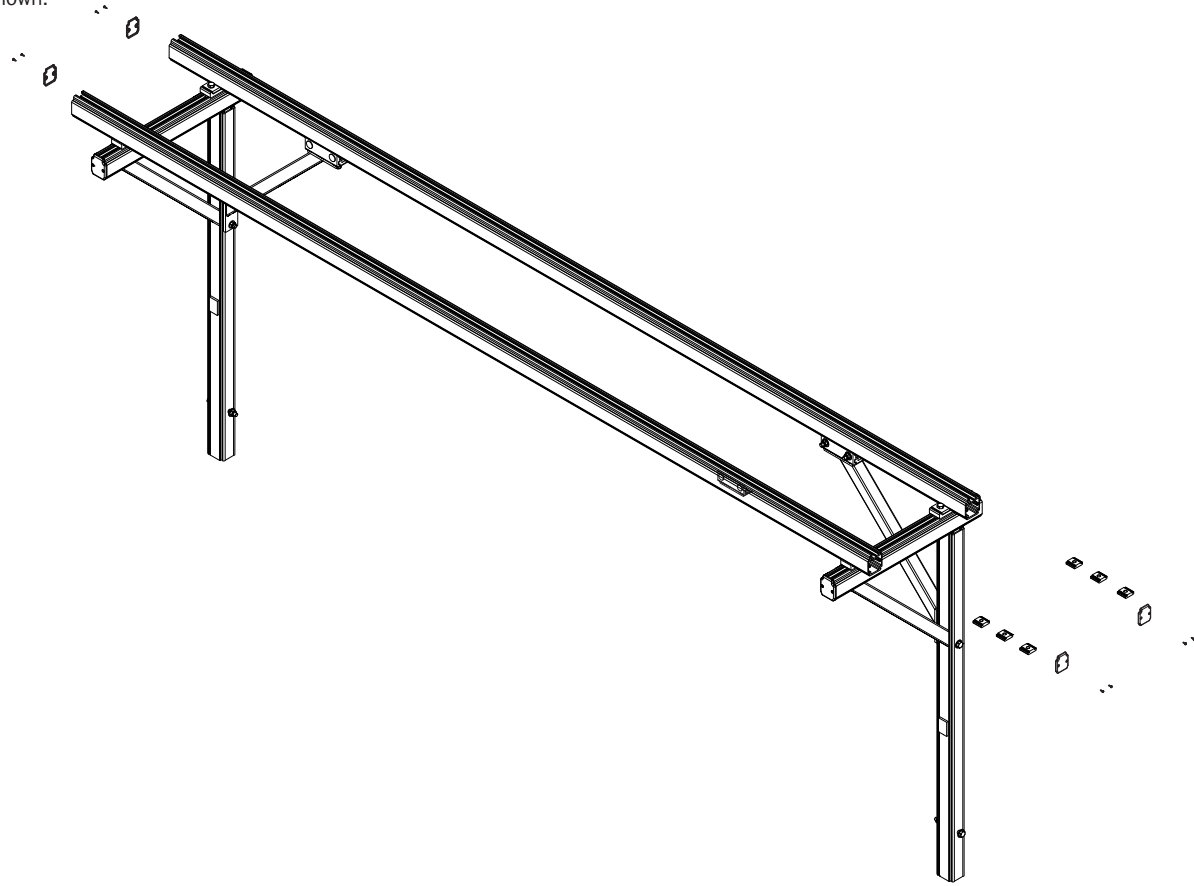

IMPORTANT FOR CROSSBAR PLACEMENT: The end of the driveshaft must not extend beyond the vehicle bumper.

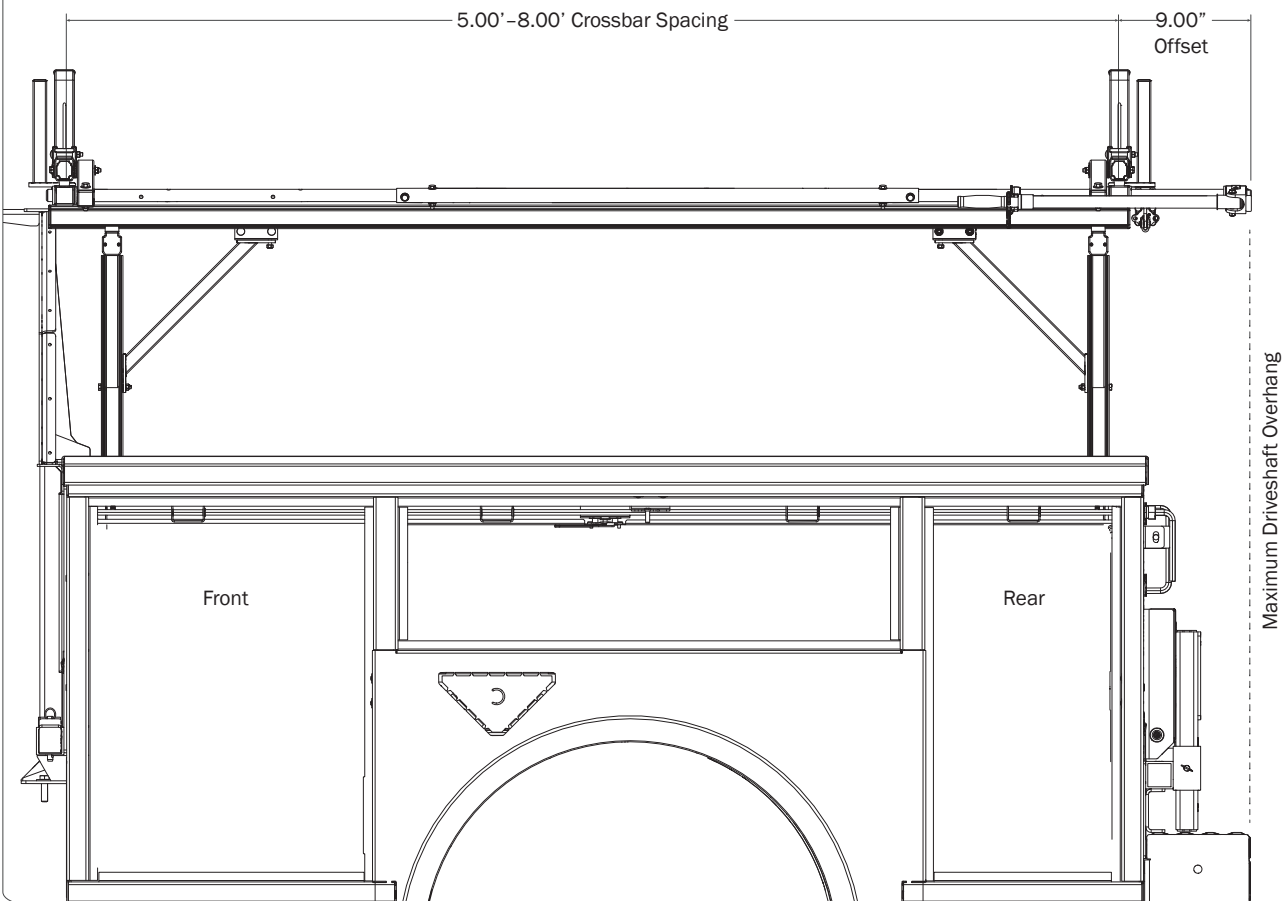

## RIGHT ROTATION ASSEMBLY SEQUENCE

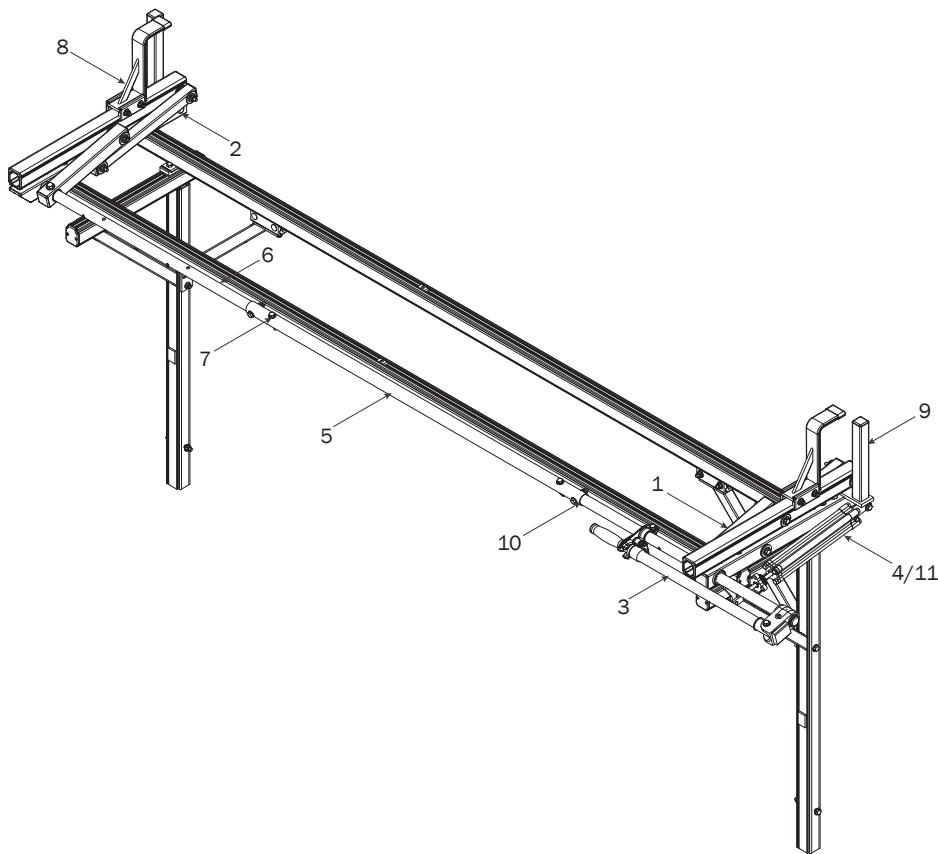

### REAR ROTATION ASSEMBLY

- 1 Place Rear Crossbar onto FBM as shown, apply Anti-Seize, and torque to 90 in-lbs.

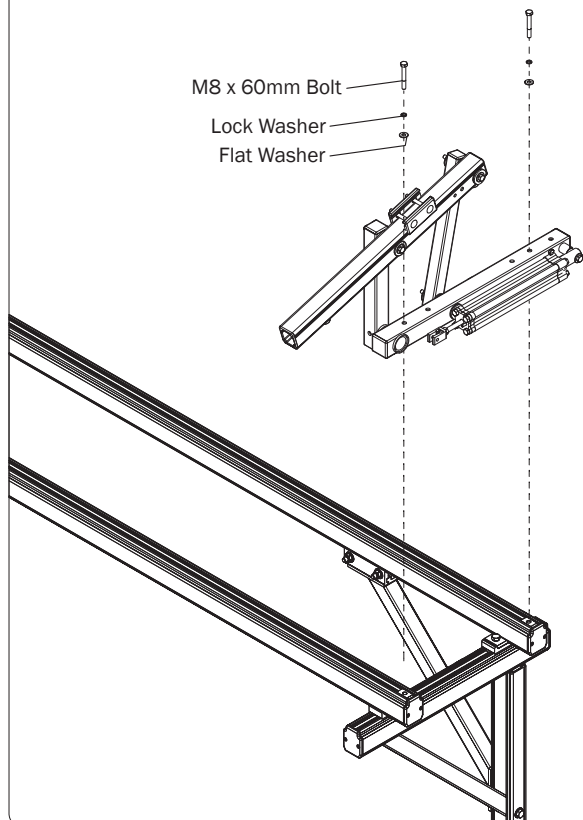

### FRONT ROTATION ASSEMBLY

- 2 Place Front Crossbar onto FBM as shown apply Anti-Seize, and torque to 90 in-lbs.

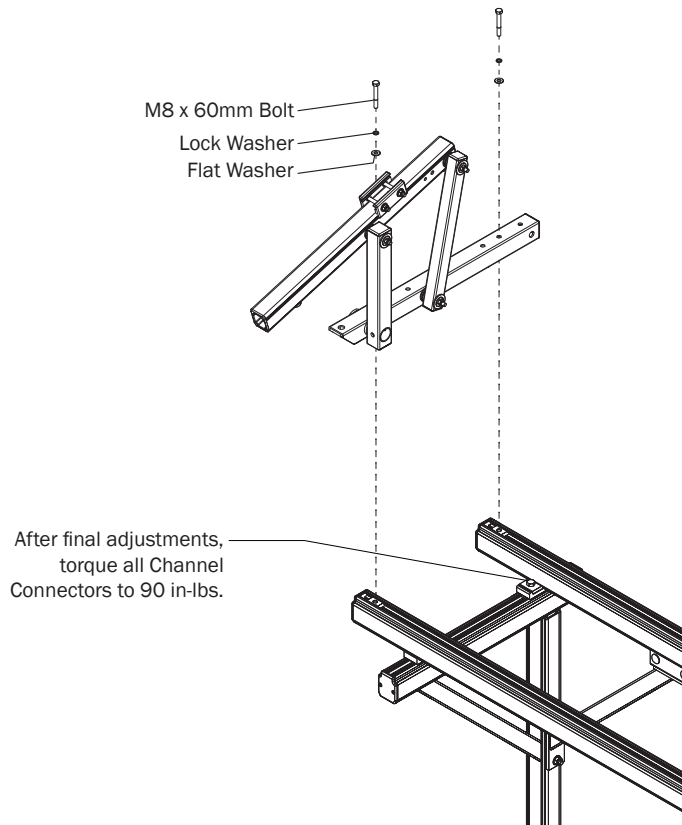



## REAR DRIVE SHAFT

NOTE: For instructional clarity, the FBM Mounting System will not be shown for the remainder of this Assembly Manual.

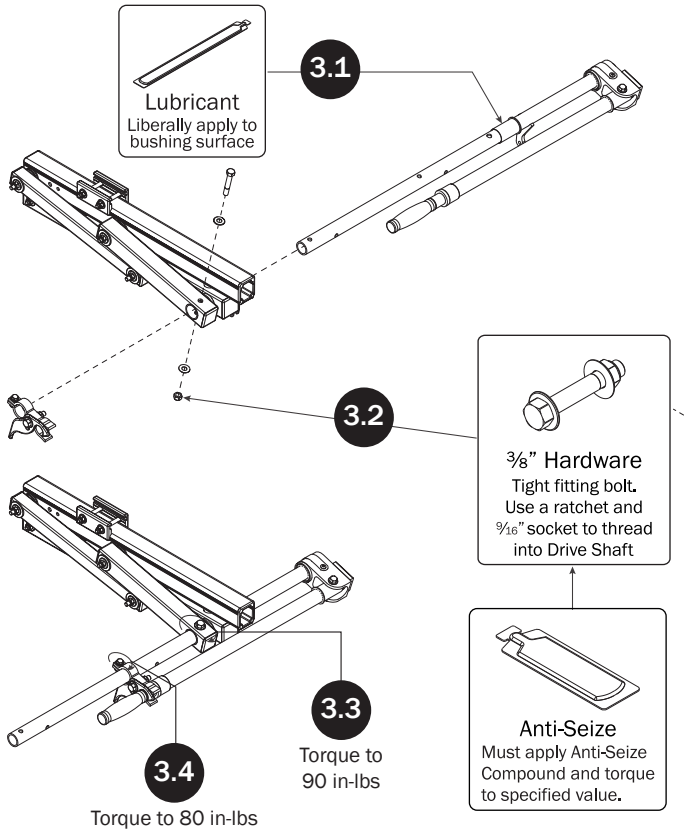

## CYLINDER HARDWARE

NOTE: Loosen the Cylinder Flow Control Screw (Fig. B) as needed to allow movement for this step sequence.

When finished with Cylinder Hardware, tighten the Flow control Screw all the way closed then turn back open  $1\frac{1}{2}$  turn.

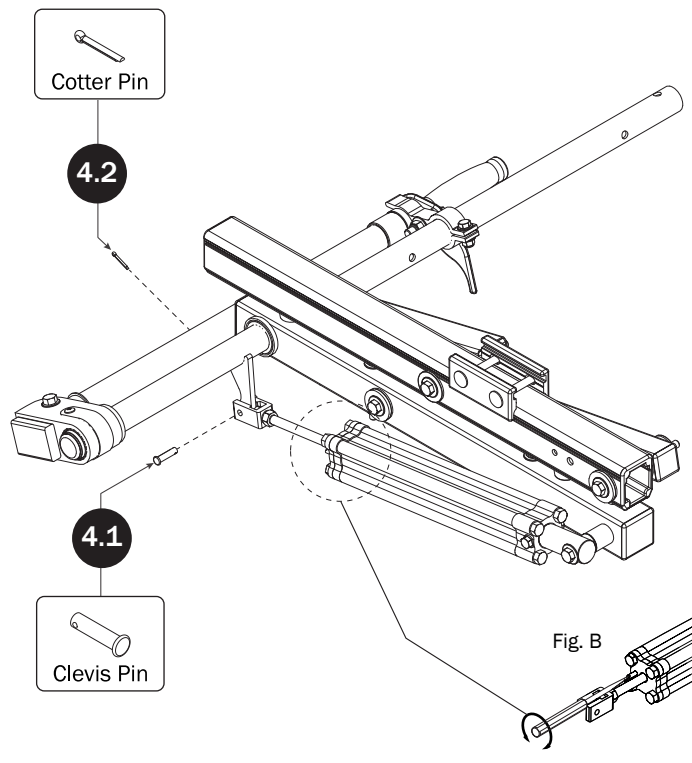

## CONNECTING BAR

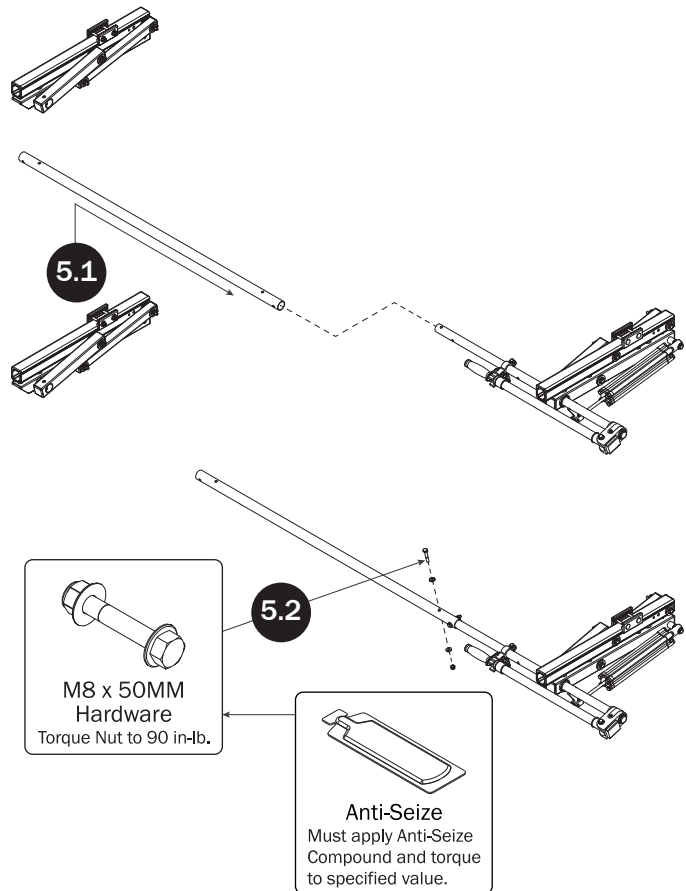

## FRONT DRIVE SHAFT

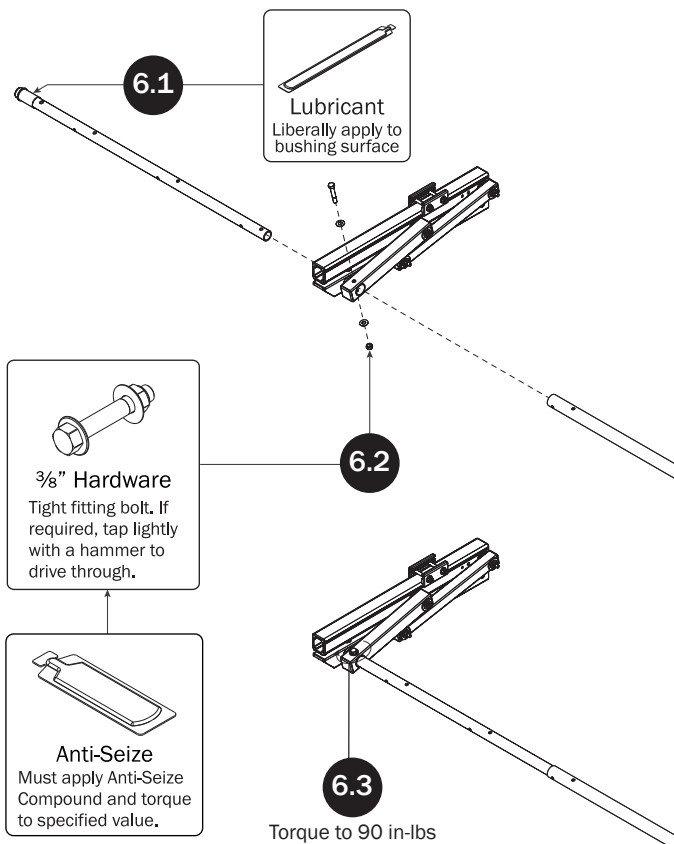

**CONNECTING BAR FASTENERS**

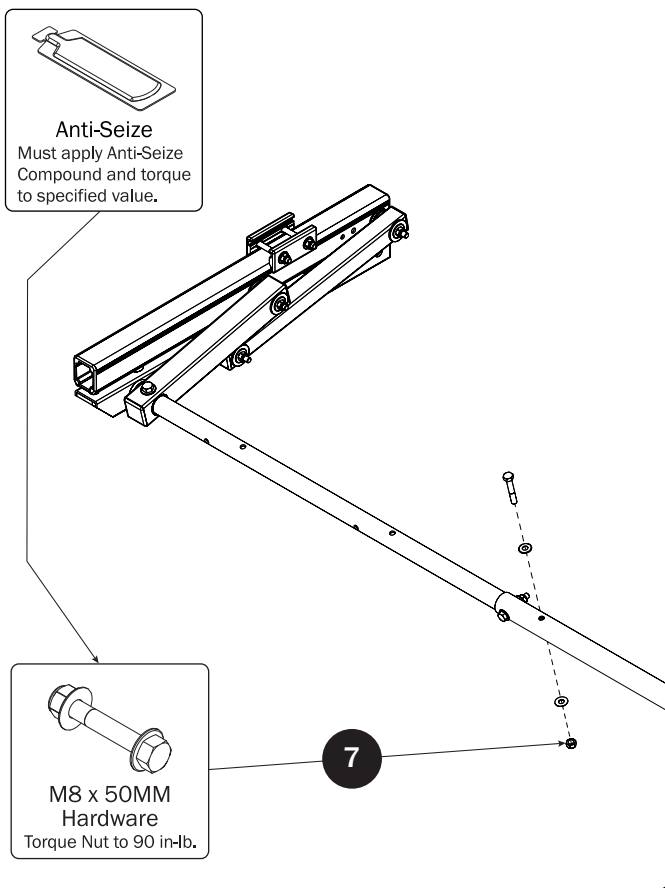

**L POSTS**

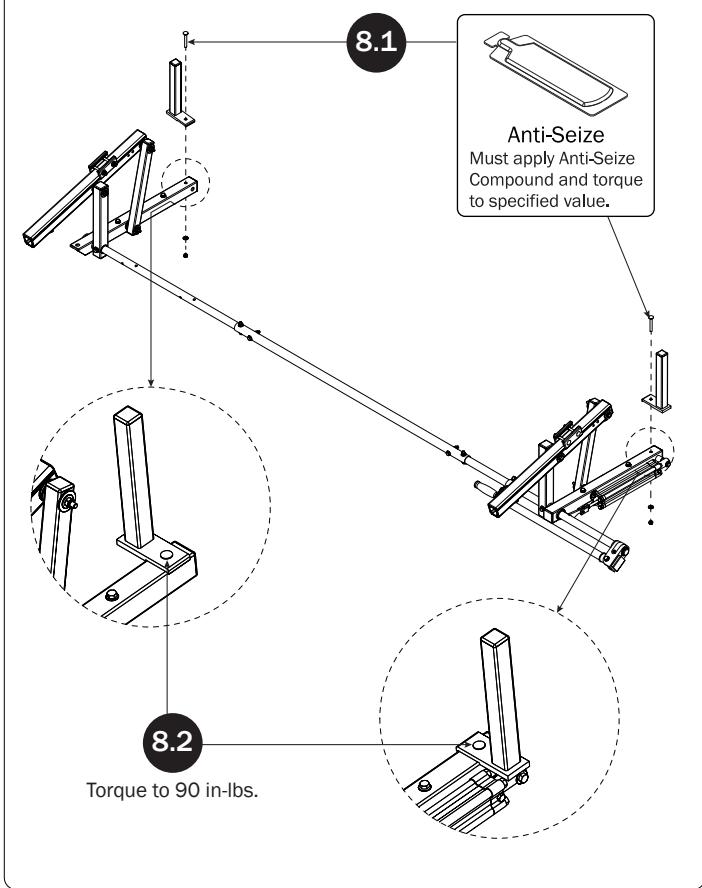

**Z POSTS**

SEE QUICK START GUIDE FOR ADJUSTMENTS

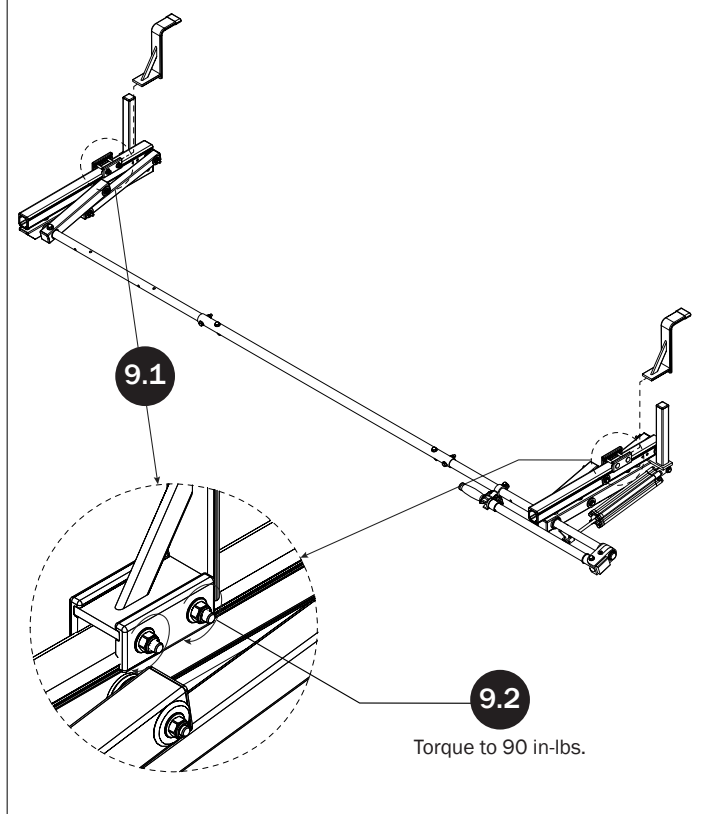

**DRIVE SHAFT SEALING**

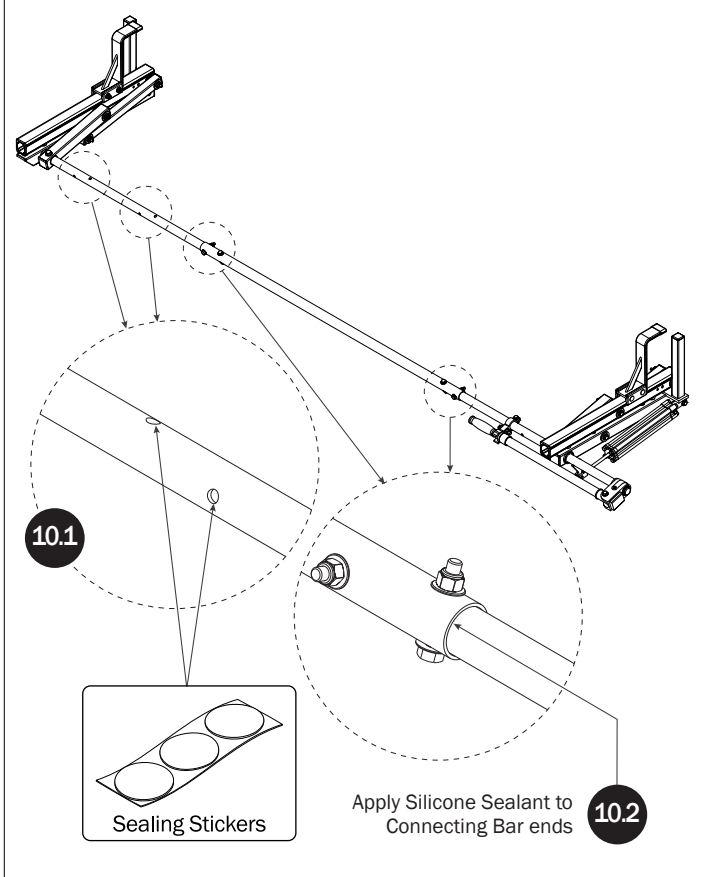

## CYLINDER ADJUSTMENT

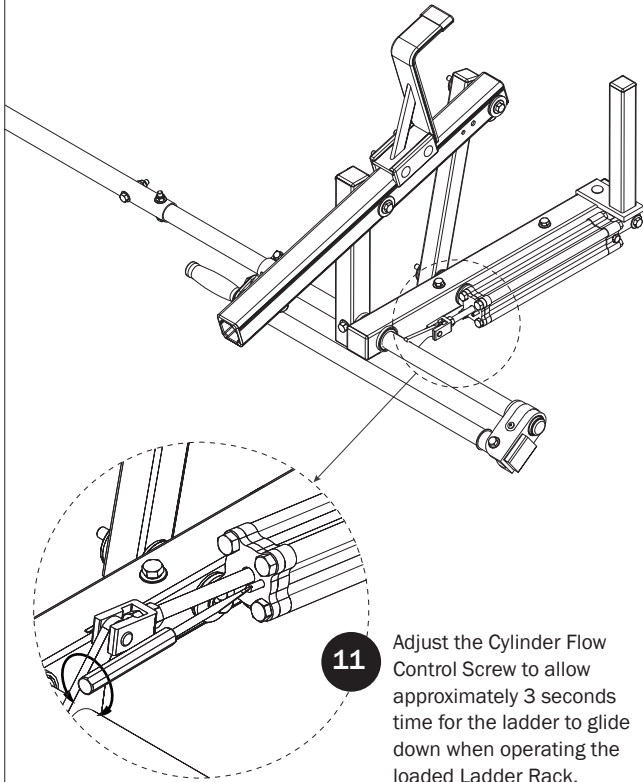

**11** Adjust the Cylinder Flow Control Screw to allow approximately 3 seconds time for the ladder to glide down when operating the loaded Ladder Rack.

