

PRIME DESIGN™

A Safe Fleet Brand

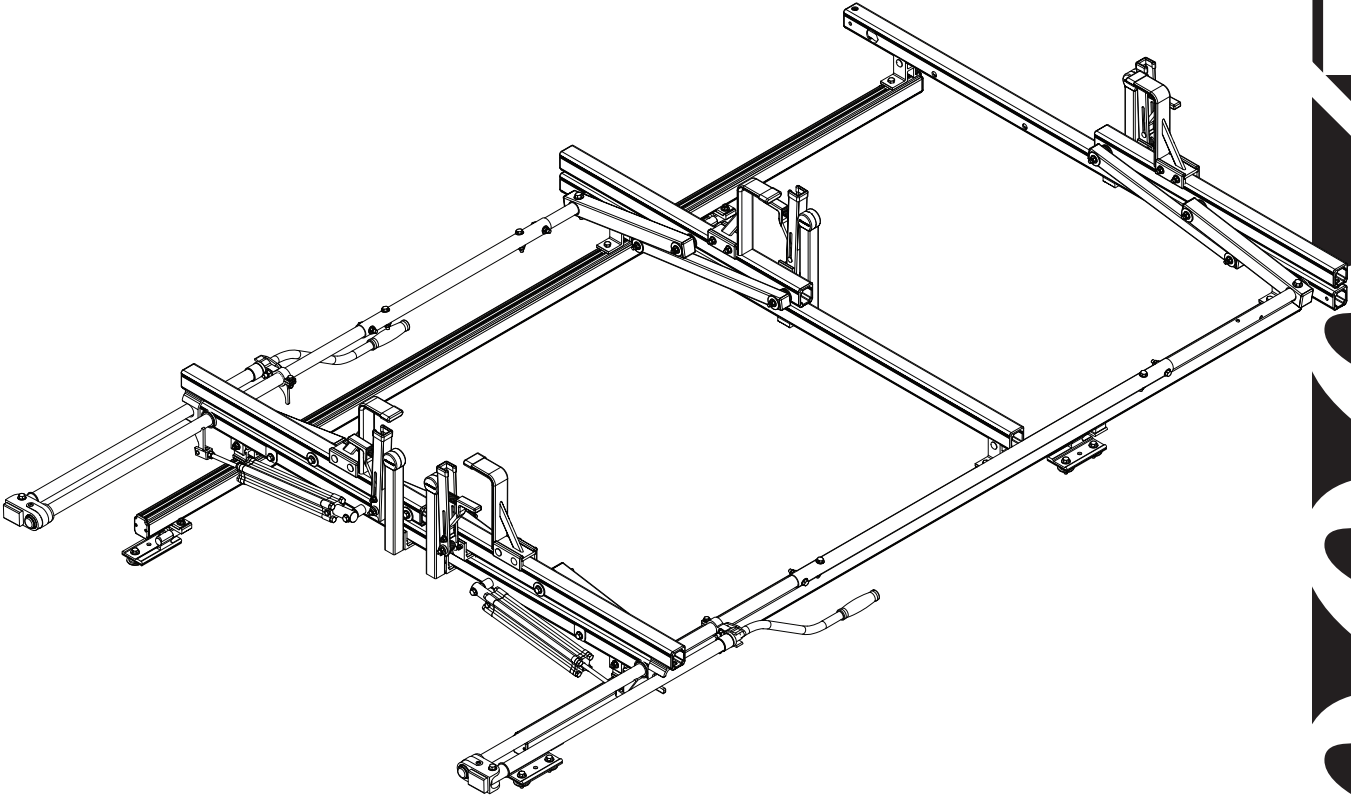

PRR3 0004

CONTENTS OVERVIEW

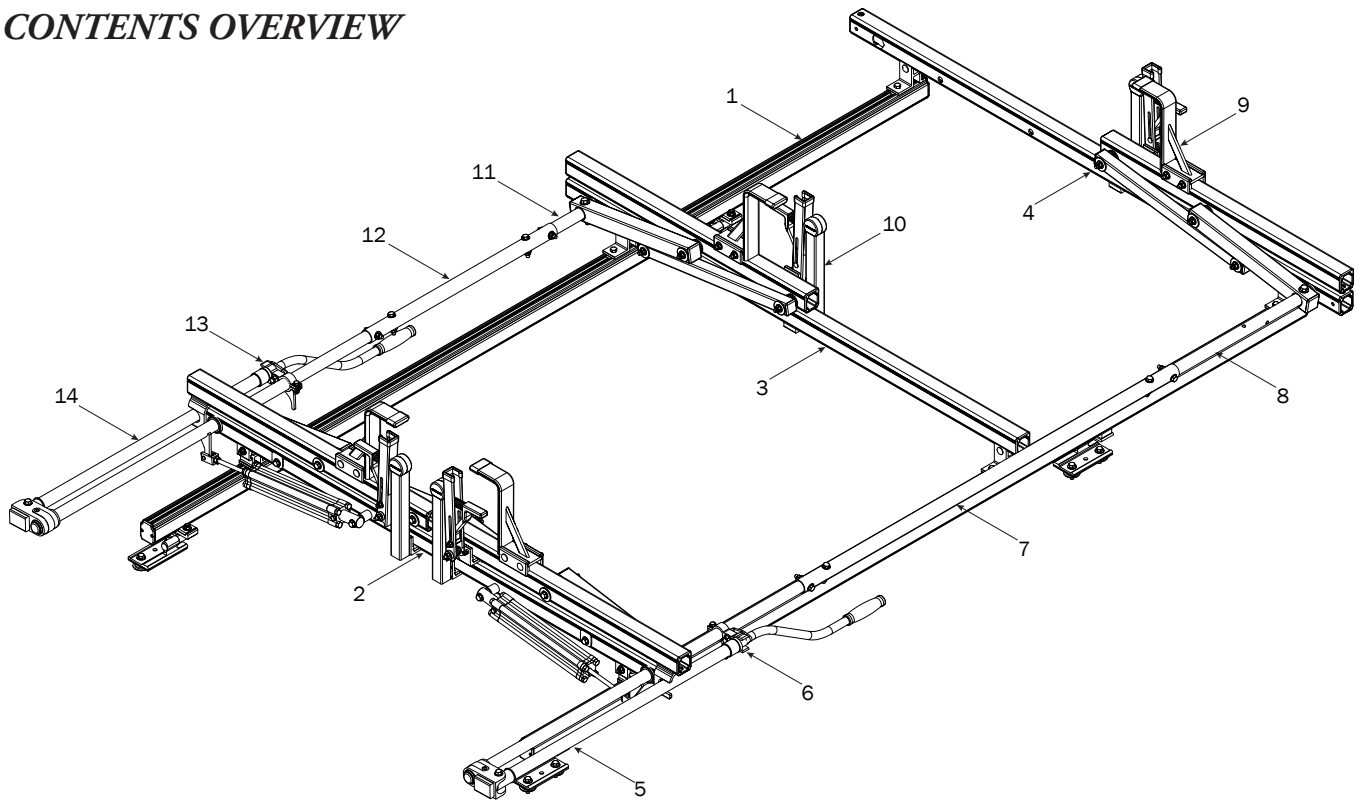

1—FBM3-0019 (Qty 1)
Suspension Bars with hardware



Channels (2X)



Screws (8X)

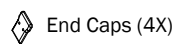

End Caps (4X)



Brackets (6X)



Mountings (4X)

2—Rear Crossbar Assembly..... (Qty 1)

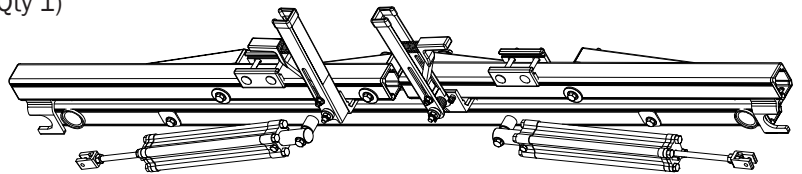

3—Center Crossbar Assembly..... (Qty 1)

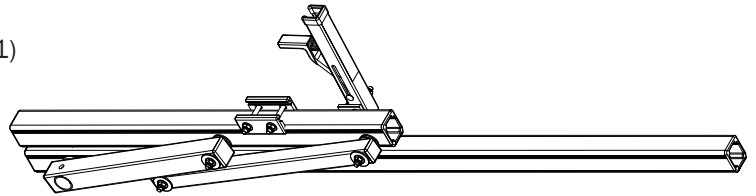

4—Front Crossbar Assembly (Qty 1)

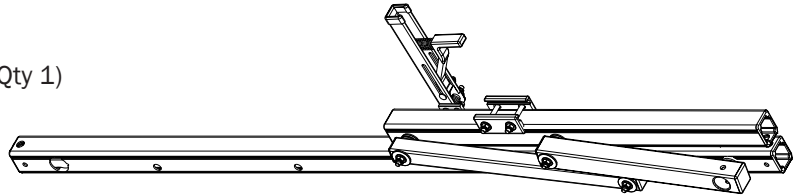

5—Rear Drive Shaft..... (Qty 1)
Right Hand, 46.00"

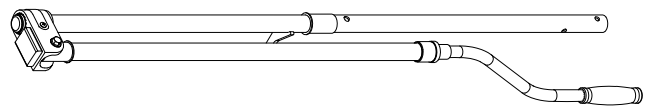

6—Handle Latch Assembly (Qty 1)



7—Connecting Bar (Qty 1)
4.00'



8—Front Drive Shaft (Qty 1)
B Version, 35.75"

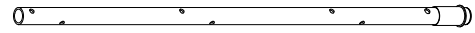

9—Z Post (Qty 4)
Adjustable, 7.25"

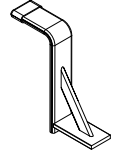

10—L Post (Qty 4)
US3, Square Cap, 11.25"

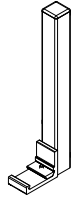

11—Front Drive Shaft (Qty 1)
B Version, 11.75"

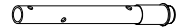

12—Connecting Bar (Qty 1)
2.00'



13—Handle Latch Assembly (Qty 1)



14—Rear Drive Shaft (Qty 1)
Left Hand, 46.00"

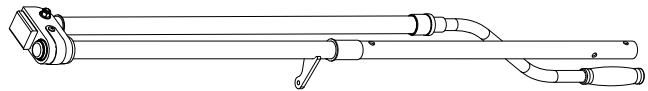

11—HKT-8163-Rotation Hardware Kit (Qty 2)
(Not called out in Overview)

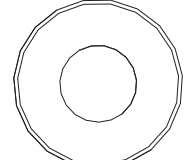
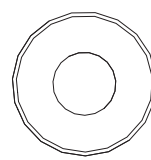
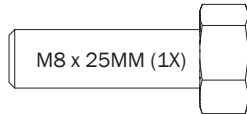
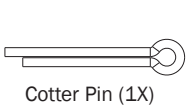
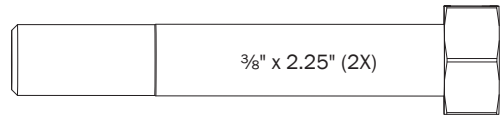
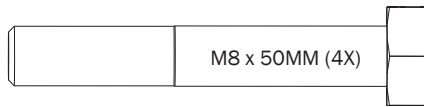

M8 Lock Nut (5X)

3/8" Lock Nut (2X)

5/16" Flat Washer (10X)

3/8" Flat Washer (4X)

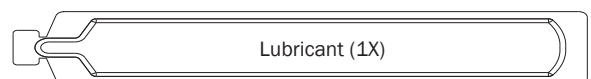
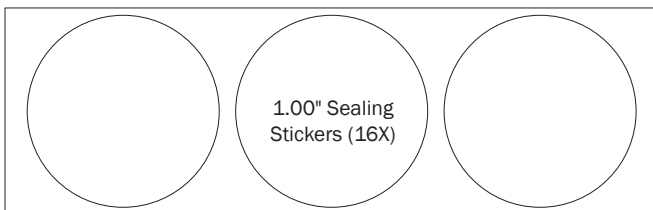

FBM3-0019

Mounting brackets must be located in Cap manufacturer's designated locations.

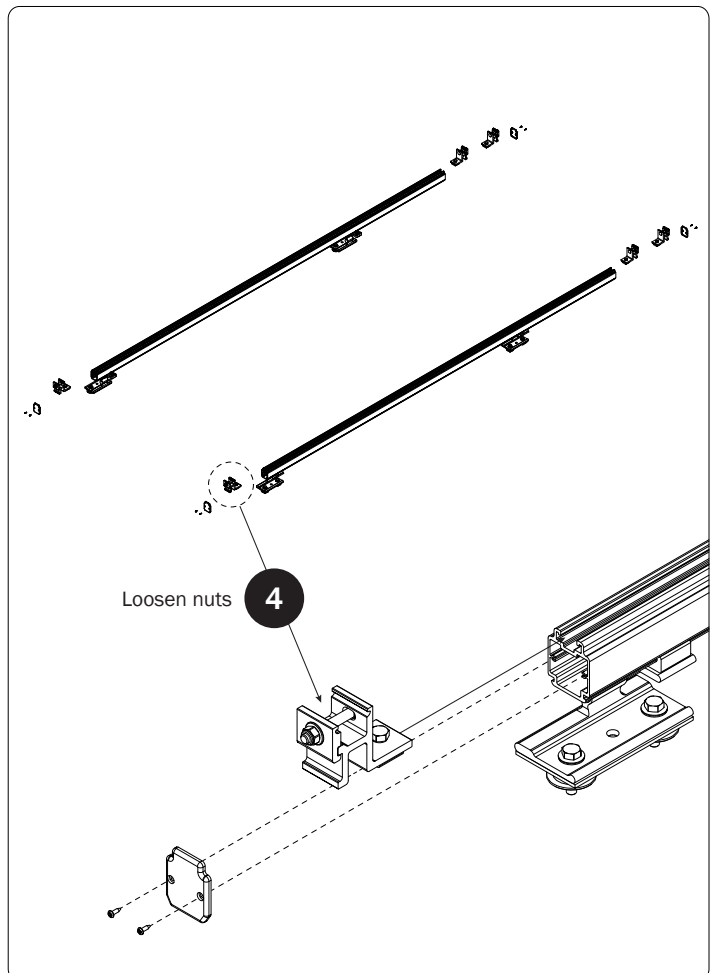
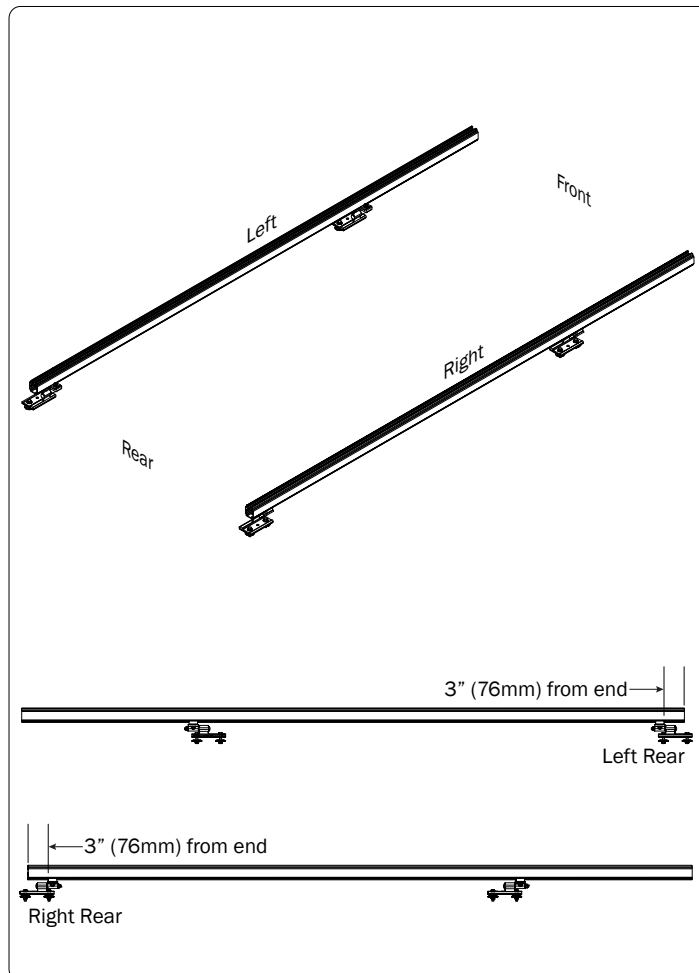
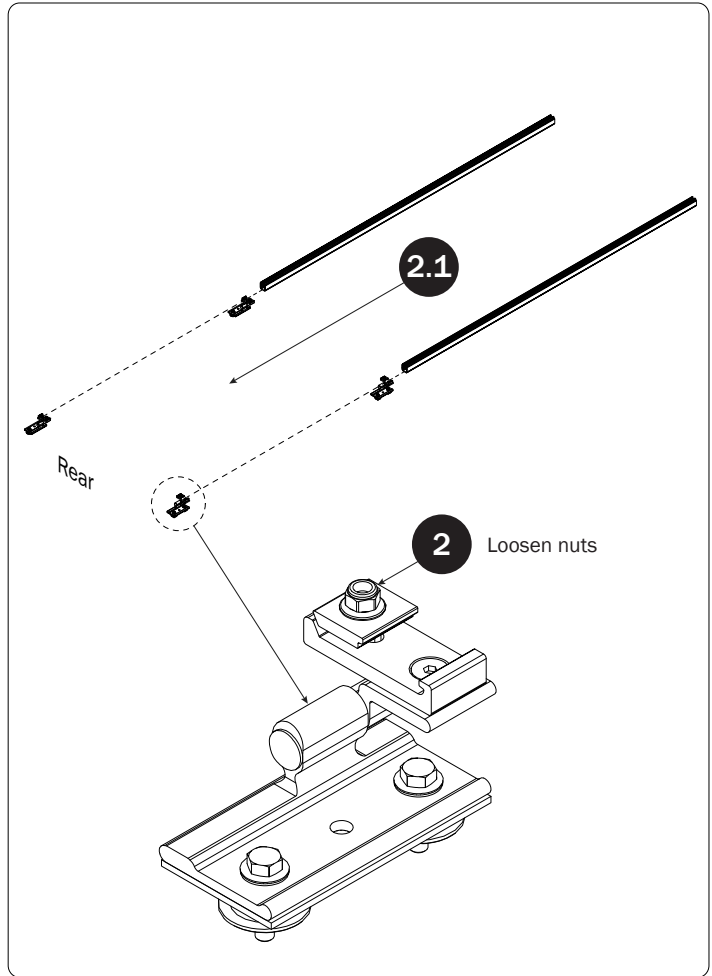
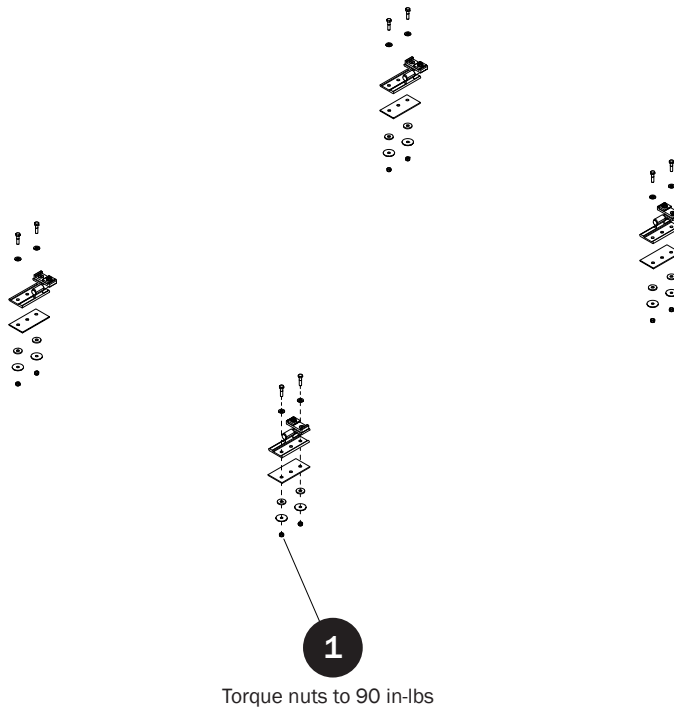

5 Set to distances shown, then torque nuts to 90 in-lbs

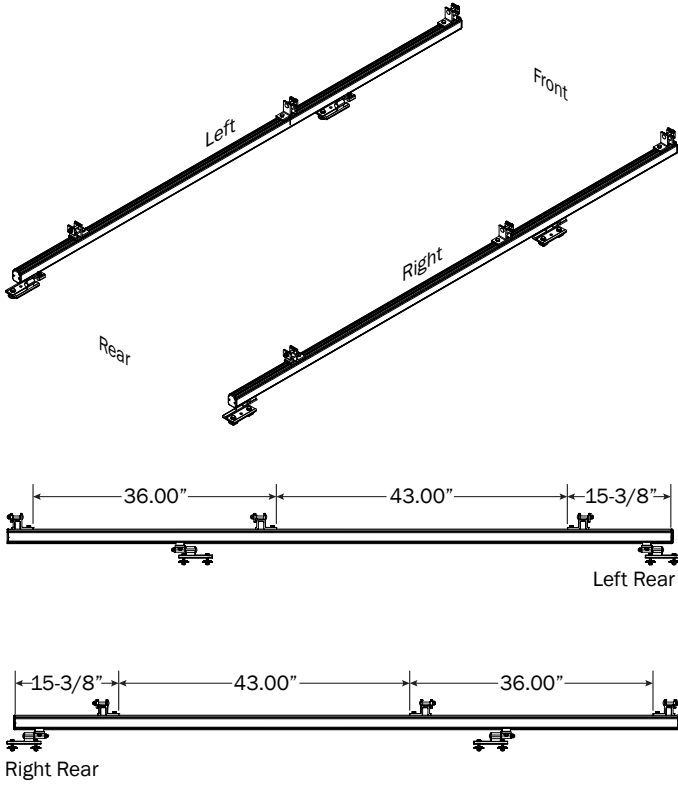

RIGHT SIDE ROTATION ASSEMBLY

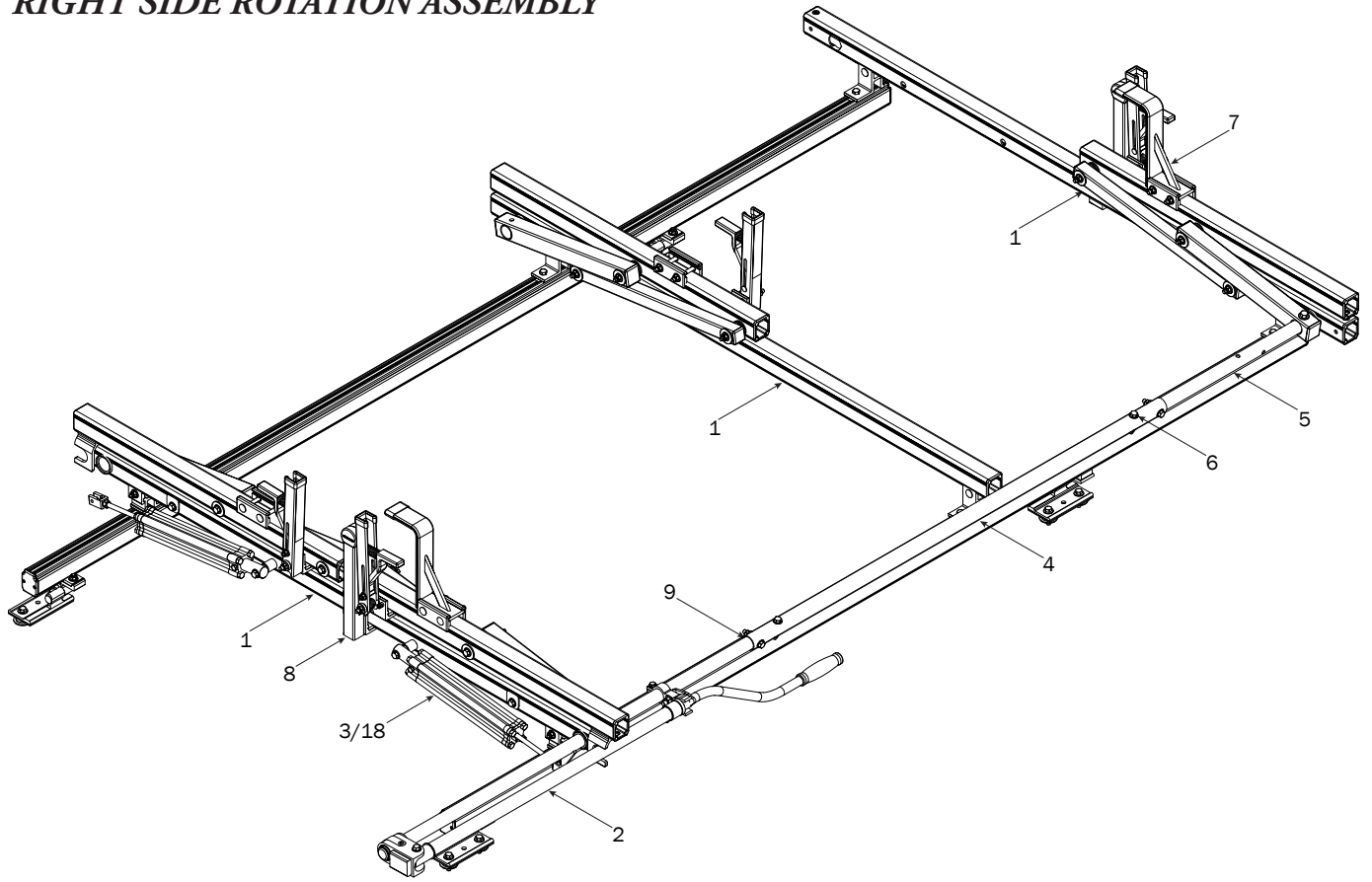

CROSSBARS

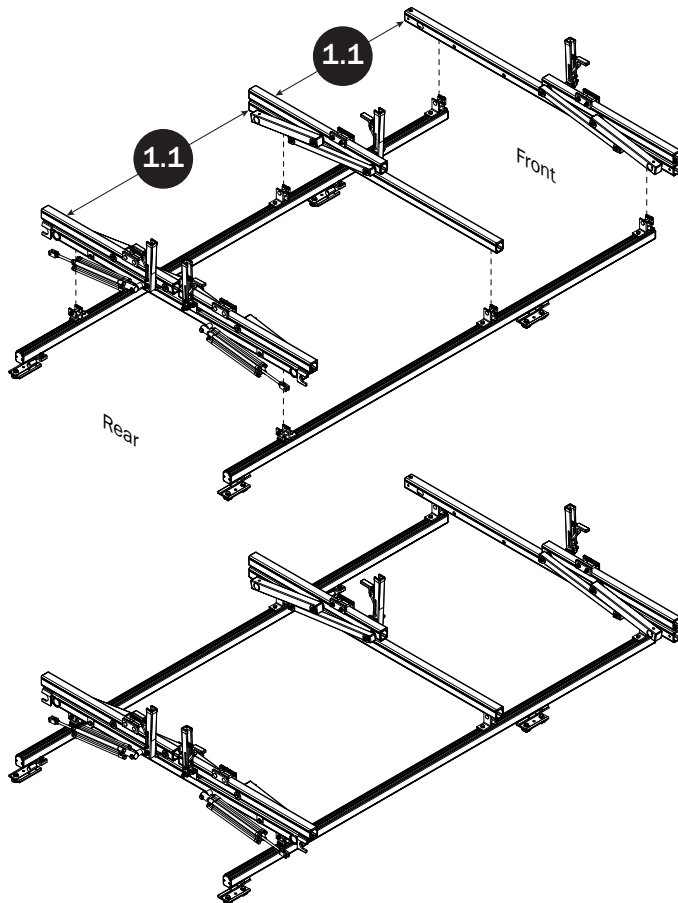

CROSSBAR ADJUSTMENT

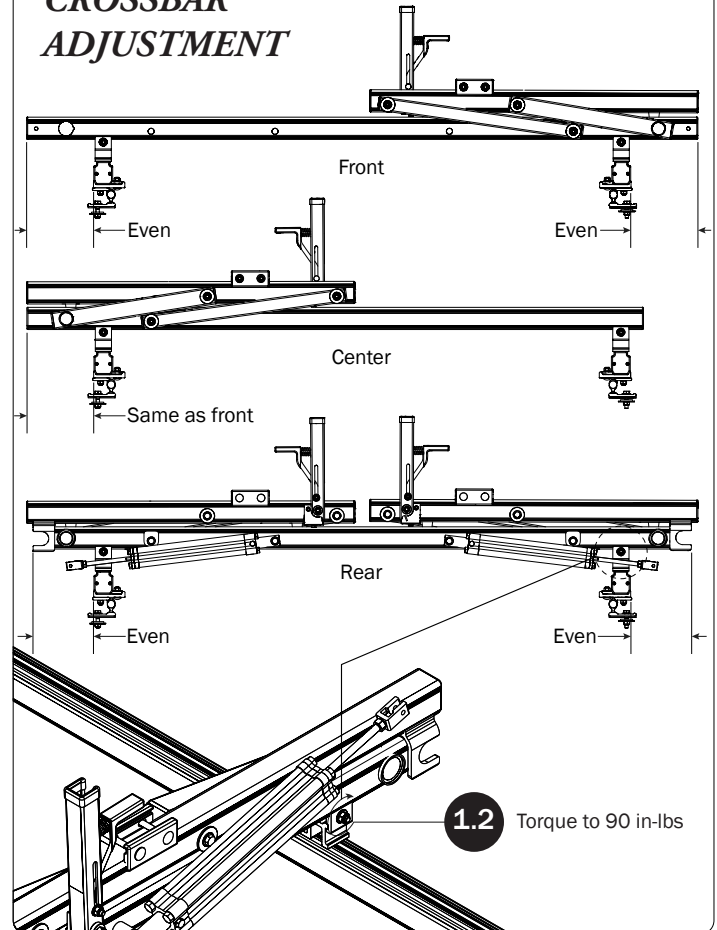

REAR DRIVE SHAFT

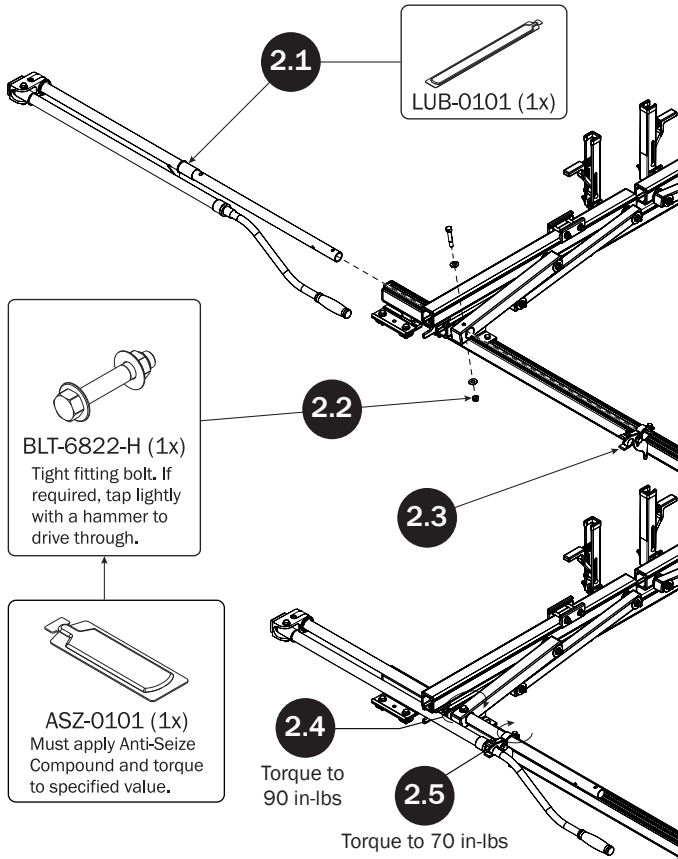

CYLINDER HARDWARE

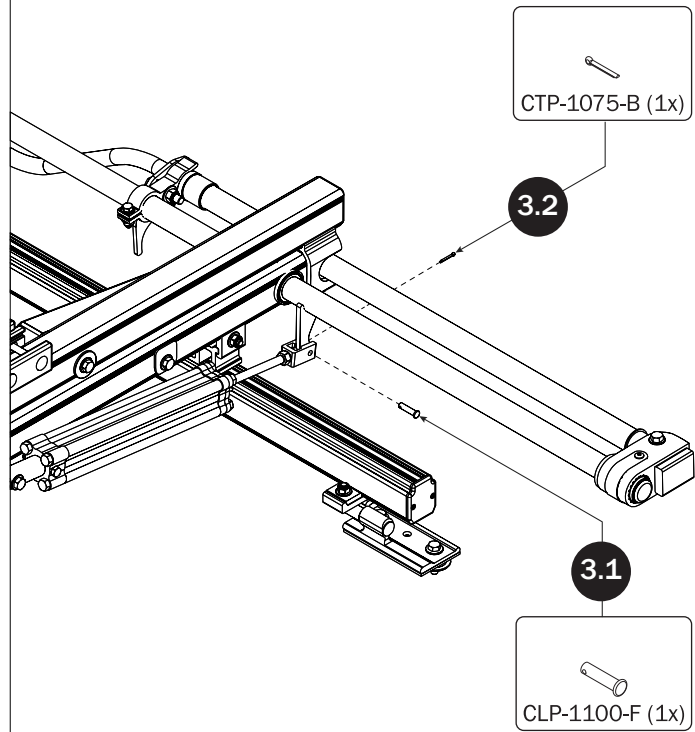

CONNECTING BAR

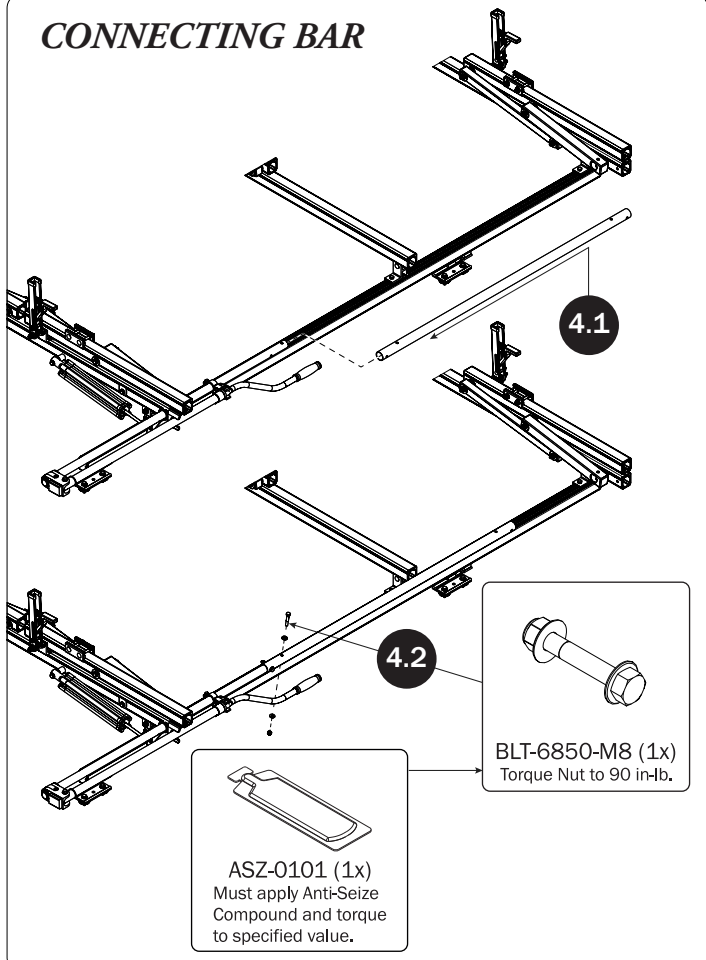

FRONT DRIVE SHAFT

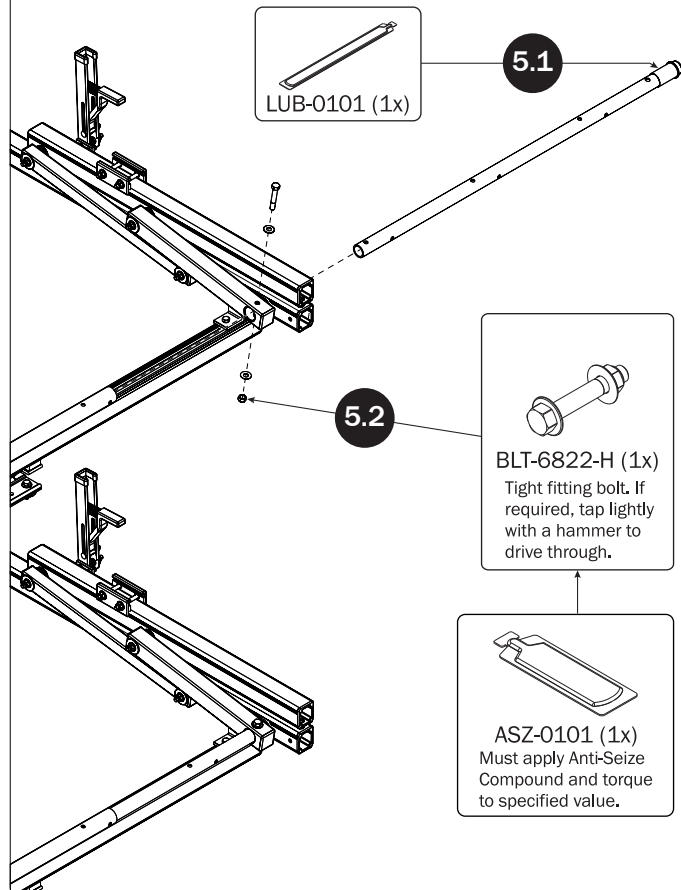

CONNECTING BAR FASTENERS

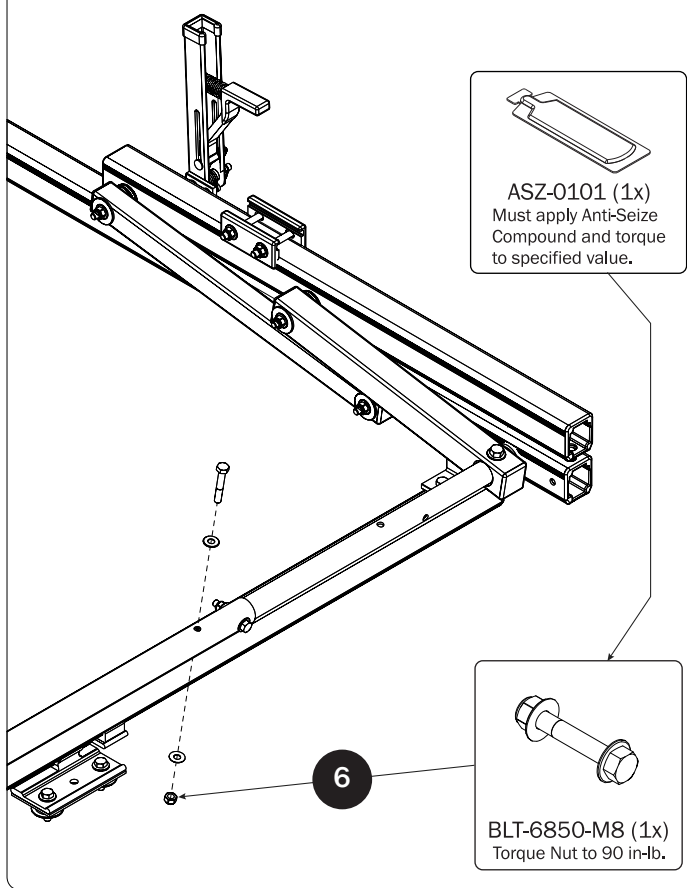

Z POSTS
SEE QUICK START GUIDE FOR ADJUSTMENTS

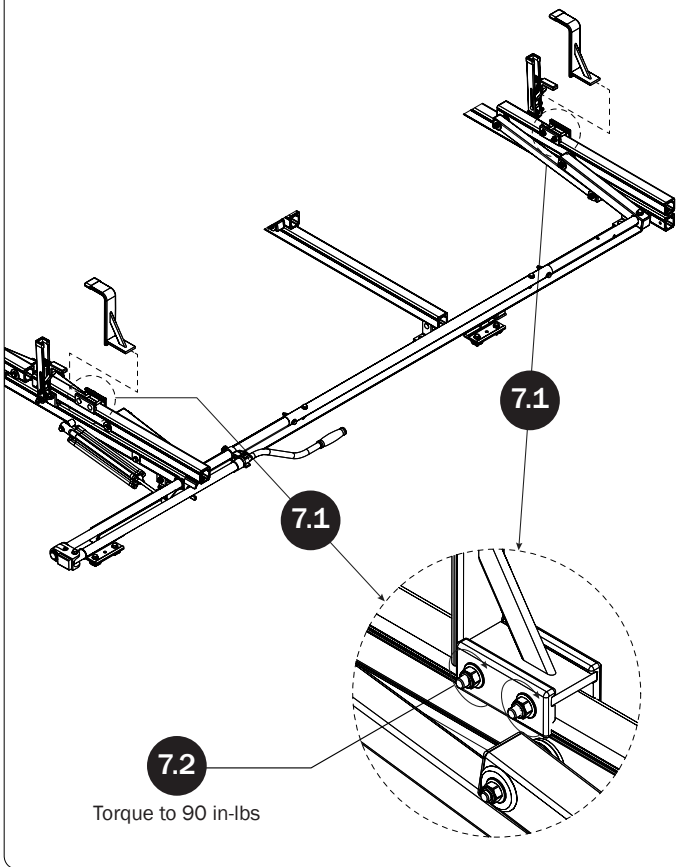

L POSTS
SEE QUICK START GUIDE FOR ADJUSTMENTS

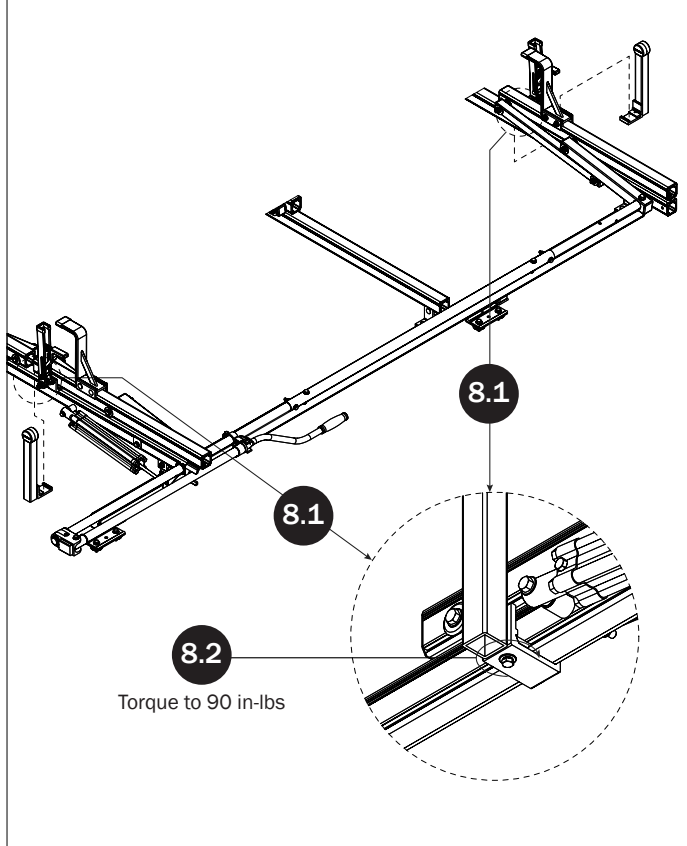

DRIVE SHAFT SEALING

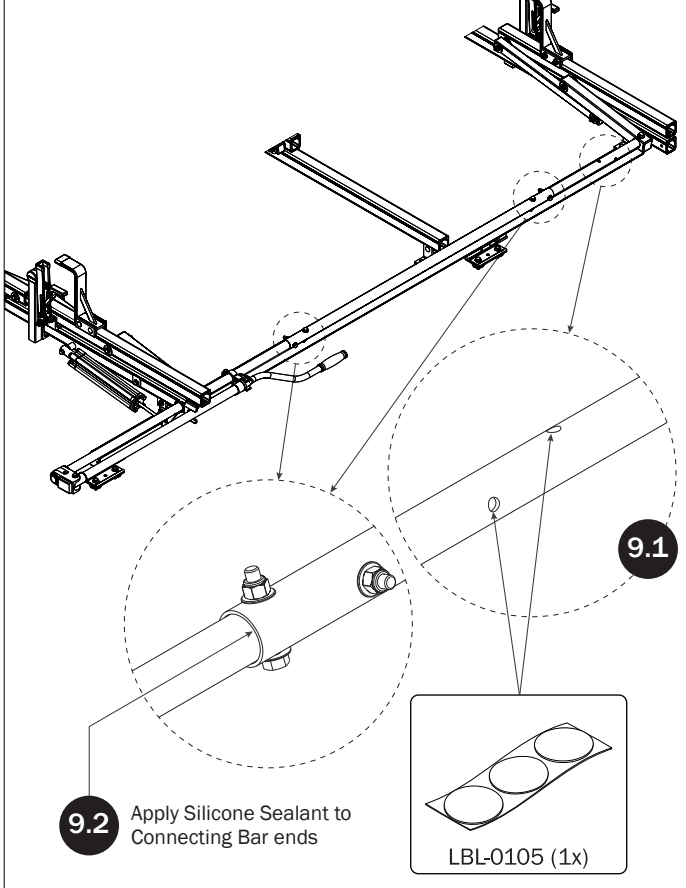

LEFT SIDE ROTATION ASSEMBLY

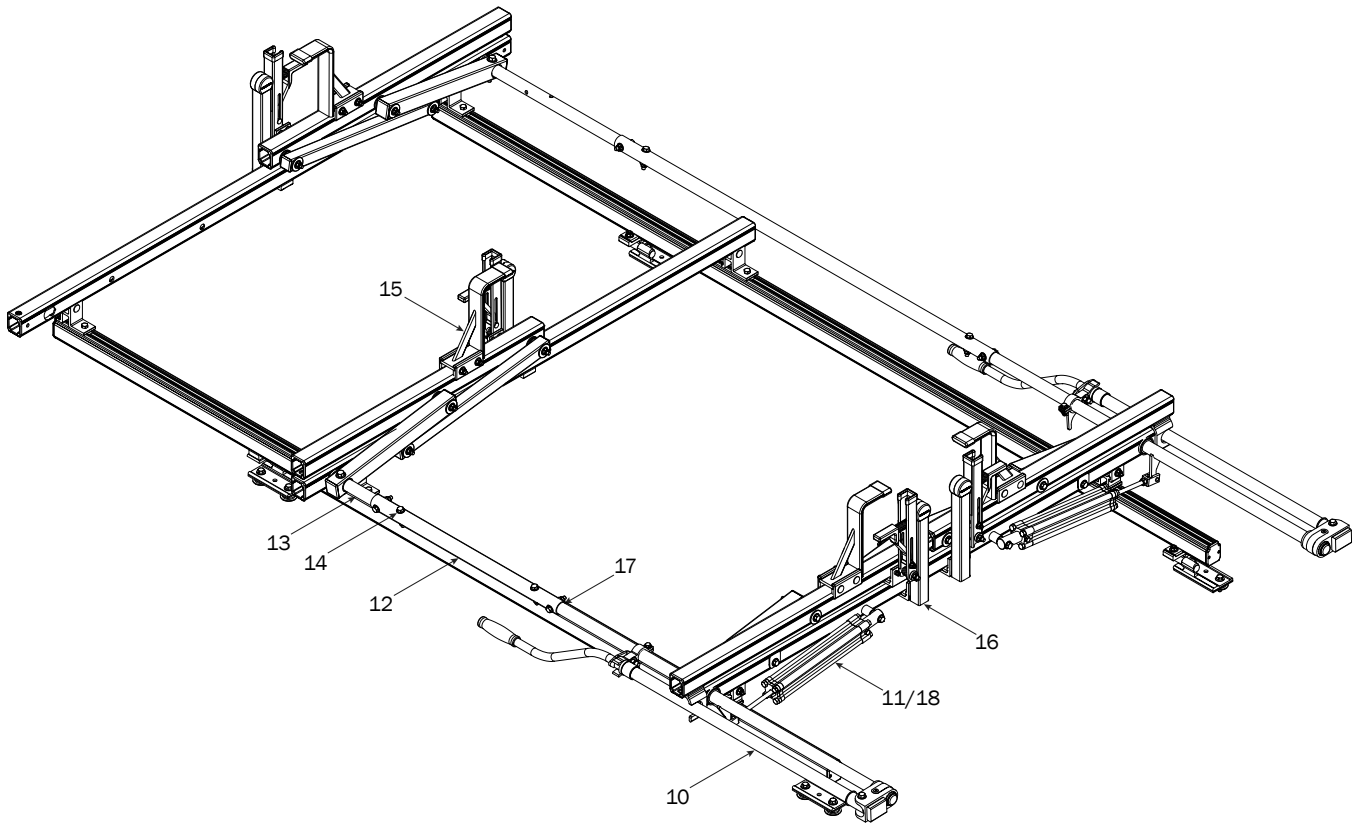

REAR DRIVE SHAFT

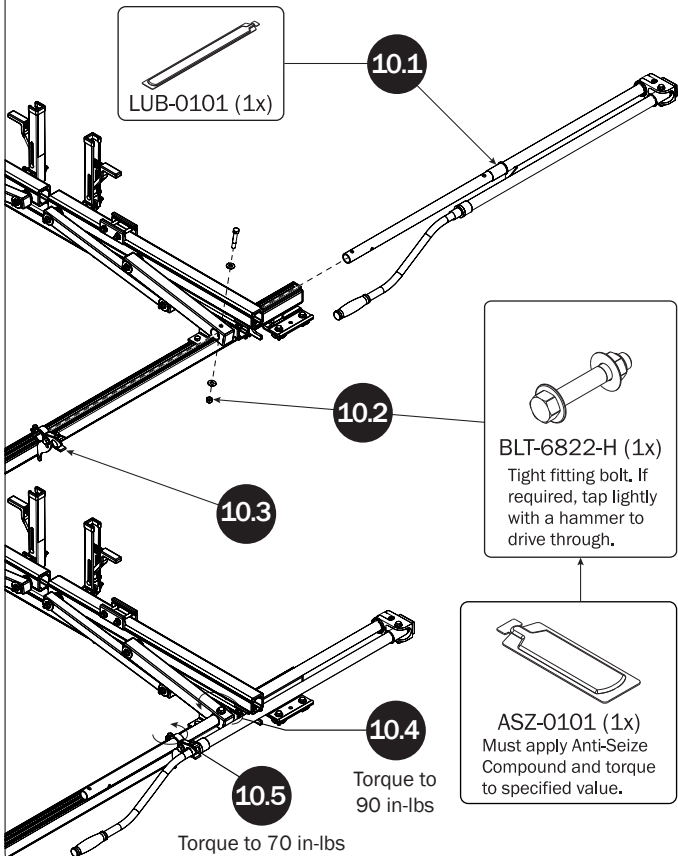

CYLINDER HARDWARE

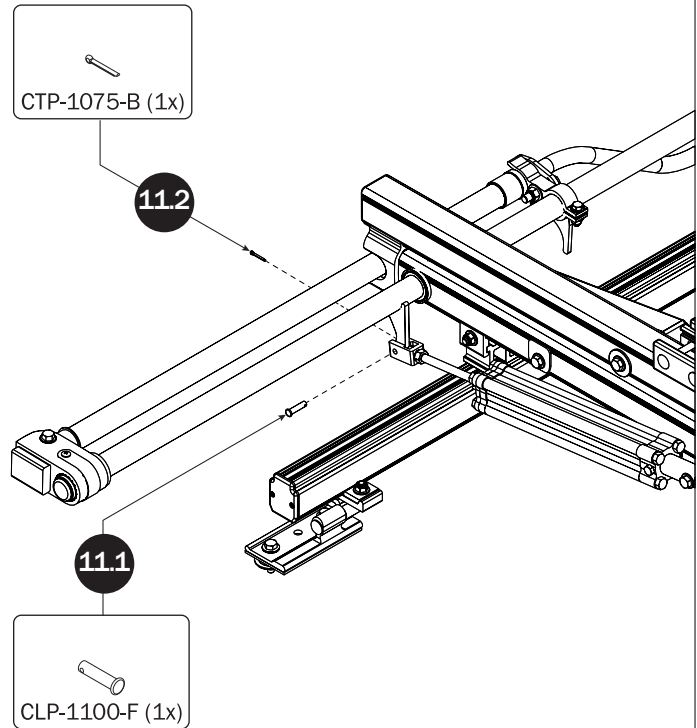

CONNECTING BAR

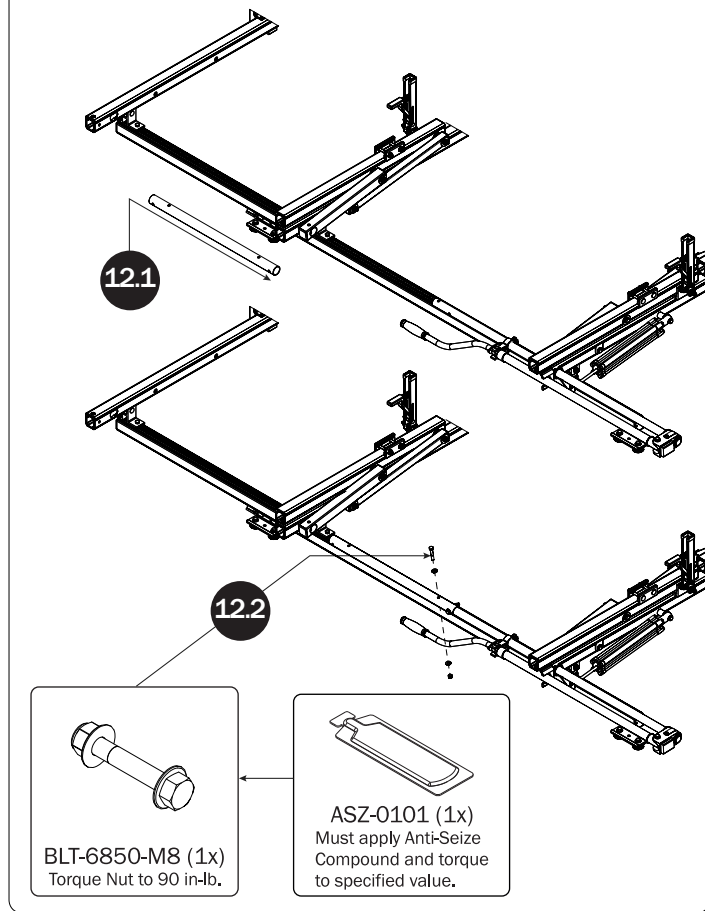

FRONT DRIVE SHAFT

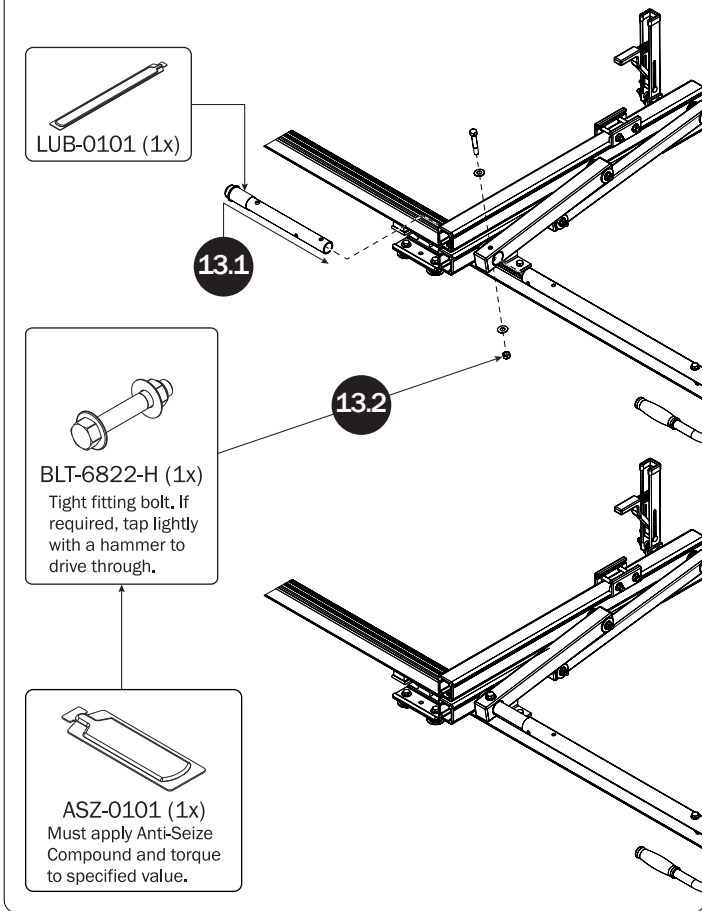

CONNECTING BAR FASTENERS

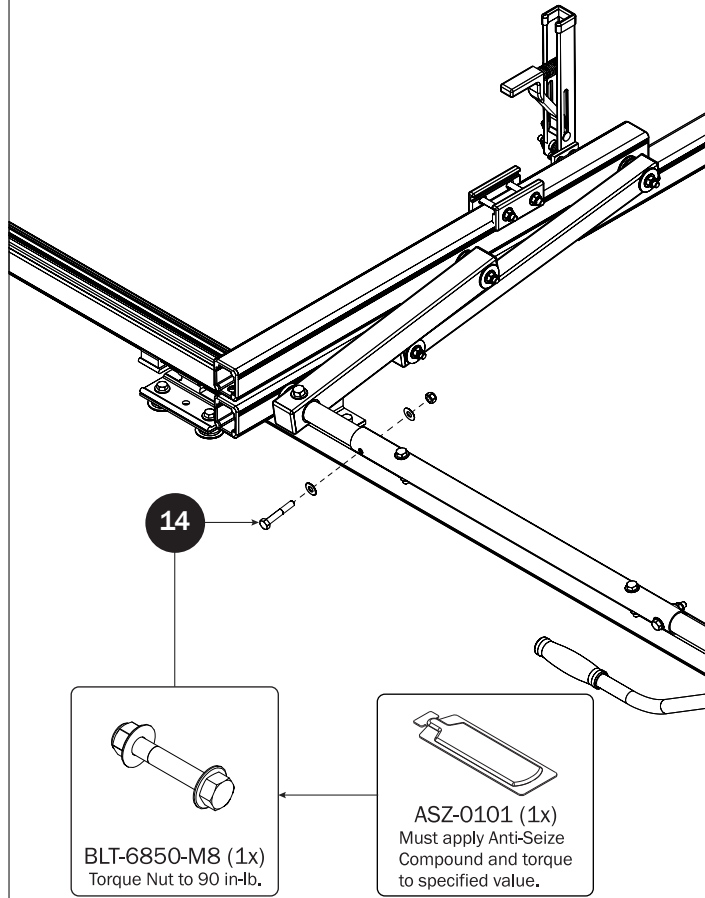

Z POSTS
SEE QUICK START GUIDE FOR ADJUSTMENTS

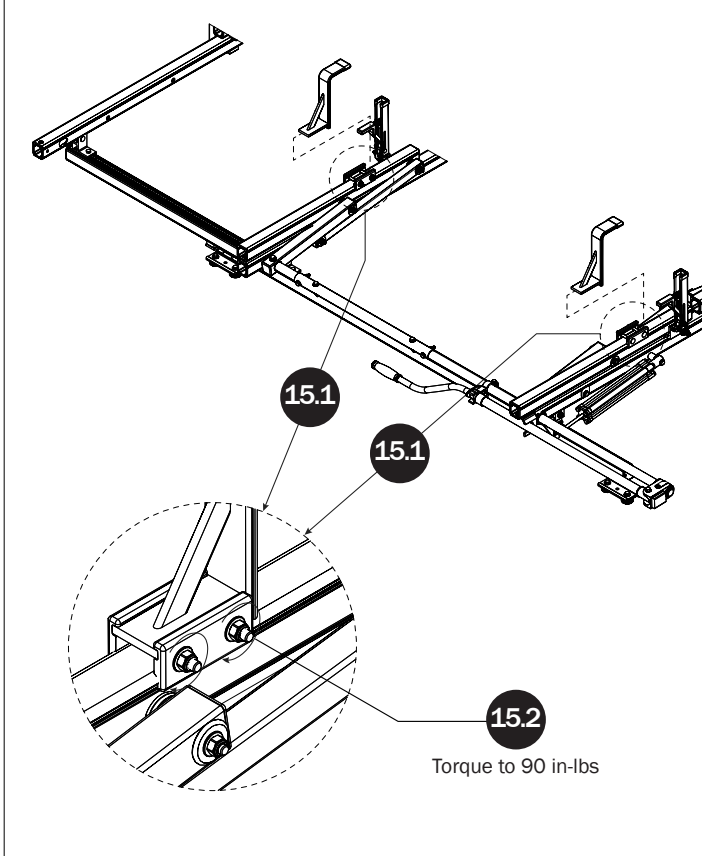

L POSTS

SEE QUICK START GUIDE FOR ADJUSTMENTS

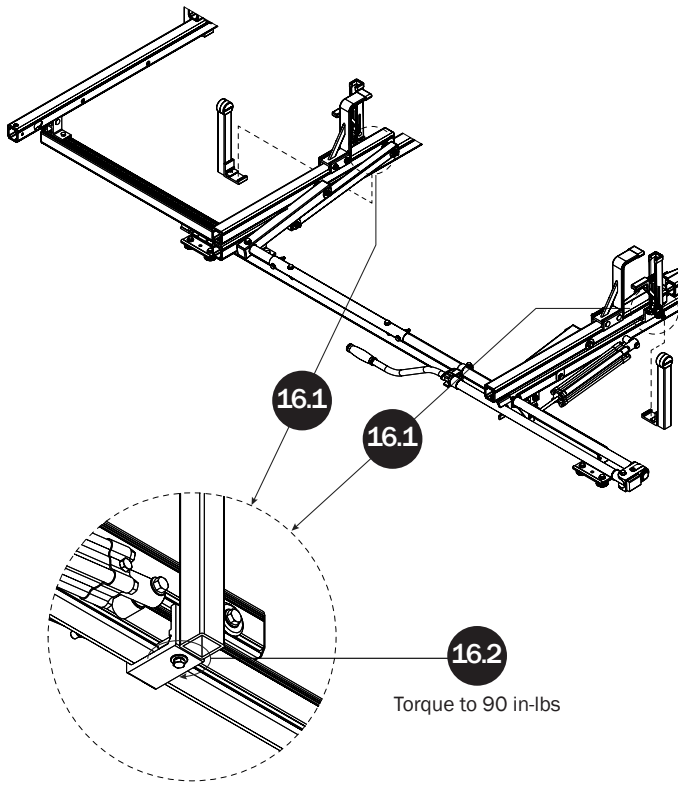

DRIVE SHAFT SEALING

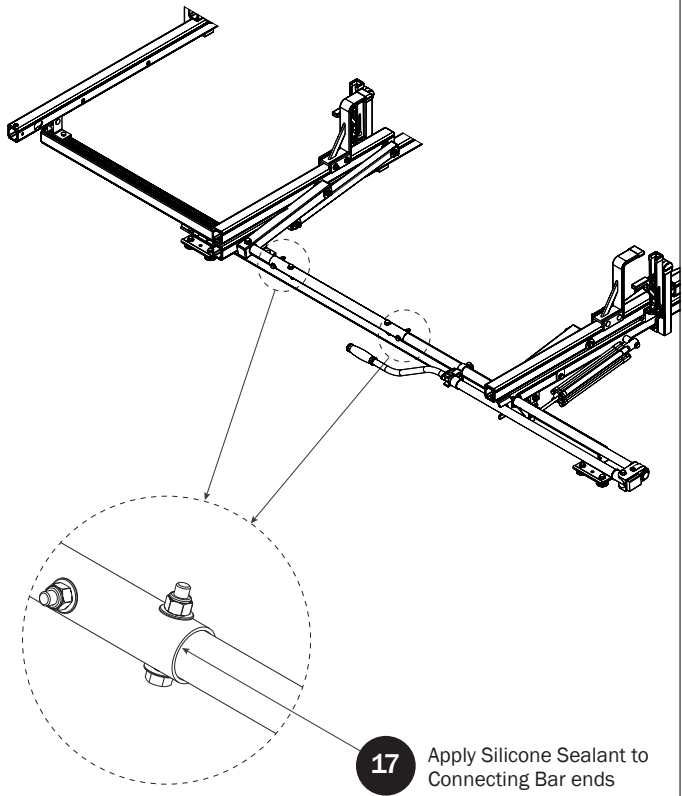

CYLINDER ADJUSTMENT

