

# PRIME DESIGN™

A Safe Fleet Brand

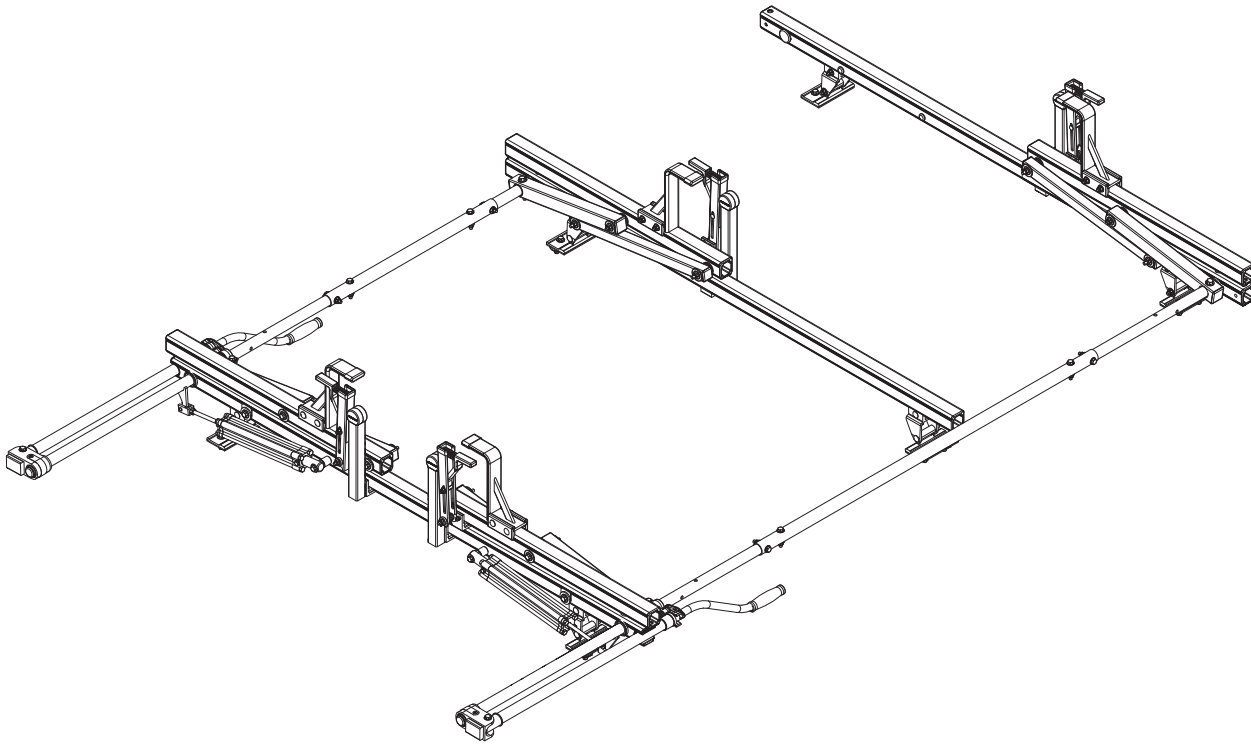

**PRR3** **0003**

PRIME DESIGN, A SAFE FLEET BRAND

Address: 580 Opperman Drive, Eagan, MN 55123 • Toll Free: 1.8.PRIME.RACK  
Fax: 651-552-1799 • Email: [info@primedesign.net](mailto:info@primedesign.net) • Website: [www.primedesign.net](http://www.primedesign.net)

CONTENTS OVERVIEW

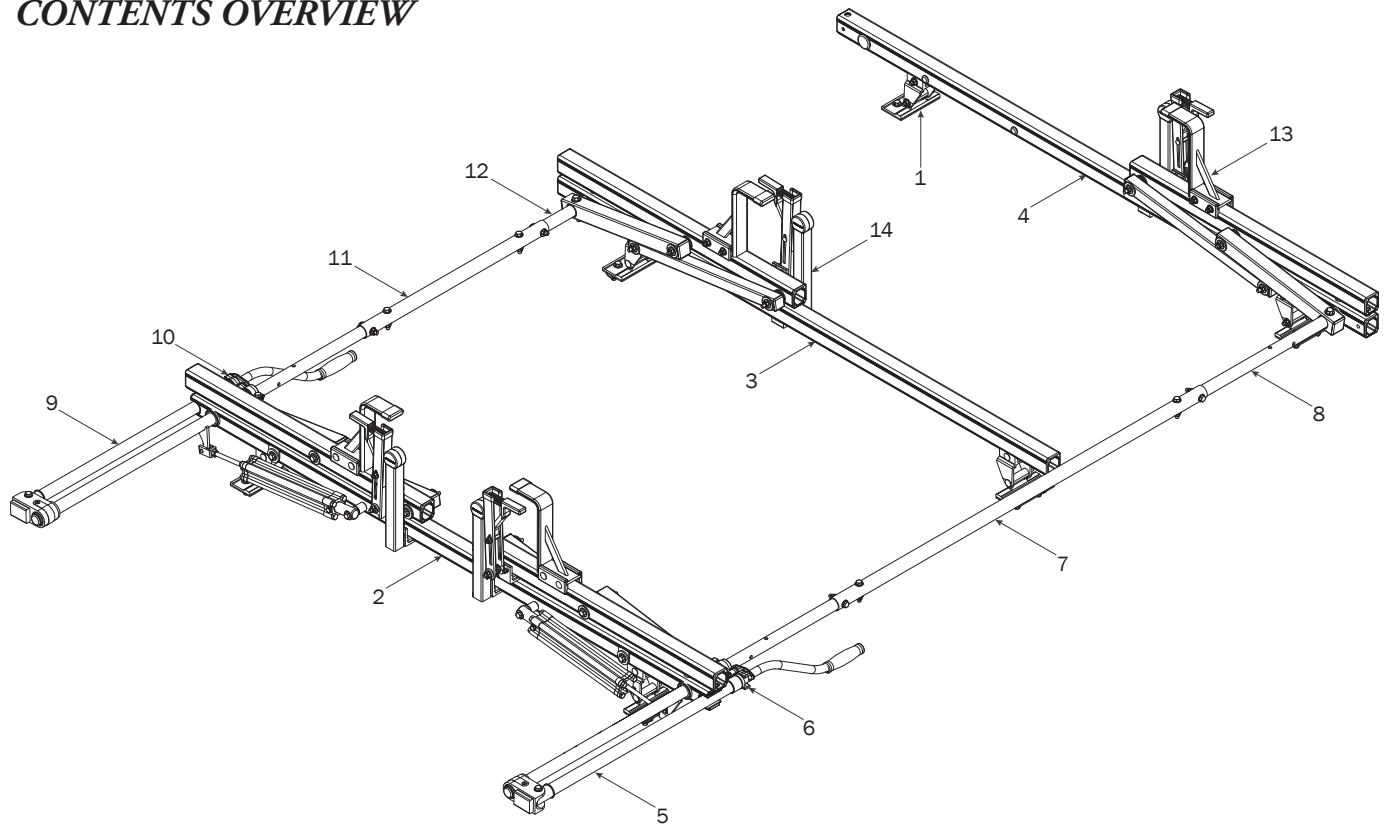

1—FBM3-0024 ..... (Qty 1)  
Mounting Brackets with Hardware

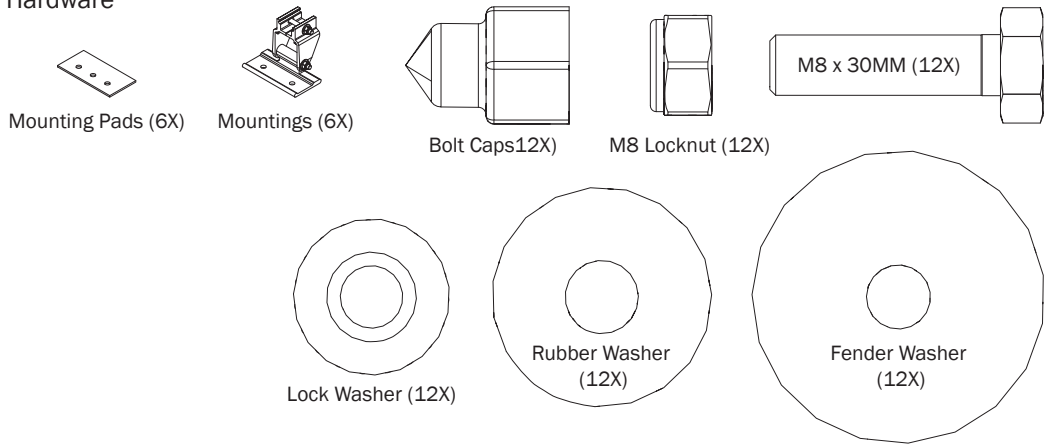

2—Rear Crossbar Assembly ..... (Qty 1)

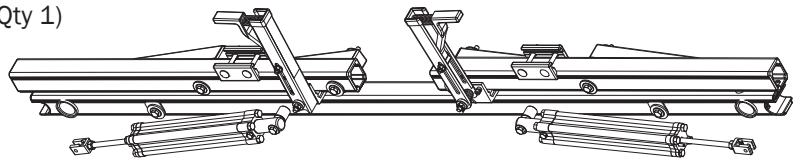

3—Center Crossbar Assembly ..... (Qty 1)

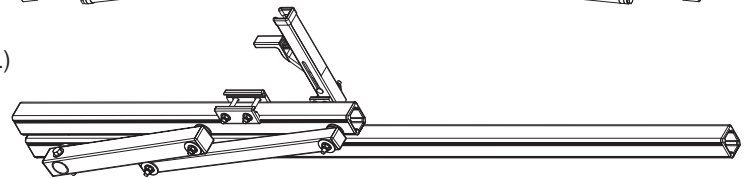

4—Front Crossbar Assembly ..... (Qty 1)

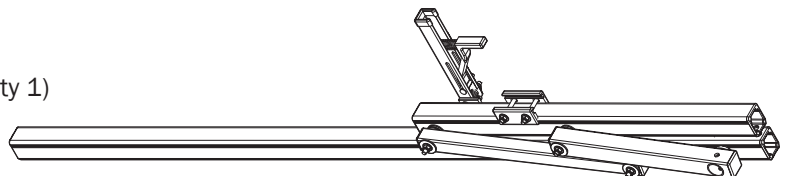

5—Rear Drive Shaft..... (Qty 1)  
Right Hand, 46.00”

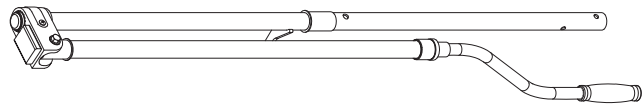

6—Handle Latch Assembly ..... (Qty 1)



7—Connecting Bar..... (Qty 1)  
48.00”

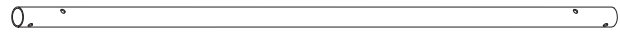

8—Front Drive Shaft ..... (Qty 1)  
B Version, 35.75”

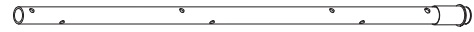

9—Rear Drive Shaft..... (Qty 1)  
Left Hand, 46.00”

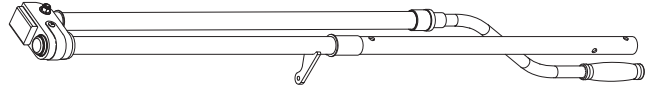

10—Handle Latch Assembly..... (Qty 1)



11—Connecting Bar ..... (Qty 1)  
24.00”

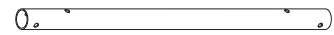

12—Front Drive Shaft..... (Qty 1)  
B Version, 11.75”



13—Z Post..... (Qty 4)  
Adjustable, 7.25”

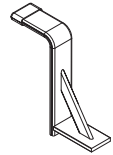

14—L Post ..... (Qty 4)  
Generation 2, Auto Clamp 2, 9.25”

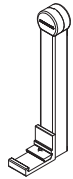

15—HKT-8163-Rotation Hardware Kit ..... (Qty 2)  
(Not called out in Overview)

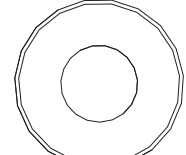
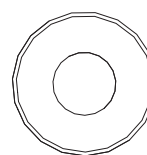
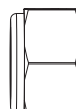
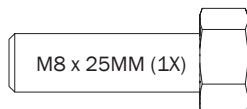
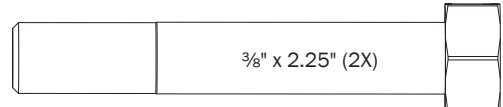
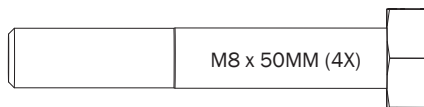
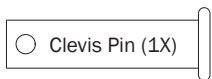

M8 Lock Nut (5X)

3/8" Lock Nut (2X)

5/16" Flat Washer (10X)

3/8" Flat Washer (4X)

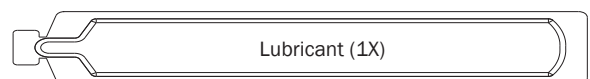
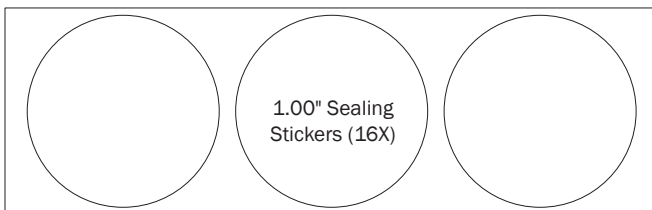

**FBM3-0024**  
**8' (96") CONFIGURATION**

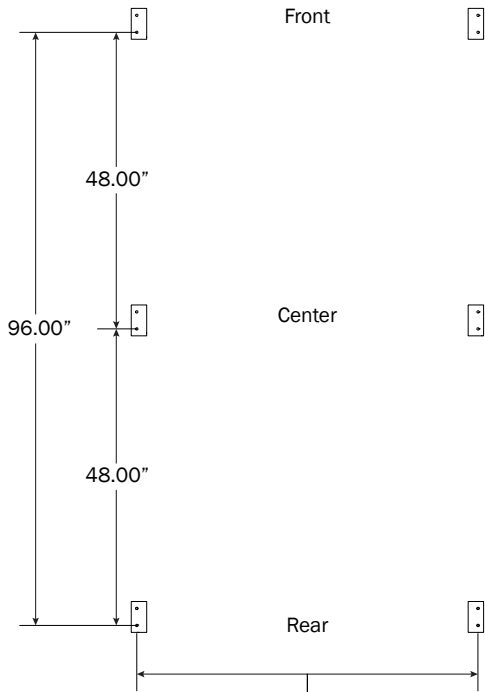

Mounting Bracket's left to right spread to be determined according to cap manufacturer's designated locations.

**7' (84") CONFIGURATION**

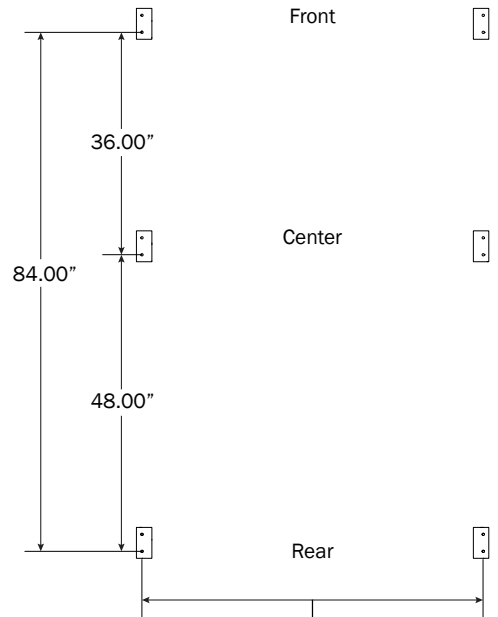

Mounting Bracket's left to right spread to be determined according to cap manufacturer's designated locations.

**6' (72") CONFIGURATION**

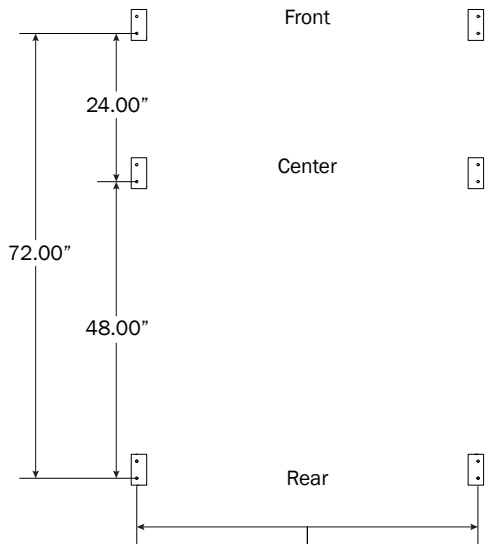

Mounting Bracket's left to right spread to be determined according to cap manufacturer's designated locations.

**0.1** Assemble and install the Mounting Brackets as shown below.

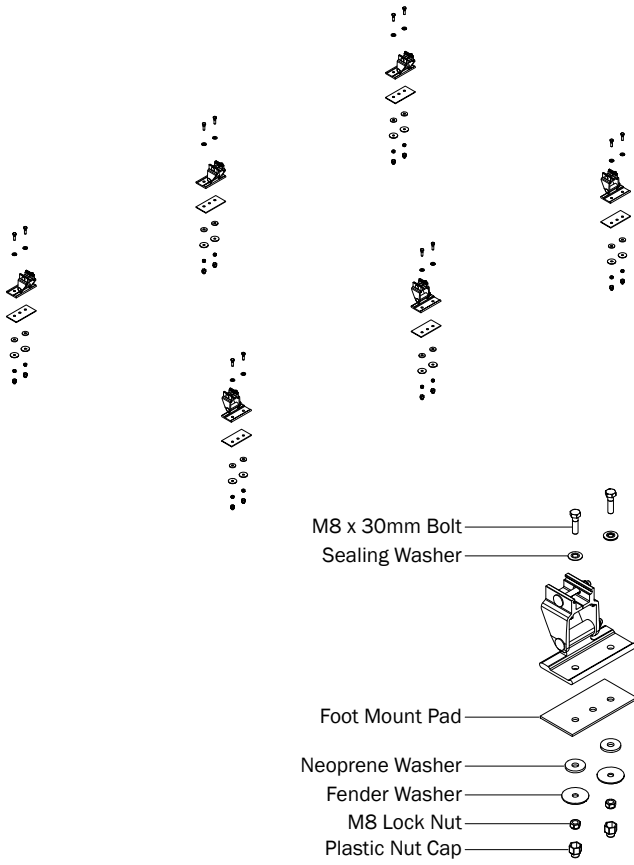

**0.2**

Torque all Mounting Bracket bolts to 90 in-lbs

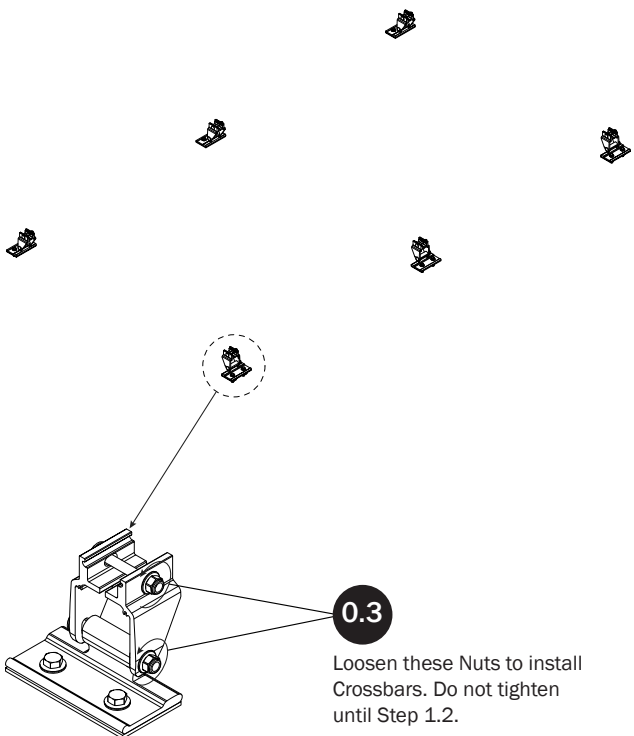

**RIGHT SIDE ROTATION ASSEMBLY**

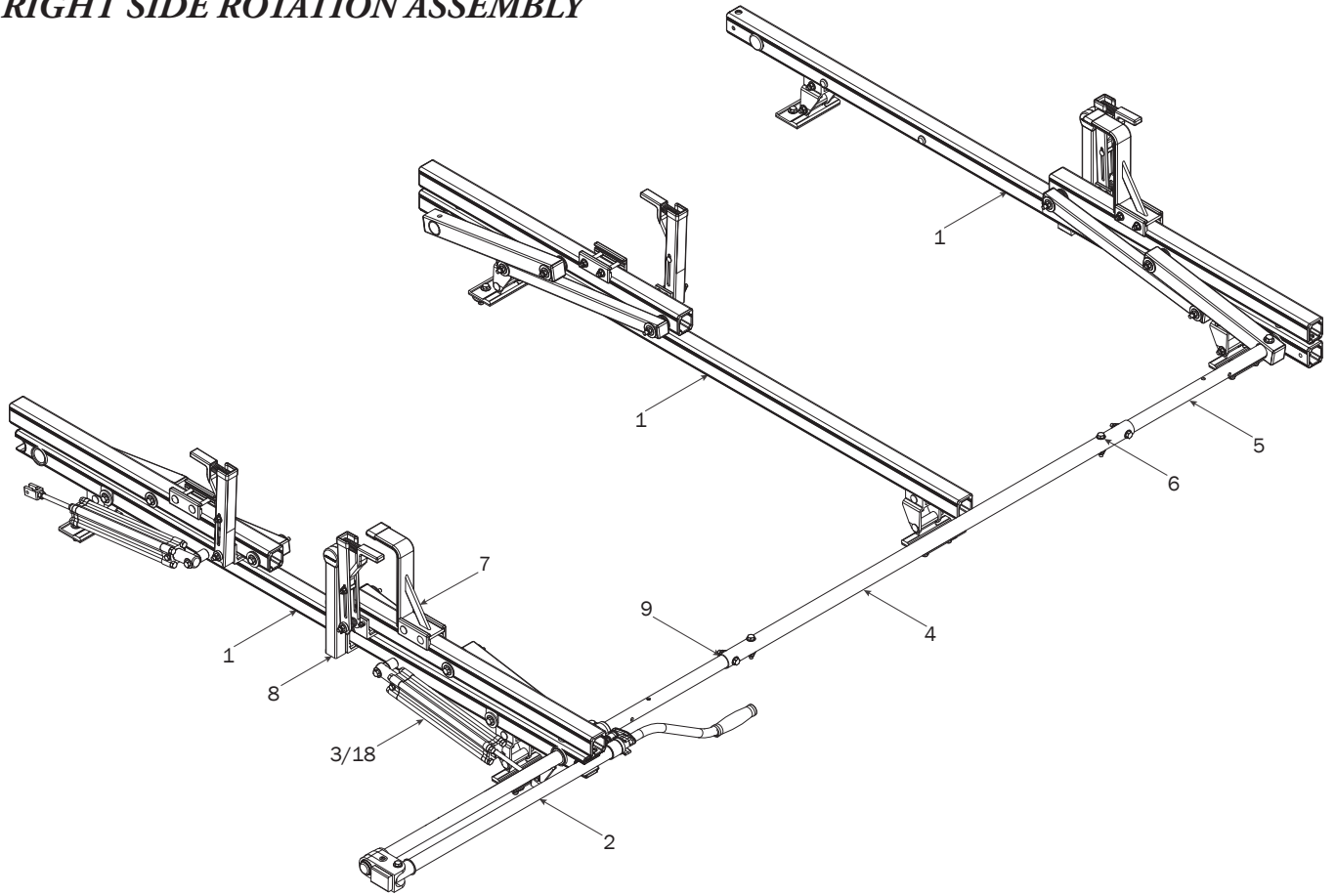

**CROSSBARS**

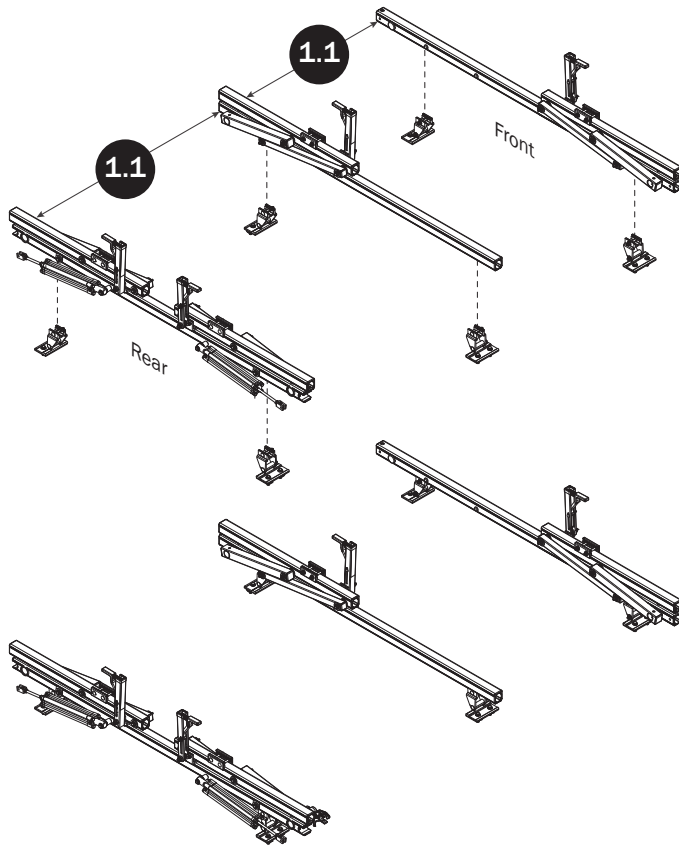

**CROSSBAR ADJUSTMENT**

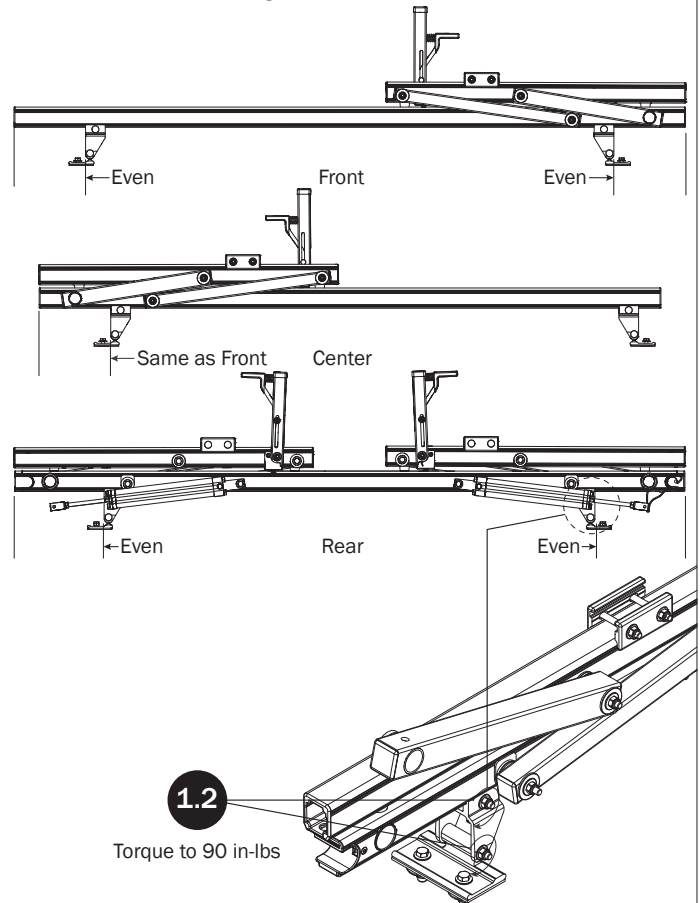

### REAR DRIVE SHAFT

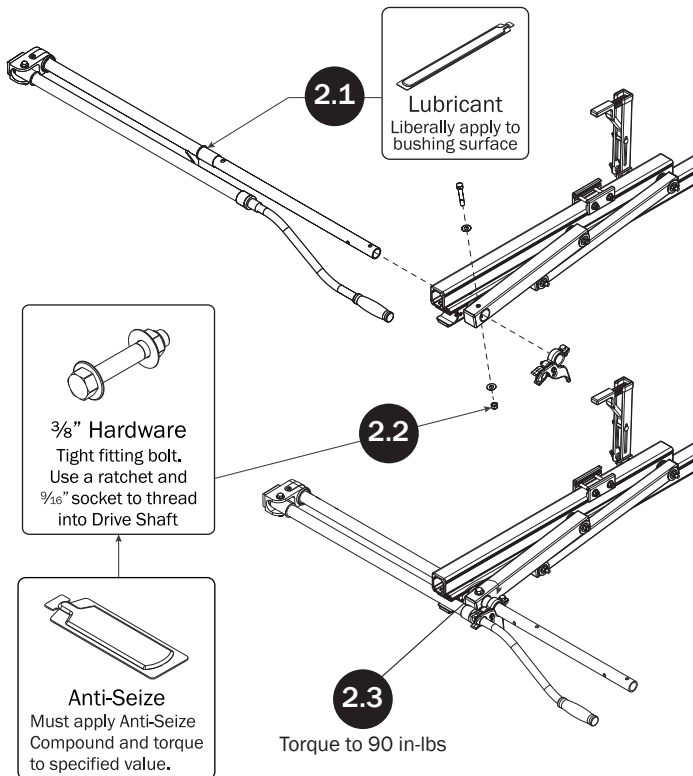

### CYLINDER HARDWARE

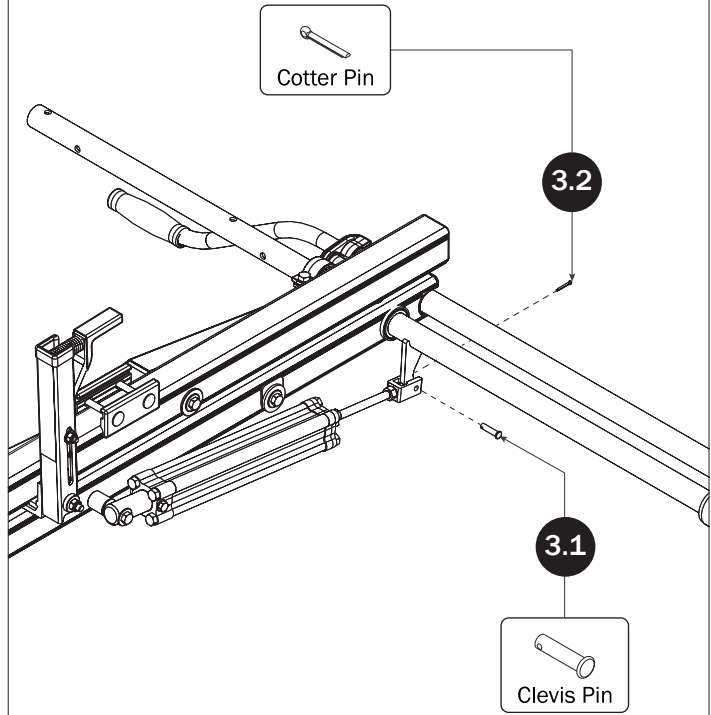

### CONNECTING BAR

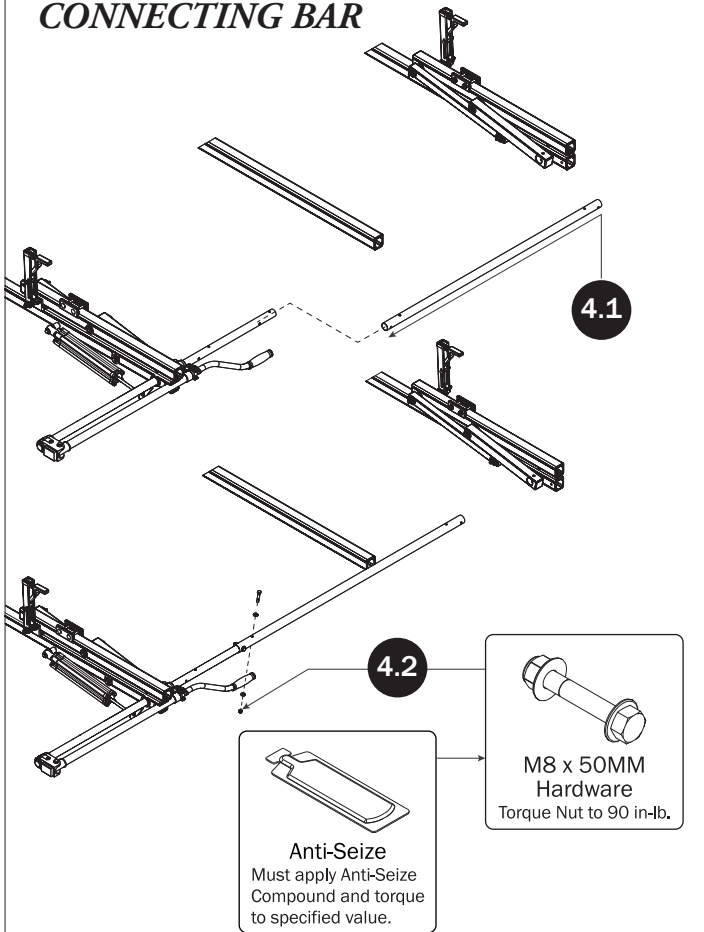

### FRONT DRIVE SHAFT

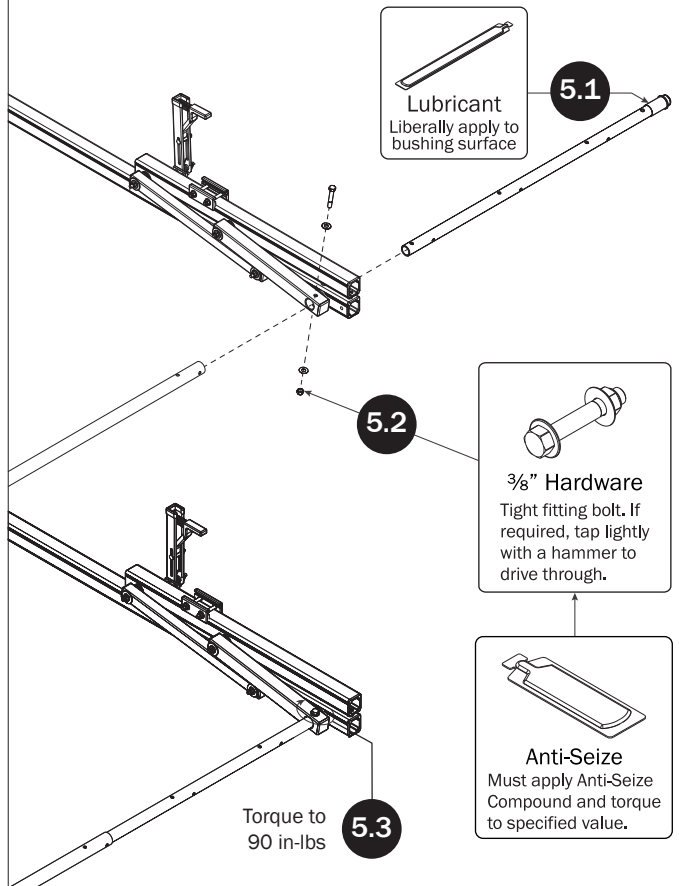

**CONNECTING BAR FASTENERS**

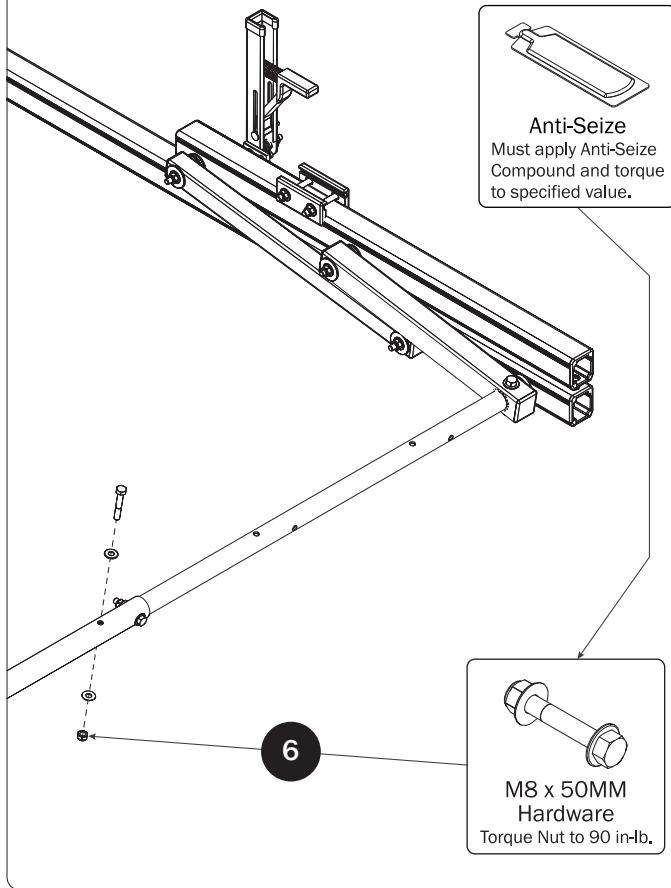

**Z POSTS**  
SEE QUICK START GUIDE FOR ADJUSTMENTS

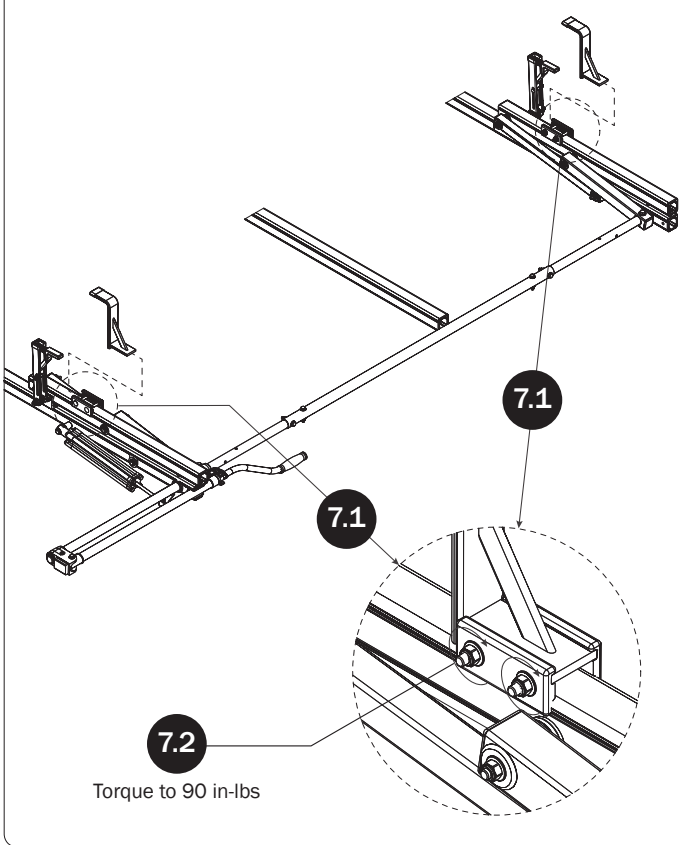

**L POSTS**  
SEE QUICK START GUIDE FOR ADJUSTMENTS

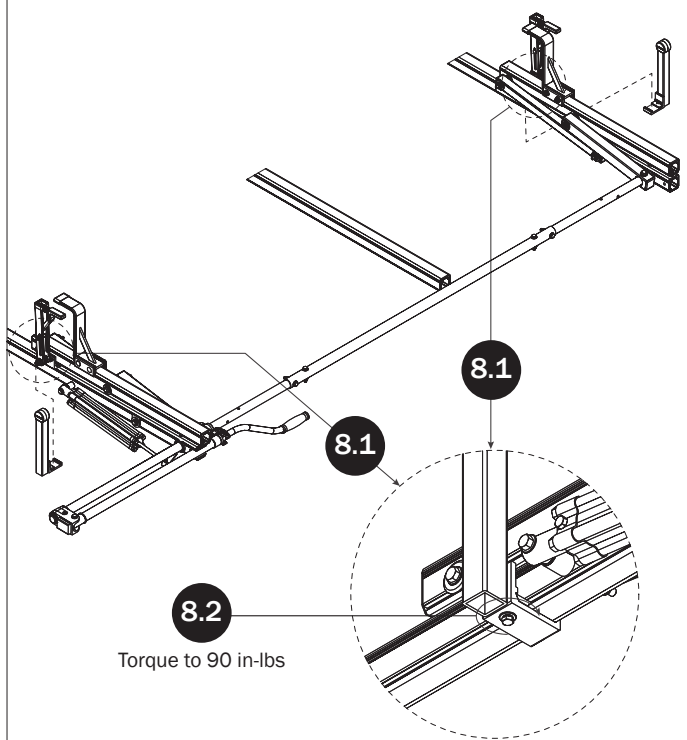

**DRIVE SHAFT SEALING**

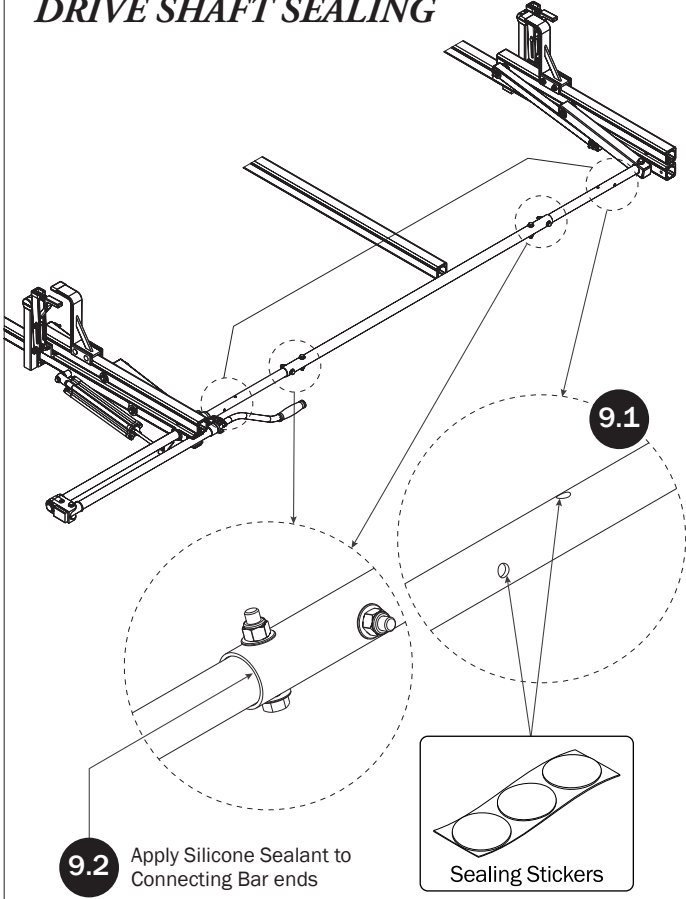



# LEFT SIDE ROTATION ASSEMBLY

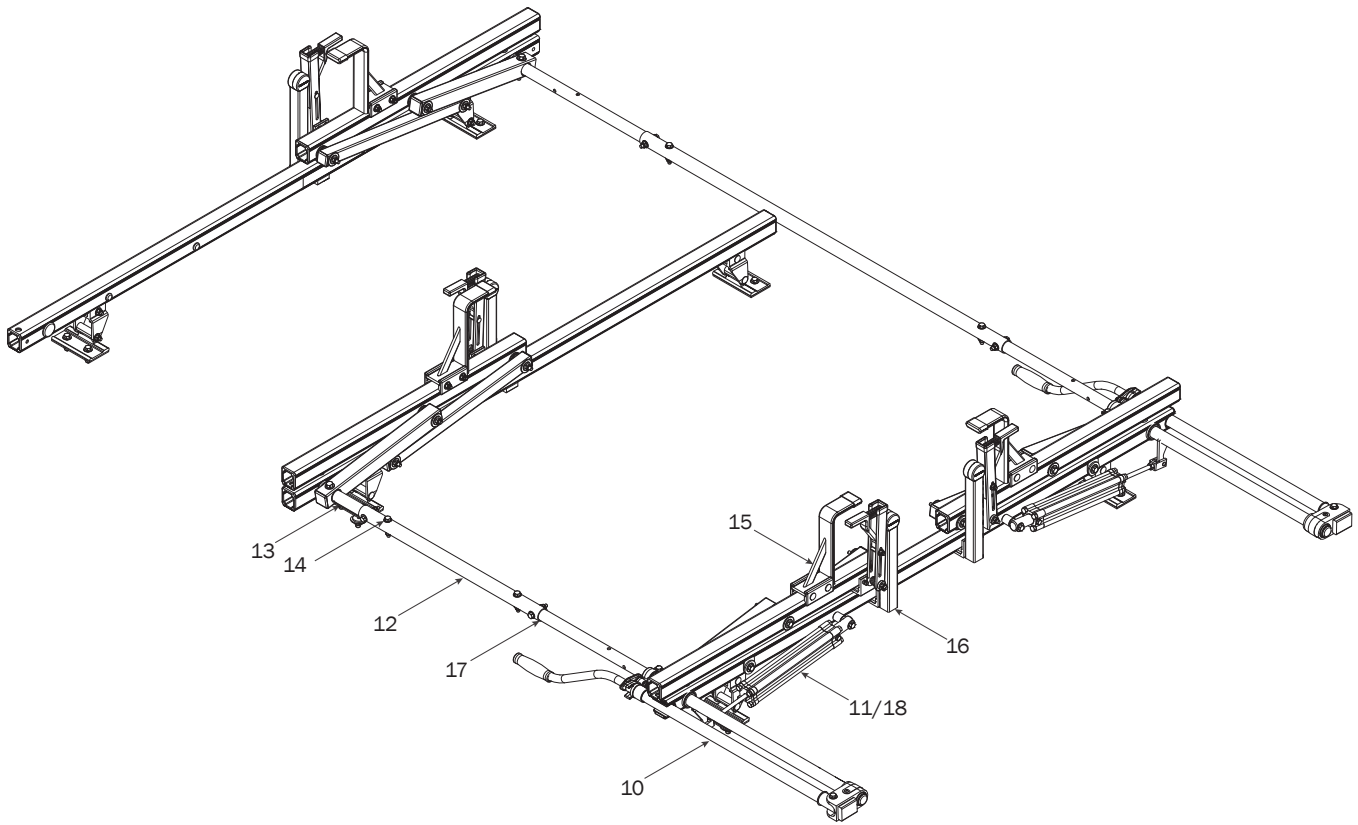

## REAR DRIVE SHAFT

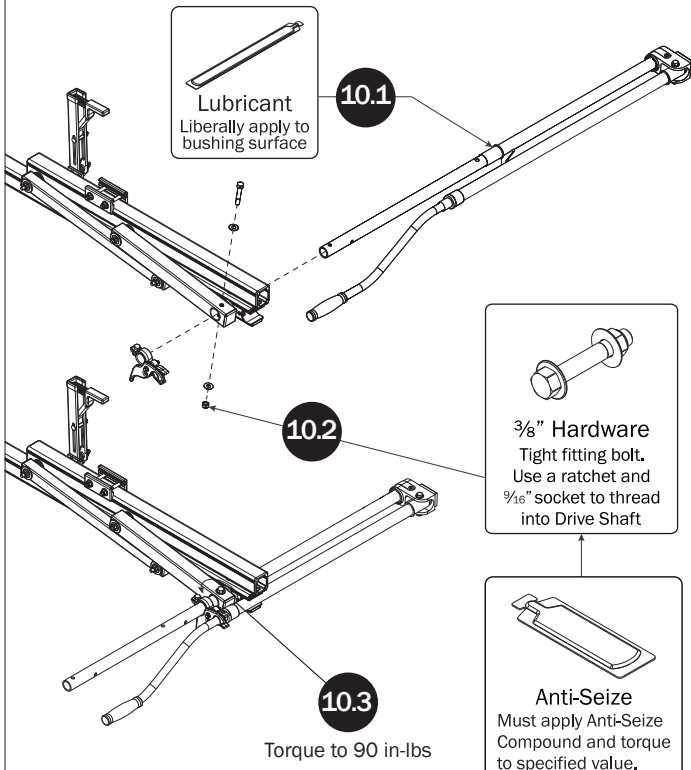

## CYLINDER HARDWARE

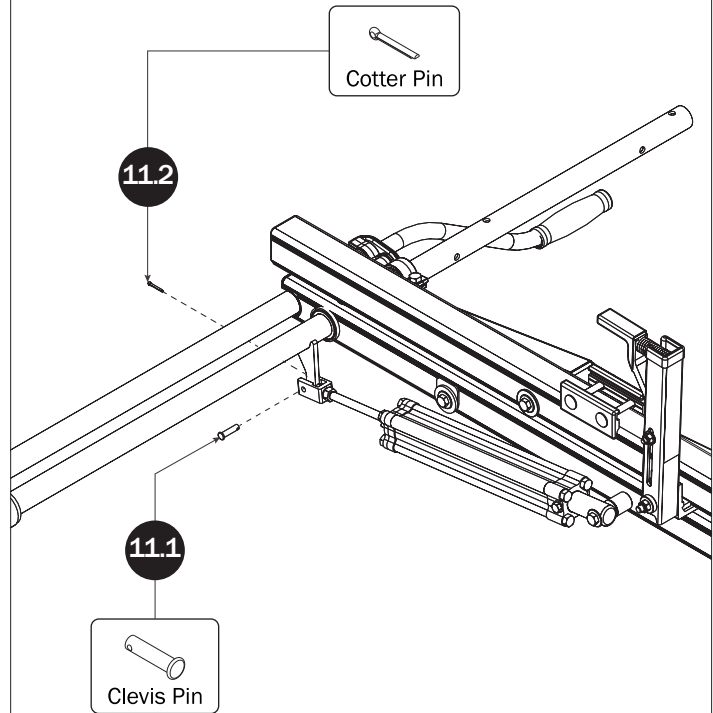

**CONNECTING BAR**

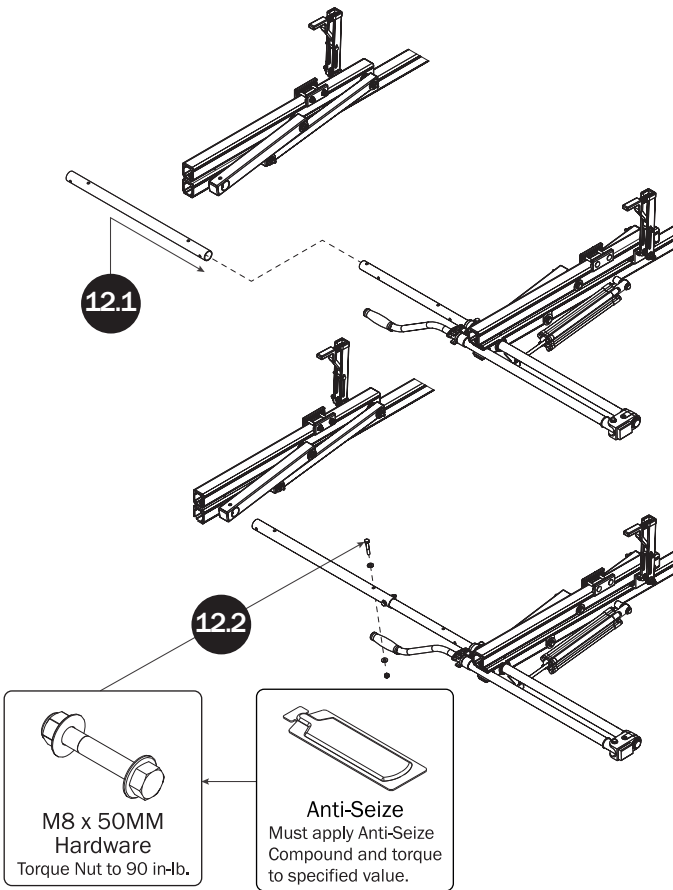

**FRONT DRIVE SHAFT**

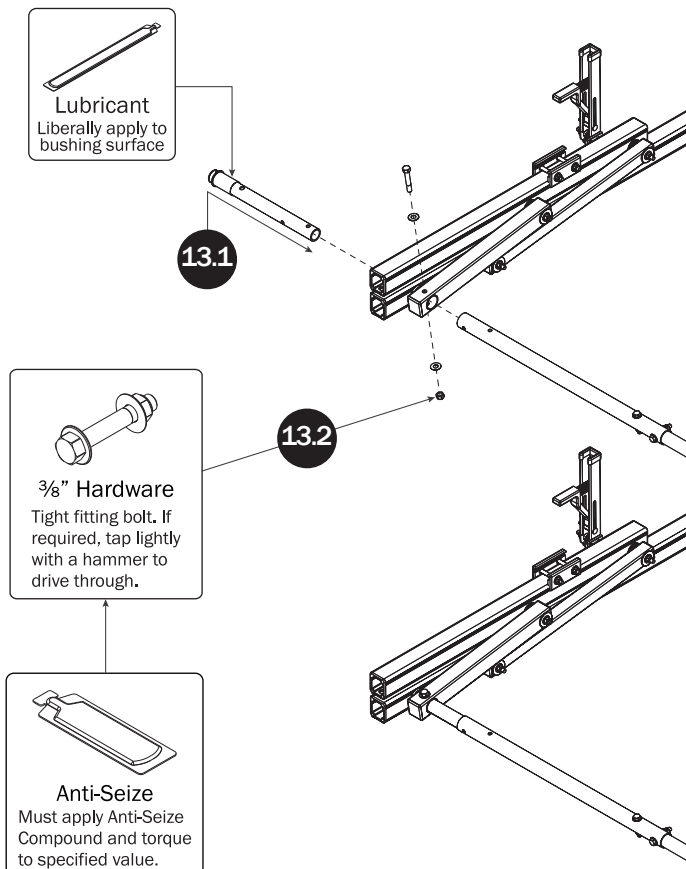

**CONNECTING BAR FASTENERS**

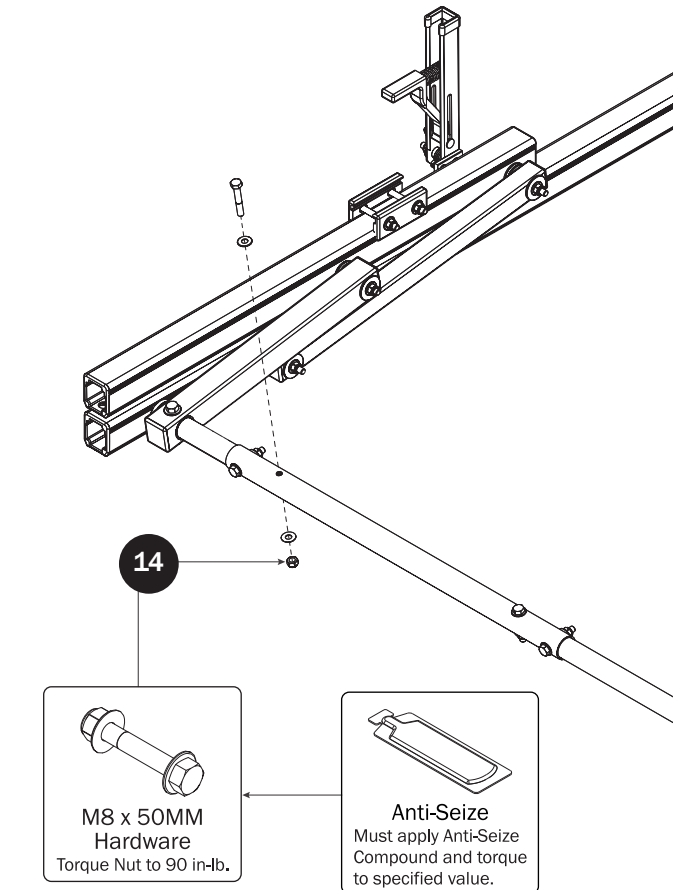

**Z POSTS**

SEE QUICK START GUIDE FOR ADJUSTMENTS

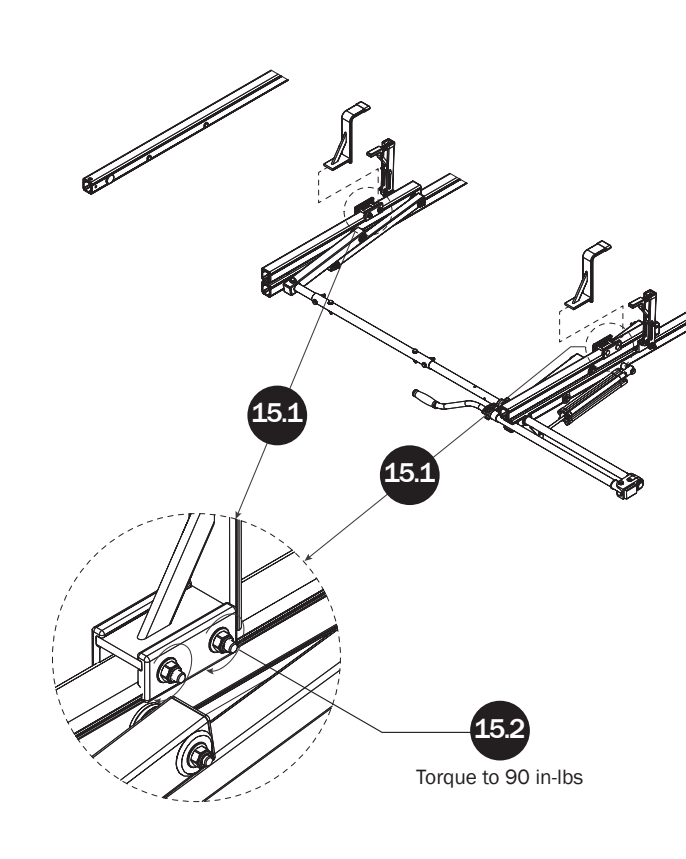

## L POSTS

SEE QUICK START GUIDE FOR ADJUSTMENTS

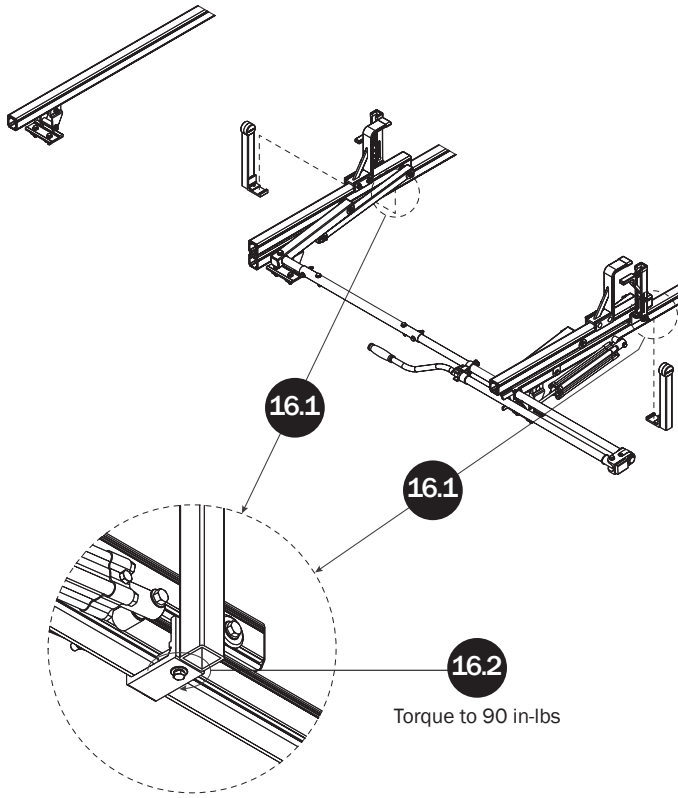

## DRIVE SHAFT SEALING

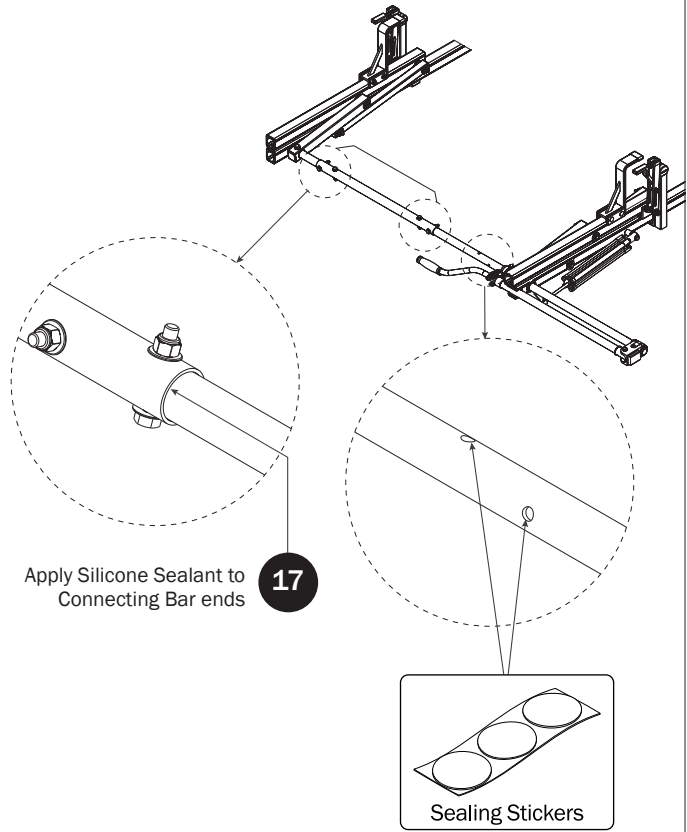

## CYLINDER ADJUSTMENT

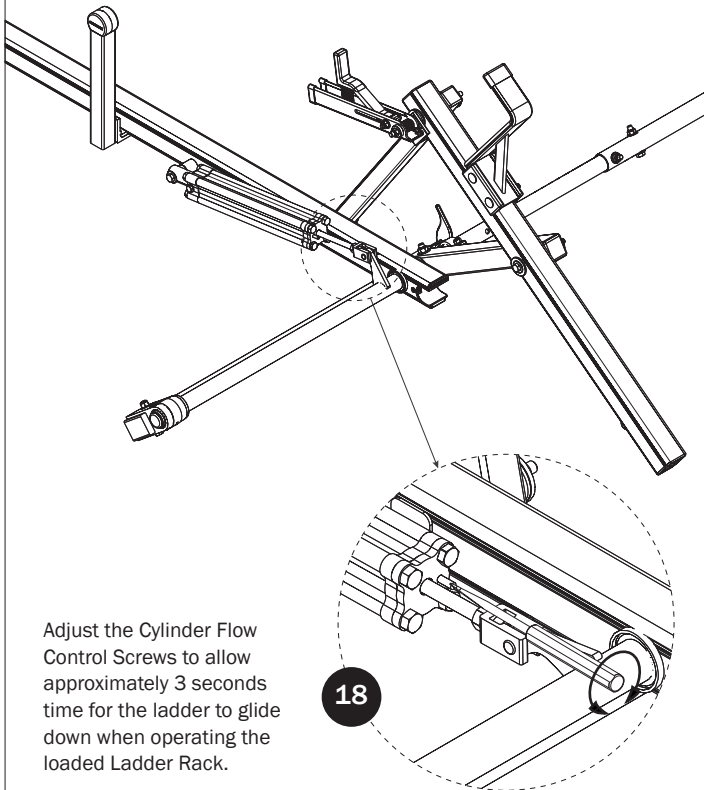

Adjust the Cylinder Flow Control Screws to allow approximately 3 seconds time for the ladder to glide down when operating the loaded Ladder Rack.

