

PRIME DESIGN™

A Safe Fleet Brand

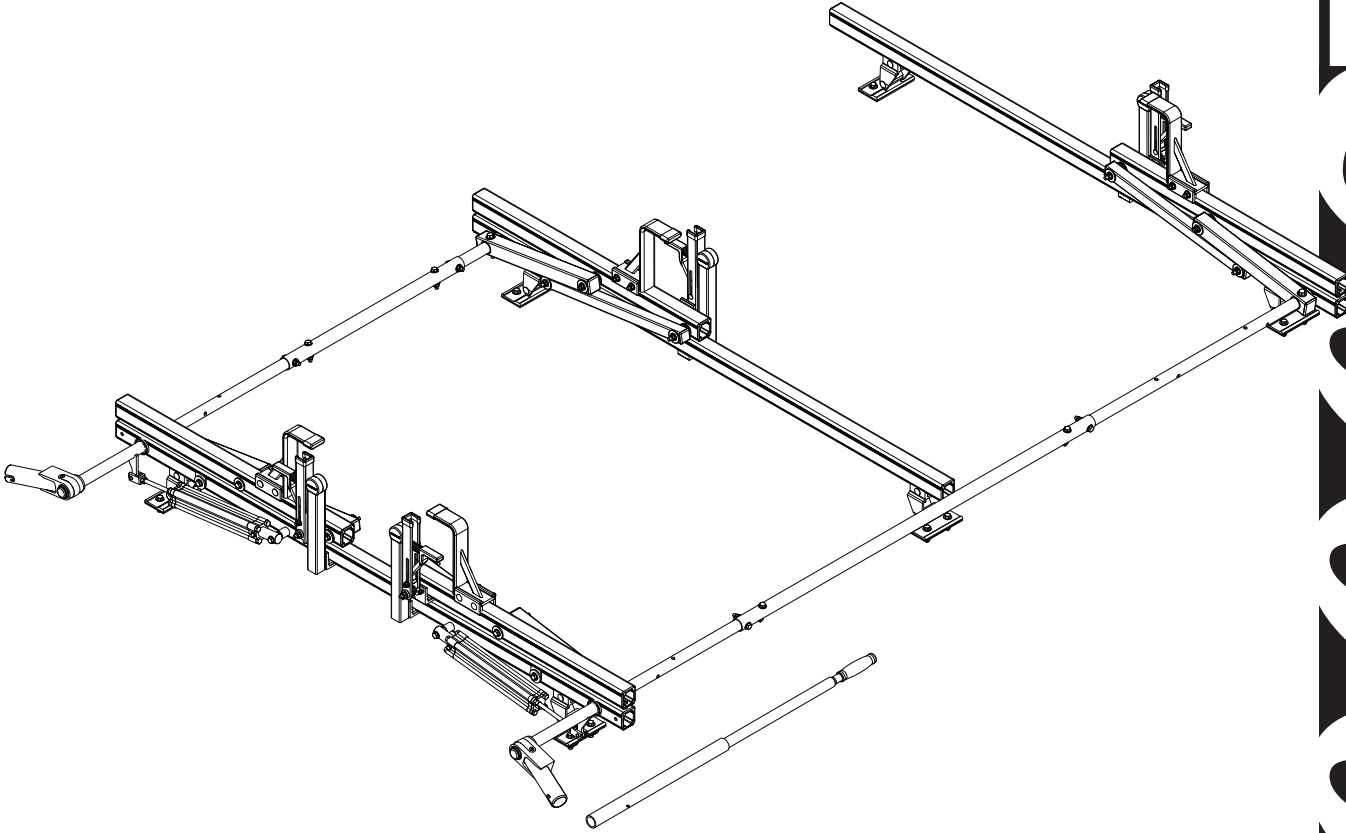

PRR3

CONTENTS OVERVIEW

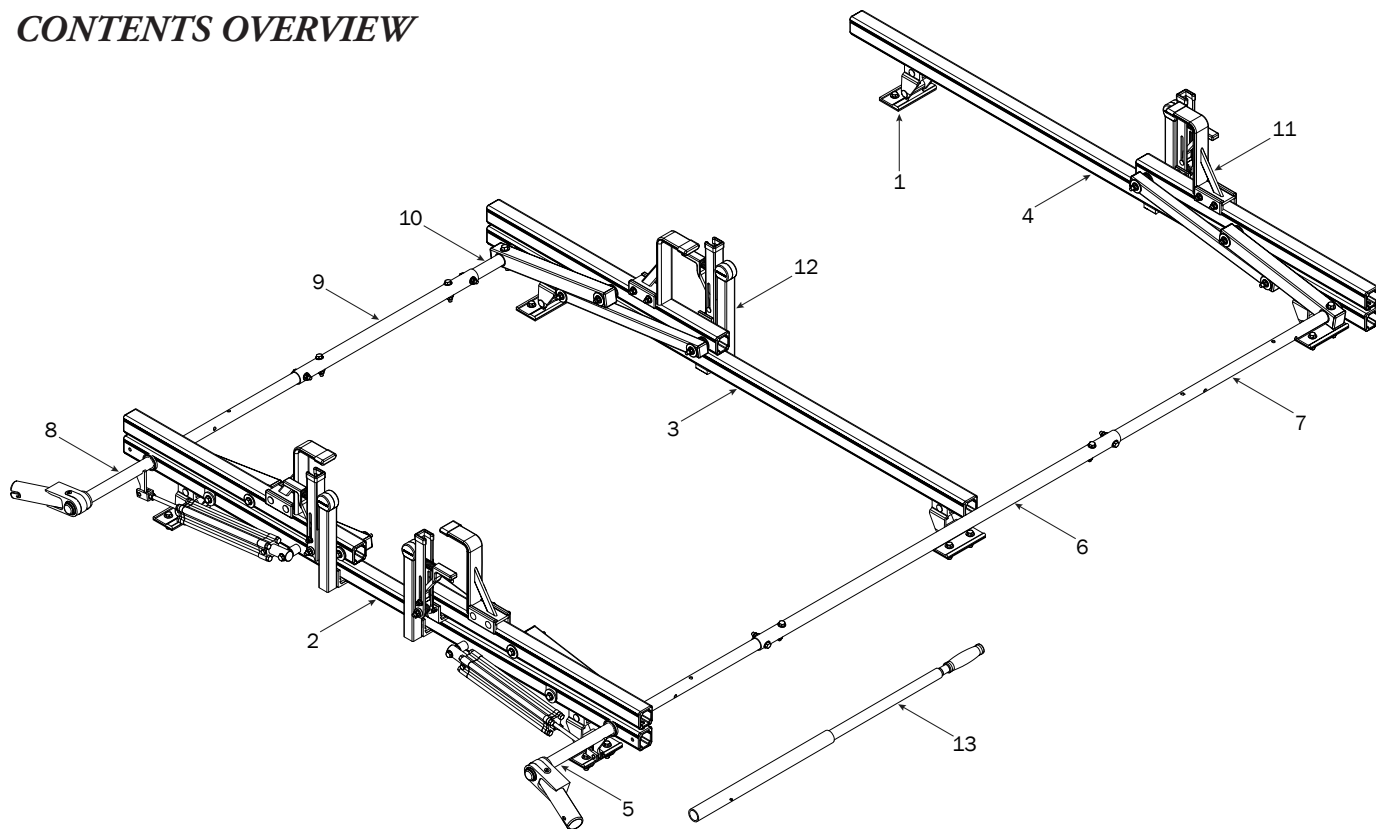

1—FBM3-0024 (Qty 1)
Mounting Brackets with HKT-8167

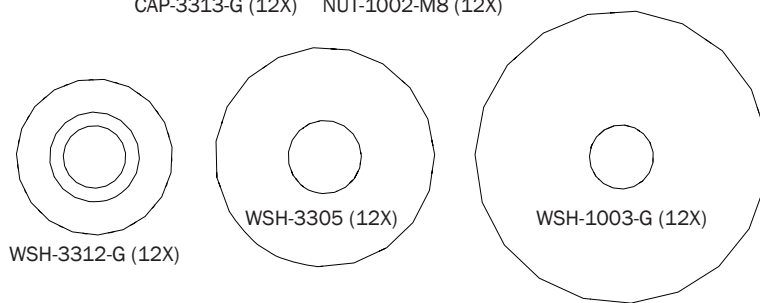
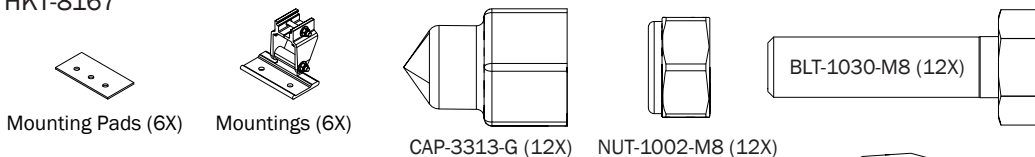

2—Rear Crossbar Assembly (Qty 1)

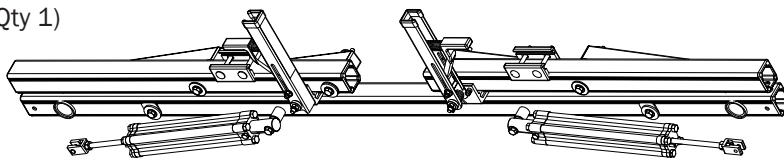

3—Center Crossbar Assembly (Qty 1)

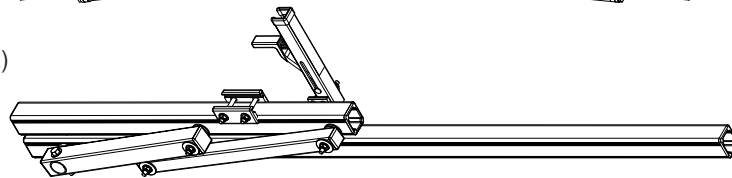

4—Front Crossbar Assembly (Qty 1)

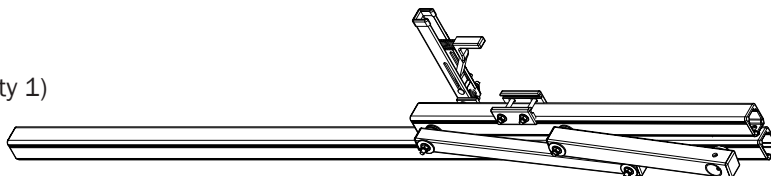

5—Rear Drive Shaft..... (Qty 1)
Right Hand, 34.00”

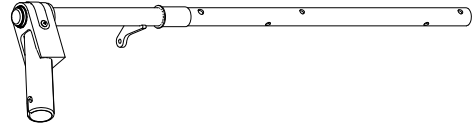

6—Connecting Bar..... (Qty 1)
48.00”



7—Front Drive Shaft..... (Qty 1)
B Version, 35.75”

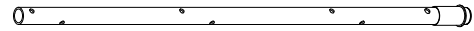

8—Rear Drive Shaft..... (Qty 1)
Left Hand, 34.00”

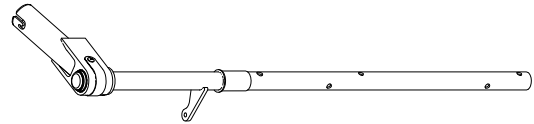

9—Connecting Bar..... (Qty 1)
24.00”

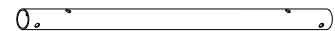

10—Front Drive Shaft..... (Qty 1)
B Version, 11.75”

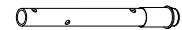

11—Z Post..... (Qty 4)
Adjustable, 7.25”

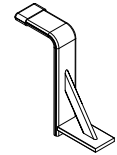

12—L Post..... (Qty 4)
Generation 2, Auto Clamp 2, 9.25”

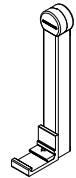

13—Removeable Handle..... (Qty 1)
35.00”



14—HKT-8163-Rotation Hardware Kit..... (Qty 2)
(Not called out in Overview)

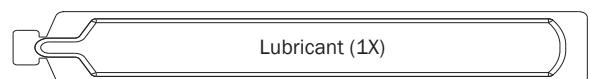
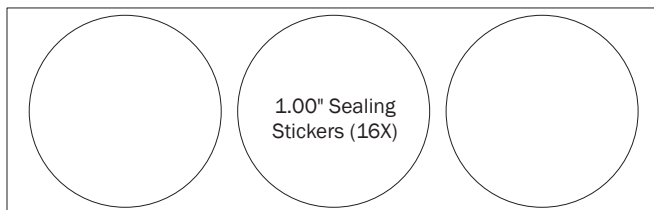
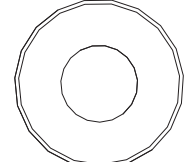
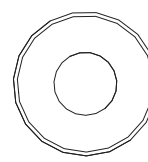
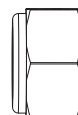
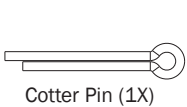
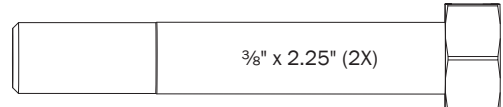
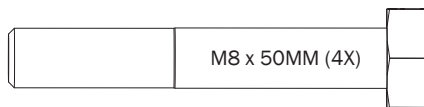

FBM3-0024

8' (96") CONFIGURATION

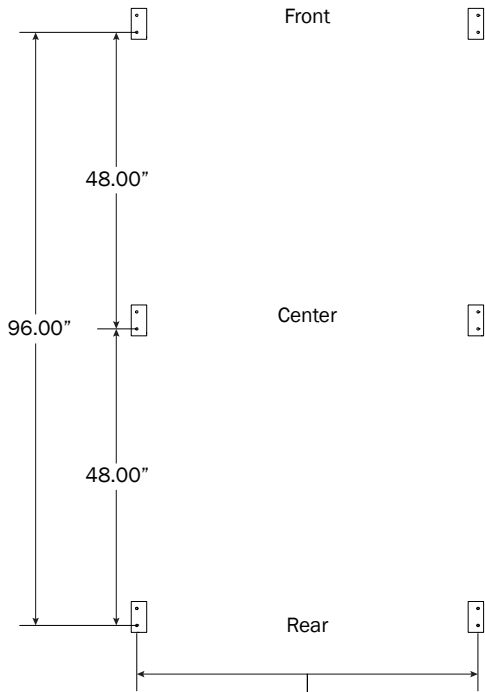

Mounting Bracket's left to right spread to be determined according to cap manufacturer's designated locations.

7' (84") CONFIGURATION

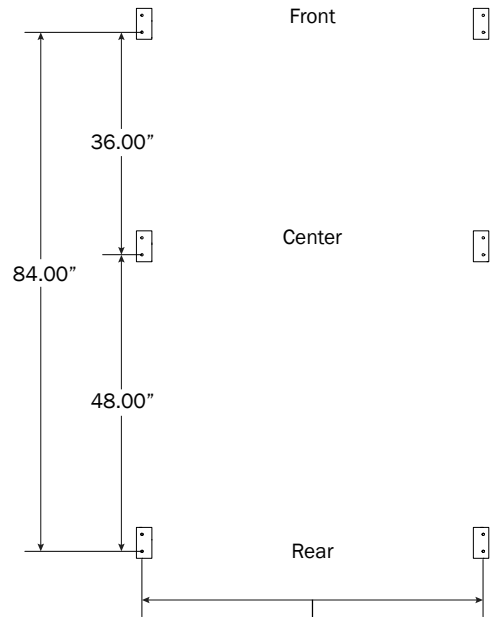

Mounting Bracket's left to right spread to be determined according to cap manufacturer's designated locations.

6' (72") CONFIGURATION

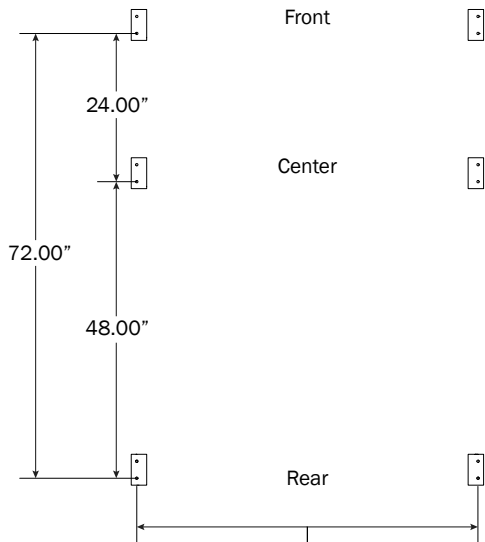

Mounting Bracket's left to right spread to be determined according to cap manufacturer's designated locations.

5' (60") CONFIGURATION

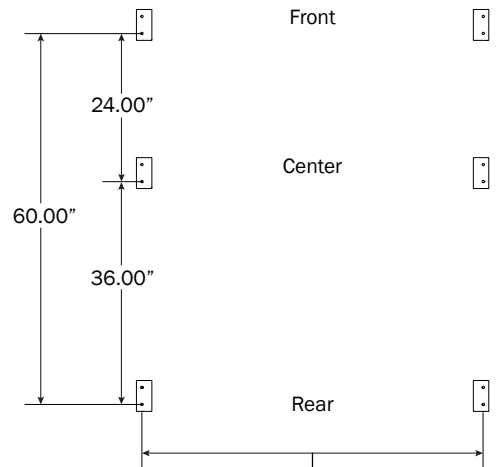

Mounting Bracket's left to right spread to be determined according to cap manufacturer's designated locations.

0.1 Assemble and install the Mounting Brackets as shown below.

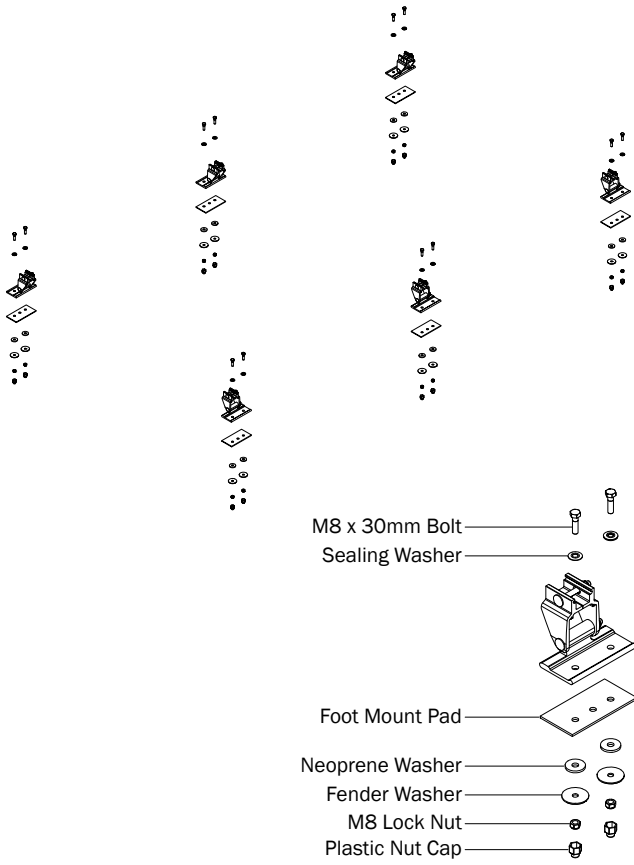

0.2

Torque all Mounting Bracket bolts to 90 in-lbs

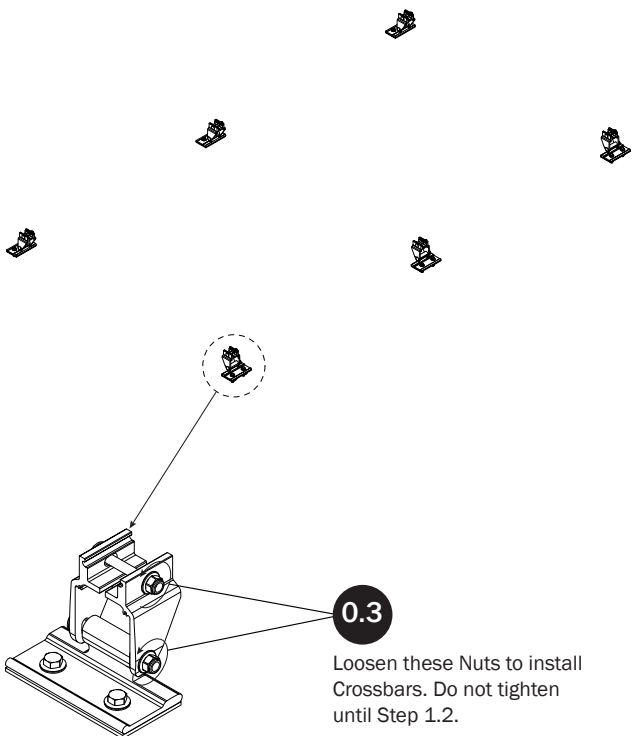

RIGHT SIDE ROTATION ASSEMBLY

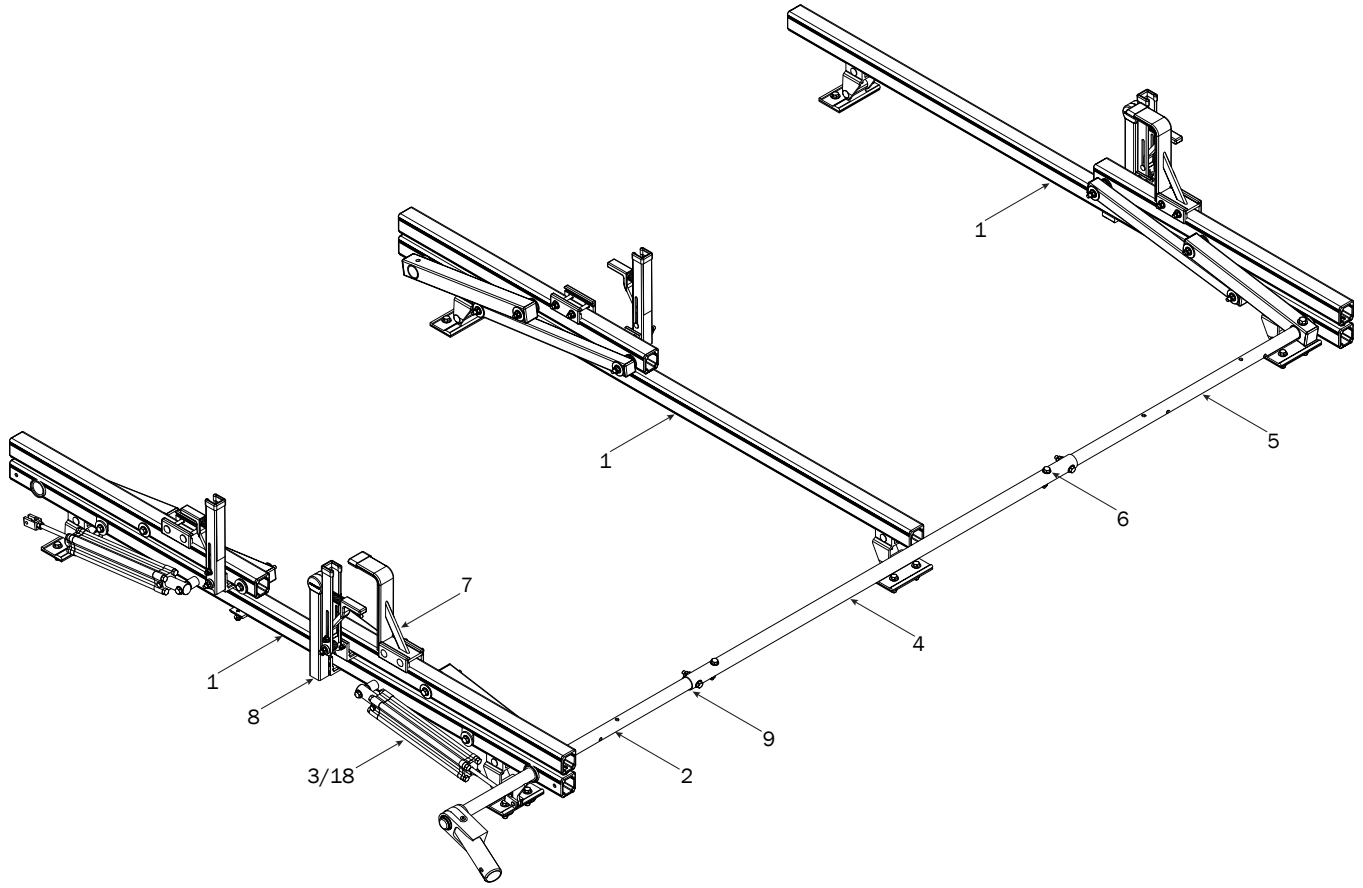

CROSSBARS

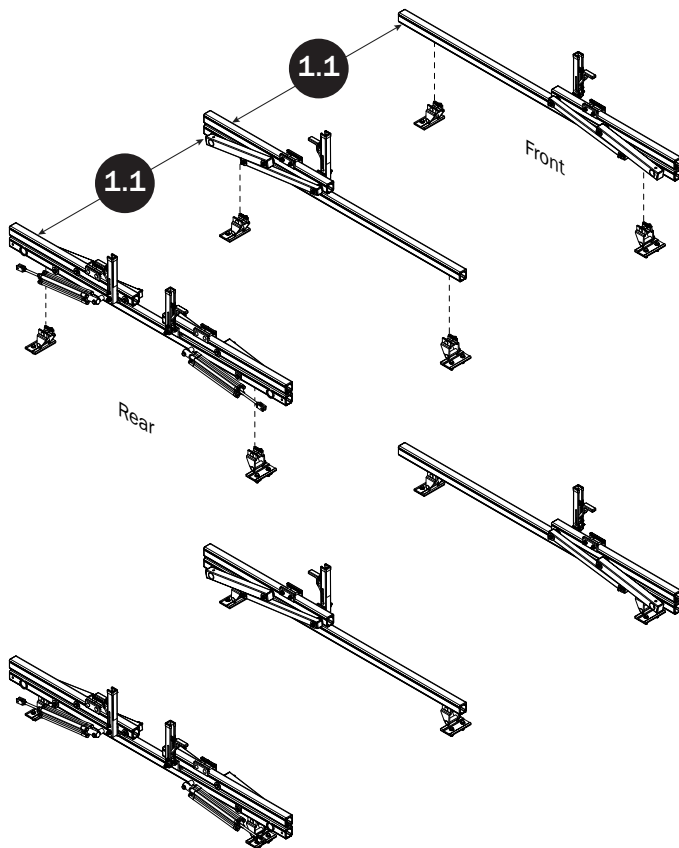

CROSSBAR ADJUSTMENT

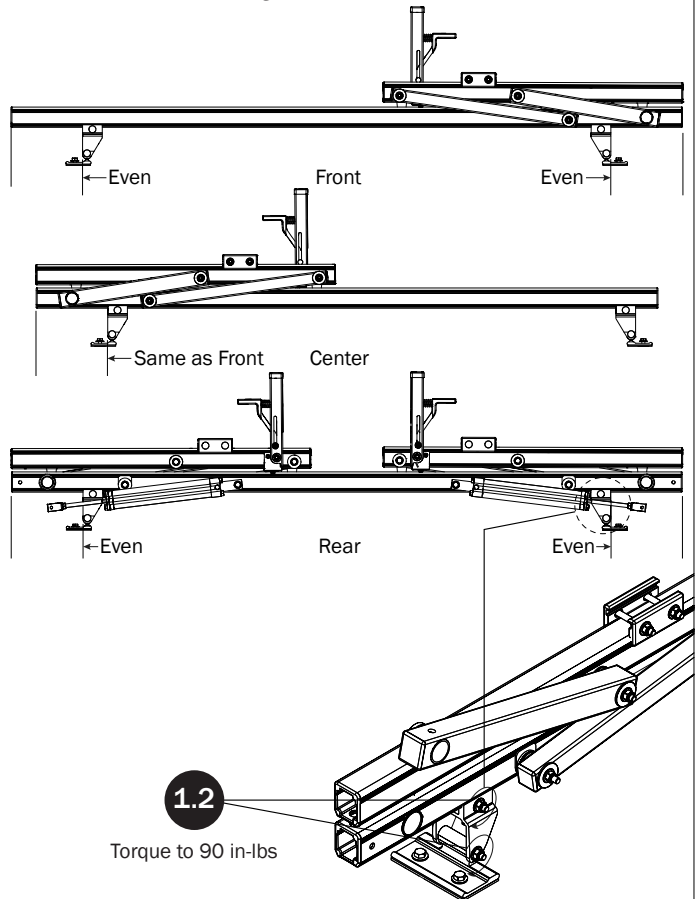

REAR DRIVE SHAFT

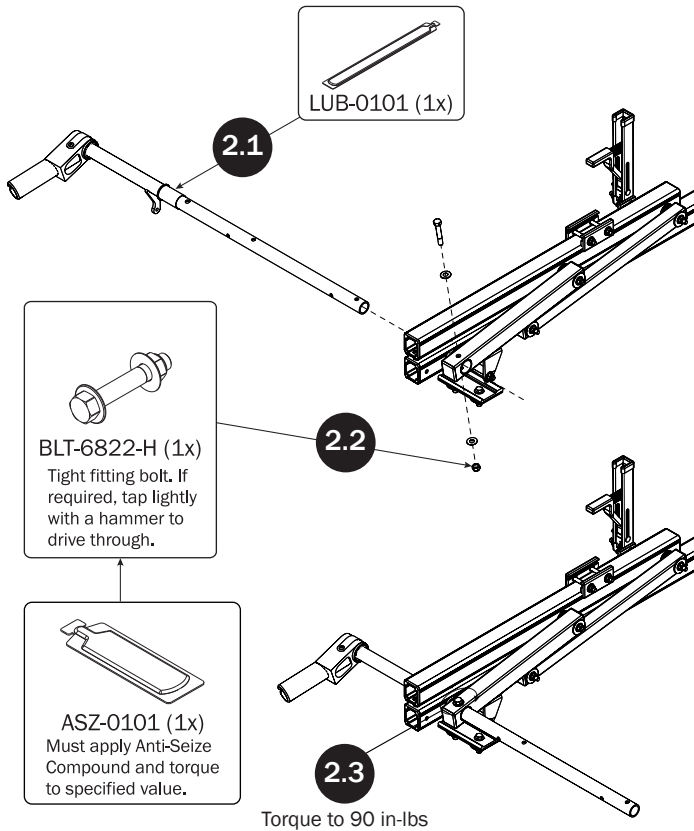

CYLINDER HARDWARE

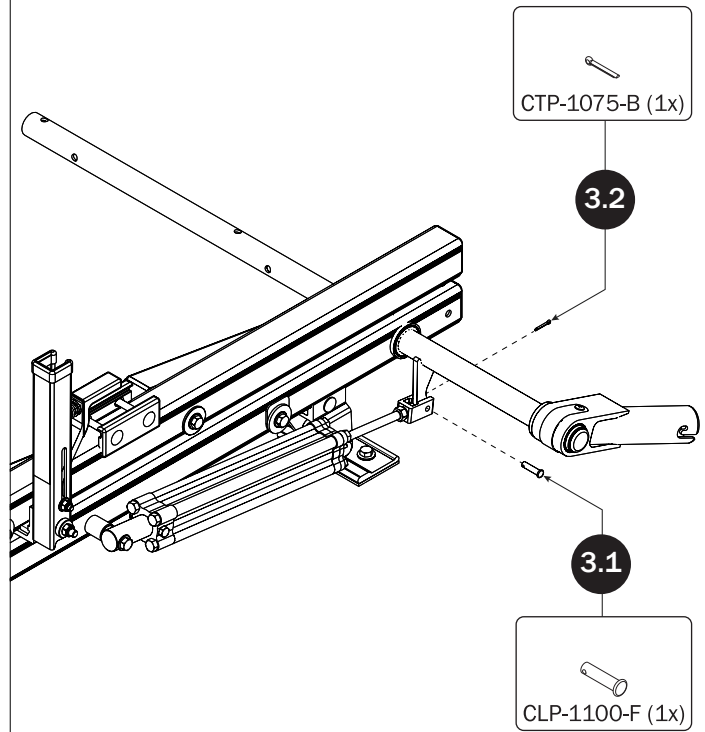

CONNECTING BAR

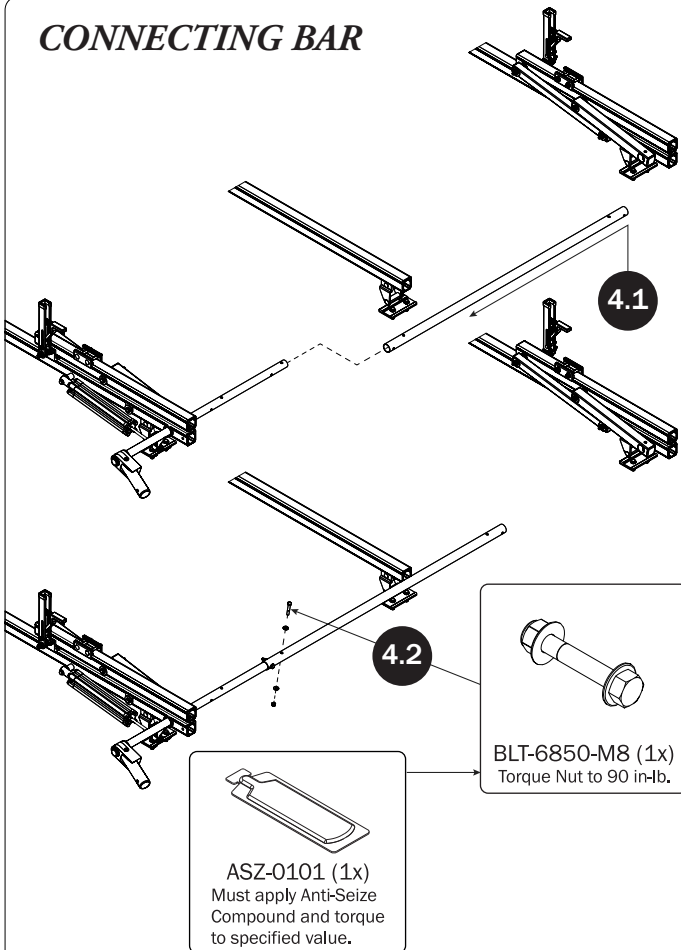

FRONT DRIVE SHAFT

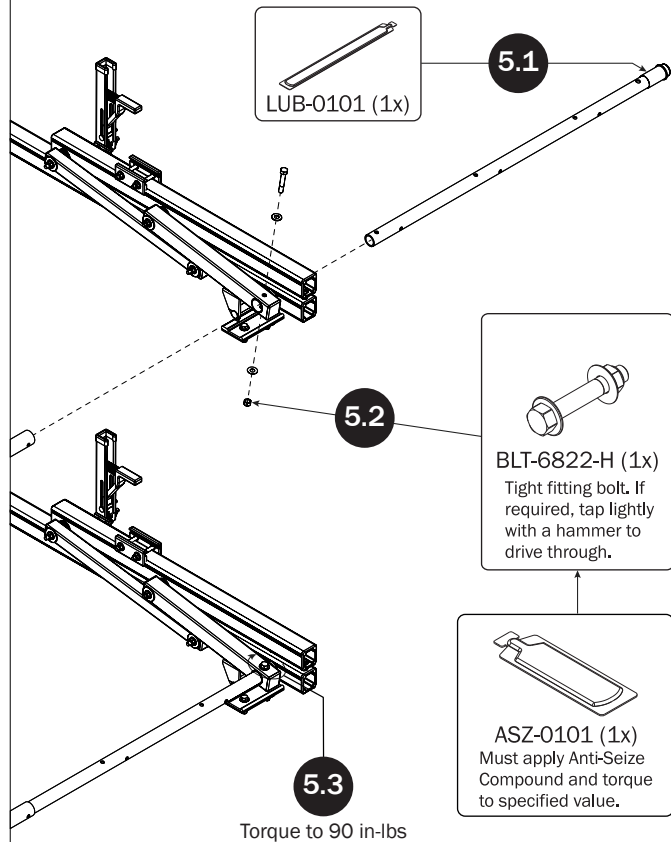

CONNECTING BAR FASTENERS

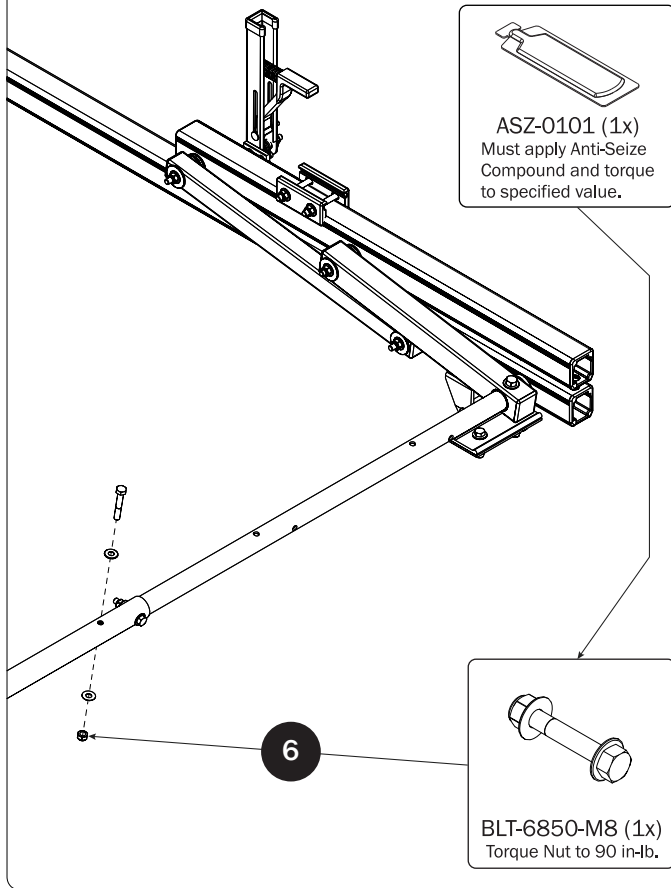

Z POSTS
SEE QUICK START GUIDE FOR ADJUSTMENTS

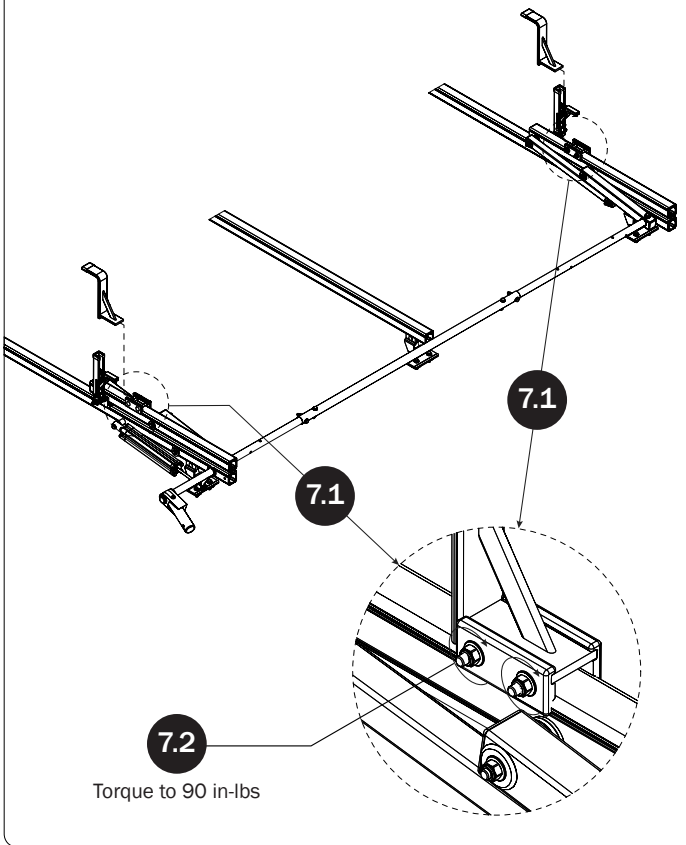

L POSTS
SEE QUICK START GUIDE FOR ADJUSTMENTS

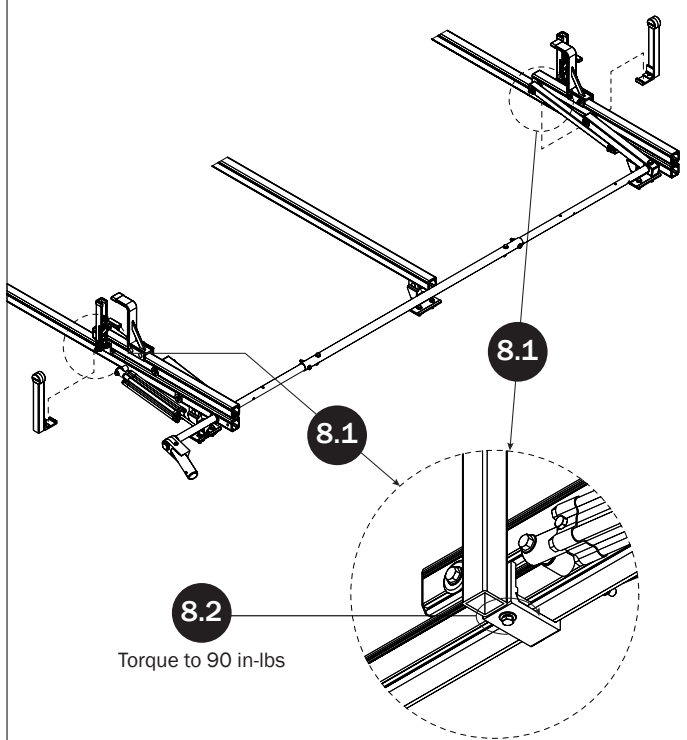

DRIVE SHAFT SEALING

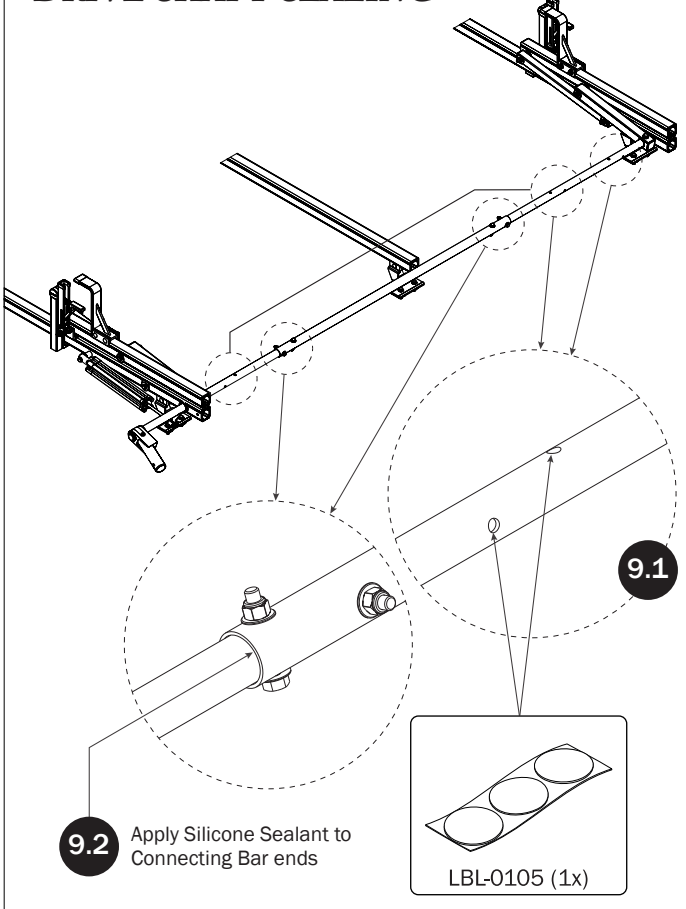

LEFT SIDE ROTATION ASSEMBLY

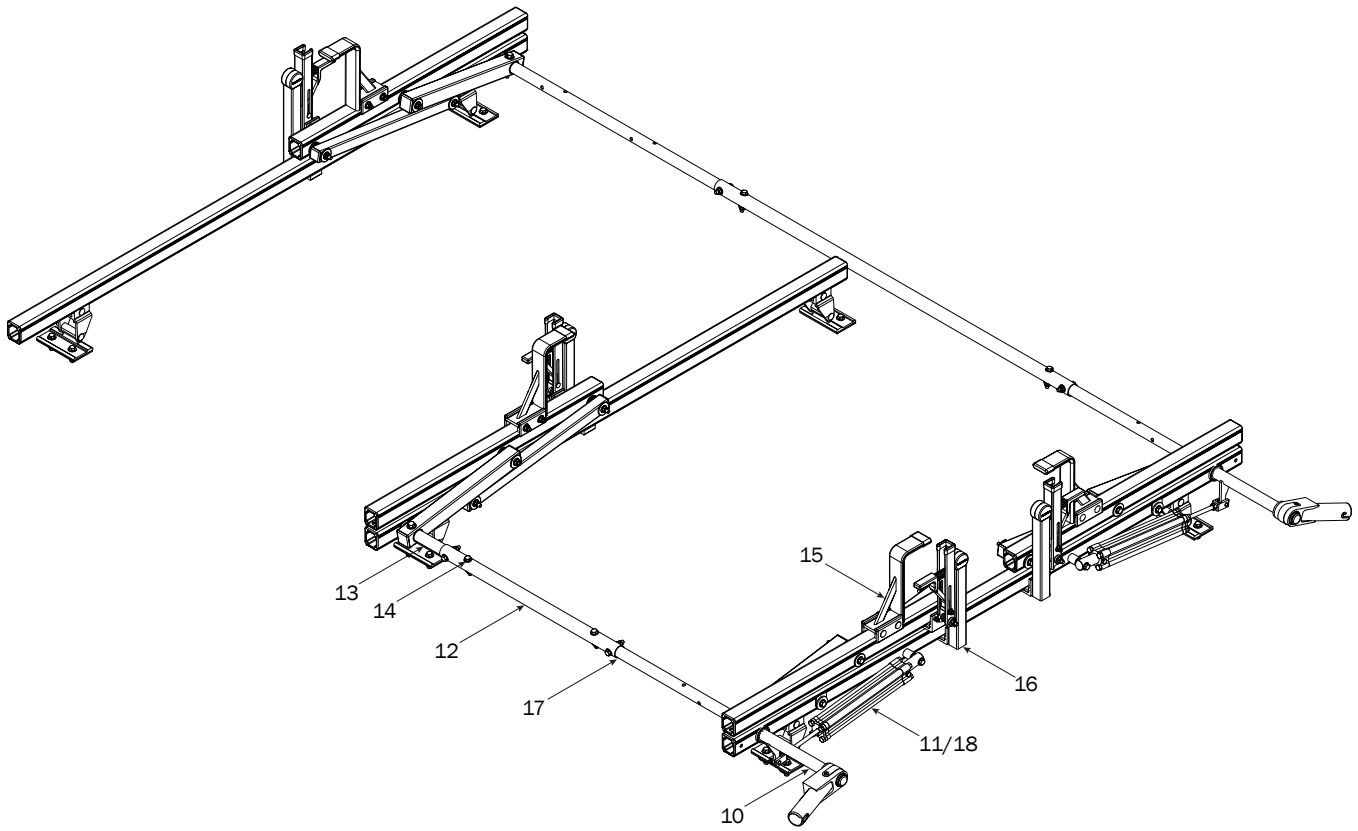

REAR DRIVE SHAFT

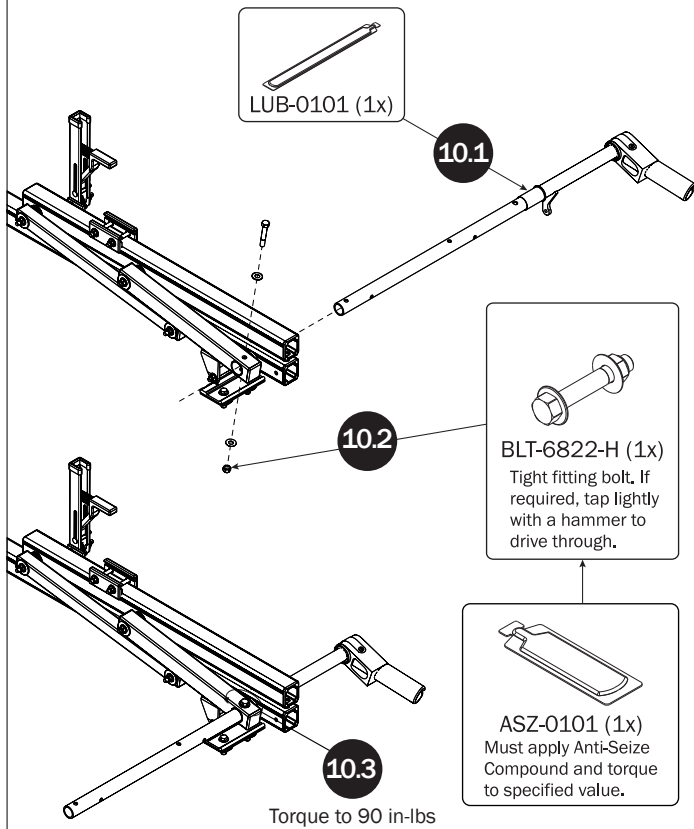

CYLINDER HARDWARE

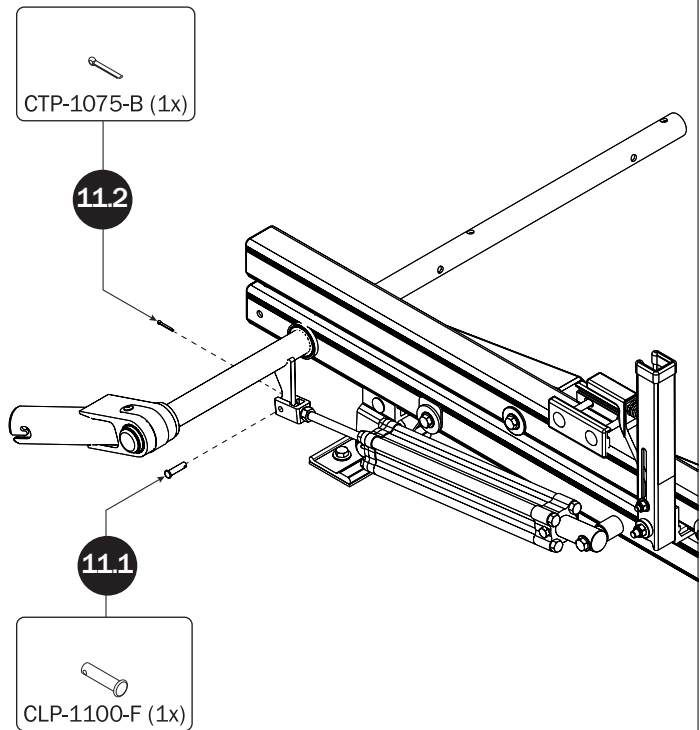

CONNECTING BAR

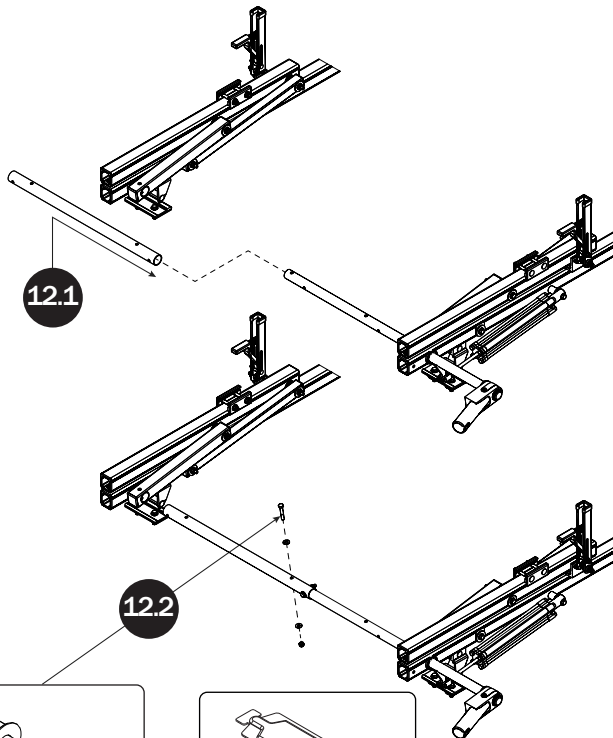

BLT-6850-M8 (1x)
Torque Nut to 90 in-lb.

ASZ-0101 (1x)
Must apply Anti-Seize Compound and torque to specified value.

FRONT DRIVE SHAFT

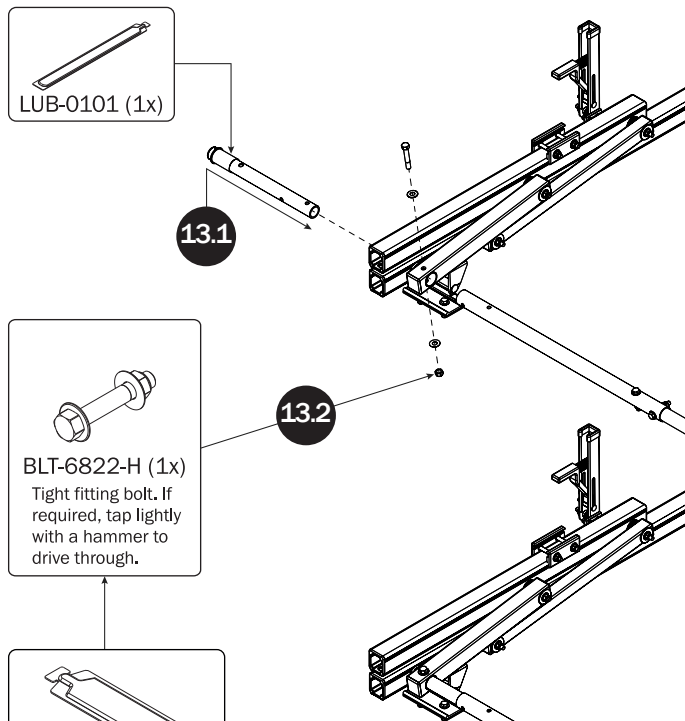

LUB-0101 (1x)

BLT-6822-H (1x)
Tight fitting bolt. If required, tap lightly with a hammer to drive through.

ASZ-0101 (1x)
Must apply Anti-Seize Compound and torque to specified value.

CONNECTING BAR FASTENERS

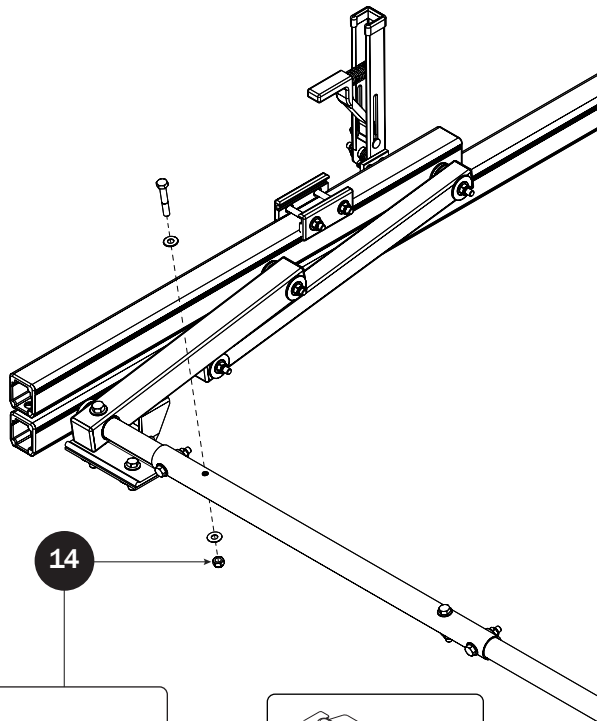

BLT-6850-M8 (1x)
Torque Nut to 90 in-lb.

ASZ-0101 (1x)
Must apply Anti-Seize Compound and torque to specified value.

Z POSTS

SEE QUICK START GUIDE FOR ADJUSTMENTS

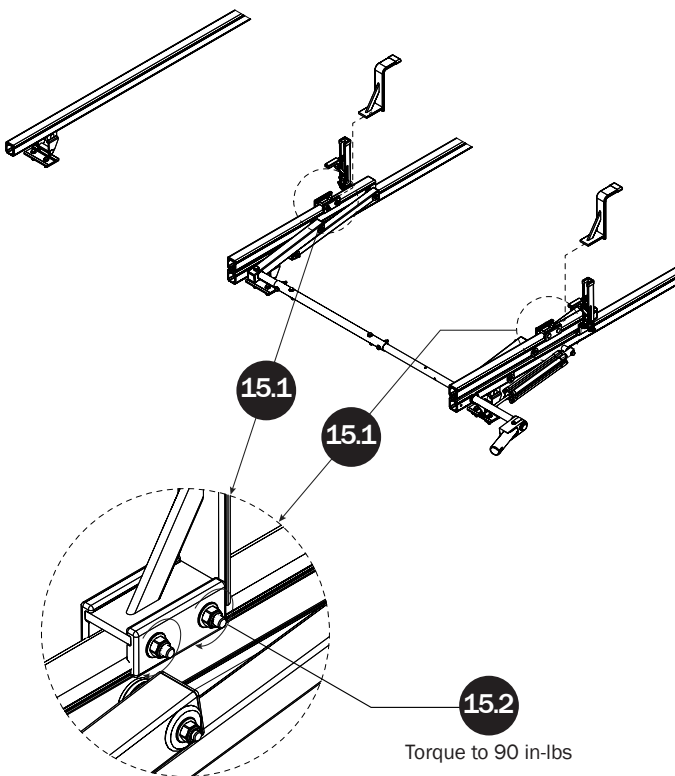

15.2
Torque to 90 in-lbs

L POSTS

SEE QUICK START GUIDE FOR ADJUSTMENTS

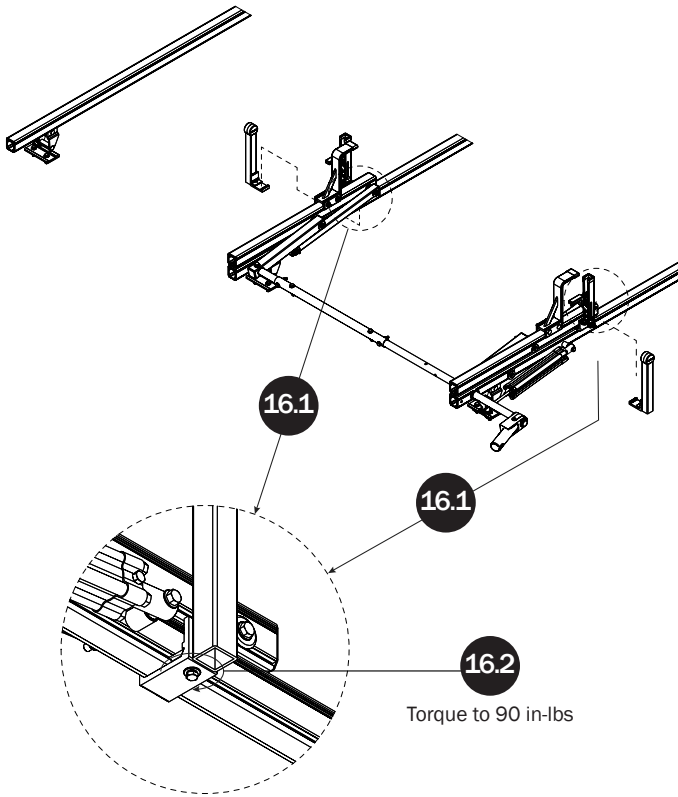

DRIVE SHAFT SEALING

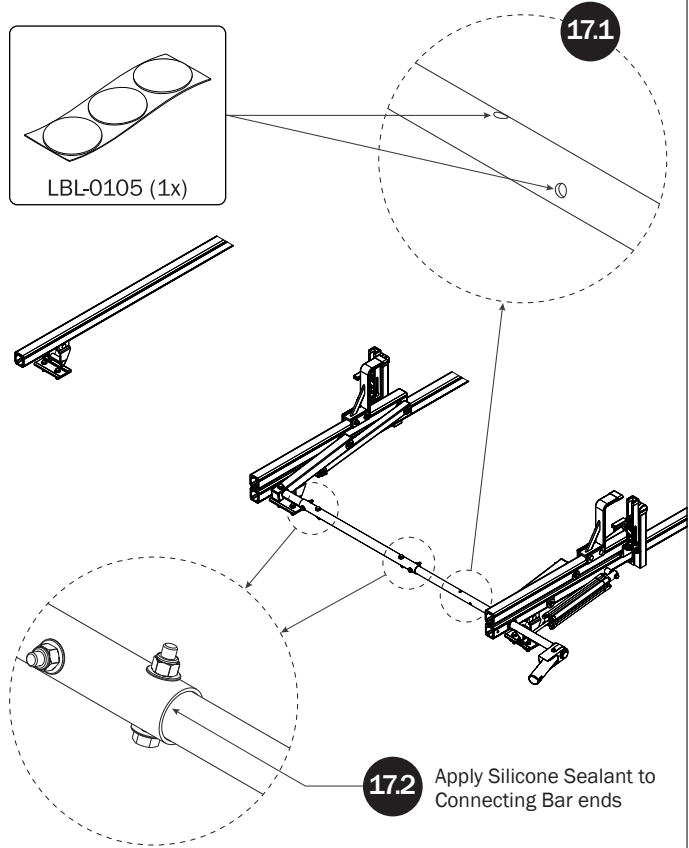

CYLINDER ADJUSTMENT

