

PRIME DESIGN™

A Safe Fleet Brand

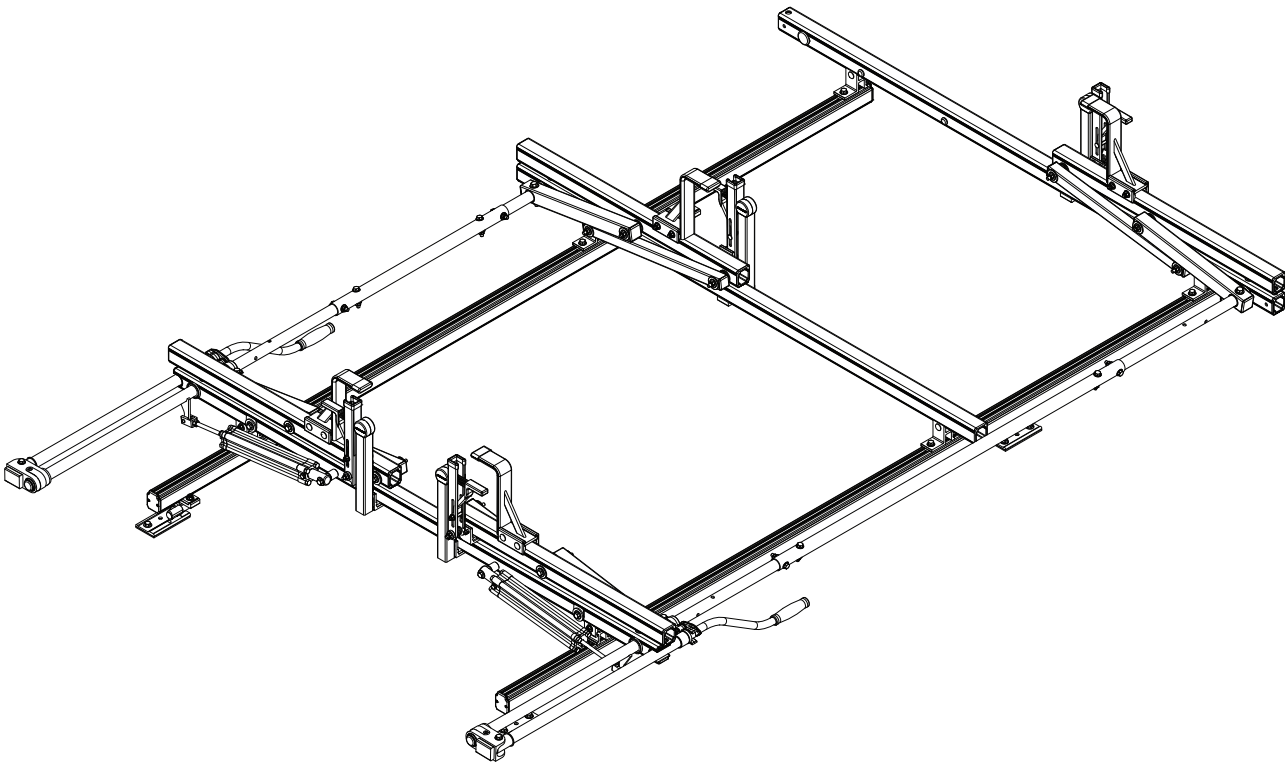

PRR3

CONTENTS OVERVIEW

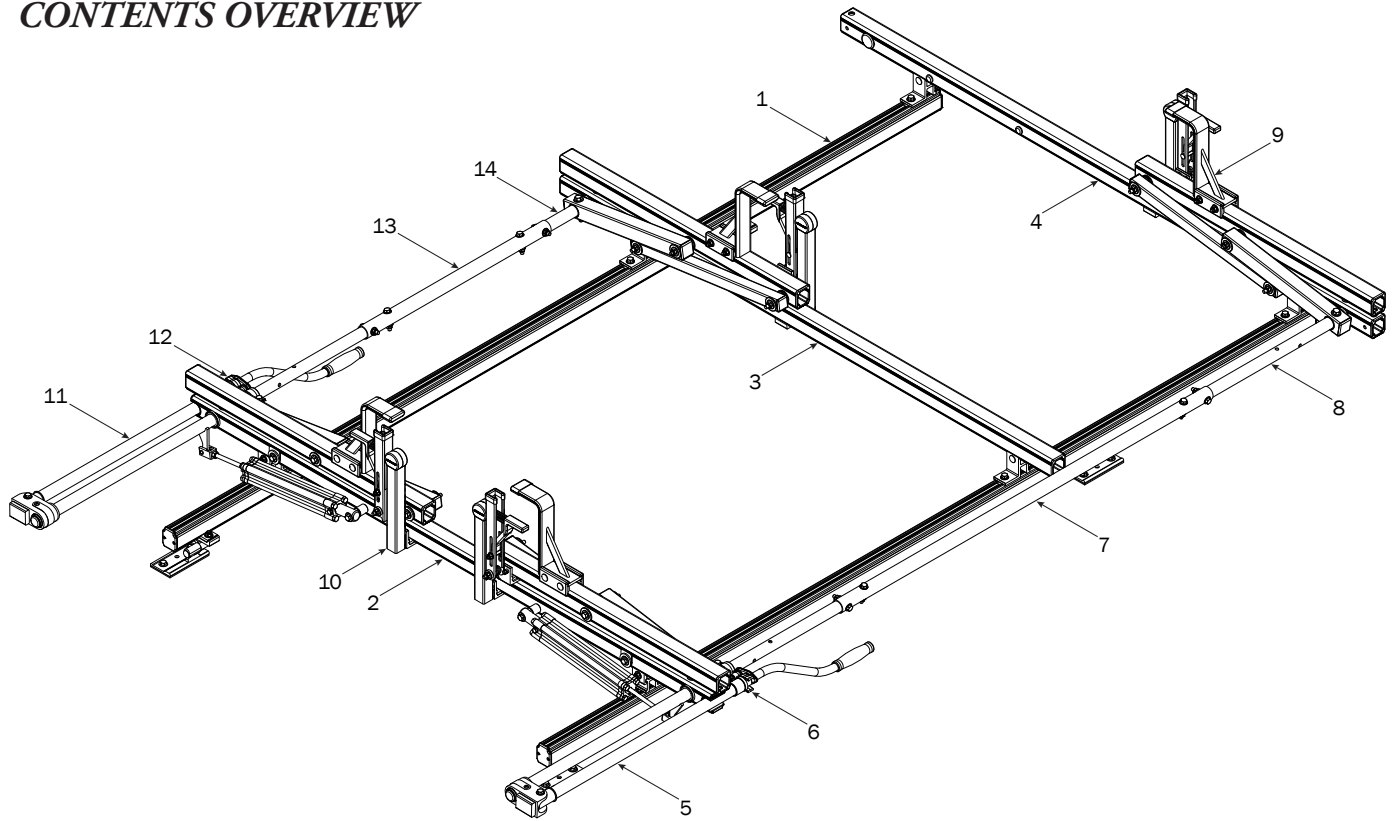

1—FBM3-0019 (Qty 1)
Suspension Bars w/Hardware



Channels (2X)



Screws (8X)

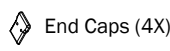

End Caps (4X)



Brackets (6X)



Mountings (4X)

2—Rear Crossbar Assembly..... (Qty 1)

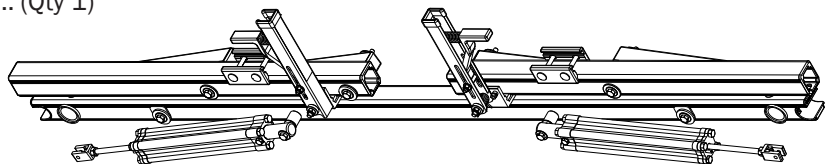

3—Center Crossbar Assembly..... (Qty 1)

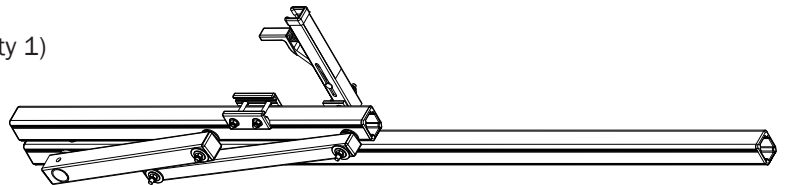

4—Front Crossbar Assembly (Qty 1)

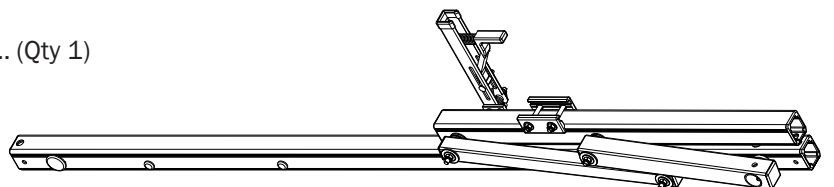

5—Rear Drive Shaft..... (Qty 1)
Right Hand, B4 Version, 46.00”

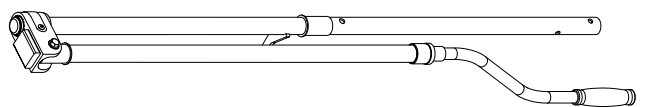

6—Handle Latch Assembly (Qty 1)
Right Hand



7—Connecting Bar (Qty 1)
4.00'

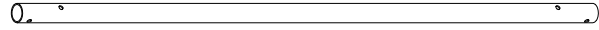

8—Front Drive Shaft (Qty 1)
B Version, 35.75"

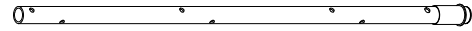

9—Z Post (Qty 4)
Adjustable, 7.25"

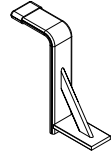

10—L Post (Qty 4)
Roller Cap, 9.25"
(Requires partial disassembly for installation)

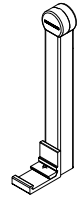

11—Rear Drive Shaft (Qty 1)
Left Hand, B4 Version, 46.00"

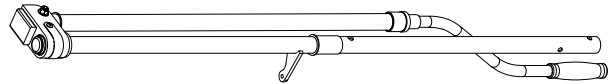

12—Handle Latch Assembly (Qty 1)
Left Hand



13—Connecting Bar (Qty 1)
24.00"

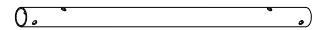

14—Front Drive Shaft (Qty 1)
B Version, 11.75"

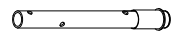

15—HKT-8163-Rotation Hardware Kit (Qty 2)
(Not called out in Overview)

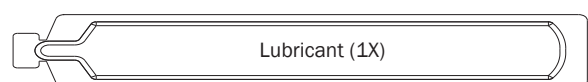
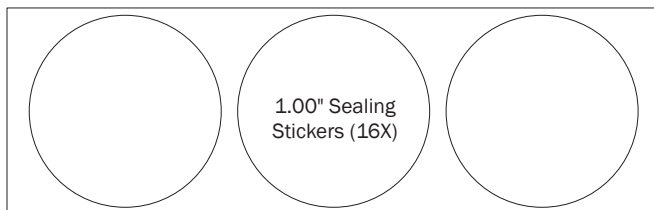
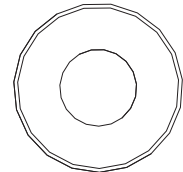
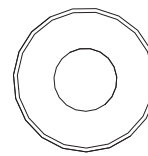
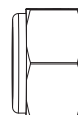
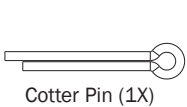
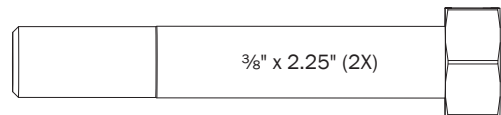
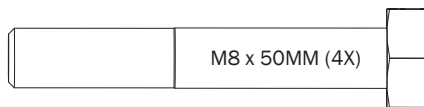

FBM3-0019
Shown on Generic Cap

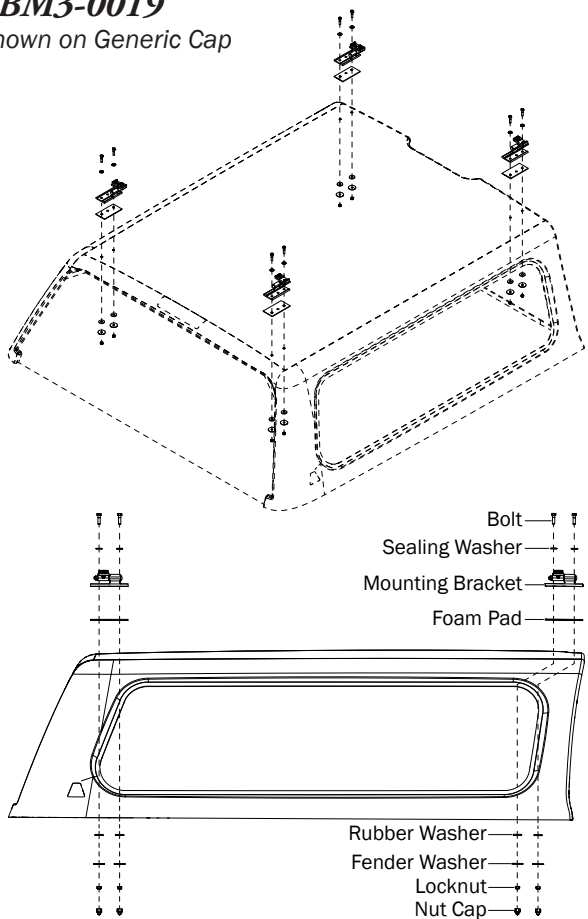

0.1 Set mountings into pre-drilled holes as shown.

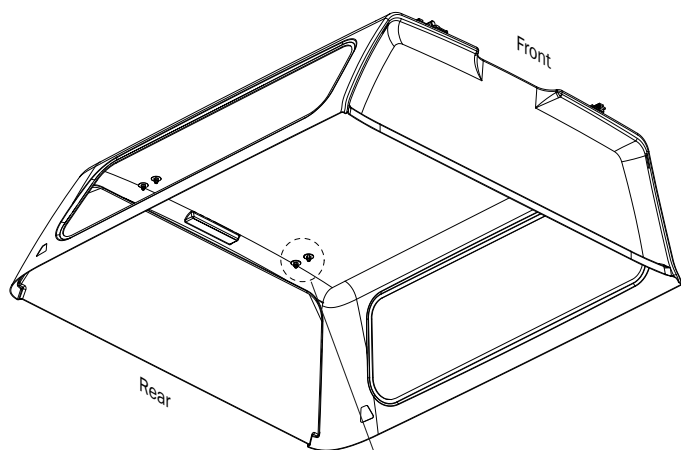
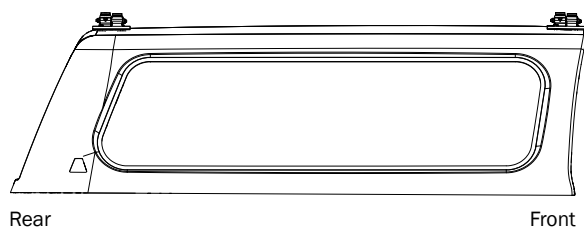
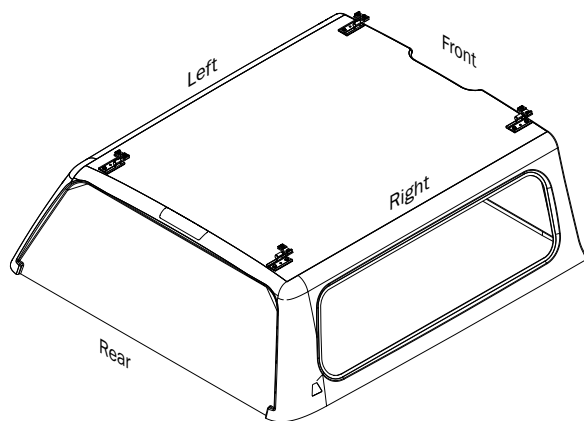

Anti-Seize
Must apply Anti-Seize Compound and torque to specified value.

Torque nuts to 90 in-lbs **0.2**

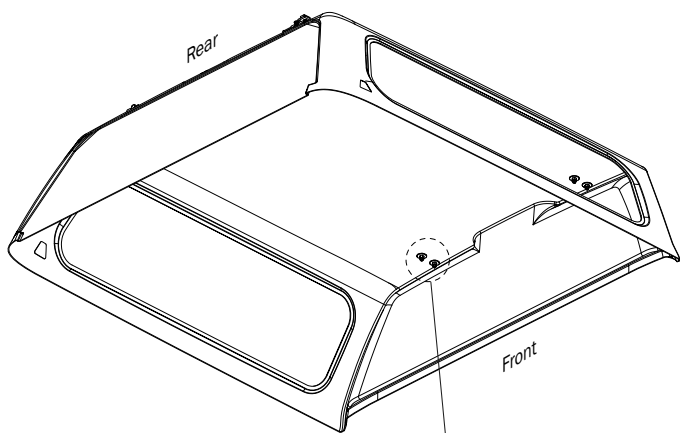

Anti-Seize
Must apply Anti-Seize Compound and torque to specified value.

Torque nuts to 90 in-lbs **0.3**

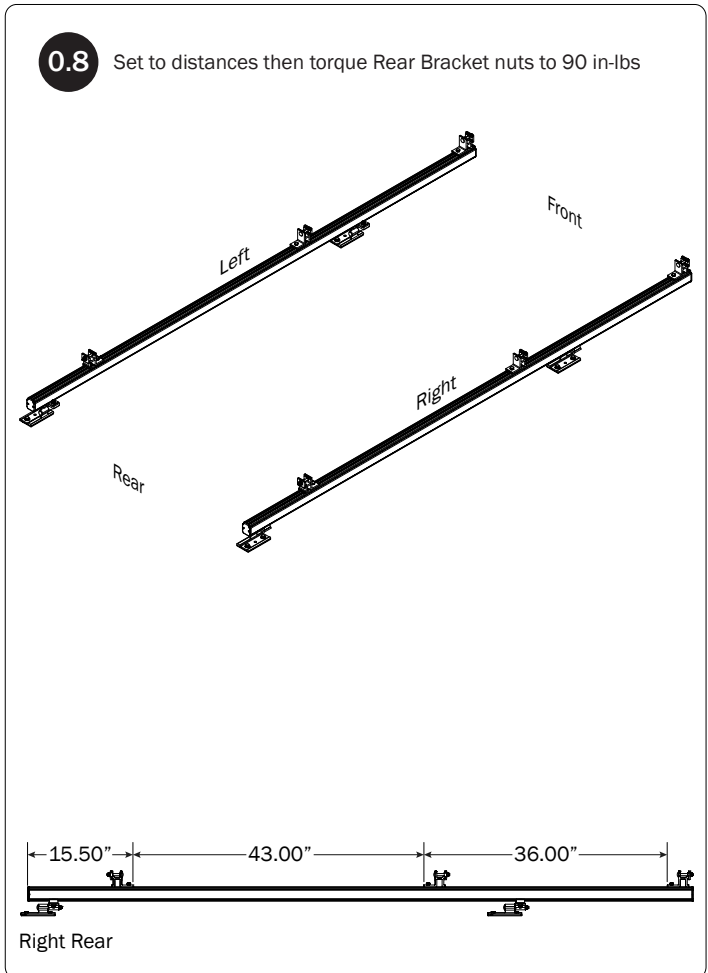
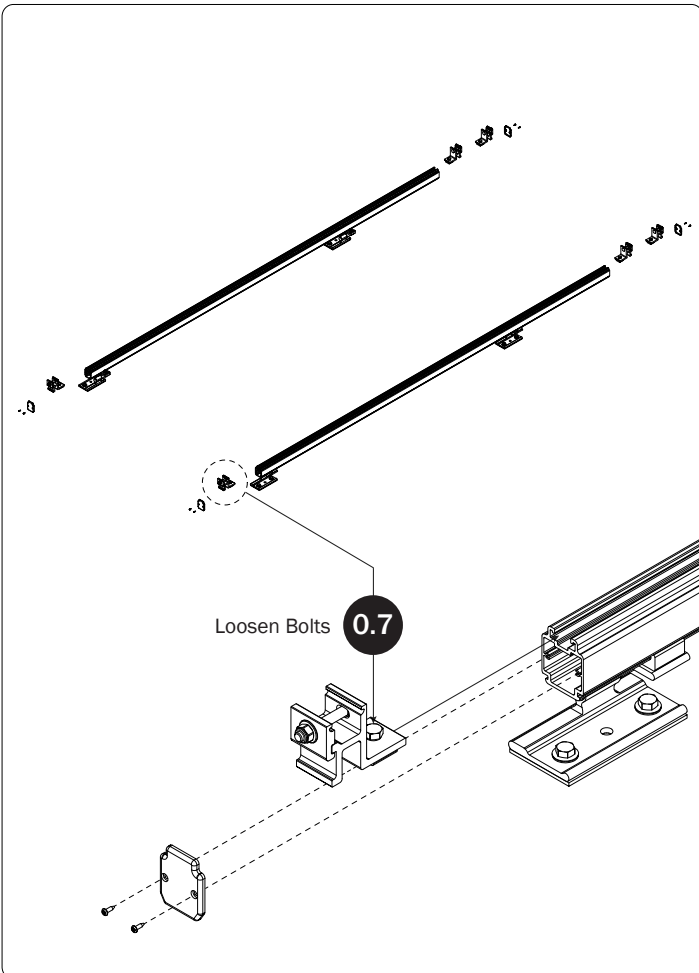
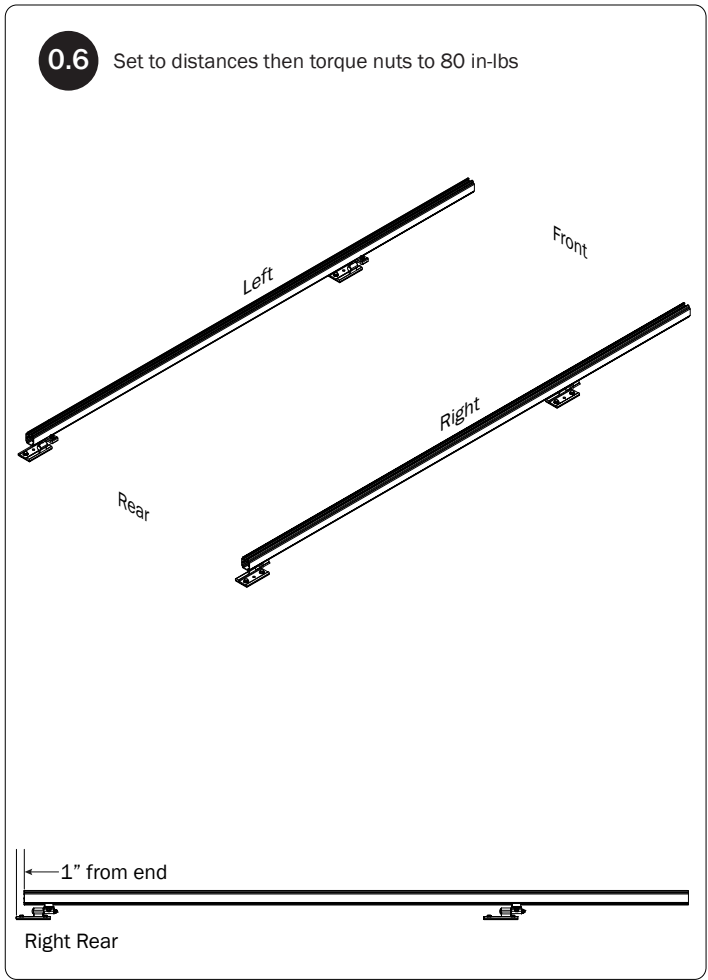
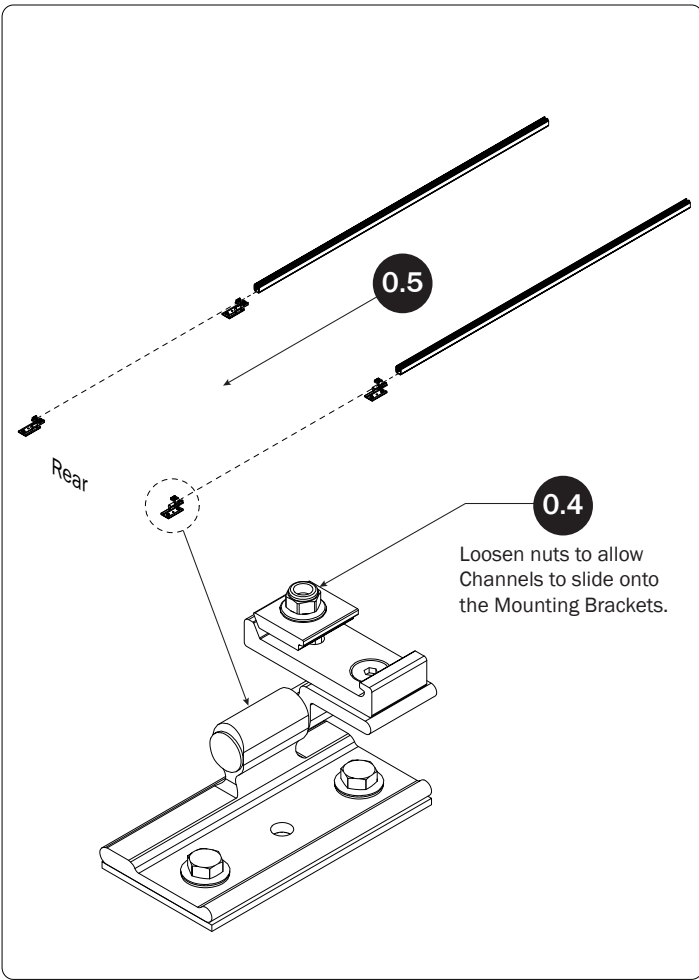

RIGHT SIDE ROTATION ASSEMBLY

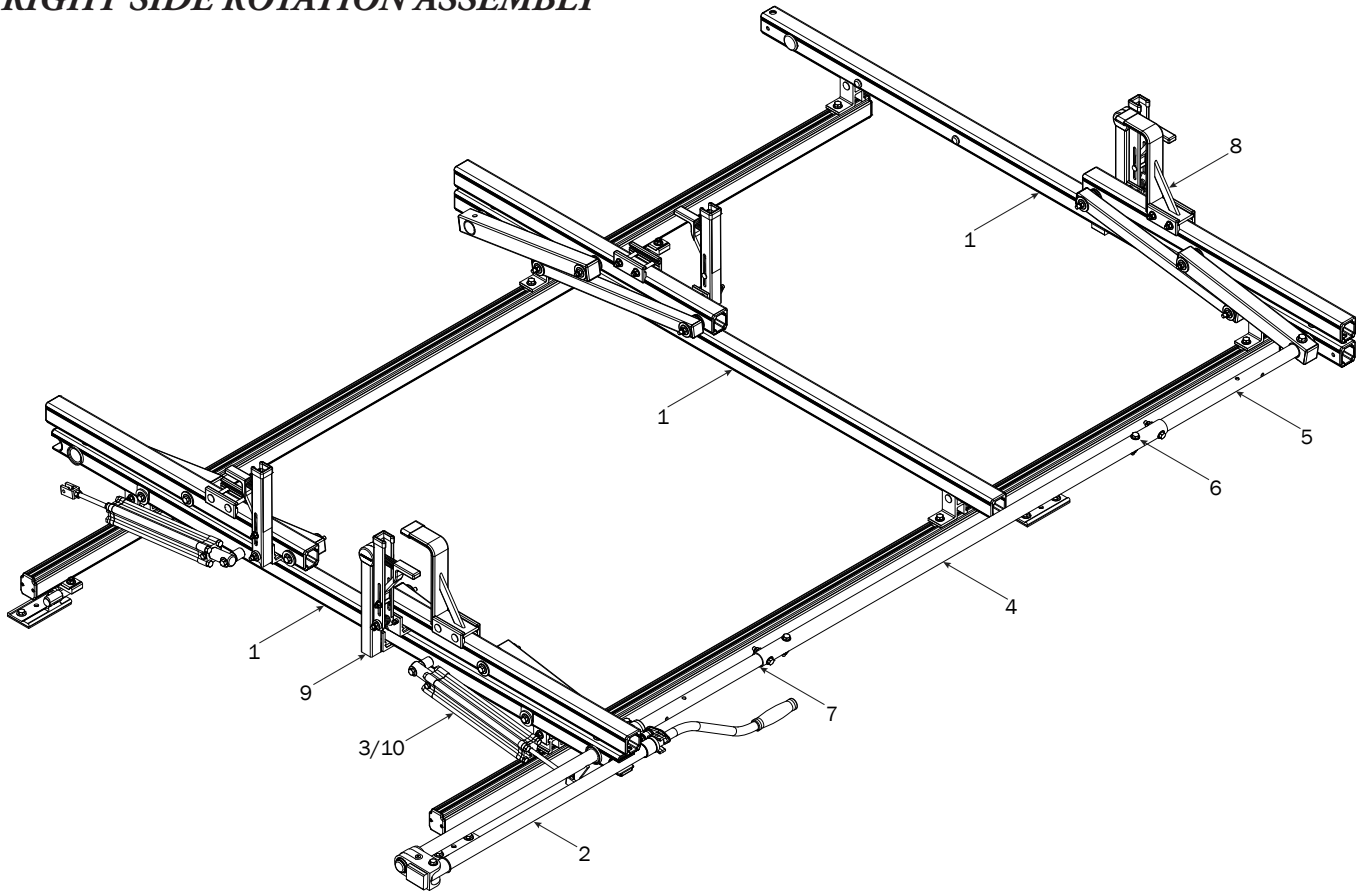

CROSSBARS

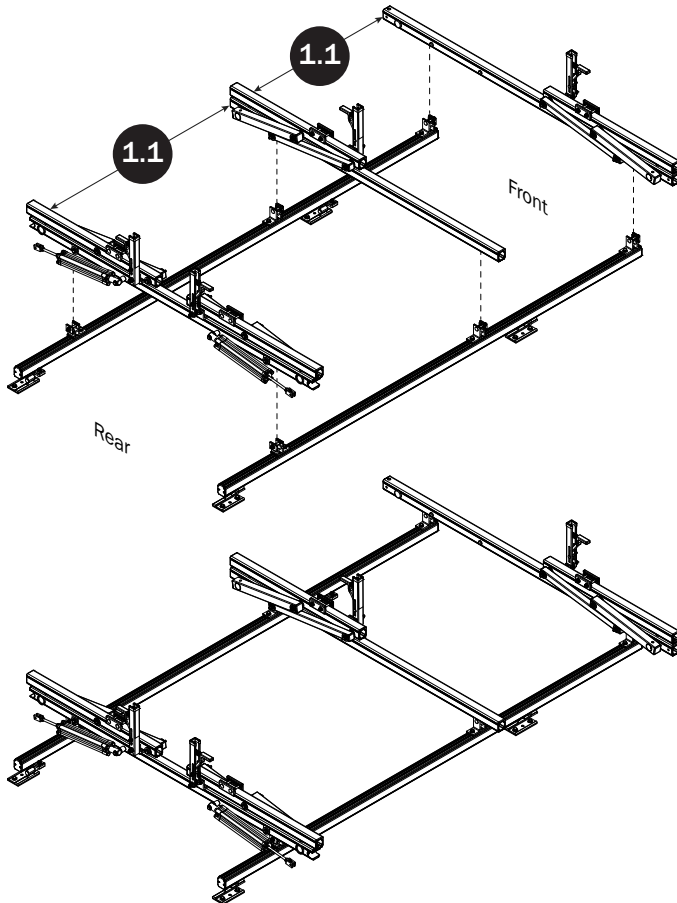

CROSSBAR ADJUSTMENT

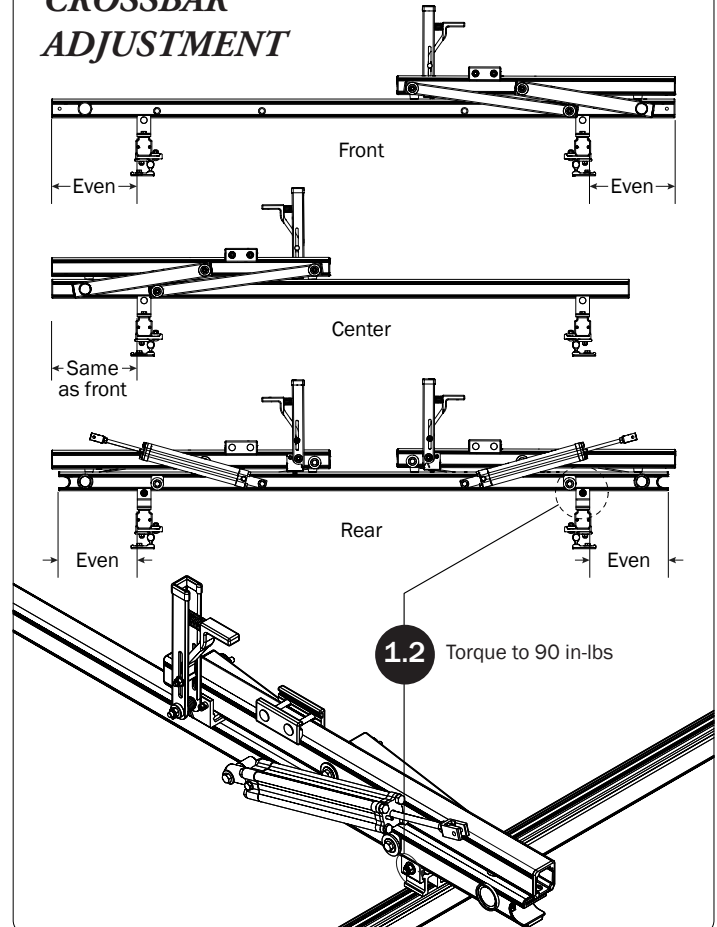

REAR DRIVE SHAFT

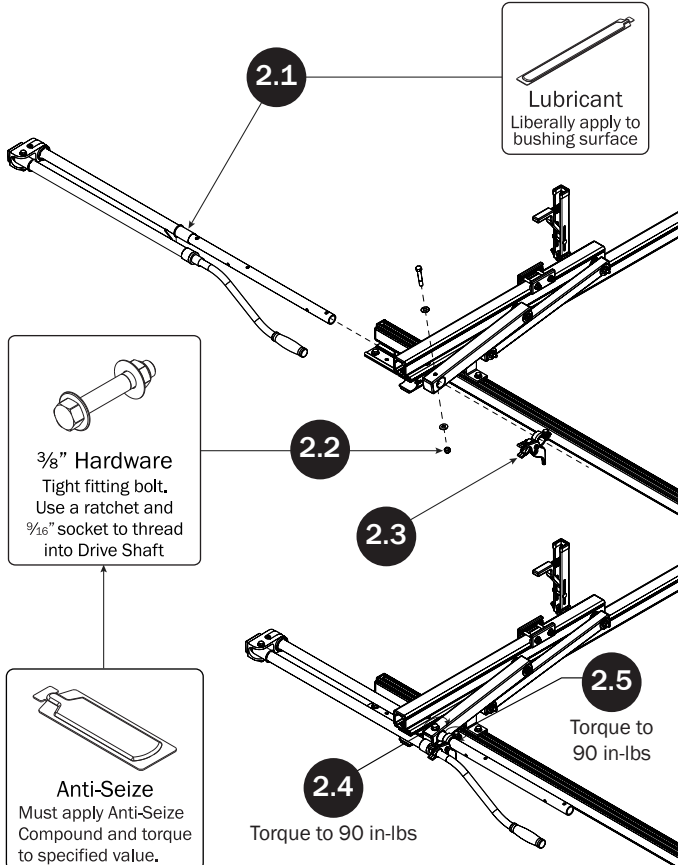

CYLINDER HARDWARE

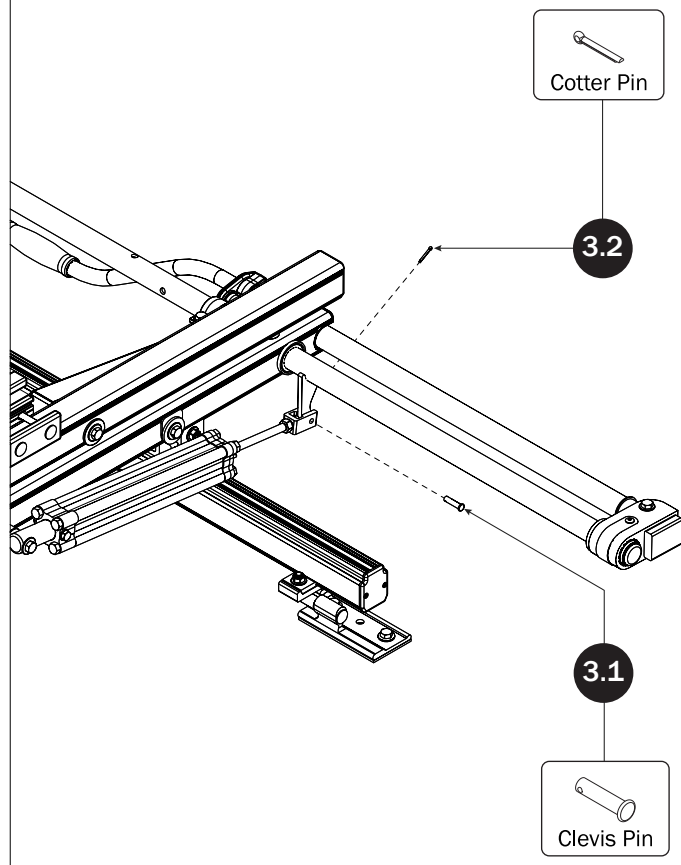

CONNECTING BAR

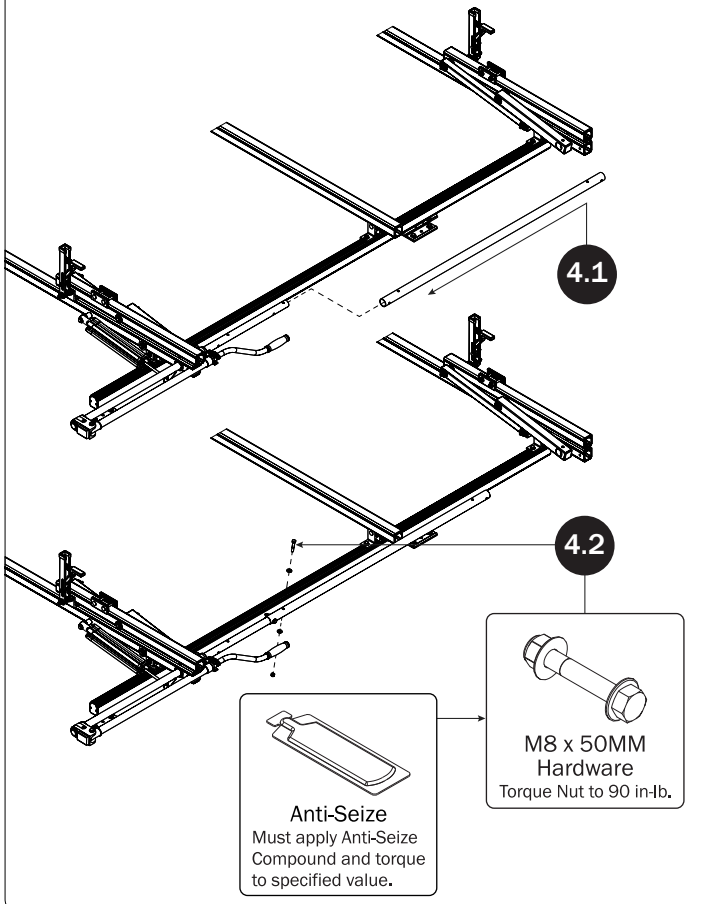

FRONT DRIVE SHAFT

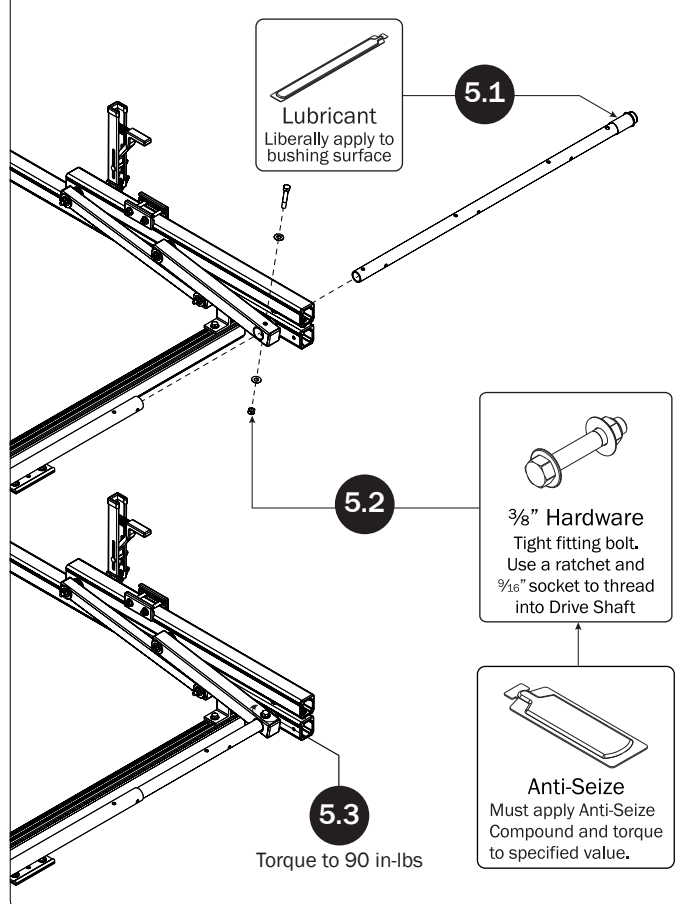

CONNECTING BAR FASTENERS

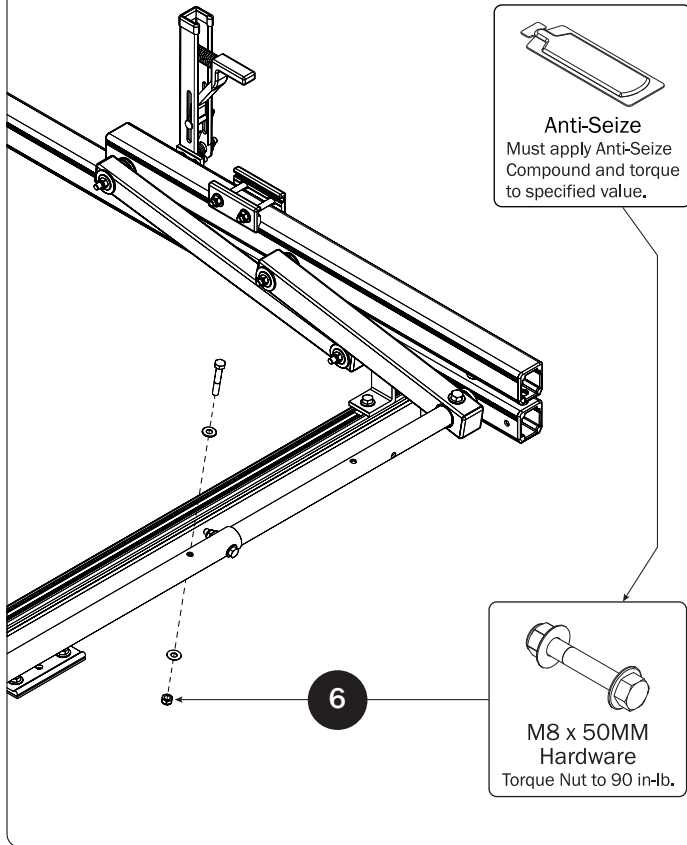

DRIVE SHAFT SEALING

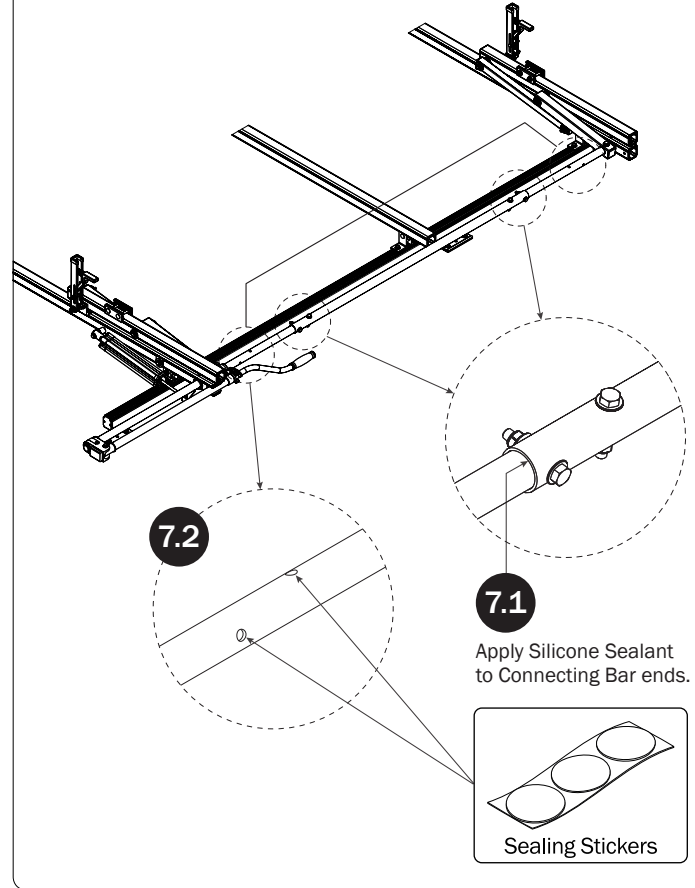

L POSTS

SEE QUICK START GUIDE FOR ADJUSTMENTS

NOTE: The Auto Clamps may come preset from the factory for packaging purposes only. To assemble the L Posts to the Crossbars, the Auto Clamps may need to be repositioned.

Ensure the Auto Clamp Spring is seated into the spring catch.

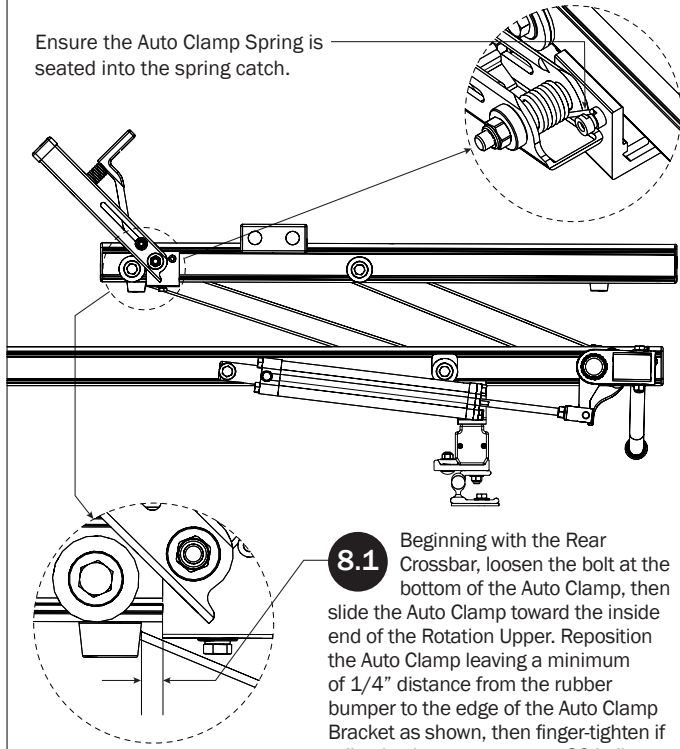

8.1 Beginning with the Rear Crossbar, loosen the bolt at the bottom of the Auto Clamp, then slide the Auto Clamp toward the inside end of the Rotation Upper. Reposition the Auto Clamp leaving a minimum of 1/4" distance from the rubber bumper to the edge of the Auto Clamp Bracket as shown, then finger-tighten if adjusting later, or torque to 80 in-lbs.

8.2

Prepare the L Post by removing the hex head bolt, lock washer, flat washer, and Bracket Clamp. Retain for installation Steps 8.4–8.8.

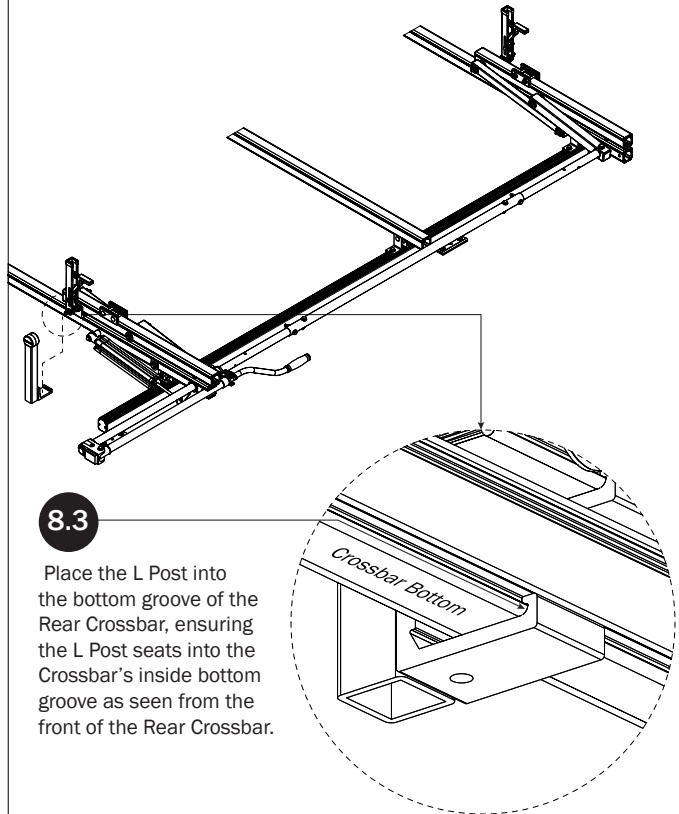

8.3

Place the L Post into the bottom groove of the Rear Crossbar, ensuring the L Post seats into the Crossbar's inside bottom groove as seen from the front of the Rear Crossbar.

8.4

Slide L Post Bracket Clamp into bottom groove, then slide into L Post Bracket as shown.

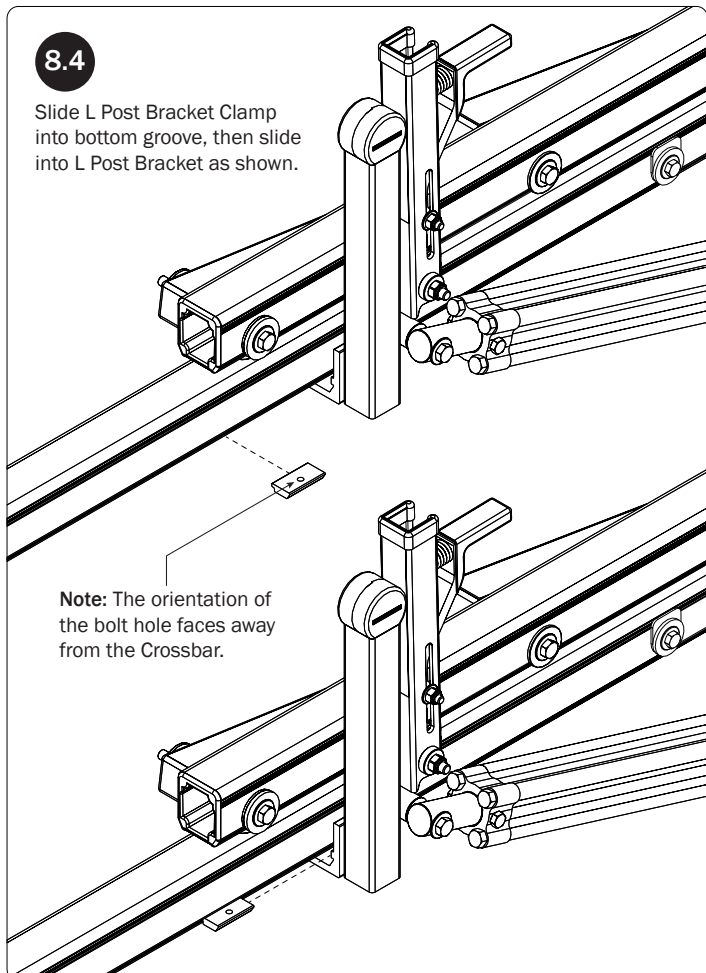

Note: The orientation of the bolt hole faces away from the Crossbar.

8.5

Bracket Clamp sits in L Post Bracket as shown.

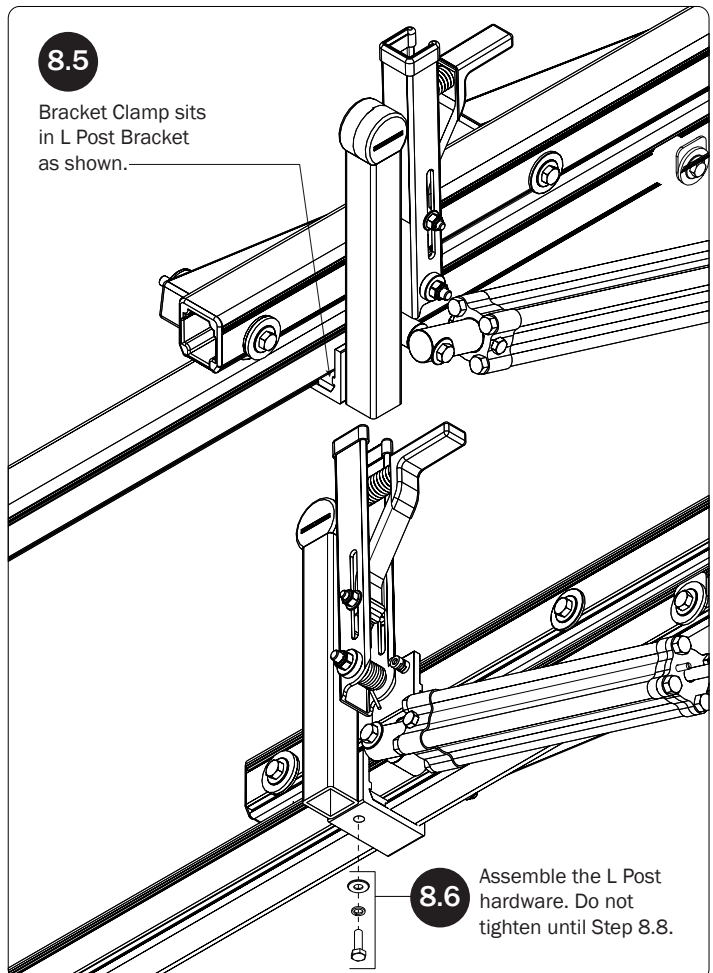

8.6

Assemble the L Post hardware. Do not tighten until Step 8.8.

8.7

Slide the L Post until parallel to the Auto Clamp and the gap between the two is even from top to bottom.

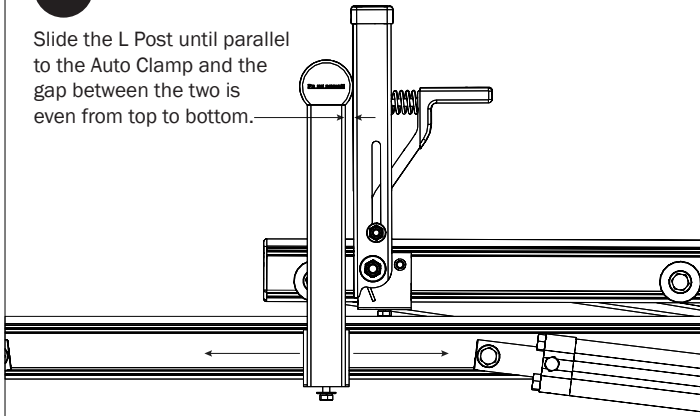

Torque to 80 in-lbs

8.8

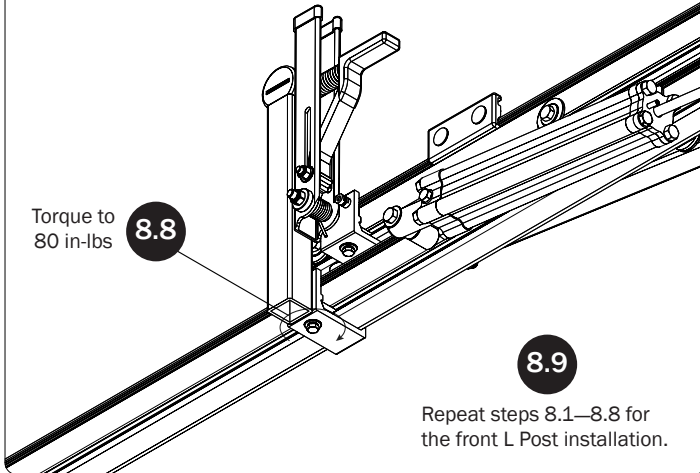

8.9

Repeat steps 8.1—8.8 for the front L Post installation.

9.2

Refer to the Quick Start Guide for Z Post positioning.

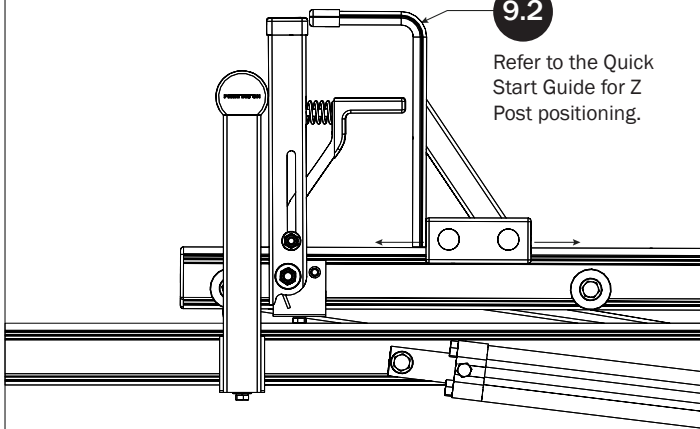

9.3

Torque to 90 in-lbs

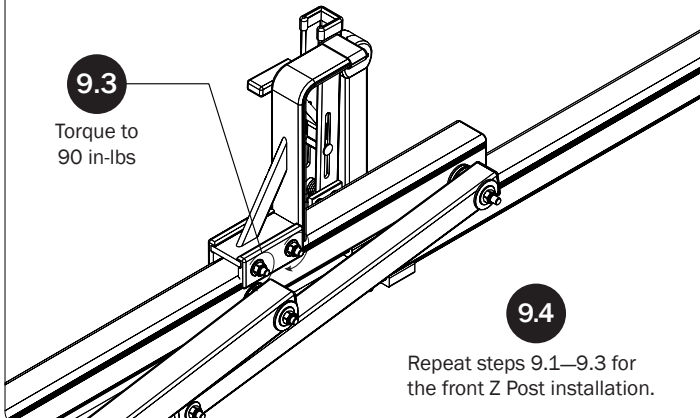

9.4

Repeat steps 9.1—9.3 for the front Z Post installation.

Z POSTS

SEE QUICK START GUIDE FOR ADJUSTMENTS

9.1

Slide the Z Post into the Mounting Clamp Assembly.

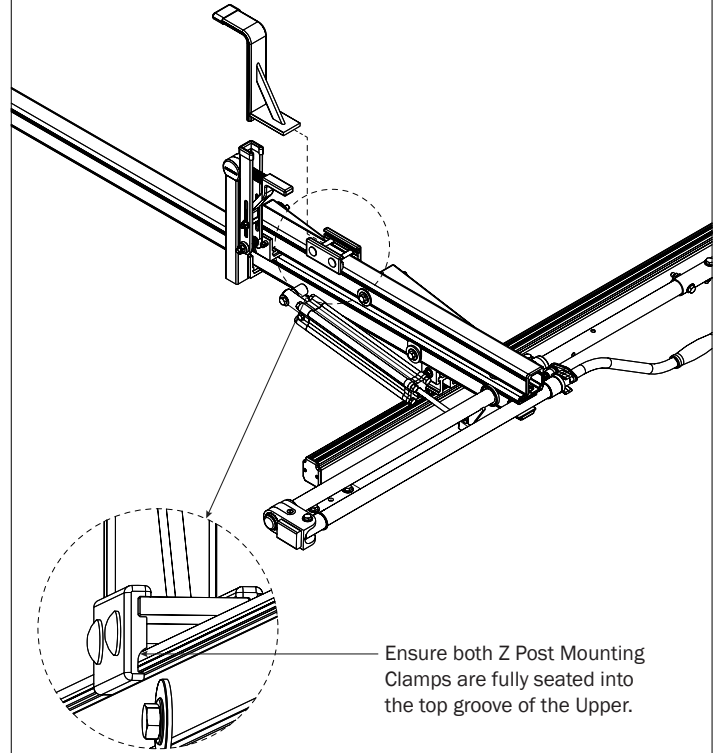

Ensure both Z Post Mounting Clamps are fully seated into the top groove of the Upper.

CYLINDER ADJUSTMENT

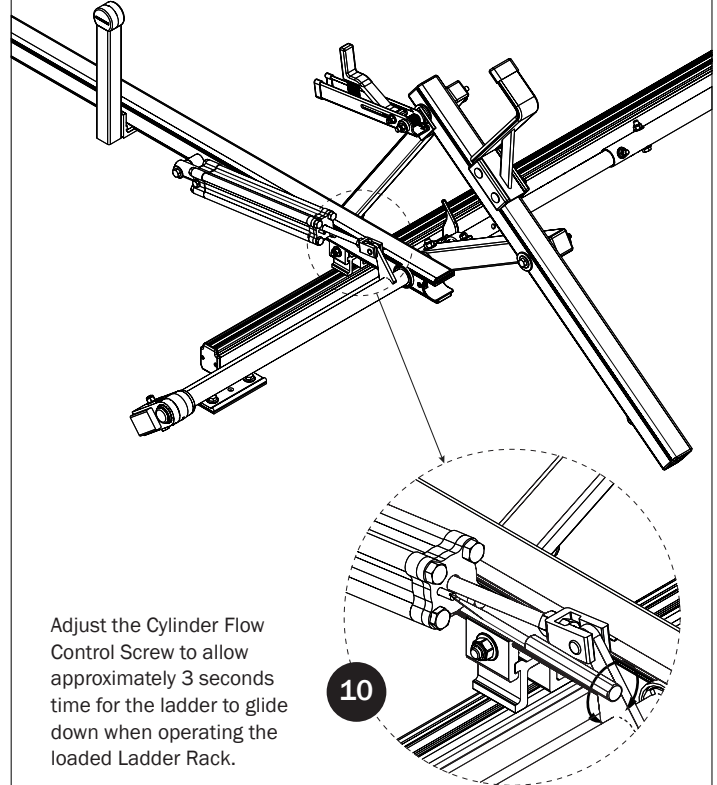

Adjust the Cylinder Flow Control Screw to allow approximately 3 seconds time for the ladder to glide down when operating the loaded Ladder Rack.

10

LEFT SIDE ROTATION ASSEMBLY

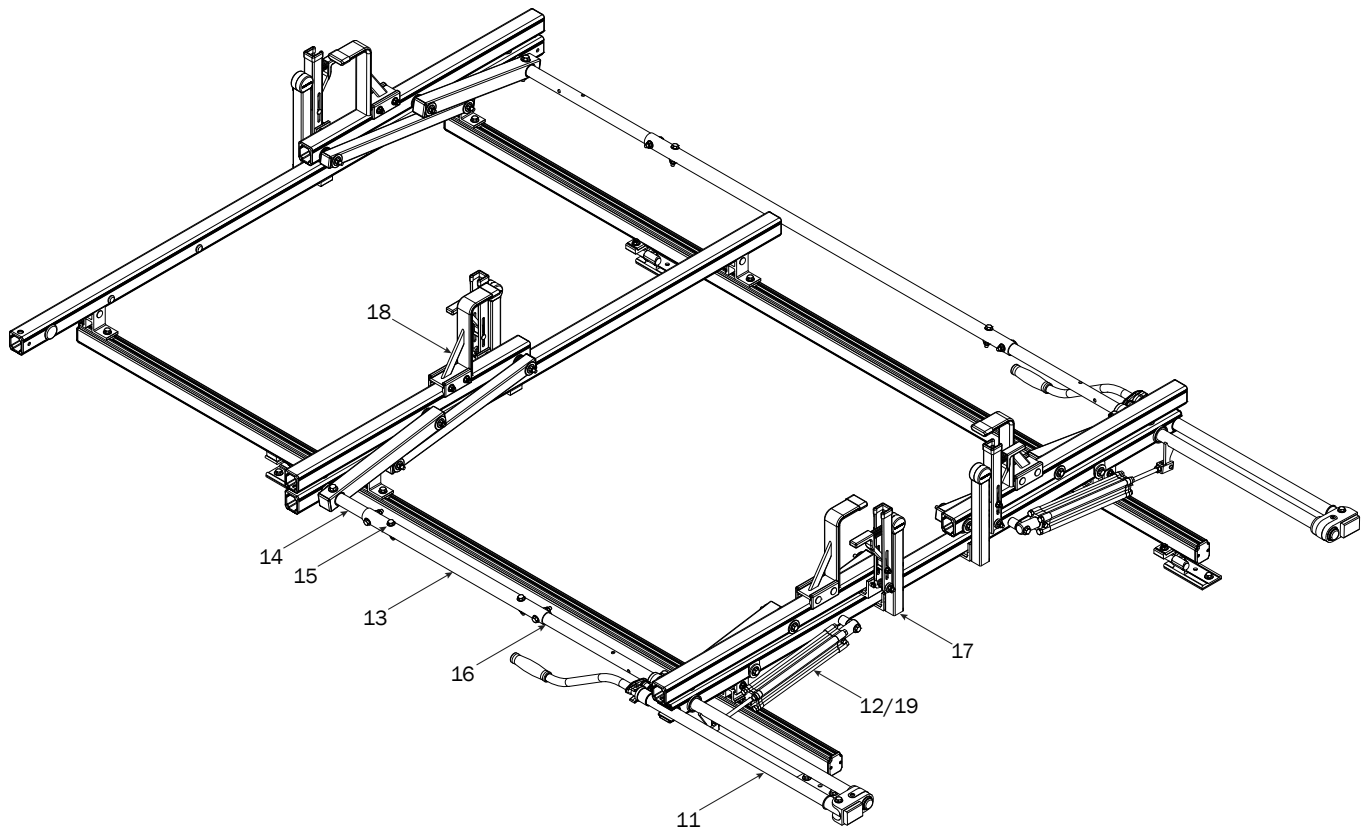

REAR DRIVE SHAFT

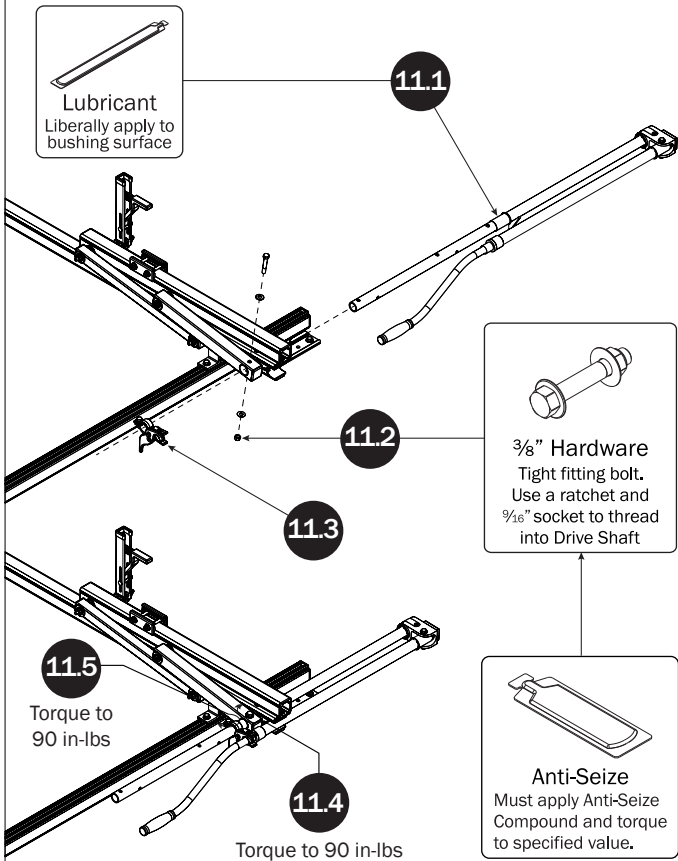

CYLINDER HARDWARE

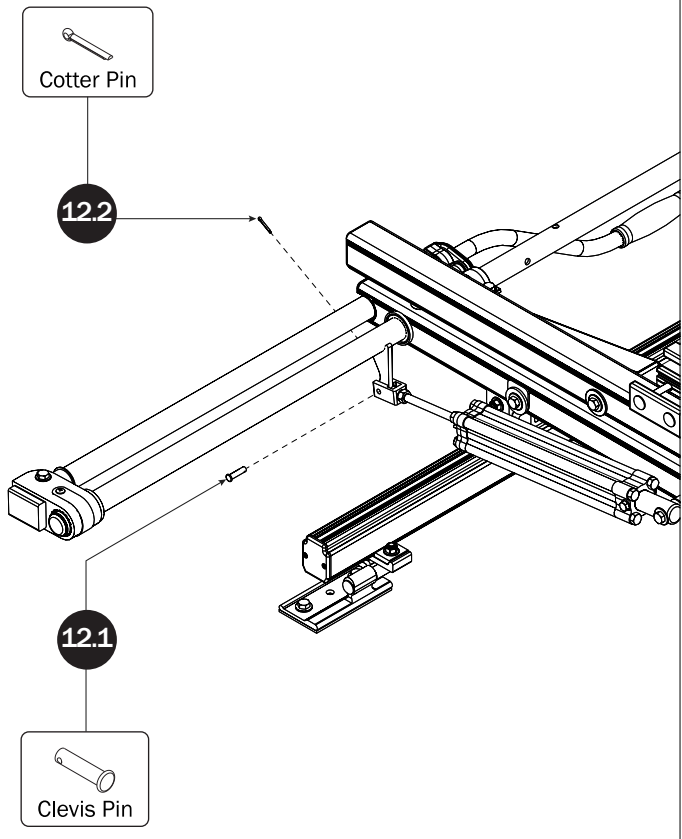

CONNECTING BAR

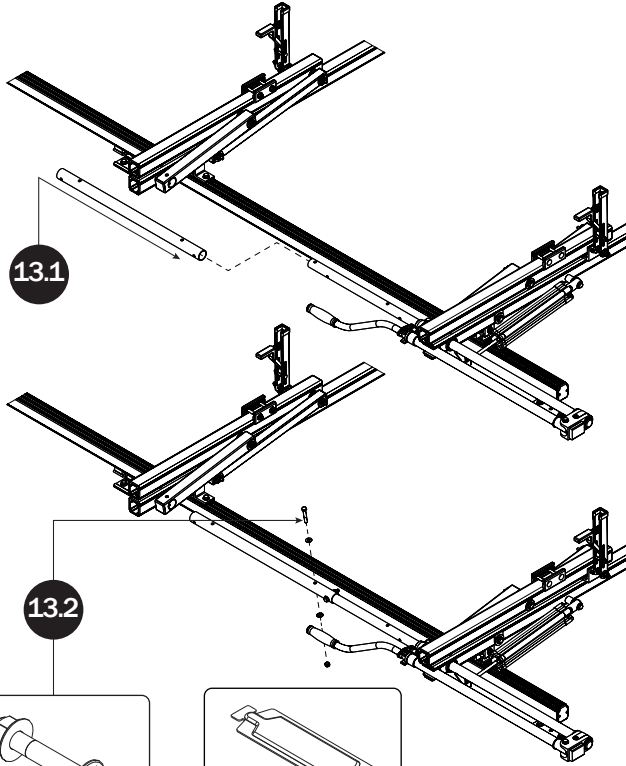

M8 x 50MM Hardware
Torque Nut to 90 in-lb.

Anti-Seize
Must apply Anti-Seize Compound and torque to specified value.

FRONT DRIVE SHAFT

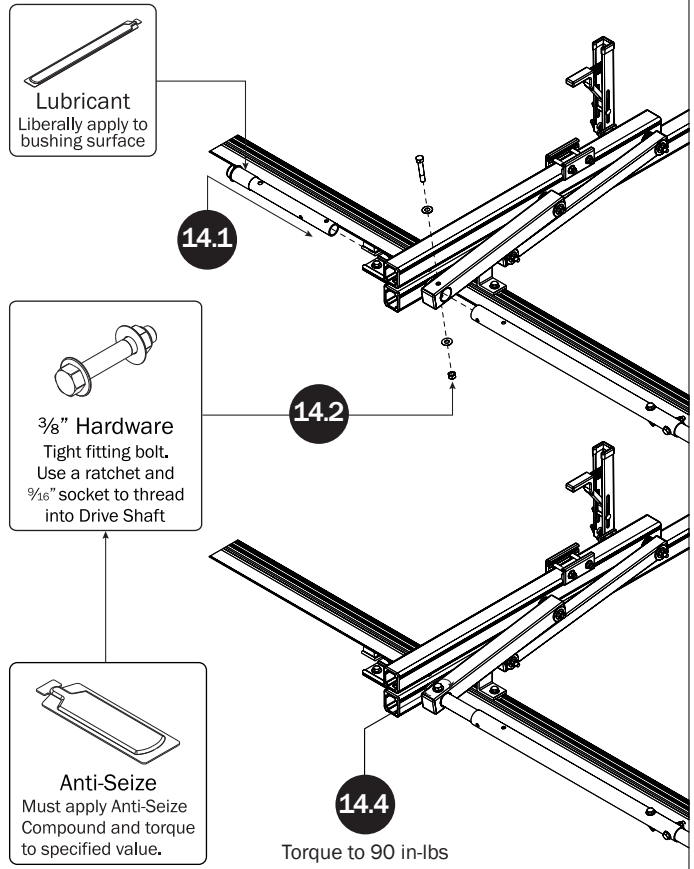

Lubricant
Liberally apply to bushing surface

3/8" Hardware
Tight fitting bolt. Use a ratchet and 3/16" socket to thread into Drive Shaft

Anti-Seize
Must apply Anti-Seize Compound and torque to specified value.

Torque to 90 in-lbs

CONNECTING BAR FASTENERS

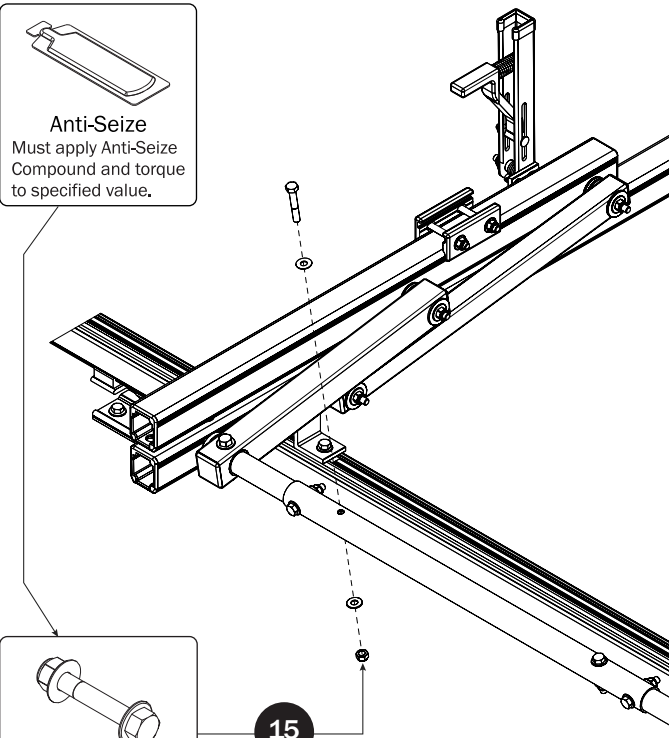

Anti-Seize
Must apply Anti-Seize Compound and torque to specified value.

M8 x 50MM Hardware
Torque Nut to 90 in-lb.

DRIVE SHAFT SEALING

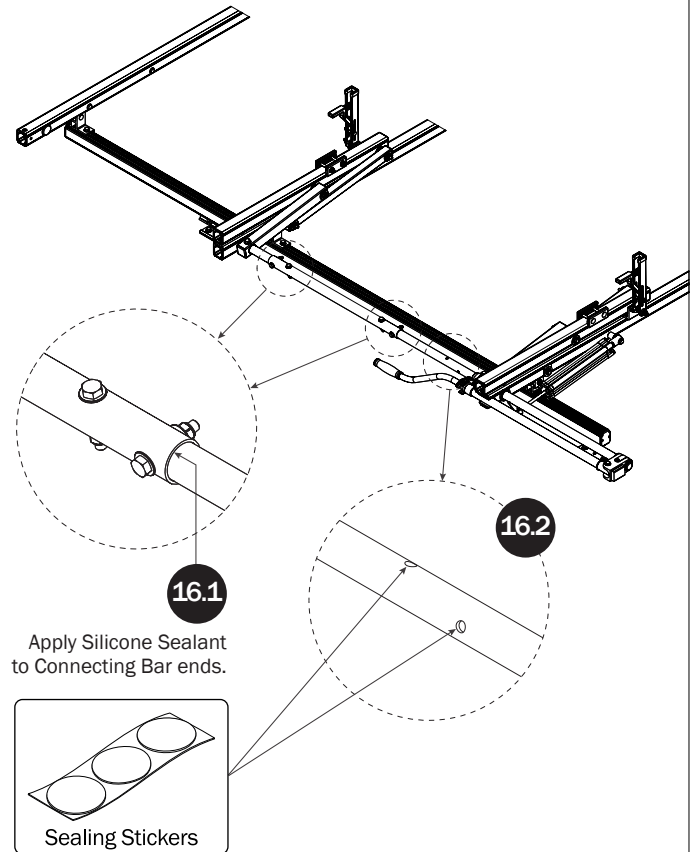

Apply Silicone Sealant to Connecting Bar ends.

Sealing Stickers

L POSTS

SEE QUICK START GUIDE FOR ADJUSTMENTS

NOTE: The Auto Clamps may come preset from the factory for packaging purposes only. To assemble the L Posts to the Crossbars, the Auto Clamps may need to be repositioned.

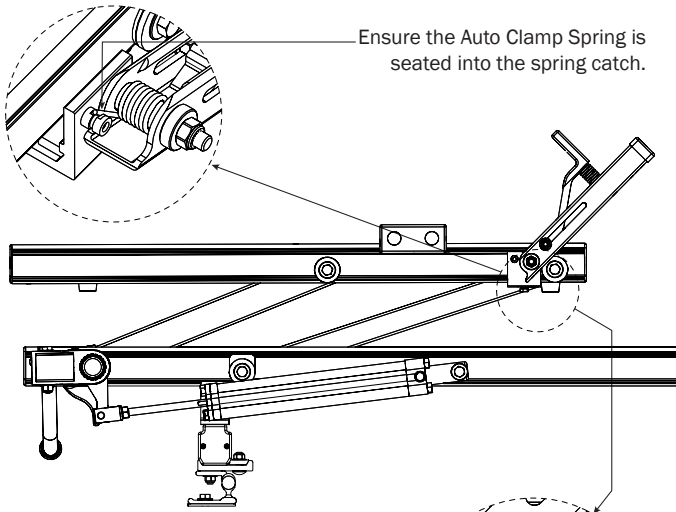

Beginning with the Rear Crossbar, loosen the bolt at the bottom of the Auto Clamp, then slide the Auto Clamp toward the inside end of the Rotation Upper. Reposition the Auto Clamp leaving a minimum of 1/4" distance from the rubber bumper to the edge of the Auto Clamp Bracket as shown, then finger-tighten if adjusting later, or torque to 80 in-lbs.

17.1

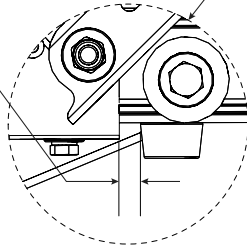

17.2 Prepare the L Post by removing the hex head bolt, lock washer, flat washer, and Bracket Clamp. Retain for installation Steps 17.4–17.8.

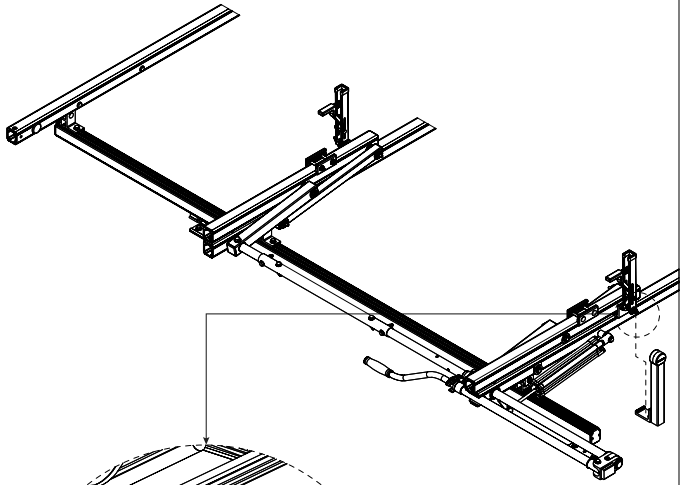

17.3

Place the L Post into the bottom groove of the Rear Crossbar, ensuring the L Post seats into the Crossbar's inside bottom groove as seen from the front of the Rear Crossbar.

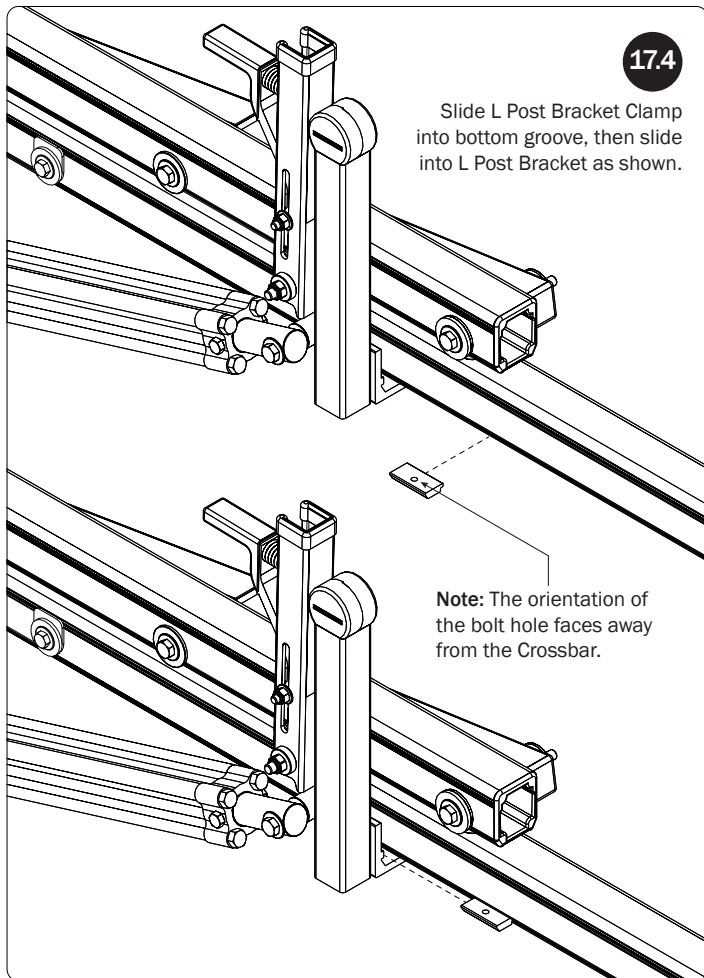

17.4

Slide L Post Bracket Clamp into bottom groove, then slide into L Post Bracket as shown.

Note: The orientation of the bolt hole faces away from the Crossbar.

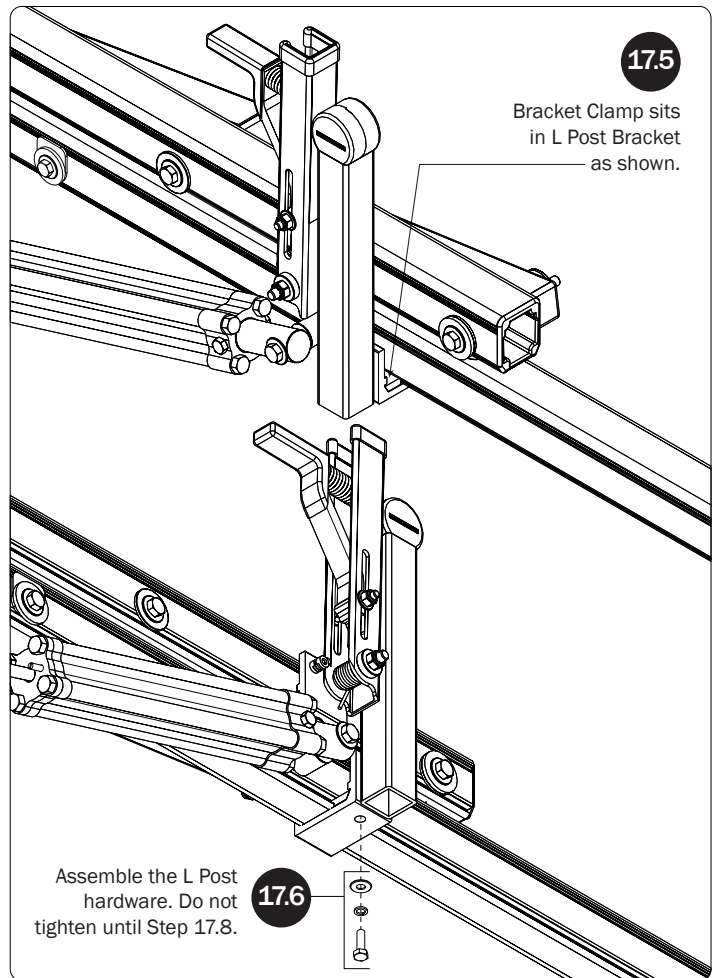

17.5

Bracket Clamp sits in L Post Bracket as shown.

Assemble the L Post hardware. Do not tighten until Step 17.8.

17.6

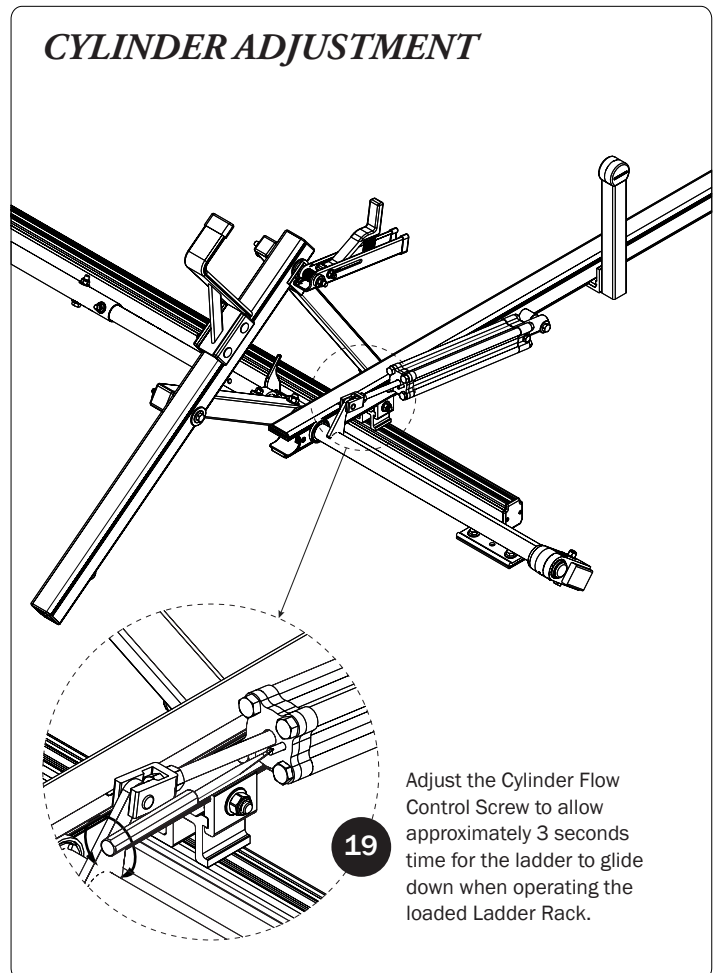
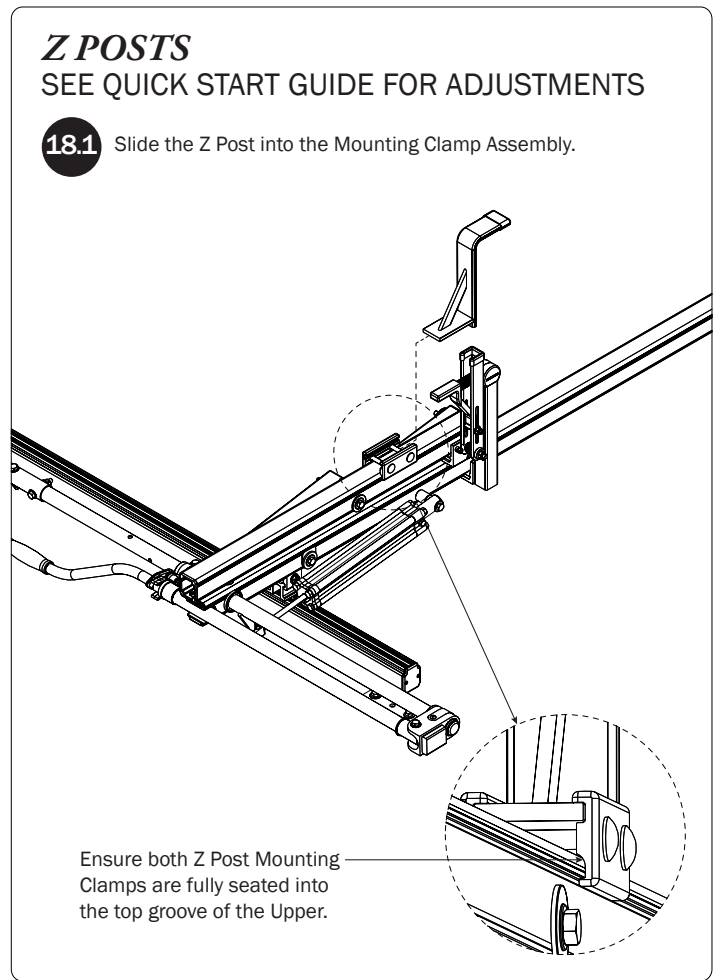
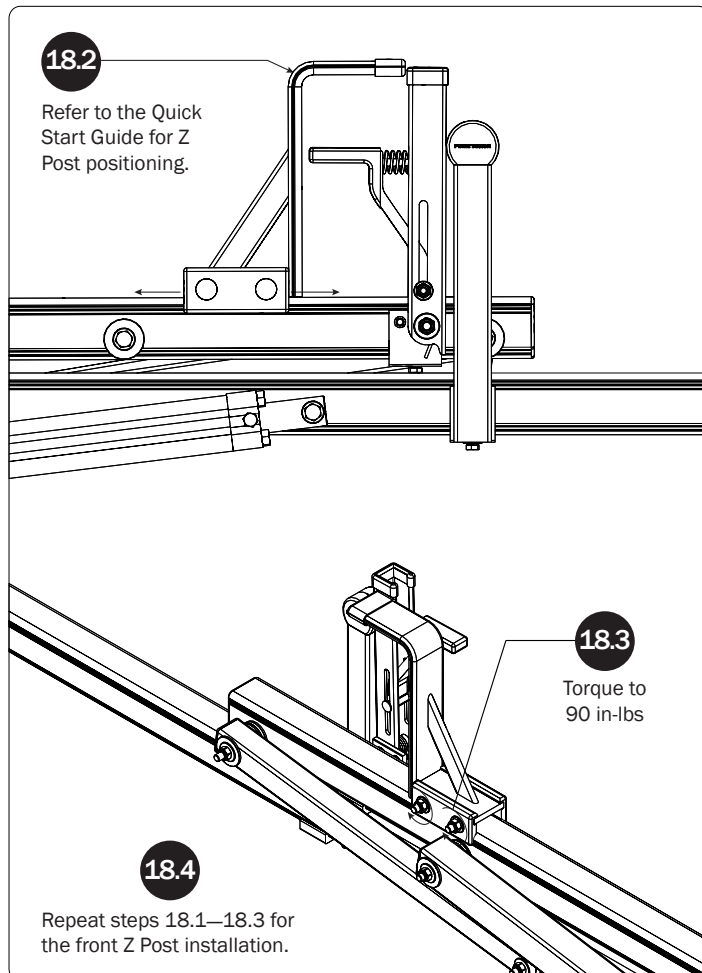
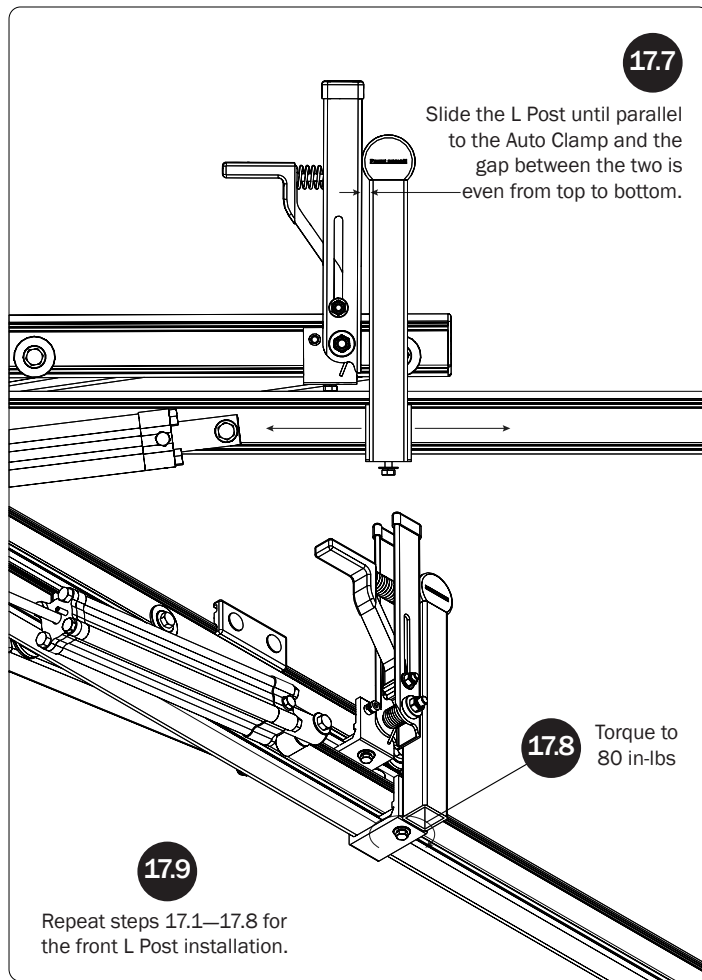

Page Intentionally Left Blank

