

PRIME DESIGN™

A Safe Fleet Brand

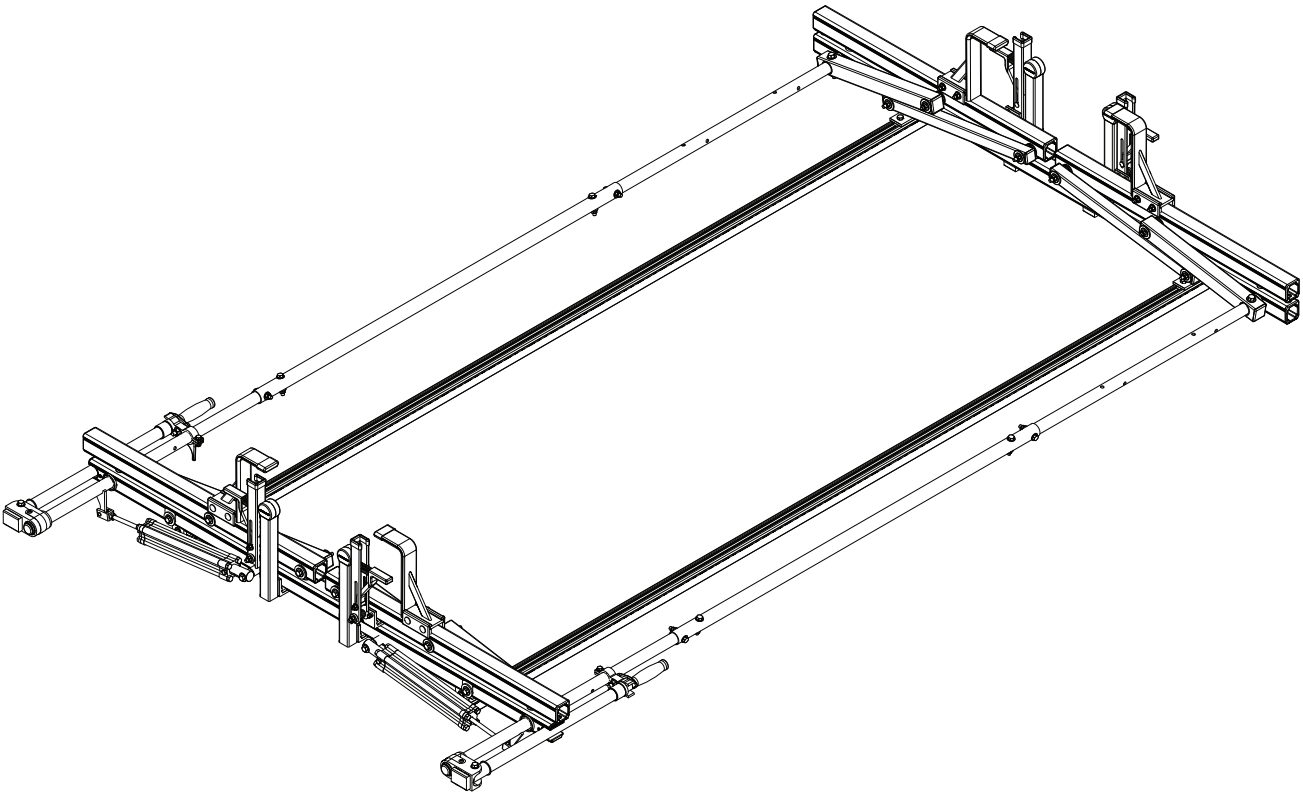

6001
PRR

CONTENTS OVERVIEW

INSTALLER NOTE: Mounting Hardware or Brackets to attach this rack to a vehicle roof or cap are not included in this kit, and must be purchased separately.

To purchase Mounting Hardware or Brackets, please contact Prime Design Sales & Support.

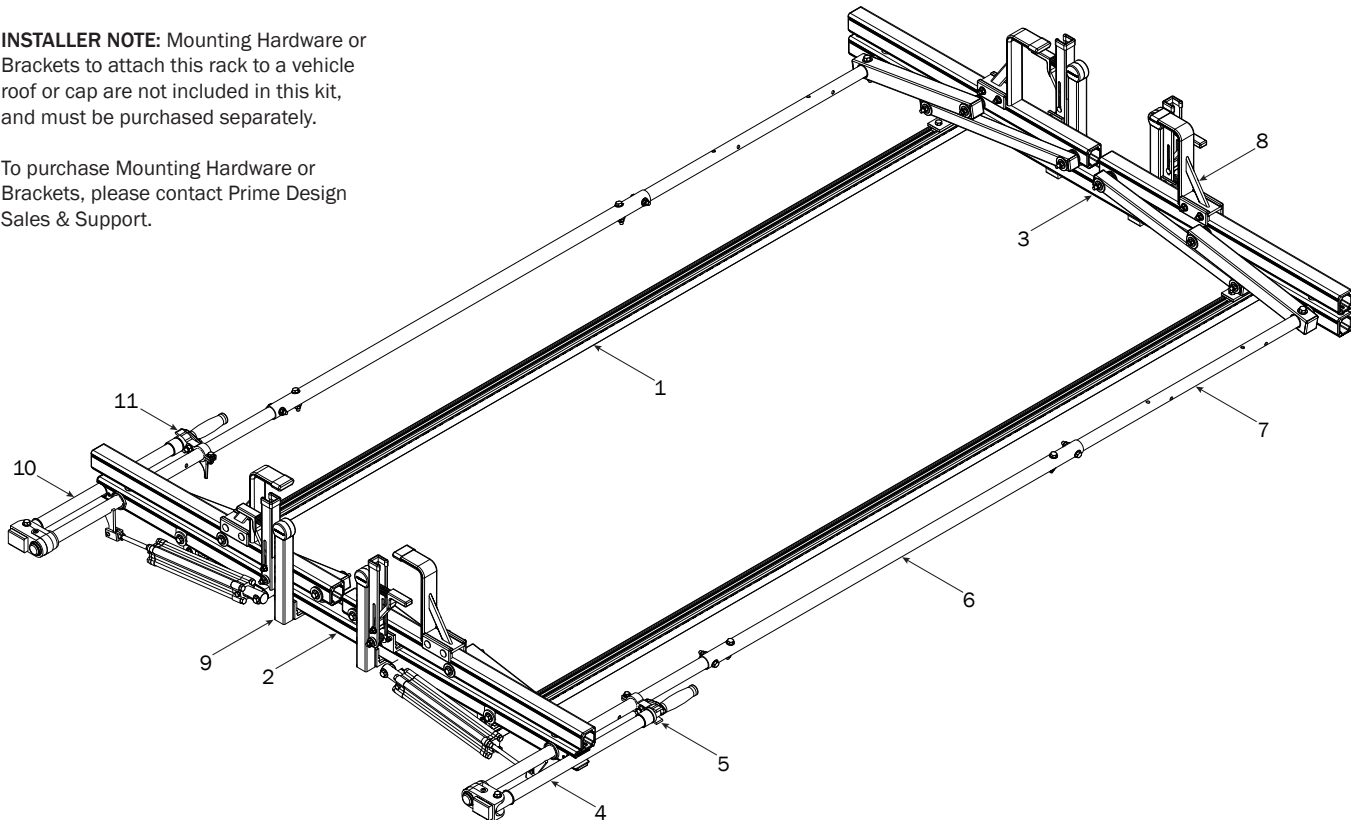

1—FBM-0002 (Qty 1)
Channels with hardware

Channels (2X)



Screws (8X) End Caps (4X) Brackets (4X)

2—Rear Crossbar Assembly..... (Qty 1)

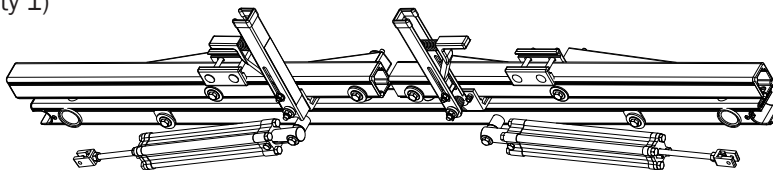

3—Front Crossbar Assembly (Qty 1)

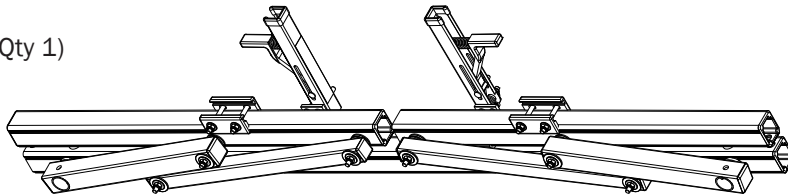

4—Rear Drive Shaft..... (Qty 1)
Right Hand, 34.00"

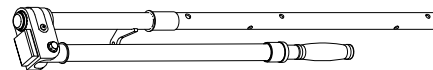

5—Handle Latch Assembly (Qty 1)
Right Hand



6—Connecting Bar..... (Qty 2)
4.00'

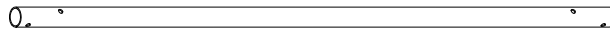

7—Front Drive Shaft..... (Qty 2)
B Version, 35.75"



8—Z Post..... (Qty 4)
Adjustable, 7.25"

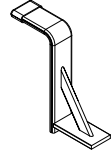

9—L Post..... (Qty 4)
Roller Cap, 9.25"

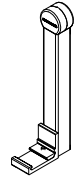

10—Rear Drive Shaft..... (Qty 1)
Left Hand, 34.00"

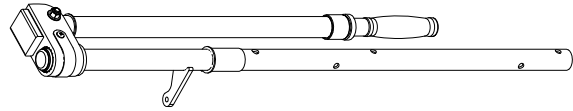

11—Handle Latch Assembly..... (Qty 1)
Left Hand



HKT-8162-Rotation Hardware Kit



Cotter Pin (2X)

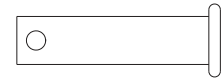

Clevis Pin (2X)

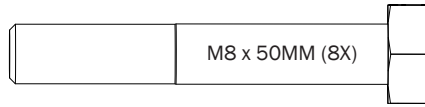

M8 x 50MM (8X)

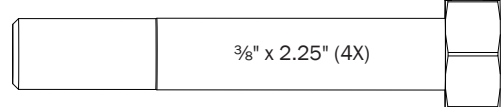

3/8" x 2.25" (4X)



M8 Lock Nut (8X)



3/8" Lock Nut (4X)

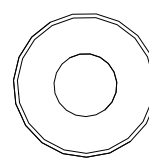

5/16" Flat Washer (16X)

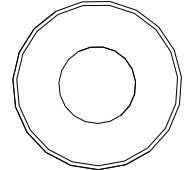

3/8" Flat Washer (8X)

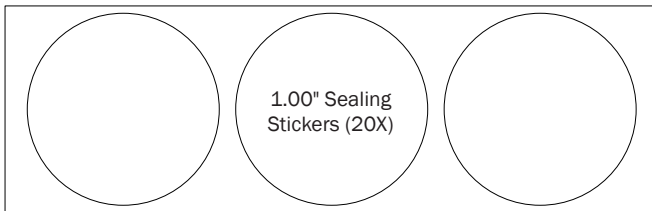

1.00" Sealing
Stickers (20X)



Anti-Seize (2X)

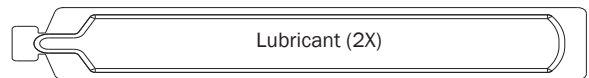

Lubricant (2X)

FBM-0002 FLUSH CHANNELS TO PRE-INSTALLED MOUNTING BRACKETS

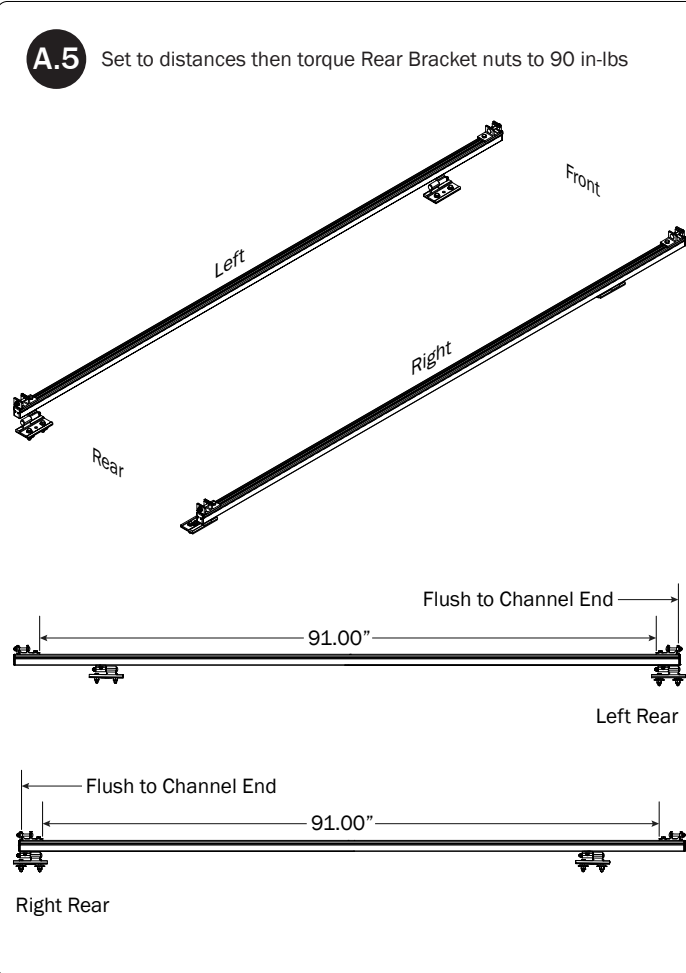
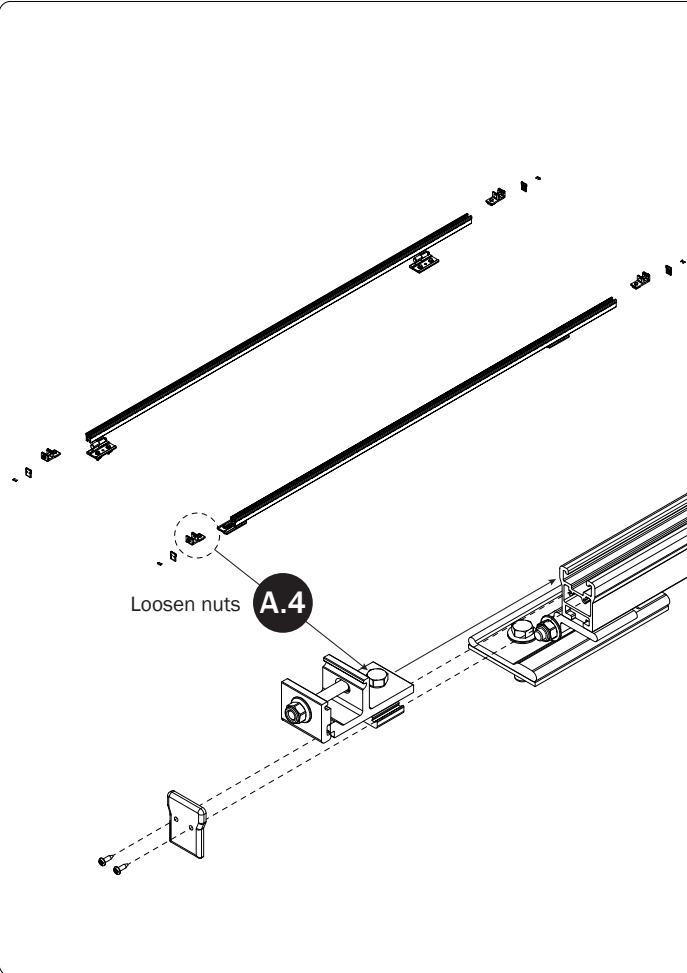
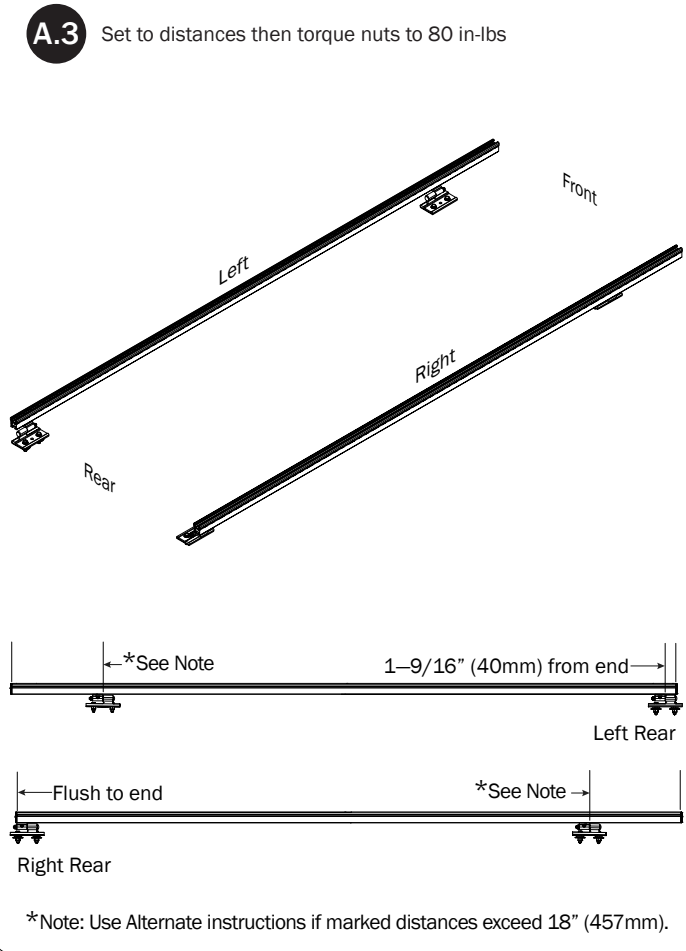
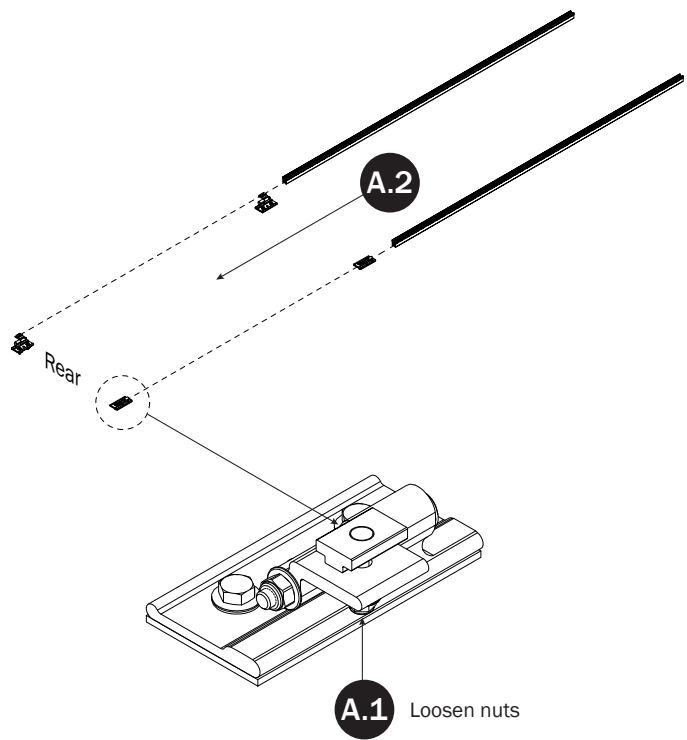

FBM-0002 ALTERNATE
CHANNELS TO PRE-INSTALLED
MOUNTING BRACKETS

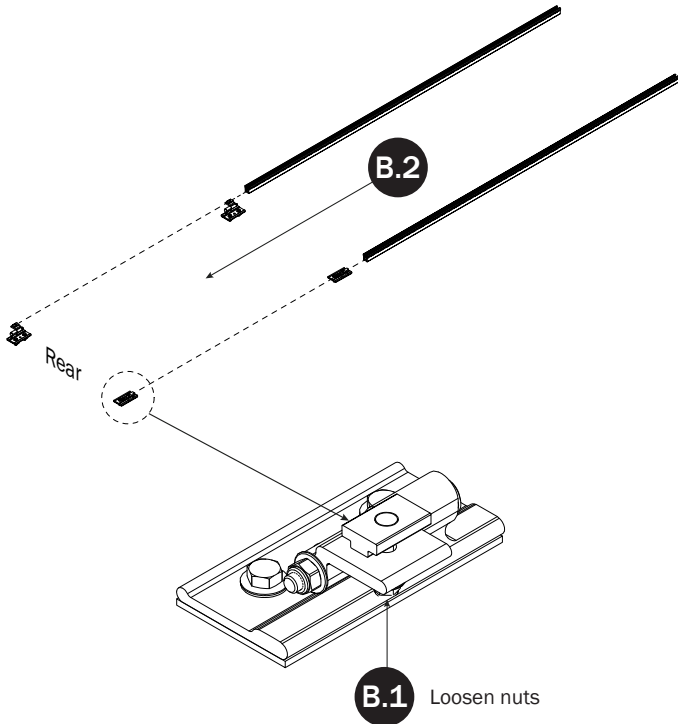

B.3 Set to distances then torque nuts to 80 in-lbs

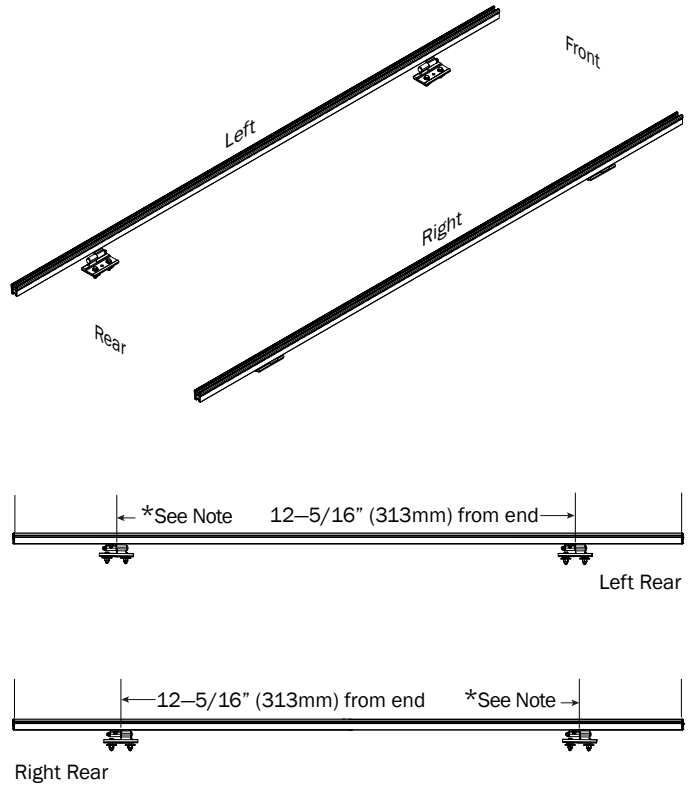

*Note: Move Channels rearward if marked front distance exceeds 18" (457mm).

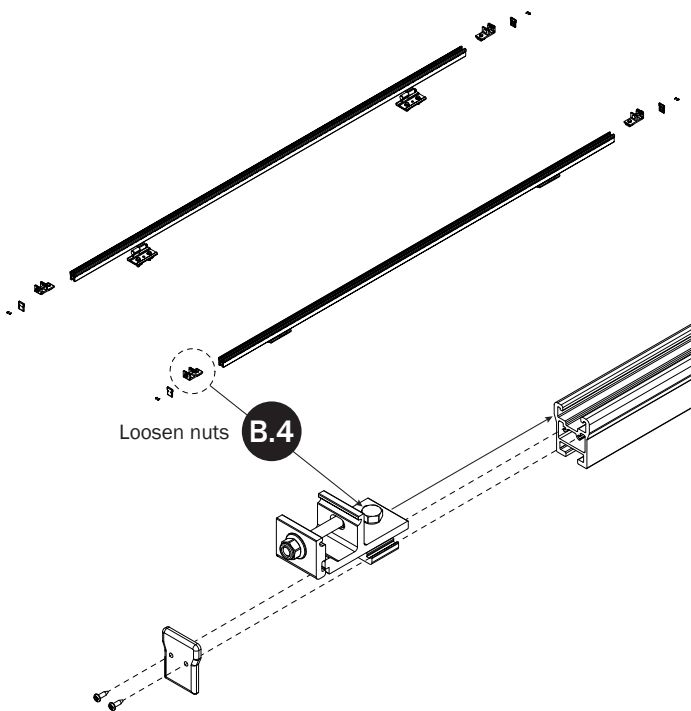

B.5 Set to distances then torque Rear Bracket nuts to 90 in-lbs

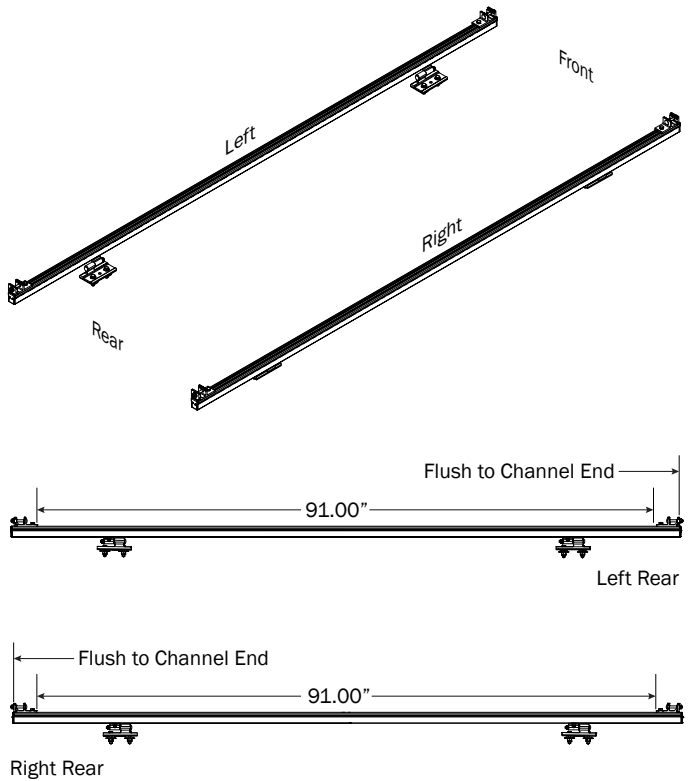

**RIGHT ROTATION
ASSEMBLY SEQUENCE**

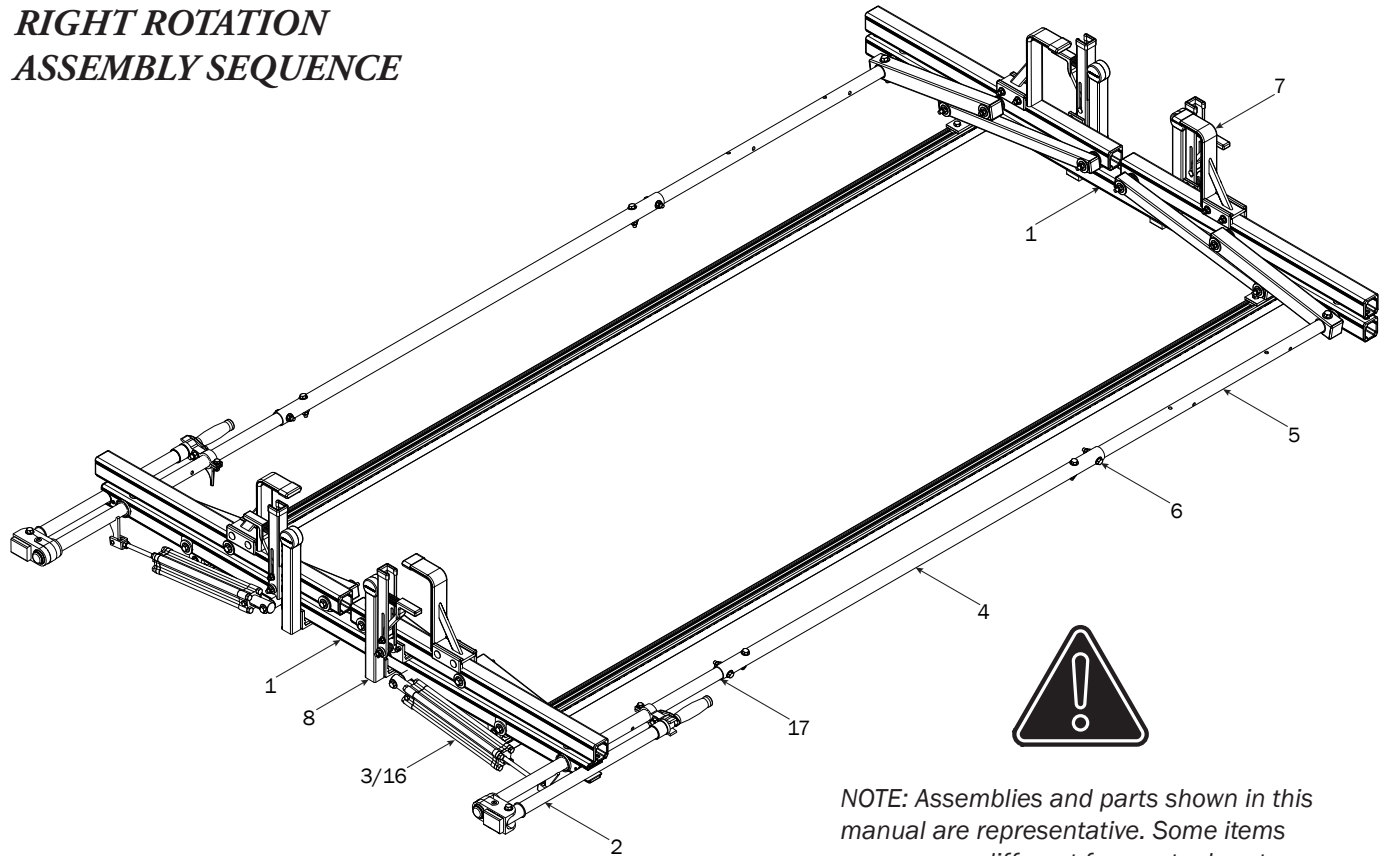

NOTE: Assemblies and parts shown in this manual are representative. Some items may appear different from actual parts, assemblies, or components received.

CROSSBARS

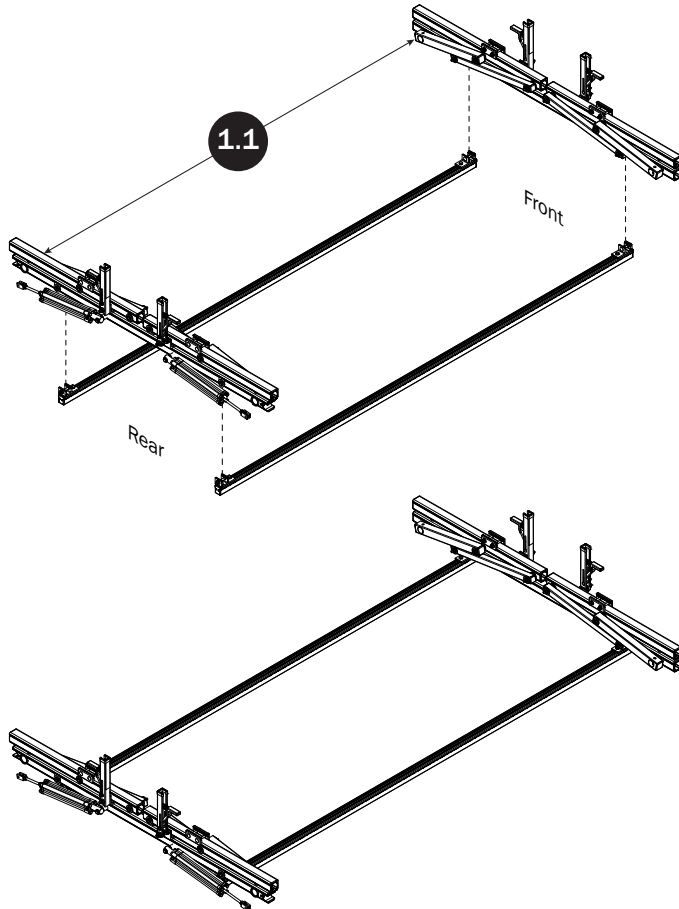

CROSSBAR ADJUSTMENT

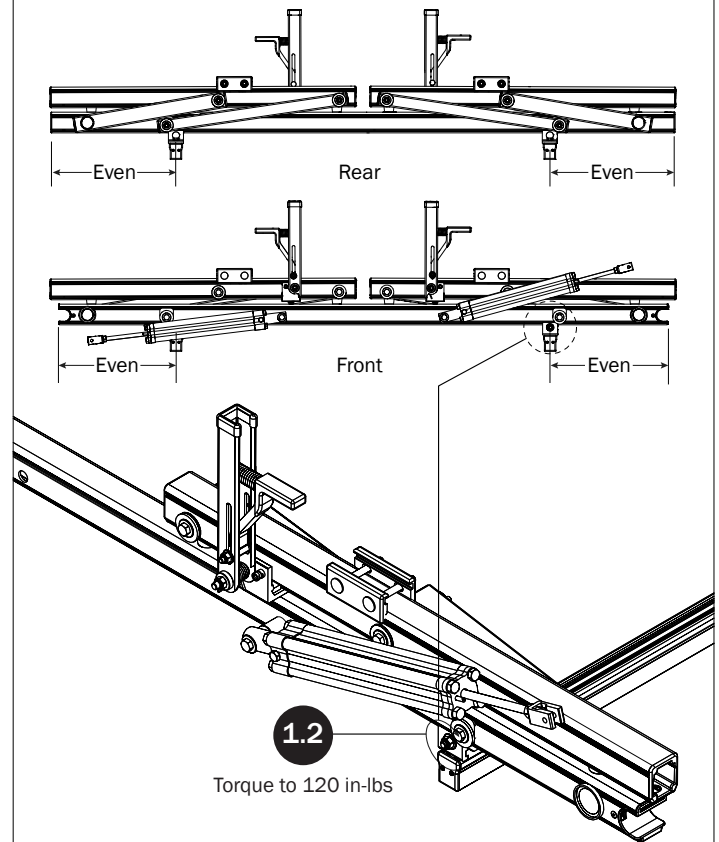

Torque to 120 in-lbs

REAR DRIVE SHAFT

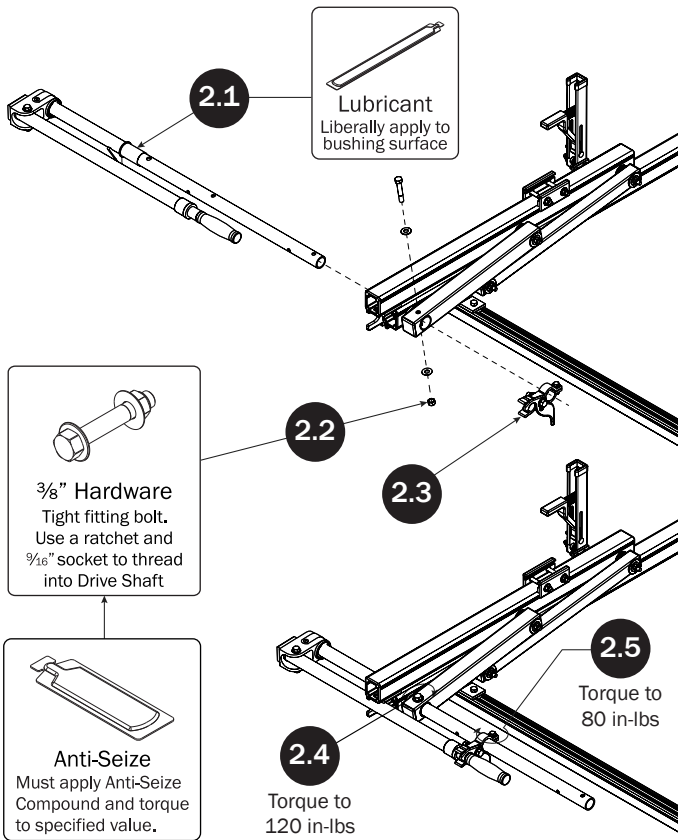

CYLINDER HARDWARE

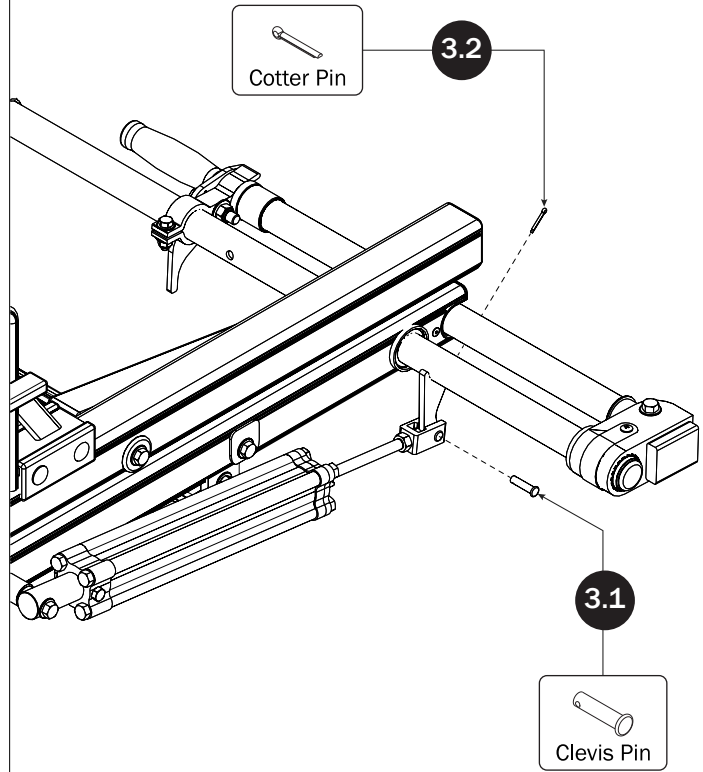

CONNECTING BAR

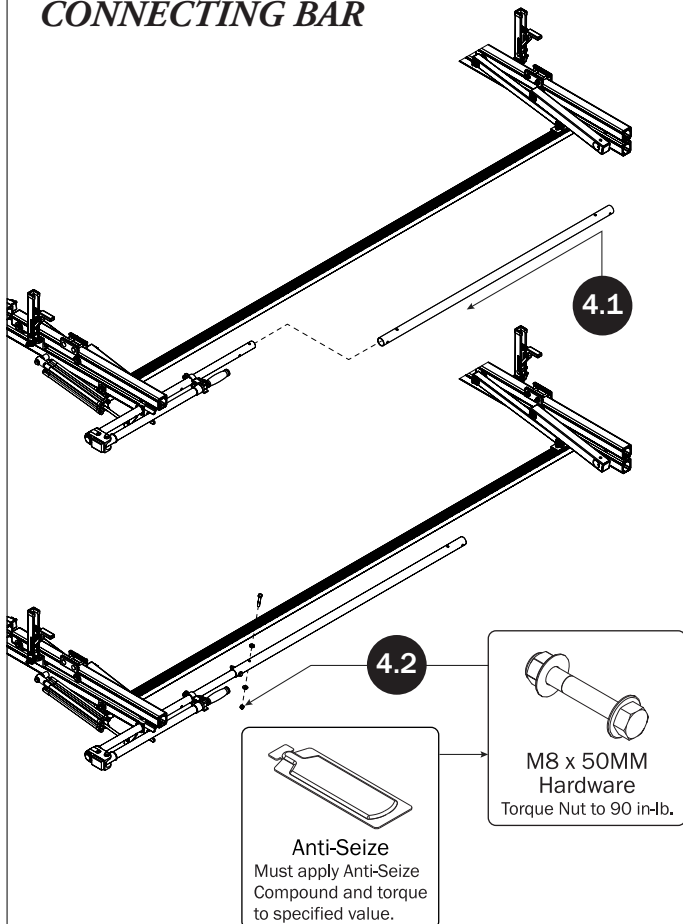

FRONT DRIVE SHAFT

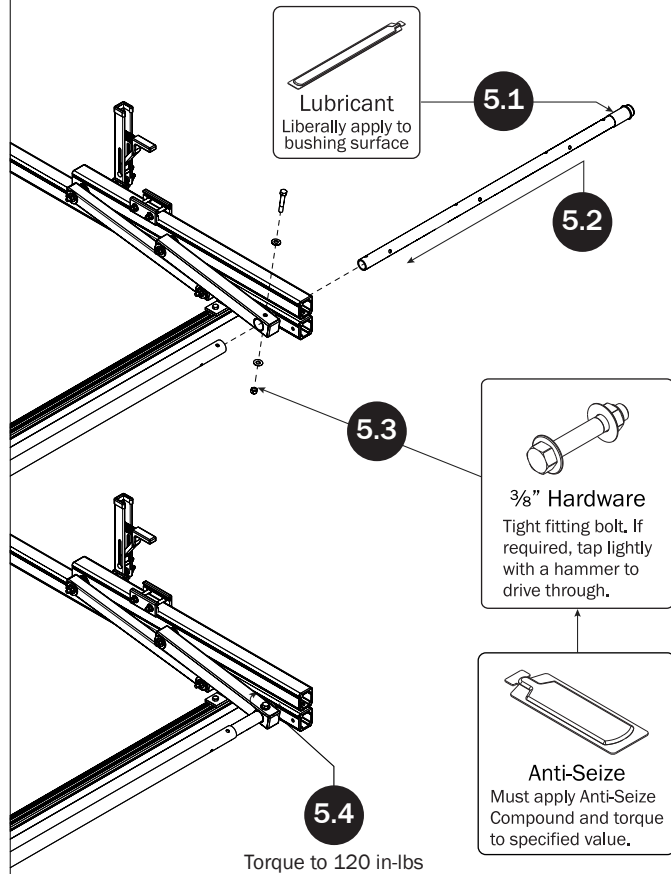

CONNECTING BAR FASTENERS

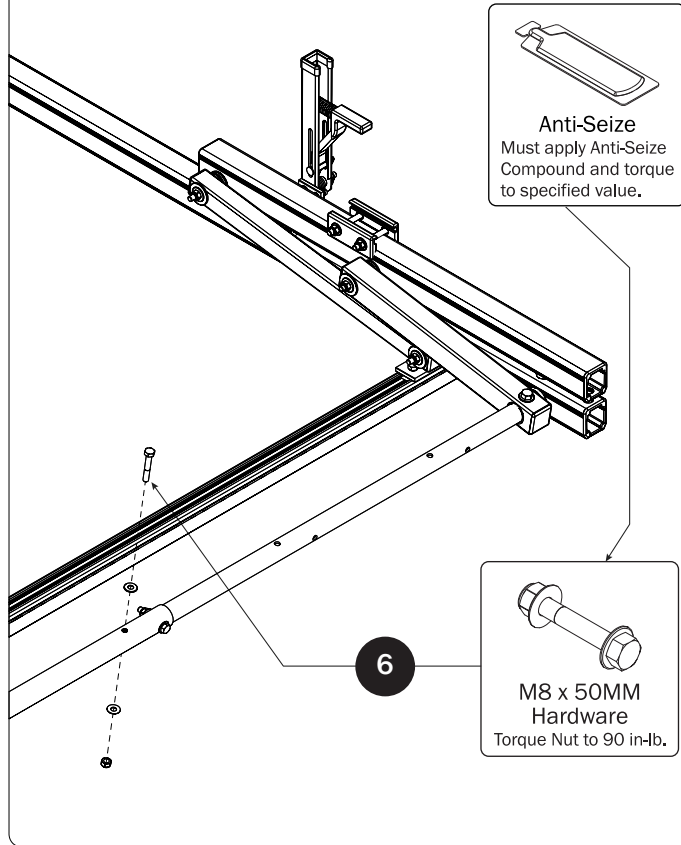

Z POSTS

SEE QUICK START GUIDE FOR ADJUSTMENTS

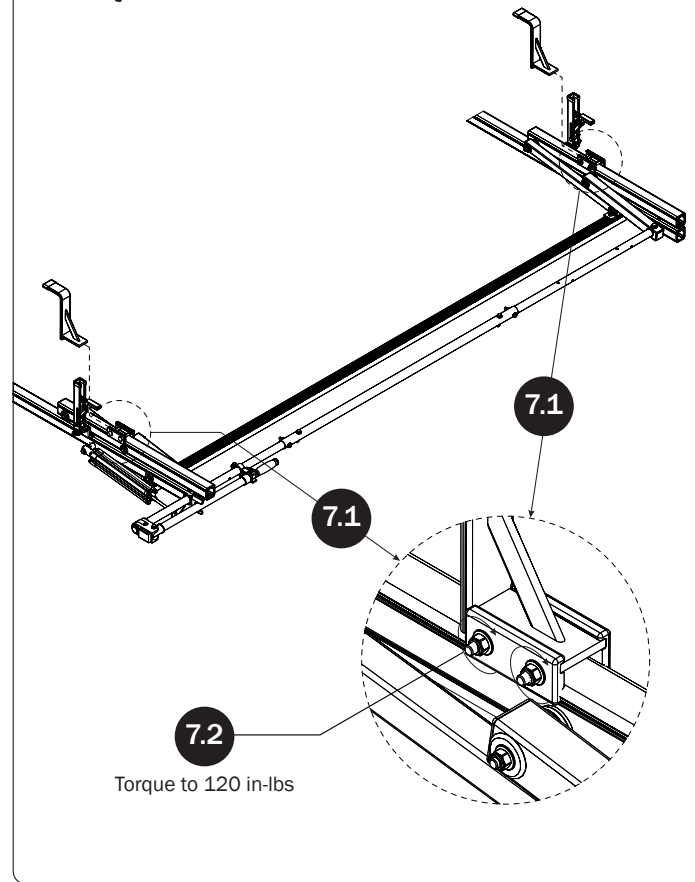

L POSTS

SEE QUICK START GUIDE FOR ADJUSTMENTS

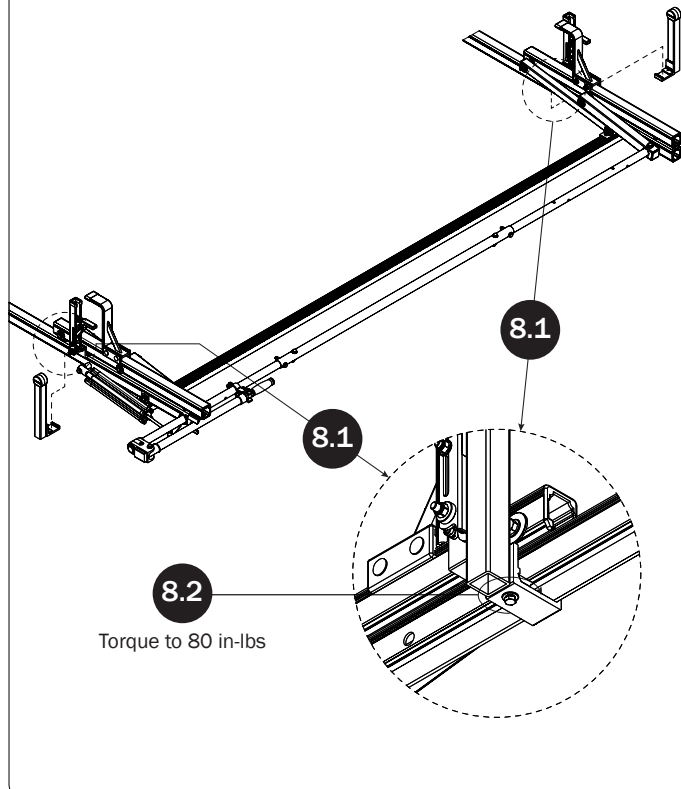

LEFT ROTATION ASSEMBLY SEQUENCE

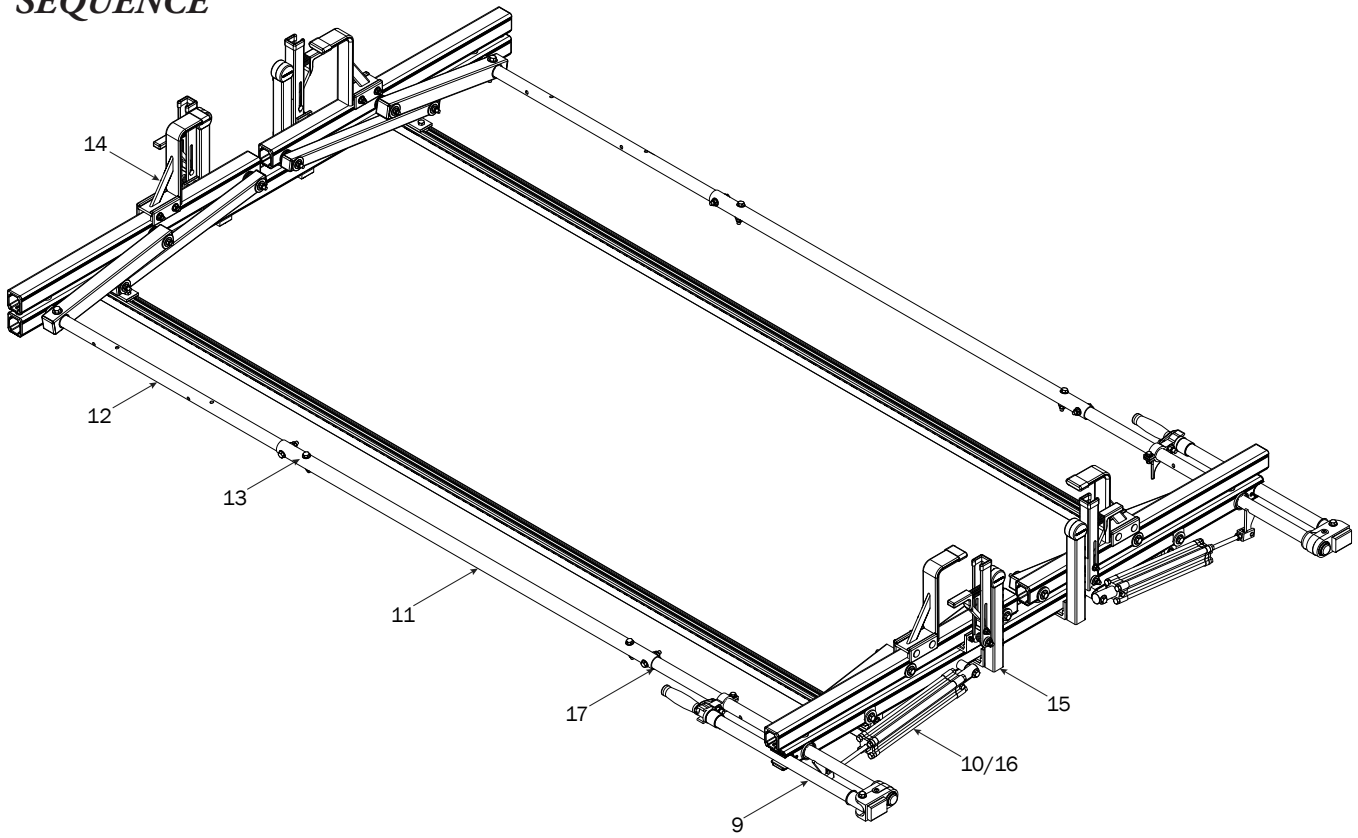

REAR DRIVE SHAFT

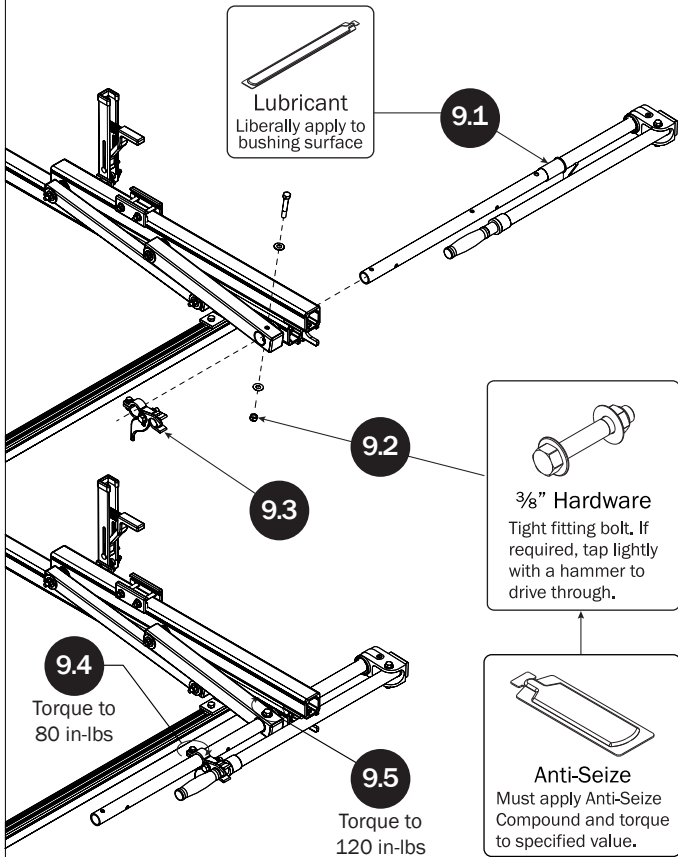

CYLINDER HARDWARE

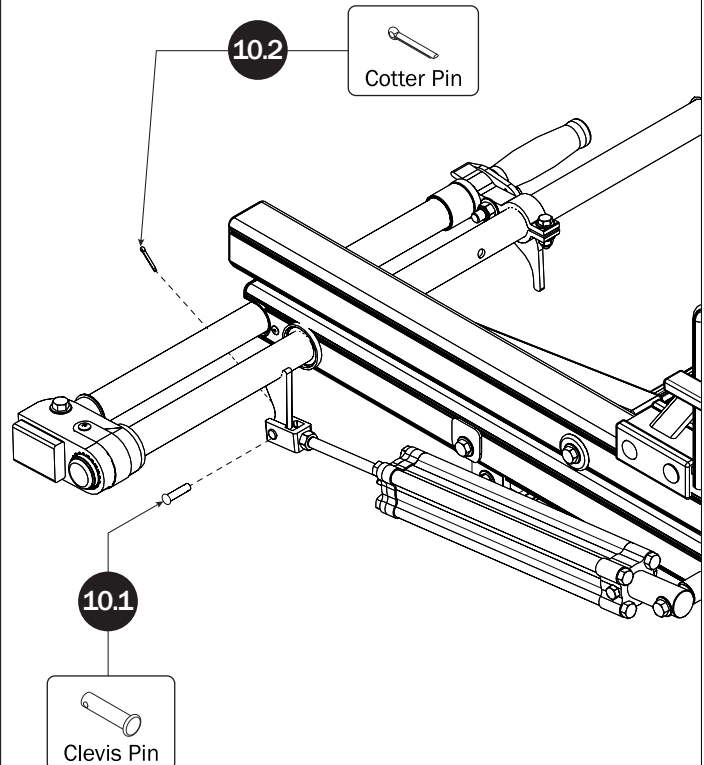

CONNECTING BAR

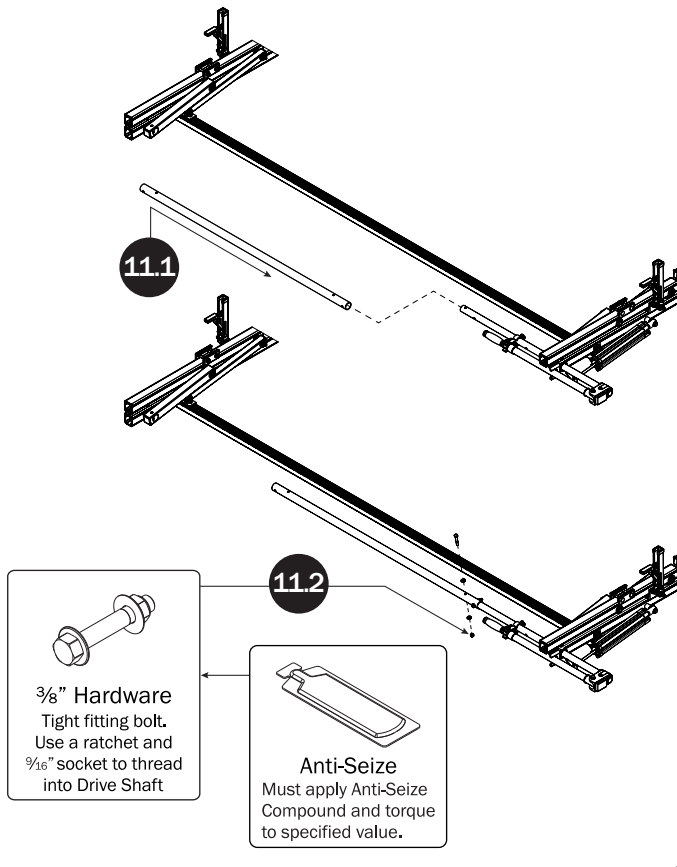

FRONT DRIVE SHAFT

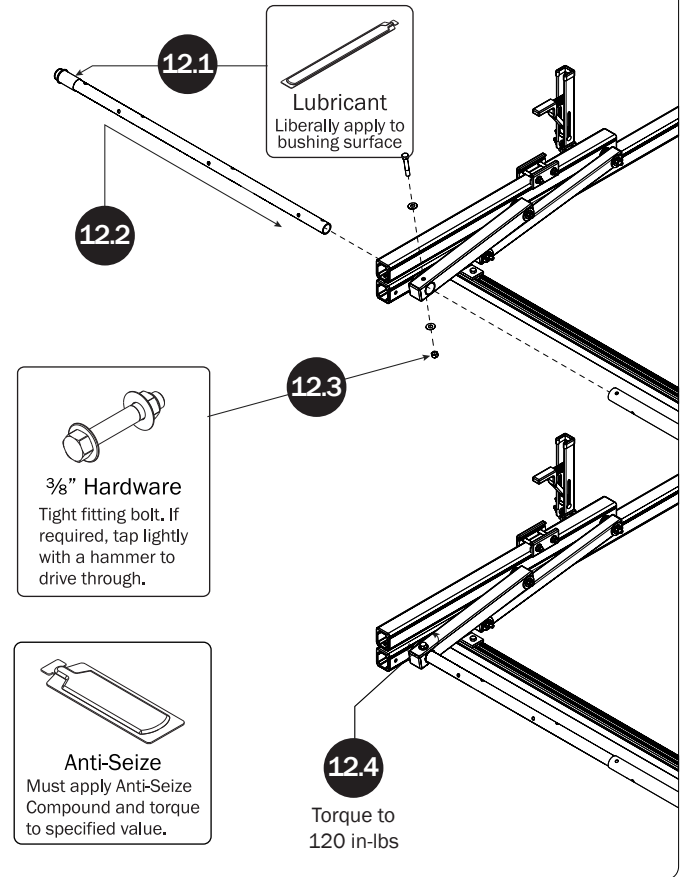

CONNECTING BAR FASTENERS

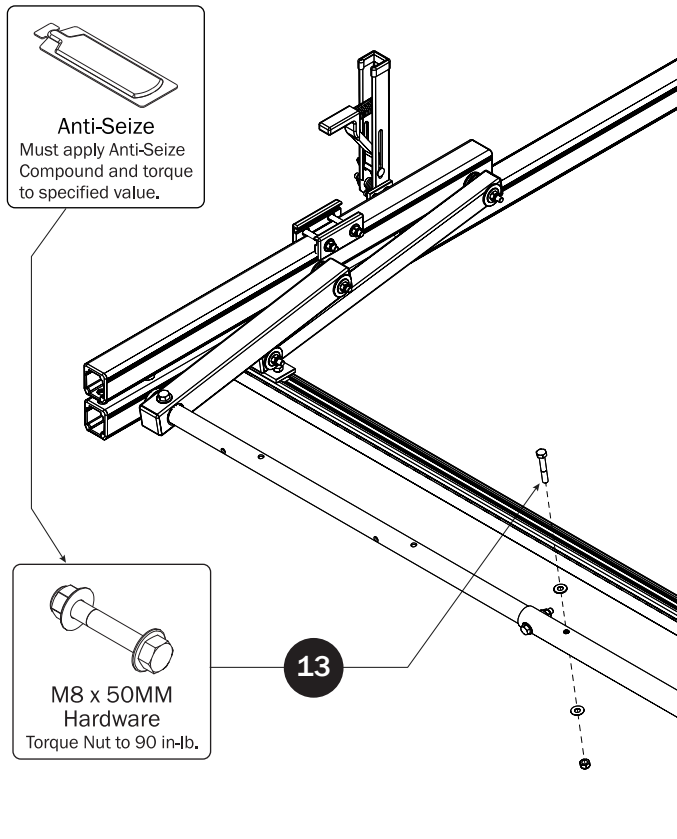

Z POSTS

SEE QUICK START GUIDE FOR ADJUSTMENTS

