

# PRIME DESIGN™

A Safe Fleet Brand

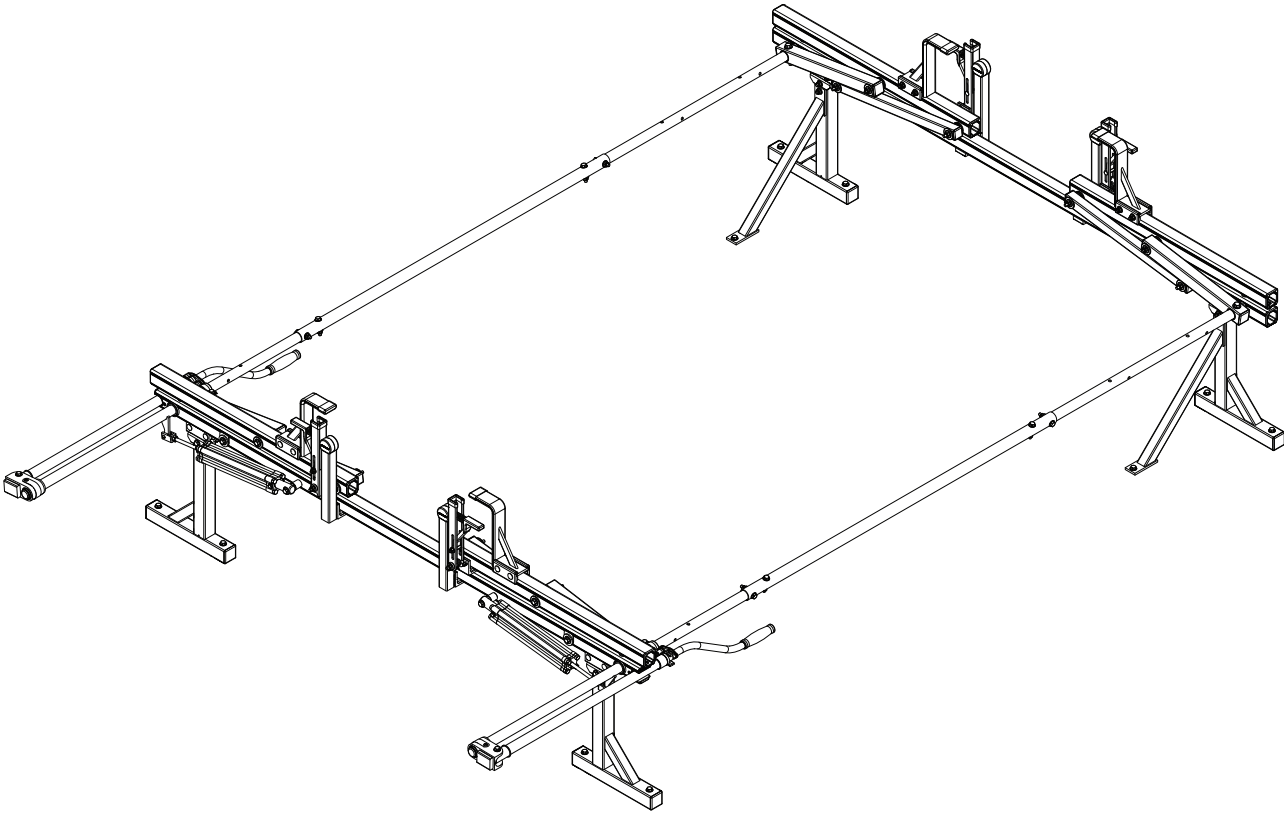

PRR 0005

CONTENTS OVERVIEW

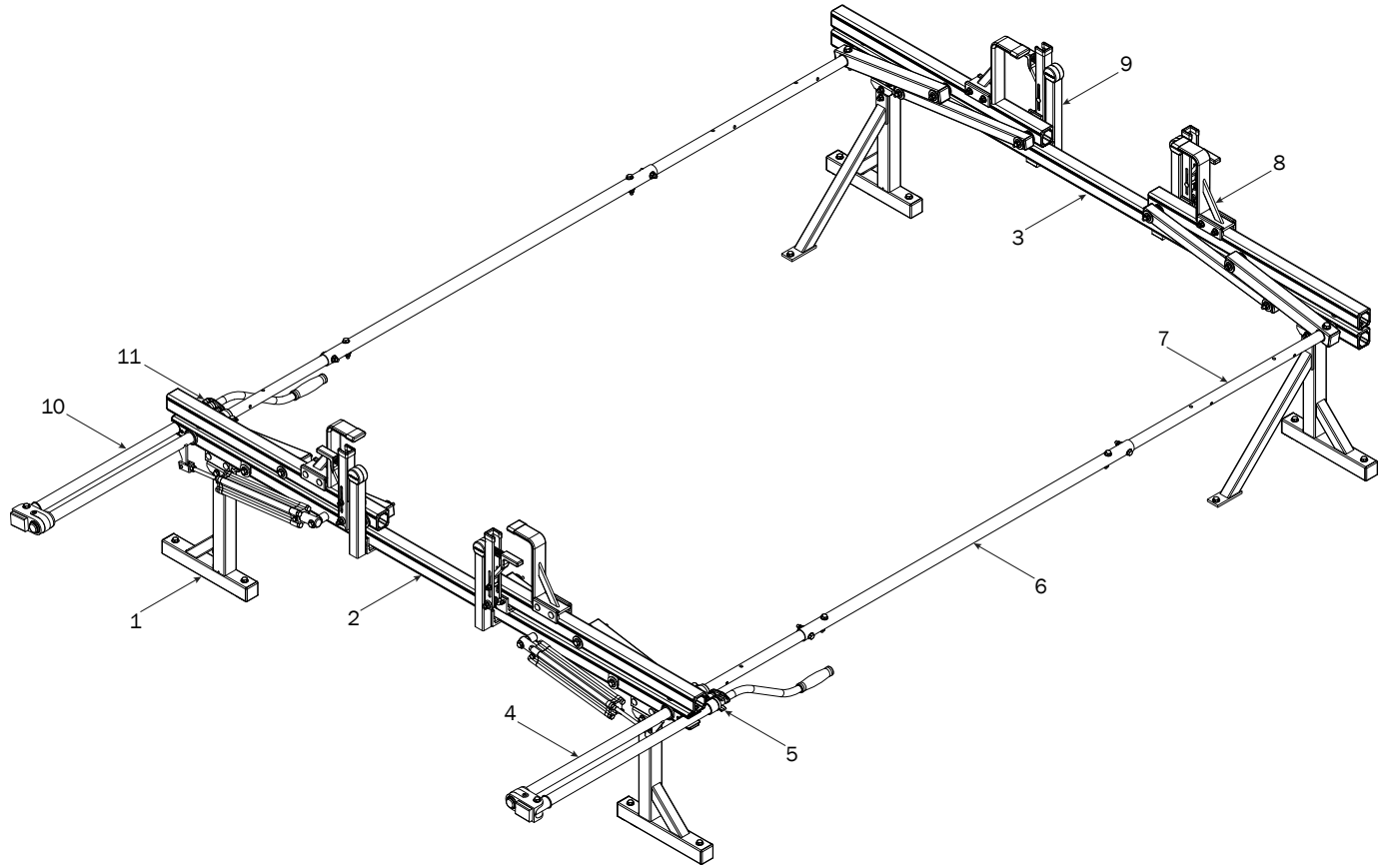

1—FBM-0031..... (Qty 1)  
Mounting Brackets with hardware

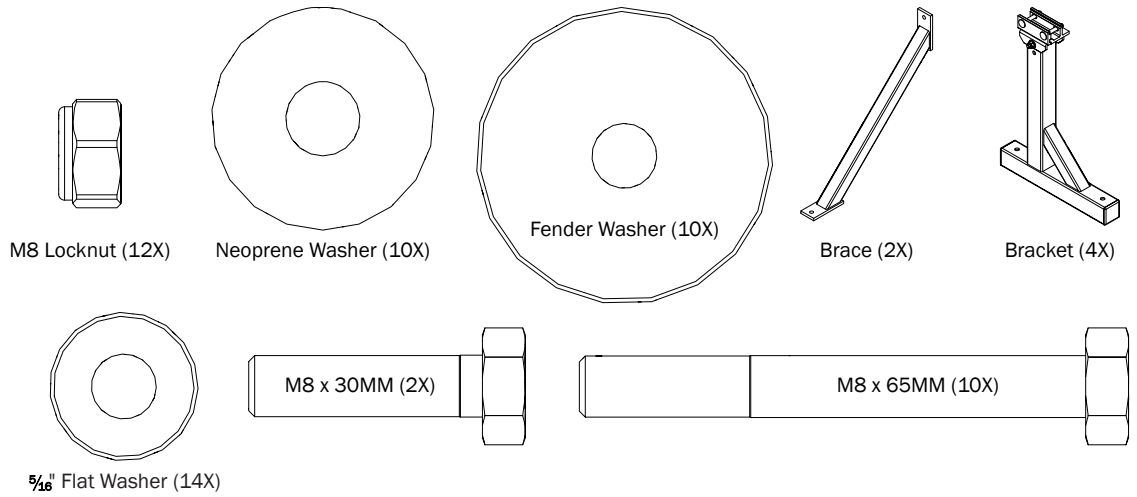

2—Rear Crossbar Assembly..... (Qty 1)

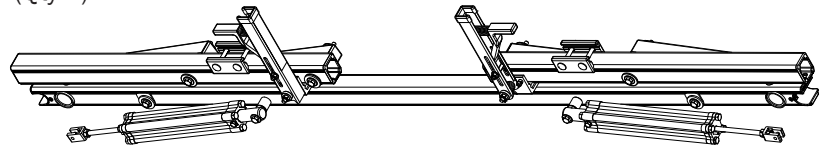

3—Front Crossbar Assembly..... (Qty 1)

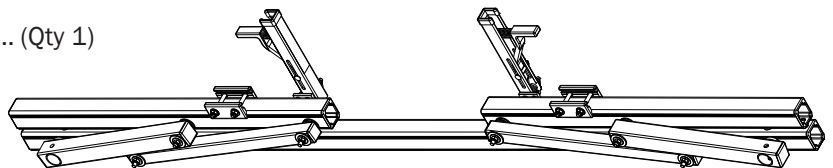

4—Rear Drive Shaft..... (Qty 1)  
Right Hand, B4 Version, 46.00”

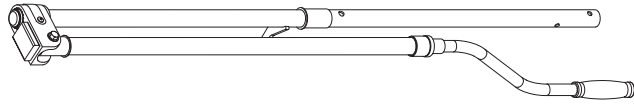

5—Handle Latch Assembly ..... (Qty 1)  
Right Hand



6—Connecting Bar..... (Qty 2)  
4.00’

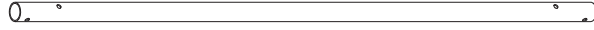

7—Front Drive Shaft ..... (Qty 2)  
B Version, 35.75”

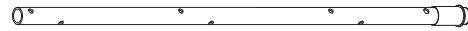

8—Z Post ..... (Qty 4)  
Adjustable, 7.25”

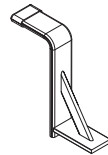

9—L Post..... (Qty 4)  
Roller Cap, 9.25”

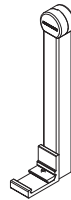

10—Rear Drive Shaft..... (Qty 1)  
Left Hand, B4 Version, 46.00”

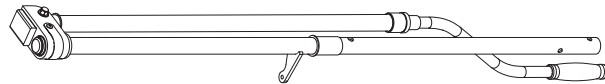

11—Handle Latch Assembly ..... (Qty 1)  
Left Hand



12—HKT-8163-Rotation Hardware Kit ..... (Qty 2)  
(Not called out in Overview)

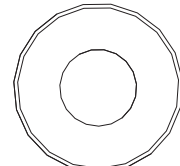
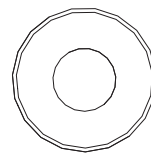
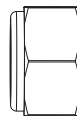
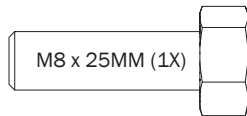
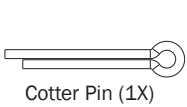
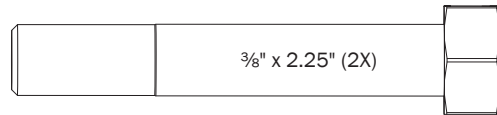

M8 Lock Nut (5X)

3/8" Lock Nut (2X)

5/16" Flat Washer (10X)

3/8" Flat Washer (4X)

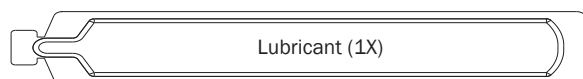
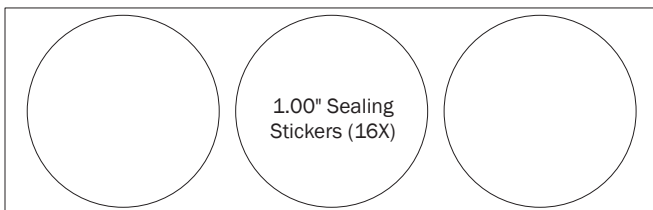

**FBM-0031**  
8' (96") CONFIGURATION

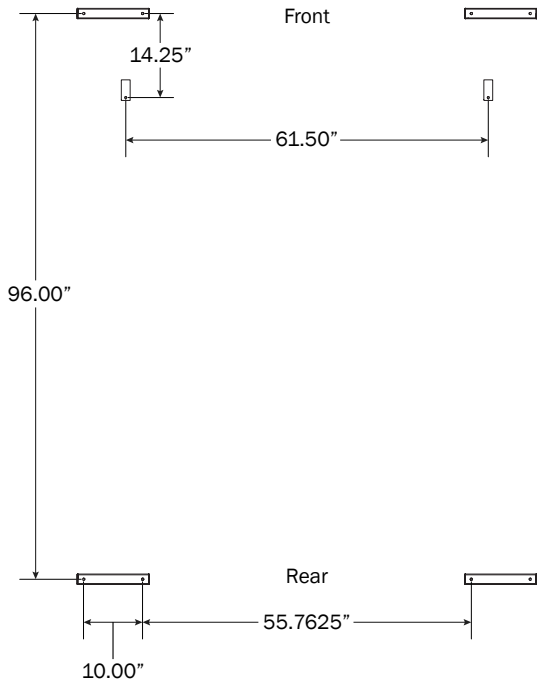

7' (84") CONFIGURATION

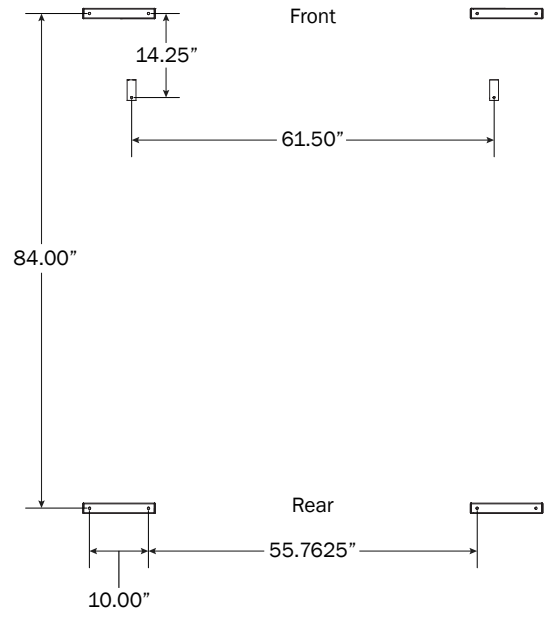

6' (72") CONFIGURATION

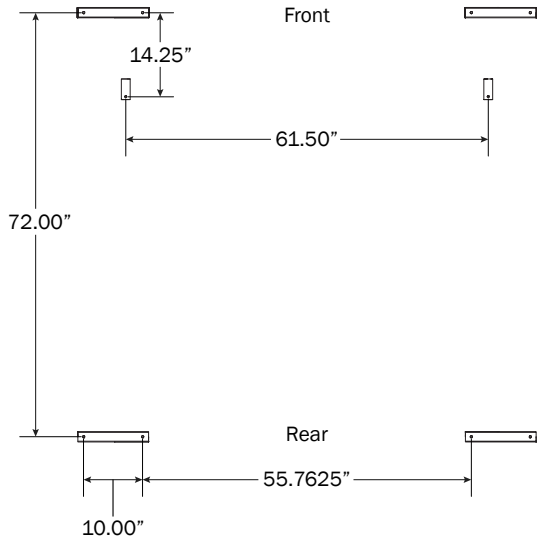

**0.1** Assemble the Braces to the Mounting Brackets using the specified hardware as shown below.

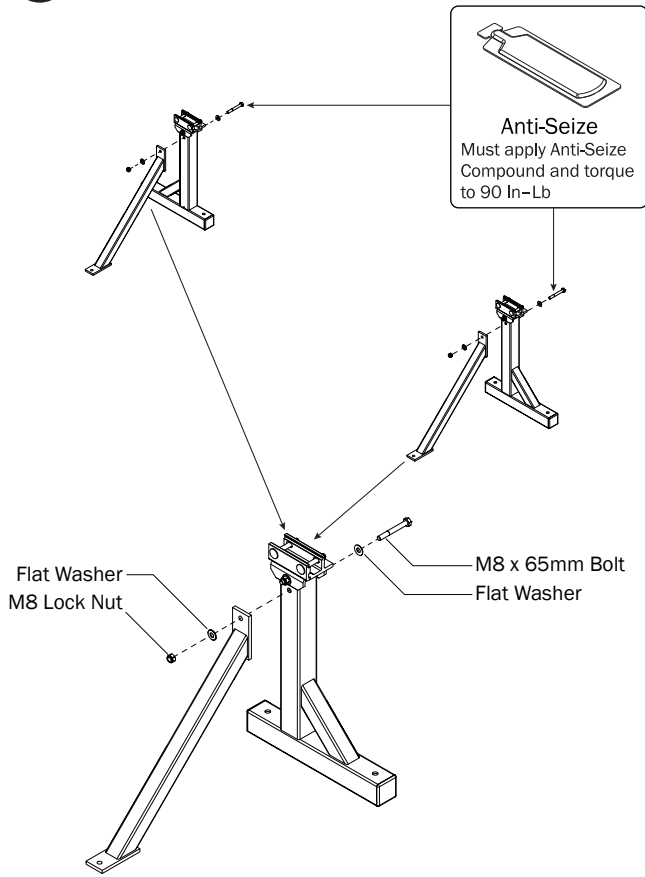

**0.2** Verify correct positioning and location of Mounting Brackets to utility body prior to installing hardware.

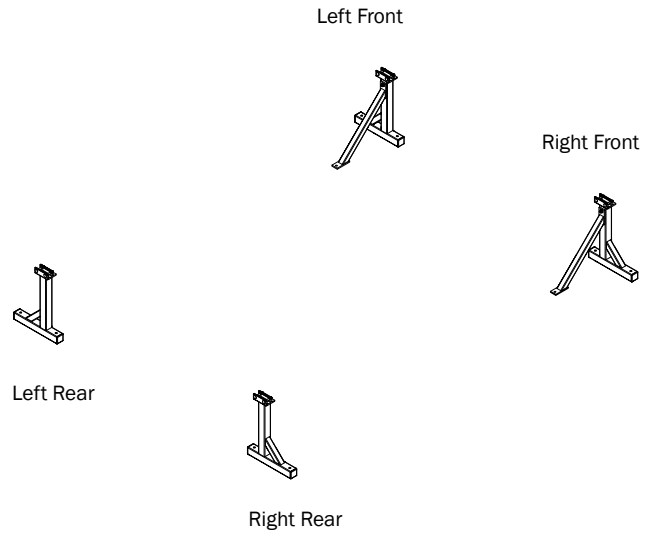

**0.3** Install the Mounting Brackets using the specified hardware as shown below.

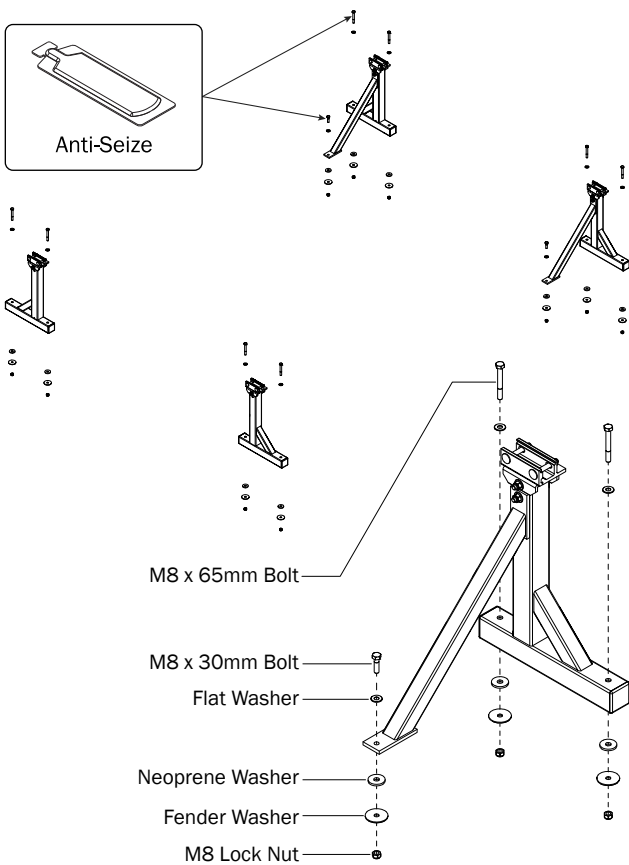

**0.4** Loosen all indicated Nuts to install the Crossbars. Do not tighten until Step 1.2.

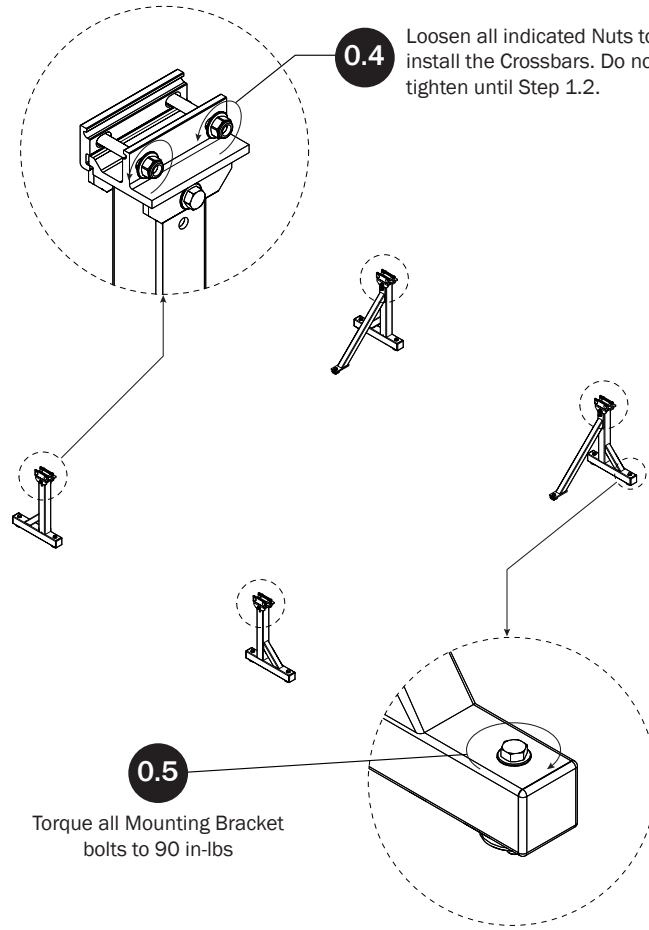

**RIGHT ROTATION ASSEMBLY**

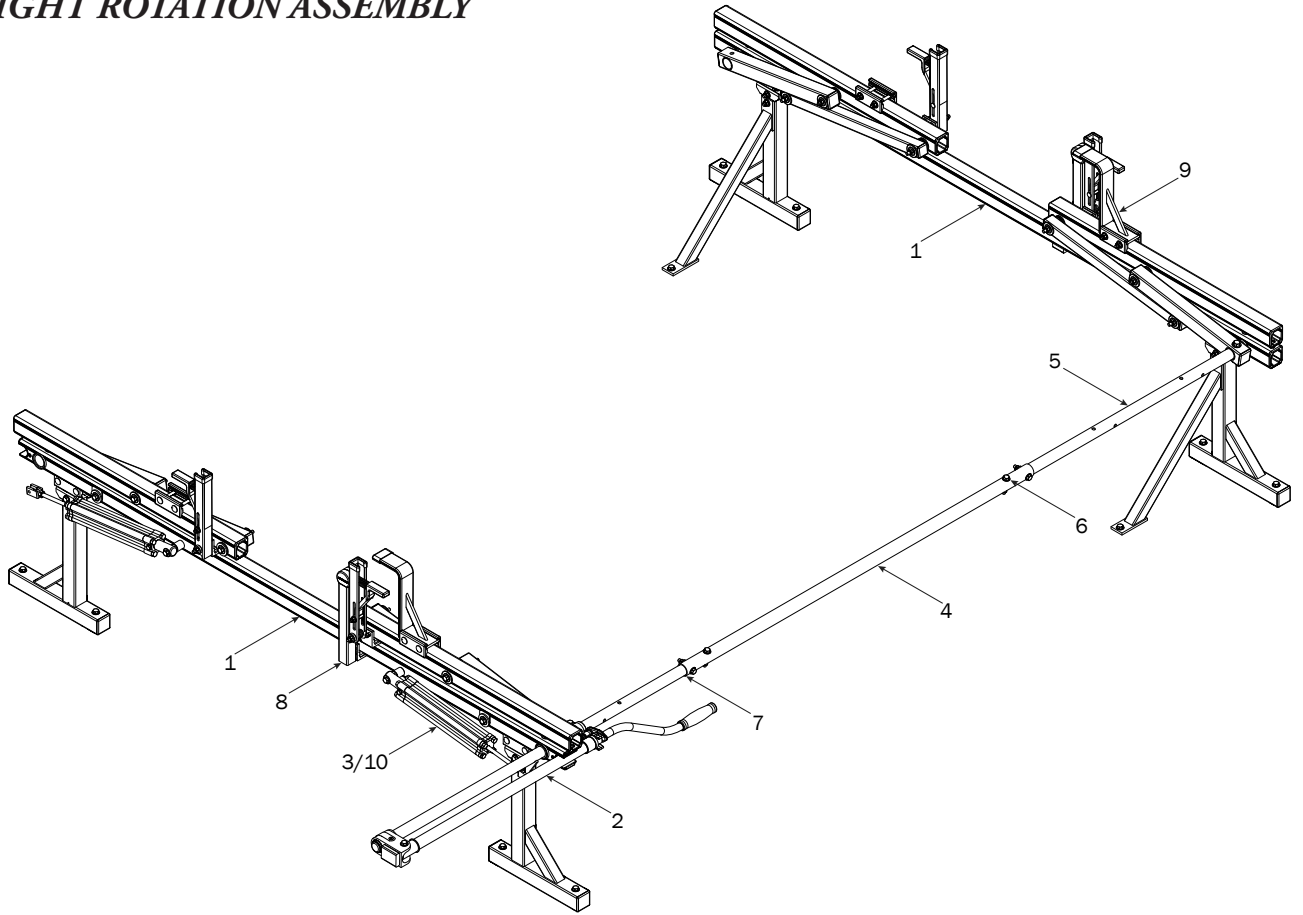

**CROSSBARS**

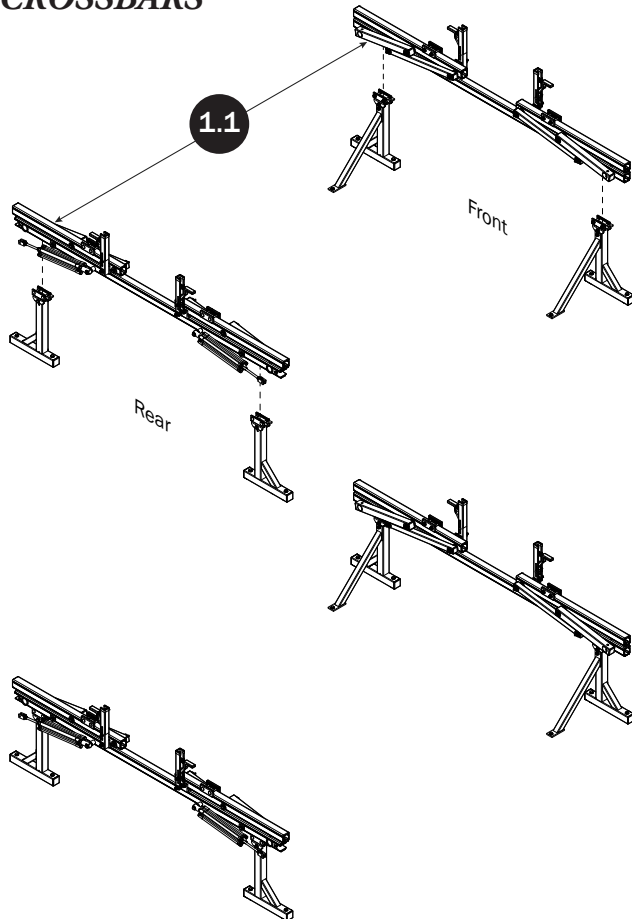

**CROSSBAR ADJUSTMENT**

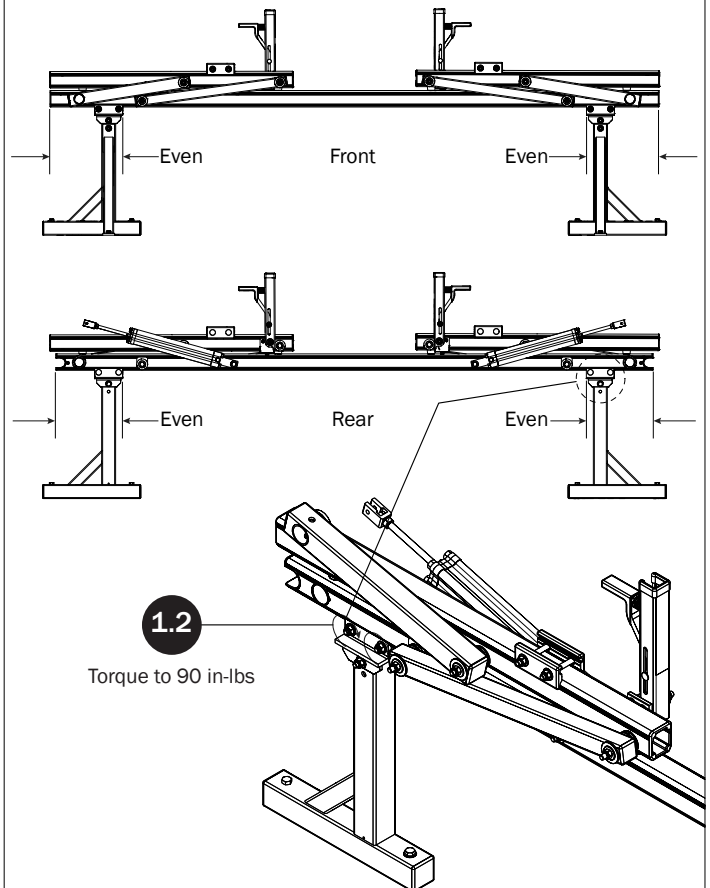

## REAR DRIVE SHAFT

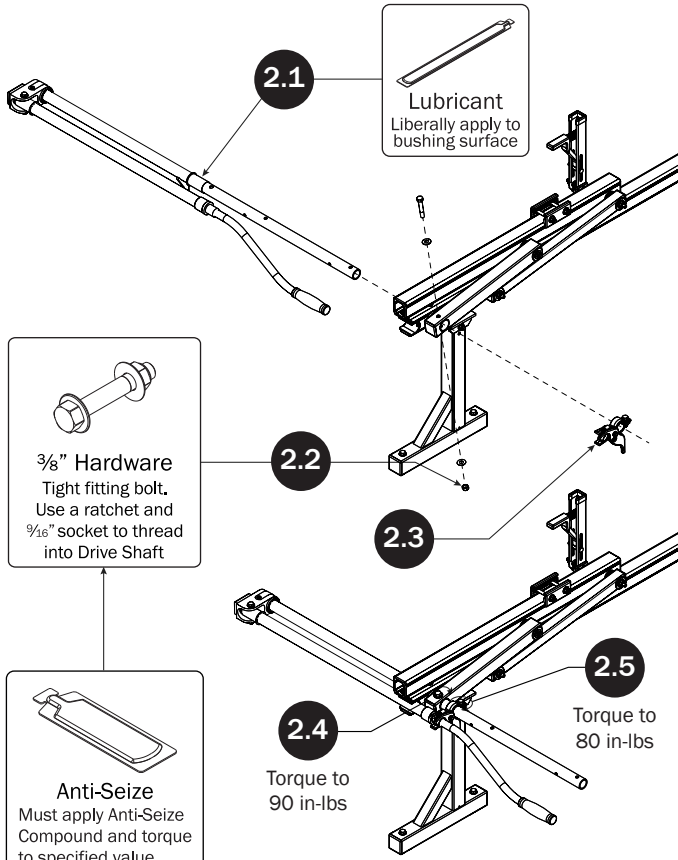

## CYLINDER HARDWARE

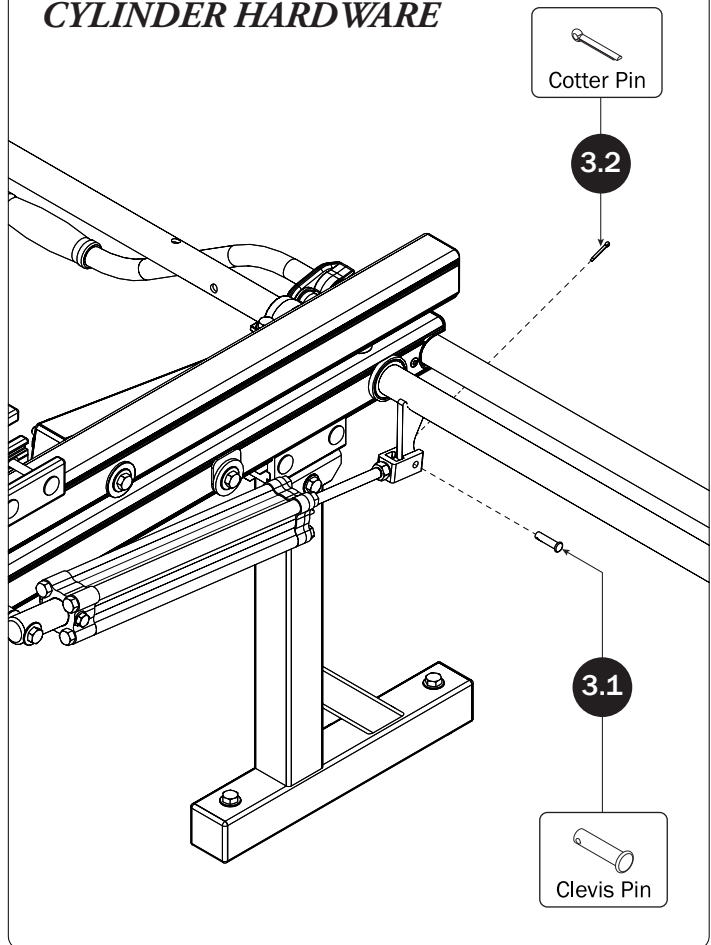

## CONNECTING BAR

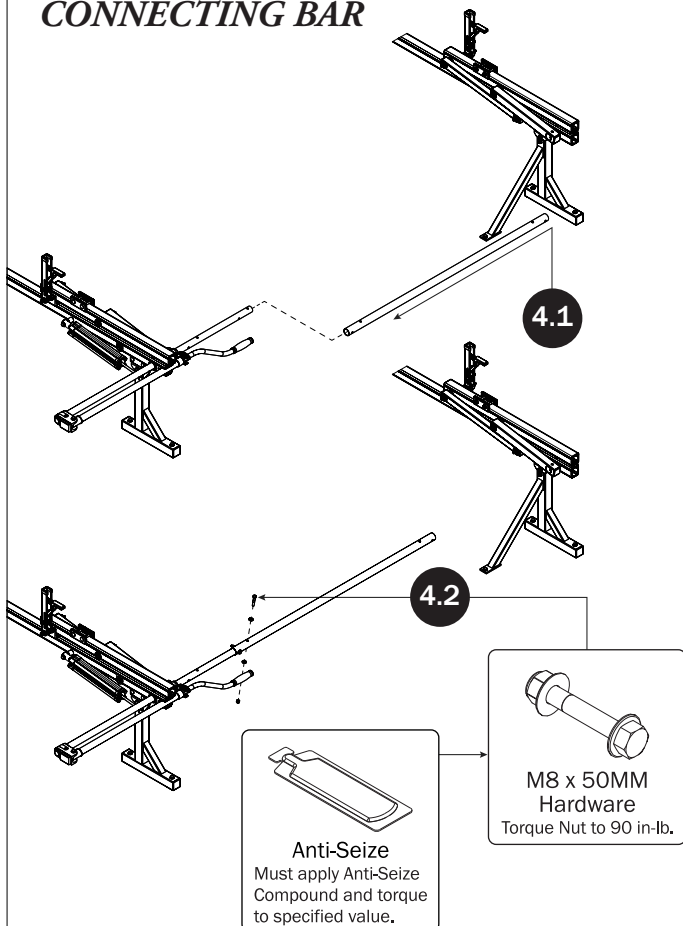

## FRONT DRIVE SHAFT

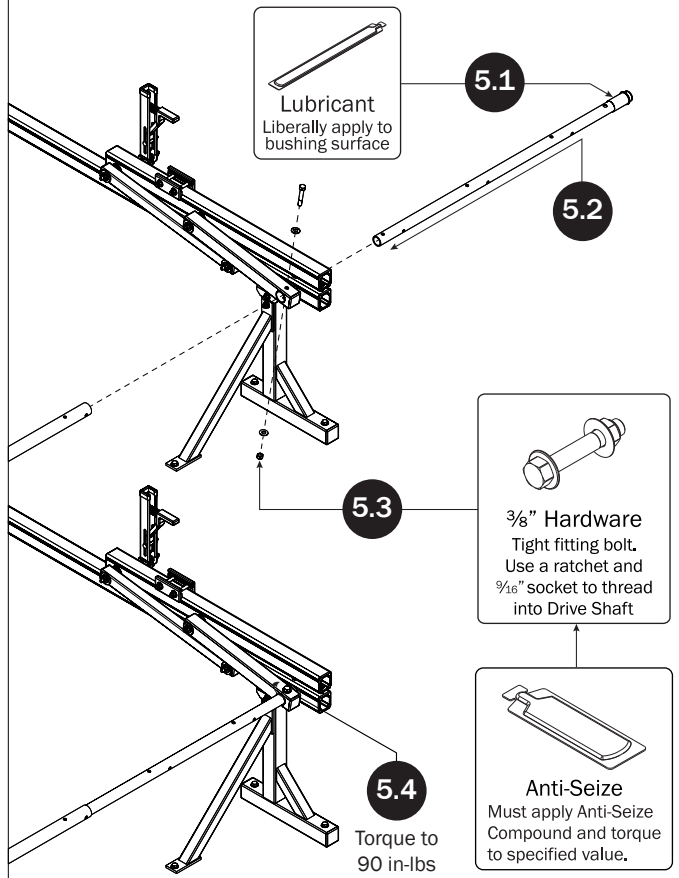

**CONNECTING BAR FASTENERS**

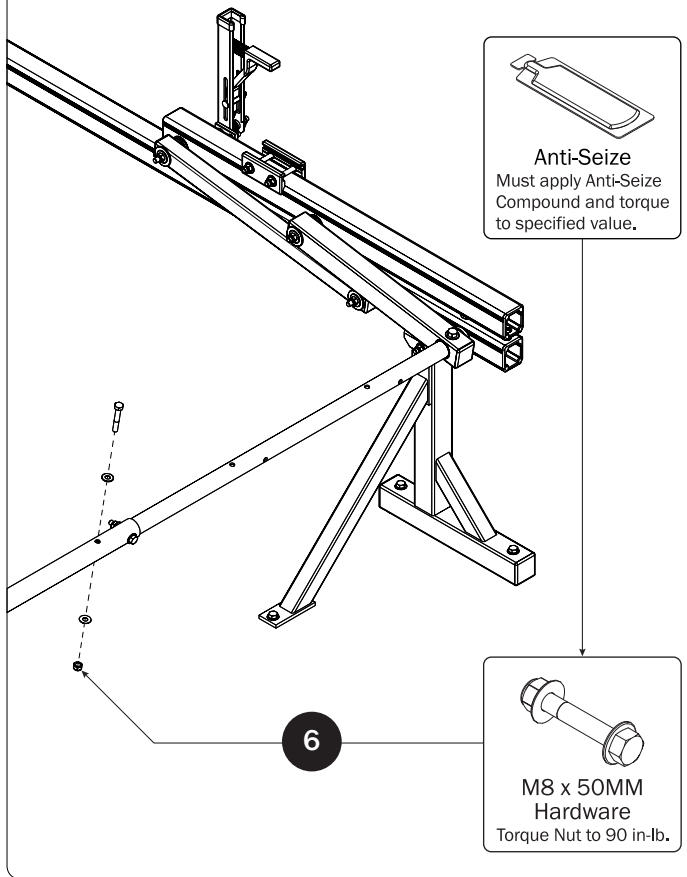

**DRIVE SHAFT SEALING**

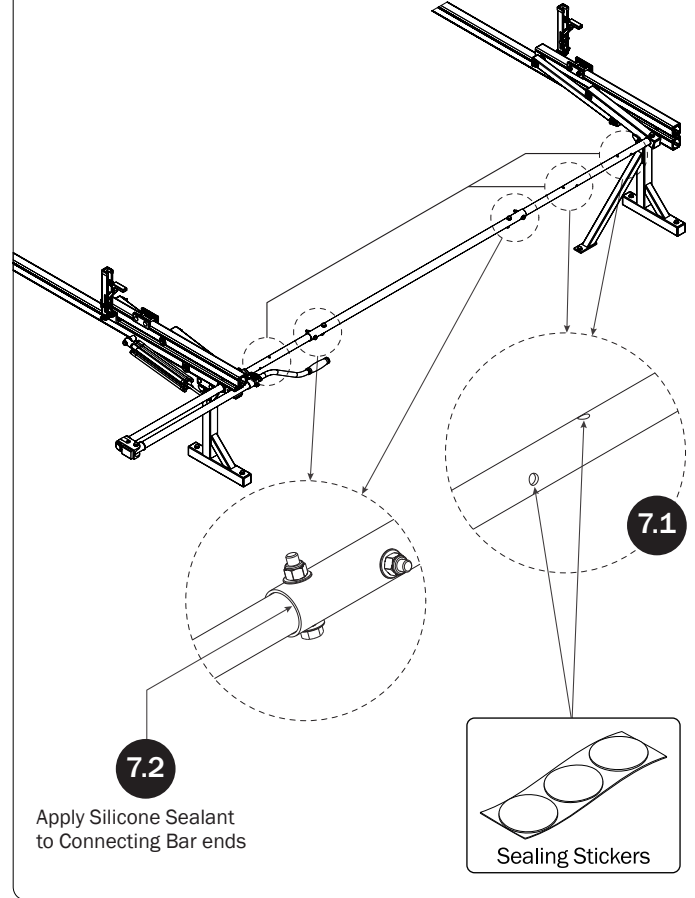



## L POSTS

### SEE QUICK START GUIDE FOR ADJUSTMENTS

**NOTE:** The Auto Clamps may come preset from the factory for packaging purposes only. To assemble the L Posts to the Crossbars, the Auto Clamps may need to be repositioned.

Ensure the Auto Clamp Spring is seated into the spring catch.

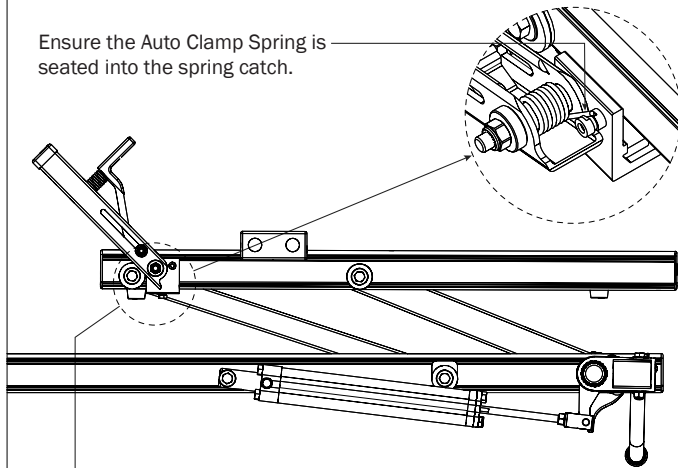

**8.1** Beginning with the Rear Crossbar, loosen the bolt at the bottom of the Auto Clamp, then slide the Auto Clamp toward the inside end of the Rotation Upper. Reposition the Auto Clamp leaving a minimum of 1/4" distance from the rubber bumper to the edge of the Auto Clamp Bracket as shown, then finger-tighten if adjusting later, or torque to 80 in-lbs.

**8.2**

Prepare the L Post by removing the hex head bolt, lock washer, flat washer, and Bracket Clamp. Retain for installation Steps 8.4—8.8.

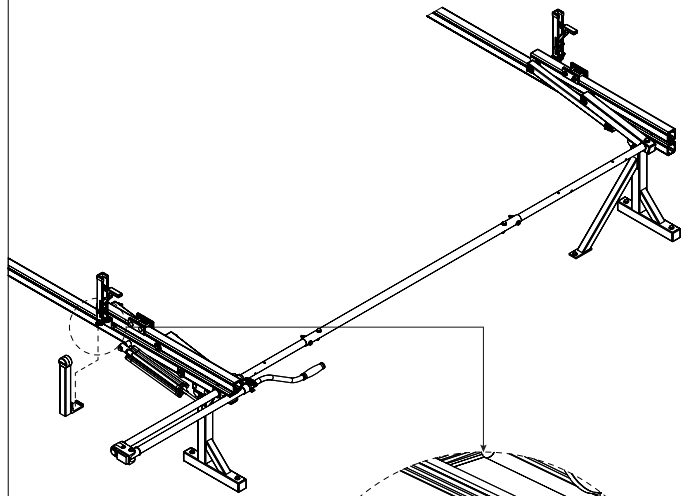

**8.3**

Place the L Post into the bottom groove of the Rear Crossbar, ensuring the L Post seats into the Crossbar's inside bottom groove as seen from the front of the Rear Crossbar.

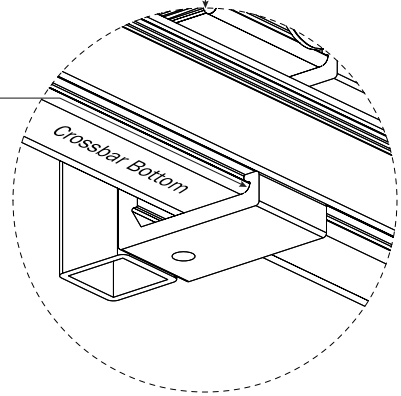

**8.4**

Slide L Post Bracket Clamp into bottom groove, then slide into L Post Bracket as shown.

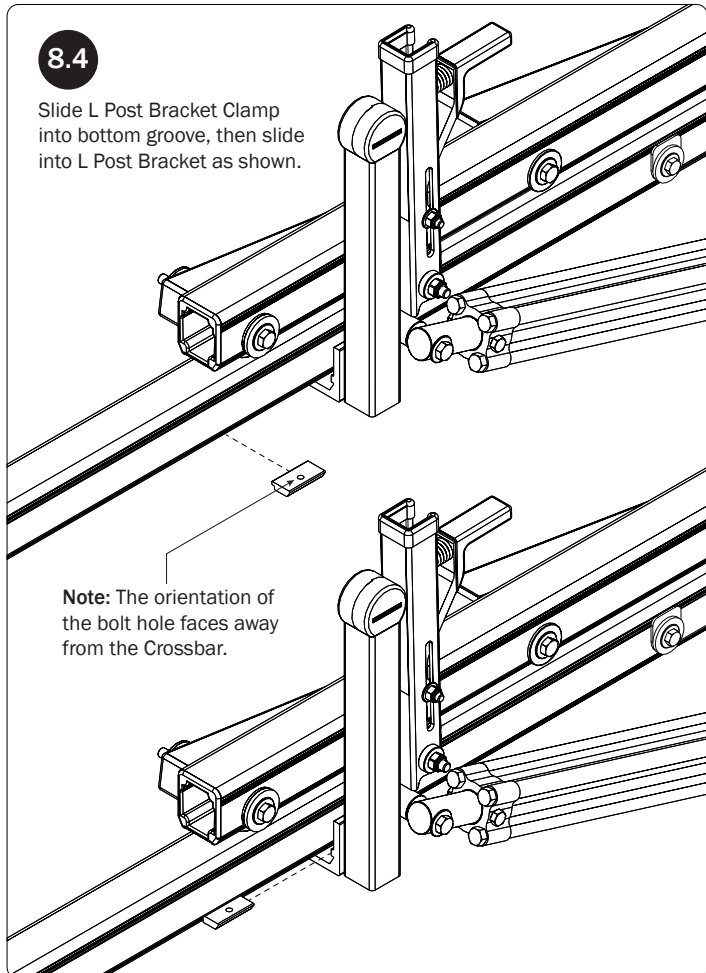

**Note:** The orientation of the bolt hole faces away from the Crossbar.

**8.5**

Bracket Clamp sits in L Post Bracket as shown.

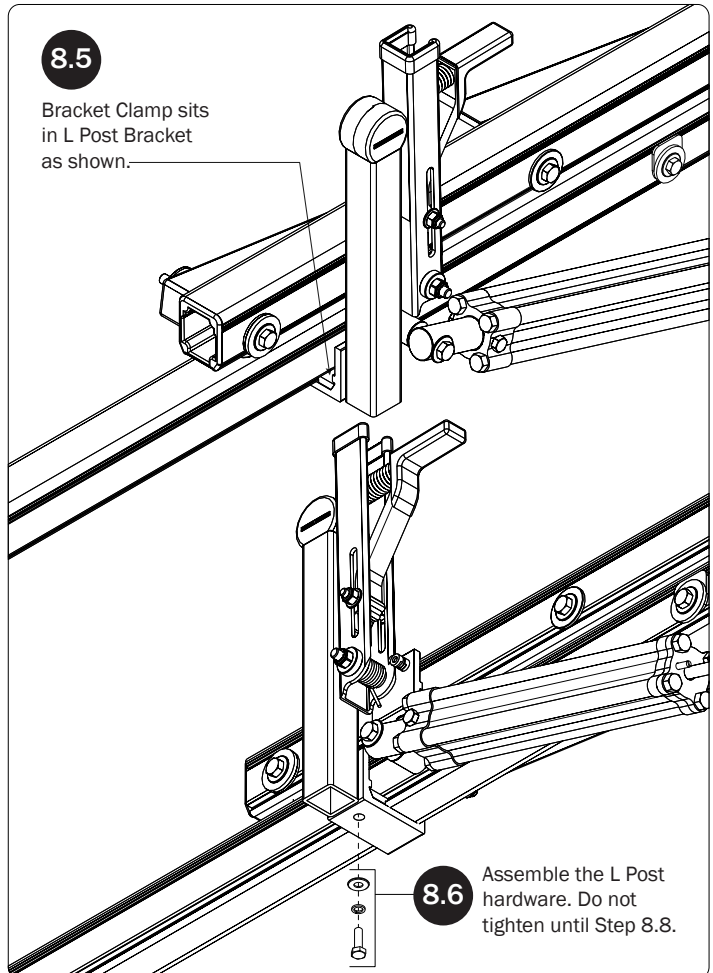

**8.6**

Assemble the L Post hardware. Do not tighten until Step 8.8.

8.7

Slide the L Post until parallel to the Auto Clamp and the gap between the two is even from top to bottom.

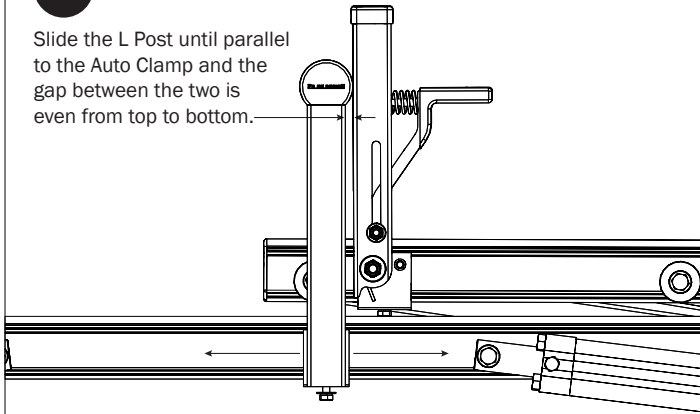

Torque to 80 in-lbs

8.8

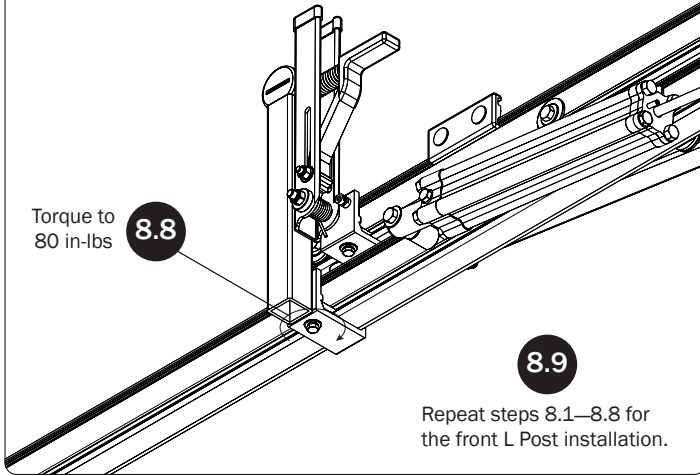

8.9

Repeat steps 8.1—8.8 for the front L Post installation.

9.2

Refer to the Quick Start Guide for Z Post positioning.

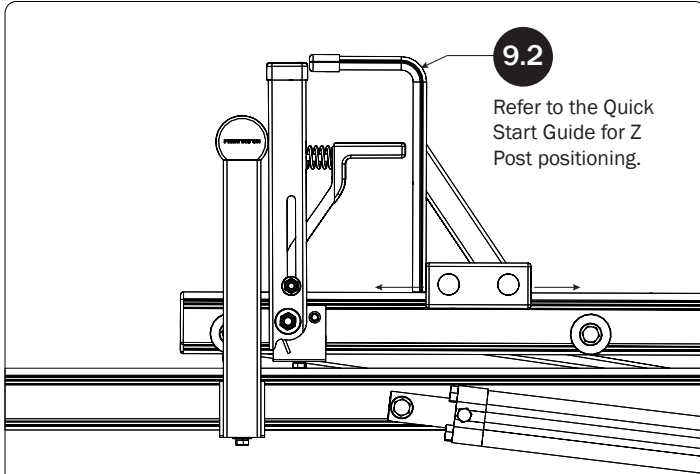

9.3

Torque to 90 in-lbs

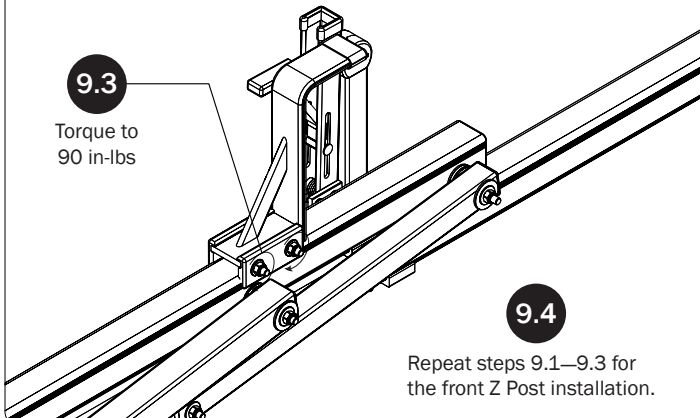

9.4

Repeat steps 9.1—9.3 for the front Z Post installation.

## Z POSTS

SEE QUICK START GUIDE FOR ADJUSTMENTS

9.1

Slide the Z Post into the Mounting Clamp Assembly.

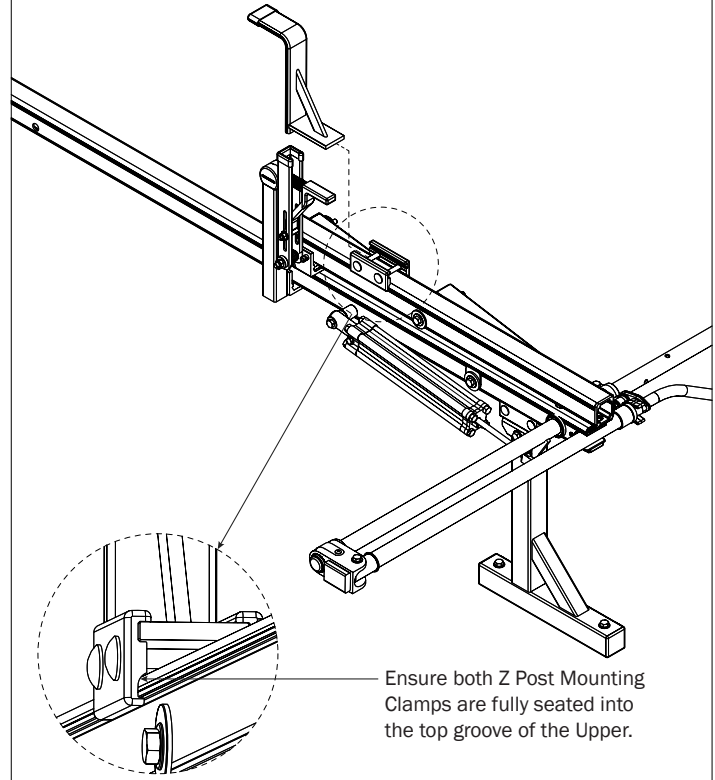

Ensure both Z Post Mounting Clamps are fully seated into the top groove of the Upper.

## CYLINDER ADJUSTMENT

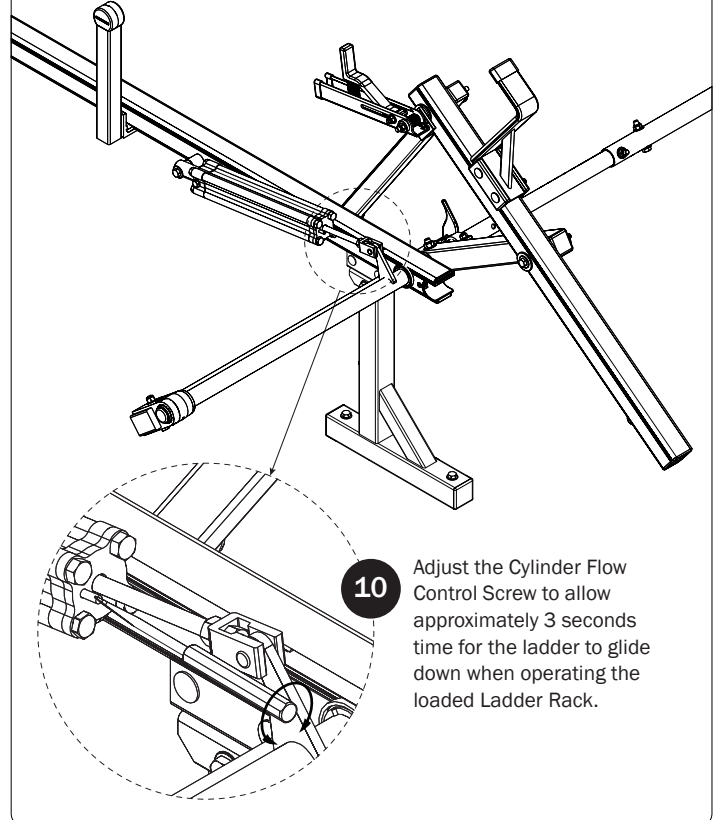

10

Adjust the Cylinder Flow Control Screw to allow approximately 3 seconds time for the ladder to glide down when operating the loaded Ladder Rack.

# LEFT ROTATION ASSEMBLY

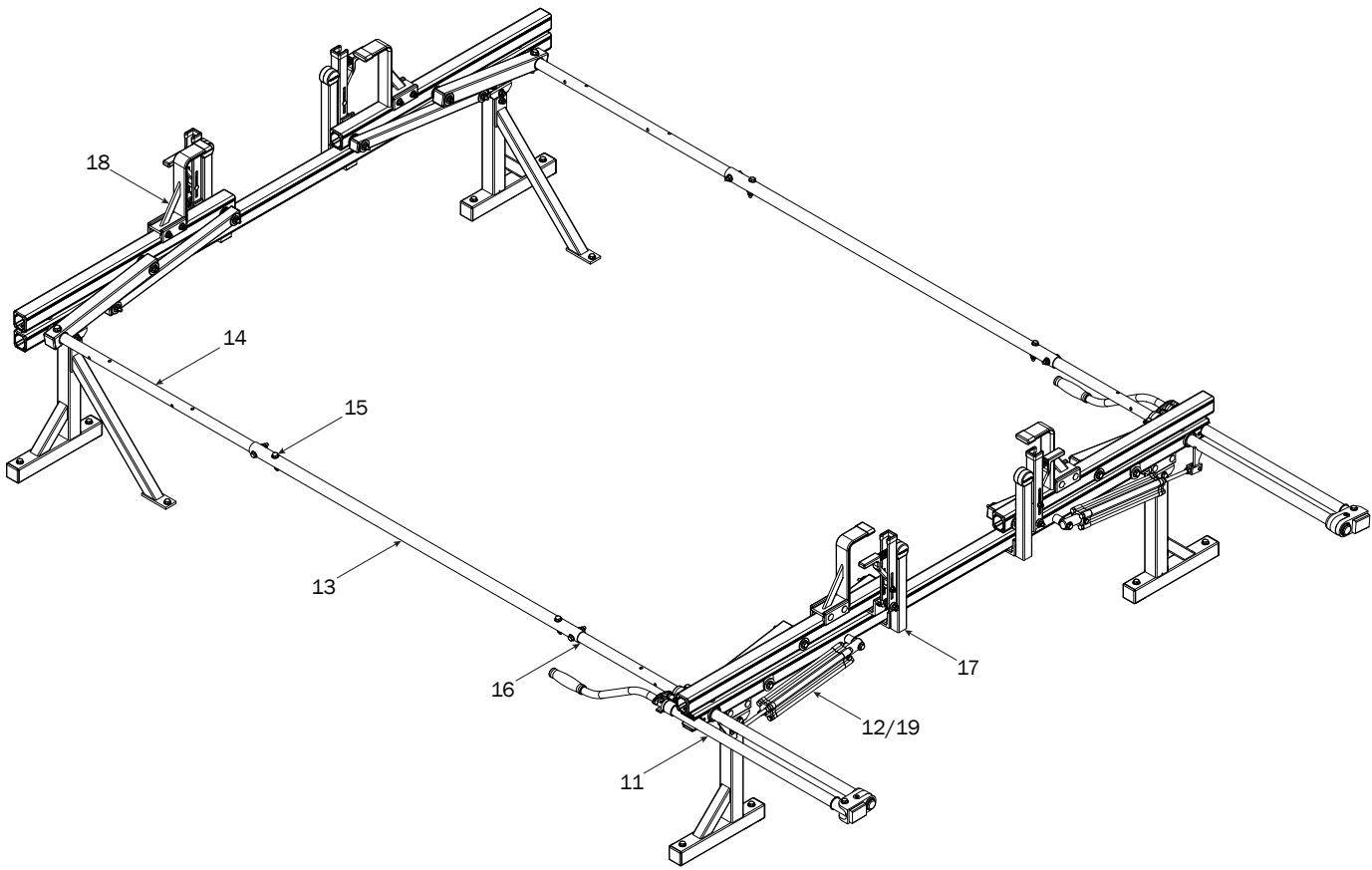

## REAR DRIVE SHAFT

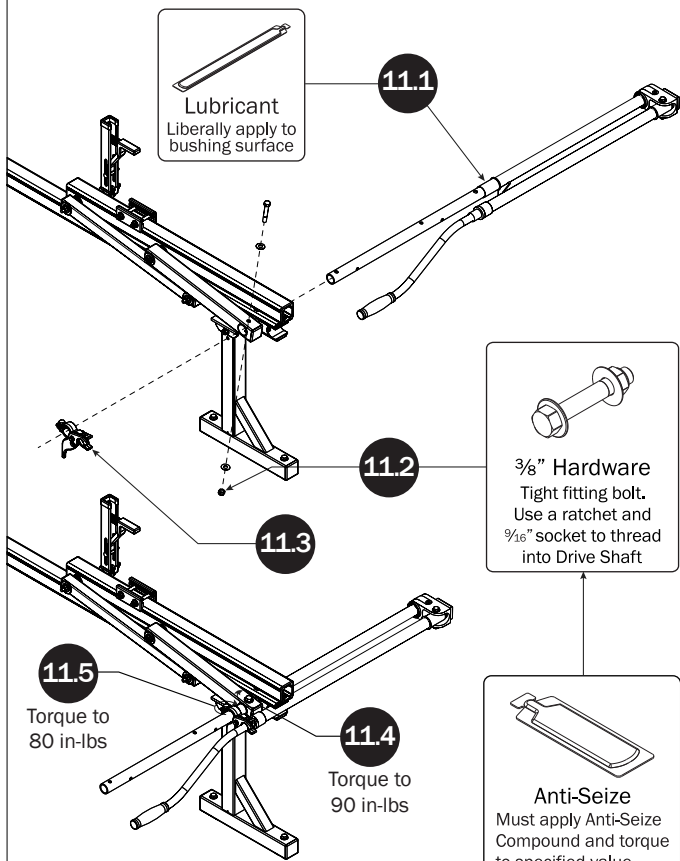

## CYLINDER HARDWARE

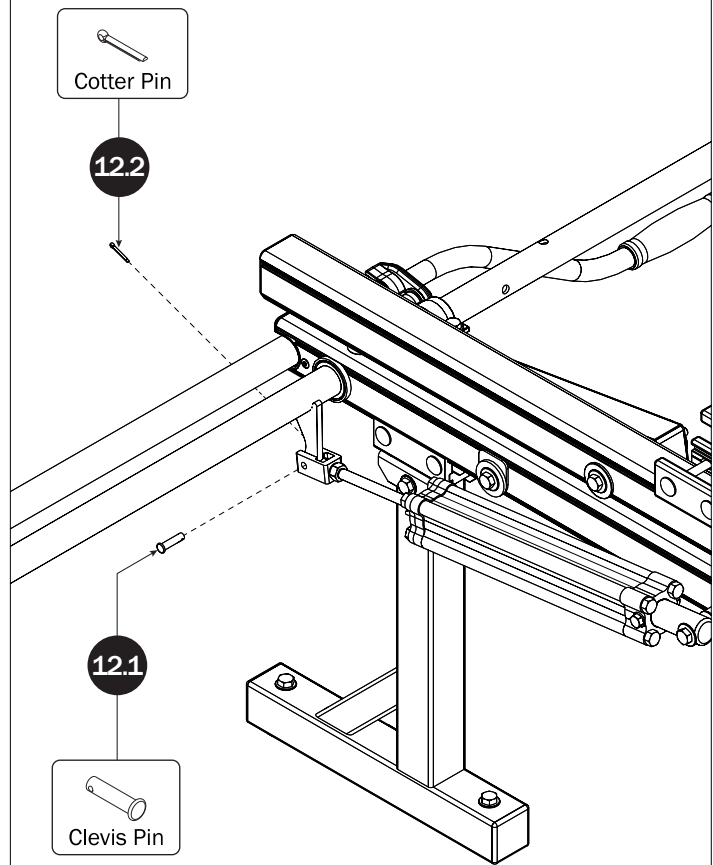

**CONNECTING BAR**

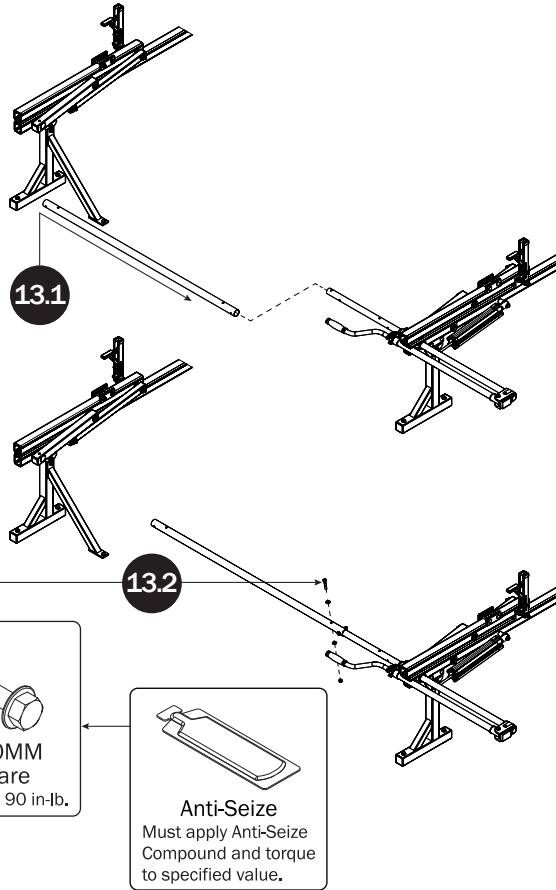

**FRONT DRIVE SHAFT**

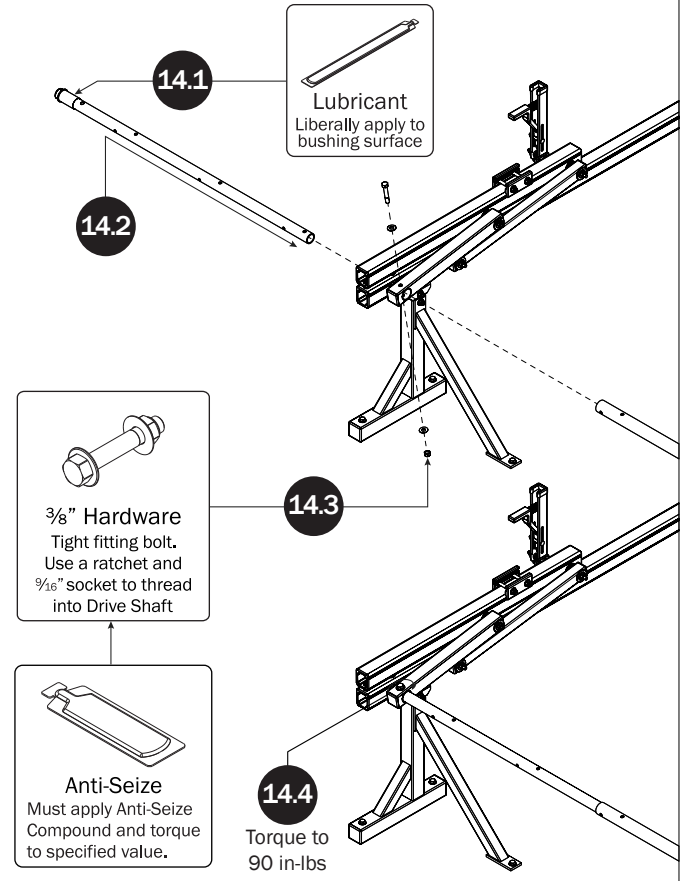

**CONNECTING BAR FASTENERS**

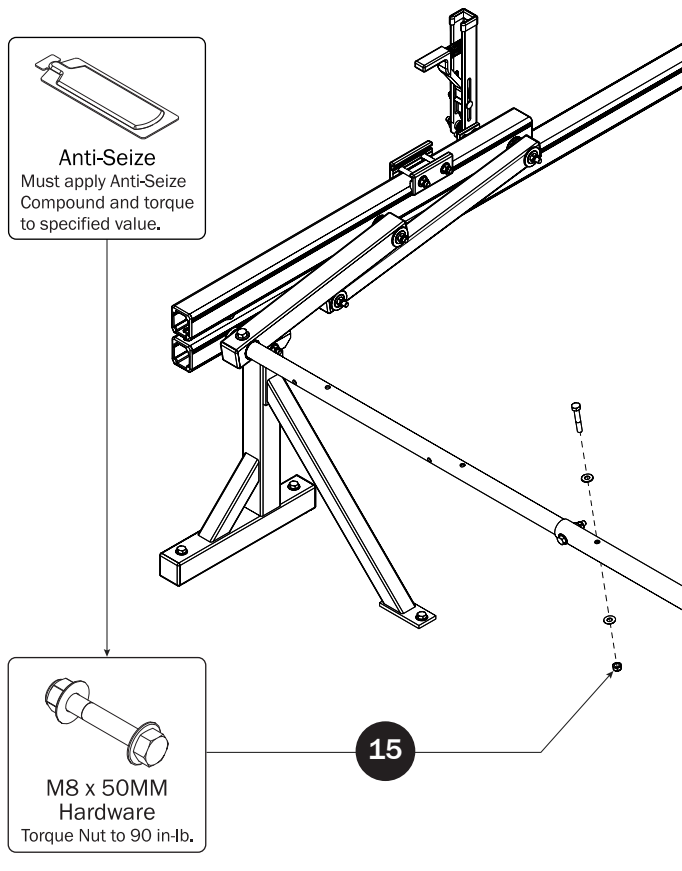

**DRIVE SHAFT SEALING**

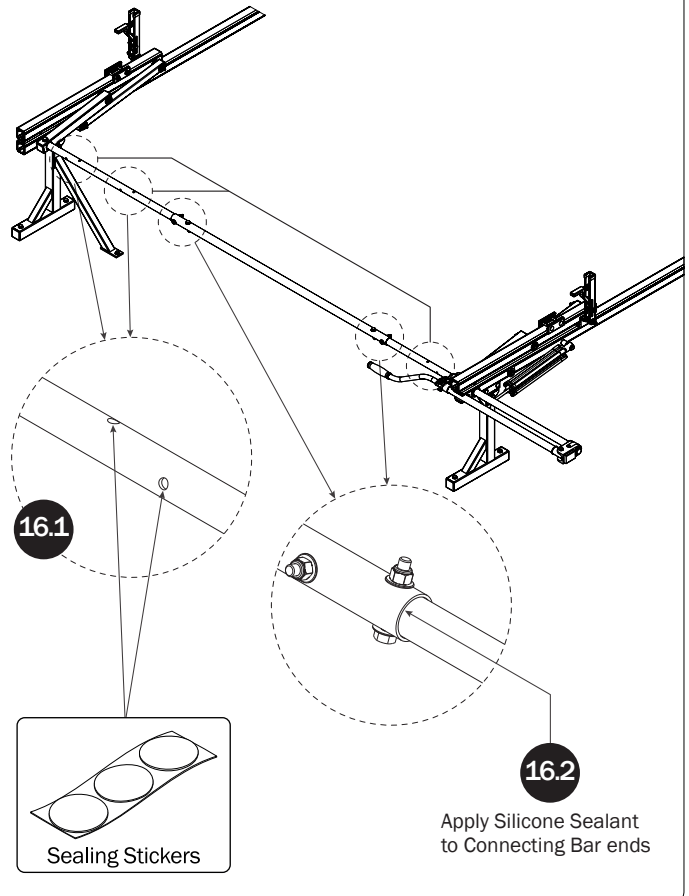

## L POSTS

### SEE QUICK START GUIDE FOR ADJUSTMENTS

**NOTE:** The Auto Clamps may come preset from the factory for packaging purposes only. To assemble the L Posts to the Crossbars, the Auto Clamps may need to be repositioned.

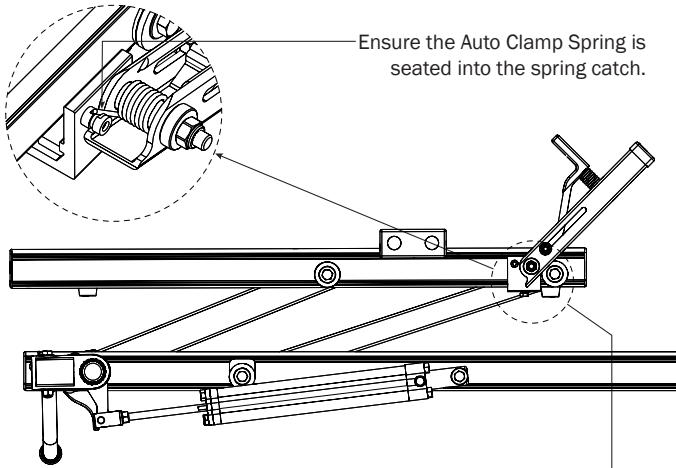

Ensure the Auto Clamp Spring is seated into the spring catch.

Beginning with the Rear Crossbar, loosen the bolt at the bottom of the Auto Clamp, then slide the Auto Clamp toward the inside end of the Rotation Upper. Reposition the Auto Clamp leaving a minimum of 1/4" distance from the rubber bumper to the edge of the Auto Clamp Bracket as shown, then finger-tighten if adjusting later, or torque to 80 in-lbs.

17.1

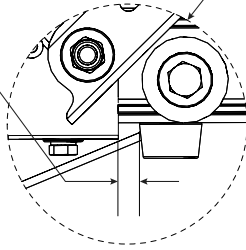

17.2 Prepare the L Post by removing the hex head bolt, lock washer, flat washer, and Bracket Clamp. Retain for installation Steps 17.4–17.8.

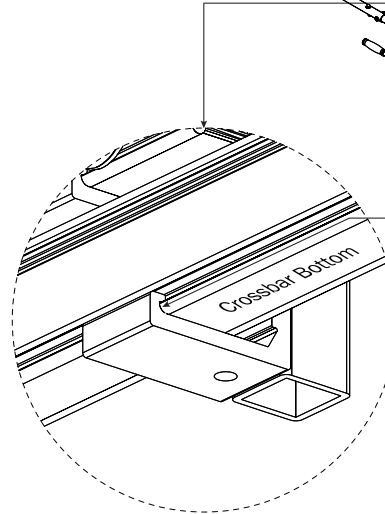
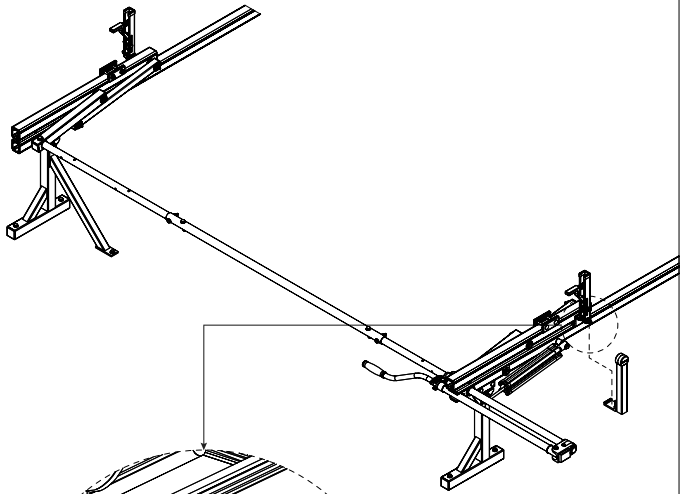

17.3

Place the L Post into the bottom groove of the Rear Crossbar, ensuring the L Post seats into the Crossbar's inside bottom groove as seen from the front of the Rear Crossbar.

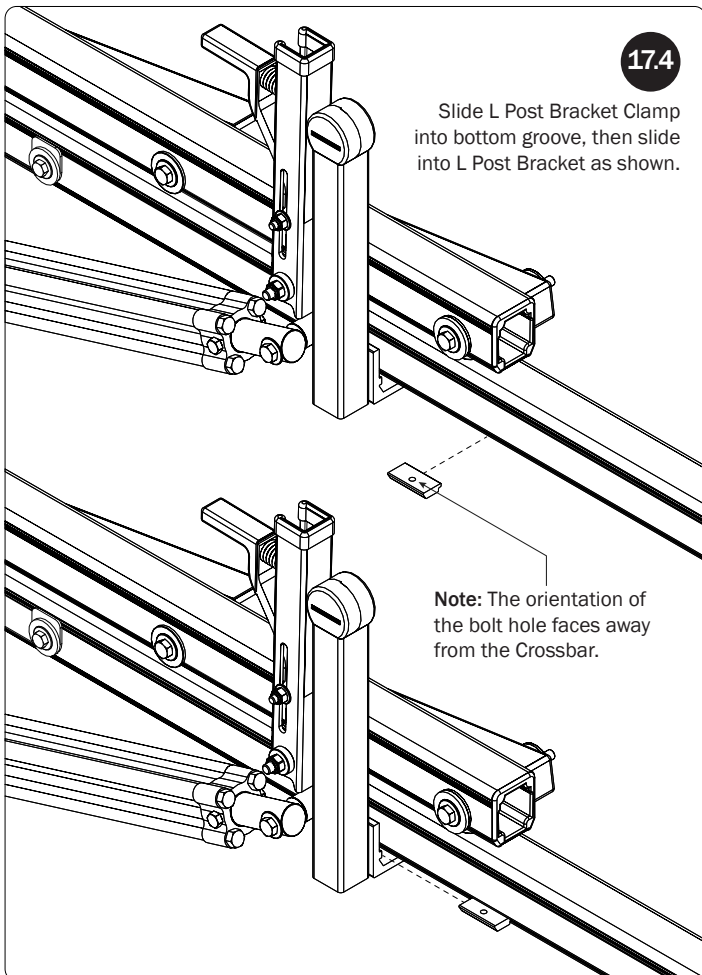

17.4

Slide L Post Bracket Clamp into bottom groove, then slide into L Post Bracket as shown.

**Note:** The orientation of the bolt hole faces away from the Crossbar.

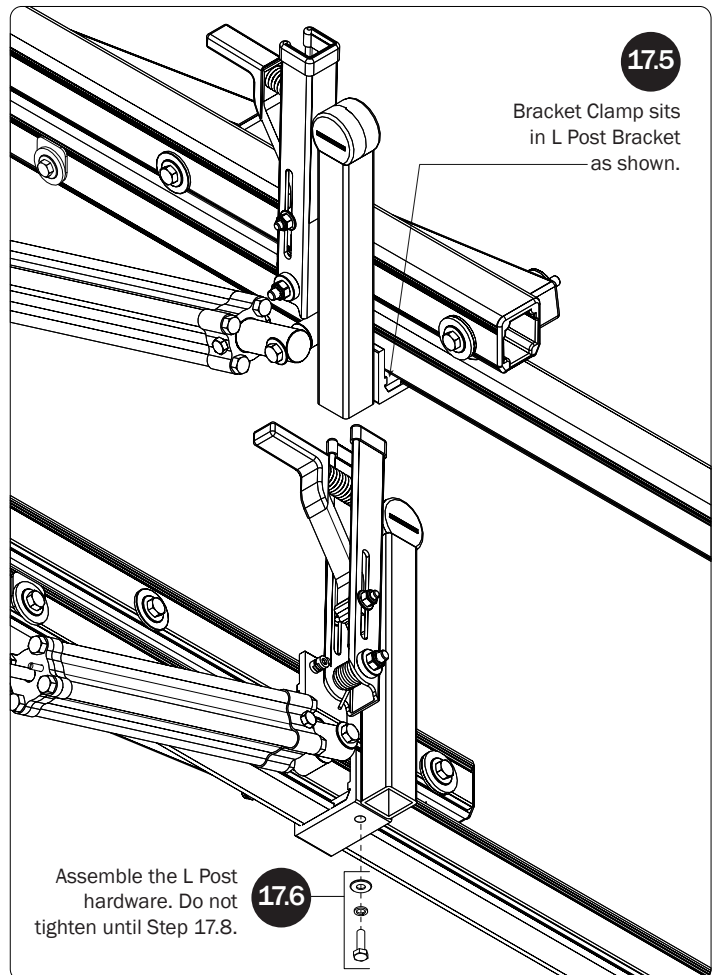

17.5

Bracket Clamp sits in L Post Bracket as shown.

Assemble the L Post hardware. Do not tighten until Step 17.8.

17.6

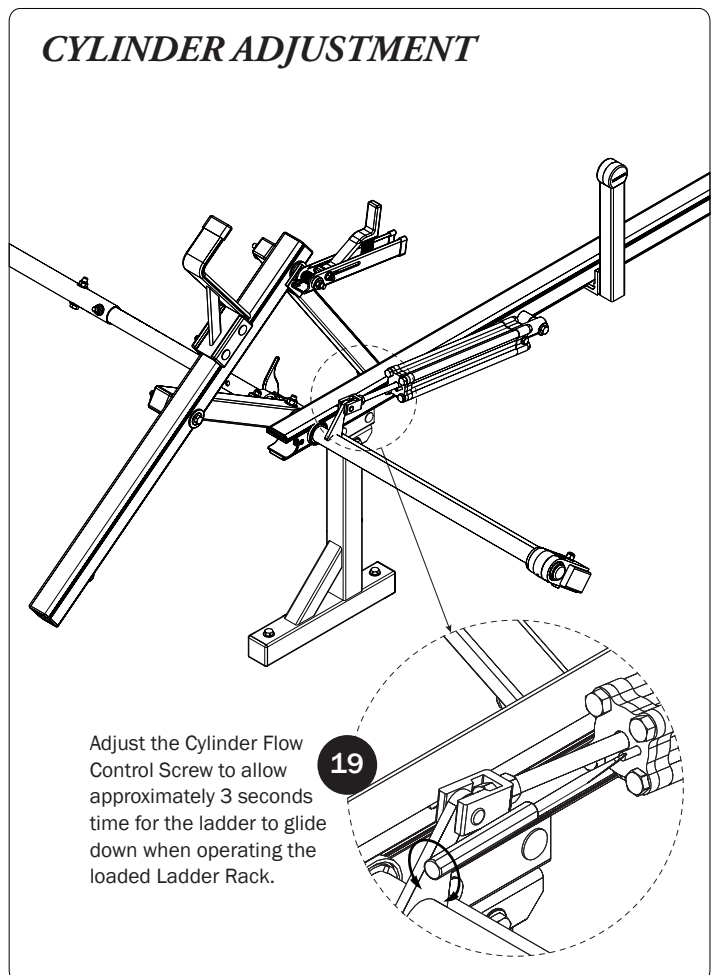
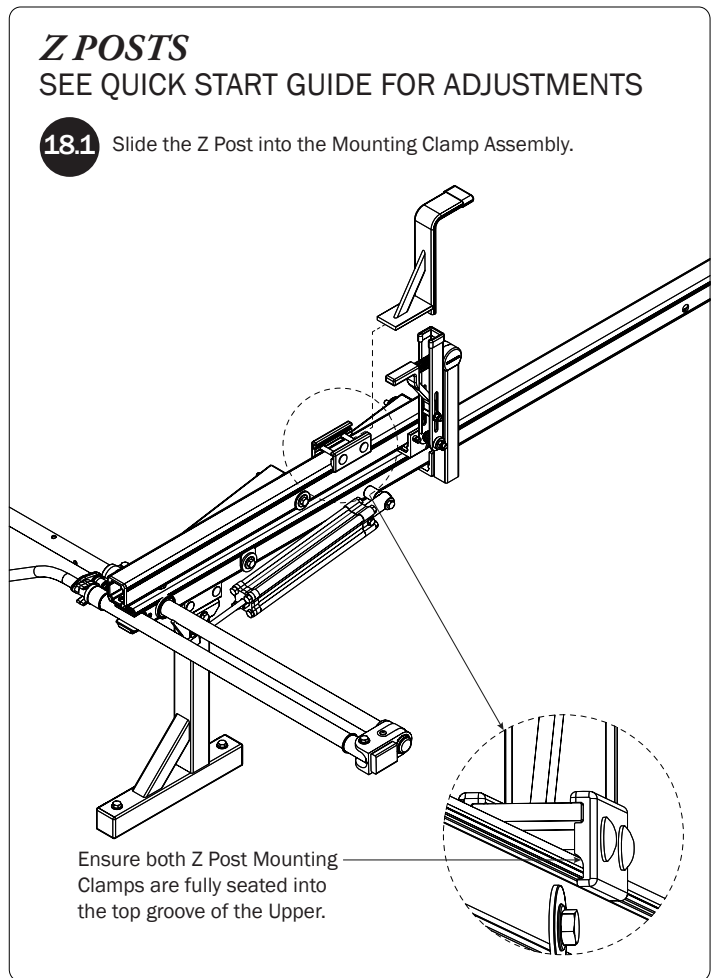
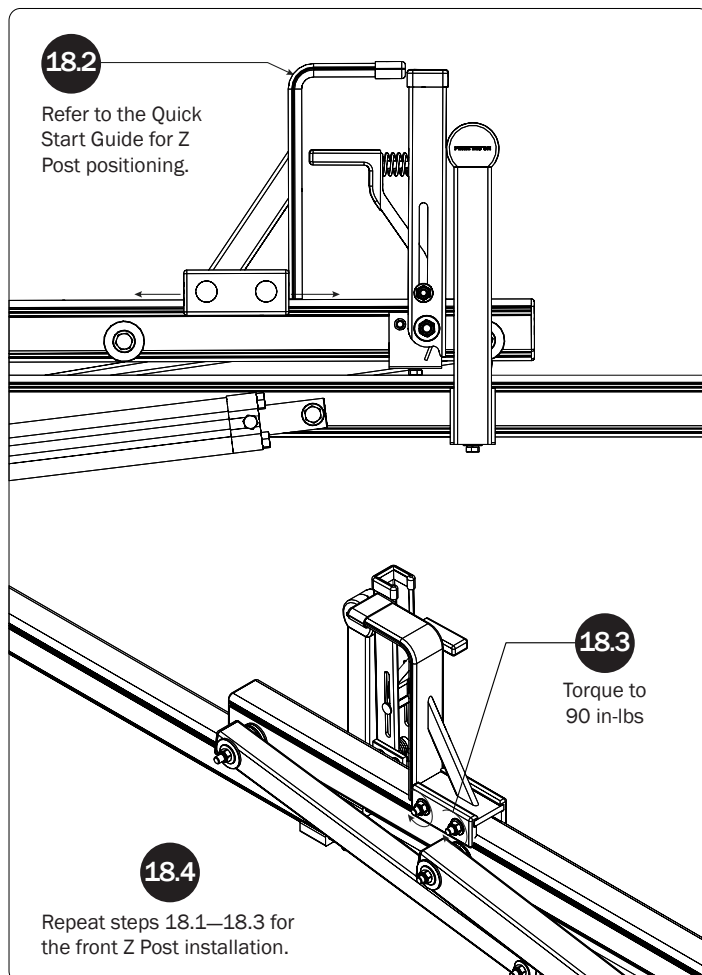
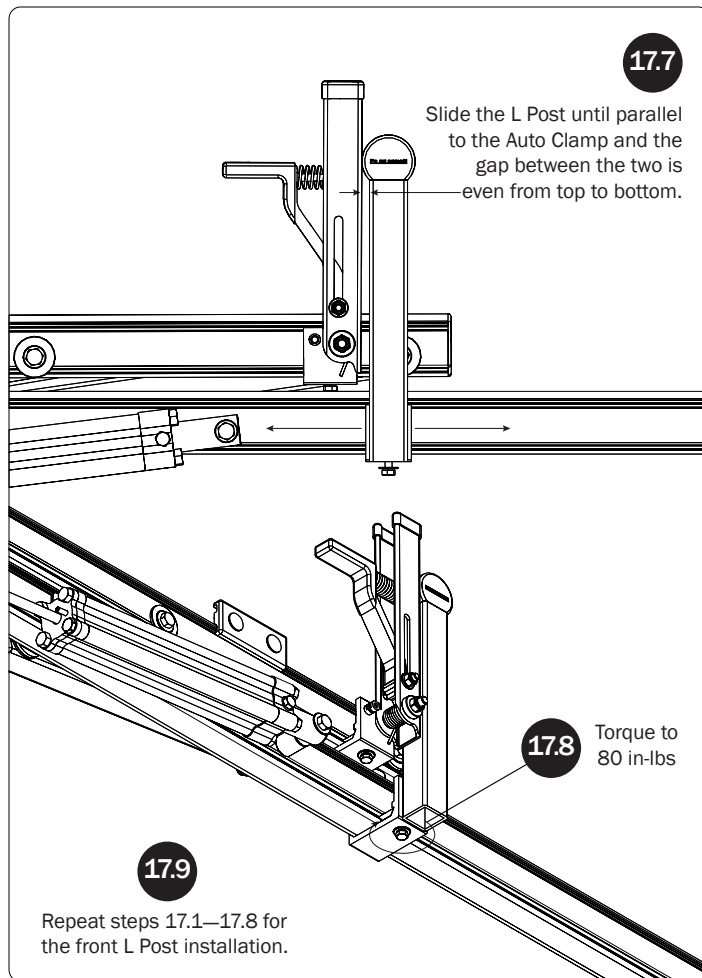

Page Intentionally Left Blank

