

PRIME DESIGN™

A Safe Fleet Brand

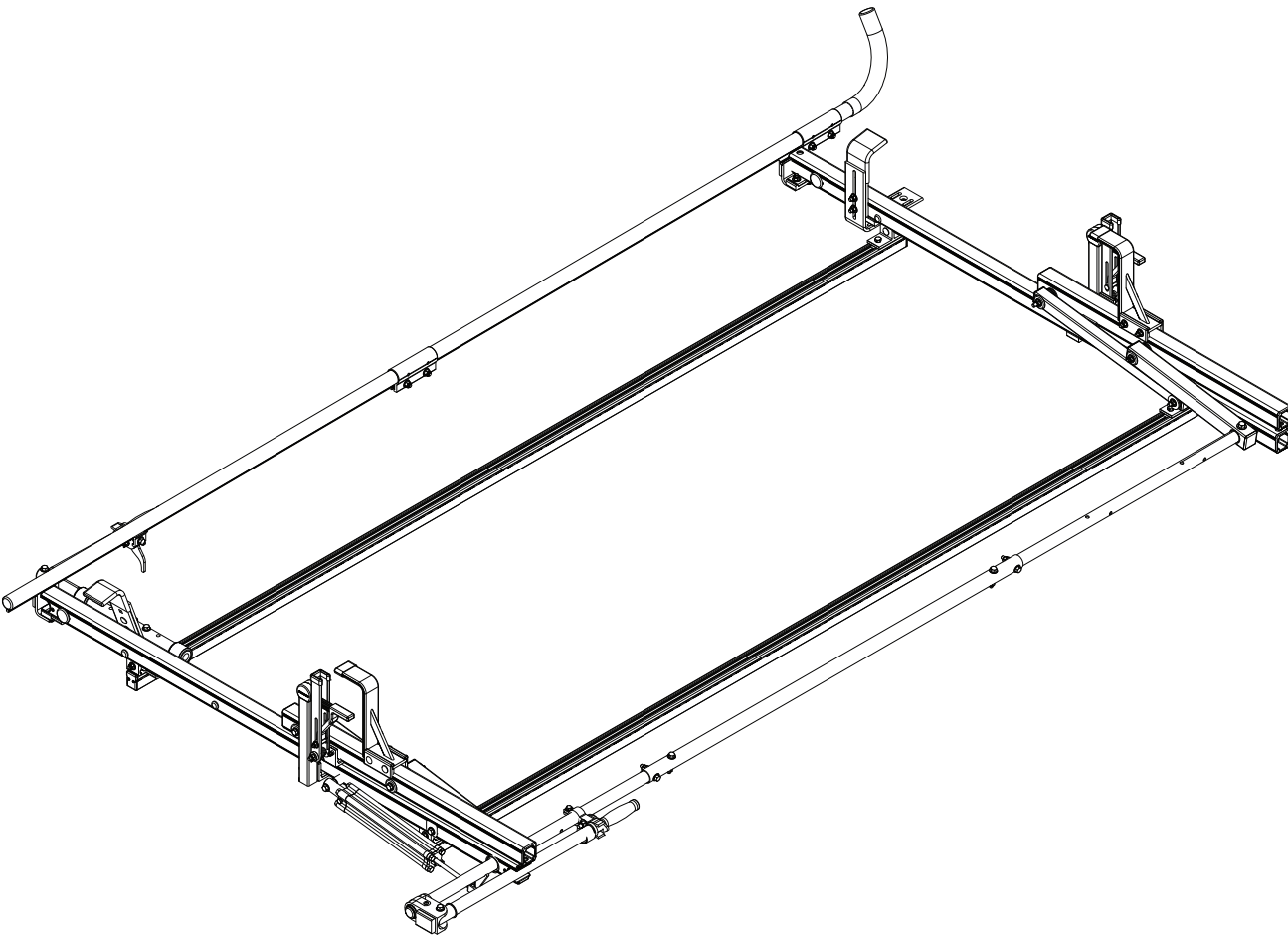

PCR 6001

PRIME DESIGN, A SAFE FLEET BRAND

Address: 580 Opperman Drive, Eagan, MN 55123 • Toll Free: 1.8.PRIME.RACK

Fax: 651-552-1799 • Email: info@primedesign.net • Website: www.primedesign.net

CONTENTS OVERVIEW

INSTALLER NOTE: Mounting Hardware or Brackets to attach this rack to a vehicle roof or cap are not included in this kit, and must be purchased separately.

To purchase Mounting Hardware or Brackets, please contact Prime Design Sales & Support.

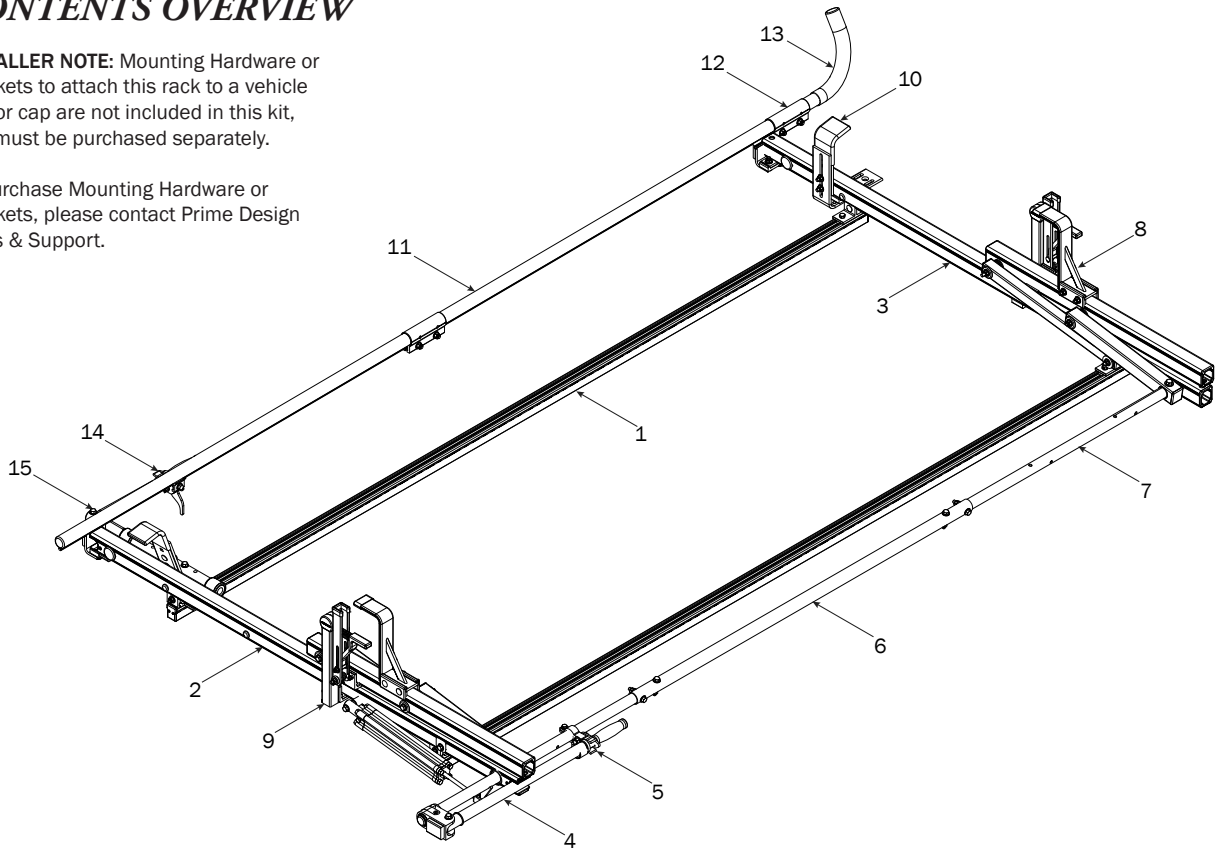

1—FBM-0002 (Qty 1)
Channels with hardware



Channels (2X)



Screws (8X)



End Caps (4X)



Brackets (4X)

2—Rear Crossbar Assembly (Qty 1)

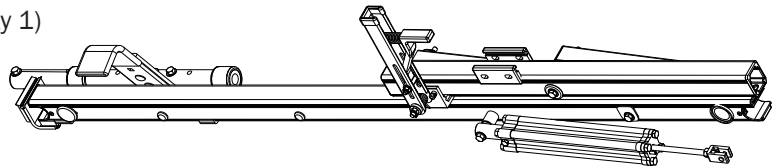

3—Front Crossbar Assembly (Qty 1)

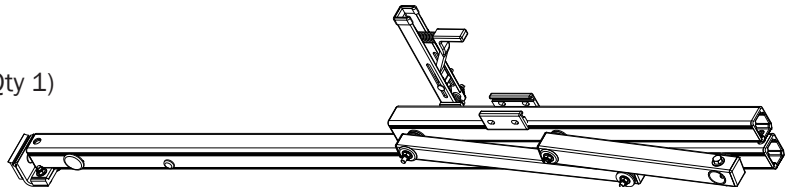

4—Rear Drive Shaft (Qty 1)
Right Hand, 34.00"

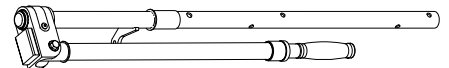

5—Handle Latch Assembly (Qty 1)



6—Connecting Bar (Qty 1)
48.00"

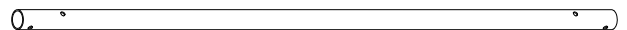

7—Front Drive Shaft (Qty 1)
B Version, 35.75"

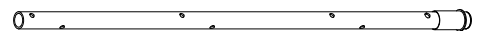

8—Z Post (Qty 2)
Adjustable, 7.25"

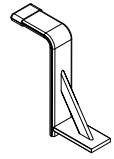

9—L Post..... (Qty 2)
Roller Cap, 9.25"

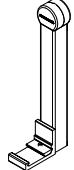

10—Front Hook Assembly (Qty 1)

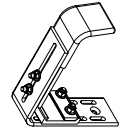

11—Clamp Down Tube (Qty 1)
80.00"

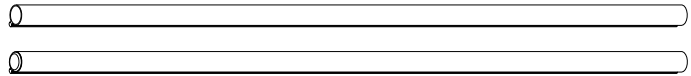

12—Quick Clamp Tube Splice Assembly..... (Qty 1)
5.00"



13—Removeable Horn with Cap..... (Qty 1)
15.00"

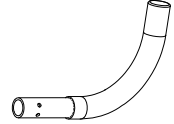

14—Clamp Down Handle Latch Assembly..... (Qty 1)



15—Clamp Down Handle Assembly (Qty 1)

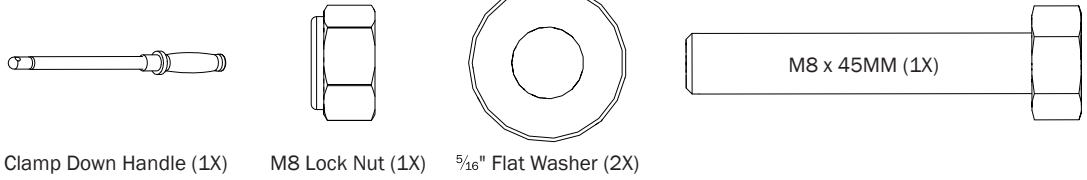

HKT-8162-Rotation Hardware Kit

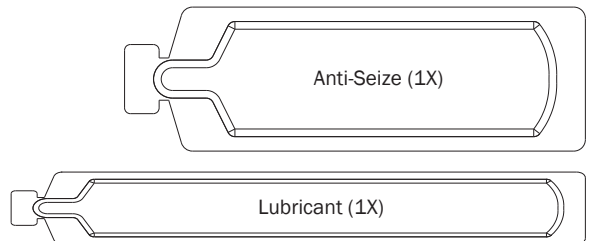
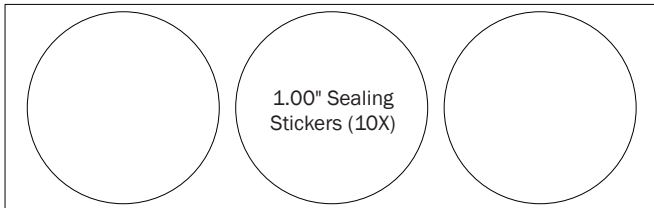
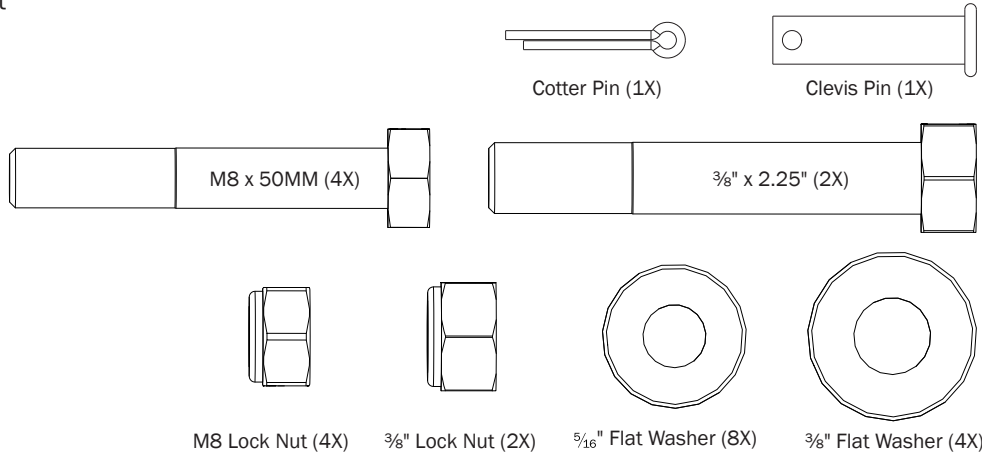

FBM-0002 FLUSH CHANNELS TO PRE-INSTALLED MOUNTING BRACKETS

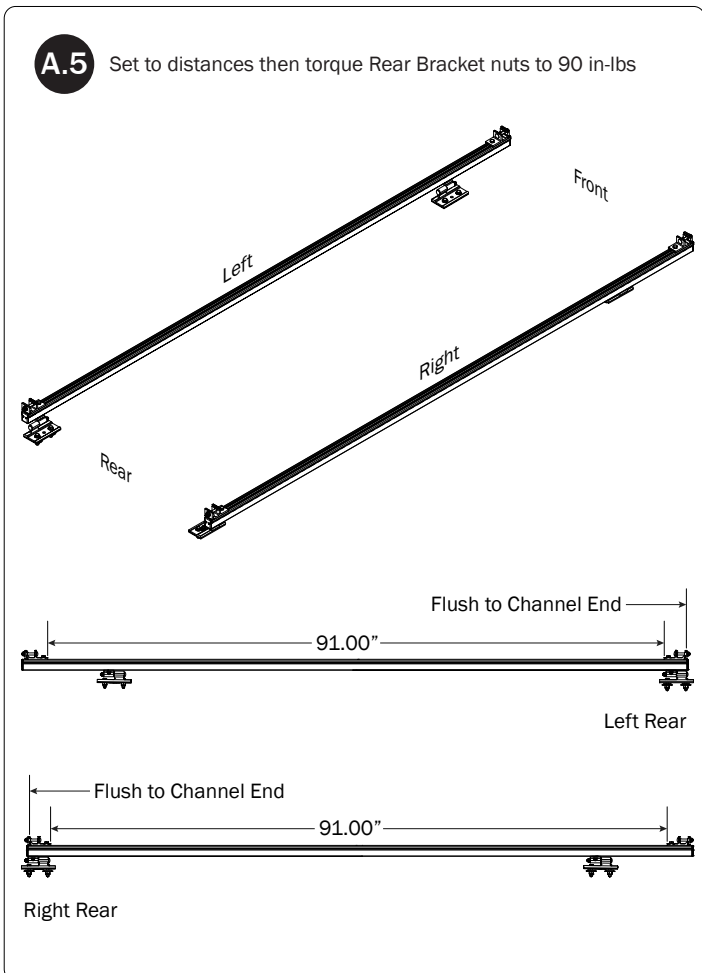
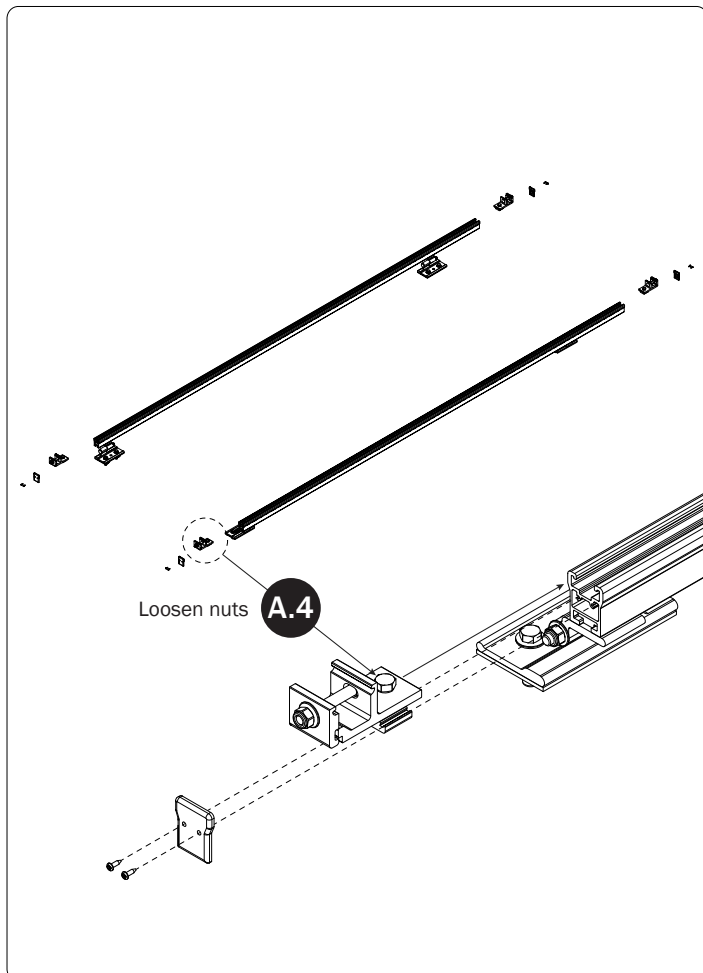
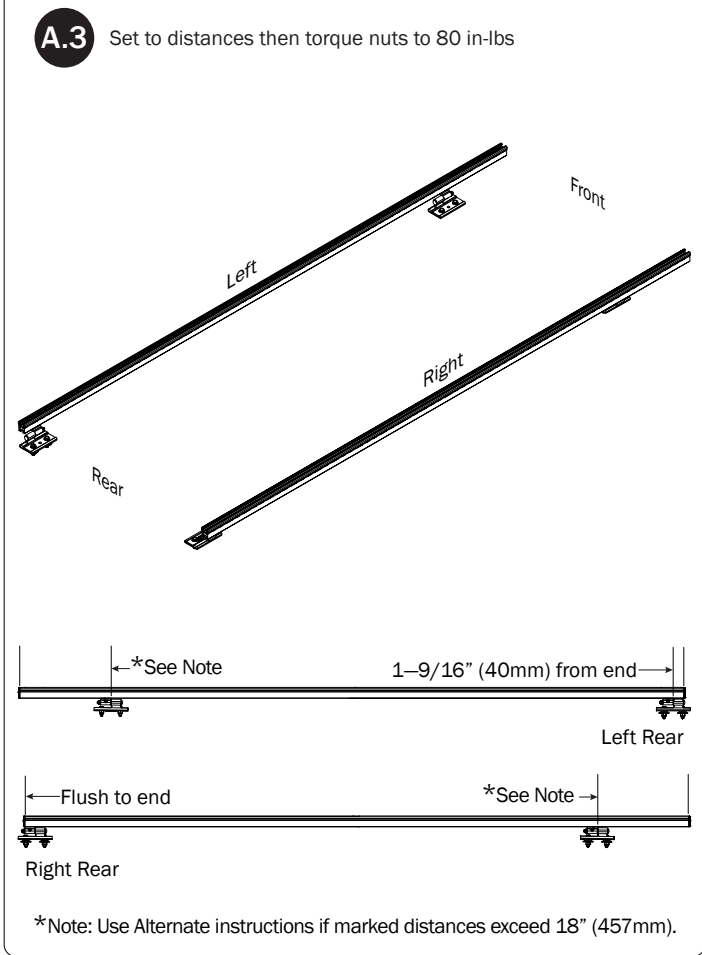
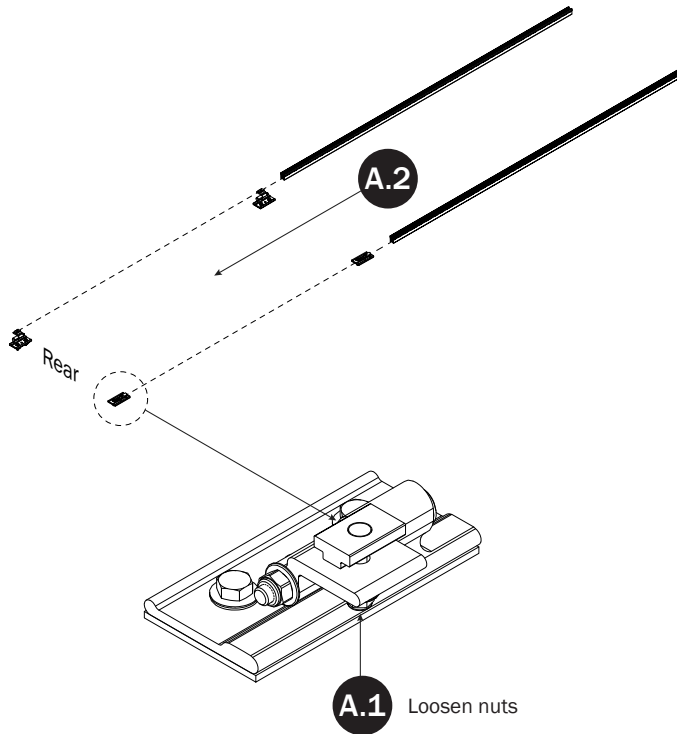

FBM-0002 ALTERNATE
CHANNELS TO PRE-INSTALLED
MOUNTING BRACKETS

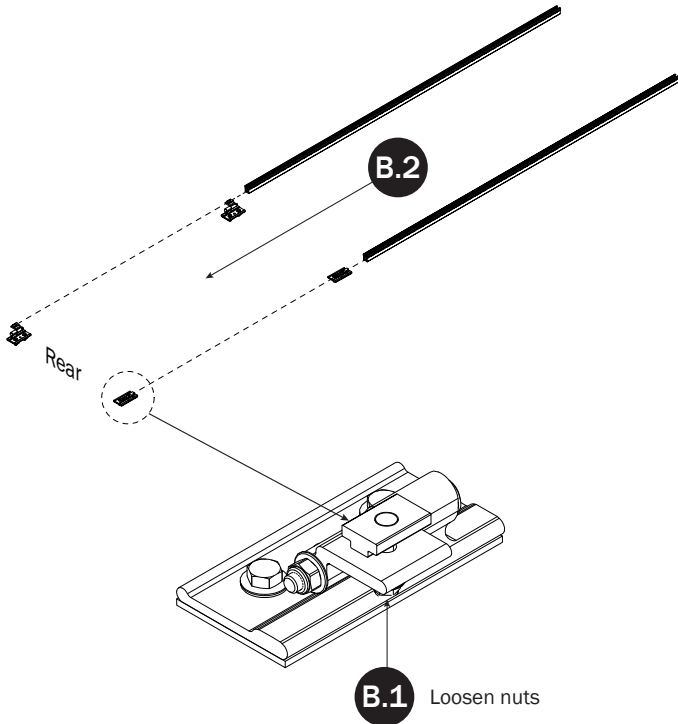

B.3 Set to distances then torque nuts to 80 in-lbs

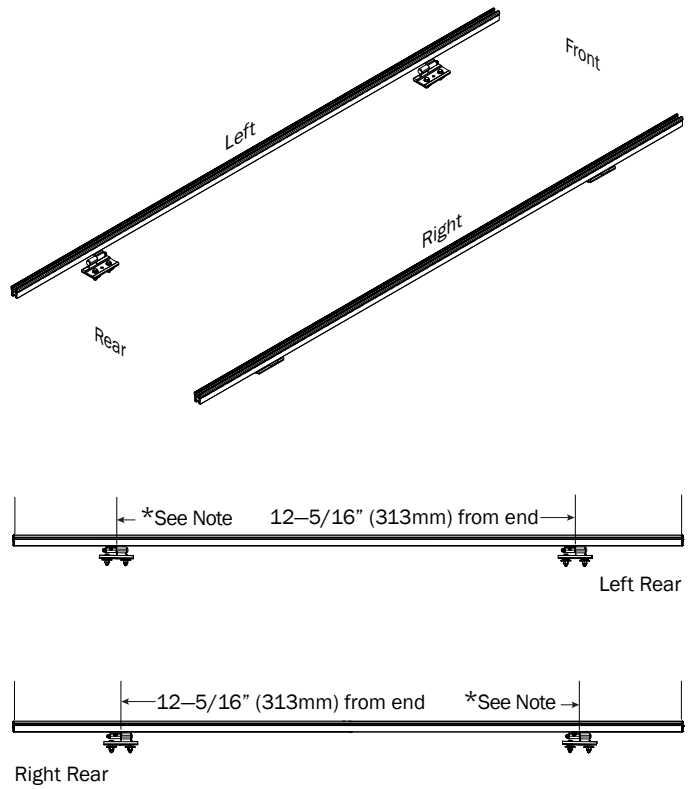

*Note: Move Channels rearward if marked front distance exceeds 18" (457mm).

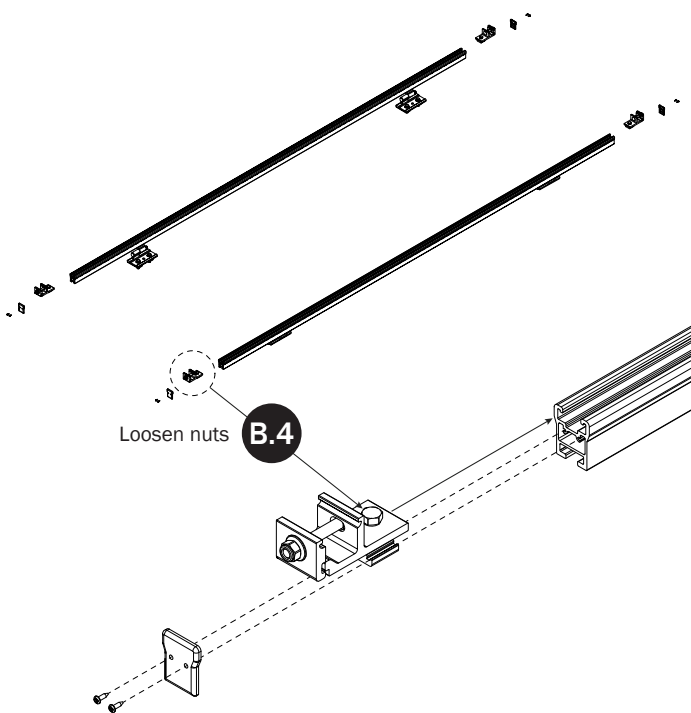

B.5 Set to distances then torque Rear Bracket nuts to 90 in-lbs

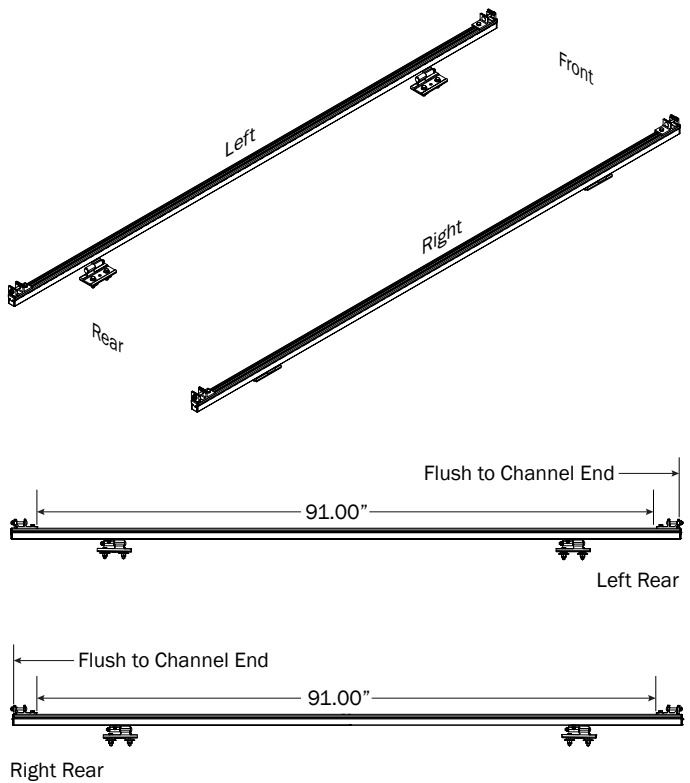

**RIGHT ROTATION
ASSEMBLY SEQUENCE**

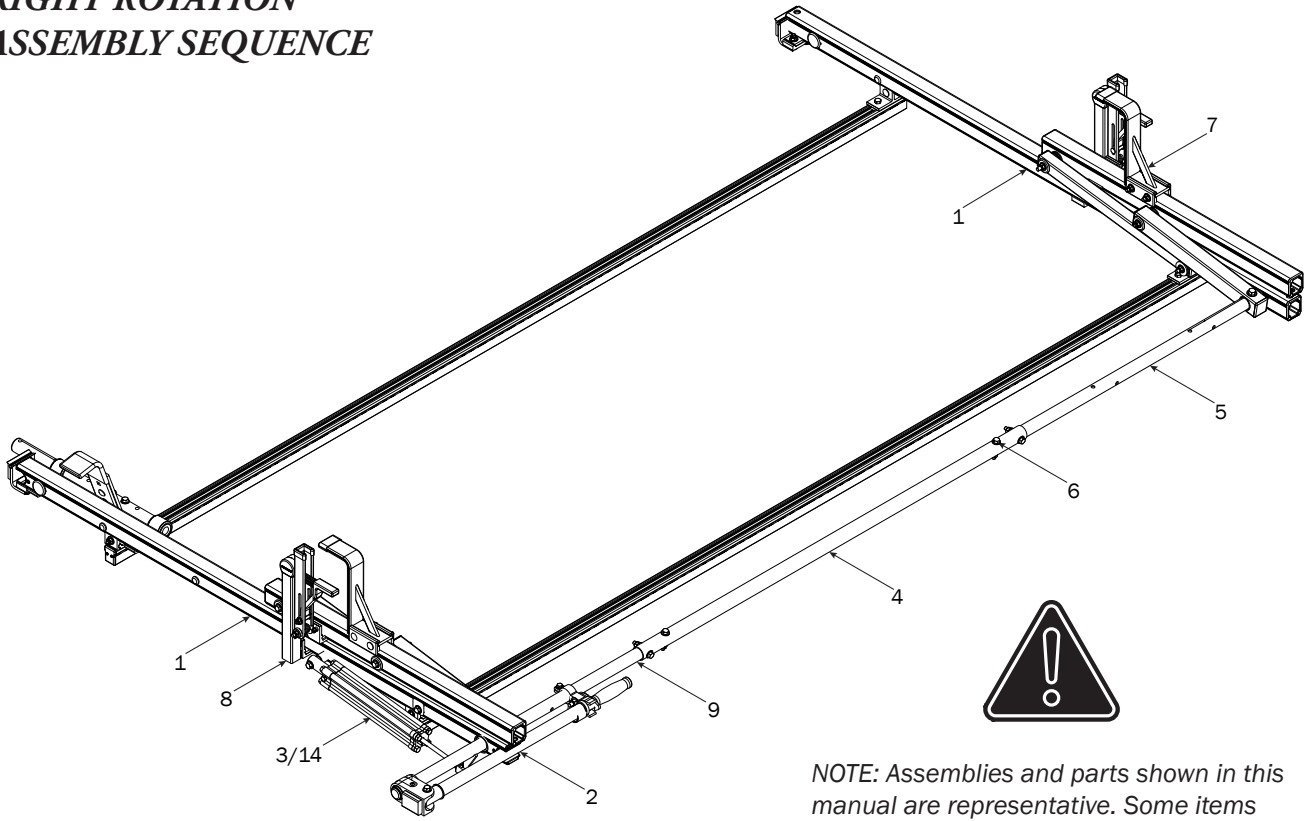

NOTE: Assemblies and parts shown in this manual are representative. Some items may appear different from actual parts, assemblies, or components received.

CROSSBARS

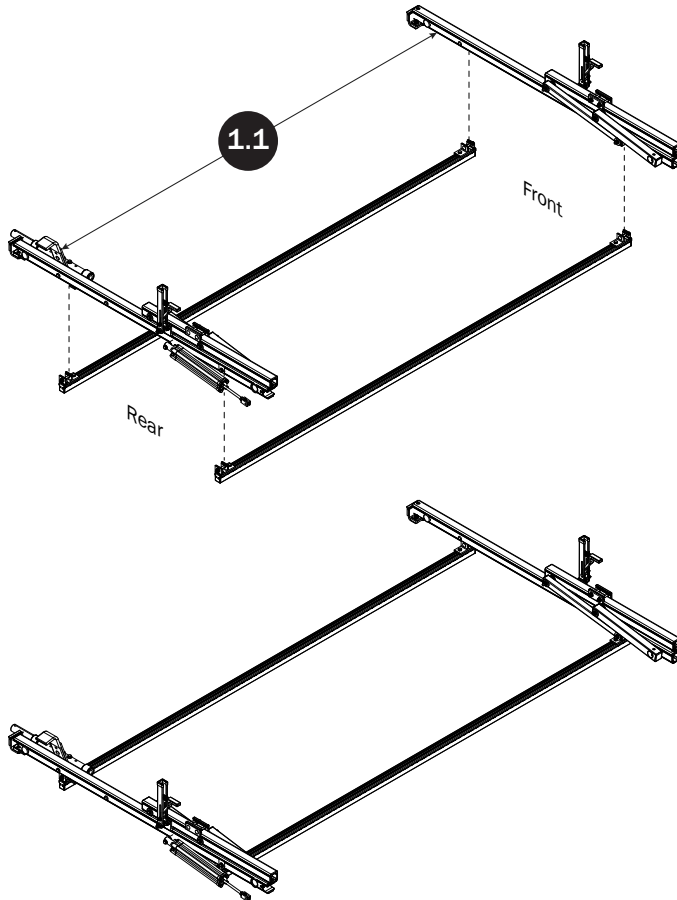

CROSSBAR ADJUSTMENT

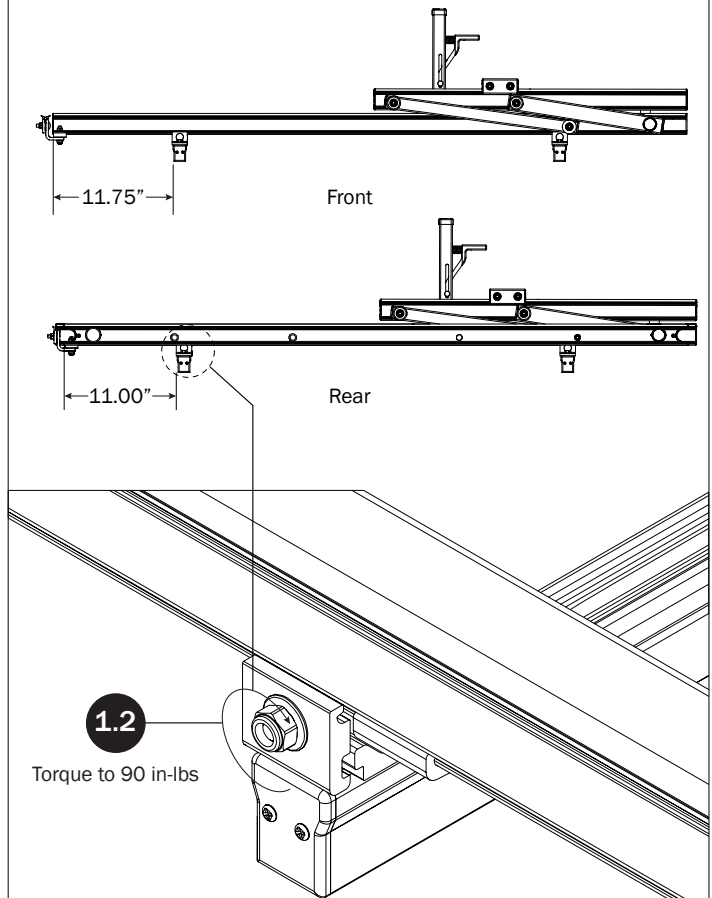

REAR DRIVE SHAFT

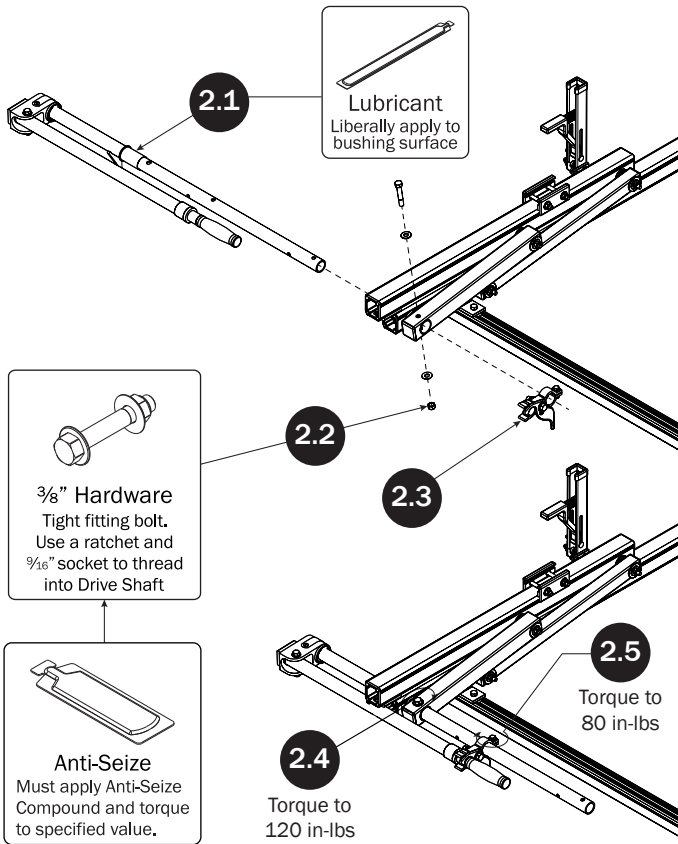

CYLINDER HARDWARE

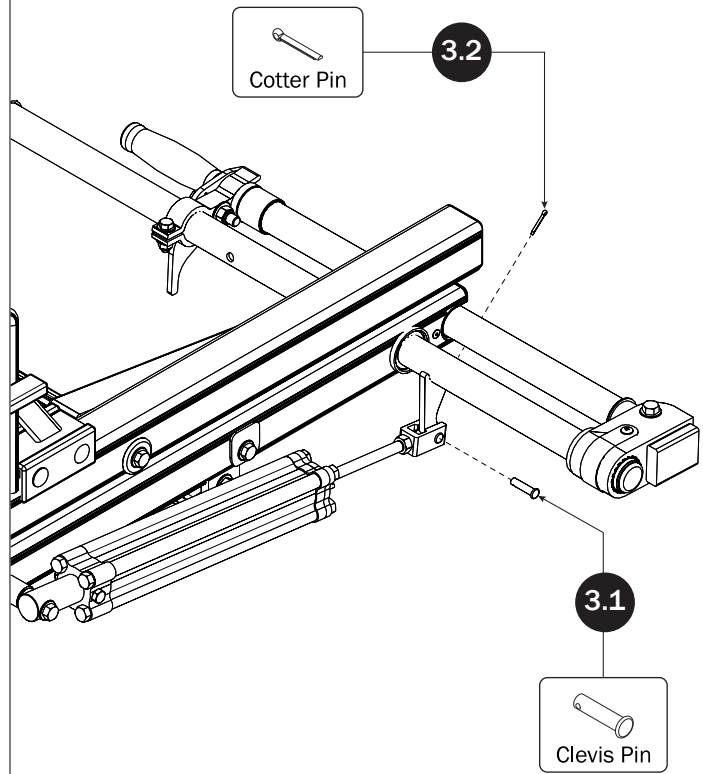

CONNECTING BAR

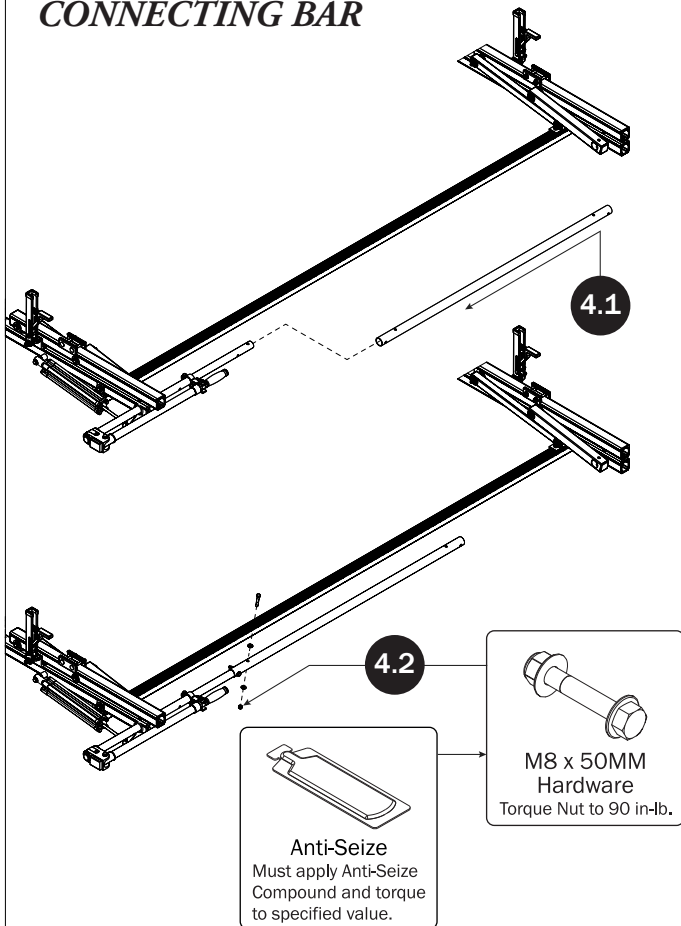

FRONT DRIVE SHAFT

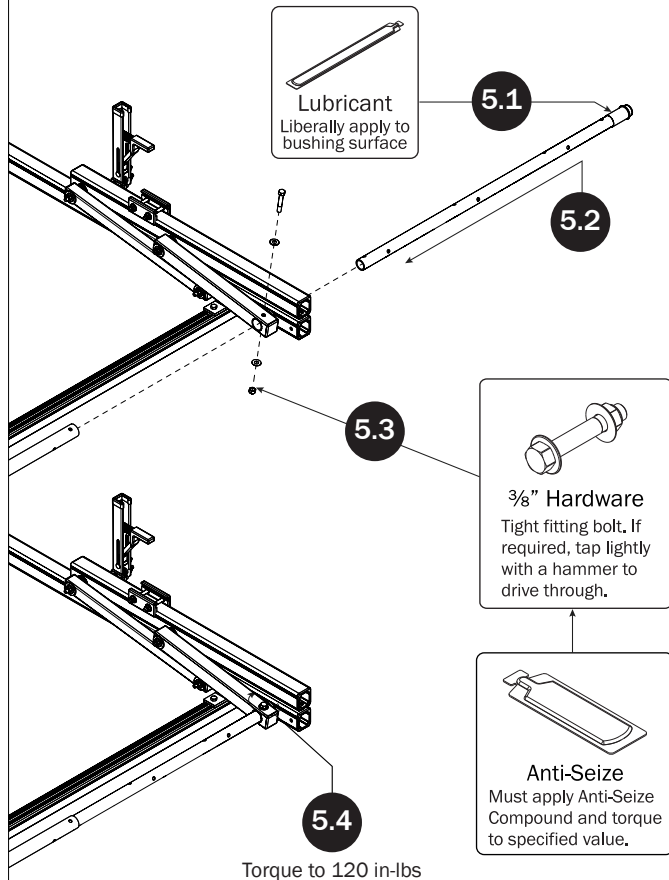

CONNECTING BAR FASTENERS

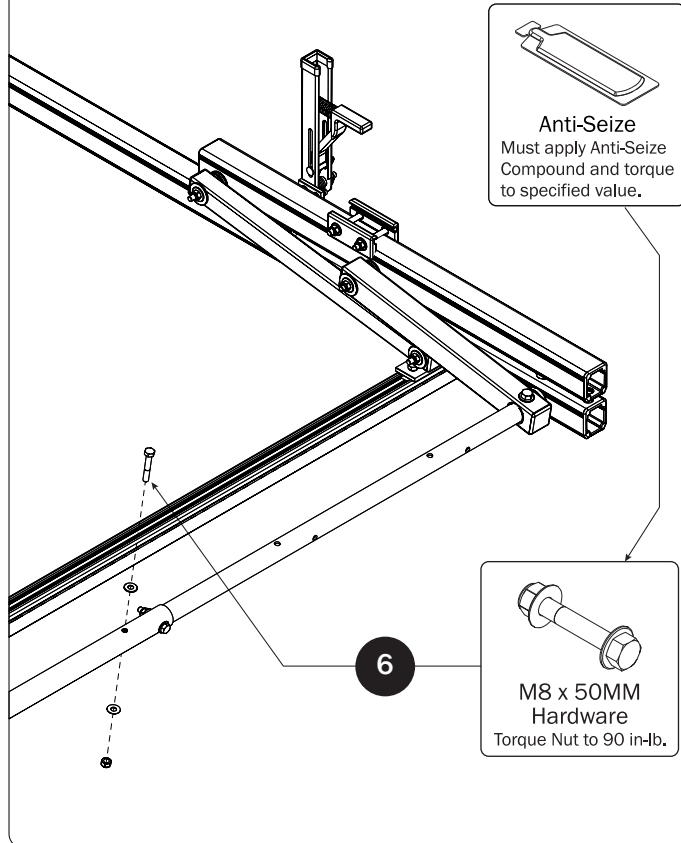

Z POSTS

SEE QUICK START GUIDE FOR ADJUSTMENTS

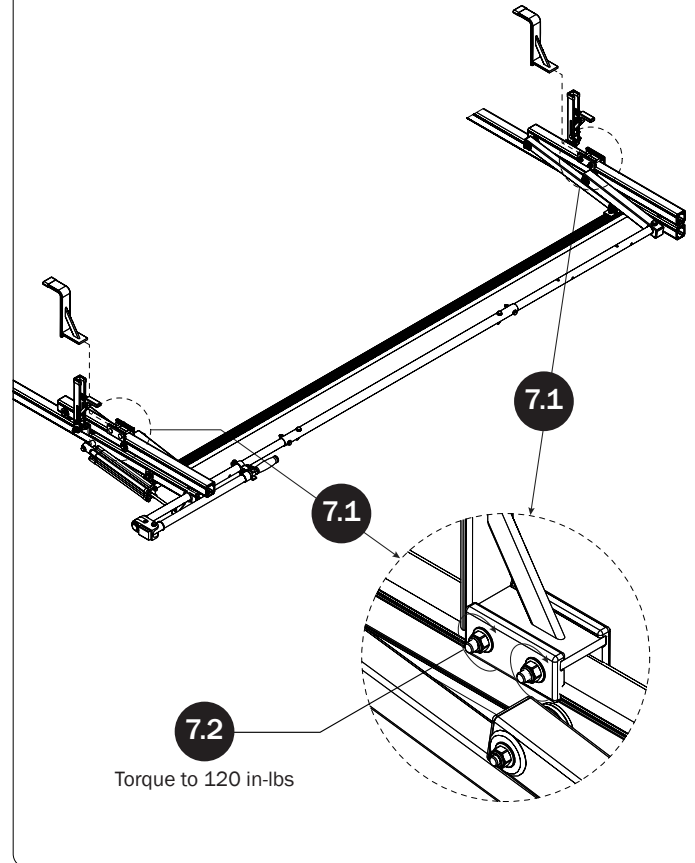

L POSTS

SEE QUICK START GUIDE FOR ADJUSTMENTS

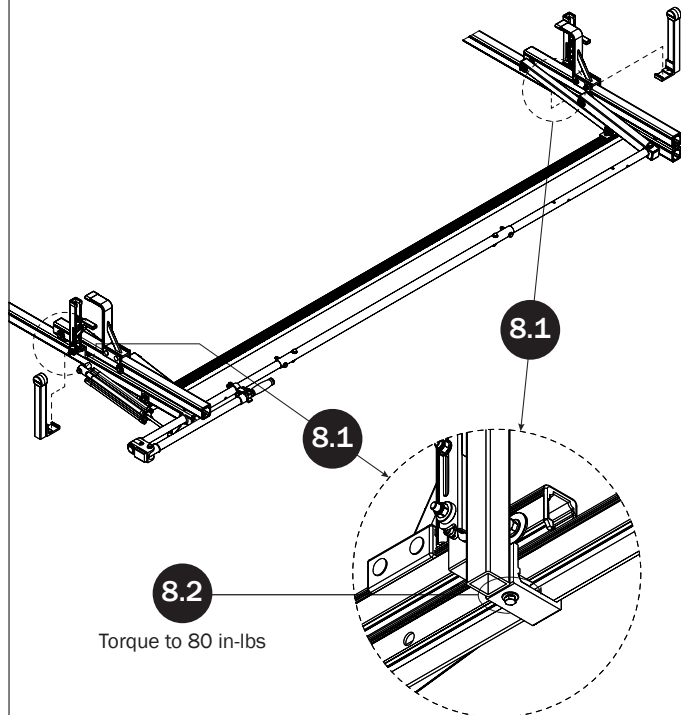

DRIVE SHAFT SEALING

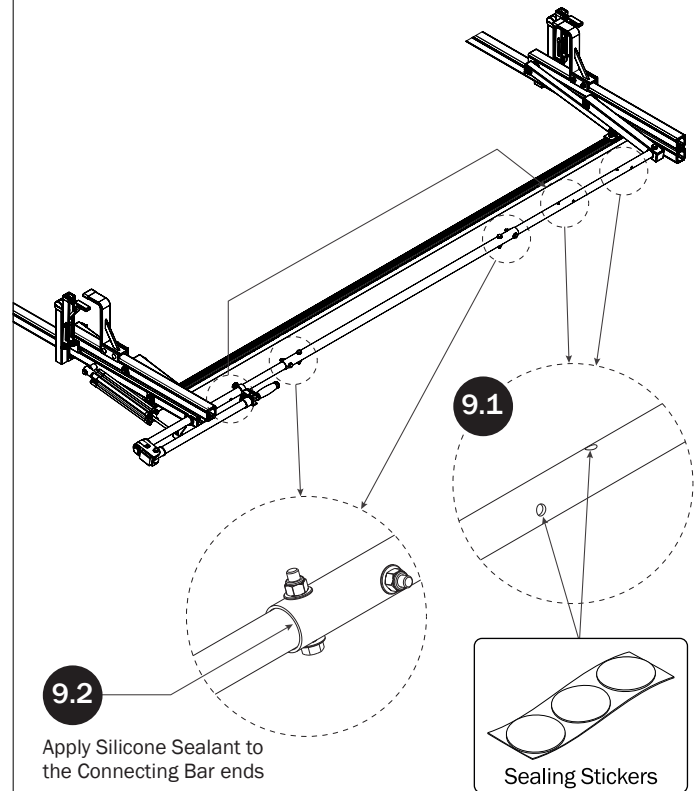

**LEFT CLAMP DOWN
ASSEMBLY SEQUENCE**

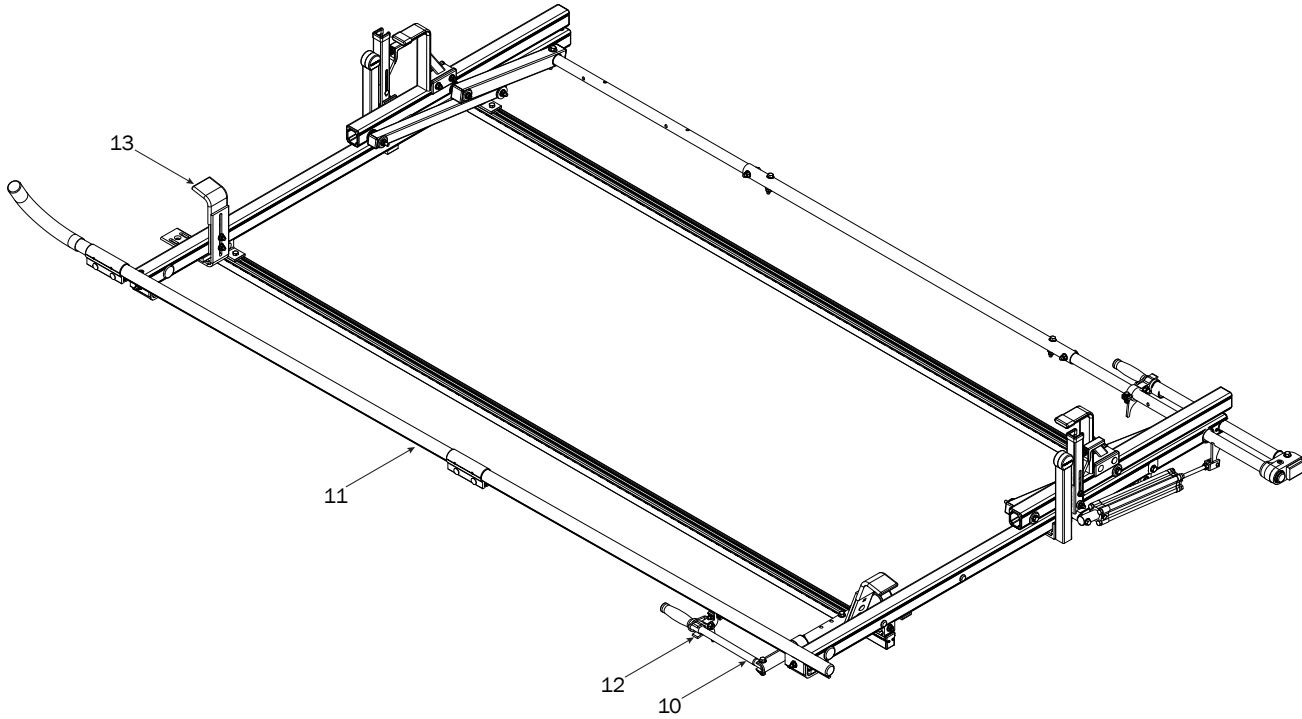

CLAMP DOWN HANDLE

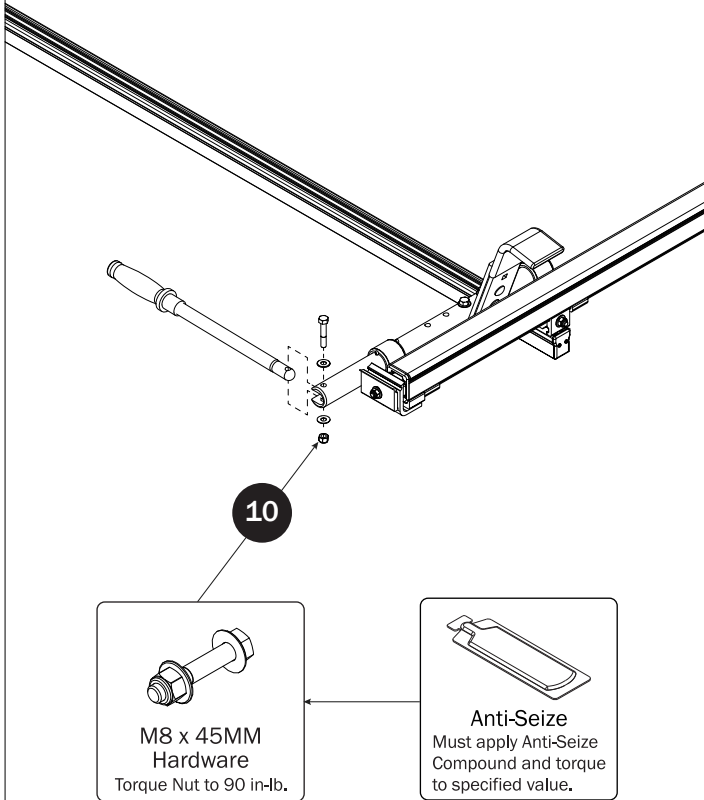

CLAMP DOWN TUBE

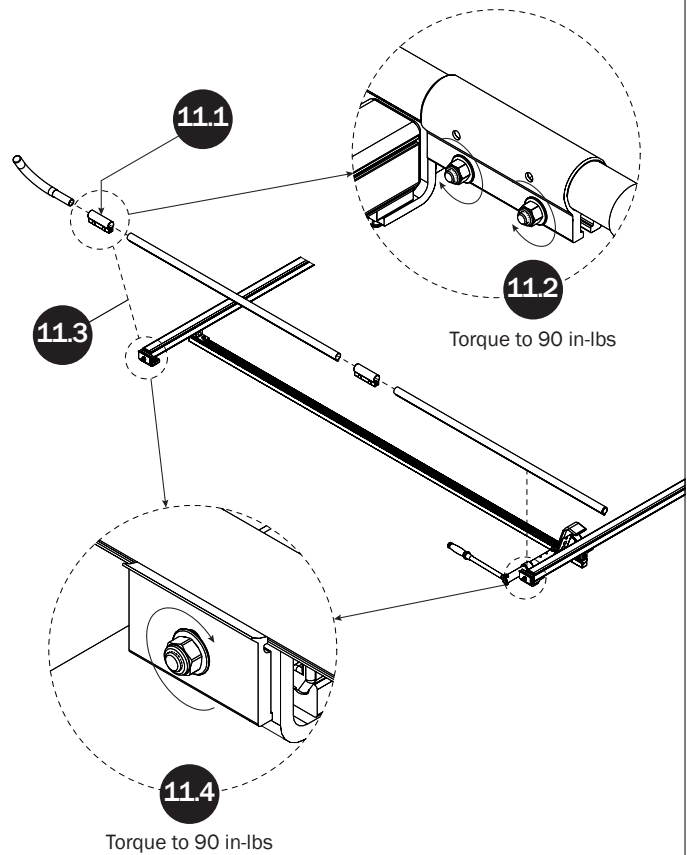

HANDLE LATCH

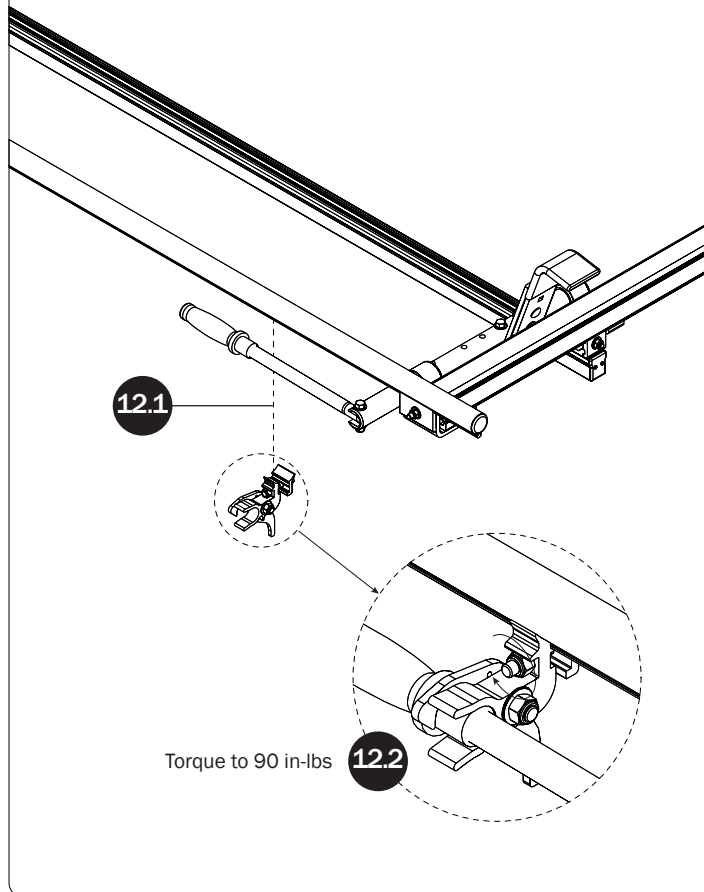

FRONT LADDER HOOK
SEE QUICK START GUIDE FOR ADJUSTMENTS

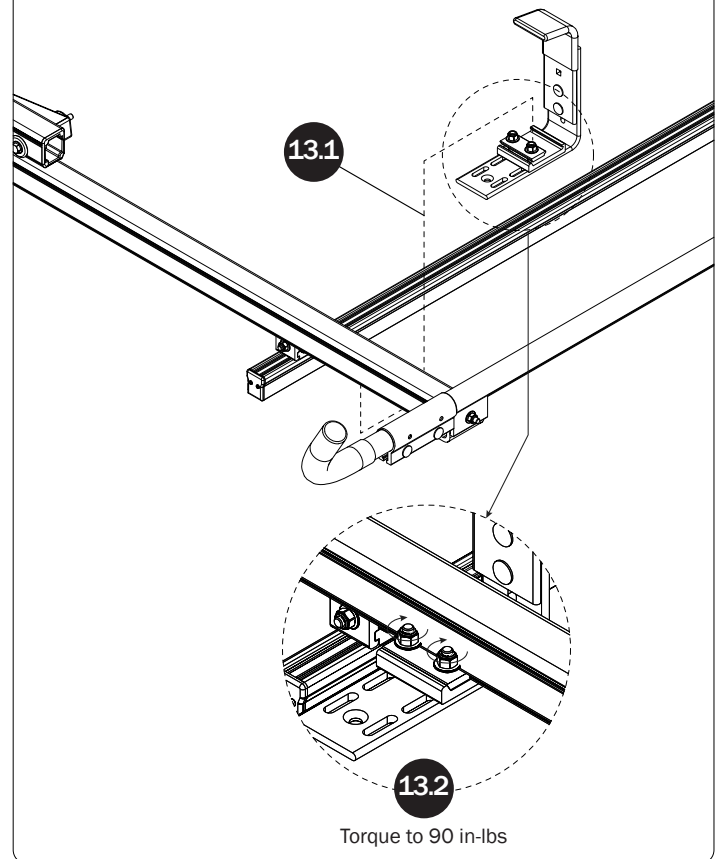

CYLINDER ADJUSTMENT

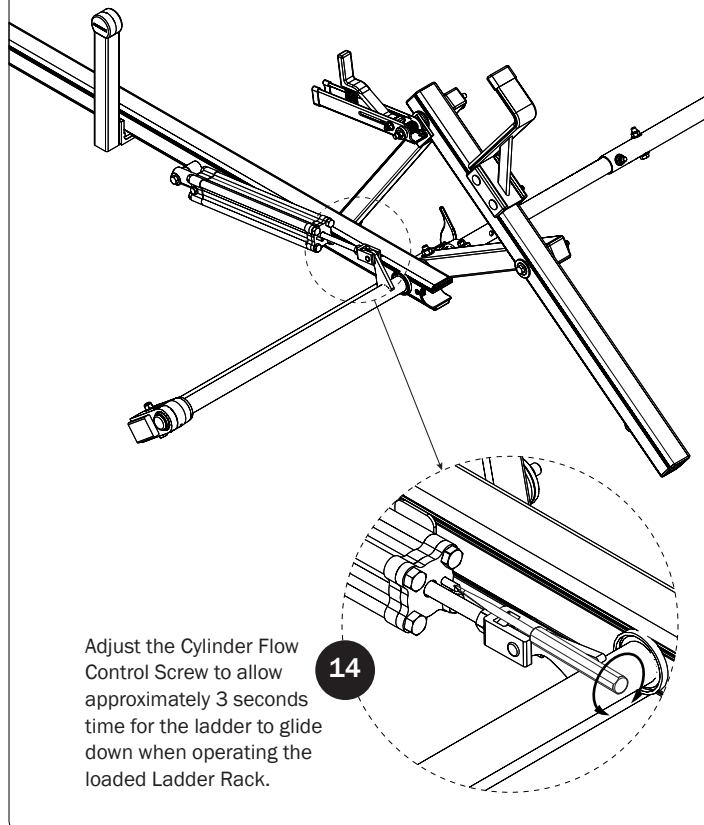

Page Intentionally Left Blank

