

# PRIME DESIGN™

A Safe Fleet Brand

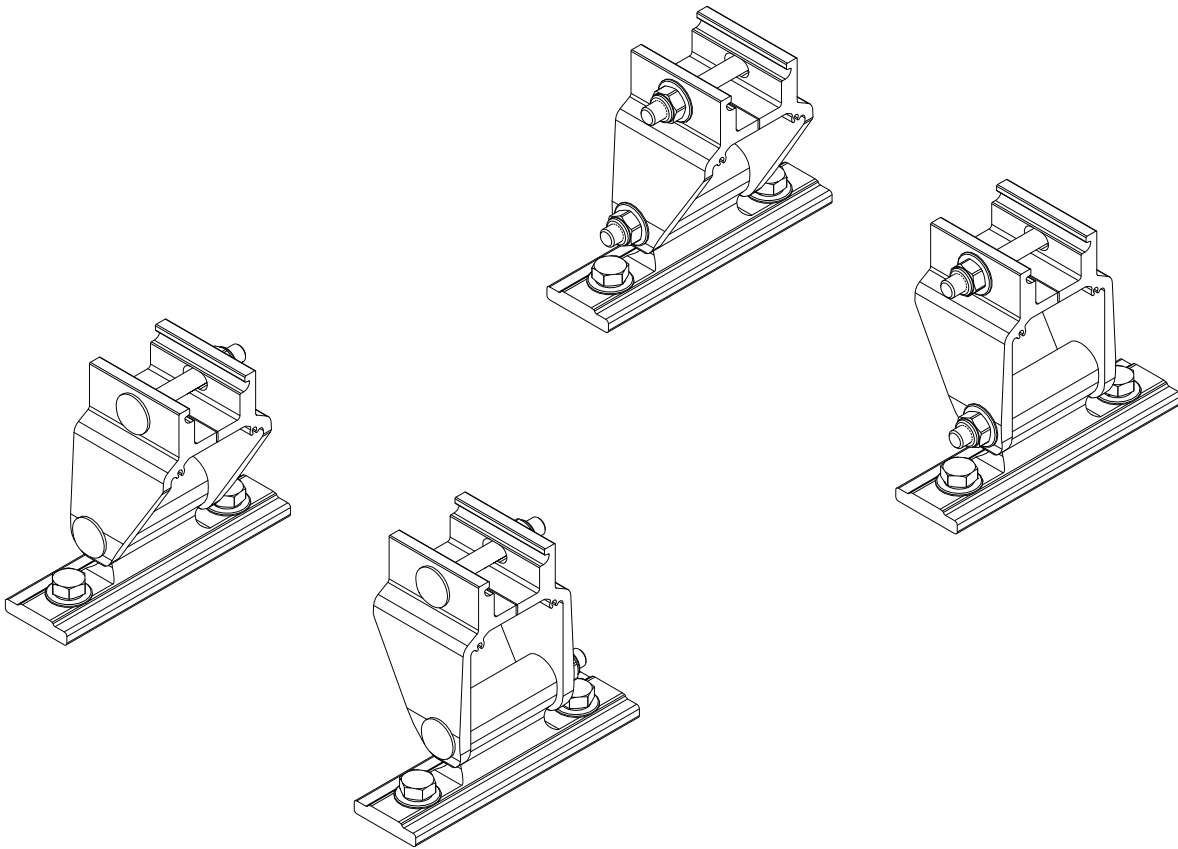

**MPK 8008**

PRIME DESIGN, A SAFE FLEET BRAND

Address: 580 Opperman Drive, Eagan, MN 55123 • Toll Free: 1.8.PRIME.RACK

Fax: 651-552-1799 • Email: [info@primedesign.net](mailto:info@primedesign.net) • Website: [www.primedesign.net](http://www.primedesign.net)

**MPK-8008**

Mounting Brackets shown in position on a generic cap with customer-supplied Channels and Strip Nuts for illustrative purposes only.

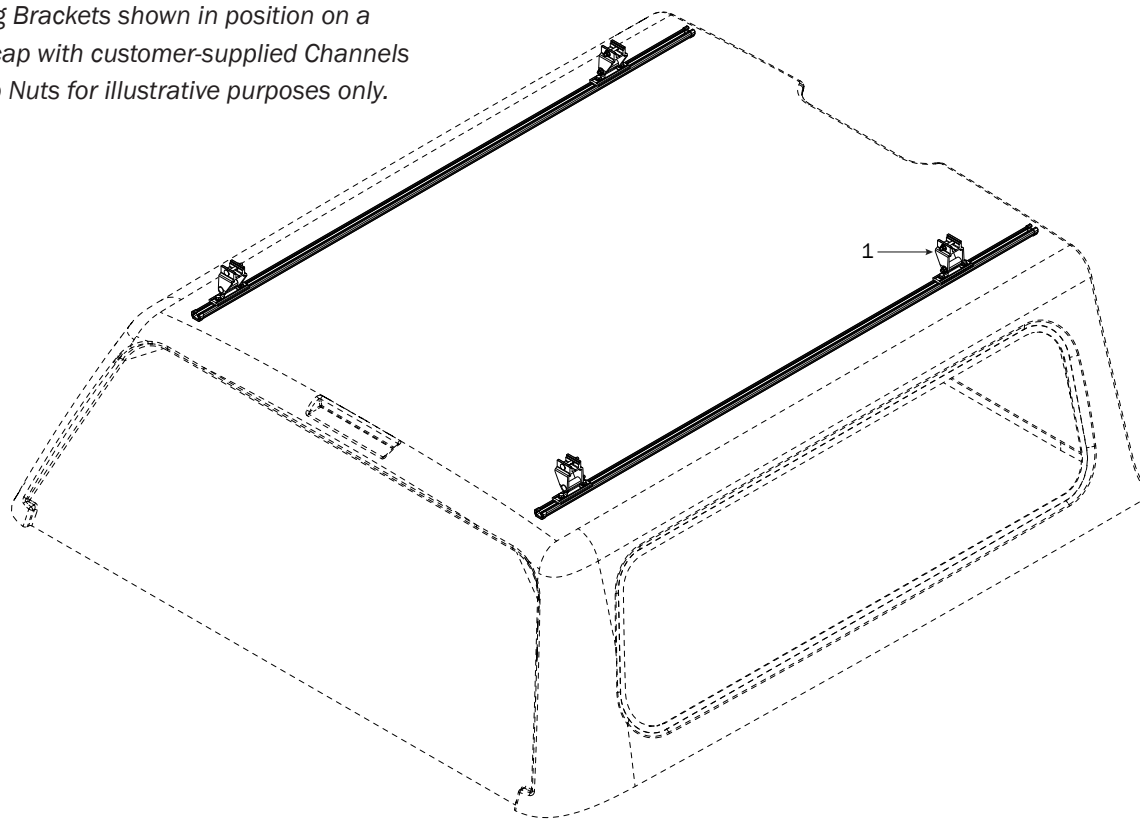

1—Mounting Brackets ..... (Qty 4)

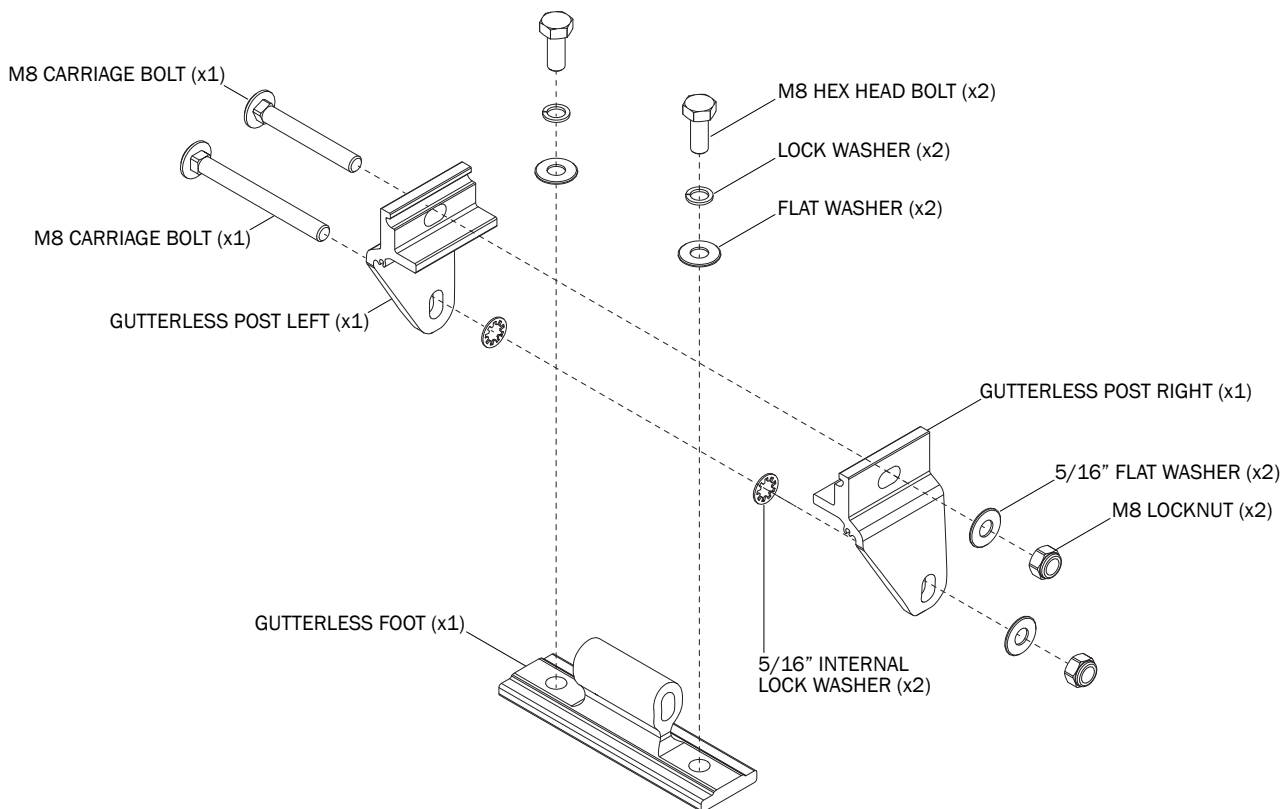

**MPK-8008**  
MOUNTING BRACKETS

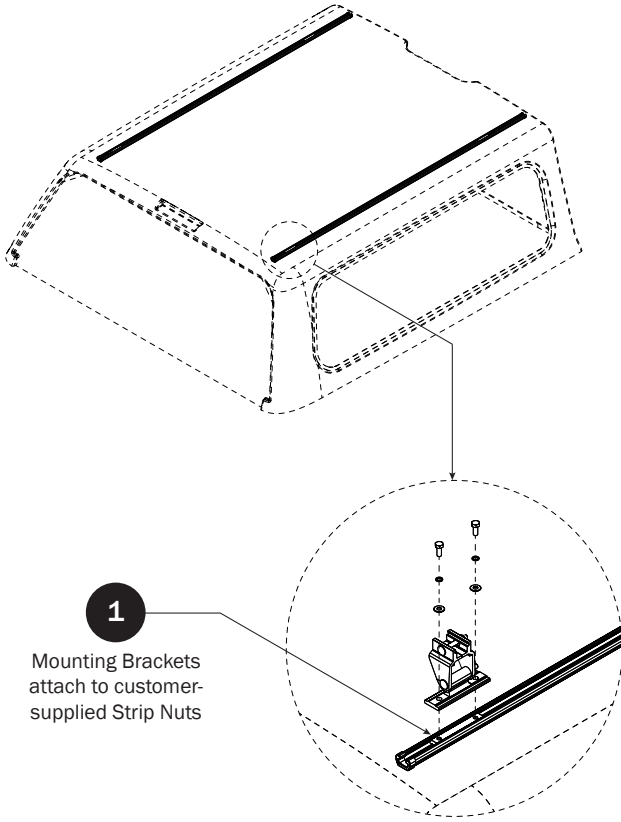

**1**

Mounting Brackets  
attach to customer-  
supplied Strip Nuts

**2** Set all mountings onto customer-supplied Channels as shown. Do not tighten until Step 4

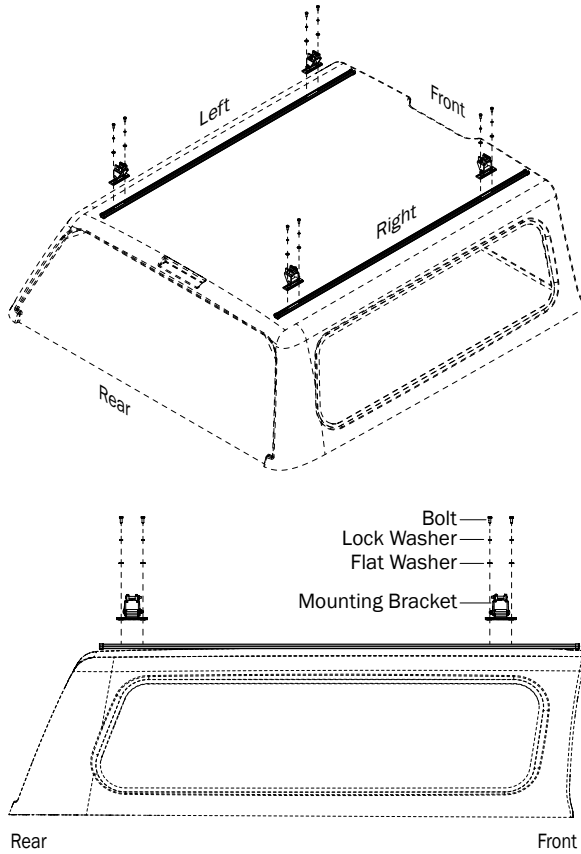

Rear

Front

**3** Set Crossbar Mounting distances according to specific Ladder Rack model requirements. Typical distances are between 4' to 8' in 1' increments.

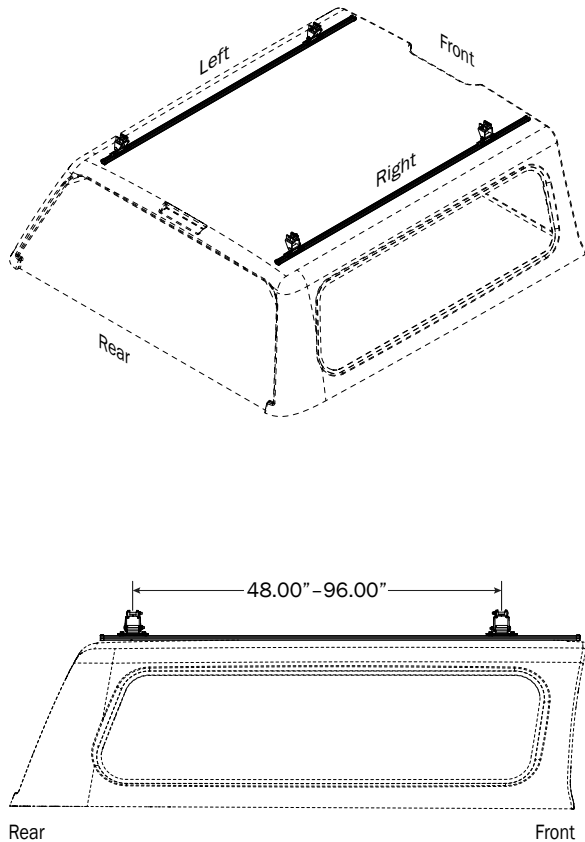

Rear

Front

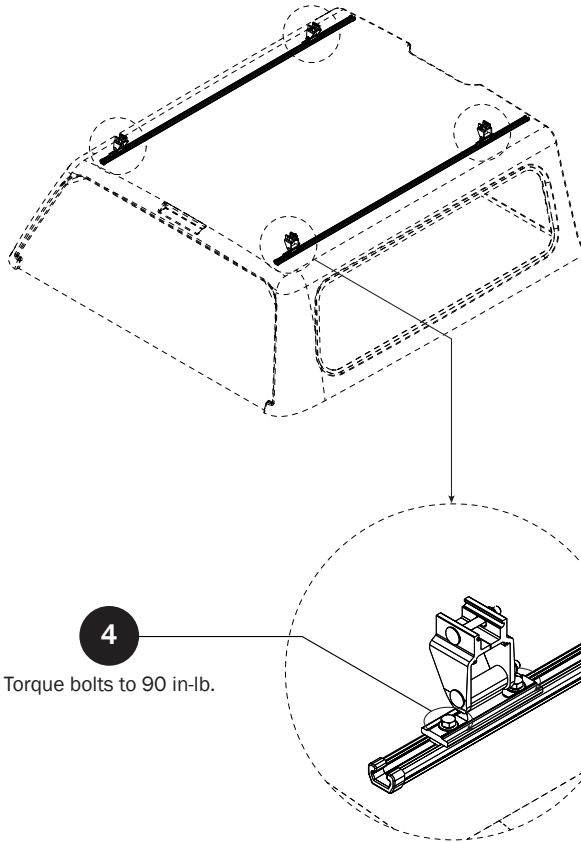

**4**

Torque bolts to 90 in-lb.

