

## HRR3-E-FT-HM

### ErgoRack, Ford Transit Mid/High Roof

Three Crossbars, Powder Coat Finish  
Rack Weight (empty): 173 lbs

\*Callouts in this Configuration Overview indicate full module assemblies only.

For details on individual parts, please refer to the linked Module Overviews below.

- A: ..... [FBM-1017-BLK Mounting System](#)
- B: ..... [CBA-3008 Hybrid Crossbar Assembly](#)
- C: ..... [CBR-0008 Mid Crossbar Kit](#)
- D: ..... [FEA-0019 Rotation Driveshaft Assembly](#)
- E: ..... [FEA-0020 Rotation Driveshaft Assembly](#)

[Modular Assembly Manuals](#)

### ErgoRack Van—Load specifications:

Check vehicle manufacturer recommendations for roof capacity weight limits.

CROSSBAR SPACING	STEP LADDER	EXT. LADDER
4 ft Spacing	6 – 8 ft.	16 – 20 ft.
5 ft Spacing	8 – 10 ft.	16 – 24 ft.
6 ft Spacing	8 – 12 ft. <sup>†</sup>	16 – 28 ft.
7 ft Spacing	10 – 12 ft. <sup>†</sup>	20 – 32 ft.
8 ft Spacing	10 – 12 ft. <sup>†</sup>	20 – 36 ft.

<sup>†</sup>Rotation Configurations: 12 ft. step ladders require an extended upper add-on component.

\*Example shown with 130" Wheelbase Configuration

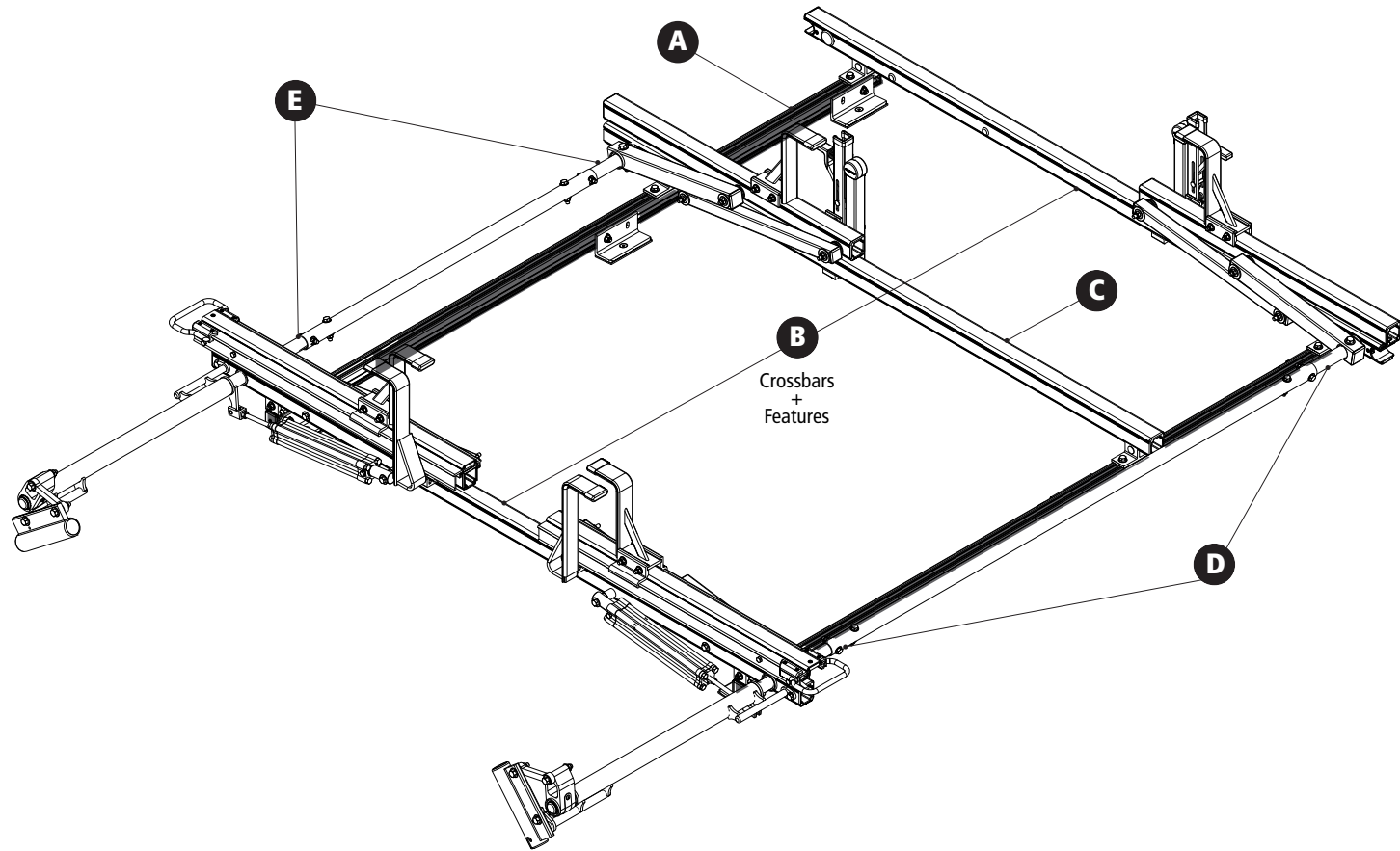

## HRR3-E-FT-HM

### ErgoRack, Ford Transit Mid Roof

Approximate dimensions as shown:

#### All Wheelbases

- A: Rack Width ..... 79"
- B: Rack Height ..... 16.50"
- C: Rear Crossbar Offset (Left)..... 8"
- D: Mount Bolt Spacing L/R..... 54"

#### 130" Wheelbase

- E: Crossbar Spacing (rear to center) ..... 4'
- F: Crossbar Spacing (center to front) ..... 2'
- G: Total Crossbar Spacing ..... 5'-6"
- H: Rack Length ..... 105"

#### 148" Wheelbase

- I: Crossbar Spacing (rear to center) ..... 4'
- J: Crossbar Spacing (center to front)..... 2'-4'
- K: Total Crossbar Spacing ..... 6'-8"
- L: Rack Length ..... 129"

#### Compatible Accessories Available

(Sold Separately)

- Rear Access Ladder..... [AAL Series](#)
- 8'-12' Conduit Carriers..... [CON Series](#)
- WorkPro LED Lighting..... [LED Series](#)
- Systems and Safety Components ..... [RVS Series](#)
- Safety monitoring..... [DS2 Series](#)

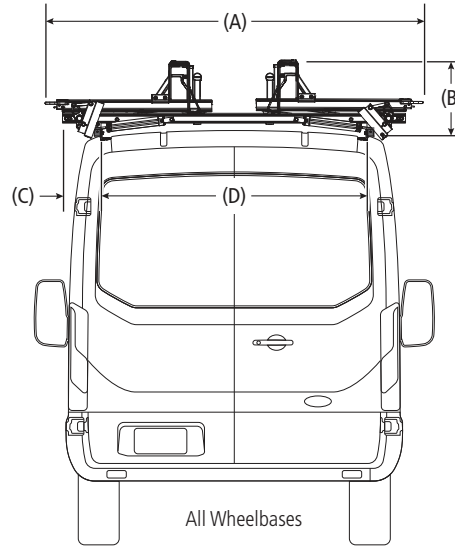

Rear Drive Shaft Offset: 29"

Note: The end of the driveshaft must not extend beyond the vehicle bumper

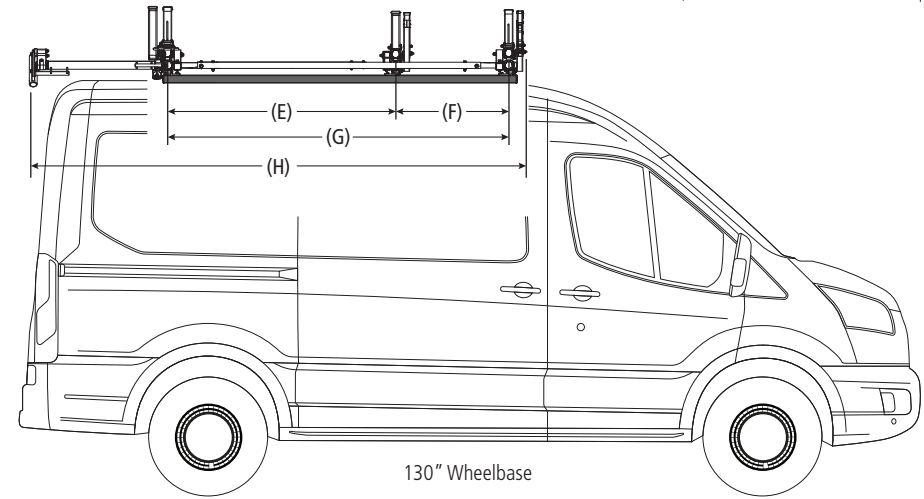
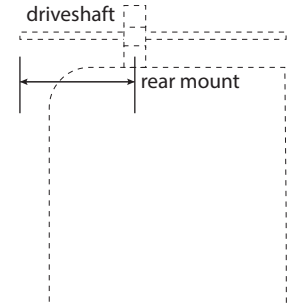

130" Wheelbase

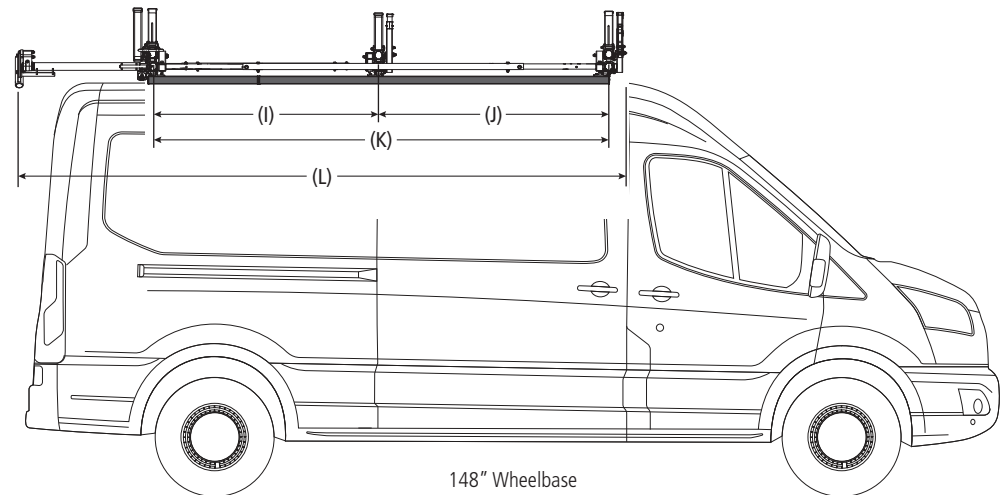

148" Wheelbase

# PRIME DESIGN™

A Safe Fleet Brand

## HRR3-E-FT-HM

### ErgoRack, Ford Transit High Roof

Approximate dimensions as shown:

#### All Wheelbases

A: Rack Width .....	79"
B: Rack Height .....	16.50"
C: Rear Crossbar Offset (Left).....	8"
D: Mount Bolt Spacing L/R.....	54"

#### 130" Wheelbase

E: Crossbar Spacing (rear to center) .....	4'
F: Crossbar Spacing (center to front) .....	2'-4'
G: Total Crossbar Spacing .....	6'-8'
H: Rack Length.....	105"

#### 148" Wheelbase

I: Crossbar Spacing (rear to center) .....	4'
J: Crossbar Spacing (center to front).....	2'-4'
K: Total Crossbar Spacing .....	6'-8'
L: Rack Length .....	129"

#### Compatible Accessories Available

(Sold Separately)

Rear Access Ladder.....	<a href="#">AAL Series</a>
8'-12' Conduit Carriers.....	<a href="#">CON Series</a>
WorkPro LED Lighting.....	<a href="#">LED Series</a>
Systems and Safety Components .....	<a href="#">RVS Series</a>
Safety monitoring.....	<a href="#">DS2 Series</a>

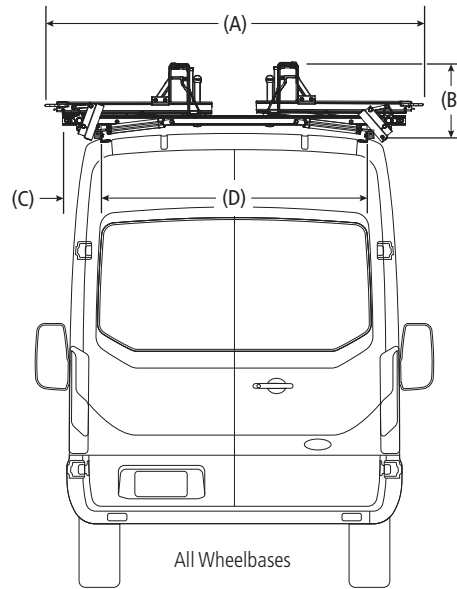

Rear Drive Shaft Offset: 29"

Note: The end of the driveshaft must not extend beyond the vehicle bumper

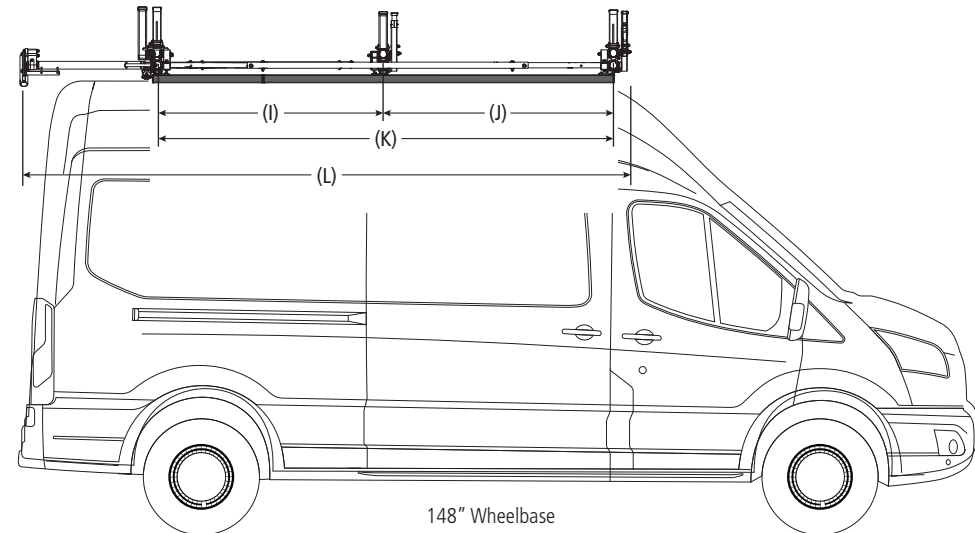
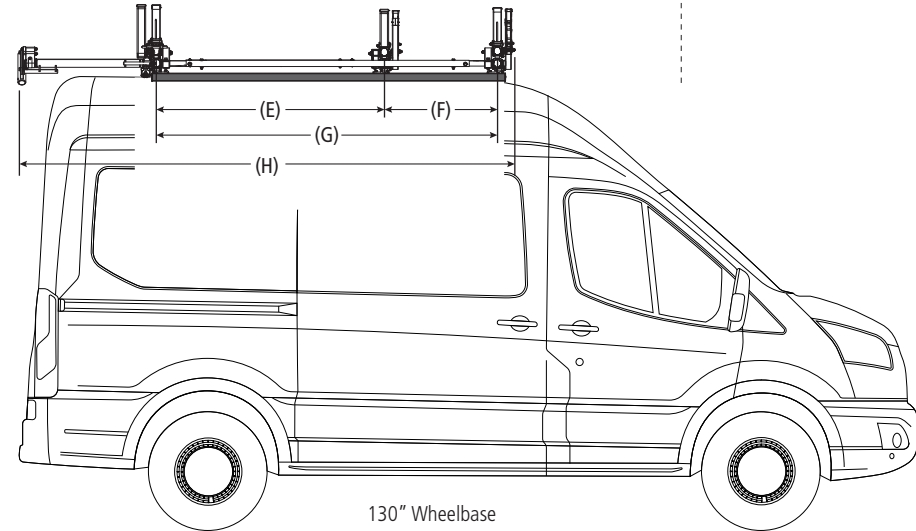
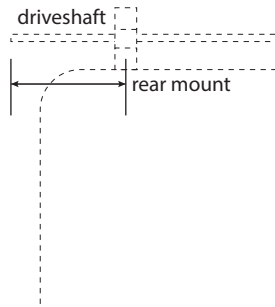

## HRR3-E-FT-HM

### ErgoRack, Ford Transit High Roof

Approximate dimensions as shown:

#### All Wheelbases

- A: Rack Width ..... 79"
- B: Rack Height ..... 16.50"
- C: Rear Crossbar Offset (Left)..... 8"
- D: Mount Bolt Spacing L/R..... 54"

#### 148" Extended Wheelbase

- E: Crossbar Spacing (rear to center) ..... 4'
- F: Crossbar Spacing (center to front) ..... 2'-4'
- G: Total Crossbar Spacing ..... 6'-8'
- H: Rack Length ..... 144"

#### Compatible Accessories Available

(Sold Separately)

- Rear Access Ladder..... [AAL Series](#)
- 8'-12' Conduit Carriers..... [CON Series](#)
- WorkPro LED Lighting..... [LED Series](#)
- Systems and Safety Components ..... [RVS Series](#)
- Safety monitoring..... [DS2 Series](#)

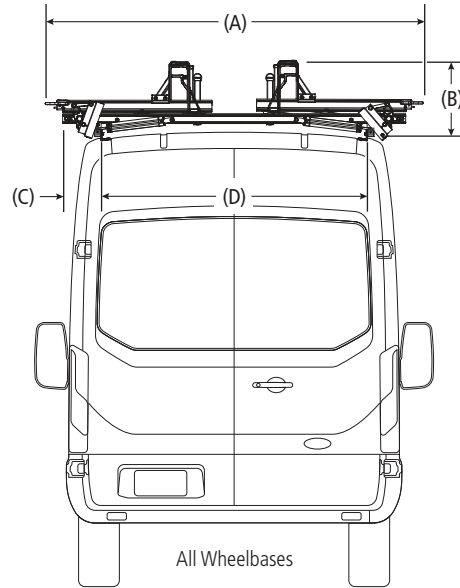

Rear Drive Shaft Offset: 29"

Note: The end of the driveshaft must not extend beyond the vehicle bumper

