

PRIME DESIGN™

A Safe Fleet Brand

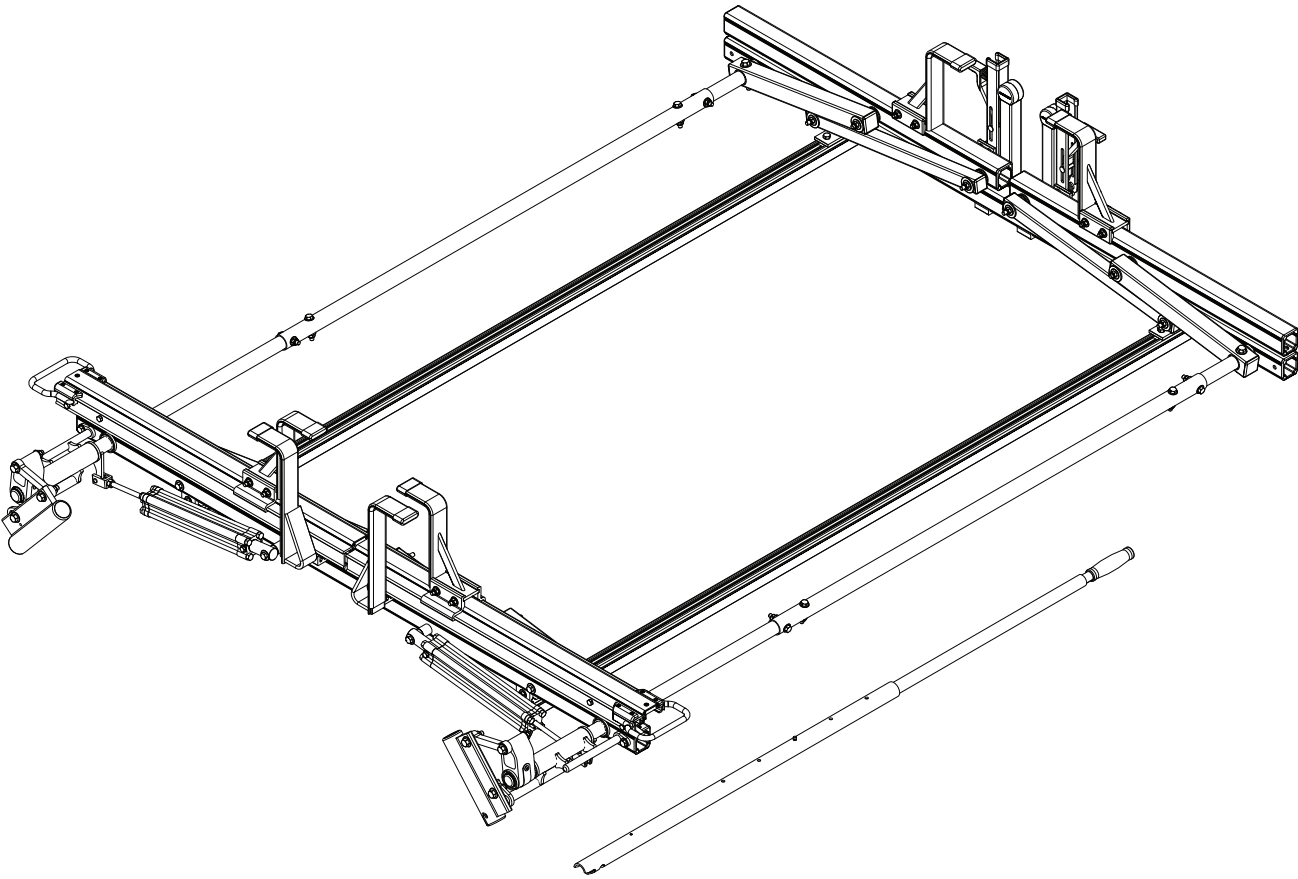

60000

HRR-E

CONTENTS OVERVIEW

INSTALLER NOTE: Mounting Hardware or Brackets to attach this rack to a vehicle roof or cap are not included in this kit, and must be purchased separately.

To purchase Mounting Hardware or Brackets, please contact Prime Design Sales & Support.

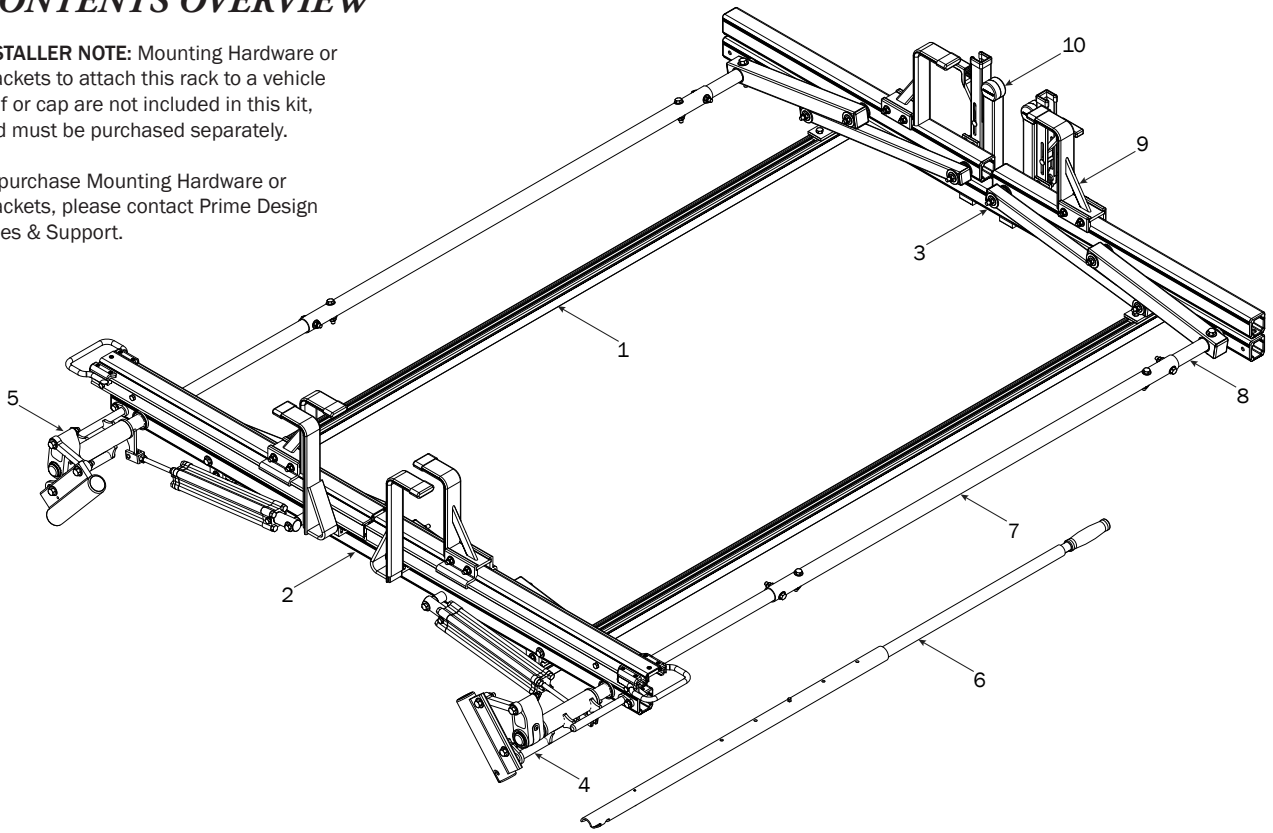

1—FBM-0001..... (Qty 1)
Channels with hardware



Channels (2X)



Screws (8X)



End Caps (4X)



Brackets (4X)

2—Rear Crossbar Assembly..... (Qty 1)

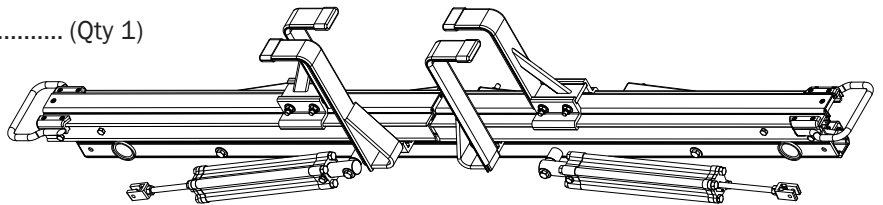

3—Front Crossbar Assembly (Qty 1)

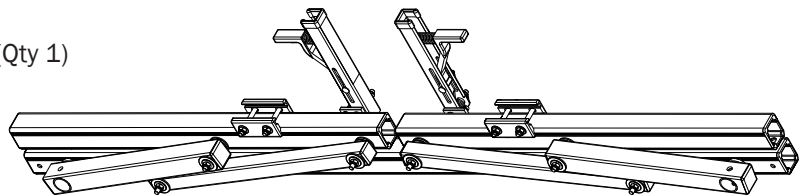

4—Rear Drive Shaft (Qty 1)
Right Hand, G4, 33.50"

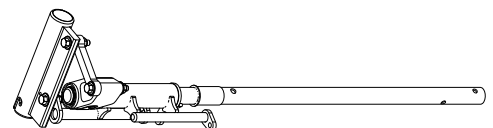

5—Rear Drive Shaft (Qty 1)
Left Hand, G4, 33.50"

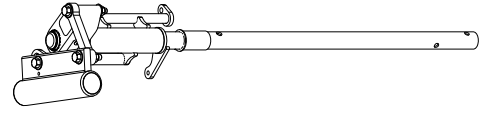

6—HRR Handle Assembly (Qty 1)
35.00"

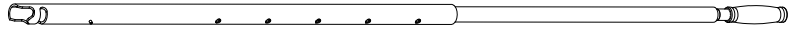

7—Connecting Bar (Qty 1)
48.00"

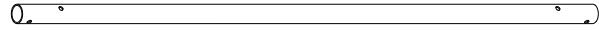

8—Front Drive Shaft (Qty 1)
B Version, 35.75"



9—Z Post (Qty 1)
Adjustable 7.25"

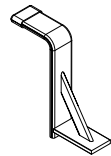

10—L Post (Qty 1)
Roller Cap, 9.25"

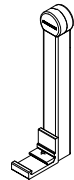

11—HKT-8163 (Not called out in Overview)..... (Qty 2)

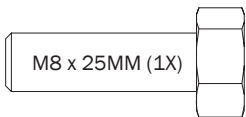

M8 x 25MM (1X)

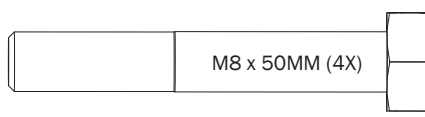

M8 x 50MM (4X)

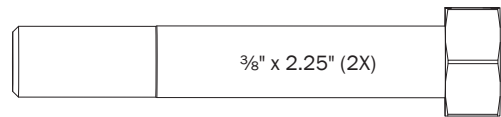

3/8" x 2.25" (2X)



Cotter Pin (1X)

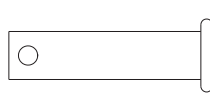

Clevis Pin (1X)



M8 Lock Nut (5X)

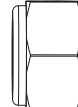

3/8" Lock Nut (2X)

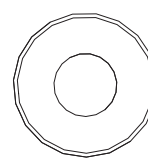

5/16" Flat Washer (10X)

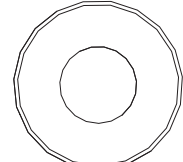

3/8" Flat Washer (4X)

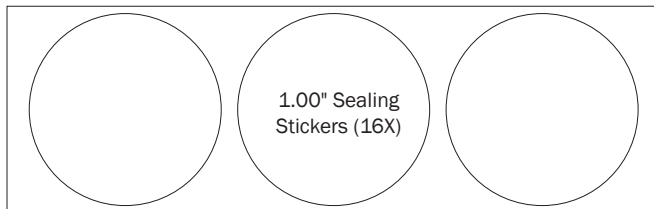

1.00" Sealing Stickers (16X)



Anti-Seize (1X)

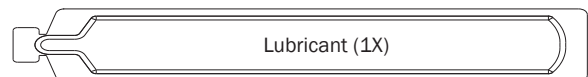

Lubricant (1X)

FBM-0001 FLUSH CHANNELS TO PRE-INSTALLED MOUNTING BRACKETS

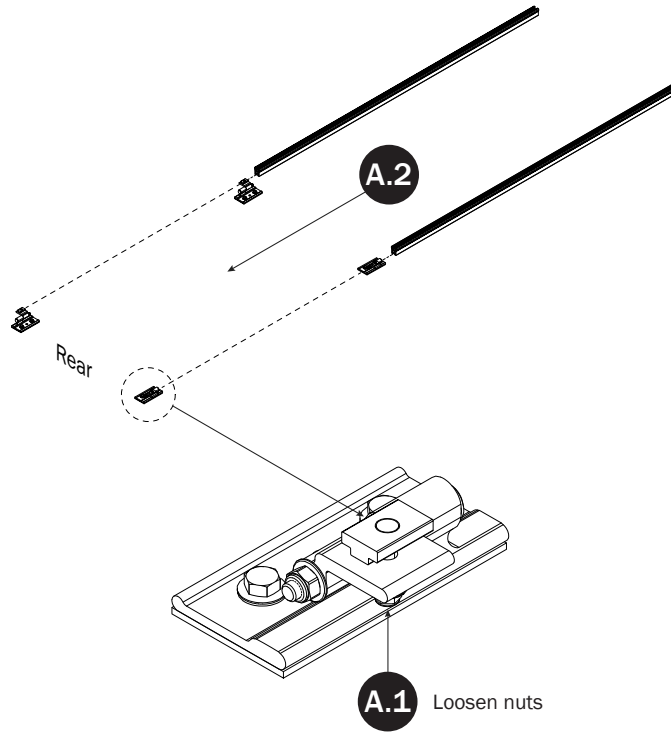

A.3 Set to distances then torque nuts to 80 in-lbs

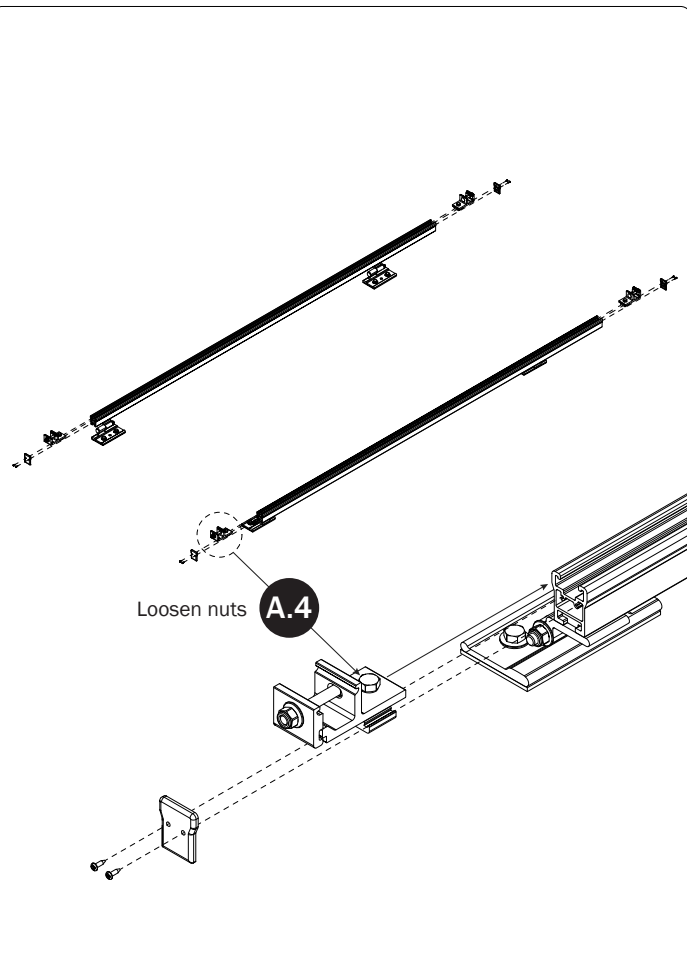
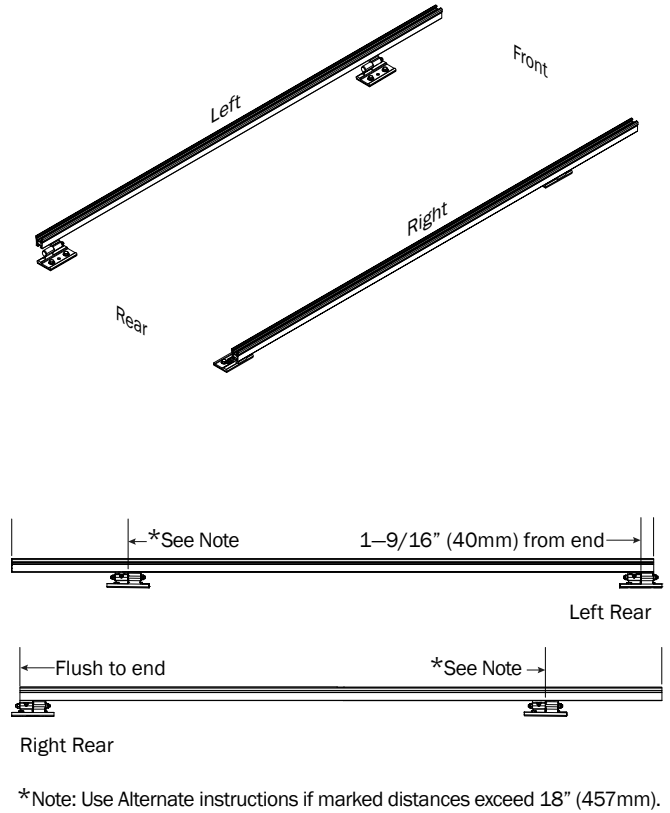

A.5 Set to distances then torque Rear Bracket nuts to 90 in-lbs

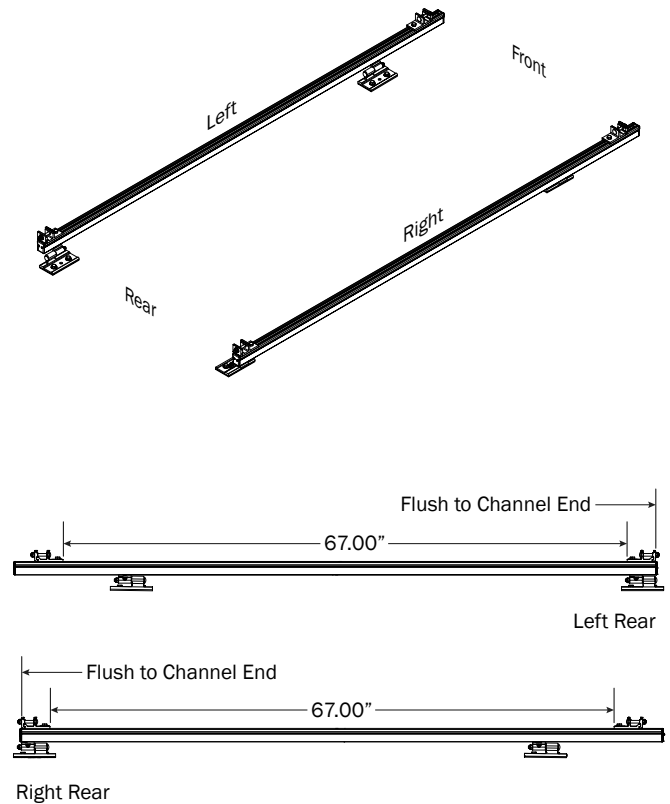

FBM-0001 ALTERNATE
CHANNELS TO PRE-INSTALLED
MOUNTING BRACKETS

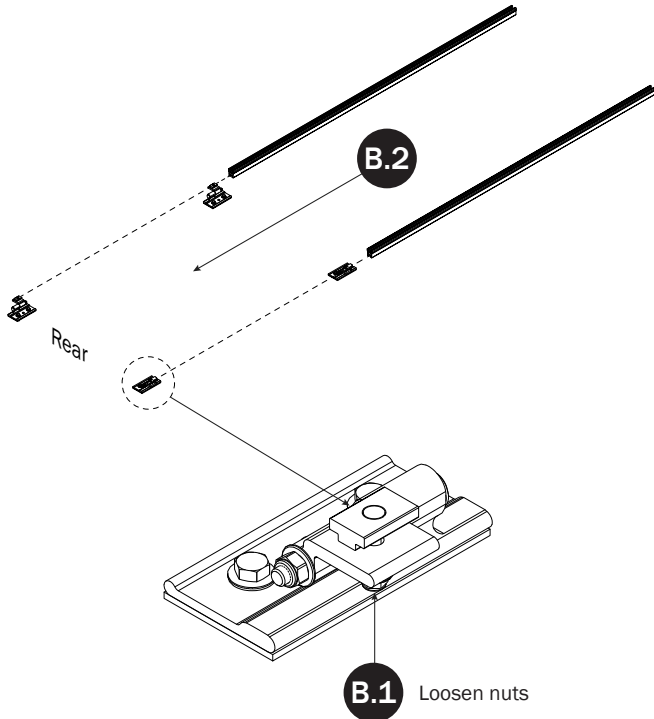

B.3 Set to distances then torque nuts to 80 in-lbs

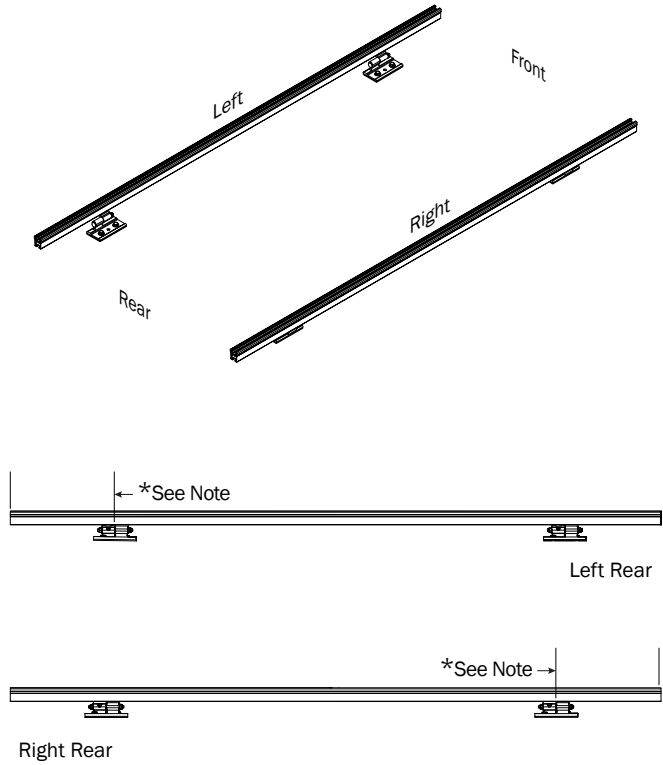

* Move Channels rearward until front distance no longer exceeds 18" (457mm).

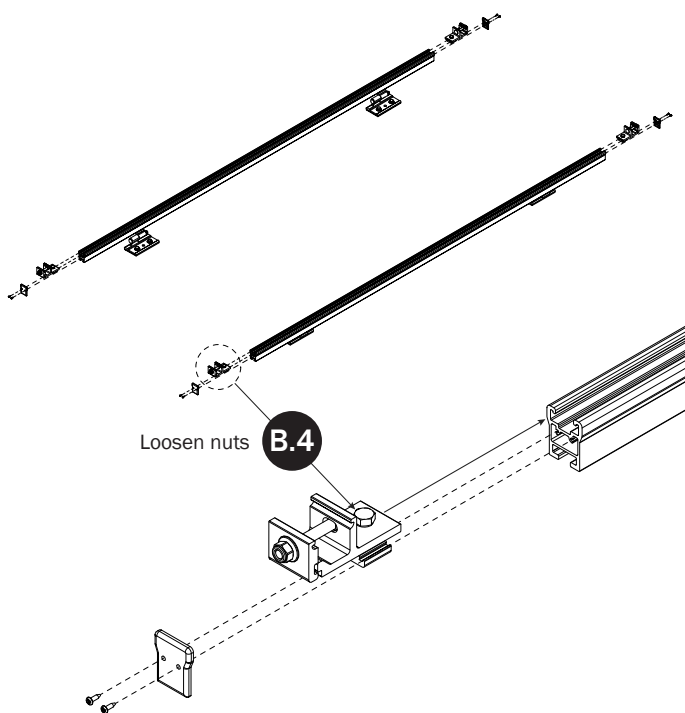

B.5 Set to distances then torque Rear Bracket nuts to 90 in-lbs

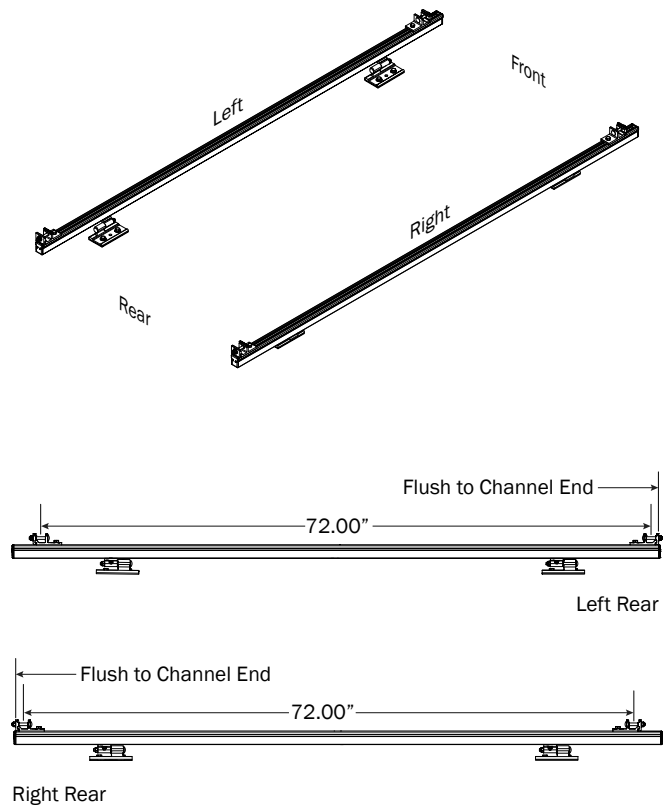

RIGHT ROTATION ASSEMBLY SEQUENCE

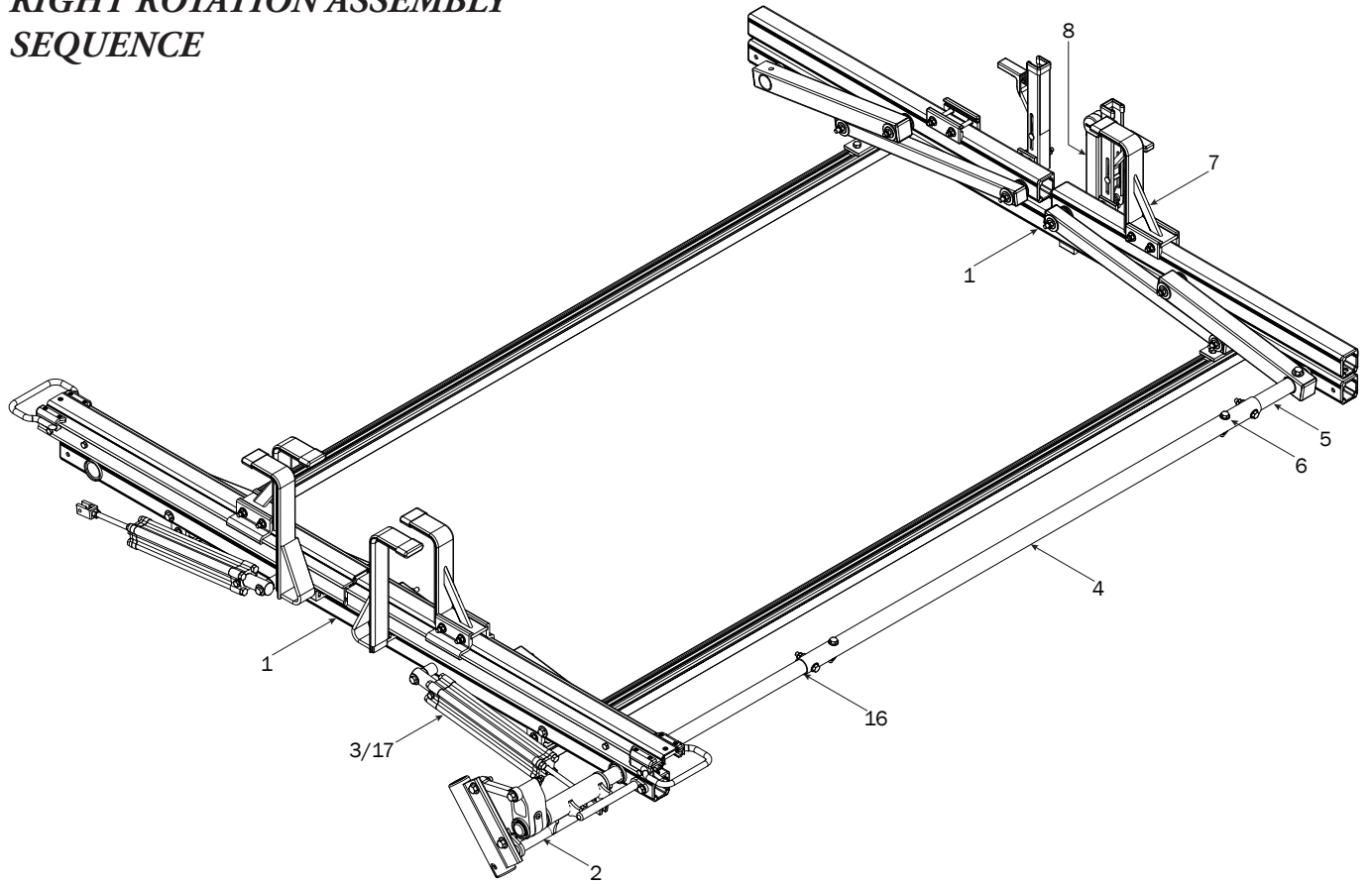

CROSSBARS

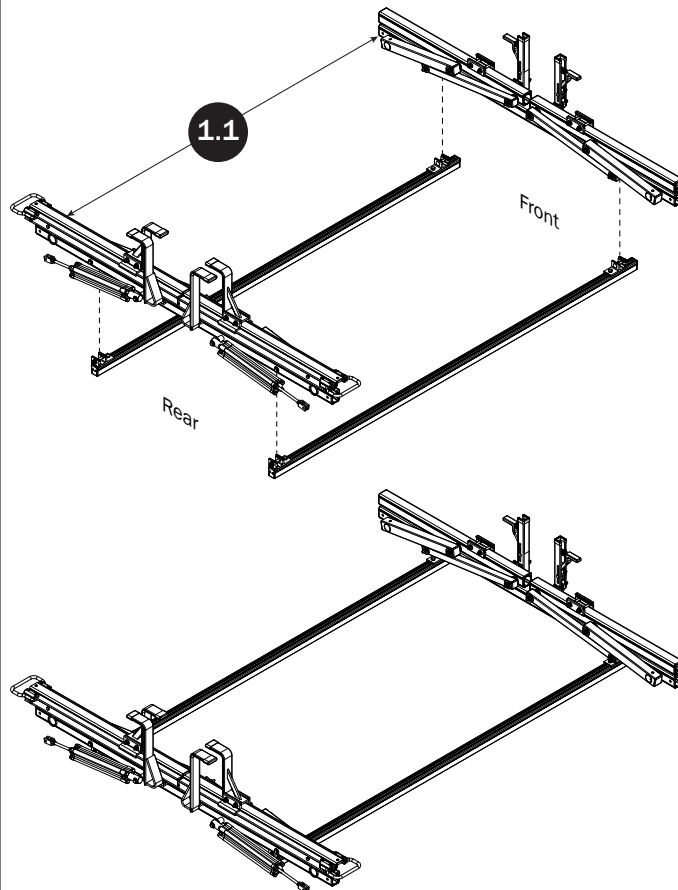

CROSSBAR ADJUSTMENT

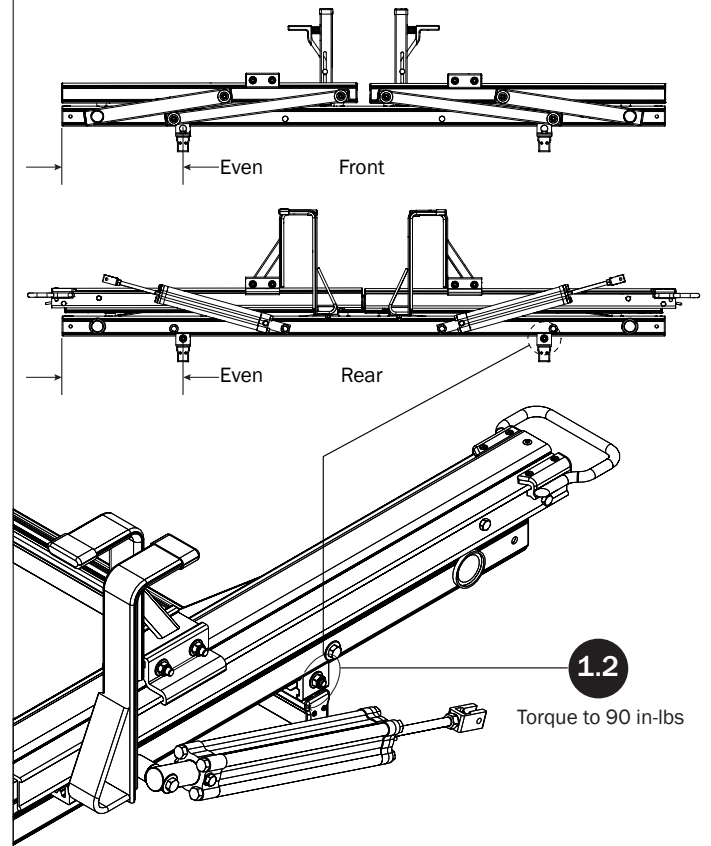

HRR-E-6000 ASSEMBLY INSTRUCTIONS—RIGHT SIDE ROTATION

PRIME DESIGN
A Safe Fleet Brand

REAR DRIVE SHAFT

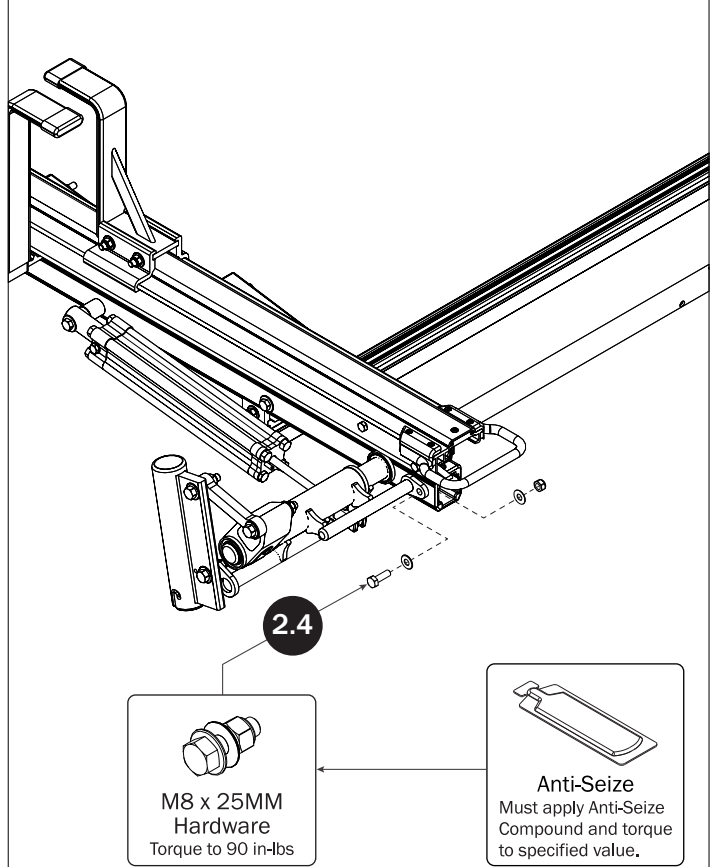
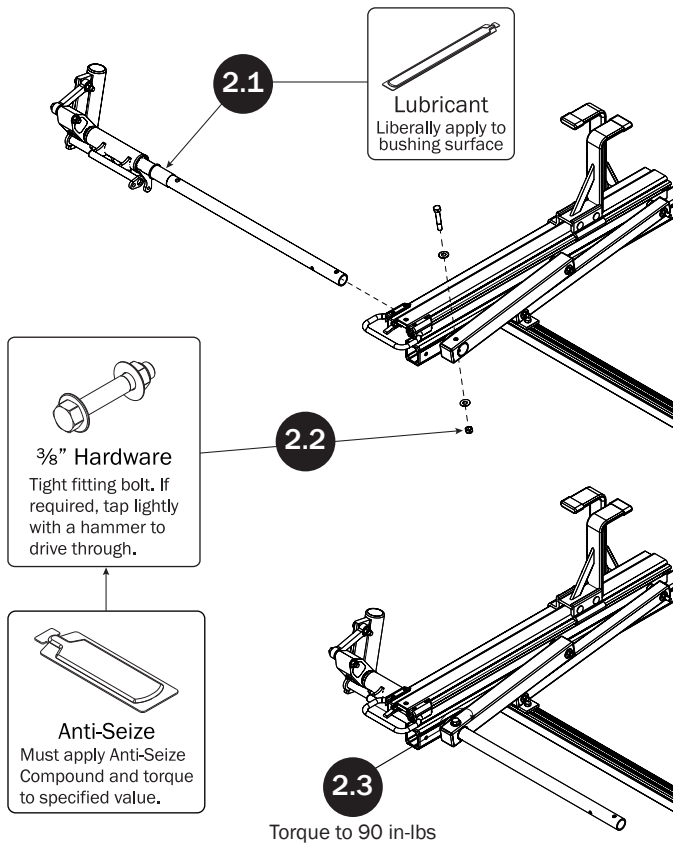

CYLINDER HARDWARE

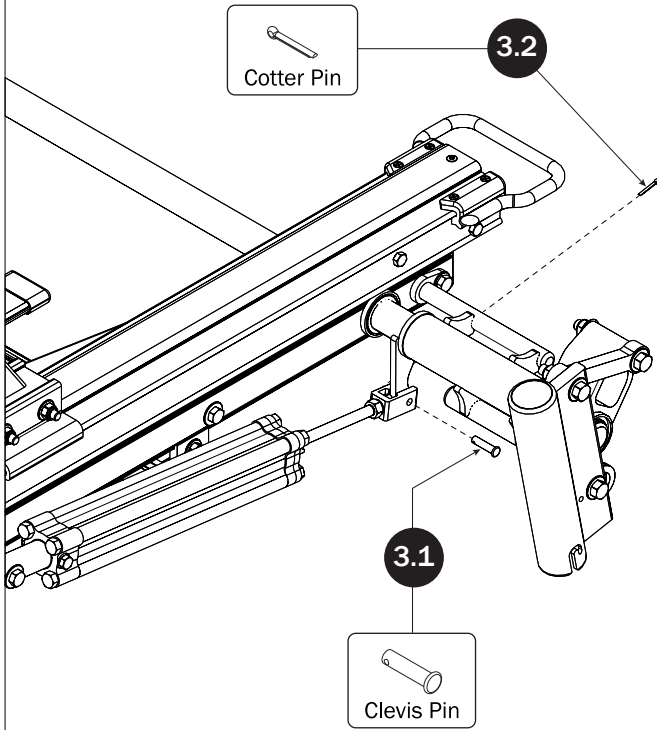

CONNECTING BAR

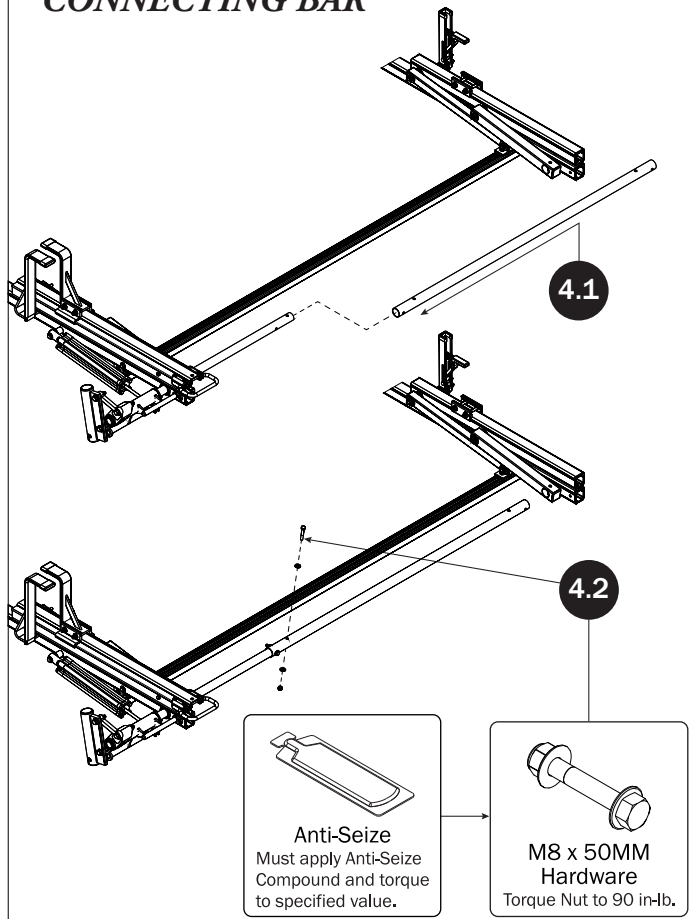

FRONT DRIVE SHAFT

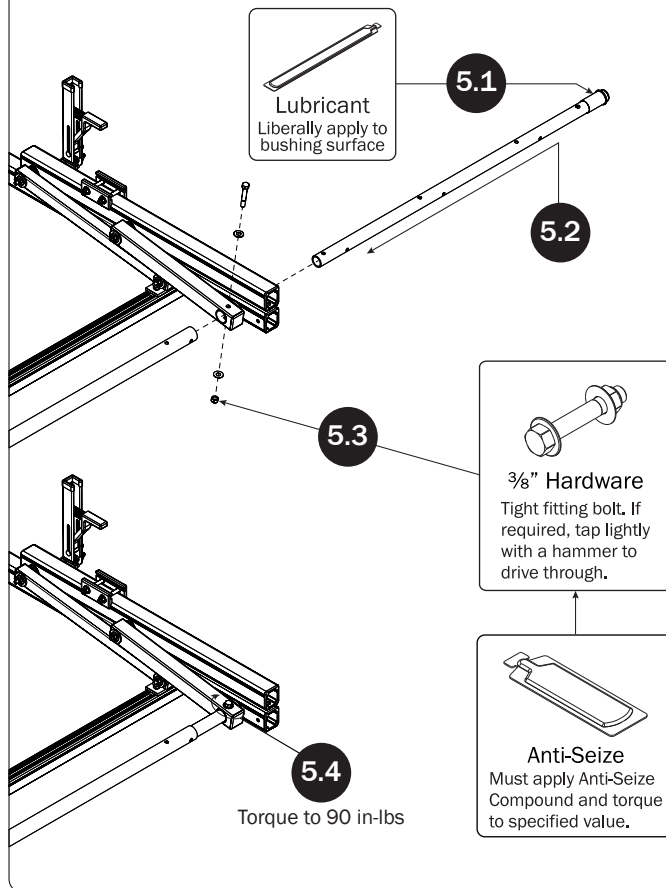

CONNECTING BAR FASTENERS

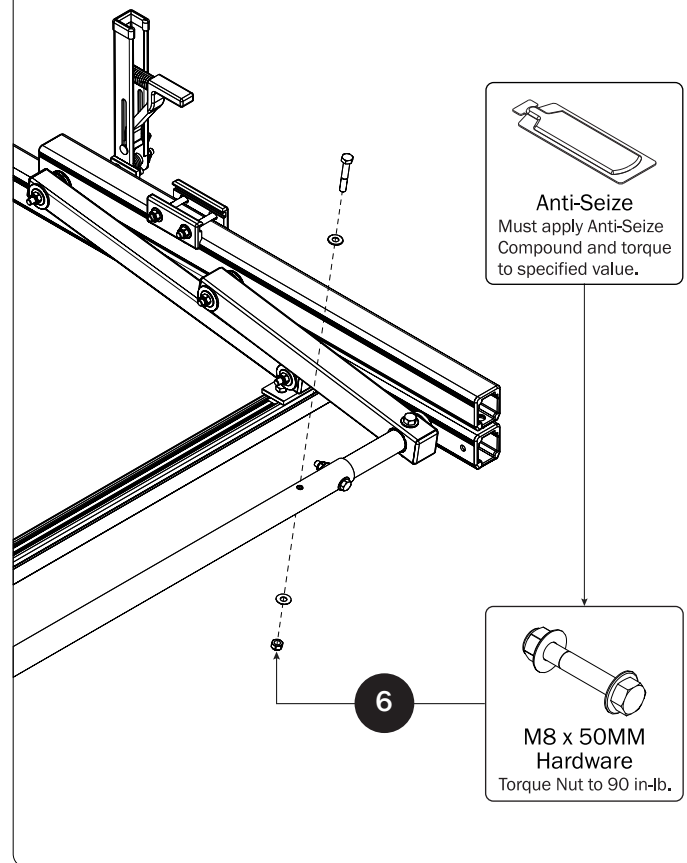

Z POSTS

SEE QUICK START GUIDE FOR ADJUSTMENTS

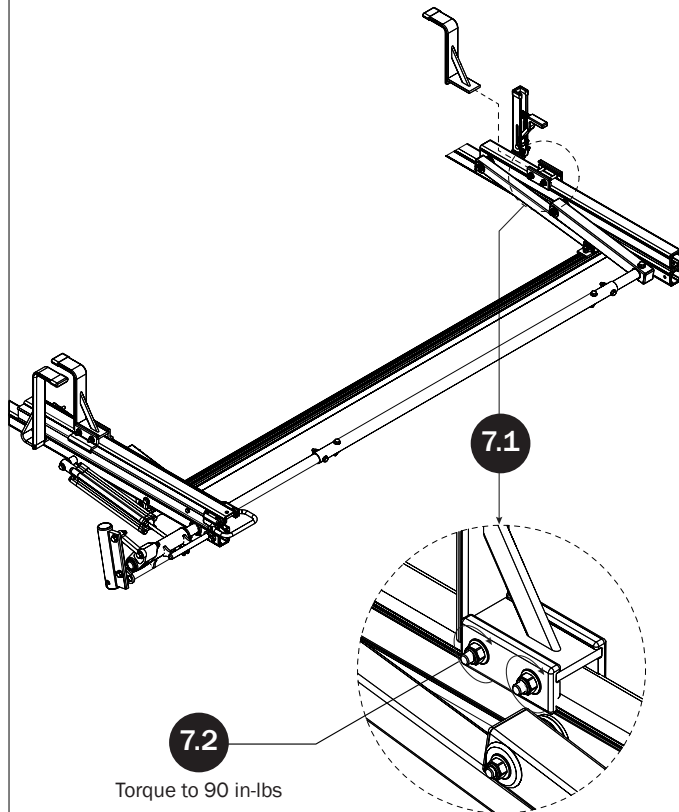

L POSTS

SEE QUICK START GUIDE FOR ADJUSTMENTS

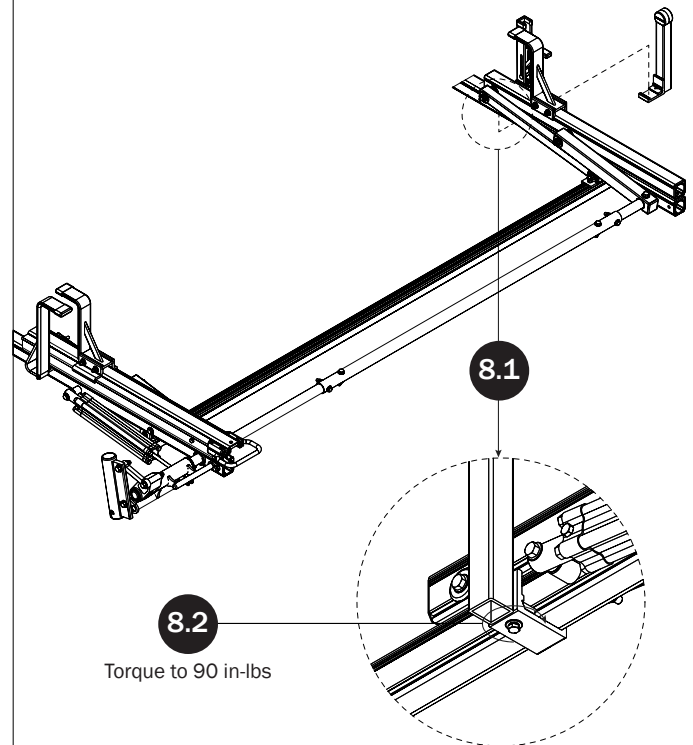

LEFT ROTATION ASSEMBLY SEQUENCE

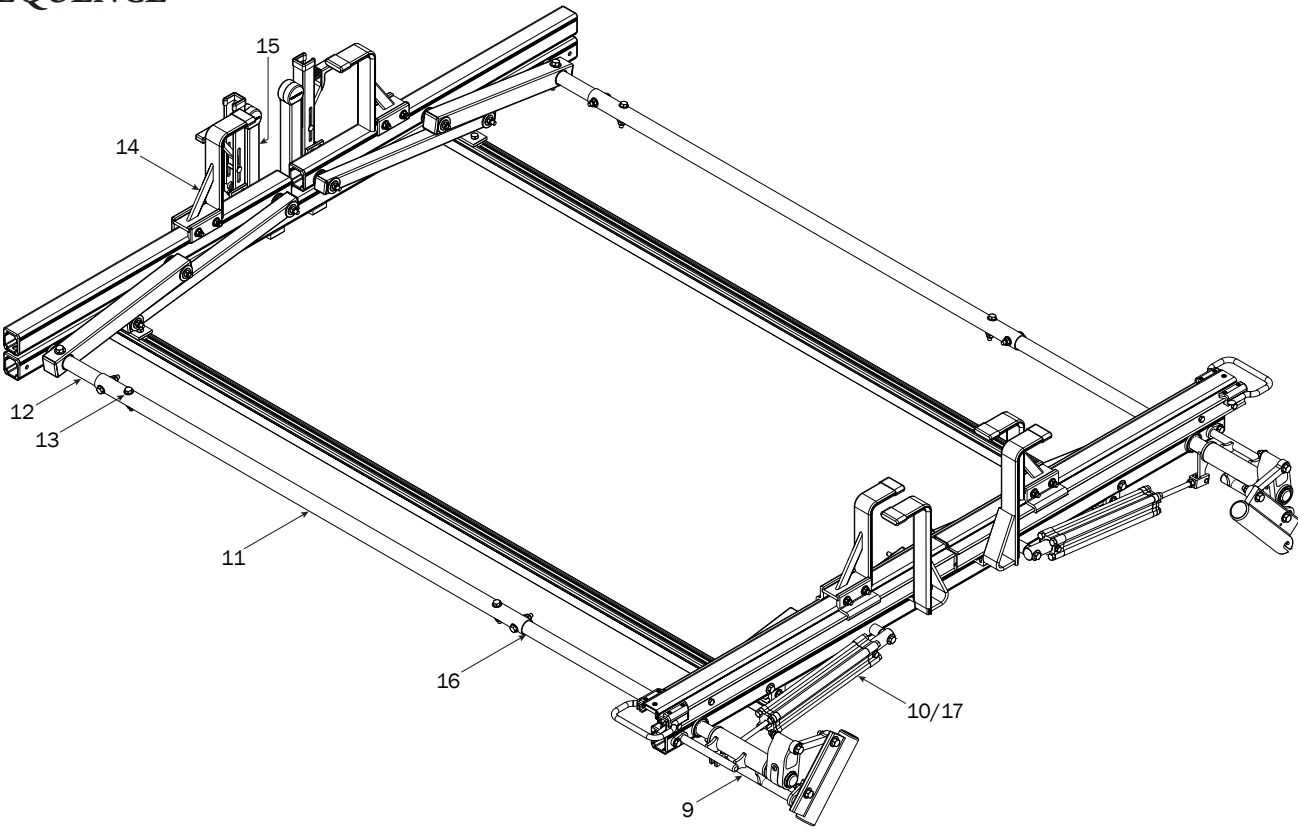

REAR DRIVE SHAFT

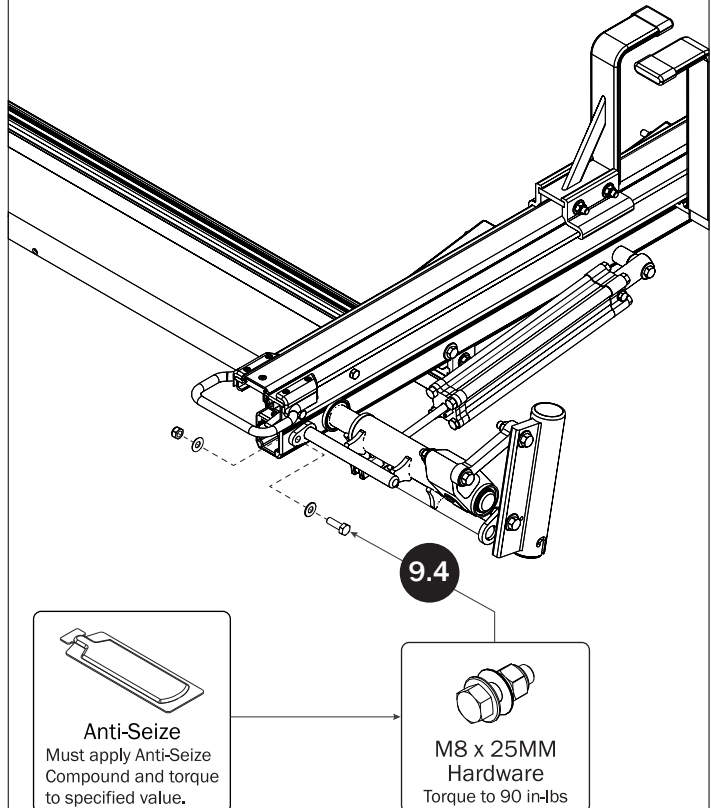
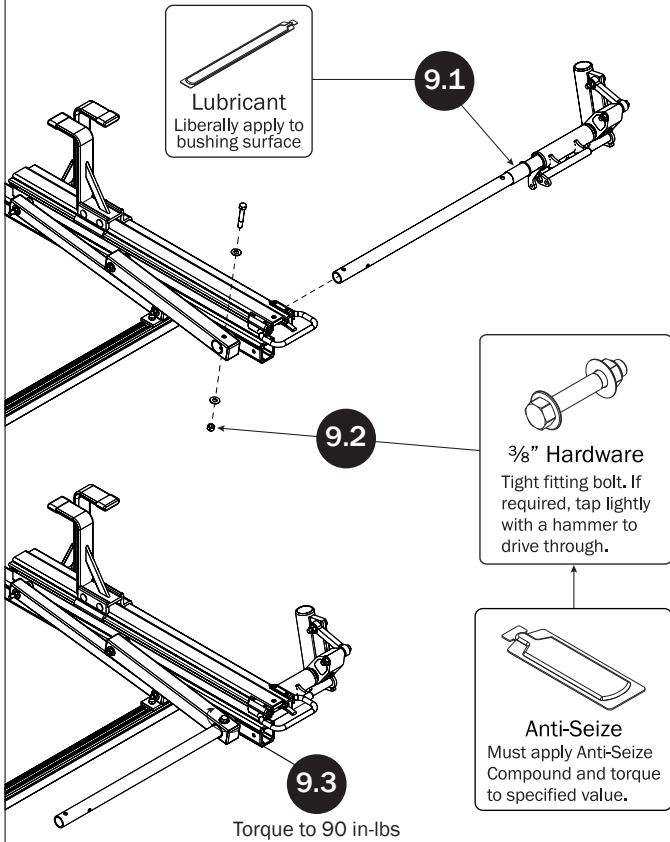

CYLINDER HARDWARE

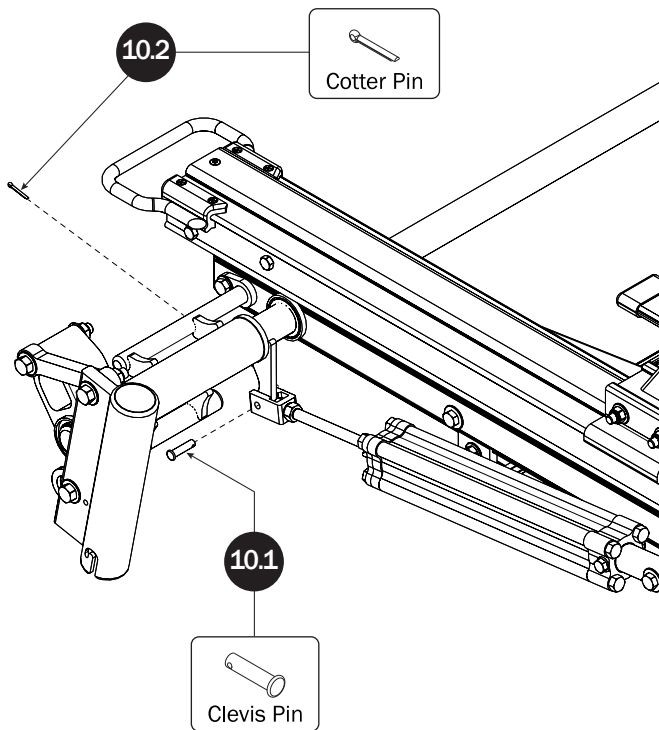

CONNECTING BAR

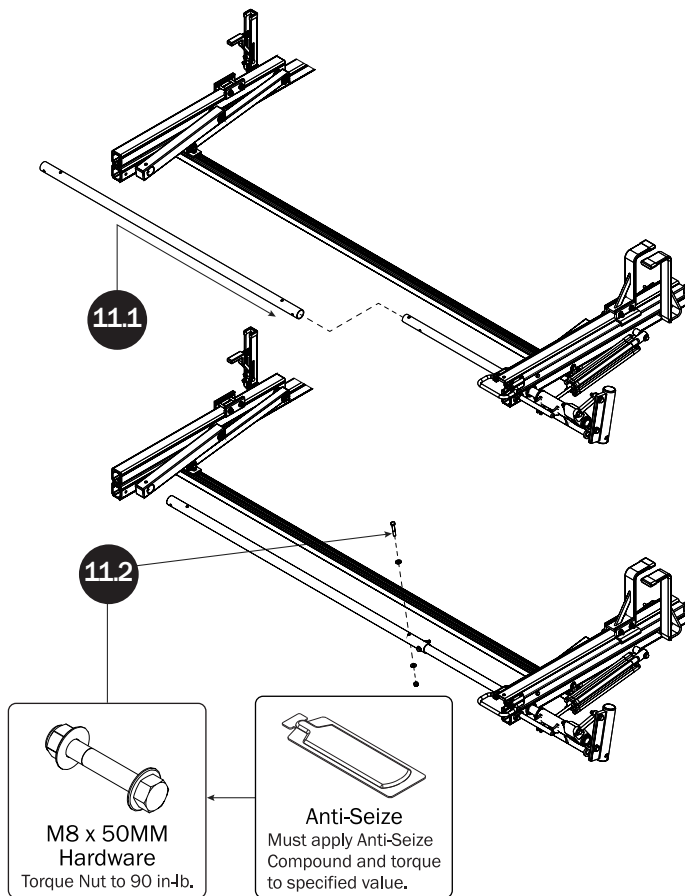

FRONT DRIVE SHAFT

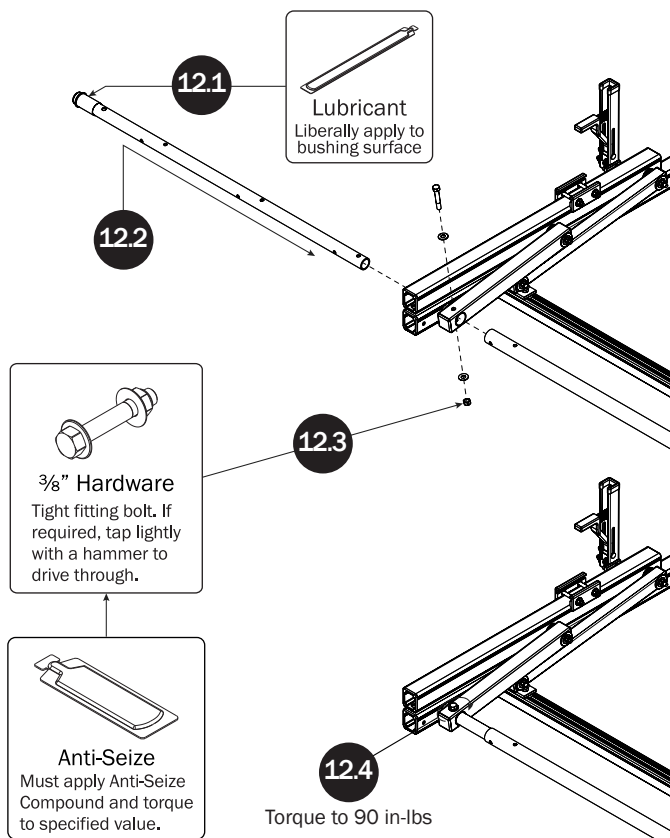

CONNECTING BAR FASTENERS

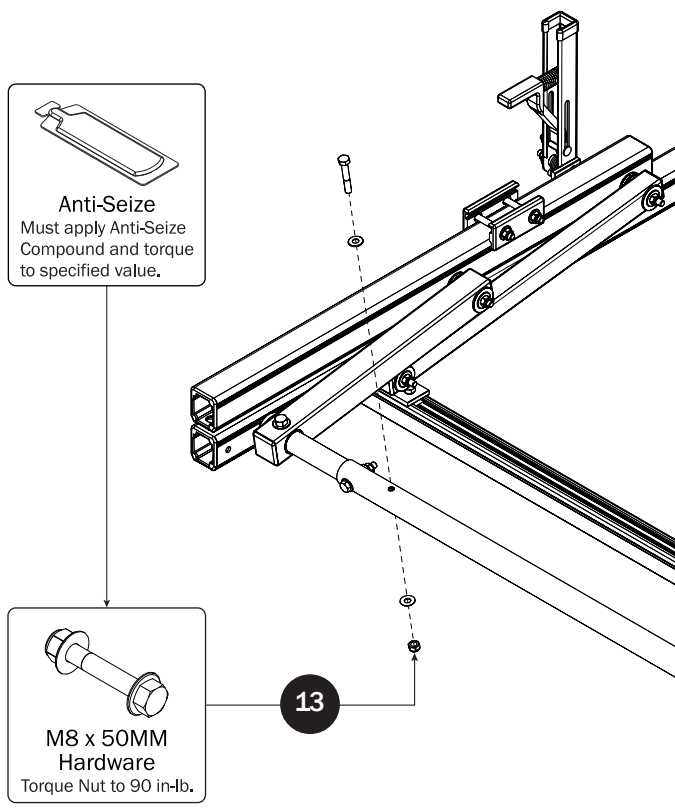

Z POSTS

SEE QUICK START GUIDE FOR ADJUSTMENTS

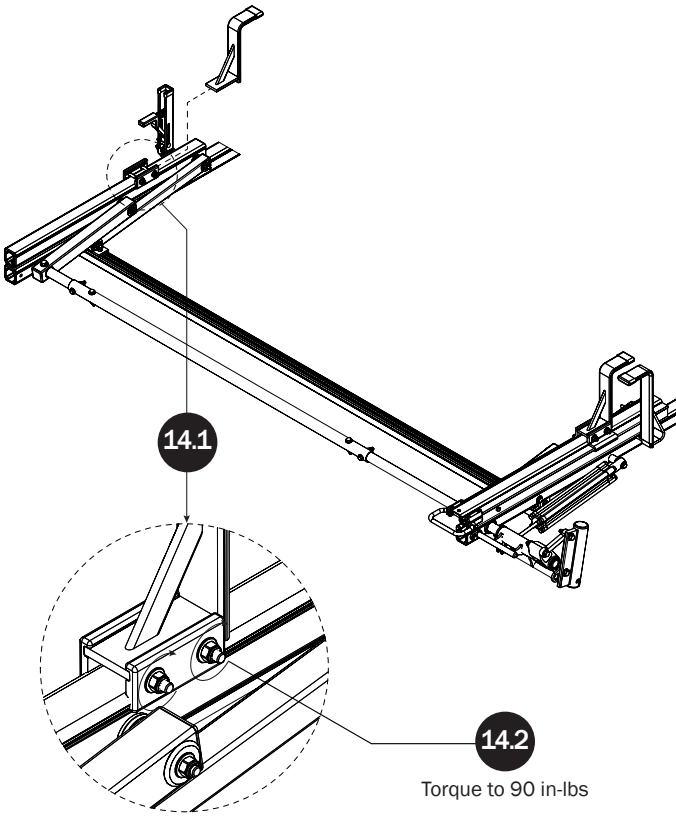

L POSTS

SEE QUICK START GUIDE FOR ADJUSTMENTS

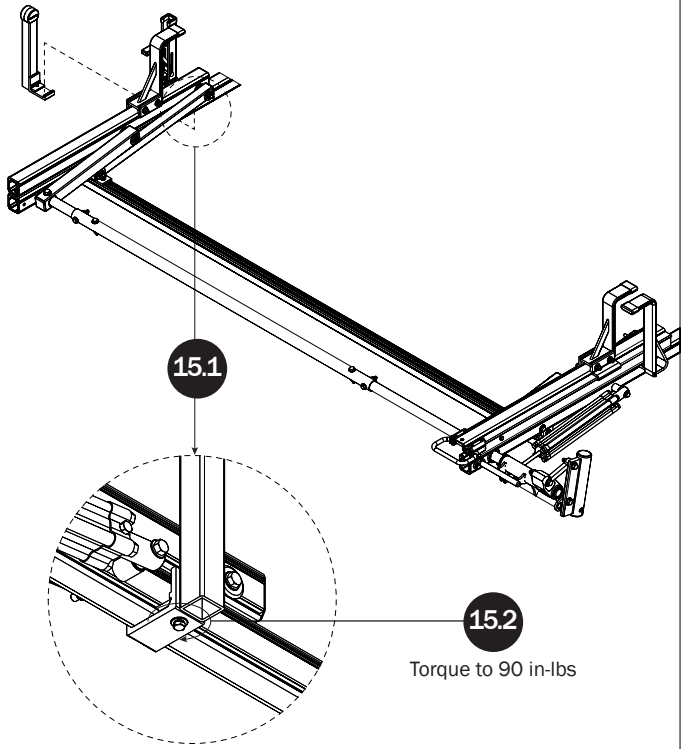

DRIVE SHAFT SEALING

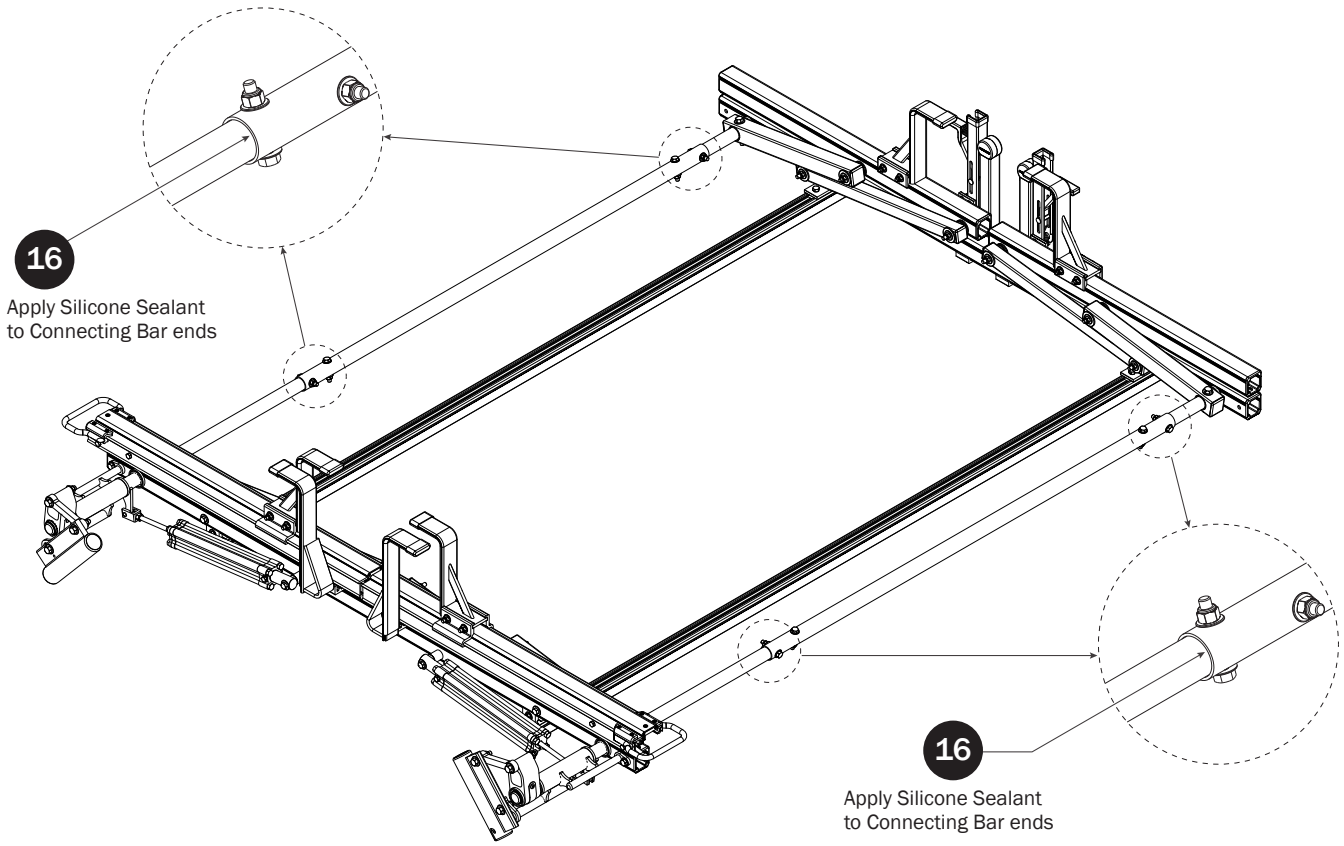

CYLINDER ADJUSTMENT

17 Adjust the Cylinder Flow Control Screw to allow approximately 3 seconds time for the ladder to glide down when operating the loaded Ladder Rack.

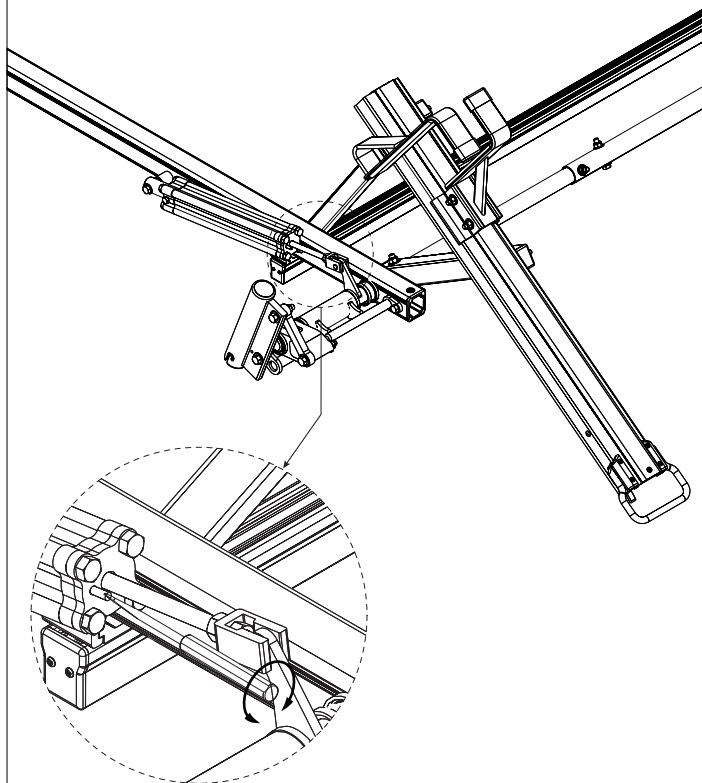

USAM-HRRE6000-US01 Rev-A 0118