

# PRIME DESIGN™

A Safe Fleet Brand

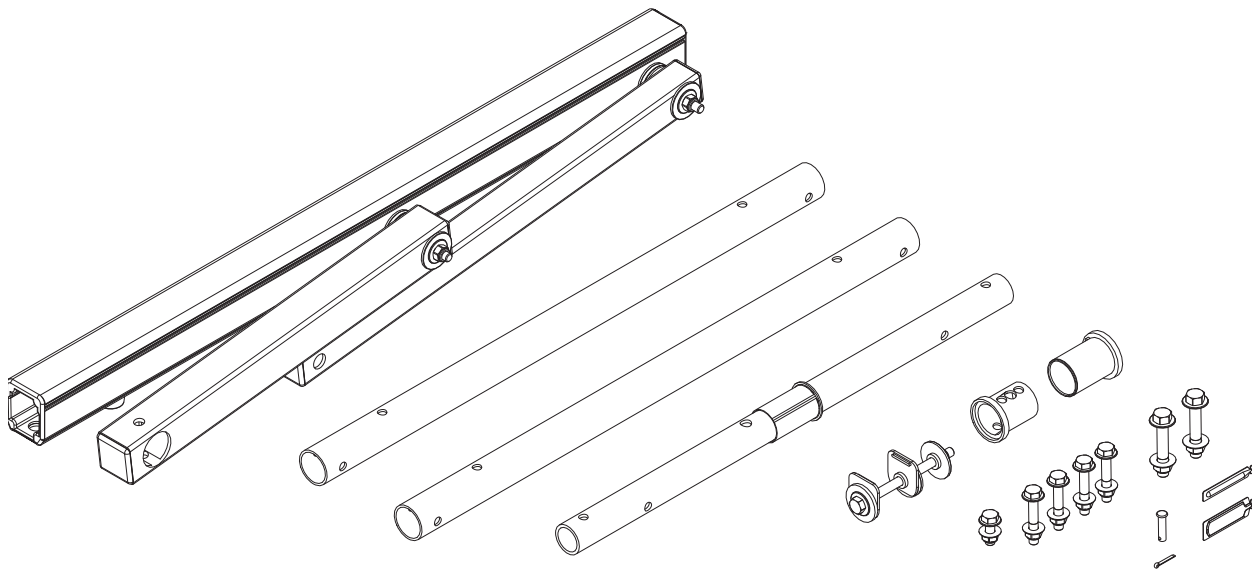

## *THIRD ROTATION UPPER FEATURE*

PRIME DESIGN, A SAFE FLEET BRAND

Address: 580 Opperman Drive, Eagan, MN 55123 • Toll Free: 1.8.PRIME.RACK

Fax: 651-552-1799 • Email: [info@primedesign.net](mailto:info@primedesign.net) • Website: [www.primedesign.net](http://www.primedesign.net)

FEA 0201

CONTENTS OVERVIEW

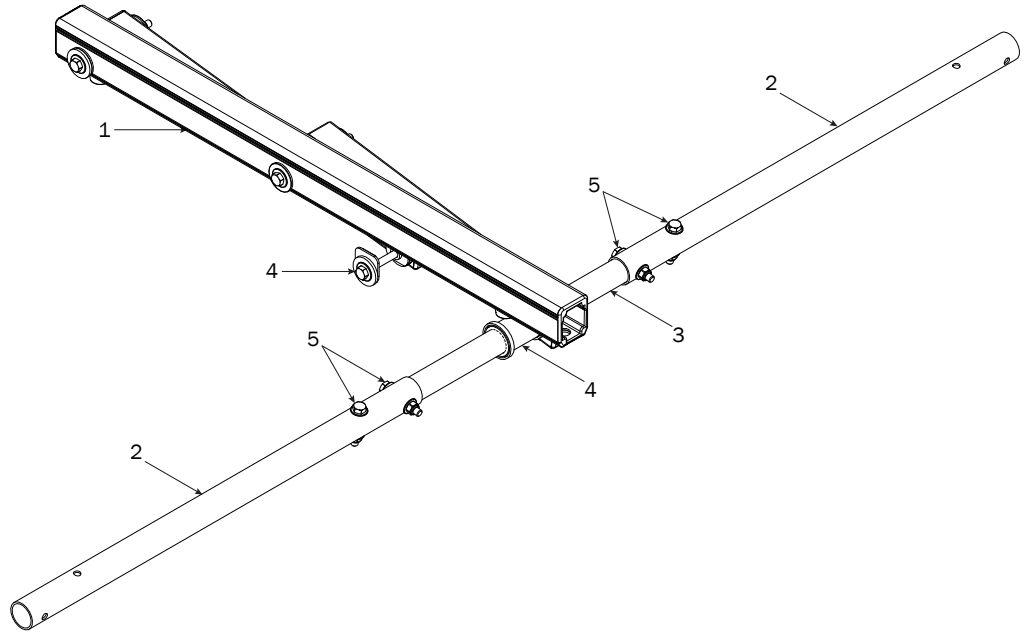

1—Upper Rotation ..... (Qty 1)

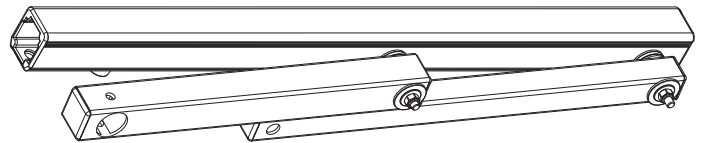

2—Connecting Bar..... (Qty 2)  
24.00"

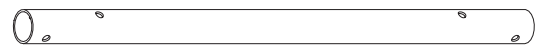

3—Middle Drive Shaft ..... (Qty 1)  
Right Hand, B4 Version, 46.00"



4—HKT-8168..... (Qty 1)  
Modular Rotation Hardware Kit

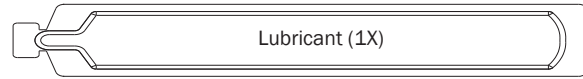
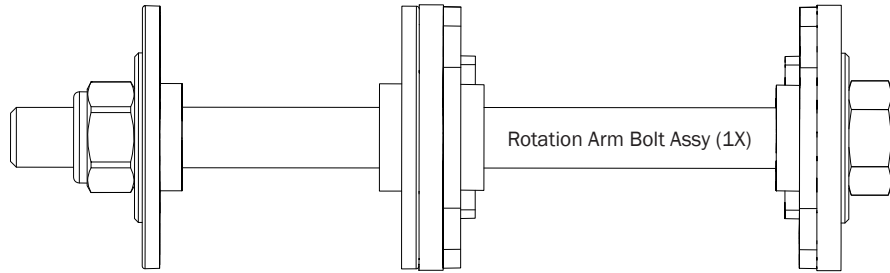
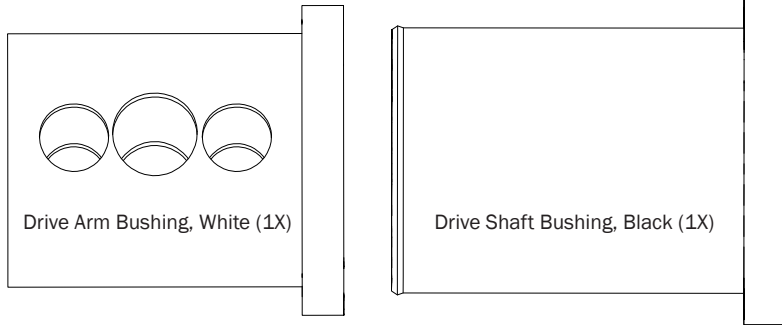

5—HKT-8162..... (Qty 1)  
Modular Rotation Hardware Kit

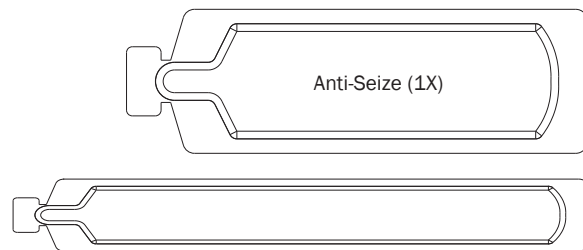
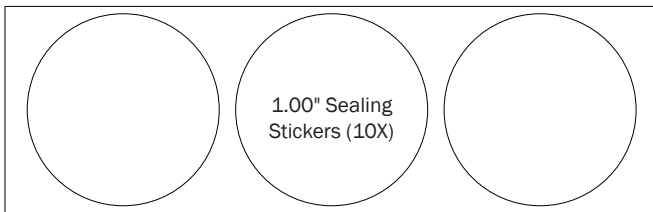
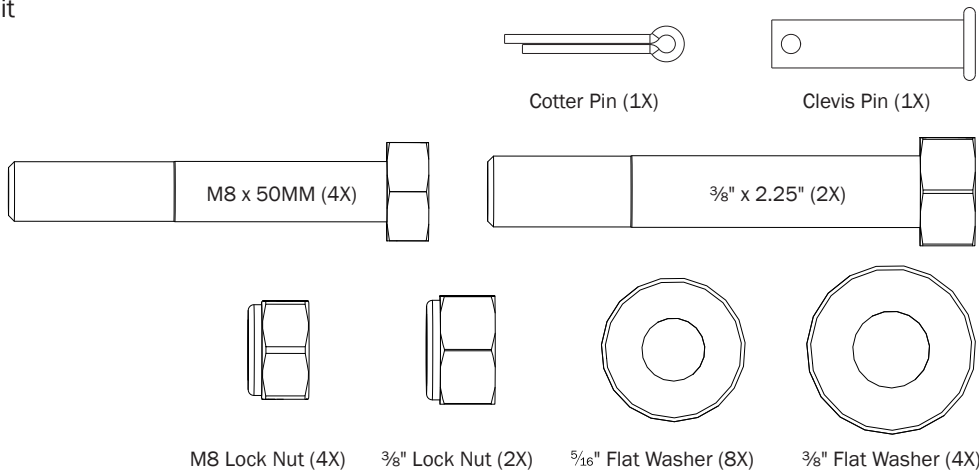

## RIGHT DRIVE SHAFT ASSEMBLY SEQUENCE

Left Hand Assembly Example

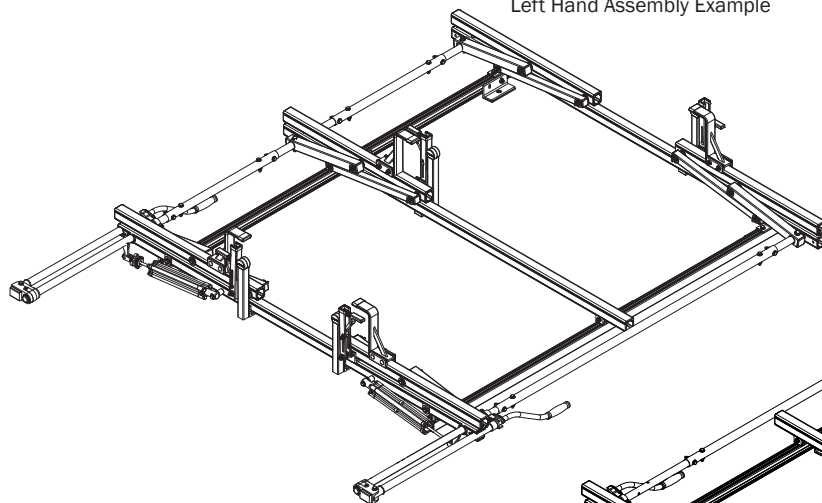

Right Hand Assembly Example

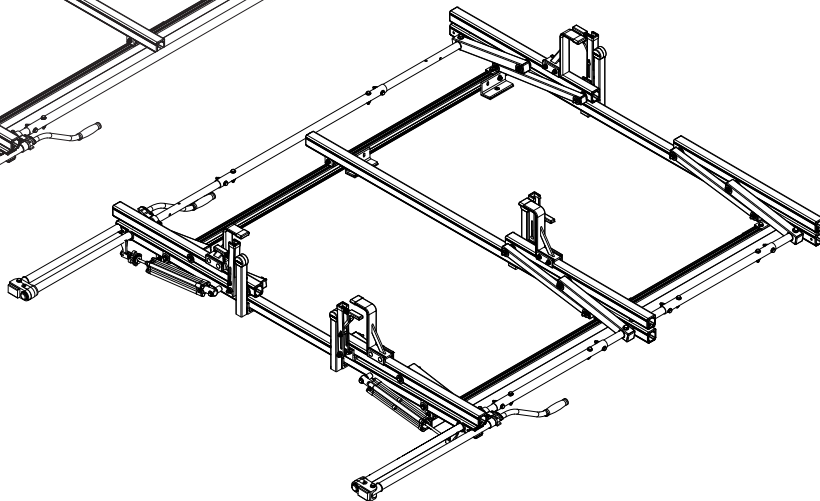

**NOTE:** Crossbars, FBMs, and other Rotation Features are shown for illustrative purposes only. They are not included with this Third Rotation Upper Feature, and must be purchased separately.

### LEFT HAND CONFIGURATION

**NOTE:** Middle Drive Shaft is shown for illustrative purposes only. Install Drive Shaft per Instructions in Steps 3.1-3.4.

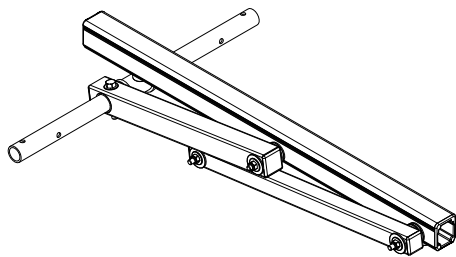

The FEA-0201 Rotation Upper is packaged in the Left Hand Configuration. No reassembly required.

For Right Hand Configuration, reassembly is required as shown in RIGHT HAND CONFIGURATION.

### RIGHT HAND CONFIGURATION

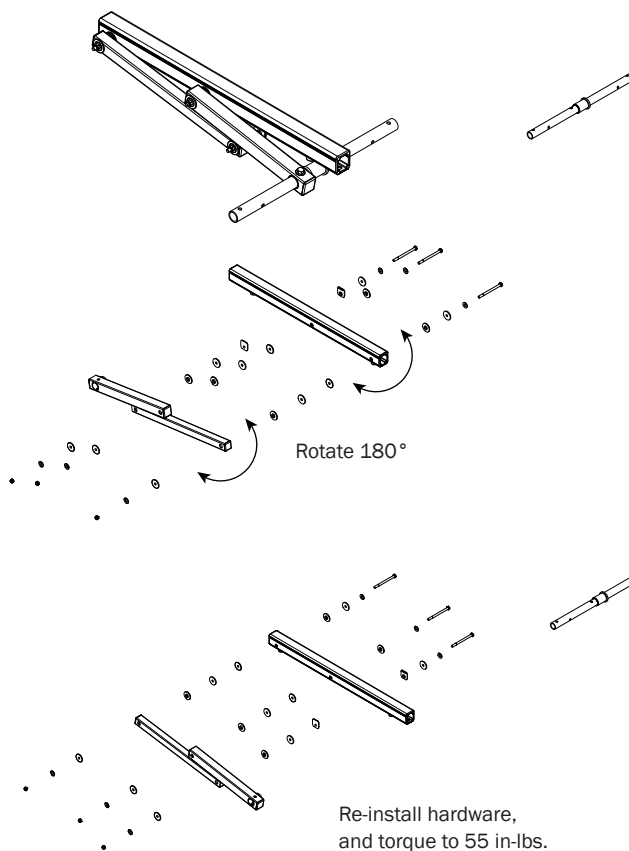

# LEFT & RIGHT SIDE OVERVIEWS

See Step by Step Instructions with Hardware on pages 6-8.

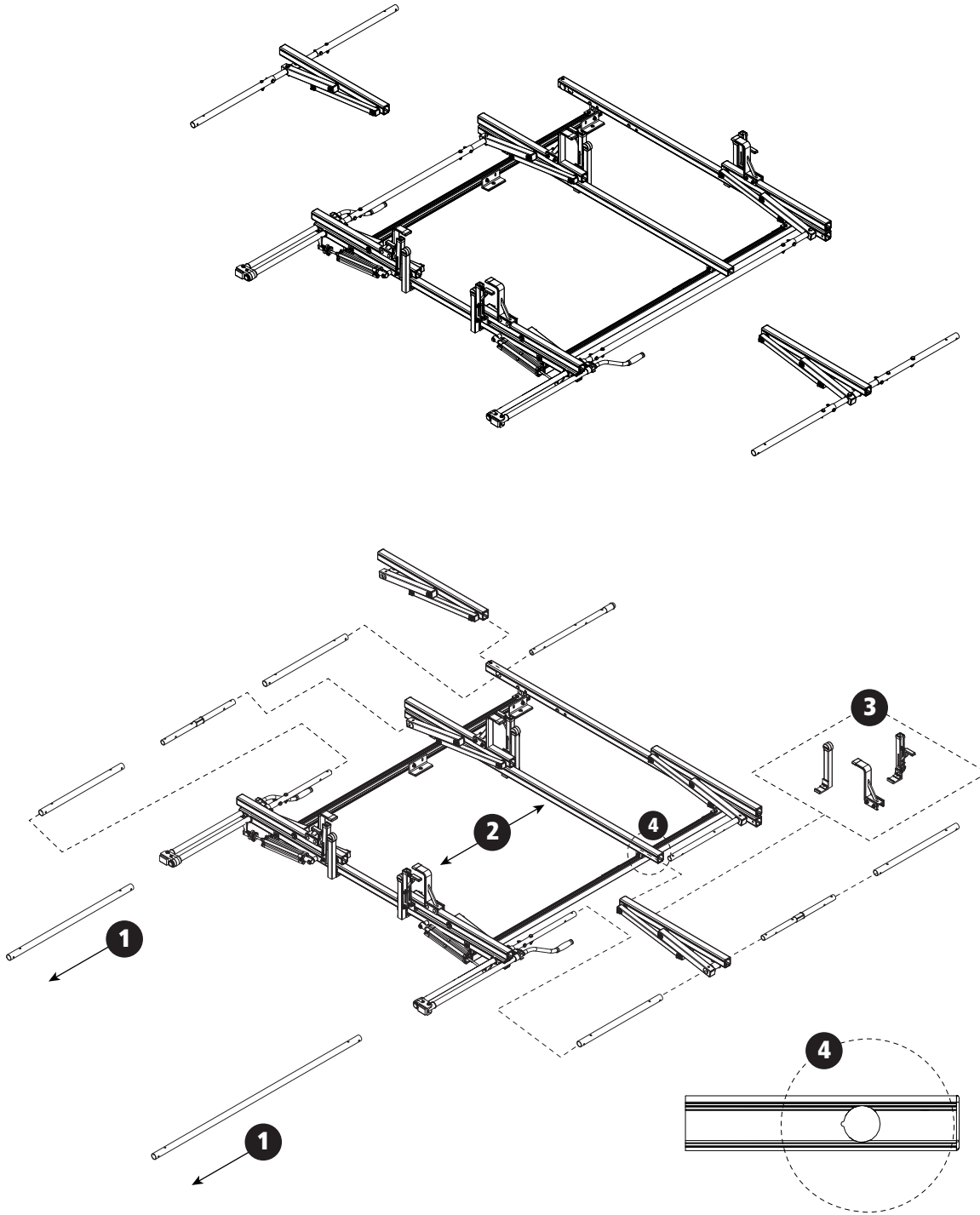

NOTES FOR EXPLODED VIEW:  
(All apply to both LH and RH side installations)

1. Original Connecting Bars: Discard or store original features for this application.
2. See table for Crossbar Distances per Rack Configuration for this application.
3. Z-Post, L-Post, and AutoClamp: Remove and install on the Third Rotation Upper OR purchase a third set separately as needed for your Configuration.
4. Make sure the Center Crossbar has the Rotation Extrusion for the Drive Shaft on the side you're installing the Third Crossbar Feature on. Re-positioning the Center Crossbar may be required.

CENTER CROSSBAR AND OVERALL DISTANCES PER PRODUCT

Product	Center Dist.	Ovr. Dist.
Low Roof	3.00'	6.00"
Med Roof	4.00'	7.00'
High Roof	4.00'	8.00'

### INSTALLING UPPER TO CROSSBAR

NOTE: For the remainder of the Instruction Sequence, all Steps are identical for all locations. Left Hand is shown for illustrative purposes.

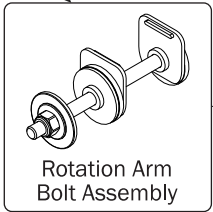
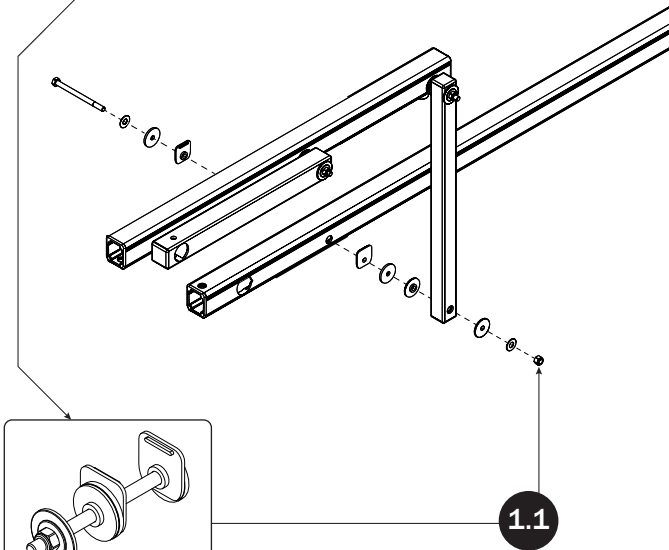

1.1

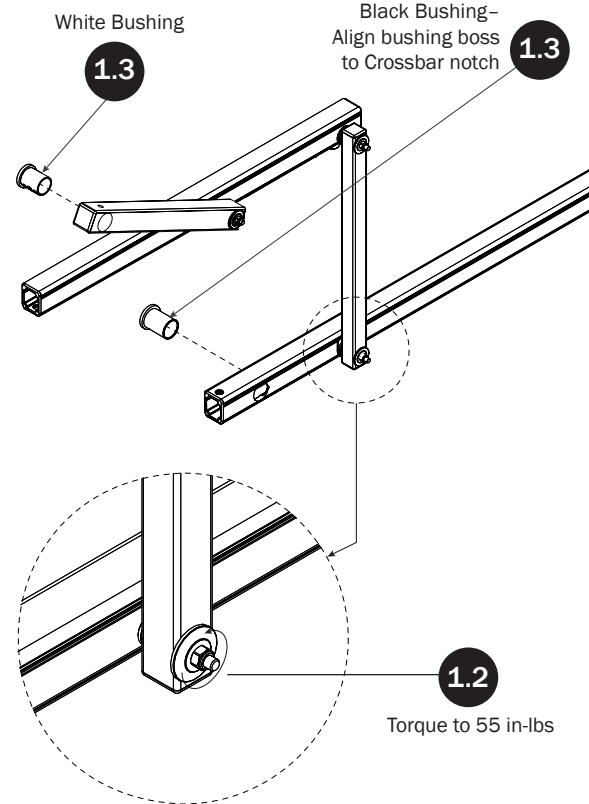

### CONNECTING BARS

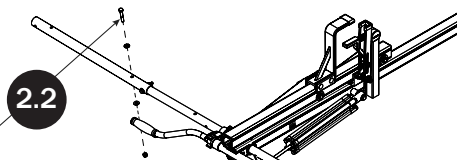
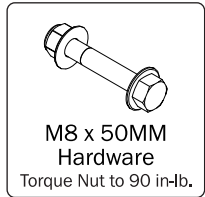
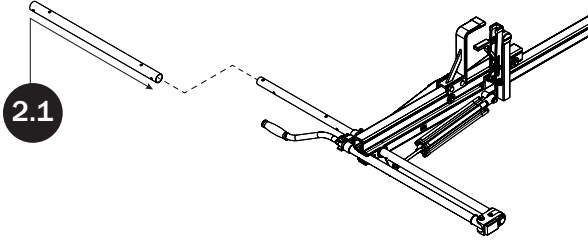

### DRIVE SHAFTS

NOTE: Steps are identical for both Front and Center Drive Shafts.

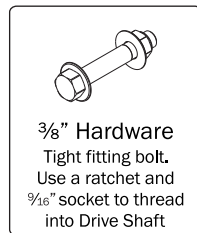
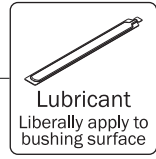
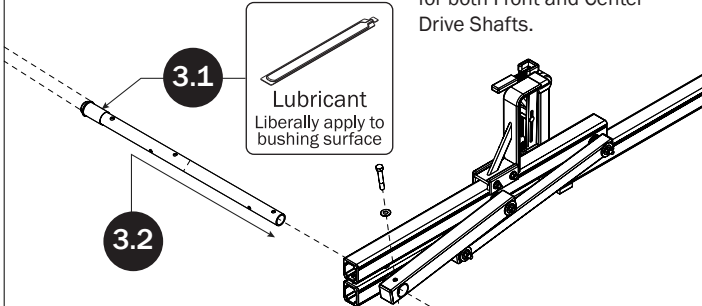

3.3

3.4

Torque to 90 in-lbs

# AUTO CLAMPS, L-POSTS, & Z-POSTS

SEE QUICK START GUIDE FOR ADJUSTMENTS

\*If needed, loosen Hardware and remove the Auto Clamp, L-Post, and Z-Post.

4.1

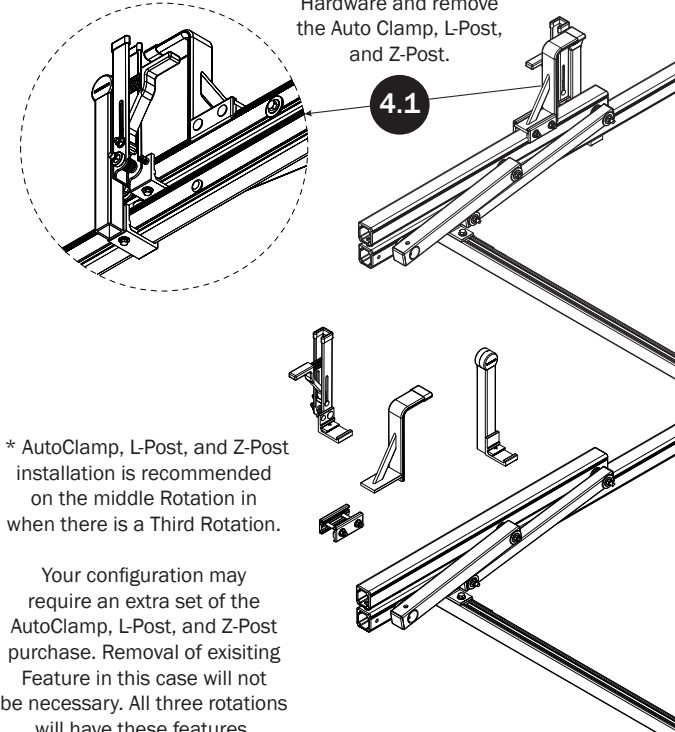

\* AutoClamp, L-Post, and Z-Post installation is recommended on the middle Rotation in when there is a Third Rotation.

Your configuration may require an extra set of the AutoClamp, L-Post, and Z-Post purchase. Removal of existing Feature in this case will not be necessary. All three rotations will have these features.

Mount the AutoClamp as shown to the Rotation Upper.

4.2

Ensure the Auto Clamp Spring is seated into the spring catch

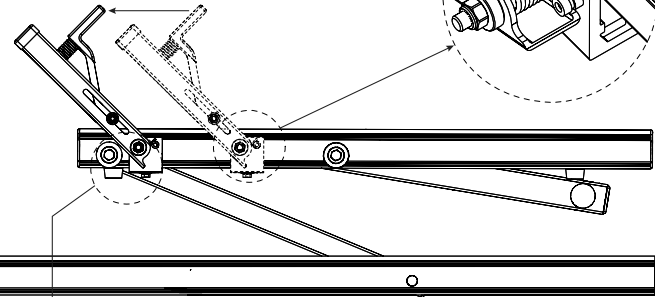

Leave a minimum of 1/4" distance from the rubber bumper to the edge of the Auto Clamp Bracket as shown, then finger-tighten if adjusting later, or torque to 80 in-lbs.

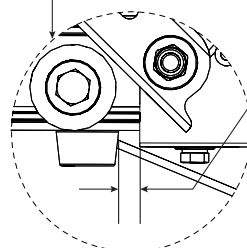

4.3 Place an L Post into the bottom groove of the Rear Crossbar

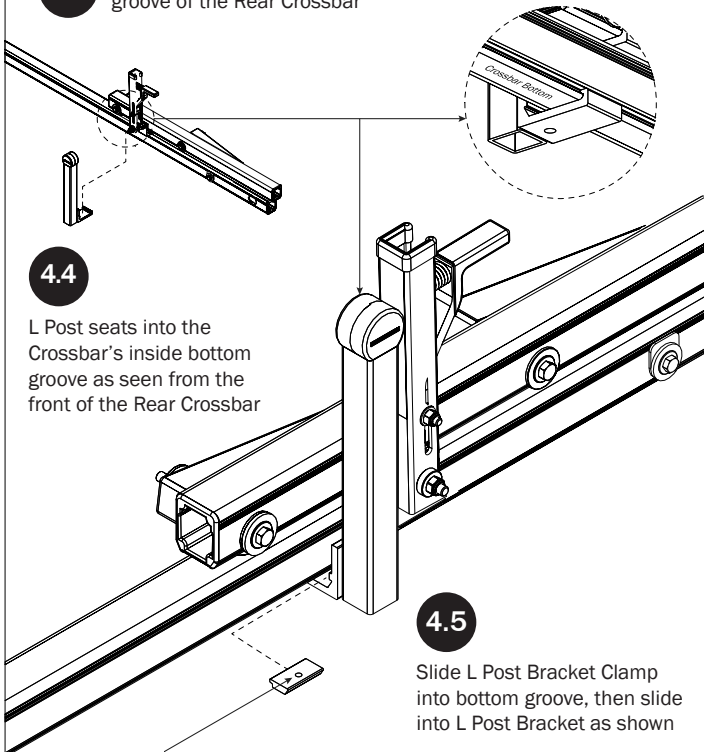

4.4

L Post seats into the Crossbar's inside bottom groove as seen from the front of the Rear Crossbar

4.5

Slide L Post Bracket Clamp into bottom groove, then slide into L Post Bracket as shown

**Note:** The orientation of the bolt hole faces away from the Crossbar

4.6

Bracket Clamp sits in L Post Bracket as shown

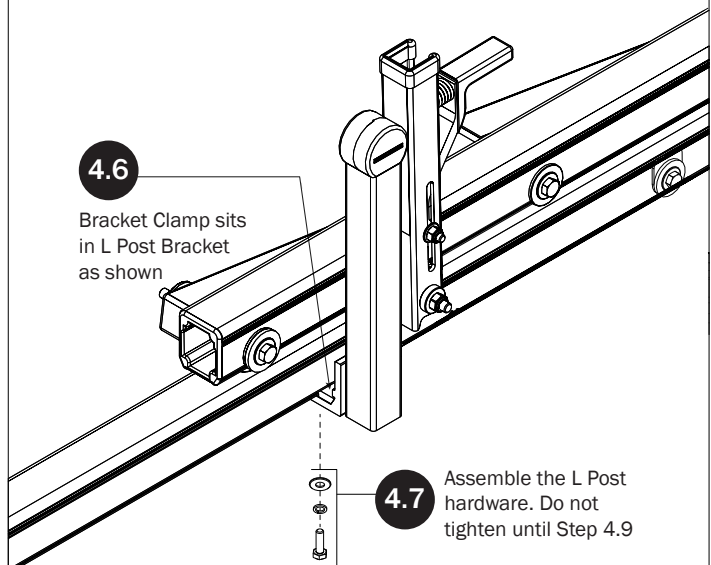

4.7

Assemble the L Post hardware. Do not tighten until Step 4.9



