

PRIME DESIGN™

A Safe Fleet Brand

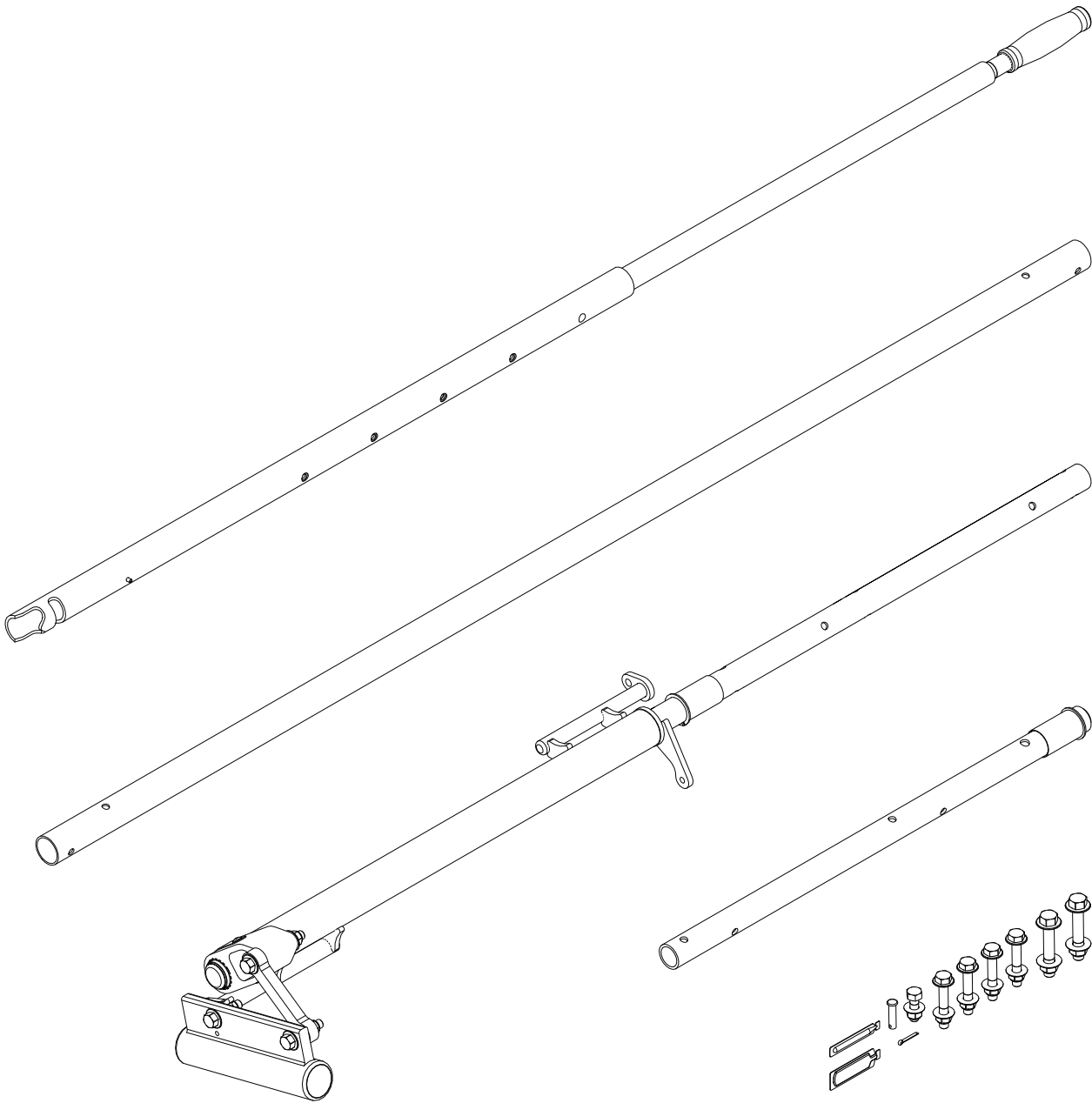

LEFT SIDE DRIVE SHAFT KIT, HIGH ROOF

PRIME DESIGN, A SAFE FLEET BRAND

Address: 580 Opperman Drive, Eagan, MN 55123 • Toll Free: 1.8.PRIME.RACK

Fax: 651-552-1799 • Email: info@primedesign.net • Website: www.primedesign.net

FEA 0020

CONTENTS OVERVIEW

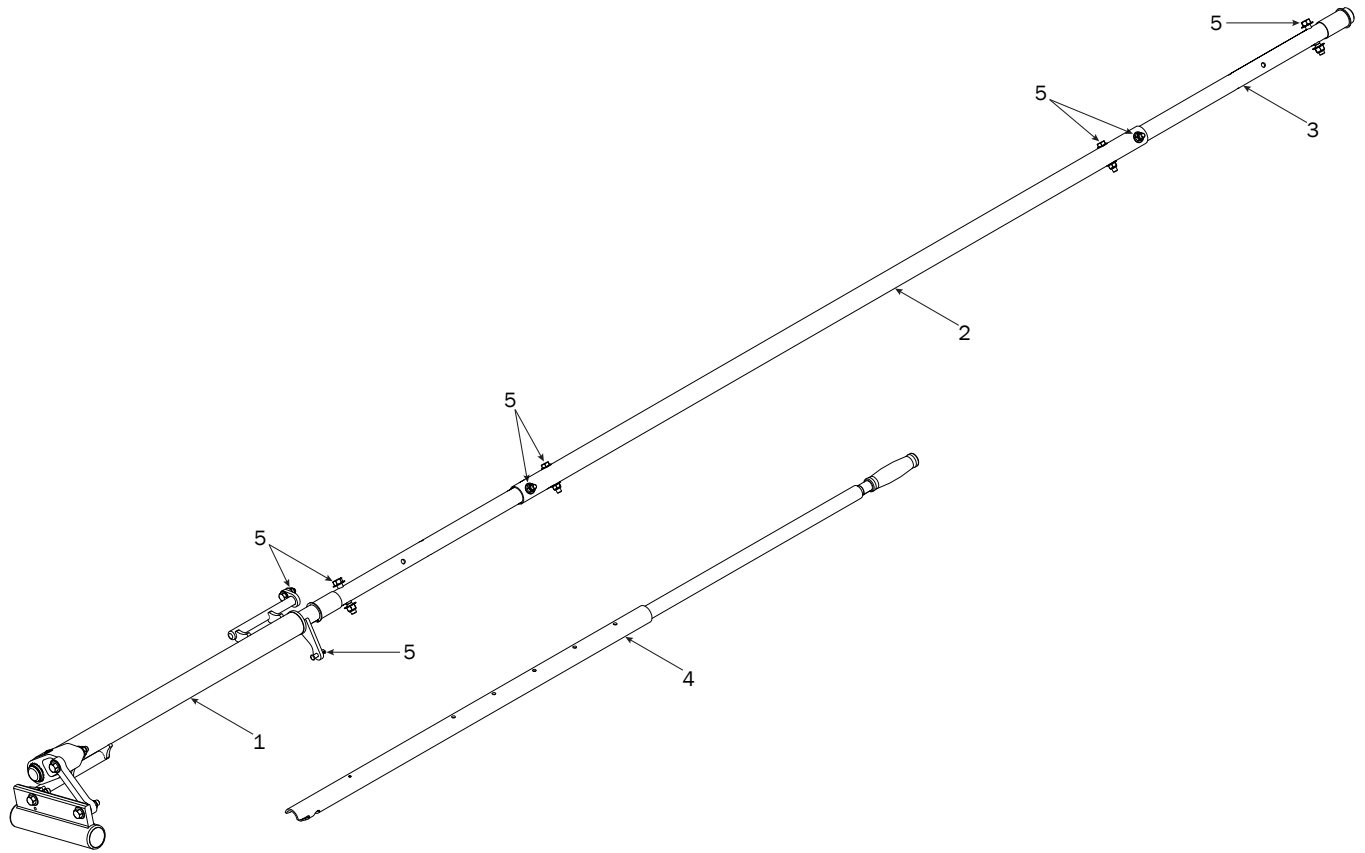

1—Drive Shaft (Qty 1)
Rear, Left Hand, 50.00"

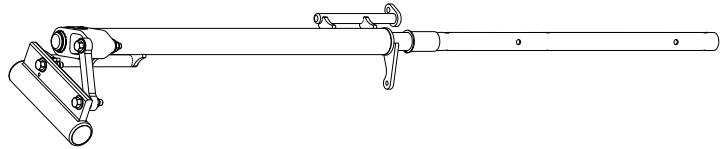

2—Connecting Bar (Qty 1)
60.00"

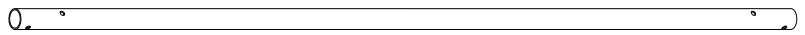

3—Front Drive Shaft (Qty 1)
B Version, 23.75"

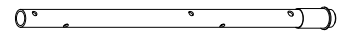

4—HRR Handle Assembly (Qty 1)
Removable, 35.00"



5—HKT-8163..... (Qty 1)
 Modular High Roof Rotation Hardware Kit



Cotter Pin (1X)

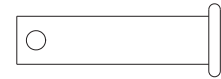

Clevis Pin (1X)

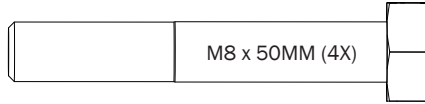

M8 x 50MM (4X)

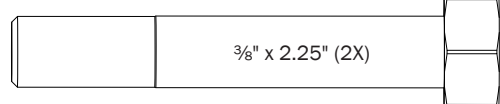

3/8" x 2.25" (2X)

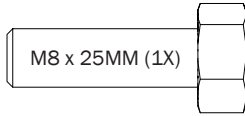

M8 x 25MM (1X)



M8 Lock Nut (5X)

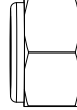

3/8" Lock Nut (2X)

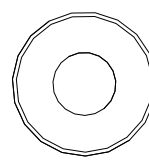

5/16" Flat Washer (10X)

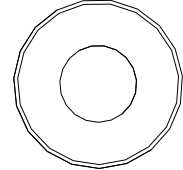

3/8" Flat Washer (4X)

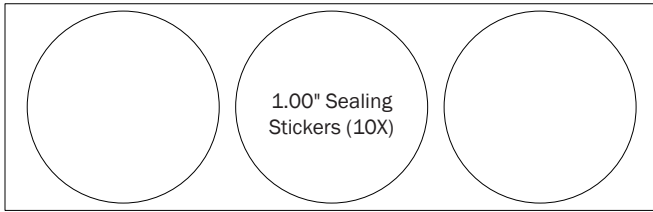

1.00" Sealing
 Stickers (10X)



Anti-Seize (1X)

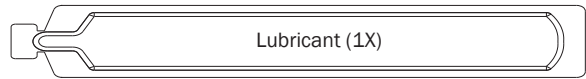

Lubricant (1X)

**LEFT DRIVE SHAFT
ASSEMBLY SEQUENCE**



NOTE: Crossbars and LH Rotation feature are shown for illustrative purposes only. Crossbars and Rotations are not included with this Drive Shaft feature, and must be purchased separately.

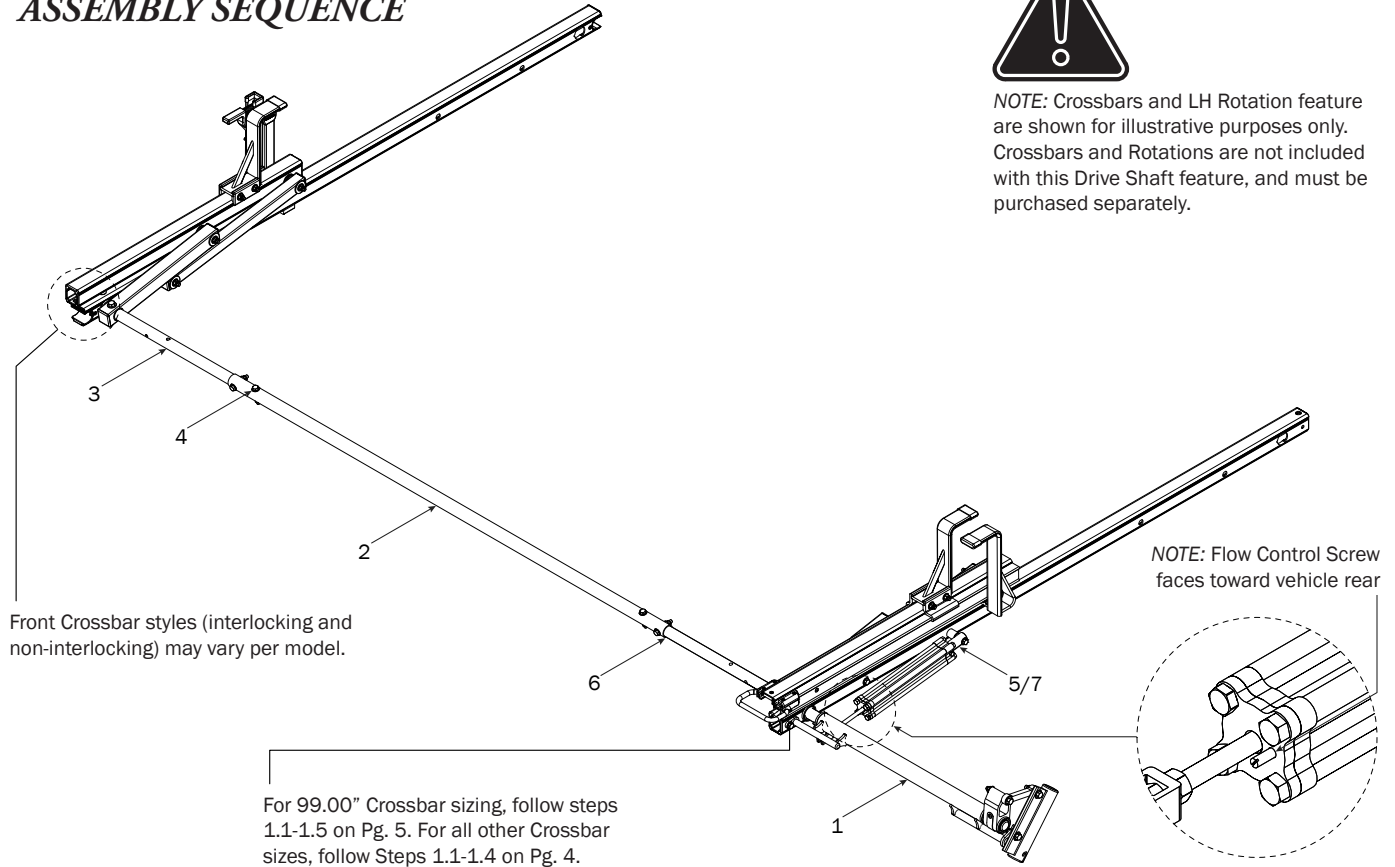

**REAR DRIVE SHAFT
EXCEPT 99.00" CROSSBAR SIZING**

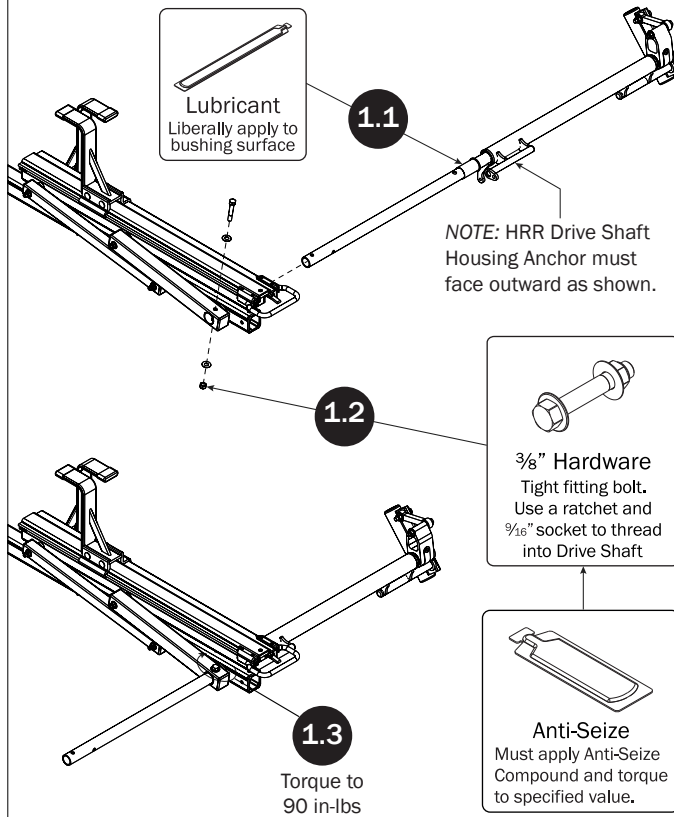

1.4 Attach HHR Housing Anchor to Rear Crossbar using indicated hardware.

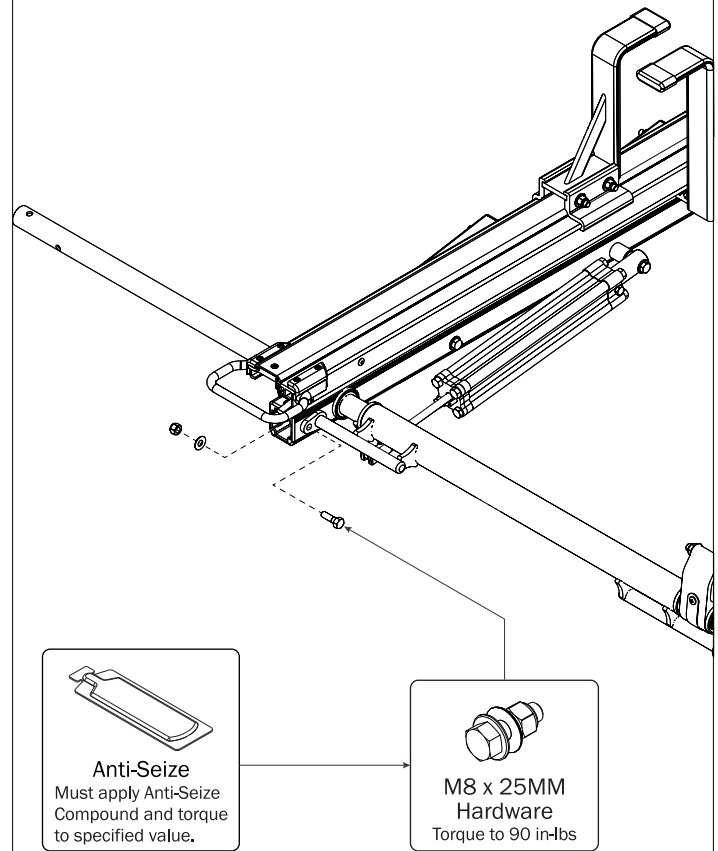

**REAR DRIVE SHAFT:
99.00" CROSSBAR SIZING ONLY**

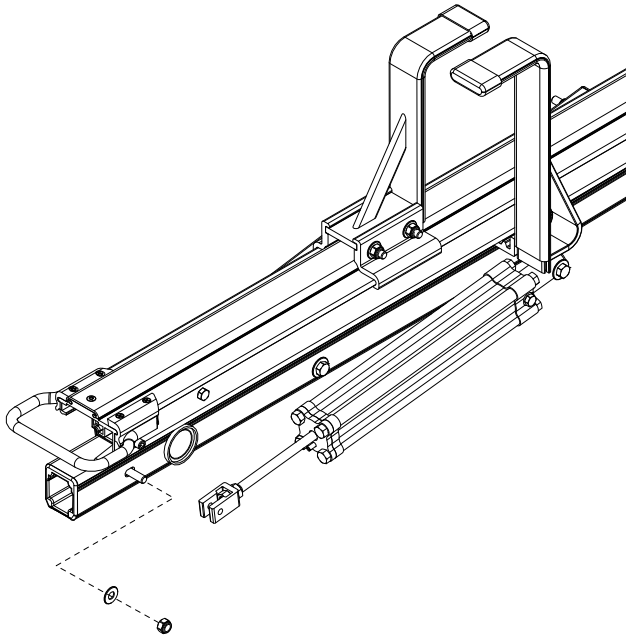

1.1 Remove and save washer and locknut before installing Rear Driveshaft.

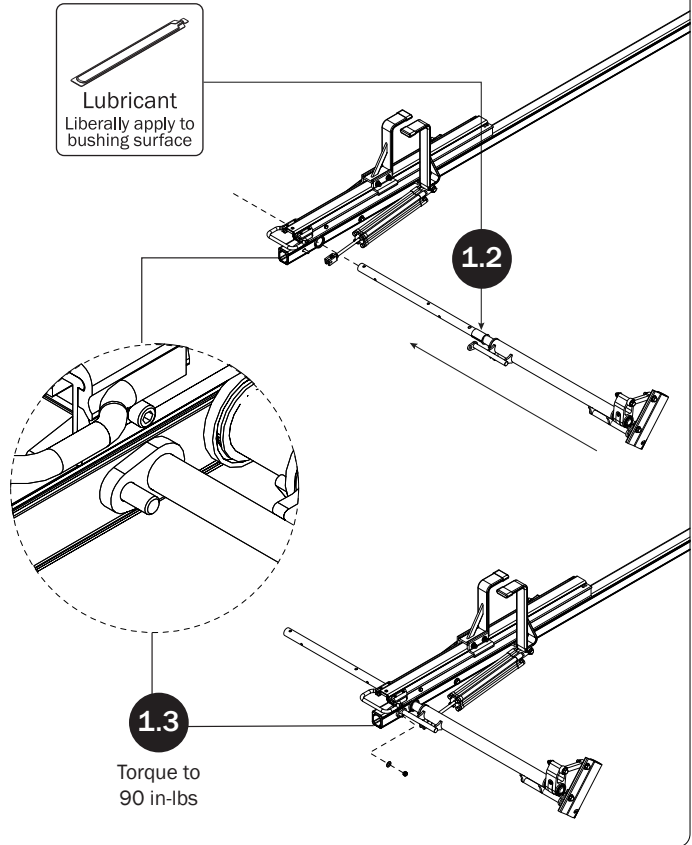

Lubricant
Liberally apply to bushing surface

1.2

1.3

Torque to 90 in-lbs

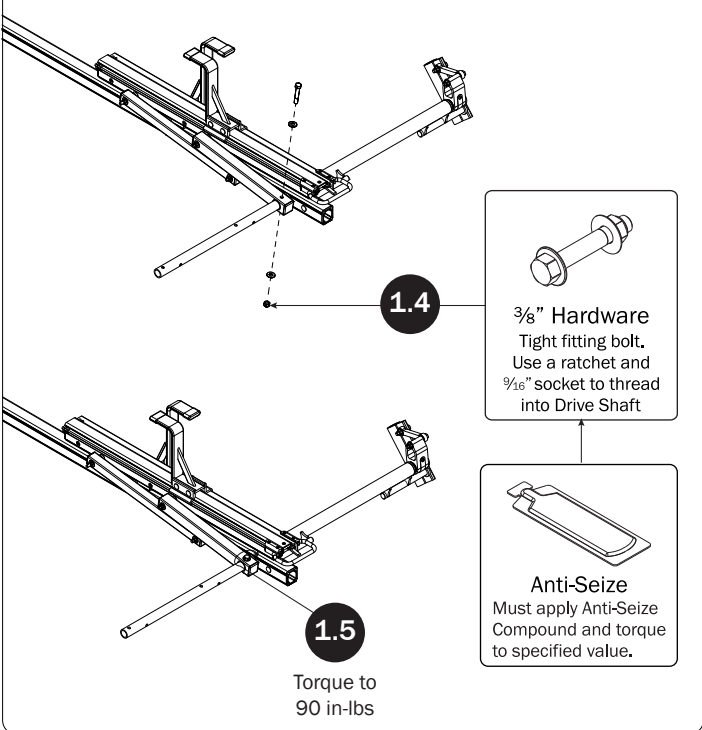

1.4

3/8" Hardware
Tight fitting bolt.
Use a ratchet and 3/16" socket to thread into Drive Shaft

1.5

Anti-Seize
Must apply Anti-Seize Compound and torque to specified value.

Torque to 90 in-lbs

CONNECTING BAR VARIATIONS

Distance D	Connect A to:	Connect B to:
6 ft (72")	A2	B2
7 ft (84")	A1	B2
8 ft (96")	A1	B1

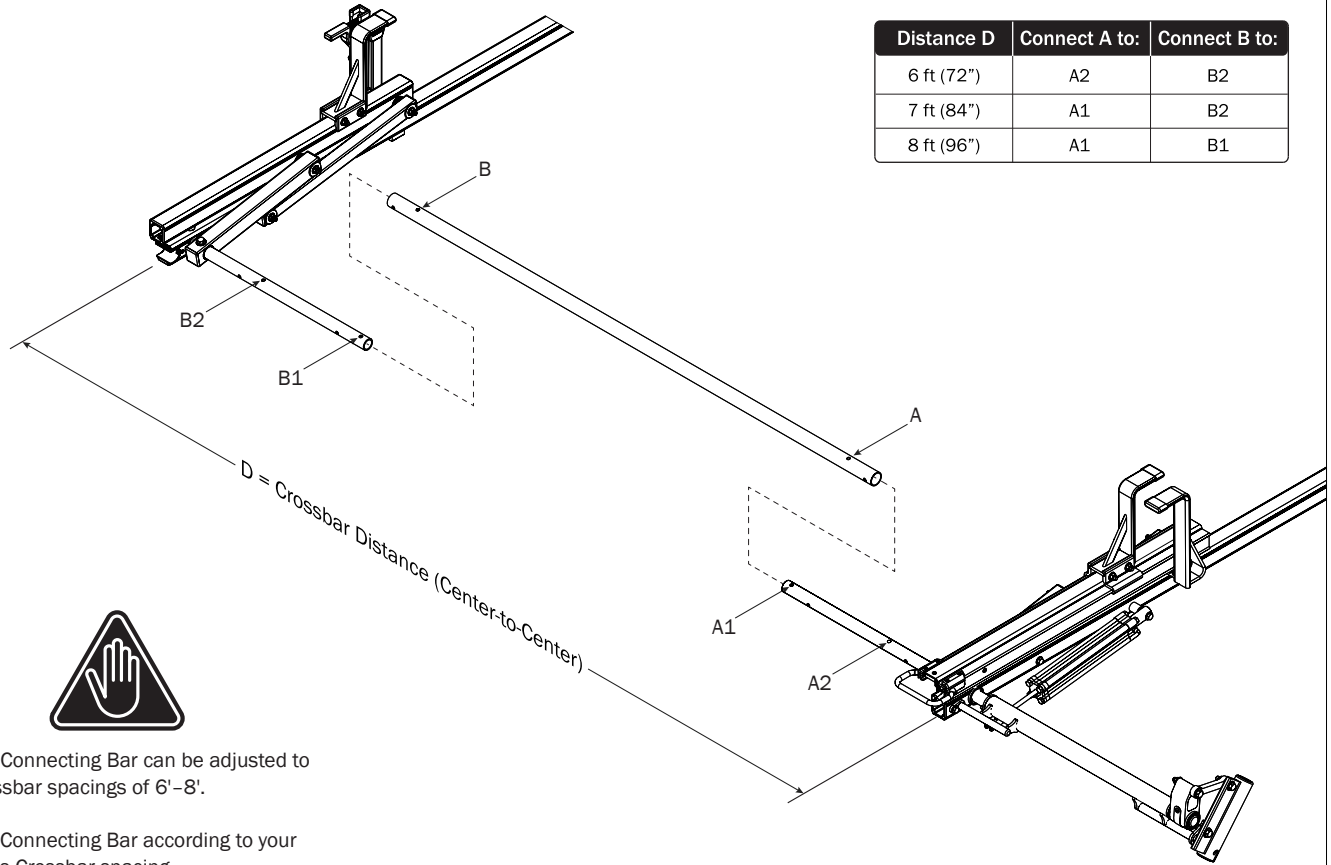

The 5' Connecting Bar can be adjusted to fit Crossbar spacings of 6'-8'.

Install Connecting Bar according to your model's Crossbar spacing.

CONNECTING BAR

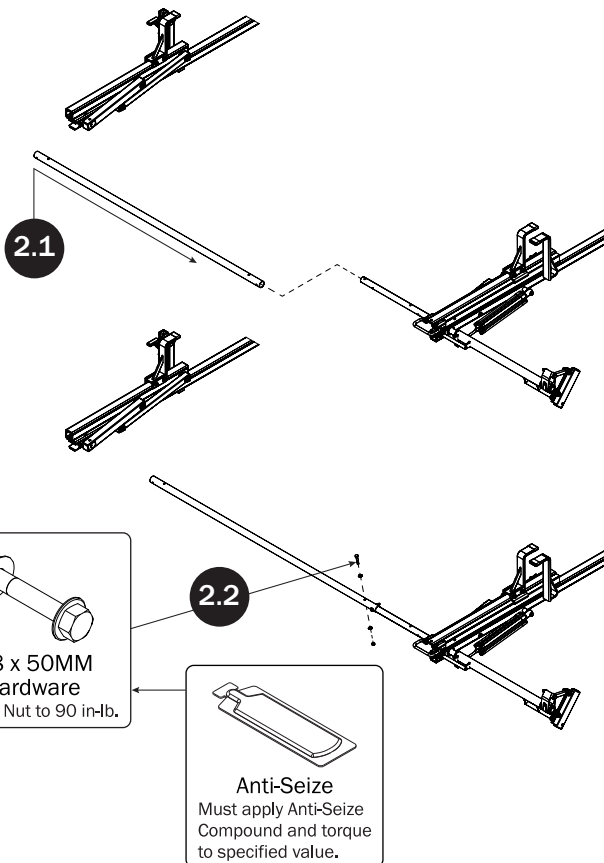

FRONT DRIVE SHAFT

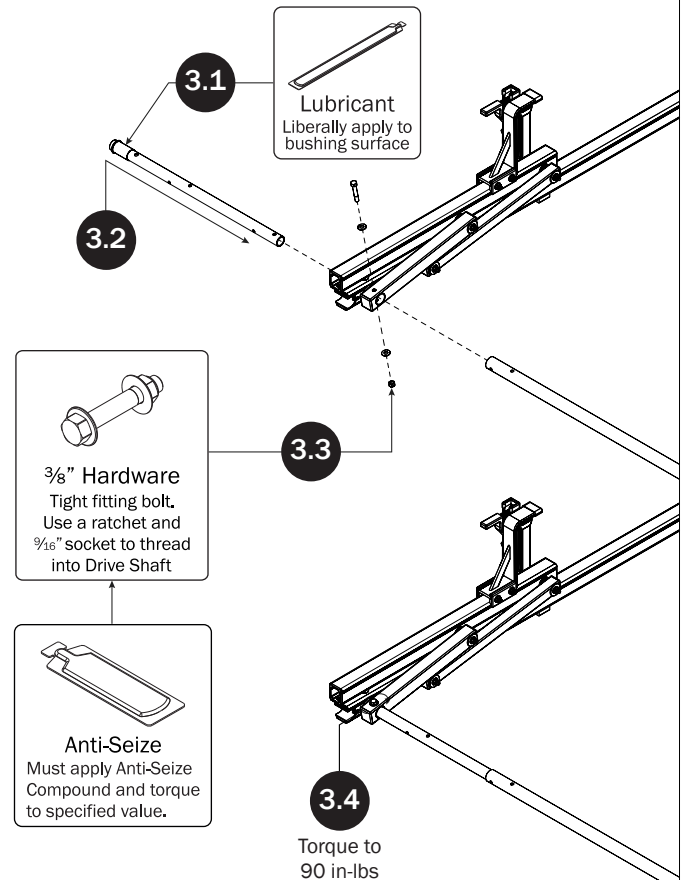

CONNECTING BAR FASTENERS

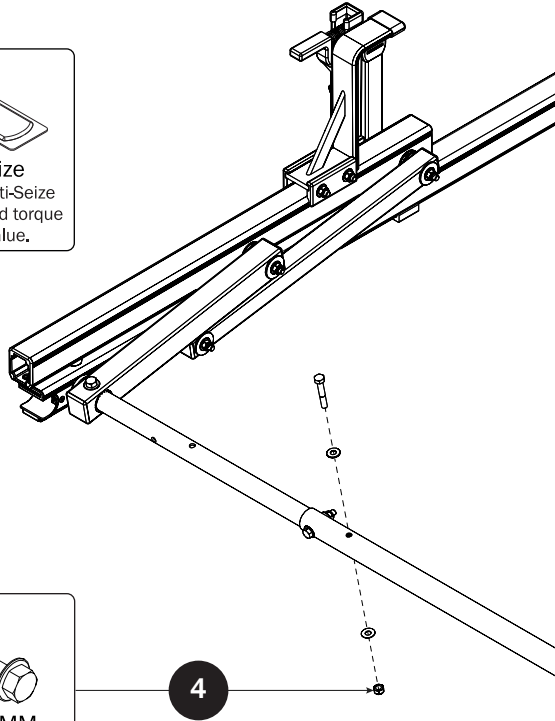
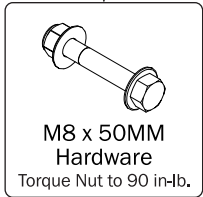

4

CYLINDER HARDWARE

5.2



5.1

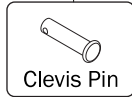

NOTE: Loosen the Cylinder Flow Control Screw (Fig. C) as needed to allow movement for Steps 5.1-5.2.
When finished with Cylinder Hardware, tighten the Flow control Screw all the way closed then turn back open 1½ turn.

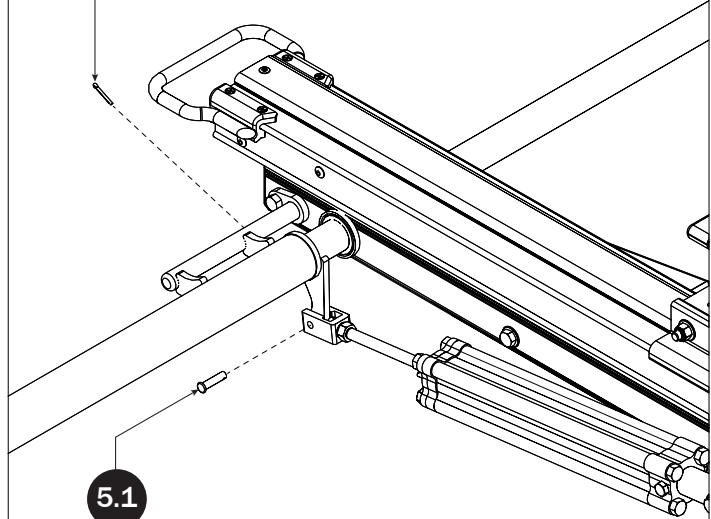

DRIVE SHAFT SEALING

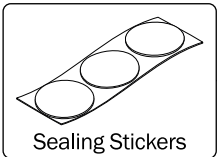

6.1

6.2

Apply Silicone Sealant (not supplied) to ends of Connecting Bar

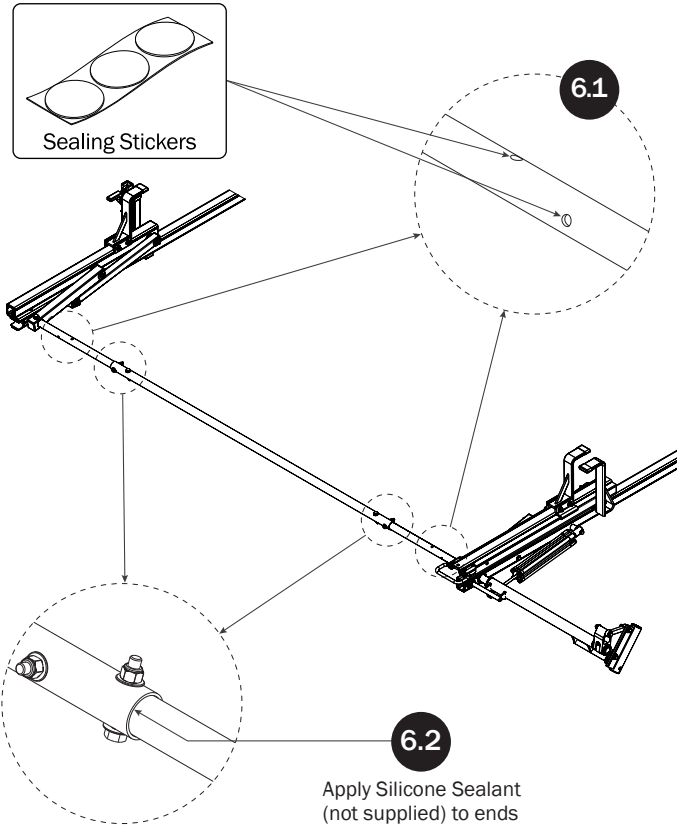

CYLINDER ADJUSTMENT

7

Adjust the Cylinder Flow Control Screw to allow approximately 3 seconds time for the ladder to glide down when operating the loaded Ladder Rack.

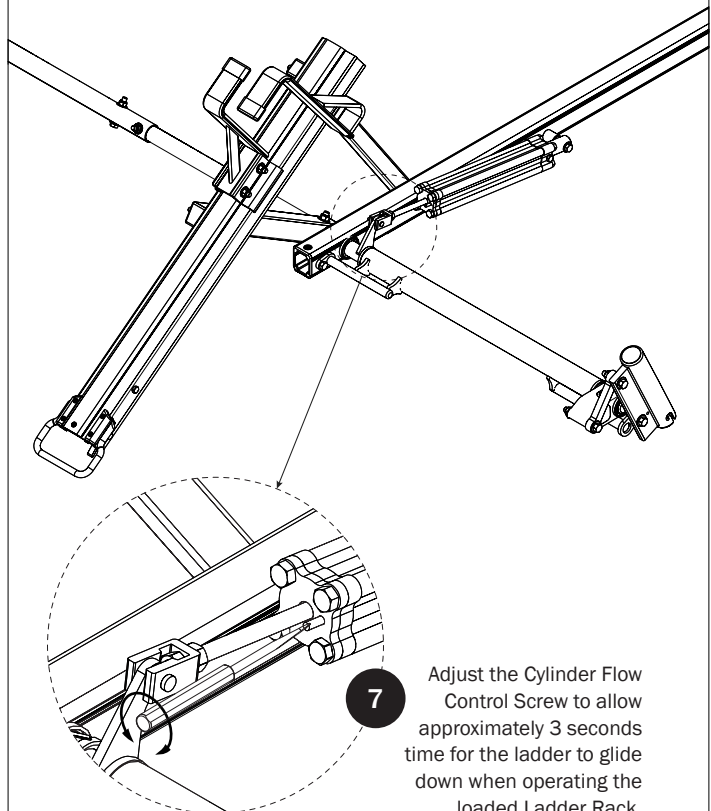

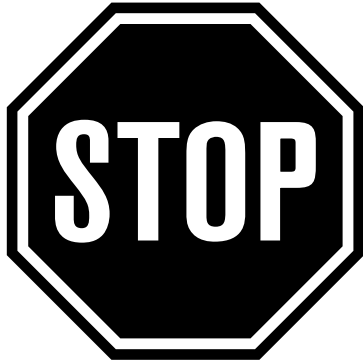

NOTE: This completes the left hand assembling of FEA-0020.
For right side Drive Shaft assembly procedures, see FEA-0019
Assembly Manual.

If applicable, refer to your next FEA Assembly Manual.

If completed, refer back to your FBM Assembly Manual, and
resume assembling at Step 3.1.

WARNING: Failure to position the Crossbars as shown in your
FBM Assembly Manual may result in damage to the sliding
door and/or ladder rack.