

PRIME DESIGN™

A Safe Fleet Brand

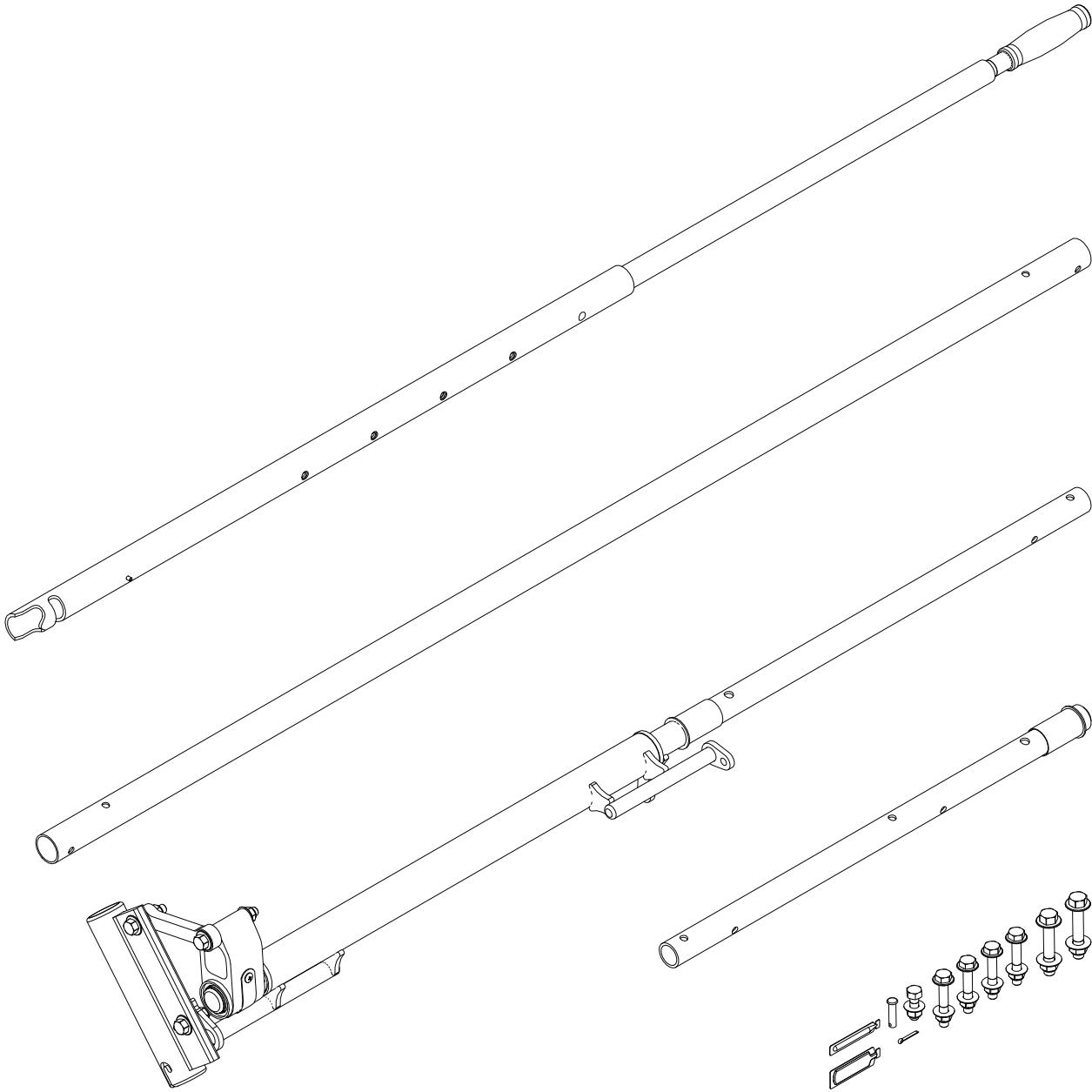

RIGHT SIDE DRIVE SHAFT KIT, HIGH ROOF

PRIME DESIGN, A SAFE FLEET BRAND

Address: 580 Opperman Drive, Eagan, MN 55123 • Toll Free: 1.8.PRIME.RACK

Fax: 651-552-1799 • Email: info@primedesign.net • Website: www.primedesign.net

SAFE FLEET

CONTENTS OVERVIEW

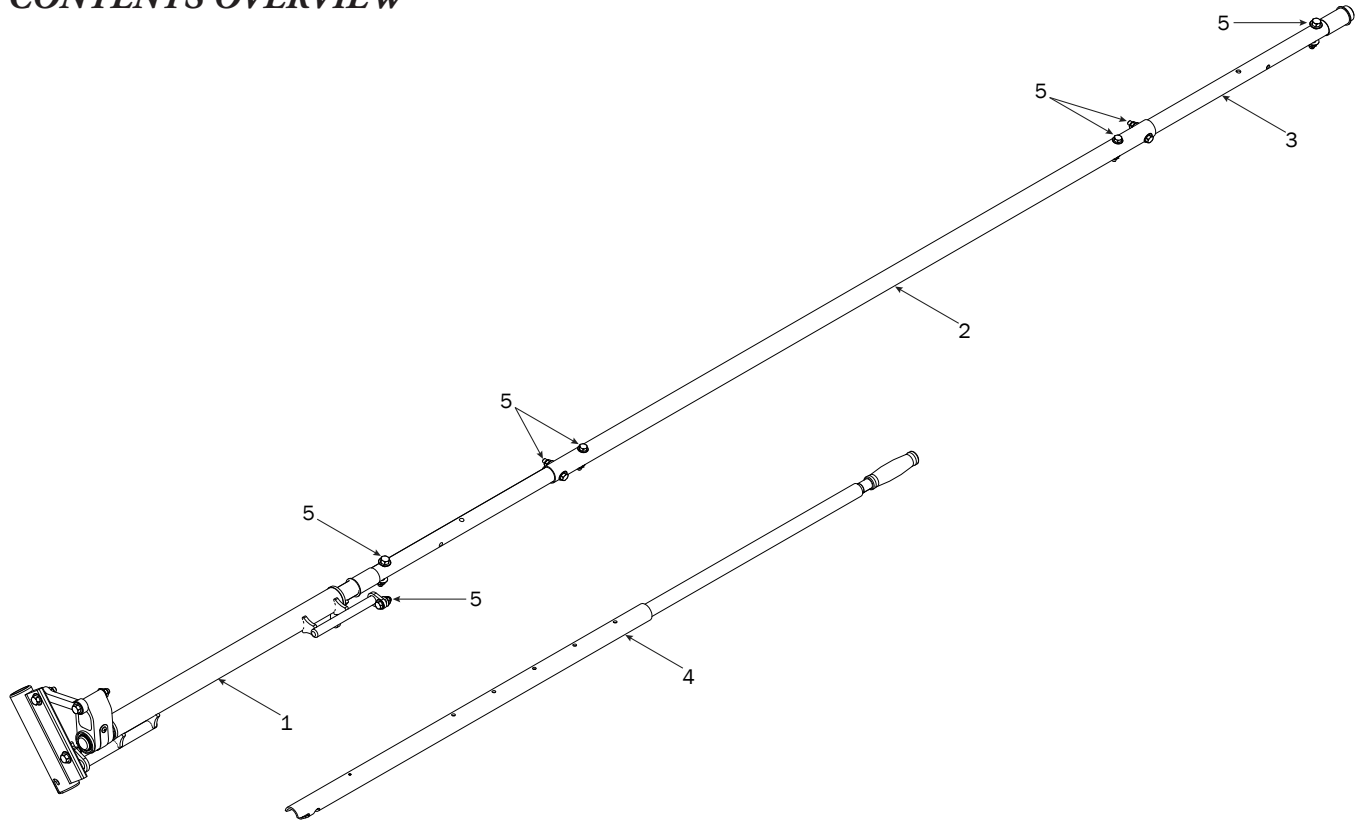

1—Drive Shaft (Qty 1)
Rear, Right Hand, 50.00"

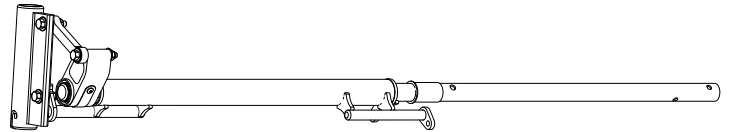

2—Connecting Bar (Qty 1)
60.00"

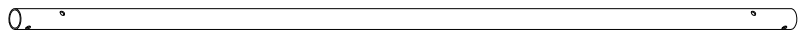

3—Front Drive Shaft (Qty 1)
B Version, 23.75"

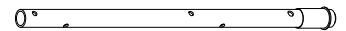

4—HRR Handle Assembly (Qty 1)
Removable, 35.00"



5—HKT-8163..... (Qty 1)
Modular High Roof Rotation Hardware Kit

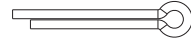

Cotter Pin (1X)

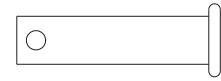

Clevis Pin (1X)

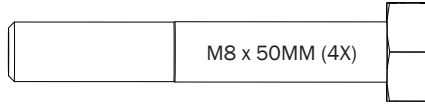

M8 x 50MM (4X)

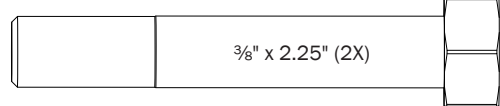

3/8" x 2.25" (2X)

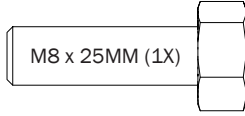

M8 x 25MM (1X)



M8 Lock Nut (5X)

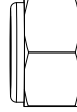

3/8" Lock Nut (2X)

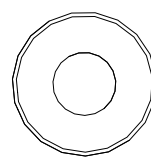

5/16" Flat Washer (10X)

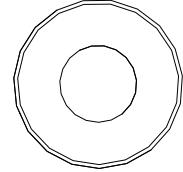

3/8" Flat Washer (4X)

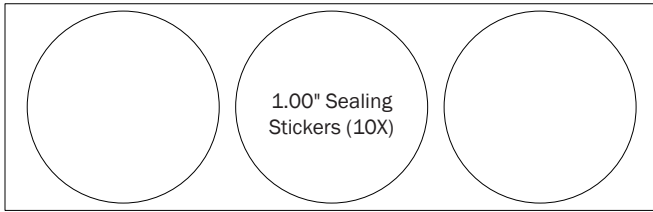

1.00" Sealing
Stickers (10X)



Anti-Seize (1X)

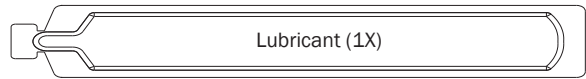

Lubricant (1X)

RIGHT DRIVE SHAFT ASSEMBLY SEQUENCE



NOTE: Crossbars and RH Rotation feature are shown for illustrative purposes only. Crossbars and Rotations are not included with this Drive Shaft feature, and must be purchased separately.

NOTE: Flow Control Screw faces toward vehicle rear

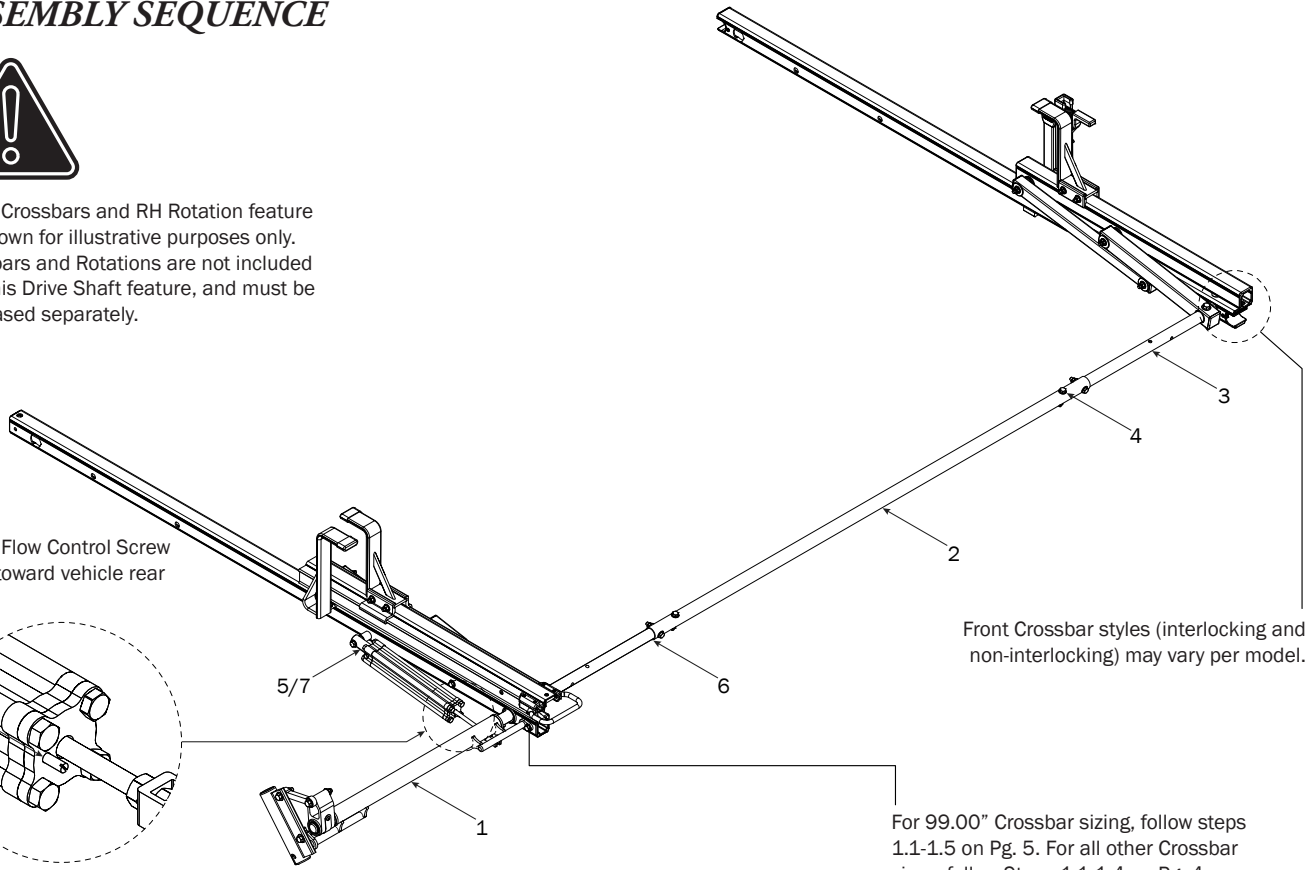
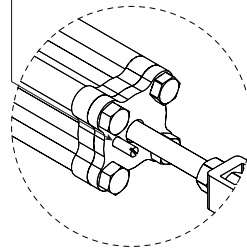

For 99.00" Crossbar sizing, follow steps 1.1-1.5 on Pg. 5. For all other Crossbar sizes, follow Steps 1.1-1.4 on Pg. 4.

REAR DRIVE SHAFT EXCEPT 99.00" CROSSBAR SIZING

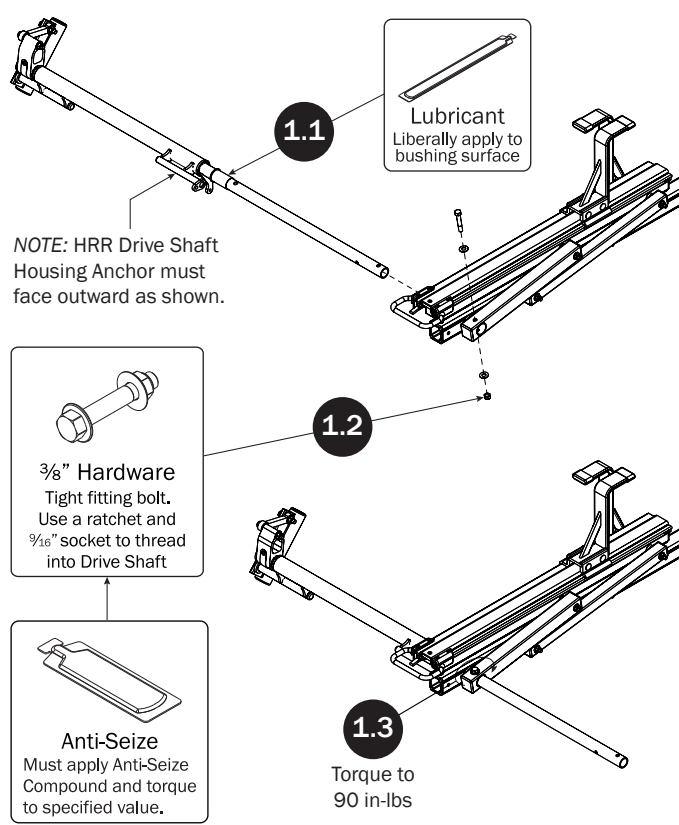

NOTE: HRR Drive Shaft Housing Anchor must face outward as shown.

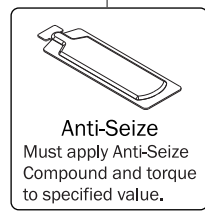
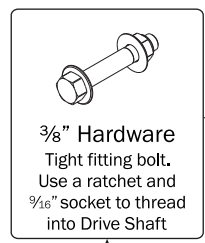

1.4 Attach HHR Housing Anchor to Rear Crossbar using indicated hardware.

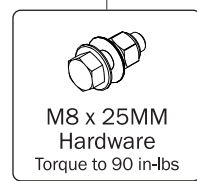
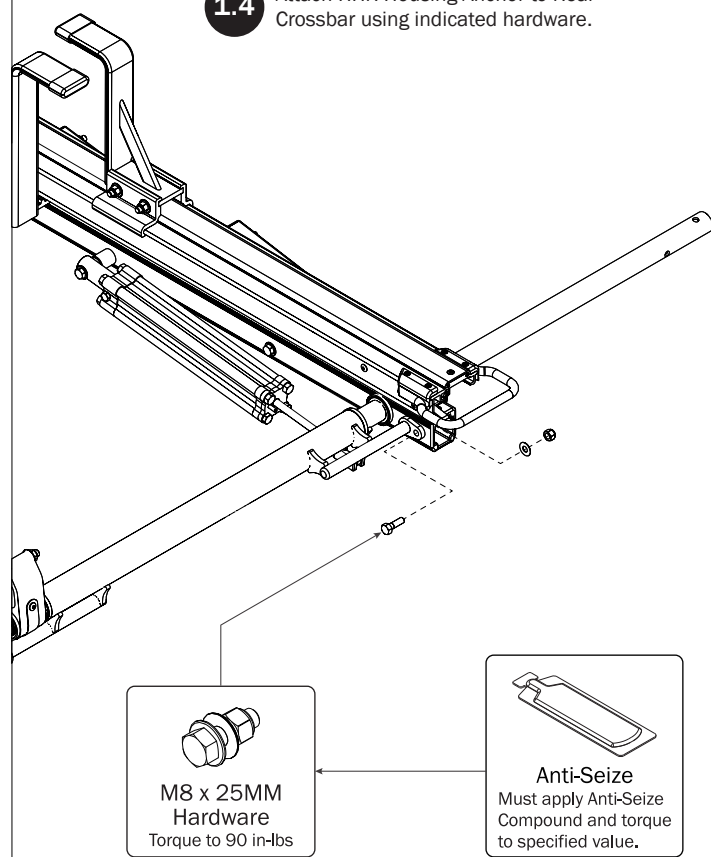

**REAR DRIVE SHAFT:
99.00" CROSSBAR SIZING ONLY**

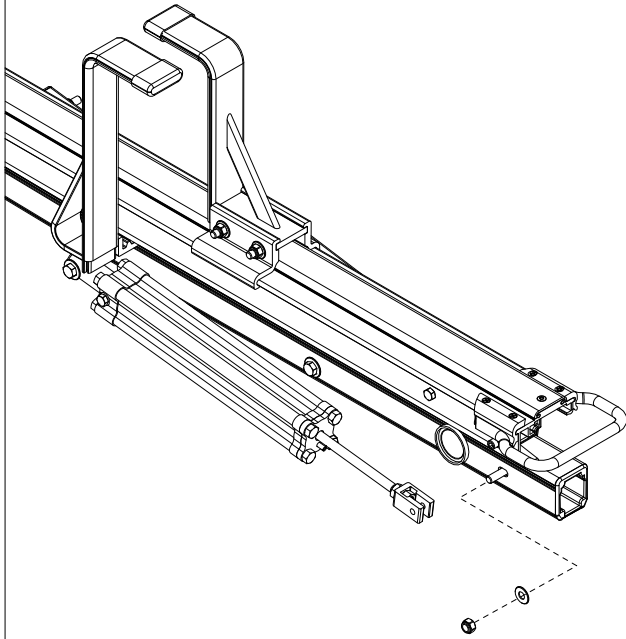

1.1 Remove and save washer and locknut before installing Rear Driveshaft.

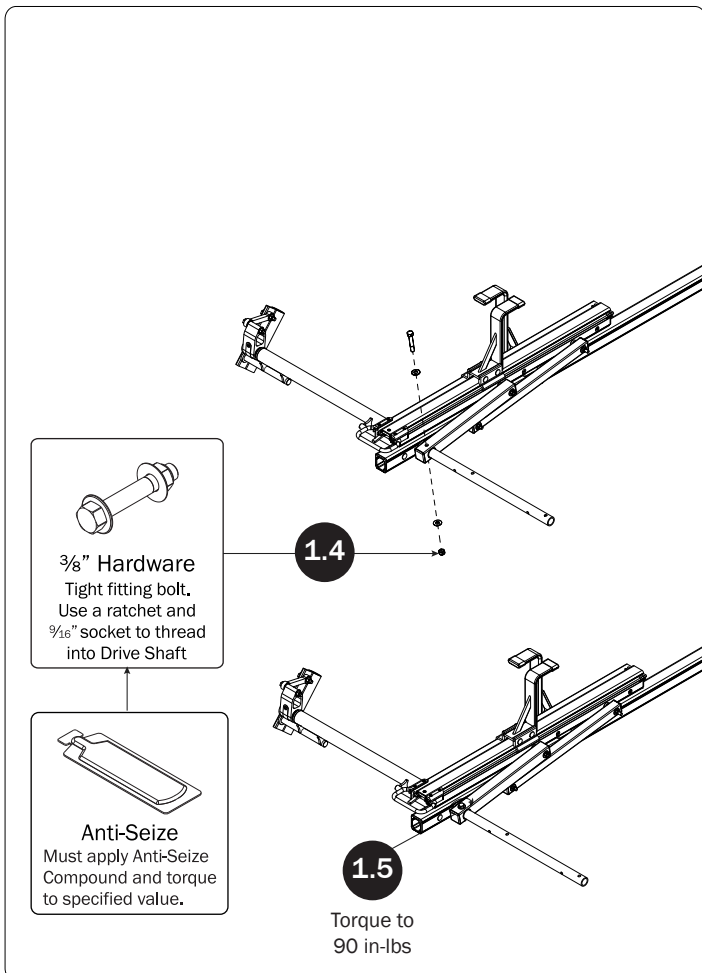
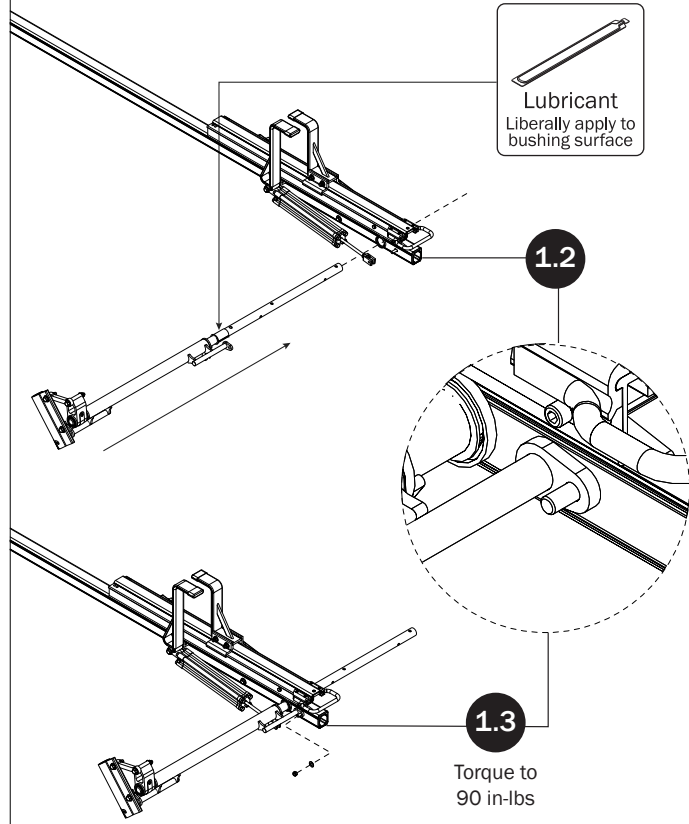

CONNECTING BAR VARIATIONS

| Distance D | Connect A to: | Connect B to: |
|------------|---------------|---------------|
| 6 ft (72") | A2 | B2 |
| 7 ft (84") | A1 | B2 |
| 8 ft (96") | A1 | B1 |

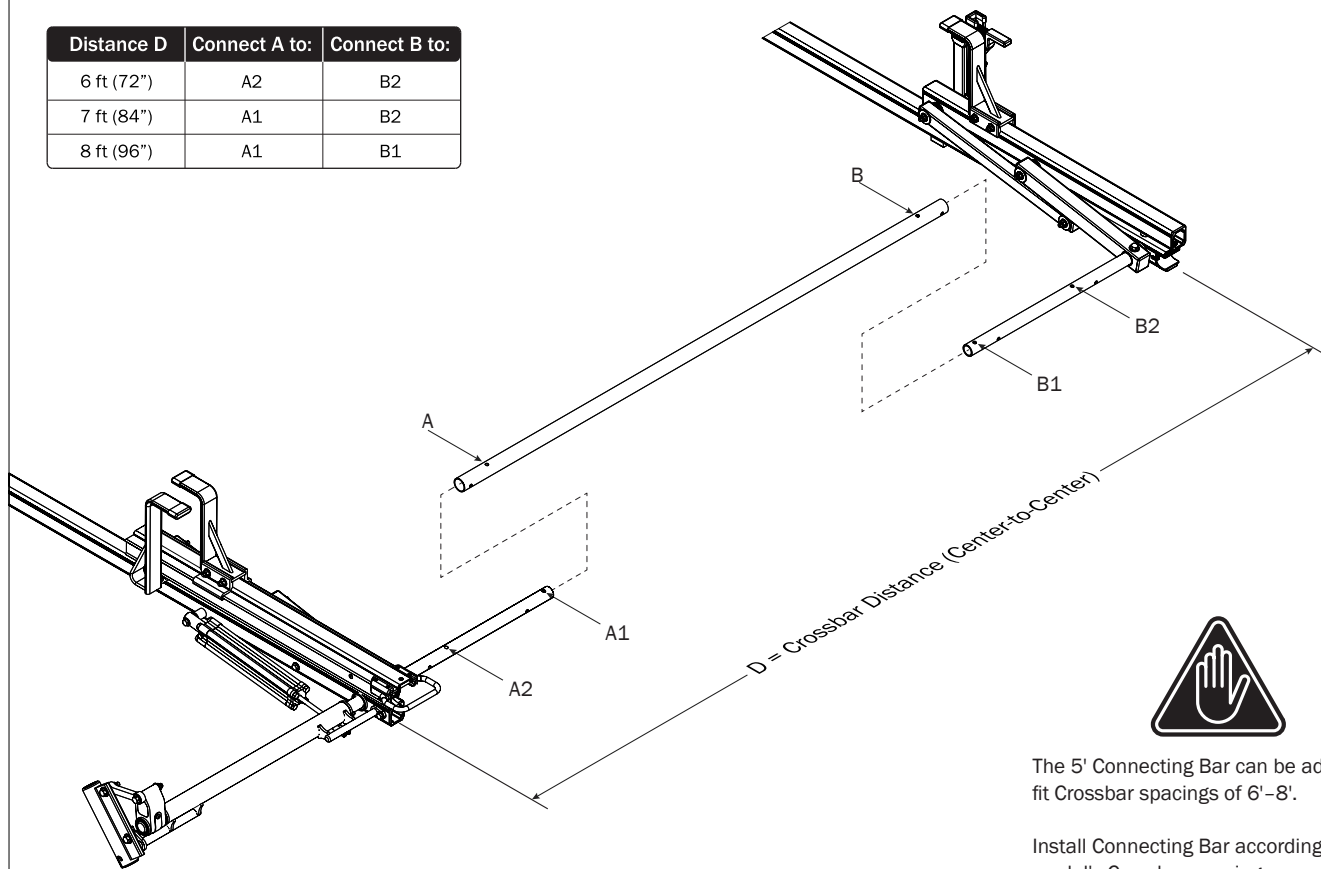

The 5' Connecting Bar can be adjusted to fit Crossbar spacings of 6'-8'.

Install Connecting Bar according to your model's Crossbar spacing.

CONNECTING BAR

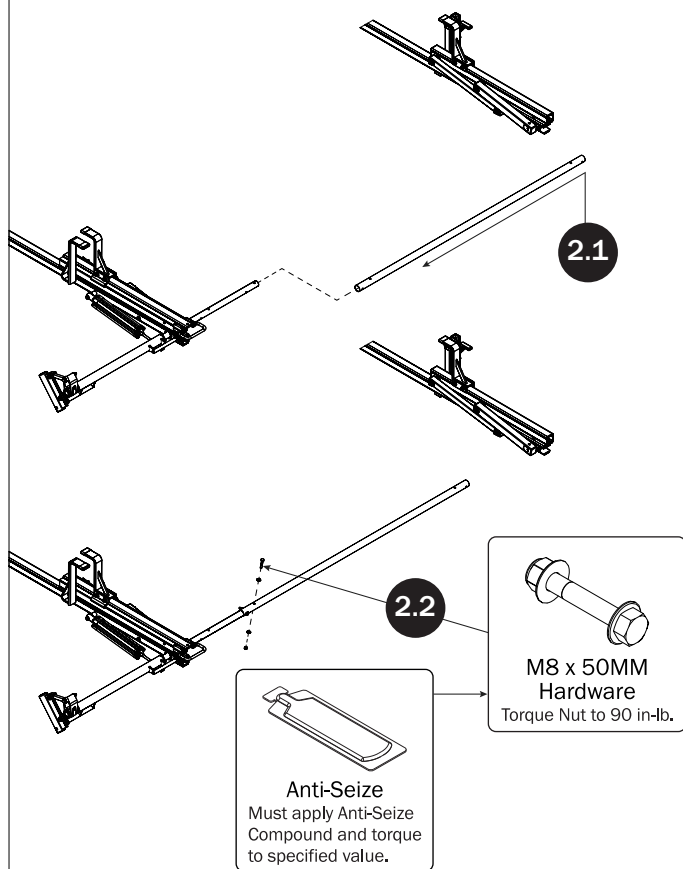

FRONT DRIVE SHAFT

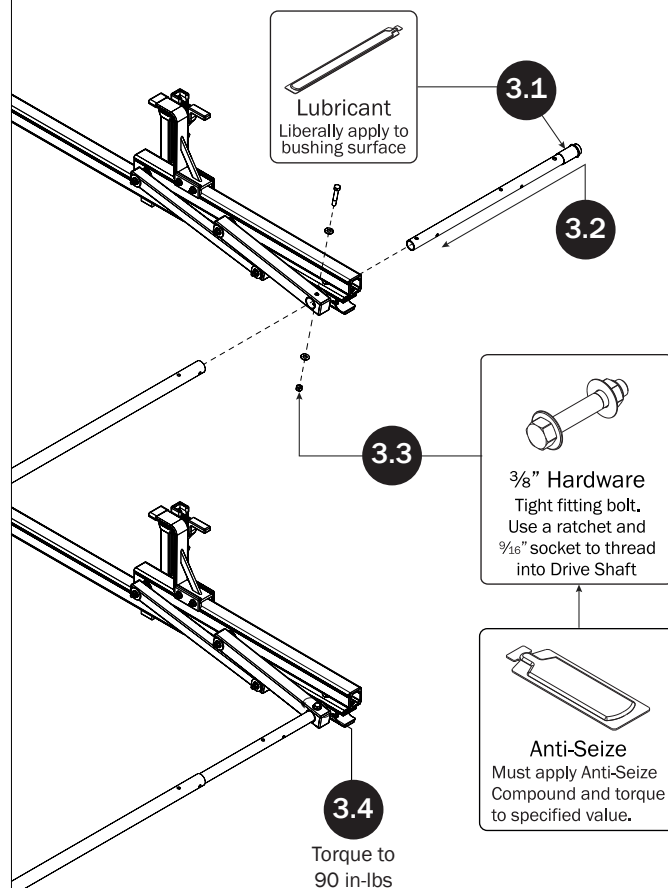

CONNECTING BAR FASTENERS

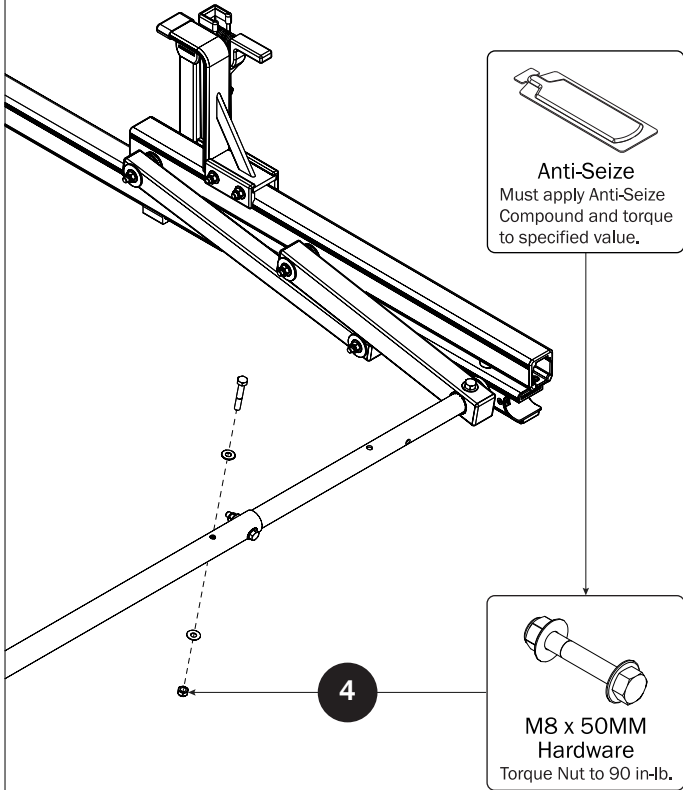

CYLINDER HARDWARE

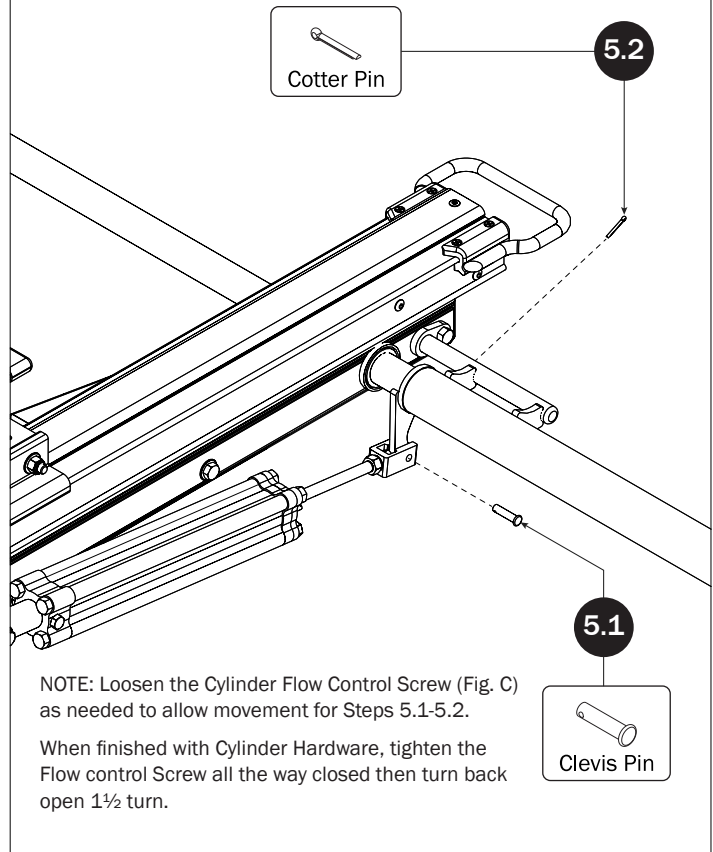

DRIVE SHAFT SEALING

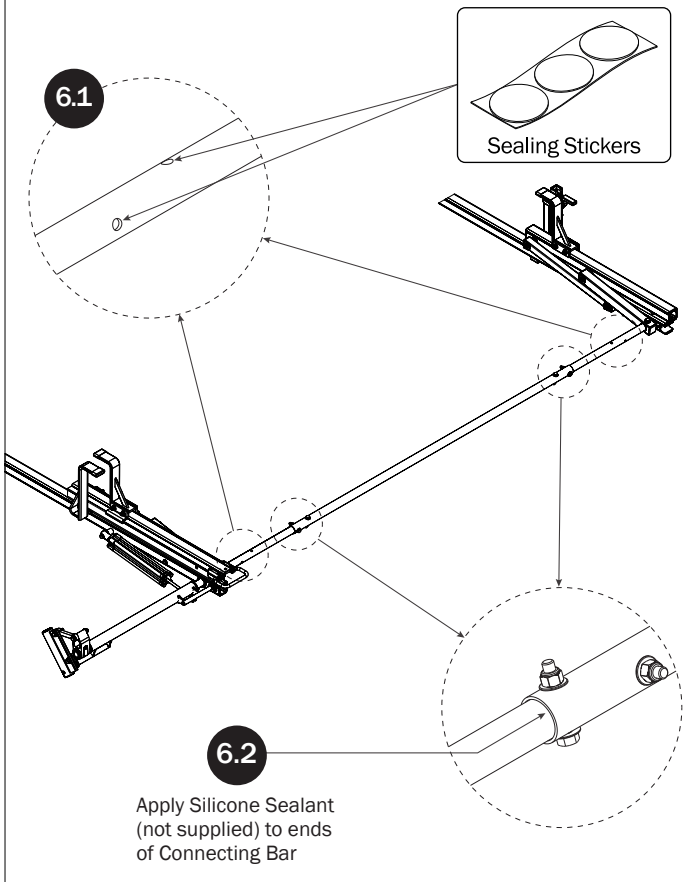

CYLINDER ADJUSTMENT

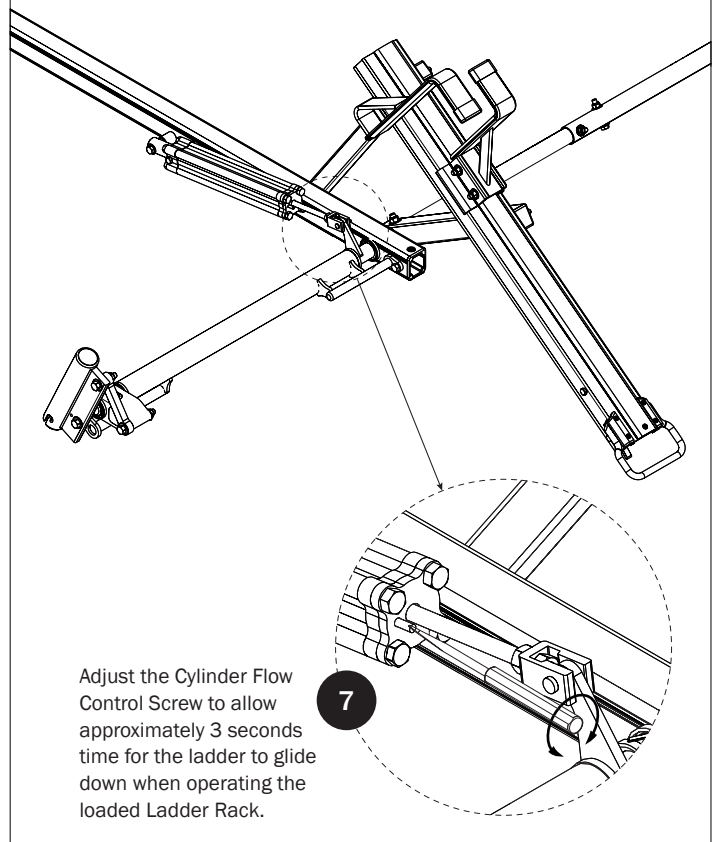



NOTE: This completes the right hand assembling of FEA-0019. For left side Drive Shaft assembly procedures, see FEA-0020 Assembly Manual.

If applicable, refer to your next FEA Assembly Manual.

If completed, refer back to your FBM Assembly Manual, and resume assembling at Step 3.1.

WARNING: Failure to position the Crossbars as shown in your FBM Assembly Manual may result in damage to the sliding door and/or ladder rack.

USAM-FEA0019-US01 Rev-B 0320