

PRIME DESIGN™

A Safe Fleet Brand

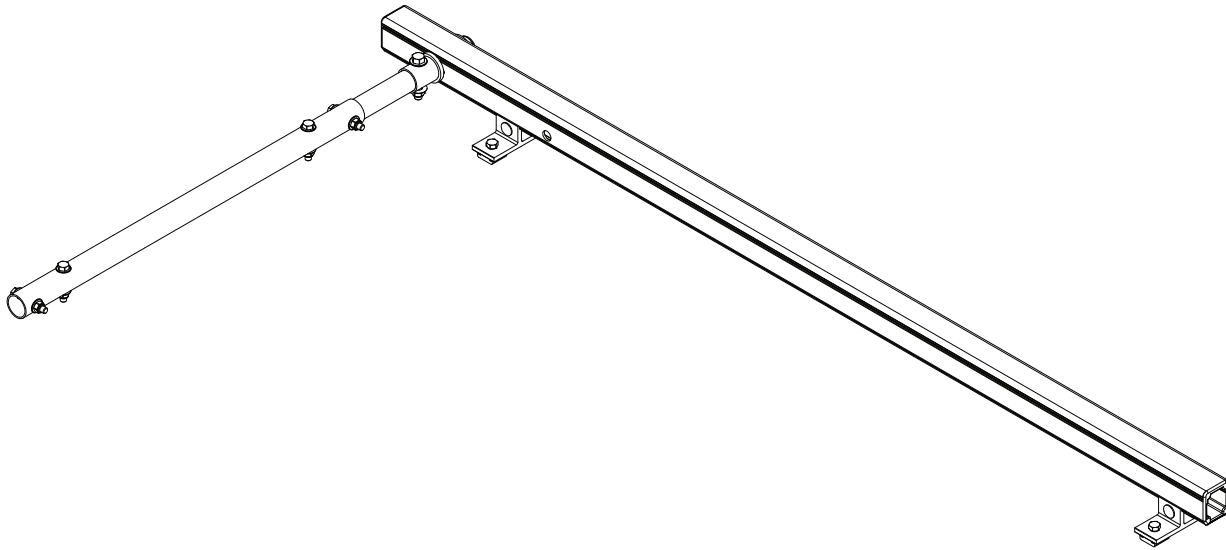

PRIME DESIGN, A SAFE FLEET BRAND

Address: 580 Opperman Drive, Eagan, MN 55123 • Toll Free: 1.8.PRIME.RACK

Fax: 651-552-1799 • Email: info@primedesign.net • Website: www.primedesign.net

CONTENTS OVERVIEW

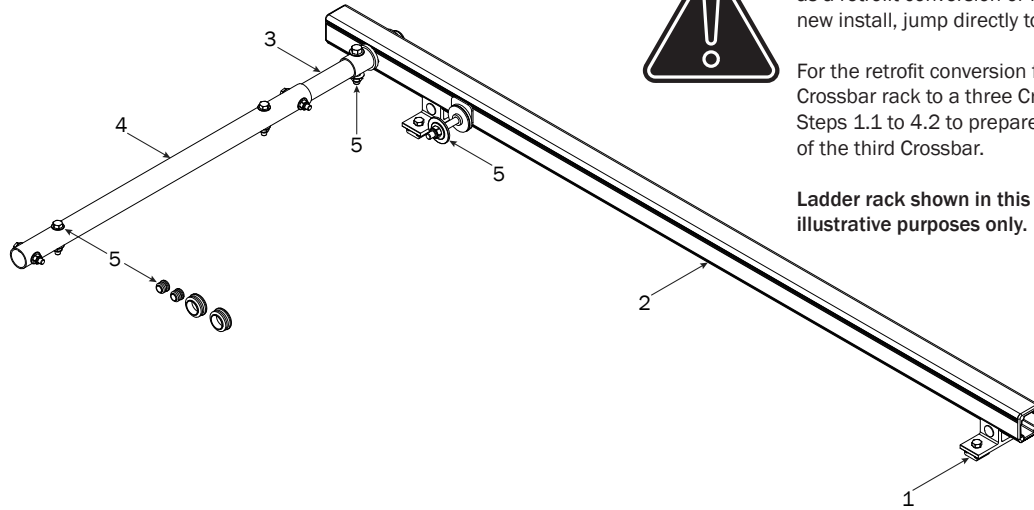

Note: This modular Crossbar kit can be installed as a retrofit conversion or new install. If this is a new install, jump directly to Step 5.1.

For the retrofit conversion from a completed two Crossbar rack to a three Crossbar rack: perform Steps 1.1 to 4.2 to prepare rack for the addition of the third Crossbar.

Ladder rack shown in this manual is for illustrative purposes only.

1—Mounting Brackets..... (Qty 2)



2—Crossbar..... (Qty 1)
57.00"



3—Front Drive Shaft (Qty 1)
11.75"

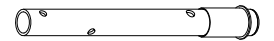

4—Connecting Bar..... (Qty 1)
24.00"

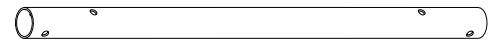

5—HKT-8407 (Qty 1)
Rotation Hardware Kit

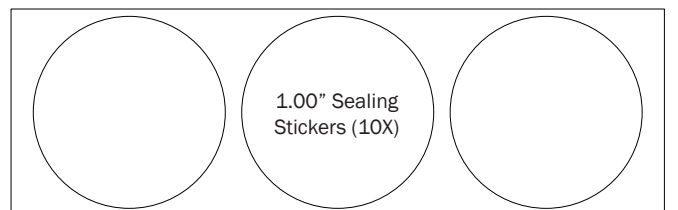
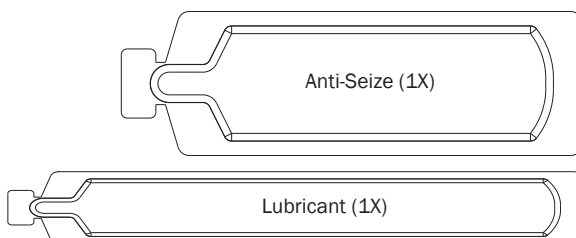
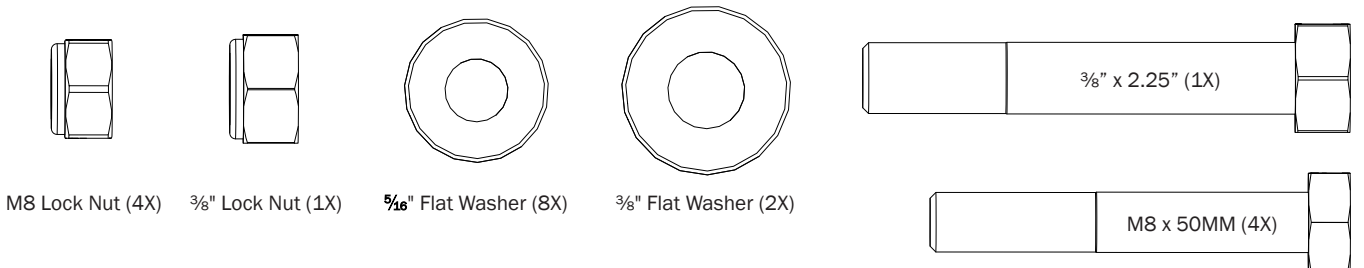
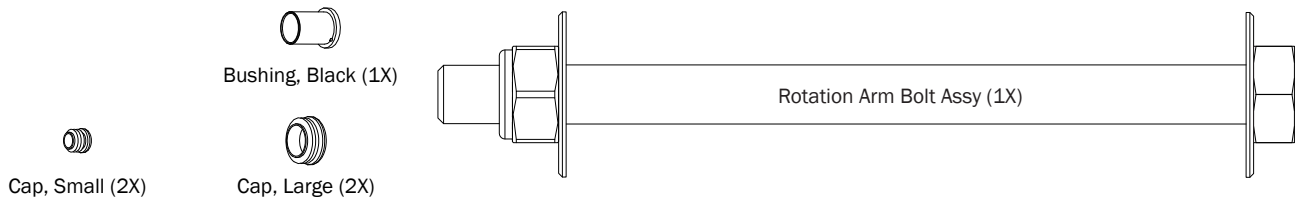

**LEFT ROTATION RETROFIT
CONVERSION SEQUENCE**

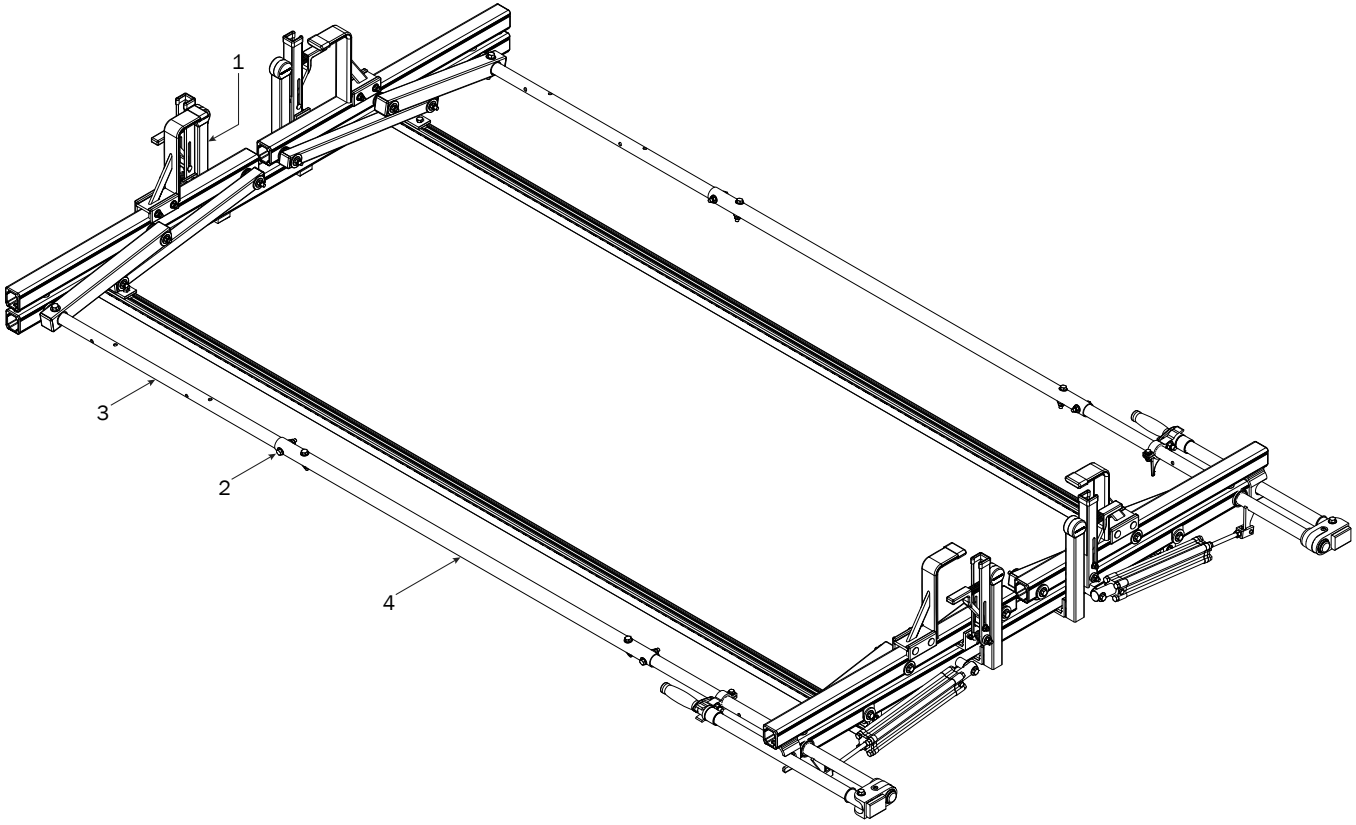

L POST

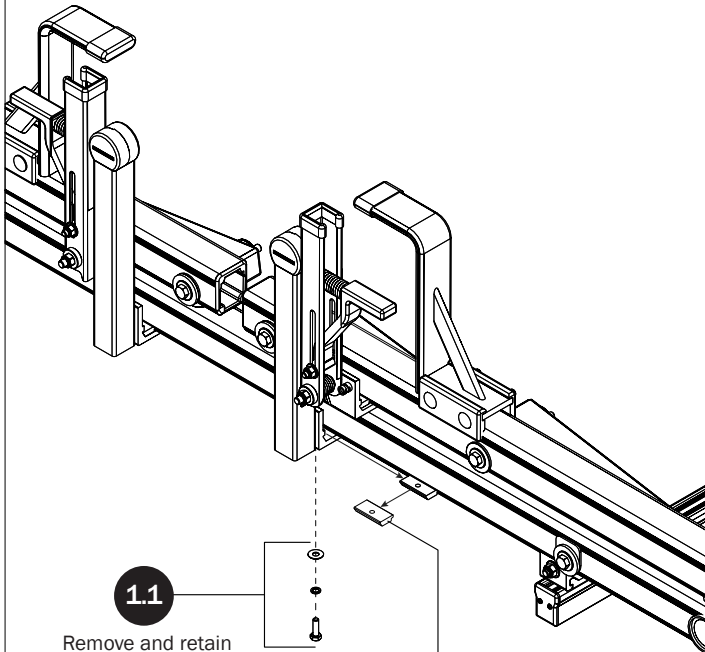

11

Remove and retain for Step 11.3

12

Remove and retain for Step 11.2

13

Remove and retain for Step 11.1

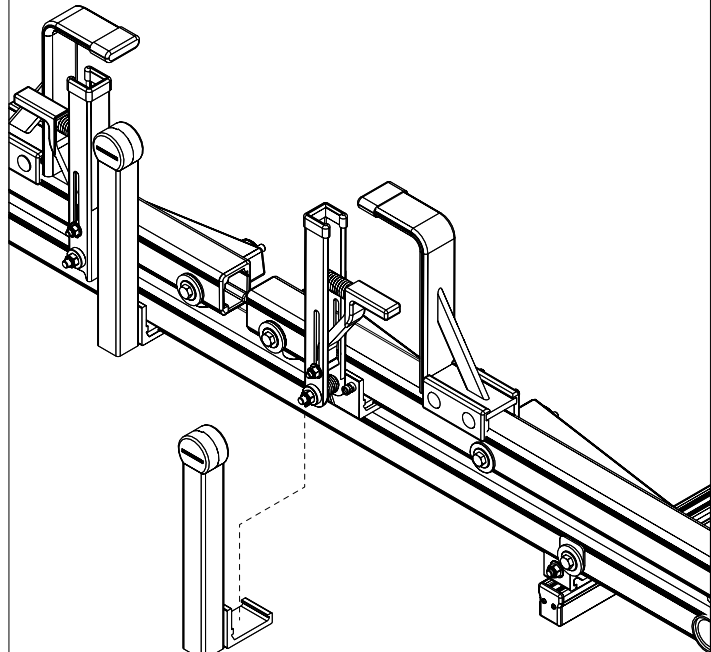

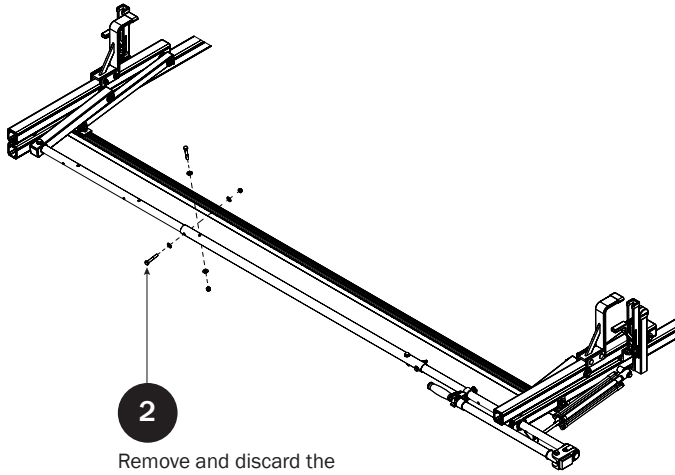
FRONT DRIVE SHAFT

2
Remove and discard the
Connecting Bar hardware.

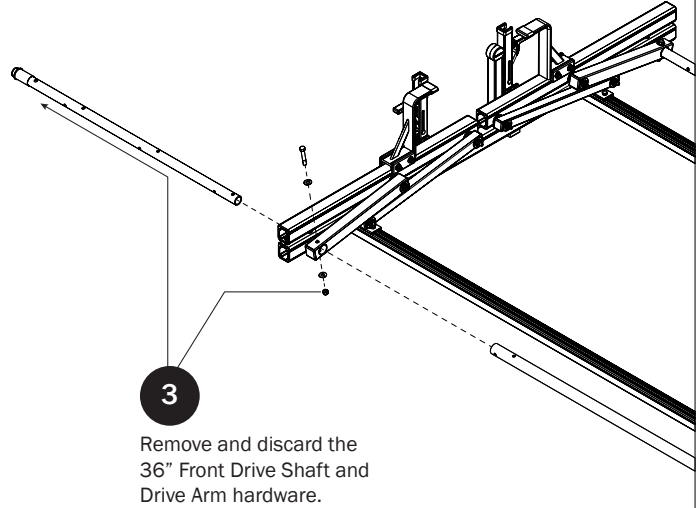

3
Remove and discard the
36" Front Drive Shaft and
Drive Arm hardware.

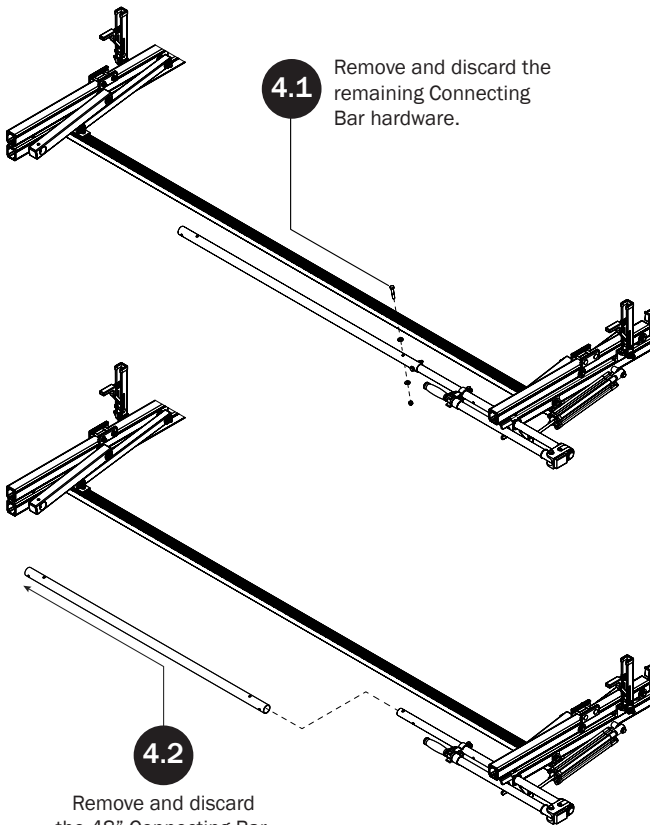
CONNECTING BAR

4.1
Remove and discard the
remaining Connecting
Bar hardware.

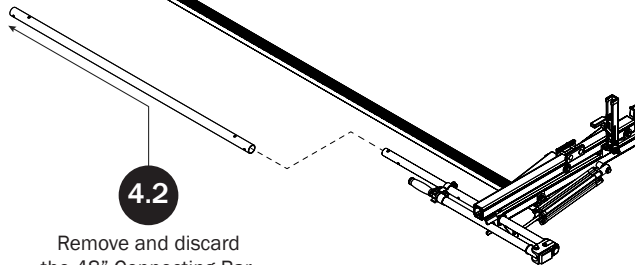

4.2
Remove and discard
the 48" Connecting Bar.

LEFT ROTATION ASSEMBLY SEQUENCE

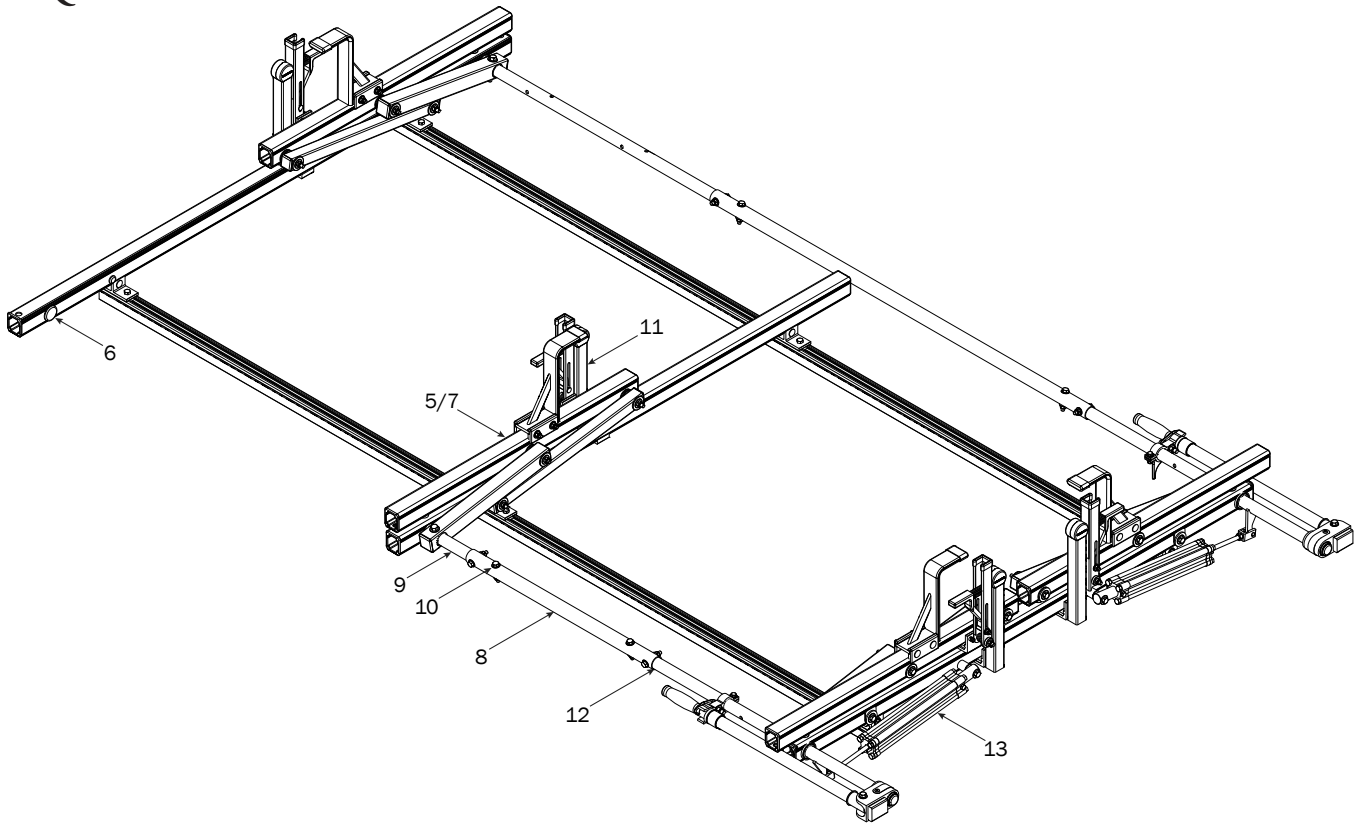

FRONT ROTATION REMOVAL

5.1 Remove the Rotation Arm to Crossbar hardware from the Front Crossbar and discard the steel hardware. It will not be reused.

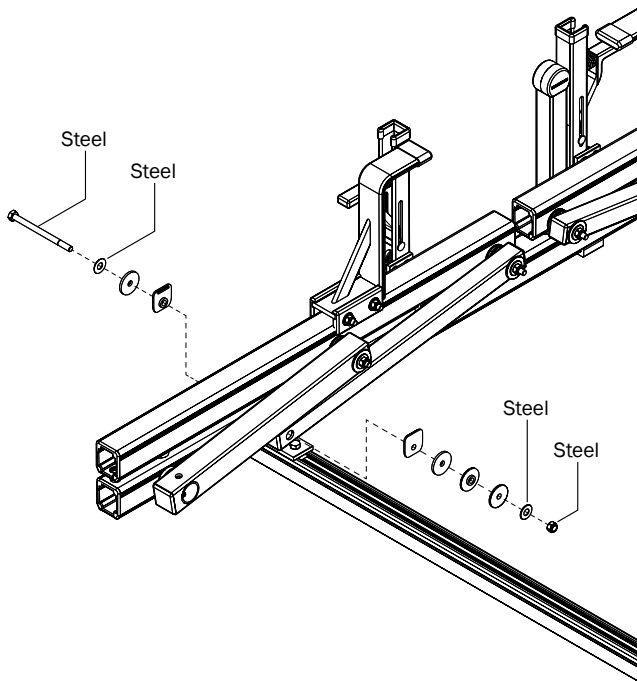

5.2 For a retrofit conversion: Remove and replace the black Drive Shaft (B) Bushing.

For new installations: Leave the white Drive Arm Bushing (A) in place, and remove the black Drive Shaft Bushing from the Front Crossbar. Set aside all components until Steps 7.8-7.11

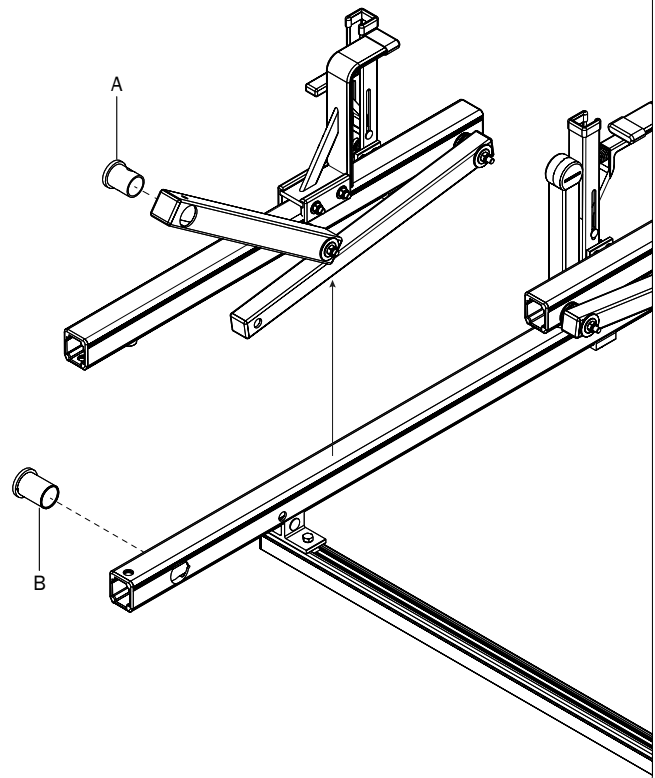

FRONT CROSSBAR

6 Install small .75" (C) and large 1.50" (D) round Caps into the Front Crossbar holes as shown.

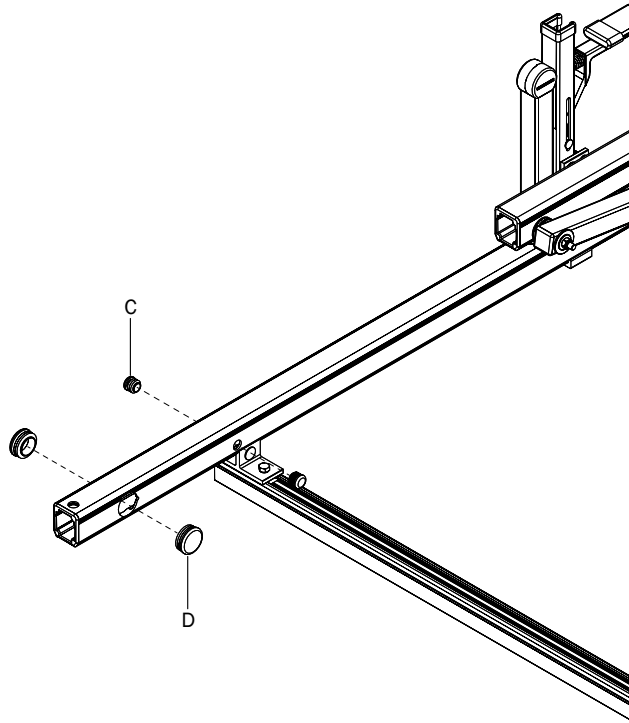

CENTER CROSSBAR

7.1 Remove and retain Channel End Caps and screws for Step 7.4

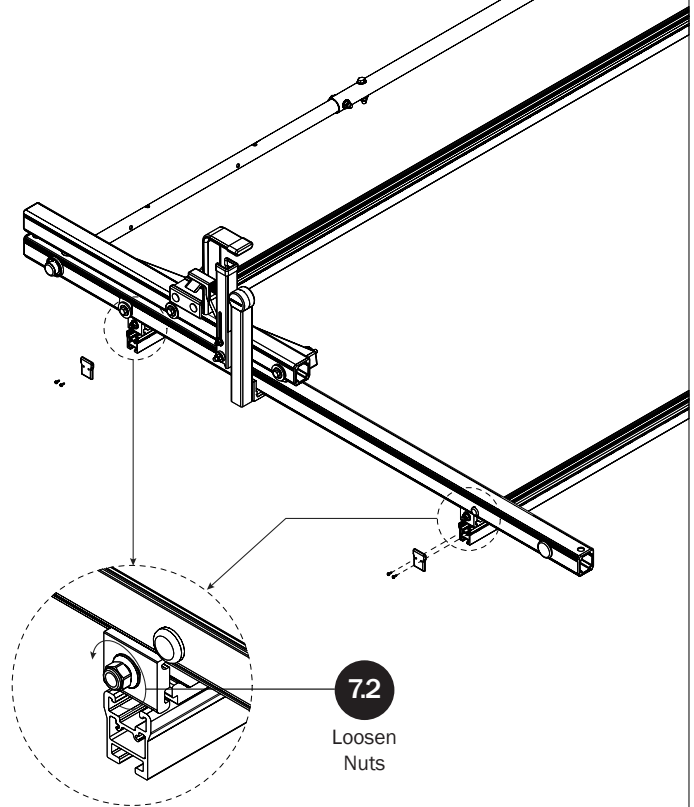

7.3 Slide front Mounting Brackets and adjust as shown in Figure A.

7.4 Place the new Mounting Brackets under the Front Crossbar as shown then reinstall the End Caps.

Loosen bolts

Figure A

48.00"

Left Rear

The diagram shows the front mounting brackets being slid into place on the front crossbar. A side view labeled 'Figure A' shows the brackets positioned on the crossbar with a dimension line indicating a distance of 48.00 inches between the centers of the brackets. The text 'Left Rear' is at the bottom.

Loosen bolts

7.5 Torque to 120 in-lbs

A perspective view of the front crossbar assembly with the mounting brackets. A callout circle shows a close-up of a bolt being tightened on the bracket. The text '7.5 Torque to 120 in-lbs' is next to it.

7.6 Place the Center Crossbar onto the Mounting Brackets, then position as shown in Figure B.

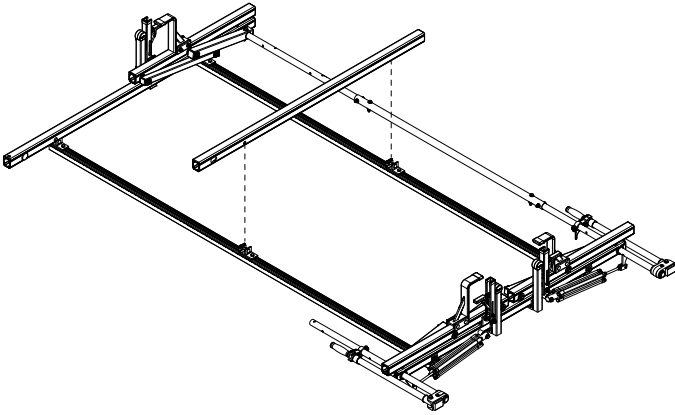
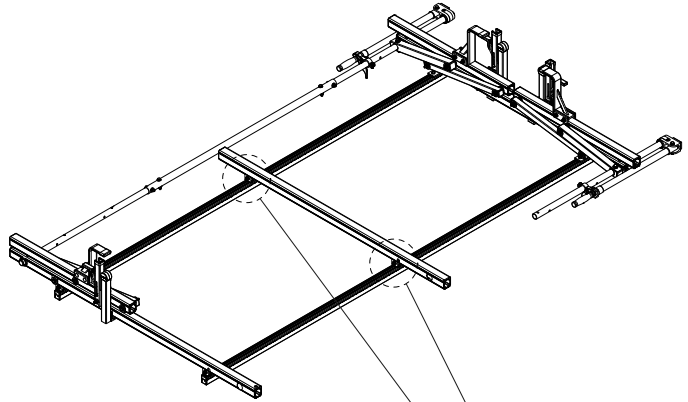
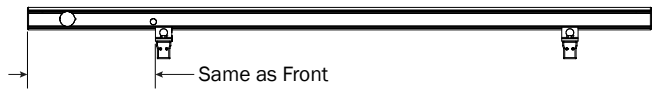
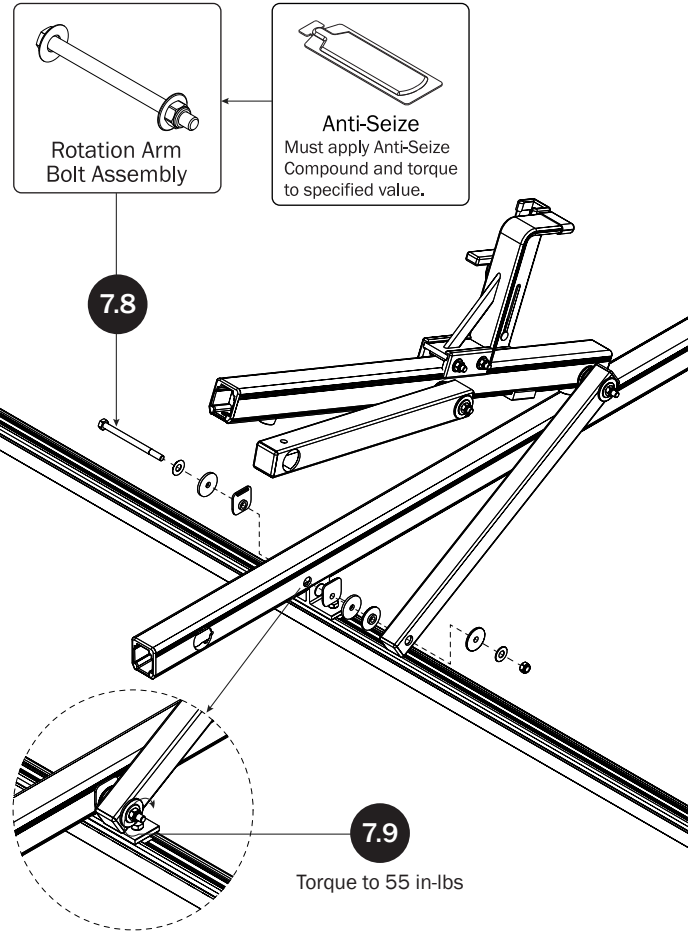
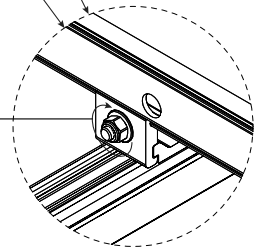

Figure B



7.7

Torque to 120 in-lbs



Rotation Arm Bolt Assembly

Anti-Seize
Must apply Anti-Seize Compound and torque to specified value.

7.8

7.9

Torque to 55 in-lbs

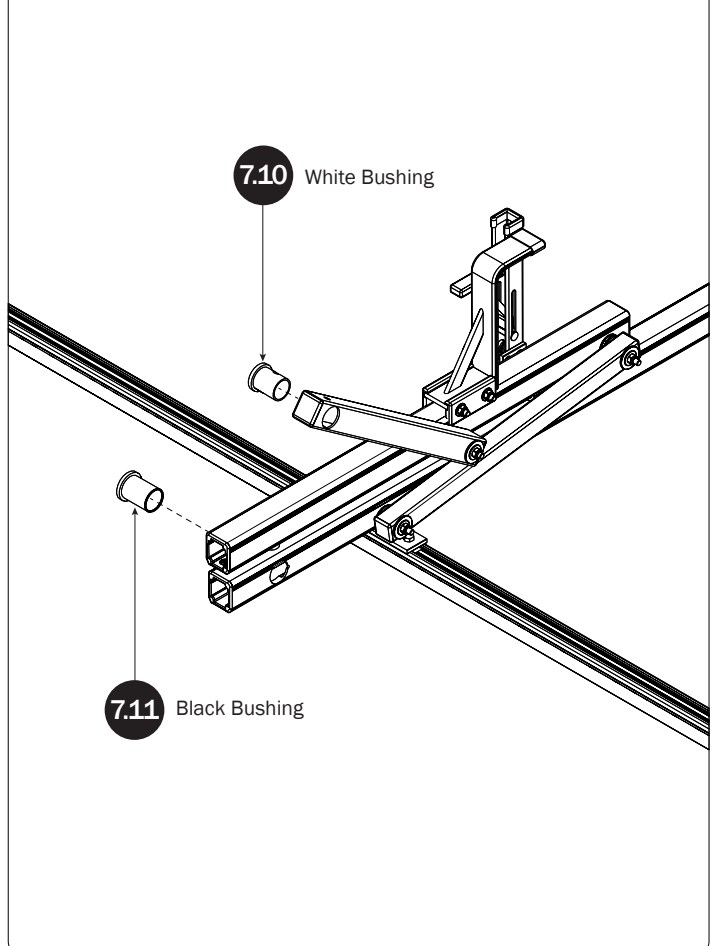

7.10 White Bushing

7.11 Black Bushing

CONNECTING BAR

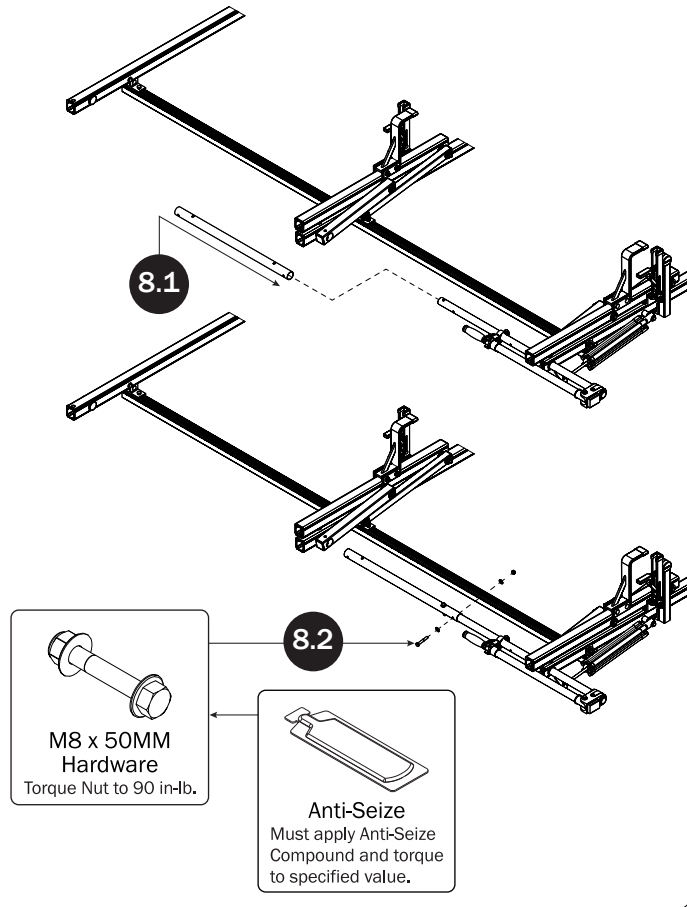

FRONT DRIVE SHAFT

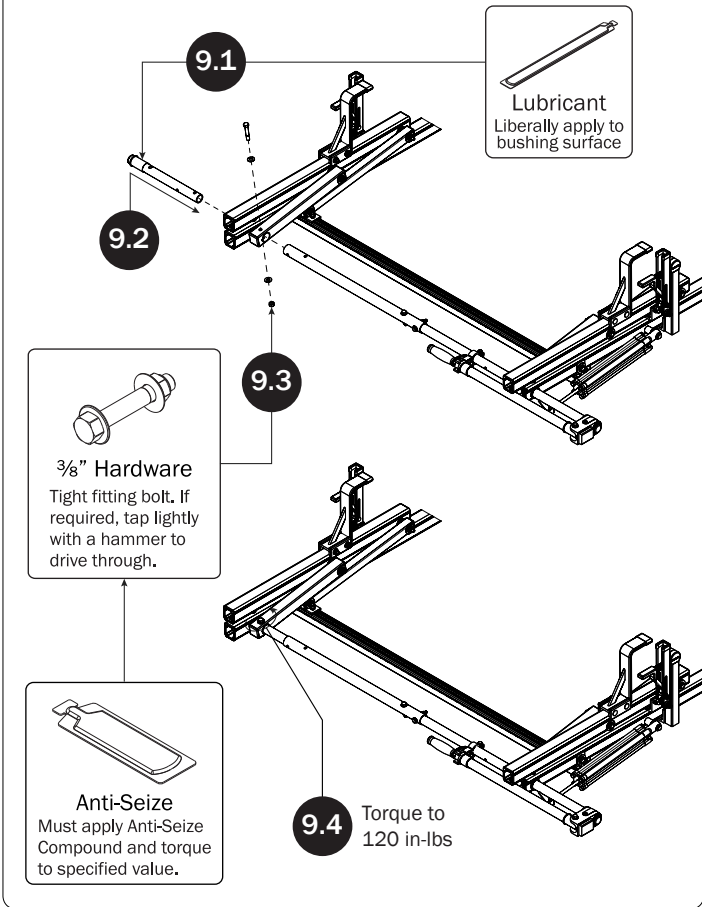

CONNECTING BAR FASTENERS

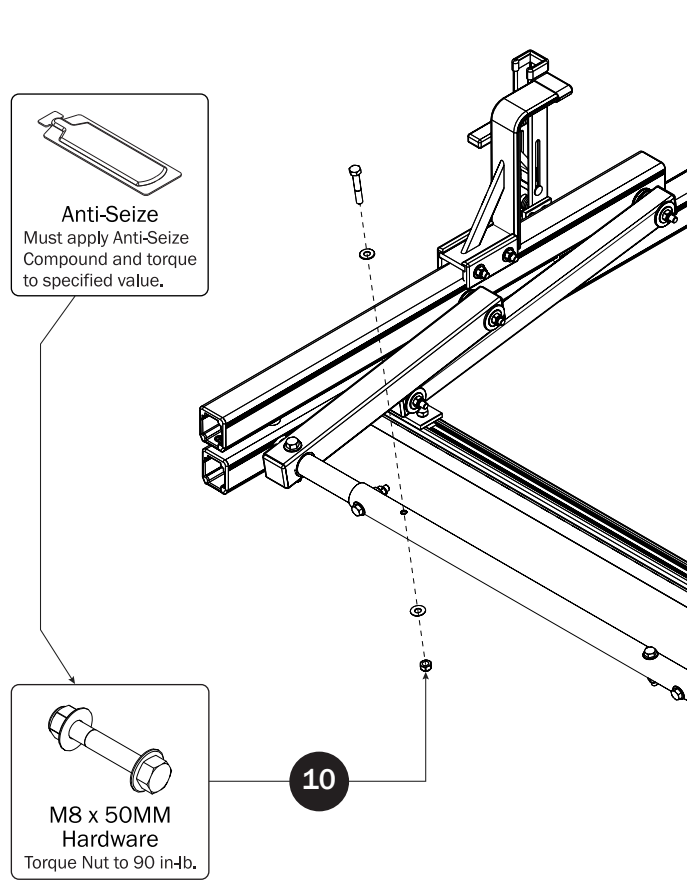

L POST
SEE QUICK START GUIDE FOR ADJUSTMENTS

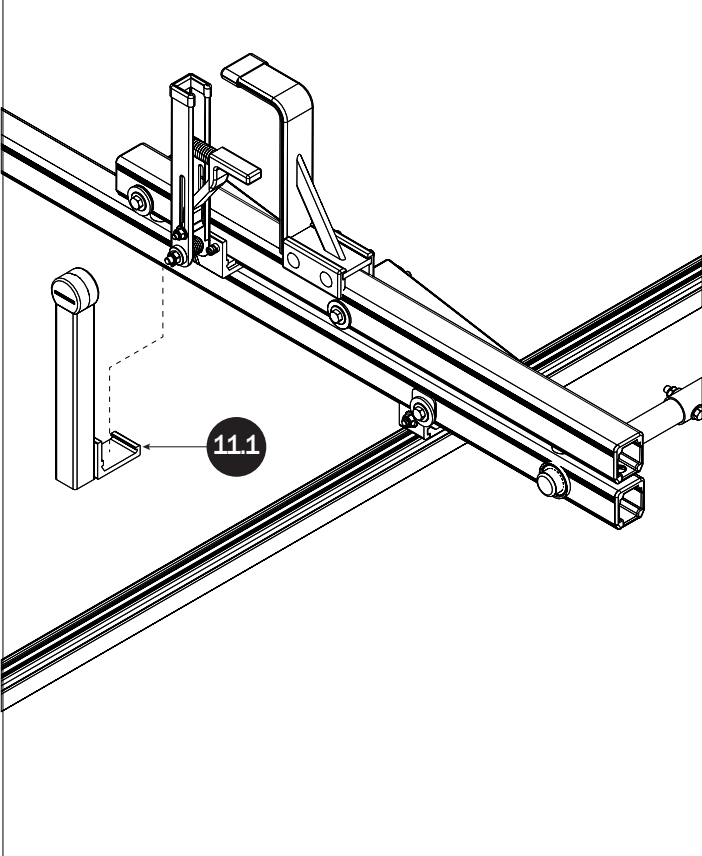

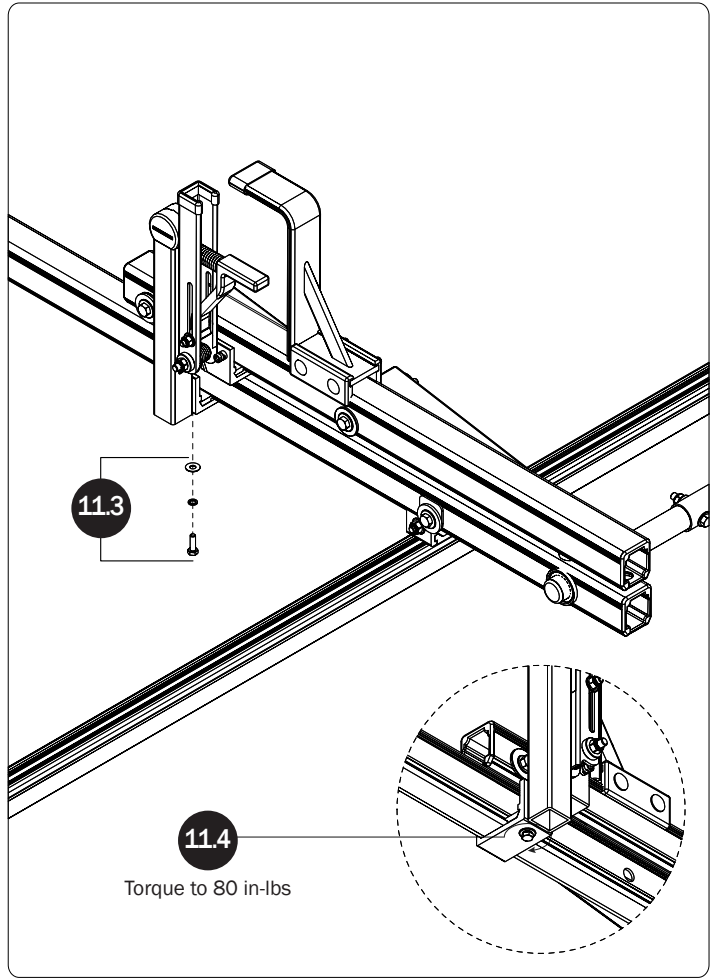
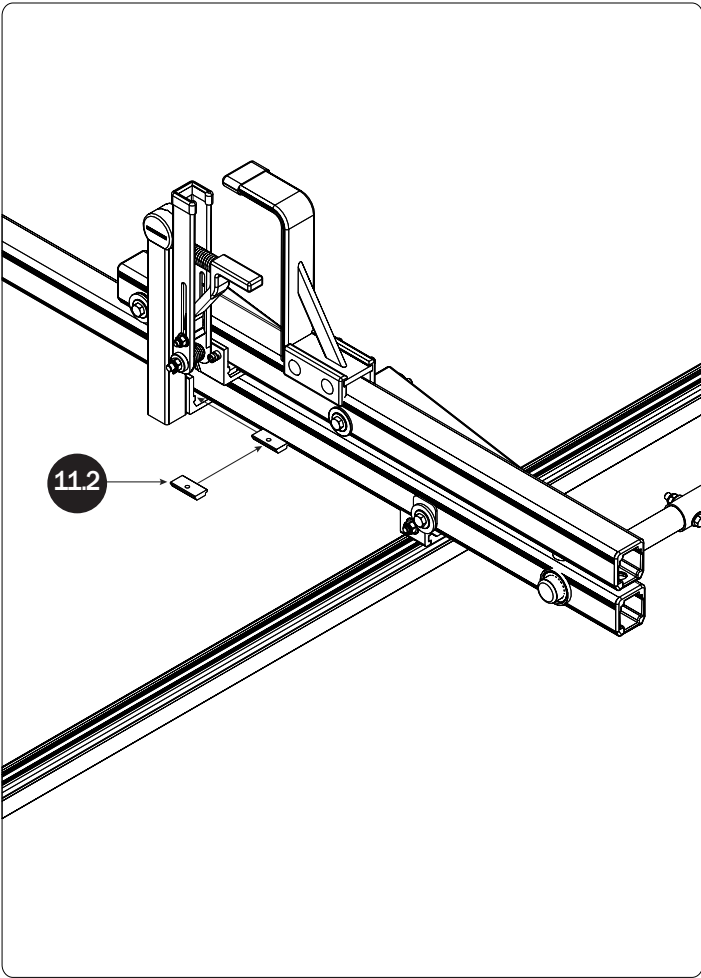

DRIVE SHAFT SEALING

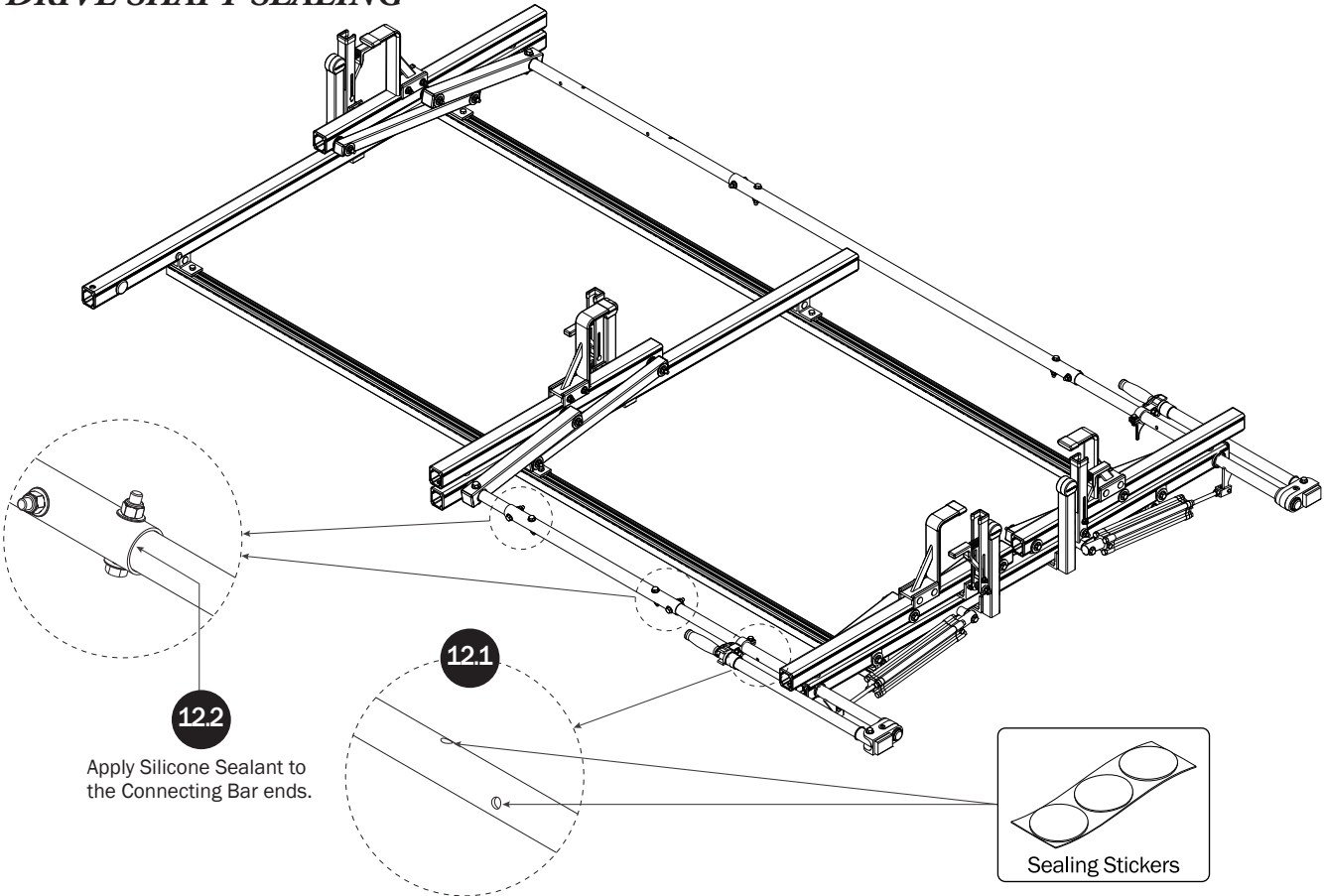

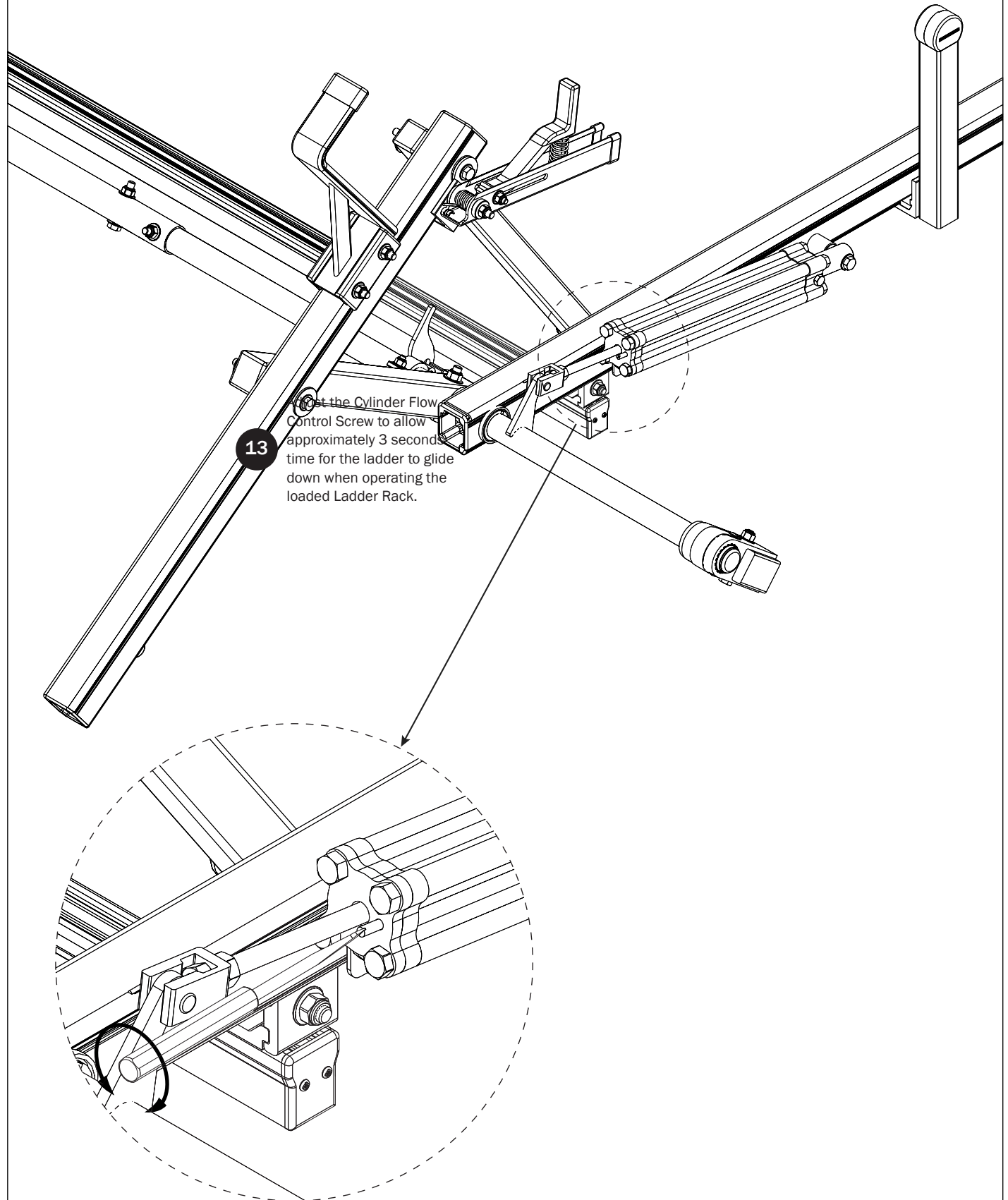

Page Intentionally Left Blank

