

CBA-3006

68" Crossbar Assembly Module

Dimensional Specifications on Page 2

Configuration as shown:

Rotation Left/Rotation Right

Two Crossbars, Powder Coat Finish

Weight: 54 lbs

A: CB4-9711-68-11 LH/RH Rear Rotation

A1:..... CBR-1711-68 Interlocking Crossbar

A2:..... CYL-8801 Cylinder

A3:..... ELR-7282 Z-Post Bracket

A4:..... ELR-7080 Z-Post

A5:..... ELR-7073 L-Post

B:..... CB4-9111-68-11 LH/RH Front Rotation

B1:..... CBR-1311-68 Crossbar

B2:..... ELR-7282 Z-Post Bracket

B3:..... ELR-7080 Z-Post

B4:..... ELR-7073 L-Post

C:Quick Start Guide (not shown)

[Modular Assembly Manuals](#)

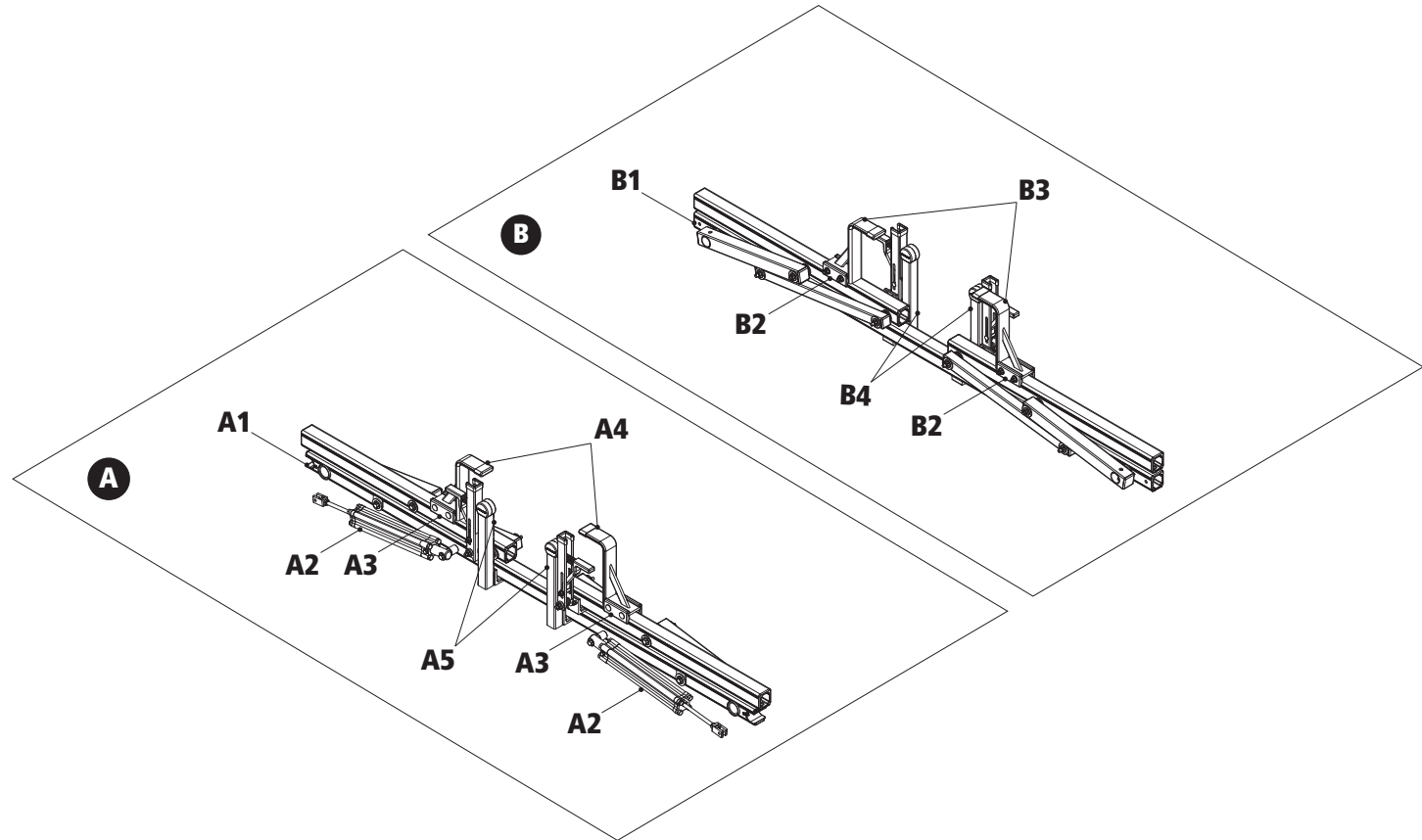

**Note: Mounting Hardware, Drive Shafts,
and Connecting Bars are purchased separately.*

For more information, please contact Sales & Support.

CBA-3006

68" Crossbar Assembly Module

Approximate dimensions as shown:

- A: Crossbar Length..... 68"
- B: Assembly Height..... 12.50"

*Note: Mounting Hardware, Drive Shafts, and Connecting Bars are purchased separately.
For more information, please contact Sales & Support.

Assembly Manual also available:

[CBA-3006](#)

USOV-CBA3006-US01 Rev-A 1118

*Other Parts and Hardware ordered separately

Typical Assembly with CBA-3006

