

FoldProSHELVING™

Doc#: USAM-FPM1020-US01 REV A 1123

Revised: 11/16/23 WLH

PRIME DESIGN, A SAFE FLEET BRAND • Address: 580 Opperman Drive, Eagan, MN 55123 • Toll Free: 1.8.PRIME.RACK • Fax: 651-552-1799 • Email: info@primedesign.net
Website: www.primedesign.net • TM & © 2022 PRIME DESIGN. PROTECTED BY ONE OR MORE OF THE FOLLOWING PATENT NO.'s 6764268, 6971563, 8511525, 8991889, 9102482, 9415726, 9481314, 9506292, 9776476, 9796340, 10470565, 10486608, 10501022, 10578182, 10654420, 10688937, 10836312 AND OTHER PATENTS PENDING



Table of Contents

FPM-1020 / Ford Transit & High Roof

Assembly Requirements 1

FoldPro Shelving Mounting System Ford Transit HR/MR FPM-1020 / Rev. B ... 2

HKT-0270 Hardware Kit - FoldPro Mounting Ford Transit 3

FPM Assembly Sequence 4-5



Assembly Requirements



INSTALLER NOTE: It is important to correctly follow these assembly instructions. These instructions for assembly are provided by the manufacturer at time of FoldPro Shelving delivery, and reflect the technical specifications applicable at the time of writing.

- These instructions are subject to change if the manufacturer revises the parts and/or production of the subsystems and accessories used in the brand's vehicles. Following the instructions for assembly will ensure proper installation of the product. The manufacturer will not be held liable if these instructions are not followed.
- The addition of parts and/or components not original to this FoldPro Shelving are discouraged. Use only OEM supplied parts.
- Consultation of the OEM vehicle may be required during assembly to avoid vehicle damage. Ensure bolt locations will not damage any critical parts of the vehicle—i.e. gas tank, wiring harnesses, or hoses—before drilling.

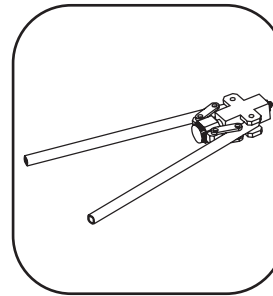

Plus Nut Applicator Tool

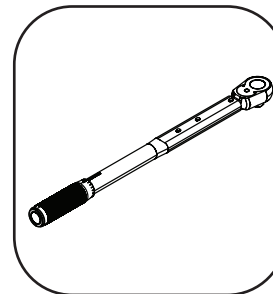

Torque Wrench w/ 13MM Socket



ASSEMBLY INSTRUCTIONS

FoldPro Shelving

ITEM	PART #	DESCRIPTION	QTY
1	BRT-8570	TRANSIT INTERIOR MOUNTING ASSEMBLY	6
2	HKT-0270	HARDWARE KIT FOLDPRO MOUNTING FORDTRANSIT	1
3	CHL-8175	MOUNTING CHANNEL ASSEMBLY 24 IN 2 X 2 NBR	1
4	CHL-8176	MOUNTING CHANNEL ASSEMBLY 32 IN 2 X 2 NBR	1
5	CHL-8177	MOUNTING CHANNEL ASSEMBLY 51 IN 2 X 2 NBR	1
6	BOX-1129	BOX, L(51.75") X W(4.75") X D(4.00")	1
7	AV-1118	CANTILEVER SHELVING ANGLE MOUNTING BRACKET	6
8	LBL-0290	FPM-1020 LABEL	2

FoldPro Shelving Mounting System Ford Transit HR/MR FPM-1020 / Rev. B

REV. 06/29/23 MH

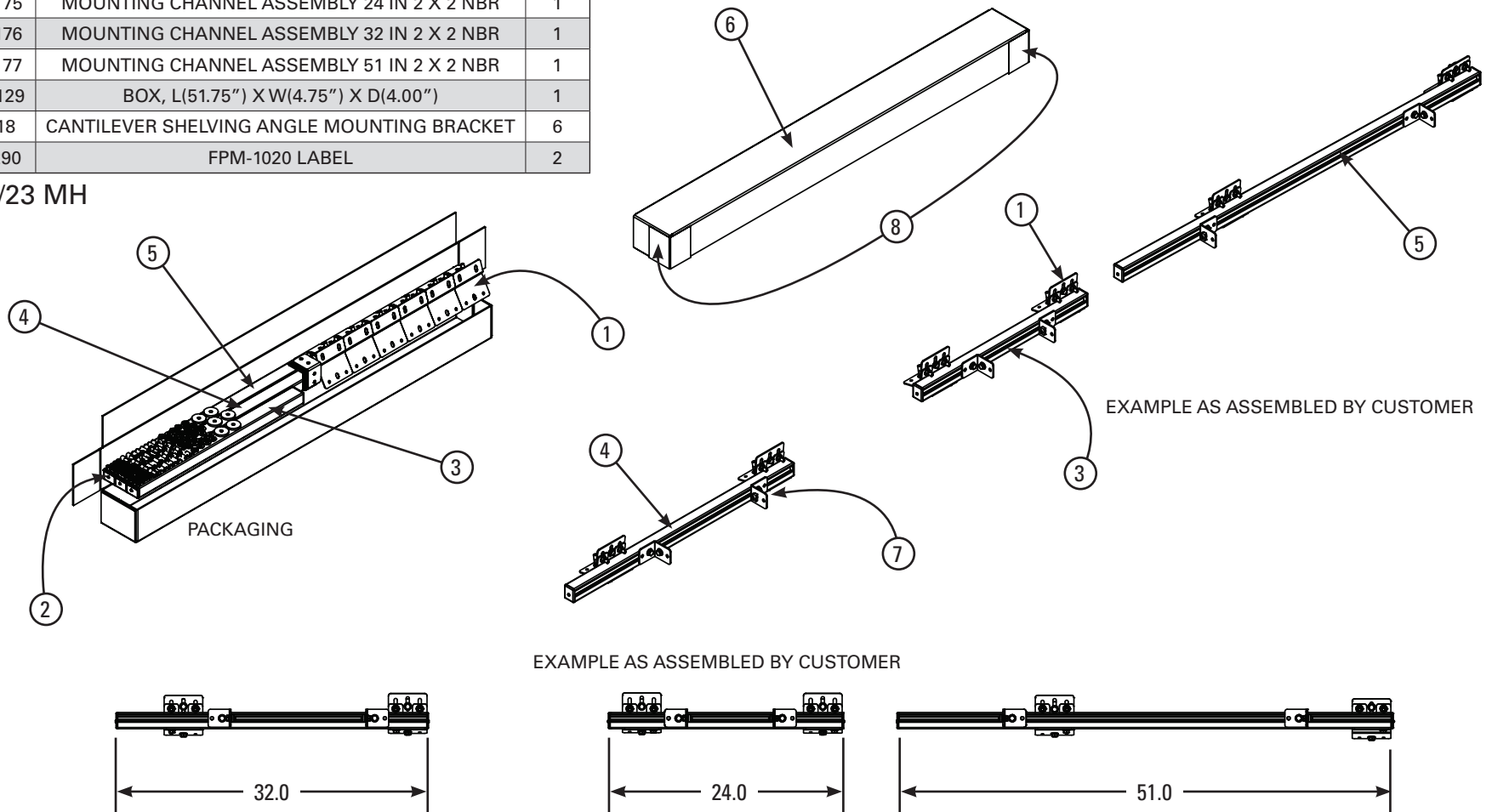



ASSEMBLY INSTRUCTIONS

FoldPro Shelving

HKT-0270 Hardware Kit - FoldPro Mounting Ford Transit

ITEM	PART #	DESCRIPTION	QTY
1	BLT-1025-M8	M8 X 25MM HEX HEAD BOLT	12
2	WSH-1150	CADDY MOUNTING SPACER	6
3	NRV-1025-M8	NUT RIVET M8 X 1.25MM	6
4	WSH-1001-G	5/16" FLAT WASHER	30
5	WSH-1002-G	5/16" LOCK WASHER	30
6	BLT-1018-M8	M8 X 18MM HEX HEAD BOLT	18
7	NBR-1014	ALURACK CROSSBAR NUT BRACKET	6
8	BAG-3516	BAG, POLY 4 MIL 5" X 16"	1

REV. 05/05/23 MH

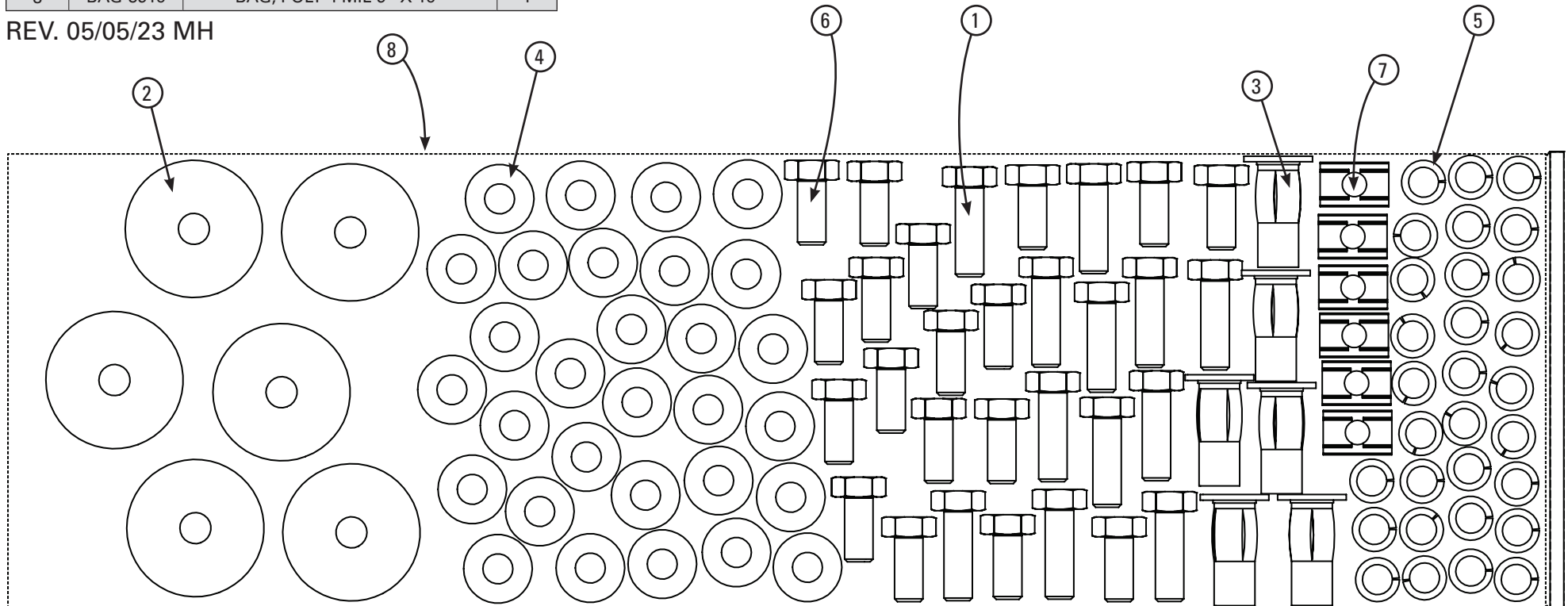



FPM Assembly Sequence

Fig. 1A

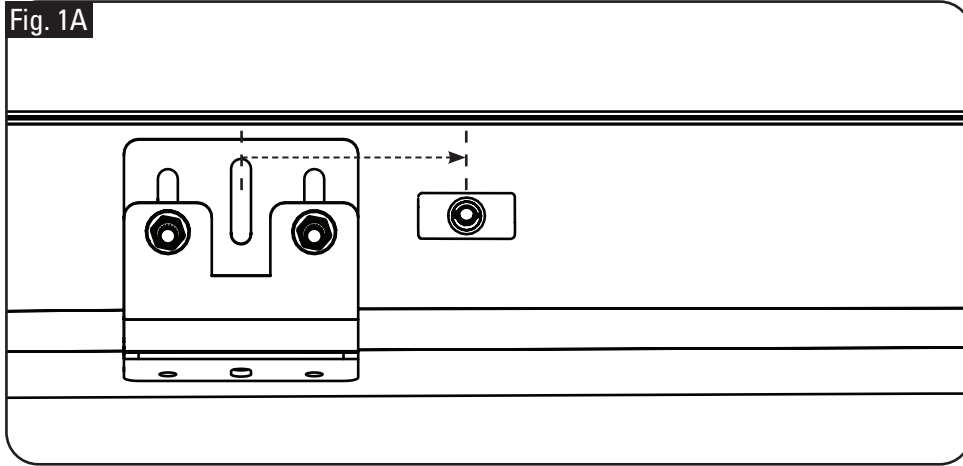
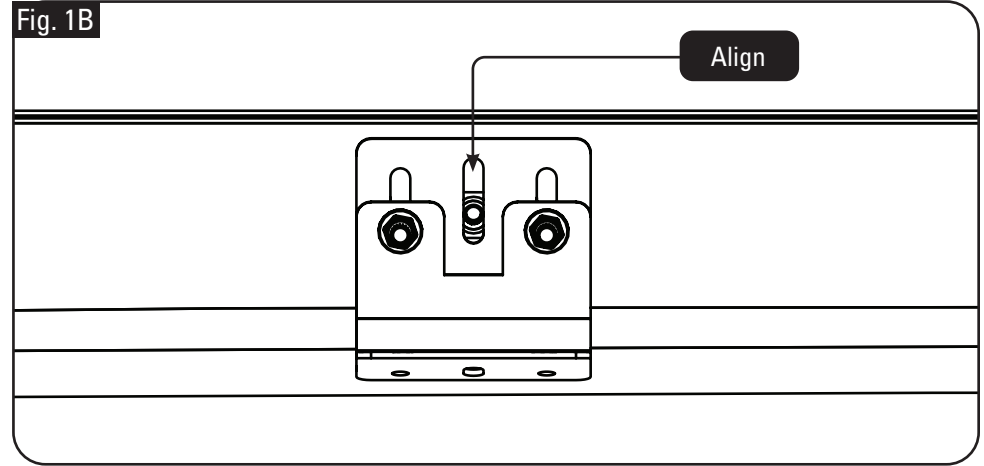
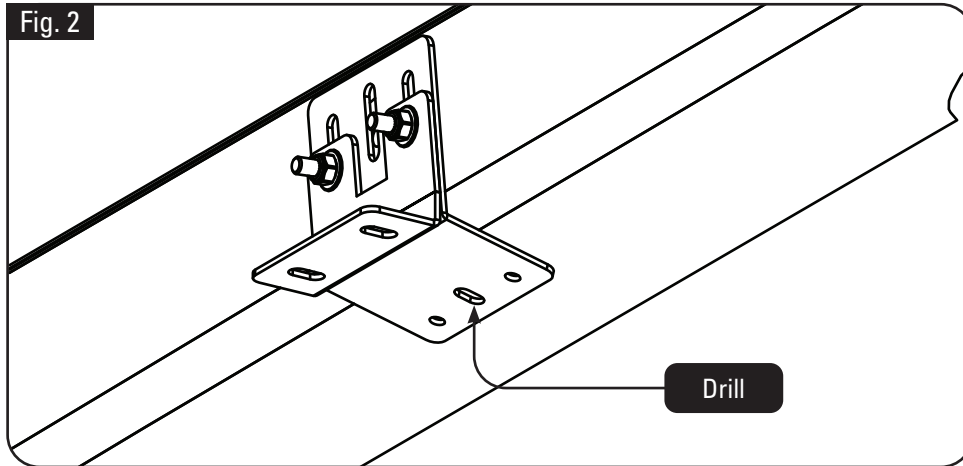

Fig. 1B



Step 1: Locate the factory tie in hole locations on the Van Wall and align with an Interior Mounting Assembly (Fig. 1A & B).

Fig. 2



Step 2: Drill into the location shown (Fig. 2).

Fig. 3

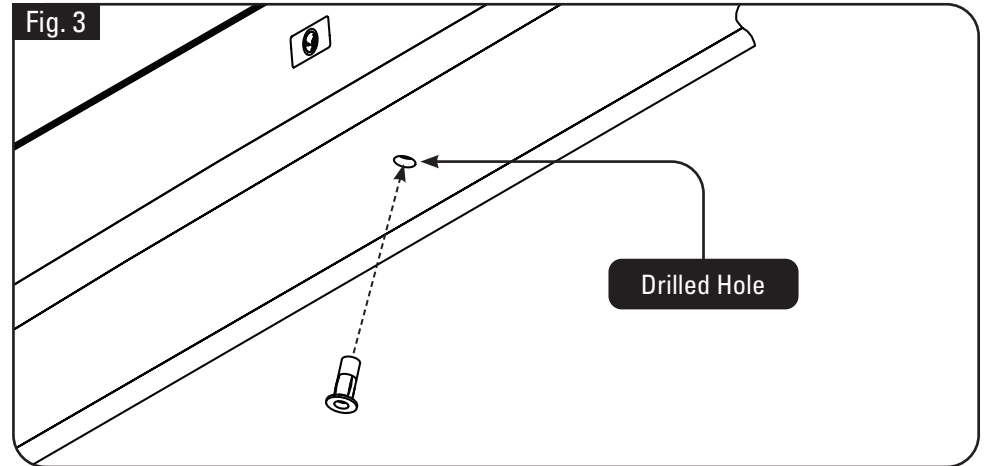

Step 3: Install a Nut Rivet into the drilled hole (Fig. 3).



ASSEMBLY INSTRUCTIONS

FoldPro Shelving

FPM Assembly Sequence

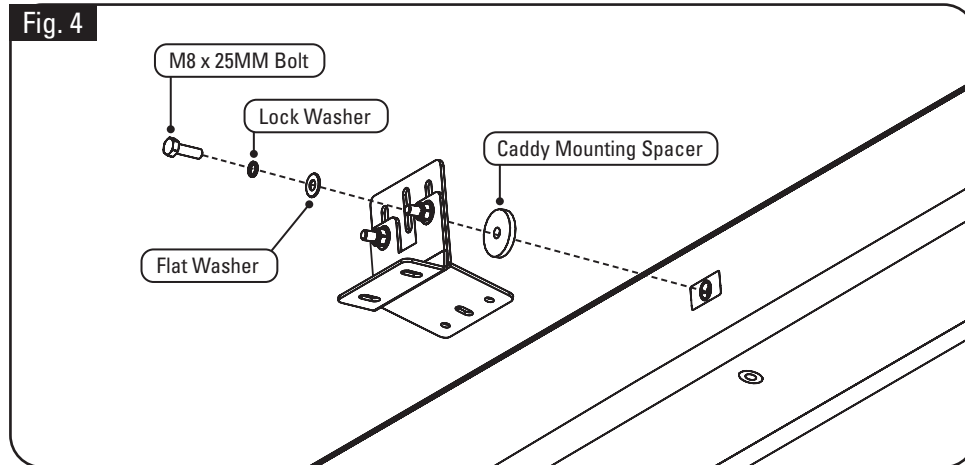

Step 4: Attach the Interior Mounting Assembly with Hardware as shown into the factory tie in hole (Fig. 4). Torque to 90 in-lbs.

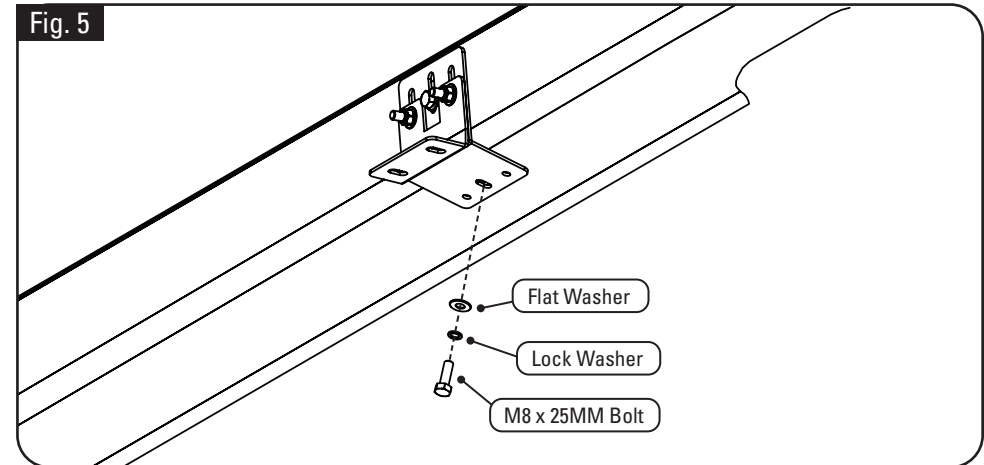

Step 5: Install Hardware into the lower Mounting Assembly hole as shown (Fig. 5). Torque to 90 in-lbs.

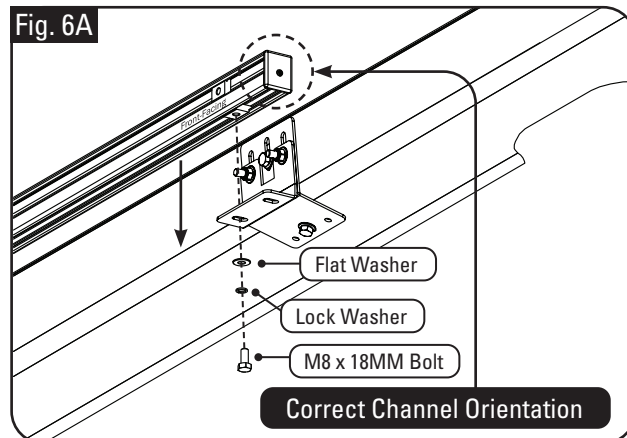

Step 6: Install the Mounting Channel in its correct orientation using Hardware as shown (Fig. 6A). Torque to 90 in-lbs. Repeat Steps 1-6 on all parts and hardware as needed for your specific configuration. Incorrect Channel orientation shown (Fig. 6B).

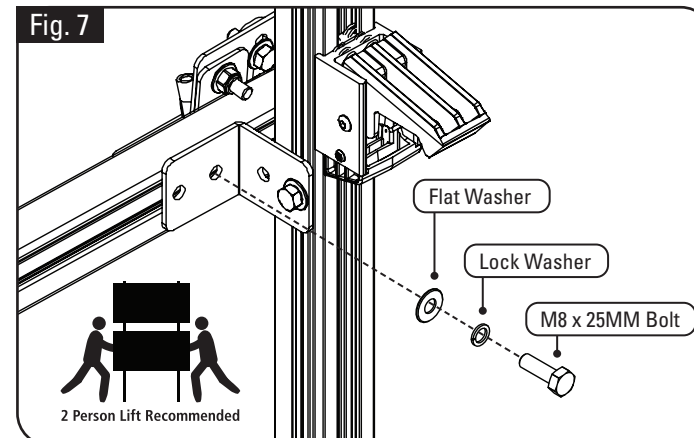
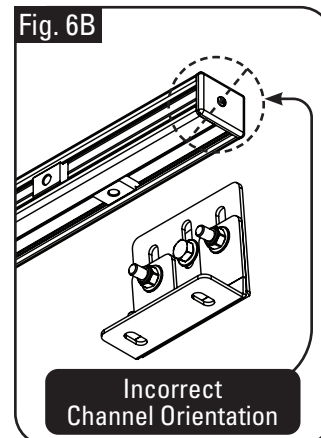

Step 7: Uprights (sold separately) are installed into FPM-XXXX according to your specific configuration (Fig. 7). Torque hardware to 90 in-lbs.

*Hardware used is from HKT-0270 contained in Upright packaging FPU-3250 (sold separately). NOTE: View below is shown with shelving removed for visual clarity.